

Important

Danger

- Do not immerse the appliance in water, nor rinse it under the tap.

Warning

- Check if the voltage indicated on the appliance corresponds to the local power voltage before you connect it.
- Only connect the appliance to a grounded power outlet. Always make sure that the plug is inserted firmly into the power outlet.
- Do not use the appliance if the plug, the power cord, the inner pot, the sealing ring, or the main body is damaged.
- Make sure that the damaged power cord is replaced by Philips, a service center authorized by Philips or similarly qualified persons in order to avoid a hazard.
- This appliance can be used by children aged from 8 years and above and persons with reduced physical, sensory or mental capabilities or lack of experience and knowledge if they have been given supervision or instruction concerning use of the appliance in a safe way and understand the hazards involved. Children shall not play with the appliance. Cleaning and user maintenance shall not be made by children without supervision.
- Keep the appliance and its cord out of reach of children.
- Do not let the power cord hang over the edge of the table or worktop on which the appliance stands.
- Make sure the heating element, the temperature sensor, and the outside of the inner pot are clean and dry before you put the plug in the power outlet.
- The heating element surface is subject to residual heat after use.
- Do not plug in the appliance or touch the control panel with wet hands.
- The appliance is not intended to be operated by means of an external timer or a separate remote-control system.
- The ducts in the pressure regulator allowing the escape of steam should be checked regularly to ensure that they are not blocked.
- Make sure the power socket is clean and dry before you plug in the appliance.
- The container must not be opened until the pressure has decreased sufficiently.
- Do not use the appliance if too much air or steam is leaking from under the top lid.

- When cooking soup or viscous liquid, do not release pressure by turning the pressure regulator to the steam vent position, otherwise liquid might spurt from the pressure regulator valve. Wait until the pressure is naturally released and the floater has dropped to open the top lid.
- Make sure to follow the instructions in the user manual to avoid a potential hazard.

What's in the box (fig. 1)

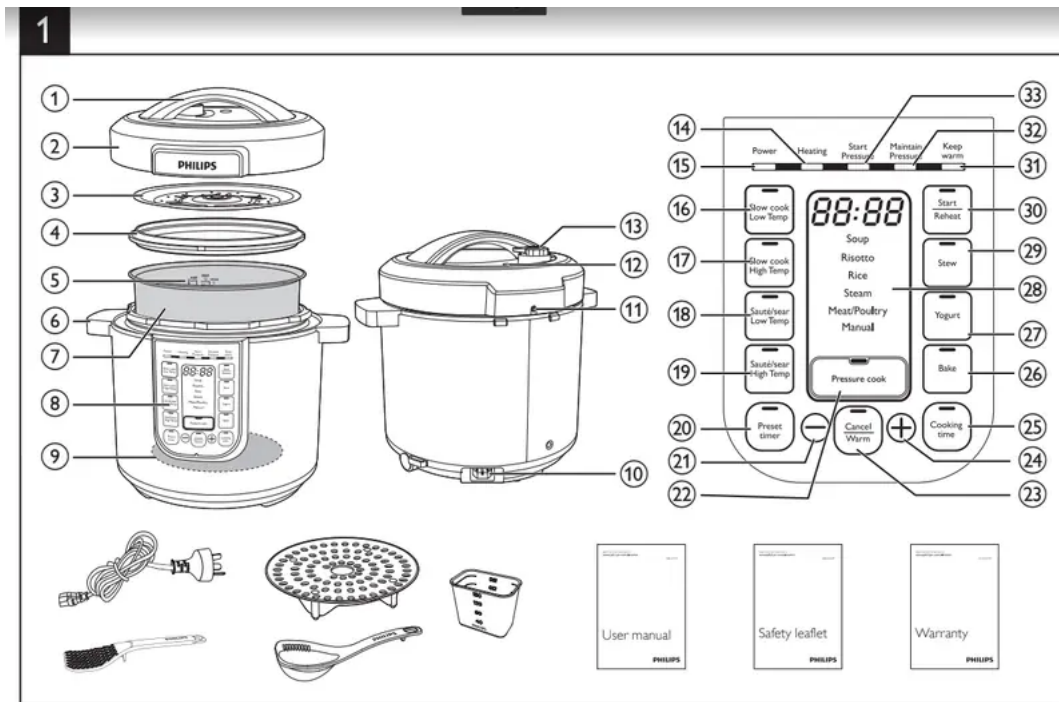

Overview (fig. 1)

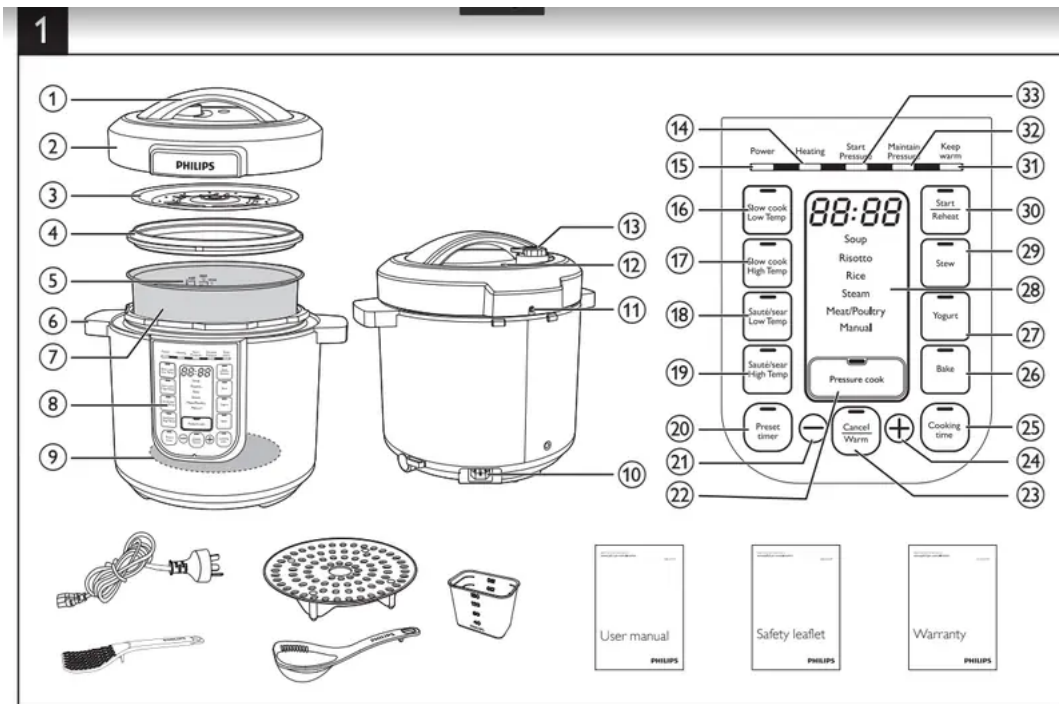

Product overview

① Lid handle	⑧ Control Panel
② Top lid	⑨ Heating element
③ Detachable inner lid	⑩ Power socket
④ Sealing ring	⑪ Locking pin
⑤ Water level indications	⑫ Floater
⑥ Side handle	⑬ Pressure regulator
⑦ Inner pot	

Controls overview

⑭	Heating indicator	⑳	Cooking time button
⑮	Power indicator	㉑	Bake button
⑯	Slow cook button (low temperature)	㉒	Yogurt button
⑰	Slow cook button (high temperature)	㉓	Stew button
⑱	Sauté/sear button (low temperature)	㉔	Start/Reheat button
㉒	Sauté/sear button (high temperature)	㉕	Pressure cook button
㉓	Preset timer button	㉖	Display screen
㉔	Decrease button	㉗	Keep warm indicator
㉕	Cancel/Warm button	㉘	Maintain pressure indicator
㉖	Increase button	㉙	Start pressure indicator

Functions overview

Pressure cooking functions		
Cooking function	Default pressure keeping time (minute)	Pressure keeping time regulating range (minute)
Soup	20	25-59
Risotto	14	Not adjustable
Rice	14	Not adjustable
Steam	10	5-59
Meat/Poultry	15	12-59
Manual	2	2-59
Normal cooking functions		
Cooking function	Default cooking time	Cooking time regulating range
Slow cook (low temperature)	6 hours	2 - 12 hours
Slow cook (high temperature)	6 hours	2 - 12 hours
Sauté/sear (low temperature)	2 minutes	2 minutes - 2 hours
Sauté/sear (high temperature)	2 minutes	2 minutes - 2 hours
Stew	1 hour	20 minutes - 10 hours
Yogurt	8 hours	6 - 12 hours
Bake	45 minutes	10 - 59 minutes
Reheat	25 minutes	8 - 25 minutes

Using the electric pressure cooker

Before first use

1. Remove all packaging materials from the appliance.
2. Take out all the accessories from the inner pot.

3. Clean the parts of the electric pressure cooker thoroughly before using it for the first time (see chapter 'Cleaning and Maintenance').

Preparations before cooking (fig. 2)



Before using the electric pressure cooker to cook food, follow below preparation steps:

1. Hold the lid handle and turn it anti-clockwise until the top lid cannot move any more, then lift up the top lid.

2. Take out the inner pot from the electric pressure cooker and put the pre-washed food in the inner pot.
3. Wipe the outside of the inner pot dry, then put it back into the electric pressure cooker.
4. Place the top lid onto the electric pressure cooker and turn it clockwise. You will hear a “click” sound when the top lid is properly locked.

Cooking food (fig. 3)

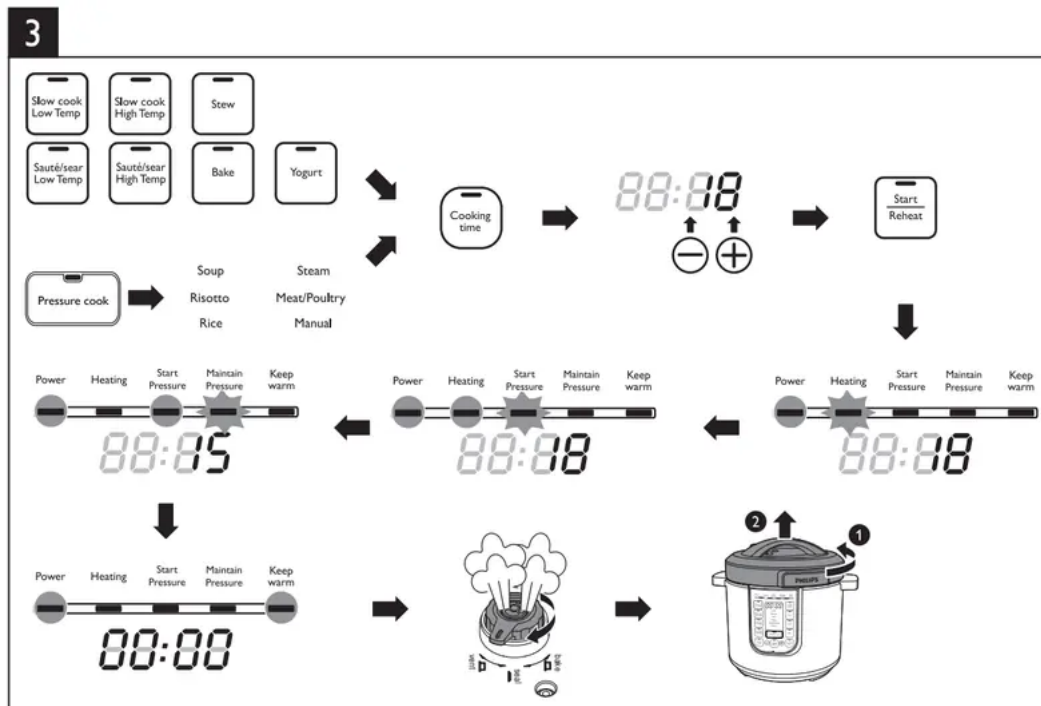

Pressure cooking

1. Follow the steps in “Preparations before cooking”.
2. Turn the pressure regulator to seal.
3. Put the plug in the power socket. → The power indicator starts flashing.
4. Press Pressure cook to choose one of the pressure cooking functions - Soup, Risotto, Rice, Steam, Meat/ Poultry or Manual. → The default pressure keeping time is displayed on the screen.
5. To set a different pressure keeping time, press Cooking time.
6. Press + or - to set the pressure keeping time.
7. Press Start/Reheat to start the cooking process.
8. When the electric pressure cooker reaches the working pressure: → Maintain Pressure lights up;
9. When the pressure keeping time has elapsed, the electric pressure cooker automatically switches to keep warm mode. → The keep warm indicator (Keep warm) lights up.

10. Turn the pressure regulator to vent. → The electric pressure cooker starts releasing pressure. → The floater drops down when the pressure is released sufficiently.
11. Hold the top lid handle and turn the lid anti-clockwise until it cannot move any more, then lift it up.

Normal cooking

To cook food with normal pressure, press the cooking buttons and choose Slow cook, Sauté/sear, Stew, Yogurt or Bake.

1. Follow the steps in “Preparations before cooking”.
2. Turn the pressure regulator to bake or seal.
 - For Slow cook, Stew and Yogurt, turn the pressure regulator to seal.
 - For Bake, turn the pressure regulator to bake.
3. Put the plug in the power socket. → The power indicator (Power) starts flashing.
4. Press the desired cooking function button to choose a cooking mode.
5. To set a different cooking time, press Cooking time. → The cooking time flashes on the screen.
6. Press or to set the cooking time.
7. Press Start/Reheat to start the cooking process.
8. When the cooking time has elapsed, the electric pressure cooker automatically switches to keep warm or standby mode.
9. Turn the pressure regulator to vent.
10. Hold the top lid handle and turn the lid anti-clockwise until it cannot move any more, then lift it up.

Baking recipe

Apple cake with hazelnuts

Ingredients:

- 190 g margarine
- 190 g flour
- 200g sugar
- ¾ tsp. baking powder
- Cinnamon
- 100g almond meal

- 2 medium eggs ml of mayple syrup medium apples, peeled, cored and cut into eights.
1. Mix the margarine with sugar, add the eggs and mix thoroughly. Add the flour, baking powder and almond meal, mix until the mixture is creamy. Fold with maple syrups.
 2. Grease the base and slides of the inner pot, add the mixture and smooth the top of mixture to create level finish. Place the apples on top, pushing them slightly into the mixture. Sprinkle with cinnamon.
 3. Press Bake, set cooking time for 50 minutes and press Start/Reheat. Close the lid.

Preset time for delayed cooking (fig.4)

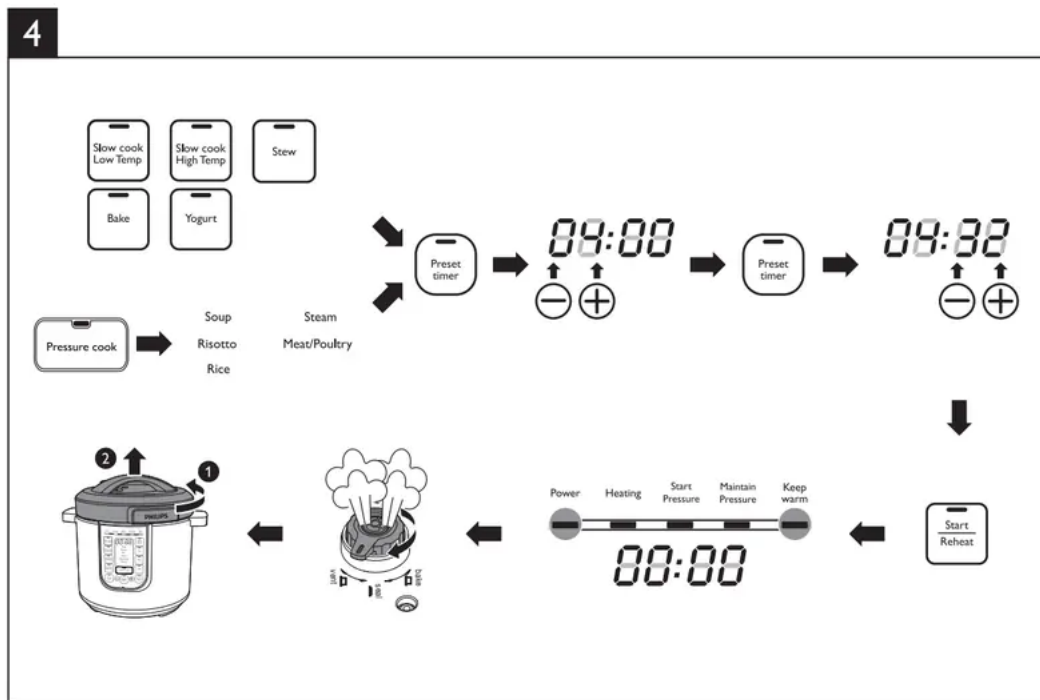

You can preset the delayed cooking time for different cooking functions. The preset timer is available up to 24 hours.

1. After the cooking function is selected, press Preset timer. → The hour unit starts flashing on the display.
2. Press + or - to set the hour unit.
3. After the hour unit is set, press Preset timer again. → The minute unit starts flashing on the display.
4. Press + or - to set the minute button.
5. Press Preset timer to confirm the preset time.
6. Press Start/Reheat to start the cooking process.
7. When the preset time has elapsed, the electric pressure cooker starts working automatically.

Assembling and disassembling the pressure regulator

- To disassemble the pressure regulator:
 1. Turn the pressure regulator clockwise until it can not move any more and reaches position A.
 2. Pull the pressure regulator up.
- To assemble the pressure regulator:
 1. Replace the pressure regulator on the pressure regulator chamber.
 2. Place the bigger pad into the bigger notch of the pressure regulator chamber, and make sure they are well fitted.
 3. Turn the pressure regulator anti-clockwise to bake until it cannot move anymore. You will hear a “click” sound when the pressure regulator is properly assembled.

Cleaning and Maintenance

Interior

Inside of the top lid and the main body:

- Wipe with wrung out and damp cloth.
 - Make sure to remove all the food residues stuck to the electric pressure cooker.

Heating element:

- Wipe with wrung out and damp cloth.
- Remove food residues with wrung out and damp cloth.

Sealing ring:

- Soak in warm water and clean with sponge.

Inner lid:

- Remove the detachable inner lid. Soak it in warm water and clean with sponge.

Exterior

Surface of the top lid and outside of the main body:

- Wipe with a cloth damped with soap water.
 - Only use soft and dry cloth to wipe the control panel.
 - Make sure to remove all the food residues around the pressure regulator valve and floating valve.

Pressure regulator valve and floating valve:

- Disassemble the pressure regulator, soak it in warm water, and clean with sponge.
- Remove food residues in the pressure regulator valve and floating valve.

Accessories

Measuring cup, rice spoon, soup ladle, and inner pot:

- Soak in hot water and clean with sponge.

Specifications

Model Number	HD2137
Rated power output	1000W
Rated capacity	6.0L
Warm keeping temperature	60-80°C

Troubleshooting

If your electric pressure cooker does not function properly or if the cooking quality is insufficient, consult the table below. If you are unable to solve the problem, contact a Philips service center or the Consumer Care Center in your country.

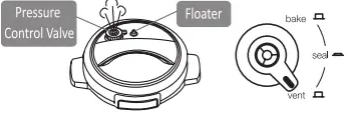
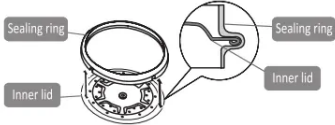

Problem	Cause	Solution
I have difficulties opening the lid after cooking	Need to release the pressure	 <p>Set the pressure control valve to Vent. And wait until the floater has dropped.</p>
	Floater stuck in up position	Set the pressure control valve to 'Vent'. And wait until the floater has dropped
I have difficulties closing the top lid	The sealing ring is not well assembled	Make sure the sealing ring is well assembled around the inside of the top lid.
	Floater stuck in up position	The floater blocks the locking pin. Push down the floater so that it does not block the locking pin
Leaking from under lid	Sealing ring missing	 <p>Put sealing ring in place correctly on inner lid</p>
	Food or debris under sealing ring	Remove sealing ring, clean and replace.
	Lid not correctly closed	Open and reclose lid, checking for correct closing.
Leaking from floater	Sealing ring broken	Replace sealing ring.
	Food or debris under sealing ring	Remove sealing ring, clean and replace.
Floater does not rise up after the appliance starts pressurizing.	Food & Water are below minimum level	Add food/water. Make sure there is enough food and water in the inner lid.
		Take the appliance to Philips service center.

	Leaking from lid or pressure control valve	
E3 is displayed on the screen.	The temperature inside the inner pot is too high.	Wait until it falls down to room temperature
E1, E2, or E4 is displayed on the screen	The electric pressure cooker has malfunction.	Take the appliance to Philips service center

Warning

This content is compiled from multiple sources and is provided for reference purposes only. It may not be complete or fully applicable to all situations. If you are unable to resolve your issue, please contact the product manufacturer or an authorized service provider for official support.