

## Product Description

### Charging Case

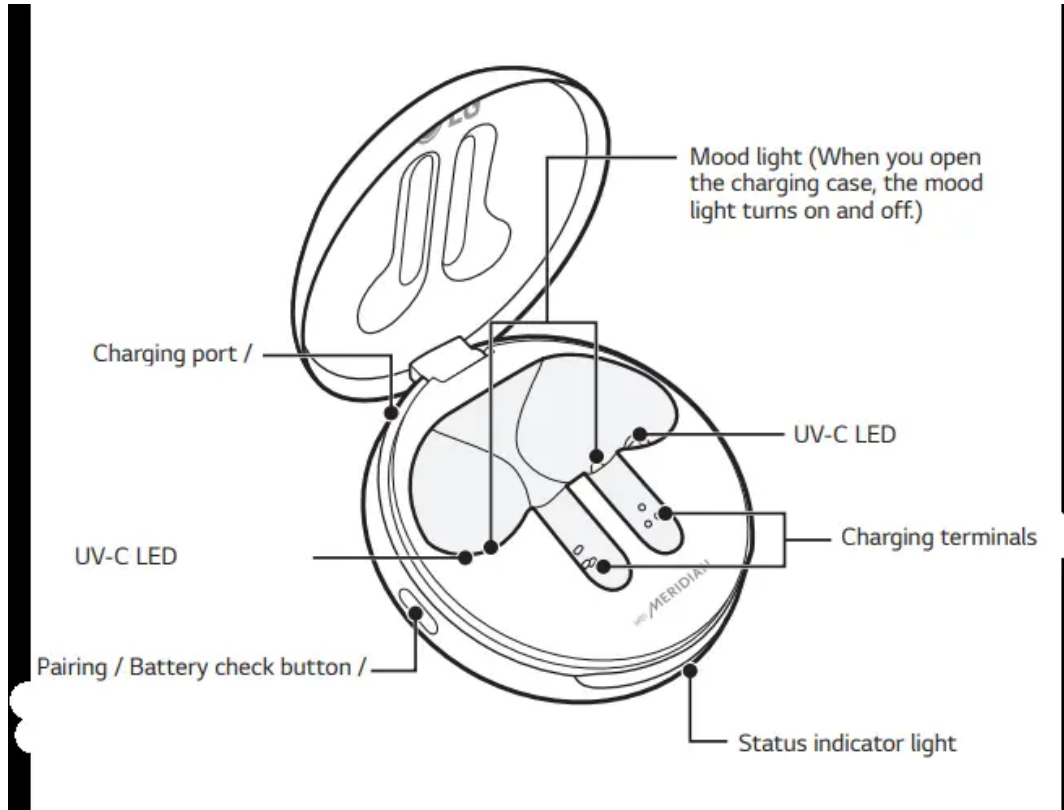

### Earbuds

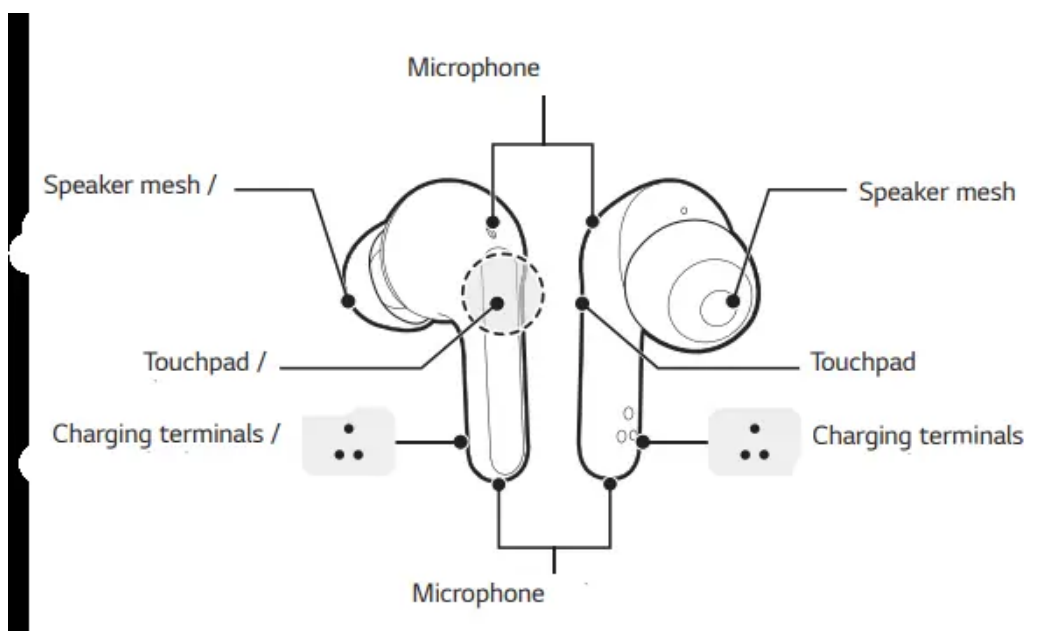

## How to pair



Activate Bluetooth on your phone or device

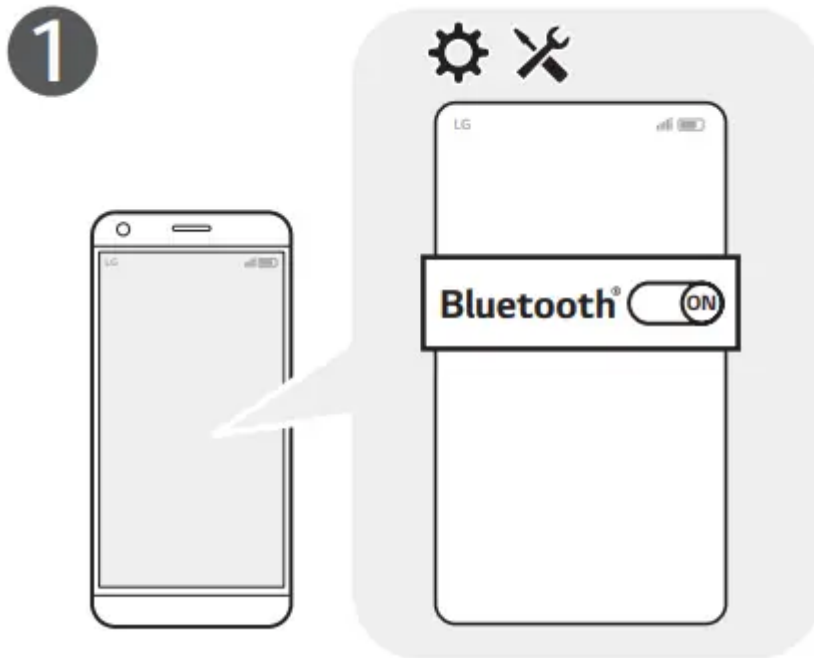

While the earbud is mounted in the charging case, open the charging case lid and press the pairing button for 3 to 5 seconds until the blue indicator light blinks.

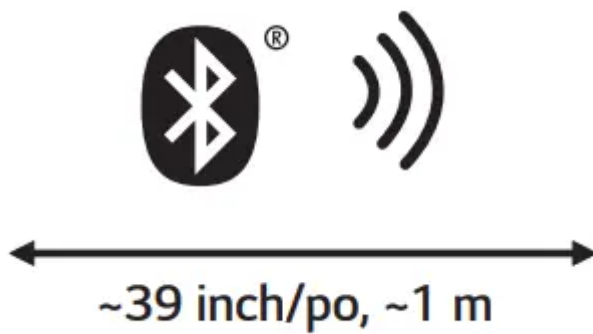

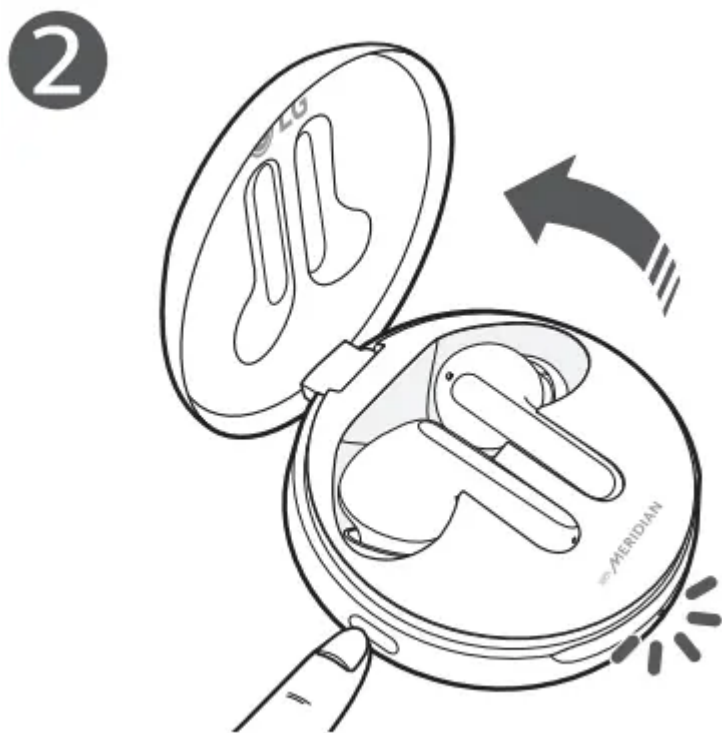

When the Fast Pair connection pop-up appears on the top area of the mobile phone screen, tap it to connect. (It only supports Android™ 5.0 or higher, and requires configuring Bluetooth and location information settings of the mobile device.)

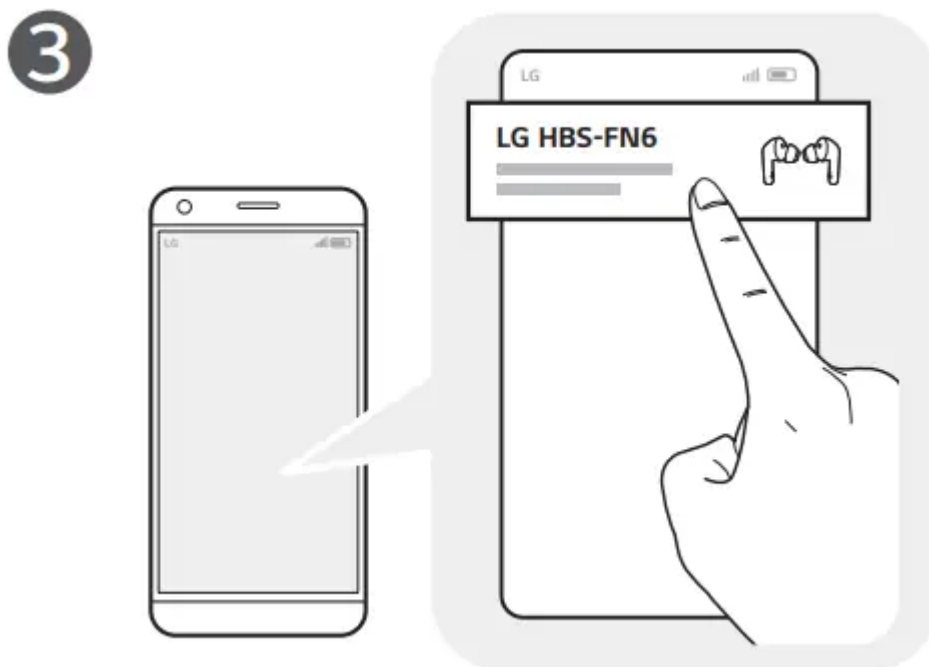

If the pop-up does not appear, select [LG HBS-FN6] from the Bluetooth menu on the mobile phone and connect it (for users of iOS or Android 5.0 or lower versions).

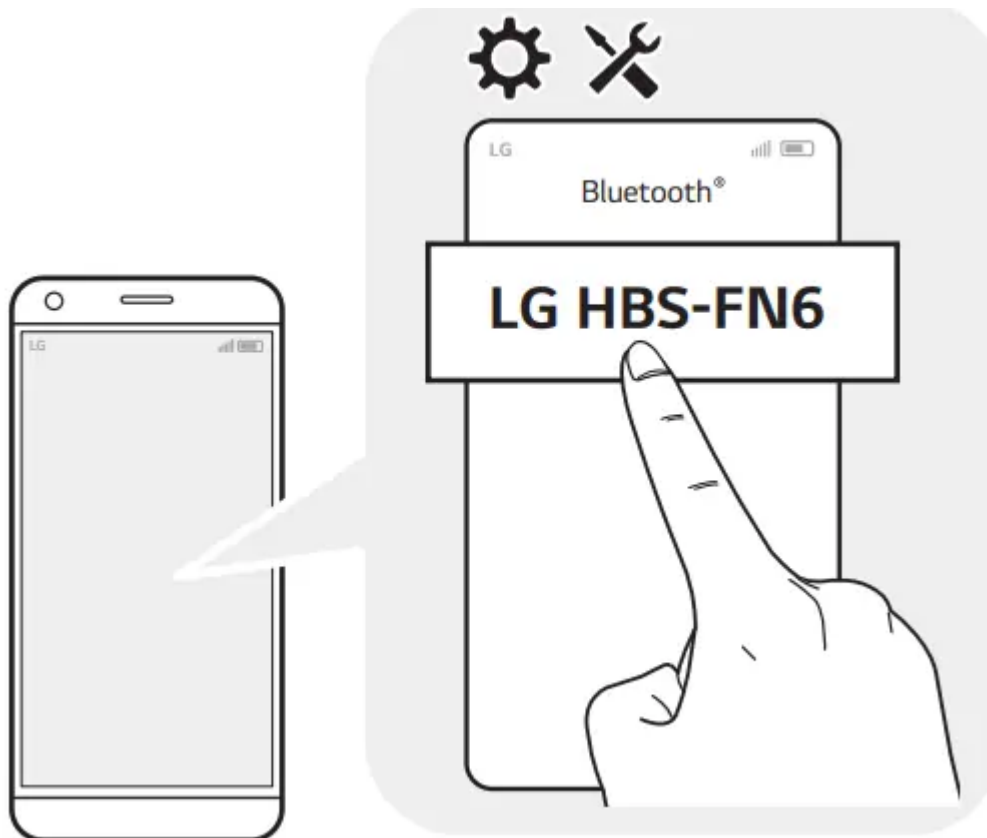

## How to wear earbuds

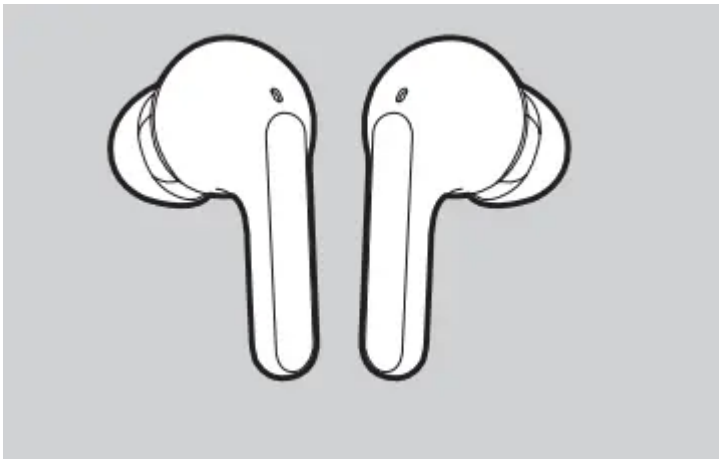

Separate the earbuds from the charging case and adjust them so that they fit comfortably in your ears. When you wear the earbuds, you will hear a wearing detection alarm.

1

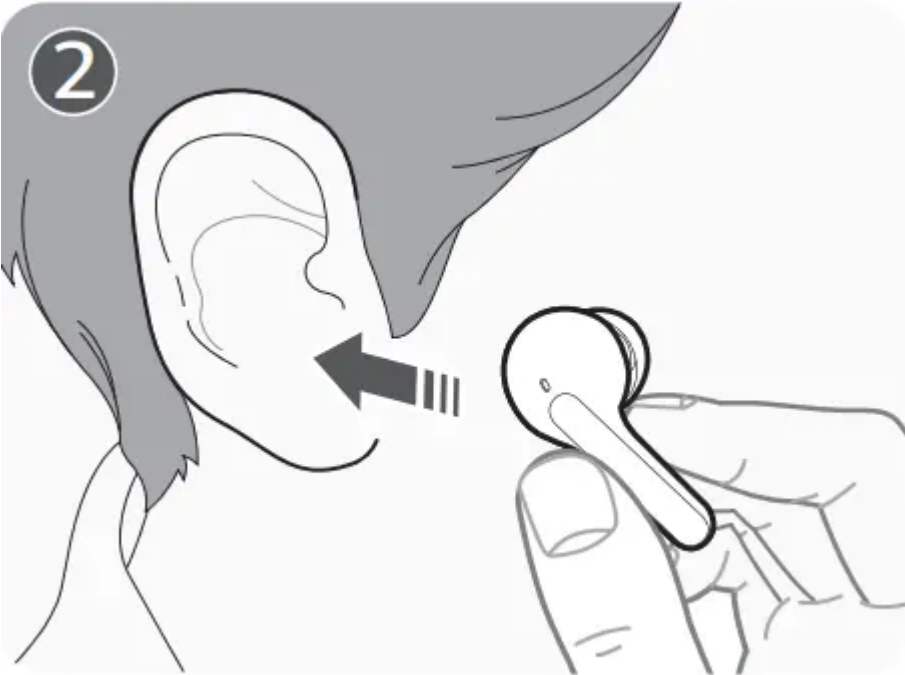
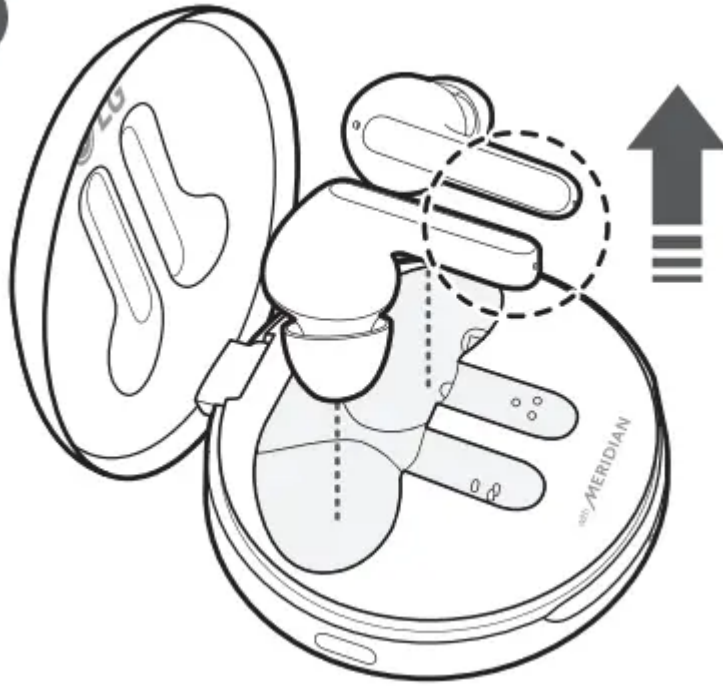

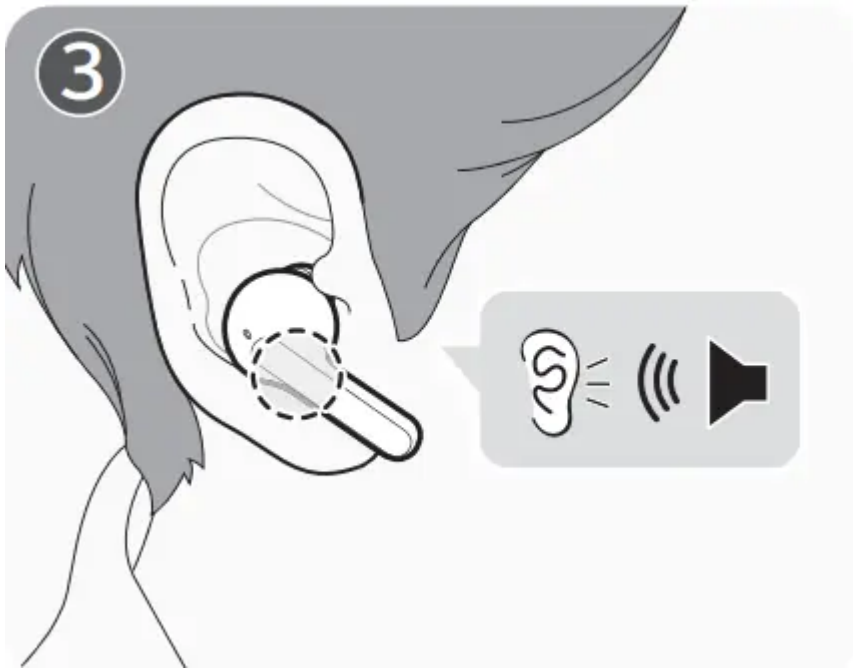

### How to receive a call



To receive a phone call, touch the left or right earbud once.

To end a phone call, touch the left or right earbud twice.

To reject a phone call, touch and hold the left or right earbud.

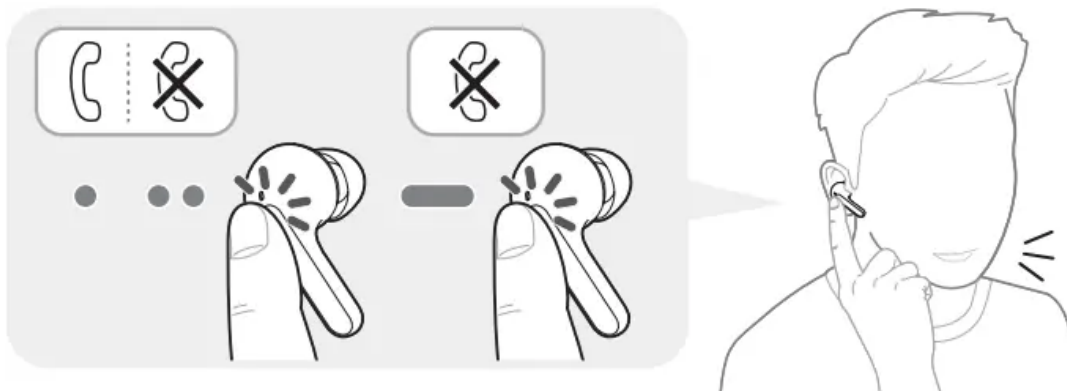

## UVnano Description

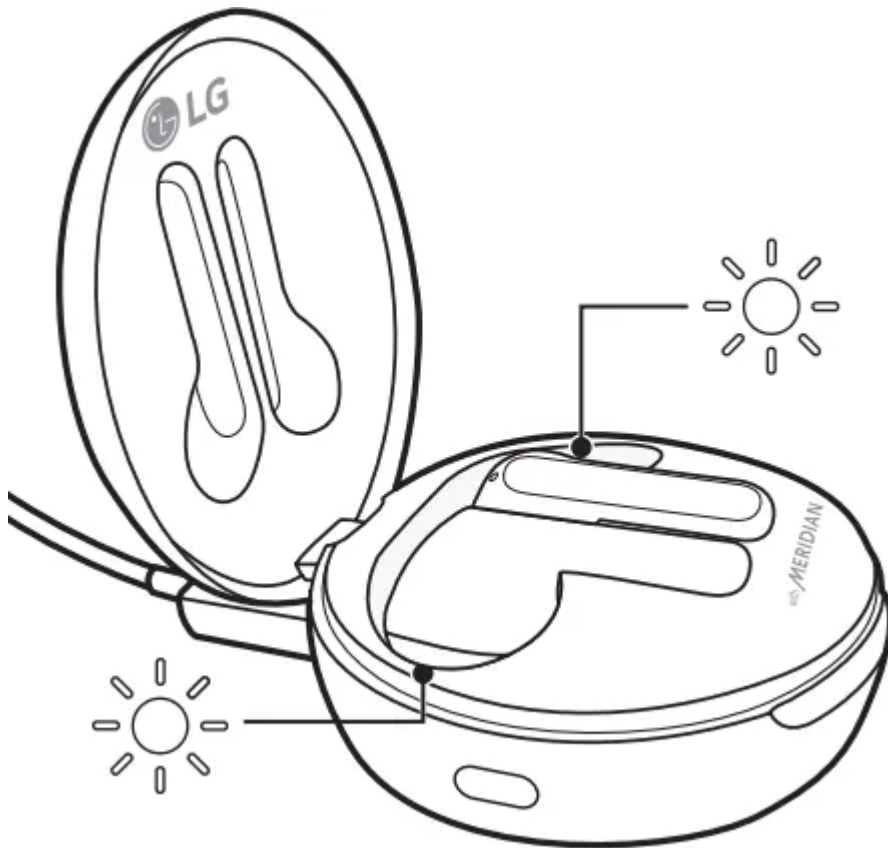
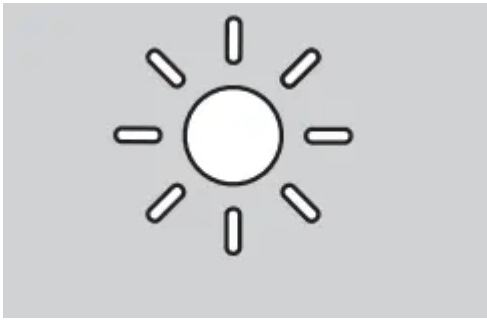

UV-C LED process operates for ten minutes and begins when charging case (with earbuds) is plugged in.

UV-C LED does not operate while device is charging wirelessly such as on a pad or third party wireless charging device (this only applies to HBS-FN6).

- Independent testing shows the UVnano charging case kills 99.9% of bacteria (Staphylococcus aureus and Escherichia coli) on the speaker mesh of the earbuds in ten minutes while charging. The UV-C LED function works only when the charging case is connected to the power cable.

- For best result, it is recommended that the full 10 minutes of UV-C LED operation be performed while charging.

## Listening to the ambient sound



Touch and hold the left or right earbud to hear the ambient sound. You can adjust the intensity of the ambient sound in the LG TONE Free app. The Listen to the Ambient Sound function works only when the product is on hold or playing music. While using the listen to the ambient sound function, the battery discharges faster than usual.

## Battery Status

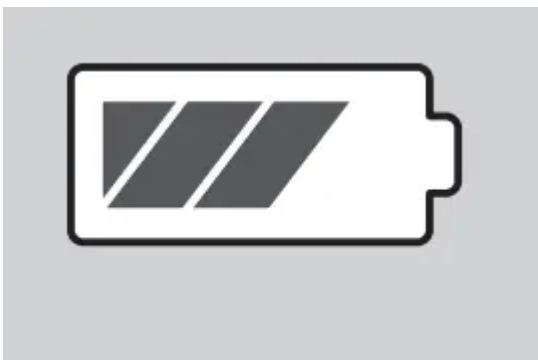



If earbuds are mounted in the charging case, the earbuds' battery status is displayed. Otherwise, the charging case's battery status is displayed. If the earbuds are mounted in the charging case while plugged in, the UVnano process will commence for ten minutes. Once this process is complete, the charging case's battery status will be displayed.

Indicator Light	Battery Status
Red	Below 20% battery
Violet	Between 20% and 80% battery
Blue	Above 80% battery

## How to charge

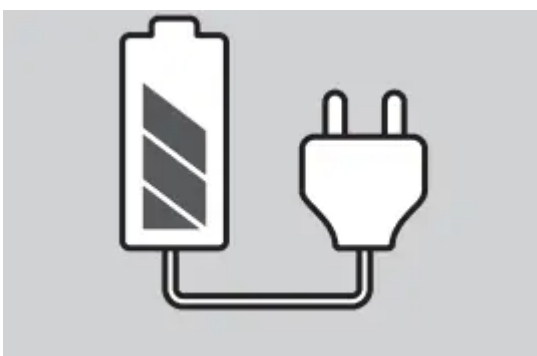

## Wired Charging

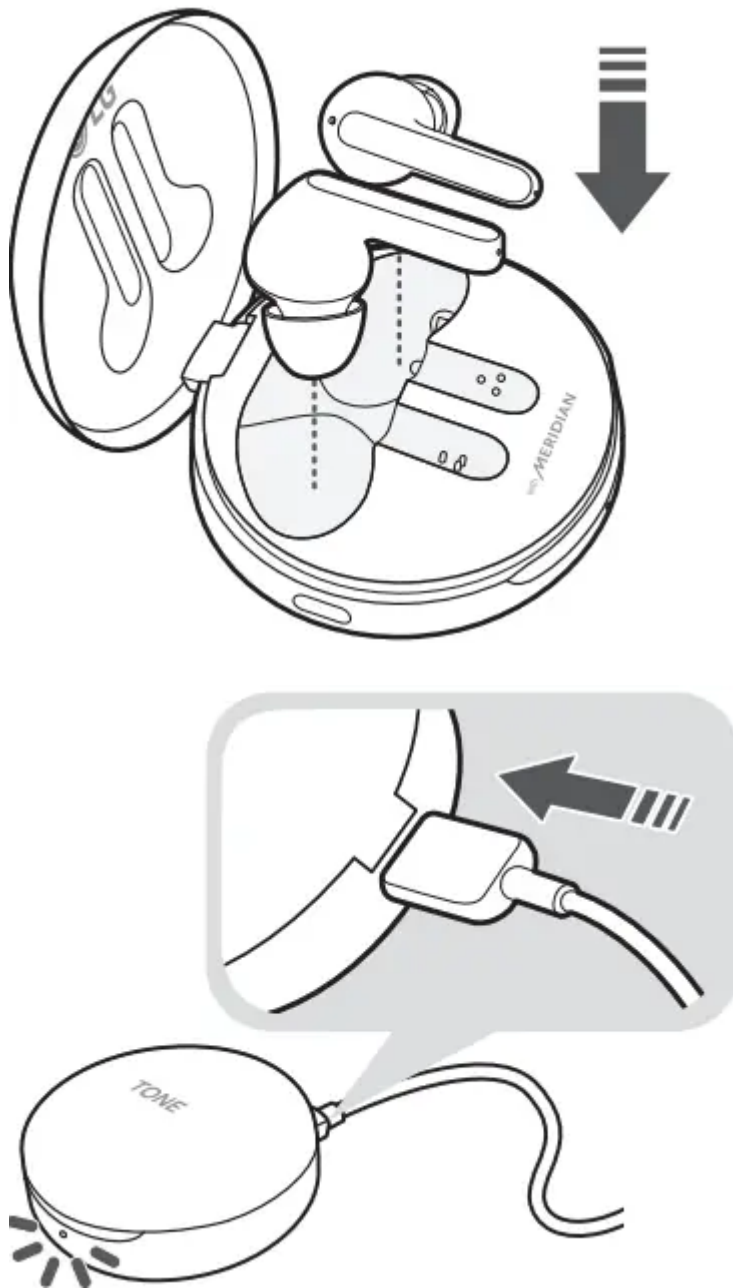

When the charging cable is connected, the charging status is displayed in the charging case

NOTE : The earbuds and the charging case are charged at the same time

## Wireless Charging

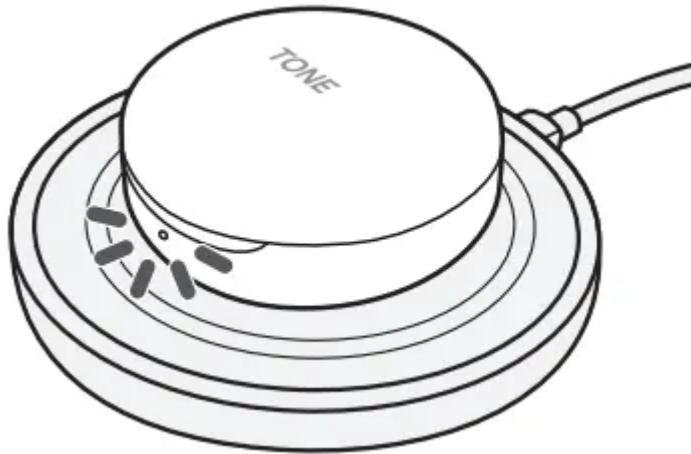

Align the bottom center of the charging case with the center of the wireless charger.

NOTE : The wireless charger is not provided. HBS-FN4 does not support wireless charging. The wireless charging function may not work in some wireless chargers. Wireless charging feature charges at a slower rate due to less power being transmitted to the charging case.

## How to play music

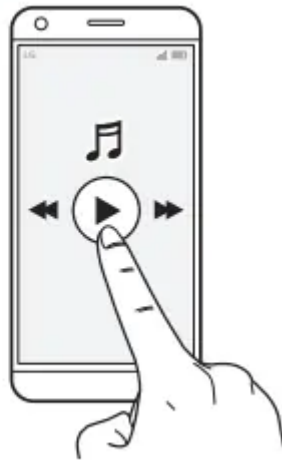

**Play / Pause :**  Touch the left or right earbud once

**Adjusting the Volume :**  Touch the left(Decrease volume) or right(Increase volume) earbud twice.

**Play Next :**  Touch the left or right earbud three times

NOTE : On the LG TONE Free app, you can switch the operation mode through the touchpad settings

## LG TONE Free

If you install the “LG TONE Free” app, you can use Check Earbud Battery, Voice Alert, Change Equalizer Mode, Check Last Connected Location Information, and Find My Earbuds functions. Check out the app for more details. To install the “LG TONE Free” app, search LG TONE Free in the Google Play Store or App Store or scan the QR code below. It supports Android 5.0 or higher and iOS 11 or higher



Google Play



App Store

## Safety Cautions

**CAUTION :** Do not disassemble, adjust, or repair the product arbitrarily. Do not place the product near excessive heat or flammable material. The product may be damaged if an incompatible charger is used. Make sure that an infant or child does not swallow a magnet or a small component of the product. Make sure that foreign objects do not enter the charger's connectors (charging port and power plug). Failure to do so may result in fire or electric shock.

If you have a medical device implanted, contact your doctor before using this device. This product has a built-in battery, and the battery cannot be removed or replaced arbitrarily. For your safety, do not remove the battery incorporated in the product. If you arbitrarily replace the battery or don't replace it correctly, it may explode. The lithium-ion battery is a hazardous component that can cause injury. Battery replacement by an unqualified professional can cause damage to your device. Do not discard the battery arbitrarily. Follow the local procedure for discarding batteries. Disposal of a battery into fire or a hot oven, or mechanically crushing or cutting of a battery, that can result in an explosion. A battery

subjected to extremely low air pressure that may result in an explosion or the leakage of flammable liquid or gas.

**WARNING :** Do not drop the product from a high place. Make sure there is no water, alcohol, or benzene in contact with the product. Do not store the product in a wet or dusty place. Do not place heavy objects on the product. This product is waterproof to the IPx4 level (daily life waterproof). (The IPx4 waterproof rating applies to the earbud product only.) Do not put the product under the water or use it in a humid location such as a bathroom

**NOTE :** If the product is exposed to excessive sweat, clean the product. Keep the earbuds clean.

## Declaration of Confirmation

### Industry Canada Statement

[For having wireless function (WLAN, Bluetooth,...)]

This device contains licence-exempt transmitter(s)/receiver(s) that comply with Innovation, Science and Economic Development Canada's licence-exempt RSS(s). Operation is subject to the following two conditions:

- (1) This device may not cause interference.
- (2) This device must accept any interference, including interference that may cause undesired operation of the device.

CAN ICES-3 (B)/NMB-3(B)

### IC Radiation Exposure Statement

[For having wireless function (WLAN, Bluetooth,...)]

This equipment complies with IC radiation exposure limits set forth for an uncontrolled environment.

**NOTE: THE MANUFACTURER IS NOT RESPONSIBLE FOR ANY RADIO OR TV INTERFERENCE CAUSED BY UNAUTHORIZED MODIFICATIONS TO THIS EQUIPMENT. SUCH MODIFICATIONS COULD VOID THE USER'S AUTHORITY TO OPERATE THE EQUIPMENT**

## Additional Information

### 1. Radio frequency exposure

This Bluetooth LG Stereo Headset is a radio transmitter and receiver. When in operation it communicates with a Bluetooth-equipped mobile device by receiving and transmitting radio frequency (RF) electromagnetic fields (microwaves) in the frequency range 2402 to 2480 MHz. Your Bluetooth headset is designed to operate in

compliance with the RF exposure guidelines and limits set by national authorities and international health agencies when used with any compatible LG Electronics mobile device.

## **2. Bluetooth Connection Precautions**

The following environments affect the range and reception of Bluetooth signals:

- When walls, metal, human bodies, or other obstacles exist between the Bluetooth device and the connected device
- When equipment that uses 2.4 GHz frequency signals (Wireless LANs, wireless phones, microwave ovens, etc.) is placed near the devices being used
- When using a Bluetooth device (TV, laptop, etc.) other than the mobile phone, the sound quality may be affected by the specifications and performance of the device.

## **3. Potentially explosive atmosphere**

Power off your electronic device when in any area with a potentially explosive atmosphere. Although this is uncommon, your electronic device could generate sparks. Sparks in such areas could cause an explosion or fire resulting in bodily injury or even death. Areas with a potentially explosive atmosphere are often, but not always, clearly marked.

## **4. Emergency calls**

IMPORTANT! This Bluetooth headset and the electronic device connected to the headset operate using radio signals, mobile and landline networks as well as user-programmed functions, which cannot guarantee connection under all conditions. Therefore you should never rely solely upon any electronic device for essential communications (e.g. medical emergencies). Remember, in order to make or receive calls, the headset and the electronic device connected to the headset must be powered on and in a service area with adequate mobile signal strength. Emergency calls may not be possible on all mobile phone networks or when certain network services and/or phone features are in use. Check with your local service provider.

## **5. Battery information**

A rechargeable battery has a long service life if treated properly. A new battery or one that has not been used for a long period of time could have reduced capacity the first few times it is used. Do not expose the battery to extreme temperatures, never above +50°C (+122°F) or below -10°C (+14°F). For maximum battery capacity, use the battery at room temperature. If the battery is used in low temperatures, the battery capacity will be reduced. The battery can only be charged in temperatures between 0°C (+32°F) and +45°C (+113°F).

## 6. Recycling the battery in your Bluetooth headset

The battery in your Bluetooth headset must be disposed of properly and should never be placed in municipal waste. The LG Electronics service partner who removes the battery will dispose of it according to local regulations. In case rechargeable battery is included in this product, the rechargeable battery should be recycled in compliance with rechargeable battery recycling standards. To dispose of properly, call 1.888.224.9764 or visit [www.call2recycle.ca](http://www.call2recycle.ca).

## 7. Conditions

- The warranty is valid only if the original receipt issued to the original purchaser by the dealer, specifying the date of purchase and serial number, is presented with the product to be repaired or replaced. LG Electronics reserves the right to refuse warranty service if this information has been removed or changed after the original purchase of the product from the dealer.
- If LG Electronics repairs or replaces the product, the repaired or replaced product shall be warranted for the remaining time of the original warranty period or for ninety (90) days from the date of repair, whichever is longer. Repair or replacement may involve the use of functionally equivalent reconditioned units. Replaced parts or components will become the property of LG Electronics.
- This warranty does not cover any failure of the product due to normal wear and tear, or due to misuse, including but not limited to use in other than the normal and customary manner, in accordance with instructions for use and maintenance of the product. Nor does this warranty cover any failure of the product due to accident, modification or adjustment, acts of God or damage resulting from liquid.
- This warranty does not cover product failures due to improper repair installations, modifications or service performed by a non-LG Electronics authorized person. Tampering with any of the seals on the product will void the warranty.
- THERE ARE NO EXPRESS WARRANTIES, WHETHER WRITTEN OR ORAL, OTHER THAN THIS PRINTING INCLUDING WITHOUT LIMITATION THE IMPLIED WARRANTIES OF MERCHANTABILITY OR FITNESS FOR A PARTICULAR PURPOSE, ARE LIMITED TO THE DURATION OF THIS LIMITED WARRANTY. IN NO EVENT SHALL LG ELECTRONICS OR ITS VENDORS BE LIABLE FOR INCIDENTAL OR CONSEQUENTIAL DAMAGES OF ANY NATURE WHATSOEVER, INCLUDING BUT NOT LIMITED TO LOST PROFITS OR COMMERCIAL LOSS, TO THE FULL EXTENT THOSE DAMAGES CAN BE DISCLAIMED BY LAW.
- Some countries/states do not allow the exclusion or limitation of incidental or consequential damages, or limitation of the duration of implied warranties, so the preceding limitations or exclusions may not apply to you. The warranty provided does not affect the consumer's statutory rights under applicable national legislation in force,

nor the consumer's rights against the dealer arising from their sales/purchase contract.

## Specifications and Features

Item	Comments
Bluetooth Specifications	V 5.0 (Headset/Hands-Free/A2DP/AVRCP)
Battery	Earbud : 3.7 V / 55 mAh, Lithium-ion Charging case : 3.7 V / 390 mAh, Lithium-ion
Talk Time (Earbuds / With Charging case)	Up to 5 / 15 hours*
Music Play Time (Earbuds / With Charging case)	Up to 6 / 18 hours*
Charging Time	Earbud : within an hour / Charging case : within 2 hours Fast Charging : 5 min charge for up to 60 min playtime ※ When charging wired at room temperature
Rated Input Voltage	Earbud : DC 5 V, 110 mA Charging case : DC 5 V, 500 mA
Operating Temperature	0 °C (+32 °F) ~ +35 °C (+95 °F)
Dimensions (mm)	Earbud : 16.1 mm (W) X 32.65 mm (L) X 25.0 mm (H) Charging case : 54.5 mm (W) X 54.5 mm (L) X 27.5 mm (H)
Weight (g)	Earbud : 5.4 g (One earbud) Charging case : 39 g
Frequency range	2402 MHz to 2480 MHz
Output power (Max.)	10 dBm

### Warning

This content is compiled from multiple sources and is provided for reference purposes only. It may not be complete or fully applicable to all situations. If you are unable to resolve your issue, please contact the product manufacturer or an authorized service provider for official support.