

RECOMMENDATIONS AND SUGGESTIONS

- The Instructions for Use apply to several versions of this appliance. Accordingly, you may find descriptions of individual features that do not apply to your specific appliance.
- The manufacturer will not be held liable for any damages resulting from incorrect or improper installation.
- The minimum safety distance between the cooker top and the extractor hood is 650 mm (some models can be installed at a lower height, please refer to the paragraphs on working dimensions and installation).
- Check that the mains voltage corresponds to that indicated on the rating plate fixed to the inside of the hood.
- For Class I appliances, check that the domestic power supply guarantees adequate earthing. Connect the extractor to the exhaust flue through a pipe of minimum diameter 120 mm. The route of the flue must be as short as possible.
- Do not connect the extractor hood to exhaust ducts carrying combustion fumes (boilers, fireplaces, etc.).
- If the extractor is used in conjunction with non-electrical appliances (e.g. gas burning appliances), a sufficient degree of aeration must be guaranteed in the room in order to prevent the backflow of exhaust gas. The kitchen must have an opening communicating directly with the open air in order to guarantee the entry of clean air. When the cooker hood is used in conjunction with appliances supplied with energy other than electric, the negative pressure in the room must not exceed 0,04 mbar to prevent fumes being drawn back into the room by the cooker hood.
- In the event of damage to the power cable, it must be replaced by the manufacturer or by the technical service department, in order to prevent any risks.
- If the instructions for installation for the gas hob specify a greater distance specified above, this has to be taken into account. Regulations concerning the discharge of air have to be fulfilled.
- Use only screws and small parts in support of the hood.
- Connect the hood to the mains through a two-pole switch having a contact gap of at least 3 mm.
- Do not flambè under the range hood; risk of fire.
- This appliance can be used by children aged from 8 years and above and persons with reduced physical, sensory or mental capabilities or lack of experience and knowledge if they

have been given supervision or instruction concerning use of the appliance in a safe way and understand the hazards involved. Children shall not play with the appliance. Cleaning and user maintenance shall not be made by children without supervision.

- “CAUTION: Accessible parts may become hot when used with cooking appliances.”
- The symbol on the product or on its packaging indicates that this product may not be treated as household waste. Instead it shall be handed over to the applicable collection point for the recycling of electrical and electronic equipment. By ensuring this product is disposed of correctly, you will help prevent potential negative consequences for the environment and human health, which could otherwise be caused by inappropriate waste handling of this product. For more detailed information about recycling of this product, please contact your local city office, your household waste disposal service or the shop where you purchased the product.
- Switch off or unplug the appliance from the mains supply before carrying out any maintenance work.
- Clean and/or replace the Filters after the specified time period (Fire hazard).

USE.

- The extractor hood has been designed exclusively for domestic use to eliminate kitchen smells.
- Never use the hood for purposes other than for which it has been designed.
- Never leave high naked flames under the hood when it is in operation.
- Adjust the flame intensity to direct it onto the bottom of the pan only, making sure that it does not engulf the sides.
- Deep fat fryers must be continuously monitored during use: overheated oil can burst into flames.

MAINTENANCE

The sponge-like part of the filter can be washed in the dishwasher at least once every 4 months, or more frequently if use is particularly intense. Operation is guaranteed for up to a maximum of 5 washes, after which it must be replaced (W) .

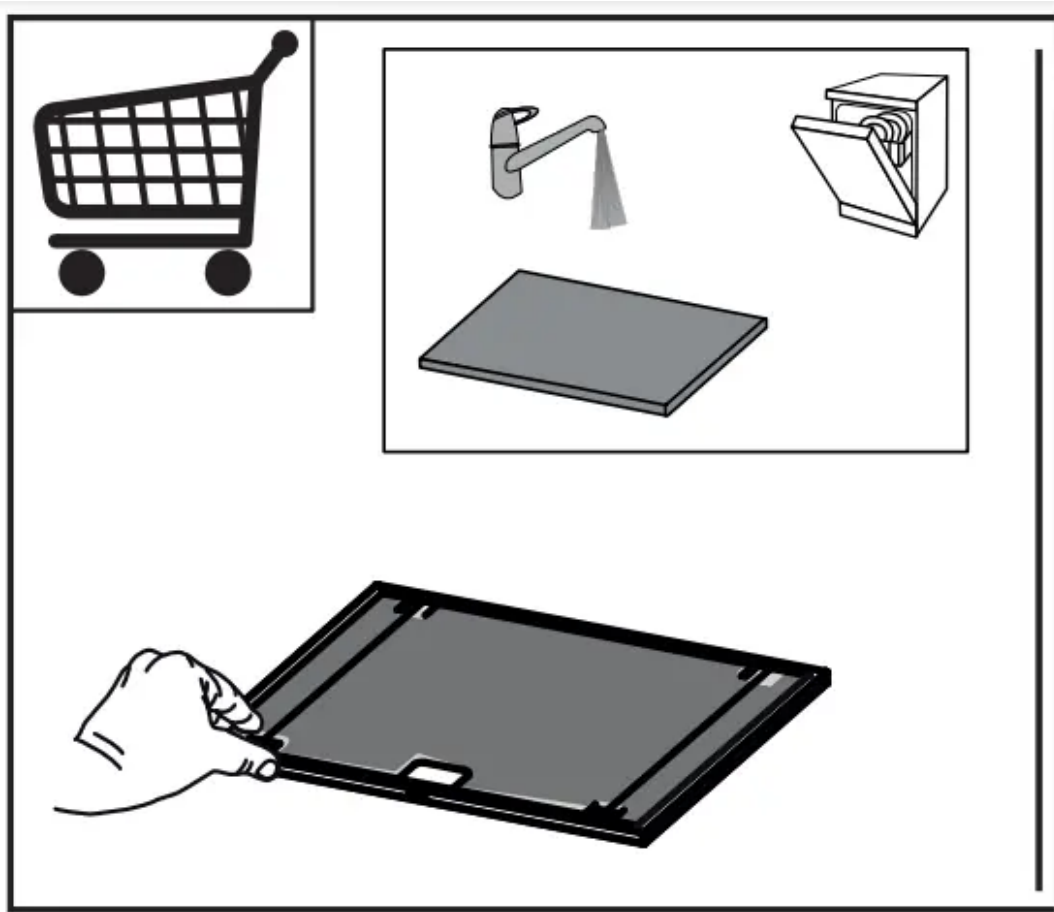

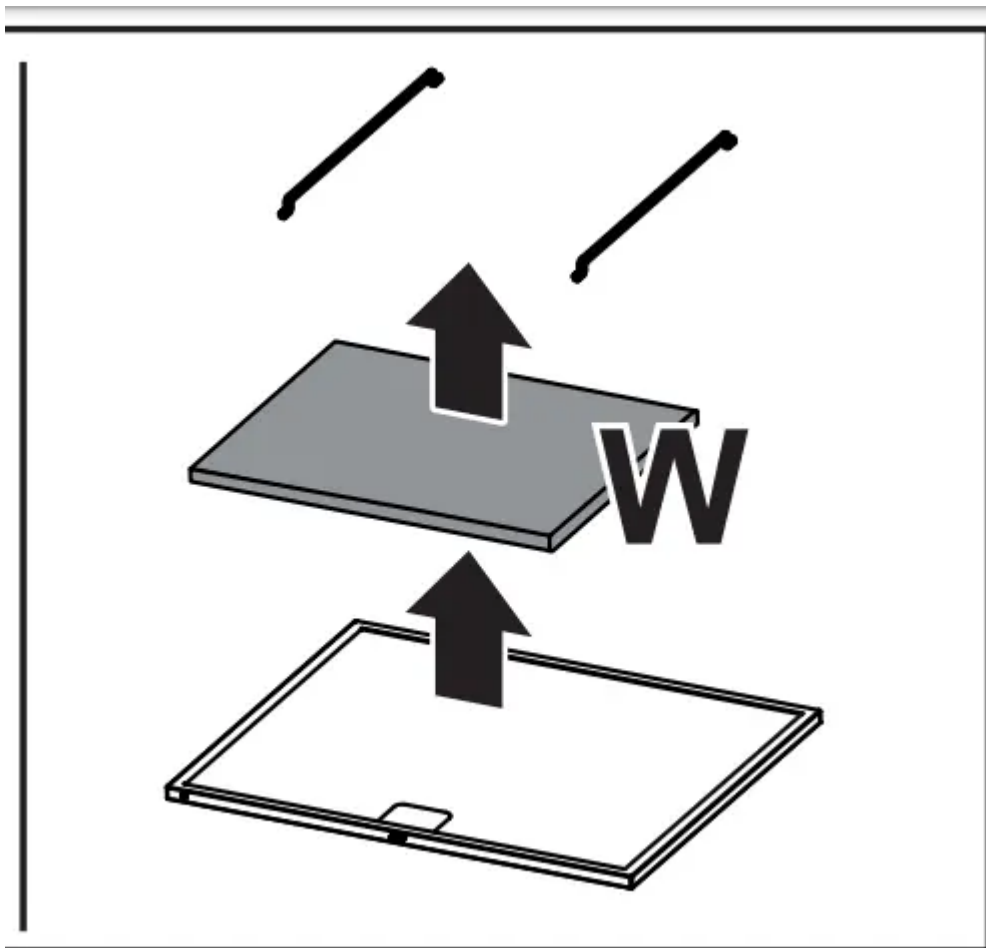

The Grease filters must be cleaned every 2 months of operation, or more frequently for particularly heavy usage, and can be washed in a dishwasher (Z) .

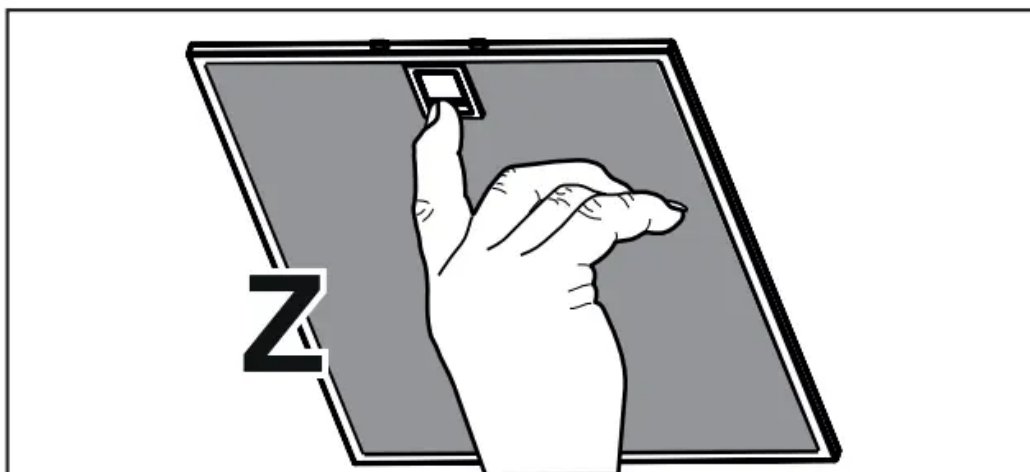

- Control lights, if present.

- Clean the hood using a damp cloth and a neutral liquid detergent.

CONTROLS



A



B



C



D



E



F



G



H



I

Button	Function	Led
A	<p>PANEL CLOSED</p> <p>Brief pressure: Activates the keyboard functions. The panel opens after 1 second, the lights turn on at maximum intensity and the motor starts at speed one (B).</p>	The buttons turn white.
	<p>PANEL OPEN</p> <p>Brief pressure: Deactivates the keyboard functions. - When pressed for 3 sec., the panel closes</p>	If the motor does not start the buttons switch off after 1 minute.
	<p>MOTOR ON</p> <p>Brief pressure: Motor off.</p>	All the buttons are on
B	Activates speed one	The button turns from white to red.
C	Activates speed two	The button turns from white to red.
D	Activates speed three.	The button turns from white to red.
E	<p>Activates INTENSIVE 1 speed for 10 minutes. At the end of this time the system will automatically return to the speed set before. It is disabled by changing speed or pressing button A.</p>	The button turns from white to red.
	<p>Press and hold the button for approximately 3 seconds, with all the loads turned off (Motor and Lights), to turn the Activated Charcoal Filter alarm on/off.</p>	H flashes 5 times

F	Activates INTENSIVE 2 speed for 5 minutes. At the end of this time the system will automatically return to the speed set before. It is disabled by changing speed or pressing button A.	The button turns from white to red.
G	Activates BREEZE speed for 60 minutes. At the end of this time the motor switches off. It is disabled by changing speed or pressing button A.	The button turns from white to red
H	Filter alarm button. This button is normal off. It is only displayed when the filter alarm is triggered. The alarm can be reset by pressing and holding this button for approximately 3 seconds.	Button H fixed (30 seconds): indicates the need to wash the metal grease filters. The alarm is triggered after the Hood has been in operation for 40 working hours. Button H flashing (30 seconds): indicates the need to change the activated charcoal filters, and also to wash the metal grease filters. The alarm is triggered after the Hood has been in operation for 160 working hours.
I	Press briefly: Turns the lighting system on and off at maximum intensity.	
	Press and hold to change the lighting intensity up or down.	

LIGHTING

- For replacement contact technical support ("To purchase contact technical support").

Warning

This content is compiled from multiple sources and is provided for reference purposes only. It may not be complete or fully applicable to all situations. If you are unable to resolve your issue, please contact the product manufacturer or an authorized service provider for official support.

