

## Overview

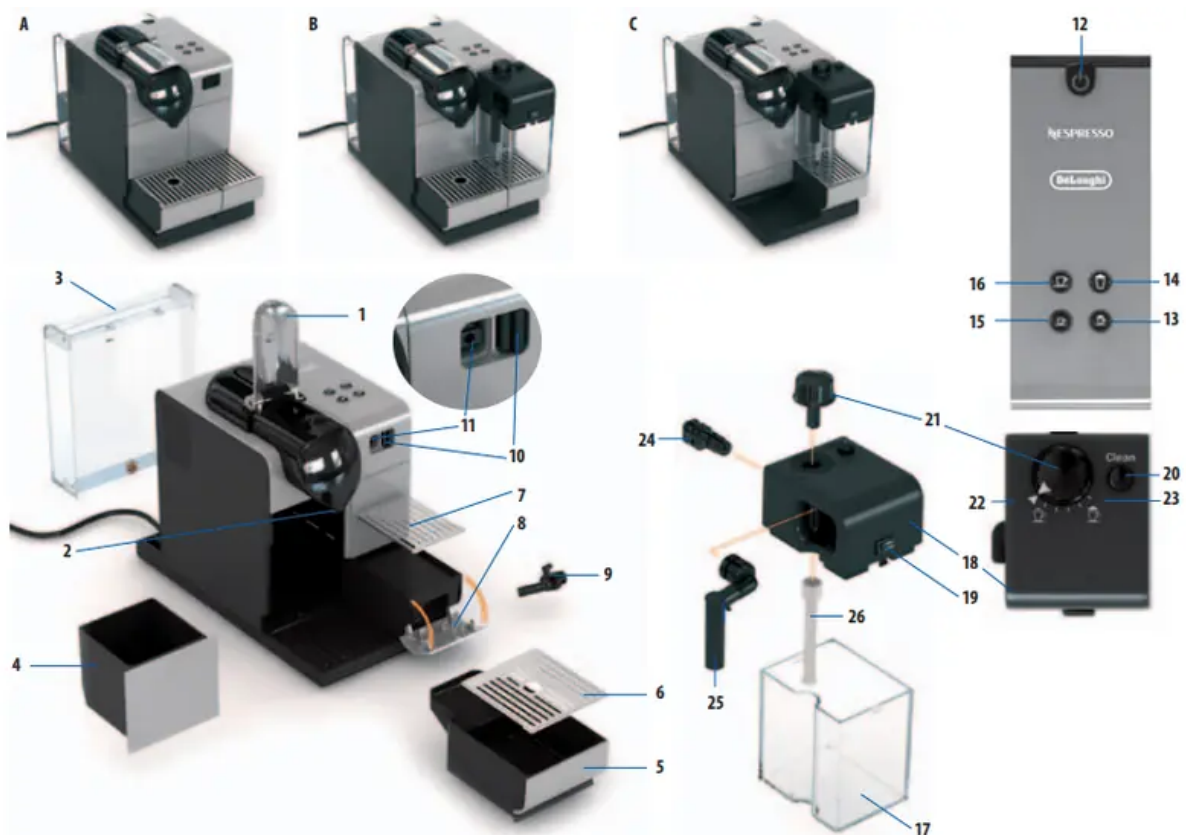

**A. Machine without the Rapid Cappuccino System**

**B. Machine with the Rapid Cappuccino System (for Cappuccino)**

**C. Machine with the Rapid Cappuccino System (for Latte Macchiato)**

**1. Lever**

**2. Coffee outlet**

**3. Water tank (0.9 l)**

**4. Used capsule container.**

**5. Drip tray (push inside for Latte Macchiato glass)**

**6. Left Grid**

**7. Right Grid**

**8. Descaling pipe storage door (pull to open)**

**9. Descaling pipe**

**10. Steam connector door**

**11. Steam connector**

12. **ON/OFF button**
- Backlight Buttons**
13. **Cappuccino**
14. **Latte Macchiato**
15. **Espresso**
16. **Lungo**
17. **Milk container (0.35 l)**
18. **Milk container Lid**
19. **Lids detach button.**
20. **Rinsing button**
21. **Milk Froth regulator knob**
22. **Min. froth**
23. **Max. froth**
24. **Rapid Cappuccino System connector**
25. **Milk spout**
26. **Milk aspiration tube**

#### **Backlight Buttons indication**



Energy saving settings, refer to page 26 When the machine is switched on, buttons light for 2sec: Lungo= power off after 9 min Espresso= power off after 30 min Both Lungo+ Espresso = power off after 8h.



Water hardness settings, refer to page 28 When the machine is switched on, buttons light for 2sec: Latte Macchiato= Soft water hardness Cappuccino= Medium water hardness Latte Macchiato+Cappuccino= Hard water hardness



Coffee mode is ready



Coffee and milk recipe modes are ready



Descaling alert, refer to page 27.

## First use or after a long period of non-use

1. Remove the plastic film from both the left and right grid, and machine panels.

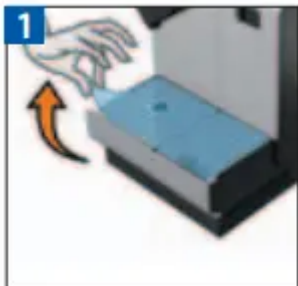

2. Remove the water tank, drip tray, and capsule container. Adjust the cable length and store the excess in the cable guide under the machine.



3. Put the machine in the upright position and plug it into the mains.



4. The water tank can be carried by its cover.



5. Rinse the water tank before filling with potable water up to the maximum level.



6. Switch the machine on. Blinking light: heating up for approximately 40 sec. Steady light: ready

Refer to the button indications on page 18.



7. Rinsing: Place a container under the coffee outlet and press the Lungo button. Repeat three times.

Machines are fully tested after being produced. Some traces of coffee powder could be found in the rinsing water.



8. Rinse the Rapid Cappuccino System (R.C.S.) by following the section “Care of the Rapid Cappuccino System (R.C.S) twice a week”, p. 25.



## Coffee preparation

1. Lift the lever completely and insert a Nespresso capsule. Close the lever and place a cup under the coffee outlet.



2. For a Latte Macchiato glass, push the drip tray inside the machine.



3. Press the Espresso (40 ml / 1.35 oz) or the Lungo (110 ml / 3.7 oz) button. Preparation will stop automatically. To stop the coffee flow or top up your coffee, press again.

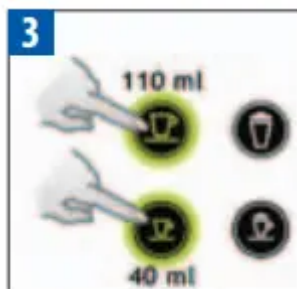



4. Take the cup. Lift and close the lever to eject the capsule into the used capsule container.



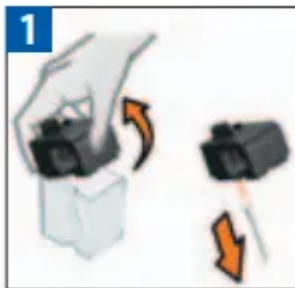

## Assembling / disassembling of the Rapid Cappuccino system (R.C.S)

1. Remove the milk container lid and unplug the milk aspiration tube.



2. Remove the milk froth regulator knob by turning it to (  ) and pulling it up.



3. Unlock and remove the Rapid Cappuccino System connector by turning it from (  ) to (  ) and pulling it off.



4. Remove the milk spout by pulling it off.



## Preparing A Cappuccino and Latte Macchiato

1. Fill the milk container with your desired quantity of milk. When the milk container is empty, before refilling, thoroughly rinse it and the milk aspiration tube with potable water.

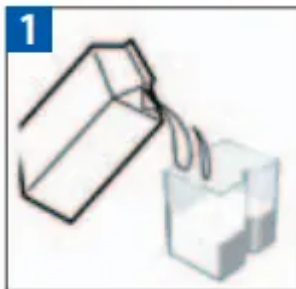

2. Close the milk container. Open the steam connector door by sliding it to the right. Connect the Rapid Cappuccino System to the machine. Milk recipe buttons blink: the Rapid Cappuccino heats up.  
Steady light: ready



3. Lift the lever completely and insert a Nespresso capsule.



4. Close the lever, place a Cappuccino cup or a Latte Macchiato glass under the coffee outlet and adjust the position of the milk spout.



5. Adjust the milk froth regulator knob according to the quantity of froth you want.



6. Press the Cappuccino or Latte Macchiato button. The preparation starts after a few seconds (first milk and then coffee) and will stop automatically.

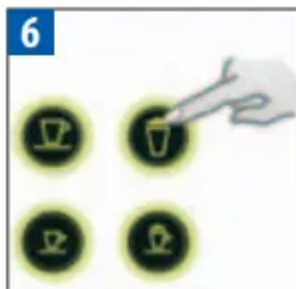

7. At the end of the preparation, lift and close the lever to eject the capsule into the used capsule container.



8. Rinse after each use as described in the section “Rinsing after each milk recipe preparation”.



## Programming the water volume

1. Fill the water tank, switch the machine on and insert a Nespresso capsule. Close the lever and place a cup under the coffee outlet.



2. Press and hold the Espresso or Lungo button. Brewing starts. Button blinks quickly: programming mode.

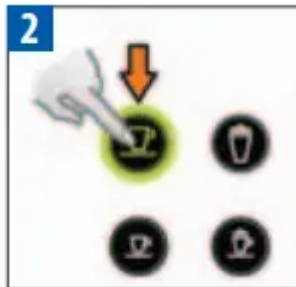

3. Release the button when the desired volume is reached.



4. The water volume is now stored for future coffee preparations. Button blinks 3 times: confirm the new water volume min 20 ml / max 300 ml.



## Programming Cappuccino/Latte Macchiato Volume

Follow the steps 1-5 of section “Preparing a Cappuccino and Latte Macchiato”

Milk: min 20 ml/max 300 ml. Coffee: min 20 ml/max 300 ml

1. Press and hold the Cappuccino or Latte Macchiato button. Milk frothing starts. Button blinks quickly: programming mode.

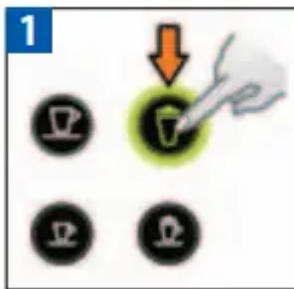

2. Release the button when your desired volume of milk froth is reached. Button blinks quickly: programming mode



3. **Press and hold the same button.** Brewing starts. Release the button when your desired coffee volume is reached. The recipe volume is now stored for future preparations. Button blinks 3 times: confirm the new recipe volume. Eject the capsule

and press the clean button.



## Rinsing after each milk recipe preparation

1. Place a container under the milk spout.



2. Press and hold the "CLEAN" button until machine stops pumping automatically. Milk recipe buttons blink: rinsing process approximately 10 sec. Steady light: rinsing process finished.



3. Disconnect the R.C.S. from the machine and place it in the refrigerator. Close the machine steam connector door. This milk should not be kept for more than 2 days.



4. All the milk container components are dishwasher proof. Twice a week, follow the section “Care of Rapid Cappuccino System twice a week”.



## Daily cleaning



Do not use any strong cleaning agent or solvent cleaner. Use a damp cloth and mild cleaning agent to clean the surface of the machine. Do not put in a dishwasher.

Remove the drip tray, capsule container and water tank. Empty and rinse. Both left and right grid can be removed for easy cleaning. Clean the coffee outlet regularly with a damp cloth.

## Care of Rapid Cappuccino System (R.C.S.) twice a week

Disassemble the Rapid Cappuccino System. Refer to section “Assembling/ Disassembling of Rapid Cappuccino System (R.C.S)”.

1. Clean all components in the upper level of a dishwasher at least twice a week.



## Emptying the system before a period of non-use, for frost protection or before a repair

1. Switch on the machine.



2. Remove the water tank. Close the lever (without a capsule inside). Place a container under the coffee outlet.



3. Press the Cappuccino and Espresso buttons simultaneously for 5 seconds. Preparation buttons blink alternately: emptying mode is in progress.

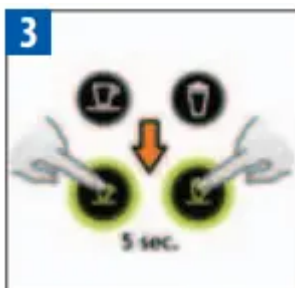

4. When the process is finished, the machine switches off automatically.



# ENERGY SAVING CONCEPT

1. Switch the machine off



A. Press and hold the Lungo button and switch the machine on.

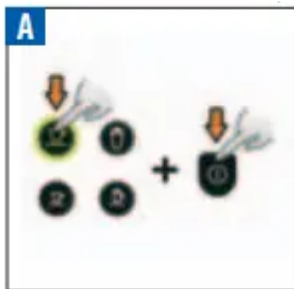

B. Press and hold the Espresso button and switch the machine on.

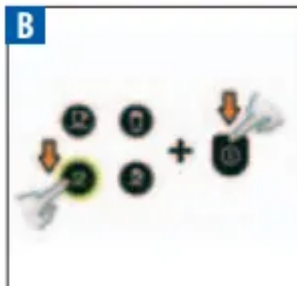

C. Press and hold both the Lungo and Espresso button and switch machine on.

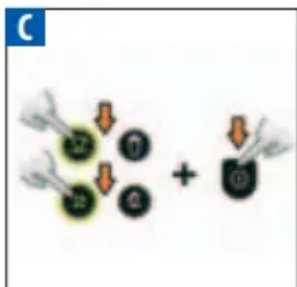

## Descaling

1. Descale the machine when the Cappuccino button shines orange in ready mode (descaling alert).



2. Empty the drip tray and the used capsule container. Fill the water tank with 100 ml of Nespresso descaling agent and 500ml water.



3. Open the descaling pipe storage door. Plug the descaling pipe into the steam connector.



4. The machine enters the descaling mode (70°C setting). Cappuccino button blinks orange.



5. Place a minimum 1 liter container under both the coffee outlet and descaling pipe nozzle.



6. Press the Cappuccino button. The descaling agent flows alternately through the coffee outlet, descaling pipe and drip tray. The Cappuccino and Macchiato button blink alternatively.

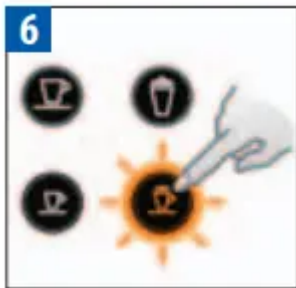

7. When the descaling cycle is finished (water tank runs empty), the Cappuccino button blinks.



8. Empty the used capsule container and drip tray, rinse and fill the water tank with fresh potable water up to the MAX level. Repeat step 5 again.



9. Press the Cappuccino button again. The rinsing cycle continues through the coffee outlet, descaling pipe and drip tray until the water tank is empty. The Cappuccino and

Macchiato button blink alternatively

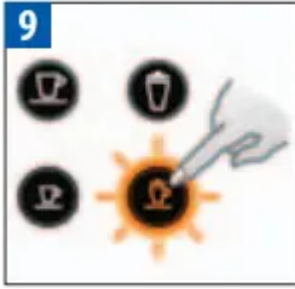

10. Once the rinsing process is finished, the machine switches off.



11. Remove and store the descaling pipe. Empty the drip tray and used capsule container. Fill the water tank with fresh potable water.



12. Clean the machine using a damp cloth. You have now finished descaling the machine.



## Water hardness setting

Switch the machine off.



Press and hold the indicated buttons and switch the machine on.

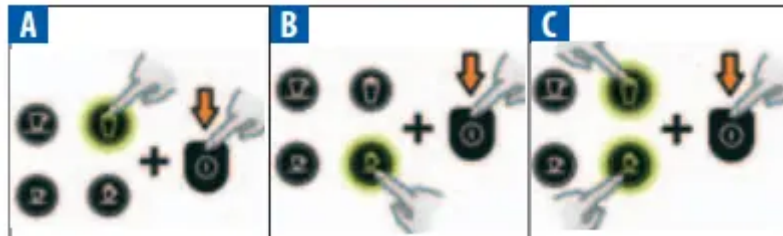

<b>A</b> Soft water hardness Faible dureté de l'eau	<b>B</b> Medium water hardness Moyenne dureté de l'eau	<b>C</b> Hard water hardness Forte dureté de l'eau
< 10° dH	10° dH – 20° dH	>20° dH
< 18° fH	18° fH – 36° fH	>36° fH
< 180 mg/l CaCO <sub>3</sub>	180–360 mg/l CaCO <sub>3</sub>	360 mg/l CaCO <sub>3</sub>

Programmed buttons blink 3 times: water hardness is set.

## Restoring volumes to factory settings

Press all 4 buttons for 5 sec (when machine is switched on). All buttons blink 3 times: all volumes are reset.

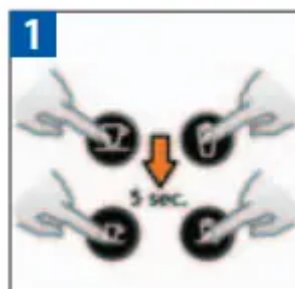

110 ml (3.7oz)



Milk\*: 150ml (5 oz)/Coffee: 40 ml (1.35 oz)



40 ml (1.35 oz)



Milk\*: 50ml (1.7 oz)/Coffee: 40ml (1.35 oz)



The volume of milk froth depends on the kind of milk that is used and its temperature.

## Troubleshooting

No indicator light	Check the mains, plug, voltage, and fuse. In case of problems, call the Nespresso Club.
No coffee, no water.	Water tank is empty. Fill water tank. → Descale if necessary; see Descaling section.
Coffee comes out very slowly.	Flow speed depends on the coffee variety. → Descale if necessary; see Descaling section.
Coffee is not hot enough.	Preheat cup. → Descale if necessary; see Descaling section.
Capsule area is leaking (water in capsule container).	Position capsule correctly. If leakages occur, call the Nespresso Club.
Irregular blinking.	Send appliance for repair or call the Nespresso Club.
No coffee, just water runs out (despite inserted capsule).	Call the Nespresso Club.
Lever cannot be closed completely.	Empty capsule container. Make sure that no capsule is blocked inside the capsule container
Quality of milk froth is not up to standard.	Use skimmed or semi-skimmed milk at refrigerator temperature (about 4° C) / Rinse after each milk preparation (see p. 25). Descale the machine (see. p. 27)
Cappuccino button shine orange.	Descale the machine.
Cappuccino button blinks orange.	Machine is in descaling mode.
All buttons blink.	Machine is in emptying mode.

### Warning

This content is compiled from multiple sources and is provided for reference purposes only. It may not be complete or fully applicable to all situations. If you are unable to resolve your issue, please contact the product manufacturer or an authorized service provider for official support.

