

ASSEMBLING AND PREPARING

CAUTION

- Always use genuine LG components to ensure safety and product performance.
- The product warranty will not cover damage or injury caused by the use of unauthorized components.
- It is recommended that use the supplied components.
- If you use generic cables not certified by LG, the screen may not display or there may be image noises.
- Illustrations in this document represent typical procedures, so they may look different from the actual product.
- Do not apply foreign substances (oils, lubricants, etc.) to the screw parts when assembling the product. (Doing so may damage the product.)
- Applying excessive force when tightening screws may cause damage to the monitor. Damage caused in this way will not be covered by the product warranty.
- Do not carry the monitor upside down by just holding the base. This may cause the monitor to fall off the stand and could result in personal injury.
- When lifting or moving the monitor, do not touch the monitor screen. The force applied to the monitor screen may cause damage to it.
- For wave pattern on appearance, unlike the general method of coating, it's applied to added glittering material in raw material. With no peeled-off appearance, it has good durability. Please use it with confidence because there is no problem in using the product at all.

NOTE

- The components may look different from those illustrated here.
- Without prior notice, all product information and specifications contained in this manual are subject to change to improve the performance of the product.
- To purchase optional accessories, visit an electronics store or an online shopping site, or contact the retailer from which you purchased the product.
- The power cord provided may differ depending upon the region.

Product and Button Description

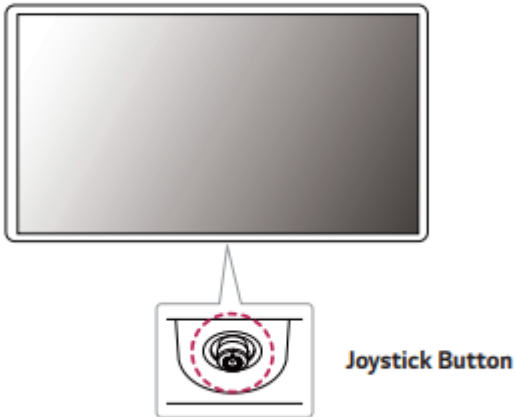

How to Use the Joystick Button

You can easily control the functions of the monitor by pressing the joystick button or moving it left/right with your finger

Basic Functions

		Power on	Press the joystick button once with your finger to turn on the monitor.
		Power off	Press and hold the joystick button once with your finger to turn off the monitor.
		Volume control	You can control the volume by moving the joystick button left/right.
		Controls screen brightness	You can control the screen's brightness by moving the joystick button up/down.

NOTE: The joystick button is located at the bottom of the monitor

Moving and Lifting the Monitor

When moving or lifting the monitor, follow these instructions to prevent the monitor from being scratched or damaged and to ensure safe transportation, regardless of its shape or size.

- Place the monitor in the original box or packing material before attempting to move it.
- Before moving or lifting the monitor, disconnect the power cord and all other cables.
- Hold the bottom and side of the monitor frame firmly. Do not hold the panel itself

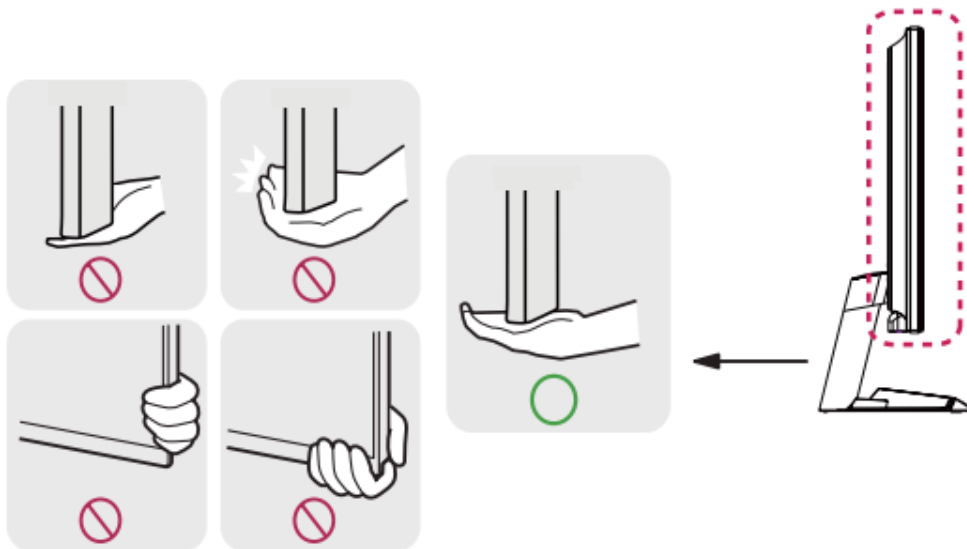

- When holding the monitor, the screen should face away from you to prevent it from being scratched.
- When transporting the monitor, do not expose the monitor to shock or excessive vibration.
- When moving the monitor, keep it upright and never turn the monitor on its side or tilt it sideways

CAUTION: Avoid touching the monitor screen as much as possible.

- This may result in damage to the screen or some of the pixels used to create images.



- If you use the monitor panel without the stand base, its joystick button may cause the monitor to become unstable and fall, resulting in damage to the monitor or human injury. In addition, this may cause the joystick button to malfunction.

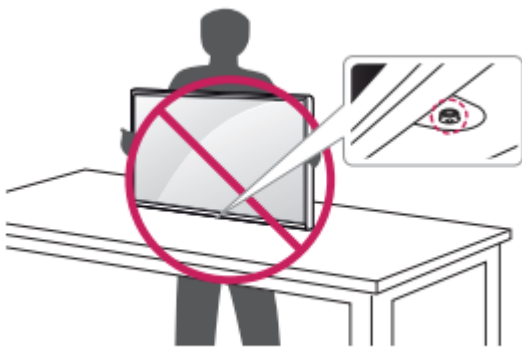

Installing on a Table

- Lift the monitor and place it on the table in an upright position. Place the monitor at least 100 mm (3.94 inches) away from the wall to ensure sufficient ventilation.

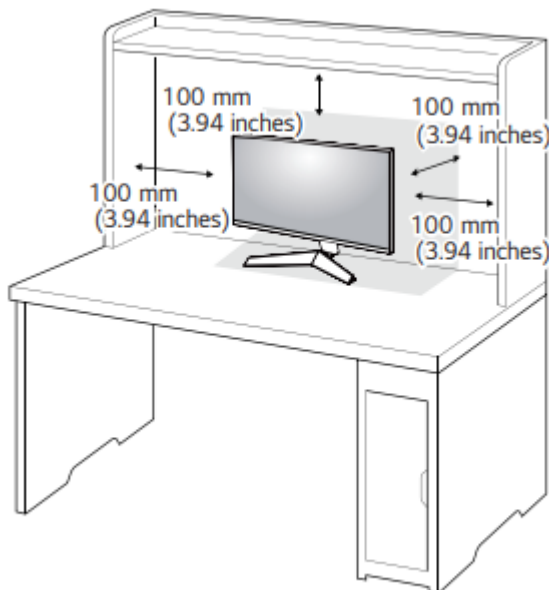

CAUTION

- Unplug the power cord before moving or installing the monitor. There is risk of electric shock.
- Make sure to use the power cord that is provided in the product package and connect it to a grounded power outlet.
- If you need another power cord, please contact your local dealer or the nearest retail store.

Adjusting the Angle

1. Place the monitor mounted on the stand base in an upright position.
2. Adjust the angle of the screen. The angle of the screen can be adjusted forward or backward from -5° to 15° for a comfortable viewing experience.

WARNING:

- To avoid injury to the fingers when adjusting the screen, do not hold the lower part of the monitor's frame as illustrated below.

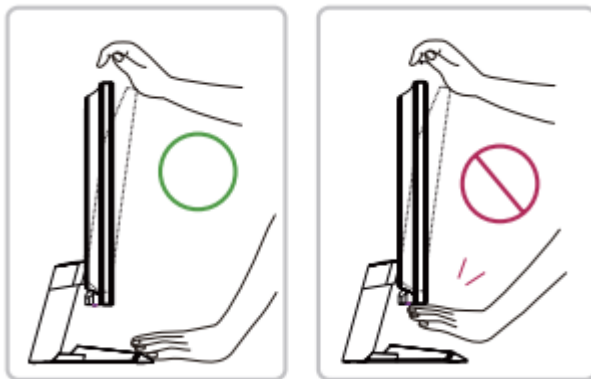

- Be careful not to touch or press the screen area when adjusting the angle of the monitor.

Tidying up Cables (27GN600, 32GN600)

- Arrange the cables using the cable holder as shown in the illustration.

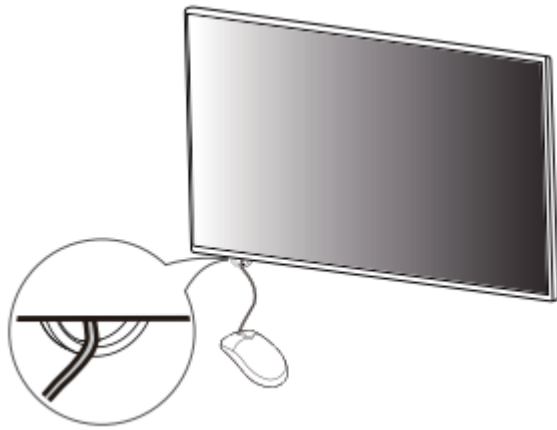

Using the Kensington Lock

- The connector for the Kensington security system is located at the bottom of the monitor.
- For more information on installation and usage, refer to the Kensington lock owner's manual or visit the website at kensington.com.
- Connect the monitor to a table using the Kensington security system cable.

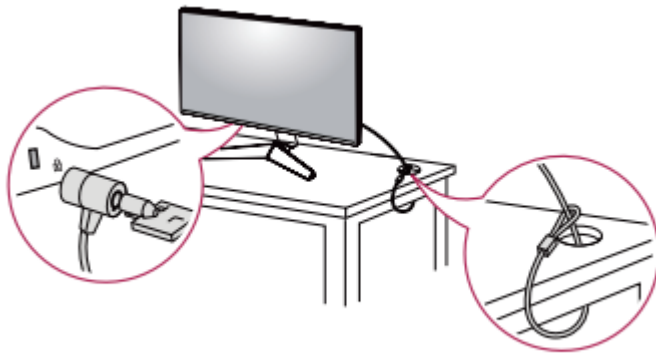

Installing the Wall Mount Plate

This monitor meets the specifications for the wall mount plate or other compatible devices.

1. Place the screen face down. To protect the monitor panel (screen), cover the surface with a soft cloth or the monitor protection pad included in the product package.
2. Remove the four screws tightened on the back of the monitor.
3. Place the wall mount plate onto the monitor and align it with the screw holes.
4. Tighten the four screws using a screwdriver to fix the plate to the monitor.

Installing on the Wall

- Install the monitor at least 100 mm (3.94 inches) away from the wall and leave about 100 mm (3.94 inches) of space at each side of the monitor to ensure sufficient ventilation.

Detailed installation instructions can be obtained from your local retail store. Alternatively, please refer to the manual for how to install and set up a tilting wall mounting bracket

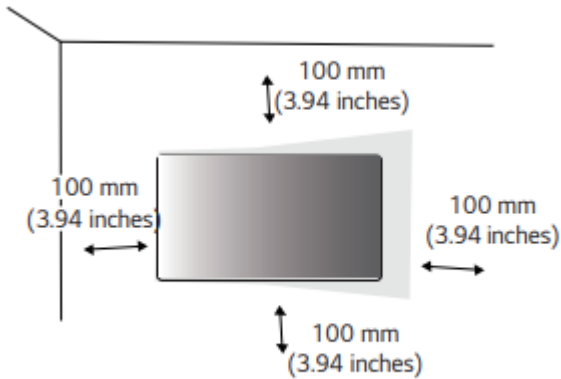

To install the monitor to a wall, attach a wall mounting bracket (optional) to the back of the monitor. Make sure that the wall mounting bracket is securely fixed to the monitor and to the wall.

1. If you use screws longer than the standard length, it may damage the inside of the product.
2. A non-VESA standard screw may damage the product and cause the monitor to fall. LG Electronics is not liable for any accidents relating to the use of nonstandard screws.

Wall Mount (mm)	100 x 100
Standard screw	M4 x L10
Number of screws	4
Wall Mount Plate (Optional)	LSW 149

NOTE

- Use the screws specified by VESA standards.
- The wall mount kit includes the installation guide and all necessary parts.
- The wall mounting bracket is optional. You can obtain optional accessories from your local dealer.
- The length of the screw may differ for each wall mounting bracket. Be sure to use the proper length.
- For more information, please refer to the user manual for the wall mounting bracket.



CAUTION

- Unplug the power cord before moving or installing the monitor to avoid electric shock.
- Installing the monitor on the ceiling or on a slanted wall may result in the monitor falling off, which could lead to injury. Use an authorized LG wall mount and contact the local dealer or qualified personnel.
- Applying excessive force when tightening screws may cause damage to the monitor. Damage caused in this way will not be covered by the product warranty.
- Use the wall mounting bracket and screws that conform to VESA standards. Damage caused by the use or misuse of inappropriate components will not be covered by the product warranty.
- When measured from the back of the monitor, the length of each installed screw must be 8 mm (0.3 inches) or less.

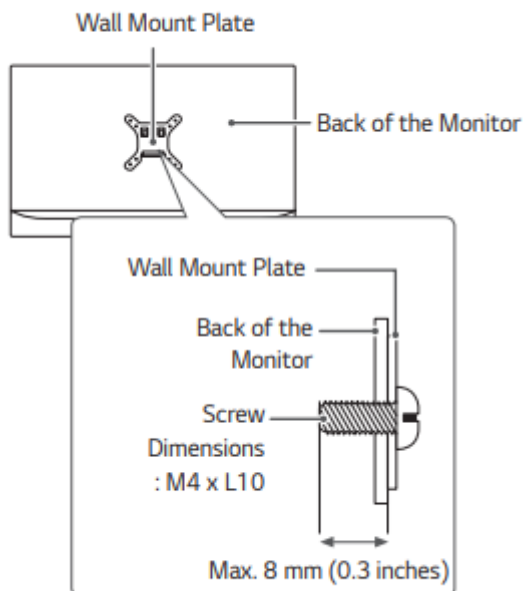

USING THE MONITOR

- Illustrations in this manual may differ from the actual product. Press the joystick button, go to Menu → Input, and then select the input option.

CAUTION

- Do not press the screen for a prolonged time. This may cause image distortion.
- Do not display a still image on the screen for a prolonged time. This may cause image retention. Use a screensaver if possible.

NOTE

- When connecting the power cord to the outlet, use a grounded (3-hole) power strip or a grounded power outlet.
- The monitor may flicker when turned on in an area where the temperature is low. This is normal.
- Sometimes red, green, or blue spots may appear on the screen. This is normal.

Connecting to a PC

- This monitor supports the *Plug and Play feature.

* Plug and Play: A feature that allows you to add a device to your computer without having to reconfigure anything or install any manual drivers.

HDMI Connection

Transmits digital video and audio signals from your PC to the monitor

CAUTION

- Using a DVI to HDMI / DP (DisplayPort) to HDMI cable may cause compatibility issues.
- Use a certified cable with the HDMI logo attached. If you do not use a certified HDMI cable, the screen may not display or a connection error may occur.
- Recommended HDMI cable types - High-Speed HDMI®/TM cable - High-Speed HDMI®/TM cable with Ethernet

DisplayPort Connection

- Transmits digital video and audio signals from your PC to the monitor.

NOTE

- There may be no video or audio output depending on the DP (DisplayPort) version of the PC.
- If you are using a Mini DisplayPort output graphics card, use a Mini DP to DP (Mini DisplayPort to DisplayPort) cable or gender that supports DisplayPort1.4. (sold separately)

Connecting AV Devices HDMI

- Connection HDMI transmits digital video and audio signals from your AV device to the monitor.

NOTE

- Using a DVI to HDMI / DP (DisplayPort) to HDMI cable may cause compatibility issues.
- Use a certified cable with the HDMI logo attached. If you do not use a certified HDMI cable, the screen may not display or a connection error may occur.

- Recommended HDMI cable types - High-Speed HDMI®/TM cable - High-Speed HDMI®/TM cable with Ethernet

Connecting Peripherals

Connecting Headphones

Connect peripherals to the monitor via the headphones port.

NOTE

- Peripheral devices are sold separately.
- If you use angled earphones, it may cause a problem with connecting another external device to the monitor. Therefore, it is recommended to use straight earphones.



Angled



Straight
(Recommend)

- Depending on the audio settings of the PC and external device, headphones and speaker functions may be limited.

Upgrading the Software via USB

(24GN600, 27GN600)

1. Remove the USB port cover when using USB port 

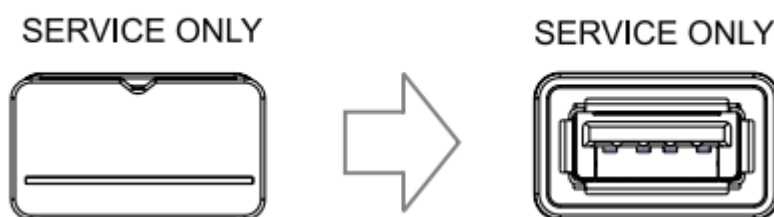

2. When the monitor screen operates normally, insert the USB storage device containing the upgrade software in the USB port ()

3. When the software upgrade message appears, select OK to start the upgrade.



4. Your Monitor will turn itself off and on again automatically after completing software upgrade.

USER SETTINGS

Activating the Main Menu

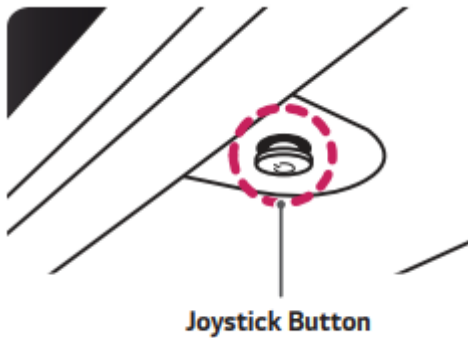
1. Press the joystick button on the bottom of the monitor.
2. Move the joystick up/down (▲ / ▼) and left/right (◀ / ▶) to set the options.
3. Press the joystick button once more to exit the main menu.

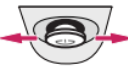

Button	Menu Status	Description
	Main menu disabled	Enables the main menu.
	Main menu enabled	Exits the main menu. (Holding down the button to turn off the monitor. You can turn off the monitor this way at any time, including when the OSD is on.)
	◀ Main menu disabled	Adjusts the monitor volume level.
	◀ Main menu enabled	Enters the Input features.
	▶ Main menu disabled	Adjusts the monitor volume level.
	▶ Main menu enabled	Enters the Menu feature.
	▲ Main menu disabled	Adjusts the monitor brightness level.
	▲ Main menu enabled	Turns off the monitor.
	▼ Main menu disabled	Adjusts the monitor brightness level.
	▼ Main menu enabled	Enters the Game Mode feature.

Main Menu Features



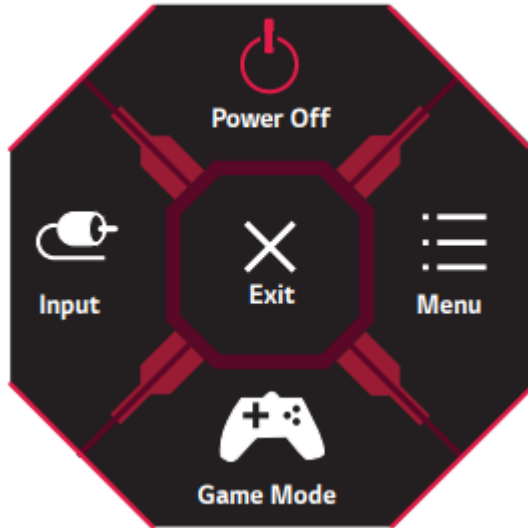

Main Menu	Description
Input	Sets input mode.
Power Off	Turns off the monitor.
Menu	Configures the screen settings.
Game Mode	Sets the game mode for gaming.
Exit	Exits the main menu.

Menu Settings

1. To view the OSD menu, press the joystick button at the bottom of the monitor and then enter the Menu.
2. Configure the options by moving the joystick up/down/left/right.
3. To return to the upper menu or set other menu items, move the joystick to ◀ or pressing (🔌) it.
4. If you want to exit the OSD menu, move the joystick to ◀ until you exit.



Game Mode



Game Adjust



Picture Adjust



Input



General



Game Mode on SDR(Non-HDR)signal.

Menu > Game Mode		Description
Game Mode	Gamer 1	In this mode, users can customize elements including game-related options.
	Gamer 2	Gamer 1 and Gamer 2 picture modes allow you to save two sets of customized settings, including game-related setup options.
	FPS	This mode is optimized for FPS games.
	RTS	This mode is optimized for RTS Game.
	Vivid	Optimized the screen for vivid colors.
	Reader	Optimizes the screen for viewing documents. You can brighten the screen in menu.
	HDR Effect	Optimizes the screen for high dynamic range.

Game Mode on HDR signal.



Menu > Game Mode		Description
Game Mode	Gamer 1	In this mode, users can customize elements including game-related options.
	Gamer 2	Gamer 1 and Gamer 2 picture modes allow you to save two sets of custom display settings, including game-related setup options.
	FPS	This mode is optimized for FPS games. It is suitable for very dark FPS games.
	RTS	This mode is optimized for RTS Game.
	Vivid	Optimized the screen for vivid colors.
		<p>NOTE</p> <ul style="list-style-type: none"> • HDR content may not be operated properly depending on the Windows10 OS setting. Please check the HDR On / Off setting of Windows. • When the HDR function is turned on, the characters or picture quality may be poor according to Graphic card performance. • While the HDR function is on, screen flickering or cracking may occur when changing monitor input or power on/off according to Graphic card performance.

Menu > Game Adjust		Description	
Game Adjust	1ms Motion Blur Reduction (for 32GN600)	On	<p>This mode minimizes motion blur in fast-moving v of this function, select 1920 x 1080 @ 120Hz/144</p> <p>1ms Motion Blur Reduction.</p>  <p>This function is available for the following vertical 165Hz)</p>
		Off	<p>Turns 1ms Motion Blur Reduction Mode off.</p> 
			<p>NOTE</p> <ul style="list-style-type: none"> • To reduce motion blur, brightness is reduced with backlight co • 1ms Motion Blur Reduction and FreeSync feature can not • This function is game-optimized. • It is recommended to turn off when you are not using the gam • Flicker may occur during 1ms Motion Blur Reduction opera
	Motion Blur Reduction (for 24GN600, 27GN600)	On	<p>This mode minimizes motion blur in fast-moving v of this function, select 1920 x 1080 @ 120Hz/144</p> <p>Blur Reduction.</p>  <p>This function is available for the following vertical</p>

	Off	<p>Turns Motion Blur Reduction Mode off.</p> 				
	<p>NOTE</p> <ul style="list-style-type: none"> • To reduce motion blur, brightness is reduced with backlight control. • Motion Blur Reduction and FreeSync feature can not used together. • This function is game-optimized. • It is recommended to turn off when you are not using the game. • Flicker may occur during Motion Blur Reduction operation. 					
<p>FreeSync Premium (for 32GN600)</p>	<p>Provides seamless and natural images by synchronizing the vertical frequency of the panel with that of the output signal.</p> <p>CAUTION</p> <ul style="list-style-type: none"> • Supported Interface: DisplayPort,HDMI. • Supported Graphic Card : A graphic card that supports AMD's FreeSync Premium. • Supported Version : Make sure to update the graphic card to the latest version. • For more information and requirement, refer to AMD website. • FreeSync Premium and 1ms Motion Blur Reduction cannot be used together. <table border="1" data-bbox="699 1386 1596 1565"> <tr> <td data-bbox="699 1386 979 1476">On</td> <td data-bbox="979 1386 1596 1476">FreeSync function on.</td> </tr> <tr> <td data-bbox="699 1476 979 1565">Off</td> <td data-bbox="979 1476 1596 1565">FreeSync function off.</td> </tr> </table>		On	FreeSync function on.	Off	FreeSync function off.
On	FreeSync function on.					
Off	FreeSync function off.					
<p>Adaptive-Sync (for 27GN600)</p>	<p>Provides seamless and natural images by synchronizing the vertical frequency of the panel with that of the output signal.</p> <p>CAUTION</p> <ul style="list-style-type: none"> • In HDMI input, the menu name is displayed as certified AMD Adaptive-Sync. (FreeSync / FreeSync Premium / FreeSync Premium Pro). • Supported Interface: DisplayPort (Adaptive-Sync), HDMI (FreeSync). • Supported Graphic Card : A graphic card that supports NVIDIA G-Sync or AMD FreeSync is necessary. • Supported Version : Make sure to update the graphic card to the latest version. 					

	<ul style="list-style-type: none"> For more information and requirement, refer to NVIDIA website (www.nvidia.com) and AMD website (www.amd.com). 						
	<table border="1"> <tr> <td>Extended</td> <td>Adaptive-Sync function on. (Enable wider frequency range than basic mode.)</td> </tr> <tr> <td>Basic</td> <td>Adaptive-Sync function on. (Enable basic frequency range.)</td> </tr> <tr> <td>Off</td> <td>Adaptive-Sync function off.</td> </tr> </table>	Extended	Adaptive-Sync function on. (Enable wider frequency range than basic mode.)	Basic	Adaptive-Sync function on. (Enable basic frequency range.)	Off	Adaptive-Sync function off.
Extended	Adaptive-Sync function on. (Enable wider frequency range than basic mode.)						
Basic	Adaptive-Sync function on. (Enable basic frequency range.)						
Off	Adaptive-Sync function off.						
FreeSync Premium (for 24GN600)	<p>Provides seamless and natural images by synchronizing the vertical frequency of the output signal.</p> <p>CAUTION</p> <ul style="list-style-type: none"> Supported Interface: DisplayPort,HDMI. Supported Graphic Card : A graphic card that supports AMD's FreeSync Premium. Supported Version : Make sure to update the graphic card to the latest version. For more information and requirement, refer to AMD website (www.amd.com) FreeSync Premium. FreeSync Premium and Motion Blur Reduction cannot be enabled at the same time. <table border="1"> <tr> <td>Extended</td> <td>FreeSync Premium function on. (Enable wider frequency range than basic mode.)</td> </tr> <tr> <td>Basic</td> <td>FreeSync Premium function on. (Enable basic frequency range.)</td> </tr> <tr> <td>Off</td> <td>FreeSync Premium function off.</td> </tr> </table>	Extended	FreeSync Premium function on. (Enable wider frequency range than basic mode.)	Basic	FreeSync Premium function on. (Enable basic frequency range.)	Off	FreeSync Premium function off.
Extended	FreeSync Premium function on. (Enable wider frequency range than basic mode.)						
Basic	FreeSync Premium function on. (Enable basic frequency range.)						
Off	FreeSync Premium function off.						
Black Stabilizer	You can control the black contrast to have better visibility in dark scenes and objects on dark game screens.						

Response Time	Sets a response time for displayed pictures based on the speed of the s For a normal environment, it is recommended that you use Fast . For a fast-moving picture, it is recommended that you use Faster . Once Faster Mode is selected, Motion Blur may occur depending on th		
	Faster	Sets the response time to Faster.	
	Fast	Sets the response time to Fast.	
	Normal	Sets the response time to Normal.	
	Off	Does not use the response time improvement fea	
Cross Hair	Cross hair provides a mark on the center of the screen for First Person can select the cross hair that fits their gaming environment among four <ul style="list-style-type: none"> • When the monitor is off or enters energy saving mode, the cro automatically turned off. 		
Game Reset	Do you want to reset your Game settings?		
	No	Cancel the select.	
	Yes	Returns to the default settings.	
Menu > Picture Adjust		Description	
Picture Adjust	Brightness	Adjusts the brightness of the screen.	
	Contrast	Adjusts the contrast of the screen.	
	Sharpness	Adjusts the sharpness of the screen.	
	Gamma	Mode 1, Mode 2, Mode 3	The higher the gamma value, the darker the image lower the gamma value, the lighter the image bec
		Mode 4	If you do not need to adjust the gamma settings,
	Color Temp	Custom	The user can adjust it to red, green, or blue by cu
		Warm	Sets the screen color to a reddish tone.

		Medium	Sets the screen color to between a red and blue
		Cool	Sets the screen color to a bluish tone.
		Manual	The user can fine - tune the color temperature.
	R/G/B	You can customize the picture color using Red , Green , and Blue colors	
	Six Color	Meets the user requirements for colors by adjusting the hue and saturation, and then saving the settings.	
		Hue	Adjusts the tone of the screen colors.
		Saturation	Adjusts the saturation of the screen colors. The higher the saturation, the more saturated and brighter the colors become. The lower the saturation, the less saturated and darker the colors become.
	Black Level	Sets the offset level (for HDMI only). <ul style="list-style-type: none"> • Offset: as a reference for a video signal, this is the darkest color. 	
		High	Keeps the current contrast ratio of the screen.
		Low	Lowers the black levels and raises the white levels, resulting in a higher contrast ratio of the screen.
Picture Adjust	DFC	On	Adjusts the brightness automatically according to the content.
		Off	Disables the DFC feature.
	Picture Reset	Do you want to reset your picture settings?	
		No	Cancel the select.
		Yes	Returns to the default settings.
Menu > Input	Description		
Input	Input List	Selects the input mode.	
		Adjusts the aspect ratio of the screen.	

	Aspect Ratio	Full Wide	Displays the video in widescreen, regardless of the aspect ratio of the source.	
		Original	Displays video according to the aspect ratio of the source.	
		<p>NOTE</p> <ul style="list-style-type: none"> The display may look the same for Full Wide and Original options at 1080p resolution. (1920 x 1080) 		
	Auto Input Switch	When automatic input switch is set to On , display will automatically switch to the input source connected.		
		On	Enables Auto Input Switch .	
		Off	Disables Auto Input Switch .	
Menu > General		Description		
General	Language	Sets the menu screen to the desired language.		
	SMART ENERGY SAVING	High	Saves energy using the high-efficiency SMART ENERGY SAVING feature.	
		Low	Saves energy using the low-efficiency SMART ENERGY SAVING feature.	
		Off	Disables the SMART ENERGY SAVING feature.	
			<p>NOTE</p> <ul style="list-style-type: none"> The value of energy saving data may differ depending on panel type. If you select the option of SMART ENERGY SAVING is High or Low, the actual energy saving may become lower or higher depend on source. 	
	Power LED	On	The power LED turns on automatically.	
		Off	The power LED turns off.	
	Automatic Standby	Feature that automatically turns off the monitor when there is no movement for a set amount of time. You can set a timer for the auto-off function. (8H , 6H , 4H and OFF)		
HDMI Compatibility Mode	HDMI Compatibility Mode feature can recognize the legacy equipment that does not support HDMI 2.0.			
	On	Enables HDMI Compatibility Mode .		

		Off	Disables HDMI Compatibility Mode .
		<p>NOTE</p> <ul style="list-style-type: none"> • If the connected device does not support HDMI Compatibility, the device may not work properly. • Some older graphics cards do not support HDMI 2.0, but you can select the HDMI 1.4 option in the control panel of window. • This may cause the screen to appear abnormally. 	
	DisplayPort Version	Please set the DisplayPort version to match the version of the connected device (e.g., 1.1) . If you want to use the HDR, select the DP version to 1.4 .	
General	Buzzer	This feature lets you set the sound generated from Buzzer when your monitor is powered on.	
		On	Enables your monitor's Buzzer .
		Off	Disables your monitor's Buzzer .
	OSD Lock	This feature disables the configuration and adjustment of menus.	
		On	Enables OSD Lock .
		Off	Disables OSD Lock .
		<p>NOTE</p> <ul style="list-style-type: none"> • All features are disabled except Brightness, Contrast in Picture, OSD Lock and Information in General. 	
	Information	The display information will be shown the Total Power On Time, Resolution, and Refresh Rate.	
	Reset to Initial Settings	Do you want to reset your settings?	
		No	Cancel the select.
Yes		Returns to the default settings.	

TROUBLESHOOTING



Nothing is displayed on the screen.	
Is the monitor's power cord plugged in?	<ul style="list-style-type: none"> • Check if the power cord is correctly plugged into the power outlet.
Is the power LED on?	<ul style="list-style-type: none"> • Check the power cable connection and press the power button.
Is the power on and the power LED displaying white?	<ul style="list-style-type: none"> • Check that the connected input is enabled (Menu > Input).
Is the power LED blinking?	<ul style="list-style-type: none"> • If the monitor is in sleep mode, move the mouse, or press any key on the keyboard, to switch the display on. • Check if the computer is turned on.
Is the The screen is not currently set to the recommended resolution. If you have no video or the screen flickers, see the troubleshooting guide in the product owner's manual. message being displayed?	<ul style="list-style-type: none"> • This occurs when signals transferred from the PC (graphics card) are not within the recommended horizontal or vertical frequency range of the monitor. Please see the Product Specification section of this manual to set the appropriate frequency.
Is the No Signal message being displayed?	<ul style="list-style-type: none"> • This is displayed when the signal cable between the PC and the monitor is missing or disconnected. Check the cable and reconnect it.
Have you installed the display driver?	<ul style="list-style-type: none"> • Be sure to install the display driver from our web site: http://www.lg.com • Make sure to check if the graphics card supports Plug and Play function.
The screen retains an image.	
Does image sticking occur even when the monitor is turned off?	<ul style="list-style-type: none"> • Displaying a still image for a prolonged time may cause damage to the screen, resulting in the retention of the image. • To extend the lifetime of the monitor, use a screensaver.
Screen display is unstable and shaky. / Images displayed on the monitor leave shadow trails.	

Did you select the appropriate resolution?	<ul style="list-style-type: none">• If the selected resolution is HDMI 1080i 60/50 Hz (interlaced), the screen may be flickering. Change the resolution to 1080p or the recommended resolution.
--	---

NOTE

- Vertical Frequency: In order to display an image, the screen must be refreshed dozens of times per second, like a fluorescent lamp. The number of times the screen is refreshed per second is called vertical frequency, or refresh rate, and is represented by Hz.
- Horizontal Frequency: The time it takes to display one horizontal line is called the horizontal cycle. If 1 is divided by the horizontal interval, the result is the number of horizontal lines displayed per second. This is called horizontal frequency and is represented by kHz.
- Check if the graphics card's resolution or frequency is within the range allowed by the monitor and set it to the recommended (optimal) resolution Control Panel > Display > Menu in Windows. (The settings may differ depending on the operating system (OS) you use.)
- Not setting the graphics card to the recommended (optimal) resolution may result in blurred text, a dimmed screen, a truncated display area or misalignment of the display.
- The setting methods may be different depending on the computer or operating system, and some resolutions may not be available depending on the performance of the graphics card. If this is the case, contact the manufacturer of the computer or graphics card for assistance.
- Some graphics cards may not support 1920 x 1080 resolution. If the resolution cannot be displayed, contact the manufacturer of your graphics card.

The display color is abnormal.	
Does the display appear discolored (16 colors)?	<ul style="list-style-type: none"> • Set the color to 24 bit (true color) or higher. In Windows, go to Control Panel > Display > Menu > Color Quality. (The settings may differ depending on the operating system (OS) you use.)
Does the display color appear unstable or monochrome?	<ul style="list-style-type: none"> • Check if the signal cable is connected properly. Reconnect the cable or reinsert the PC's graphics card.
Are there spots on the screen?	<ul style="list-style-type: none"> • When using the monitor, pixilated spots (red, green, blue, white, or black) may appear on the screen. This is normal for an LCD screen. It is not an error, nor is it related to the monitor's performance.
No sound from the headphone port.	
Are images displayed using DP (DisplayPort) or HDMI input without sound?	<ul style="list-style-type: none"> • Make sure that the headphone port connections are made properly. • Try increasing the volume with the joystick. <ul style="list-style-type: none"> ◦ Set the audio output of the PC to the monitor you are using. In Microsoft Windows, go to Control Panel > Hardware and Sound > Sound > set the Monitor as default device. (The settings may differ depending on the operating system (OS) you use.)

Warning

This content is compiled from multiple sources and is provided for reference purposes only. It may not be complete or fully applicable to all situations. If you are unable to resolve your issue, please contact the product manufacturer or an authorized service provider for official support.

