

## Seat belts

Make sure that all occupants are wearing their seat belts before driving the vehicle.

### Correct use of the seat belts

- Extend the shoulder belt so that it comes fully over the shoulder, but does not come into contact with the neck or slide off the shoulder.
- Position the lap belt as low as possible over the hips.
- Adjust the position of the seatback. Sit up straight and well back in the seat.
- Do not twist the seat belt.



### Fastening and releasing the seat belt (except for the third center seat)

1. To fasten the seat belt, push the plate into the buckle until a click sound is heard.
2. To release the seat belt, press the release button.

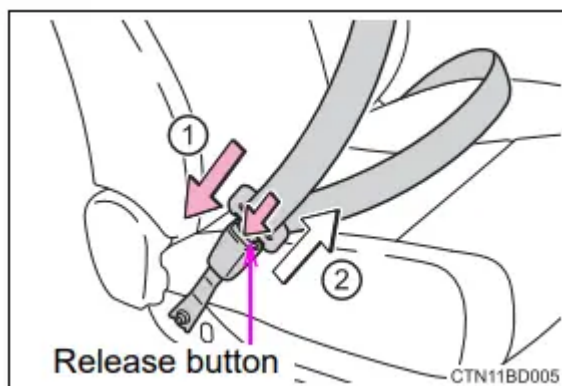

### Fastening the seat belt (for the third center seat)

1. Take the plate out of the holder, and then pull down the seat belt

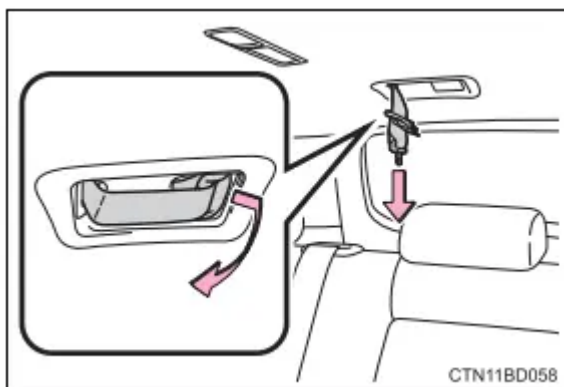

2. Push plate "A" into buckle "A" until a click sound is heard.

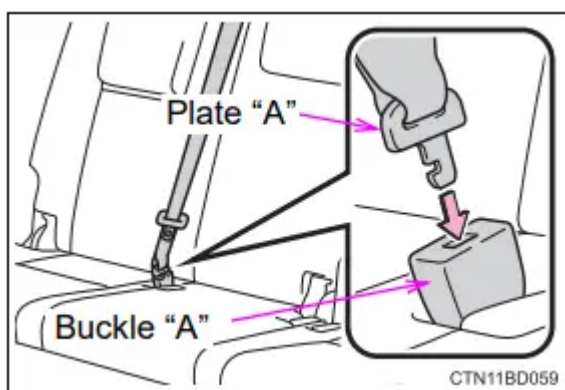

3. Push plate "B" into buckle "B" until a click sound is heard.

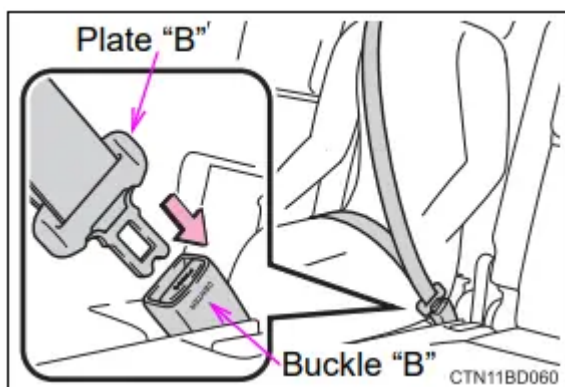

### Releasing and stowing the seat belt (for the third center seat)

1. To release plate "B", press the release button on buckle "B".

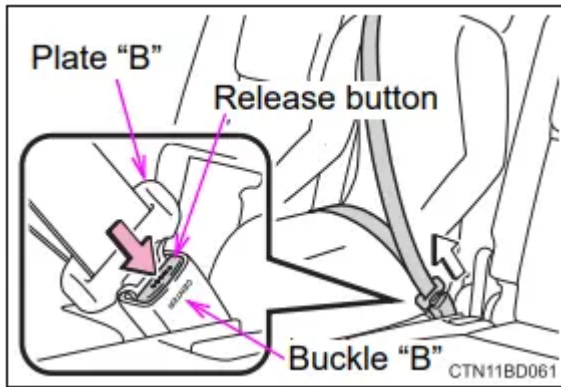

2. To release plate "A", insert the key (P. 114) or plate "B" into the hole on buckle "A". Retract the belt slowly when releasing and stowing the seat belt.

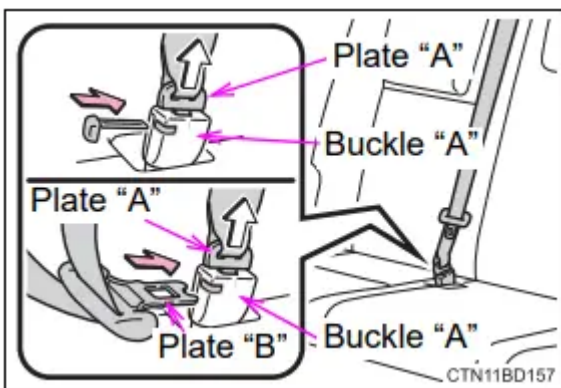

3. Holding plate "A" and "B" together, insert both plates into the holder on the roof.

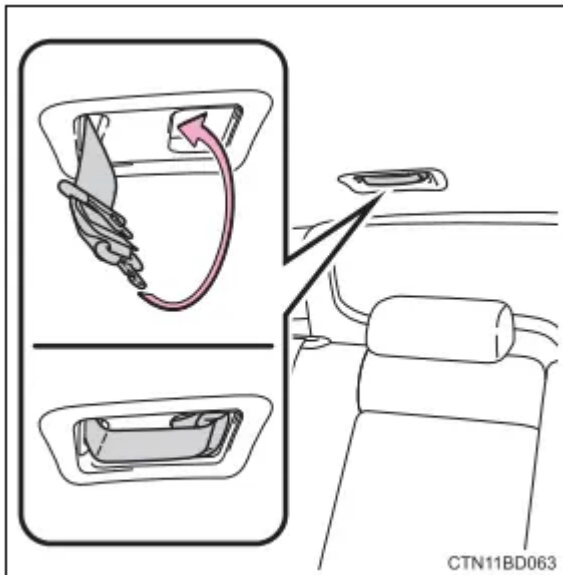

### Adjusting the seat belt shoulder anchor height (front seats)

1. Push the seat belt shoulder anchor down while pressing the release button.
2. Push the seat belt shoulder anchor up.

Move the height adjuster up and down as needed until you hear a click



### Seat belt comfort guide (for the third center seat)

If the shoulder belt sits close to a person's neck, use the seat belt comfort guide.

1. Pull the comfort guide from the pocket.

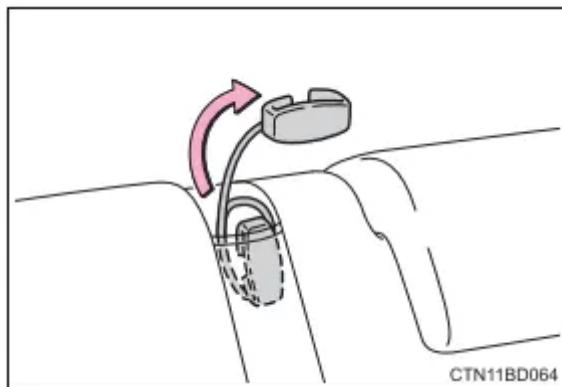

2. Slide the belt past the slot of the guide.

The elastic cord must be behind the seat belt.

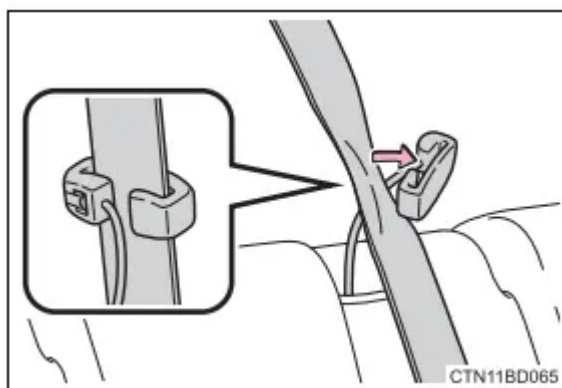

3. Buckle the seat belt and position it comfortably.

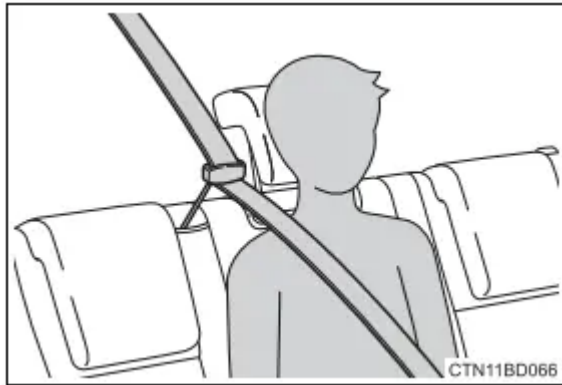

### **Seat belt pretensioners (front seats)**

The pretensioners help the seat belts to quickly restrain the occupants by retracting the seat belts when the vehicle is subjected to certain types of severe frontal collision or a vehicle rollover.

The pretensioners do not activate in the event of a minor frontal impact, a side impact or a rear impact

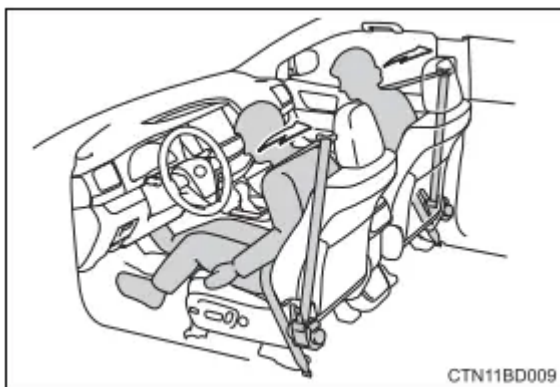

### **Emergency locking retractor (ELR)**

The retractor will lock the belt during a sudden stop or on impact. It may also lock if you lean forward too quickly. A slow, easy motion will allow the belt to extend so that you can move around fully.

### **Automatic locking retractor (ALR)**

When a passenger's shoulder belt is completely extended and then retracted even slightly, the belt is locked in that position and cannot be extended. This feature is used to hold the child restraint system (CRS) firmly. To free the belt again, fully retract the belt and then pull the belt out once more. ( P. 65)

### **When not using the rear seat belts**

- Second seat belts

Pass the outer seat belts through the seat belt hangers and secure the seat belt plates to prevent the shoulder belts from being damaged.

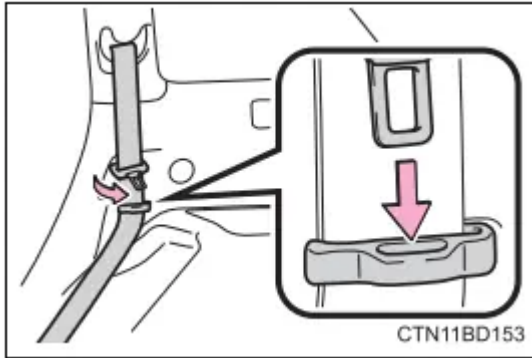

- Third seat belts

Pass the outer seat belts through the seat belt hangers and secure the seat belt plates to prevent the shoulder belts from being damaged.

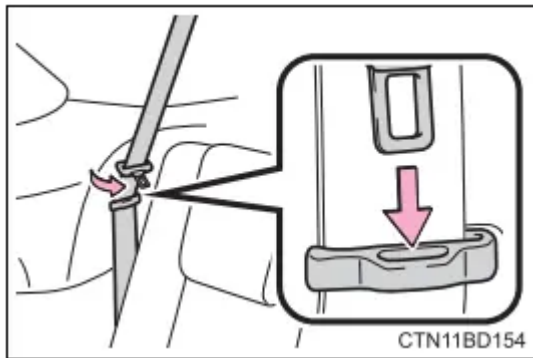

### Child seat belt usage

The seat belts of your vehicle were principally designed for persons of adult size.

- Use a child restraint system appropriate for the child, until the child becomes large enough to properly wear the vehicle's seat belt. ( P. 61)
- When the child becomes large enough to properly wear the vehicle's seat belt, follow the instructions regarding seat belt usage. ( P. 30)

### Replacing the belt after the pretensioner has been activated (front seats)

If the vehicle is involved in multiple collisions, the pretensioner will activate for the first collision, but will not activate for the second or subsequent collisions.

### Seat belt extender

If your seat belts cannot be fastened securely because they are not long enough, a personalized seat belt extender is available from your Toyota dealer free of charge.

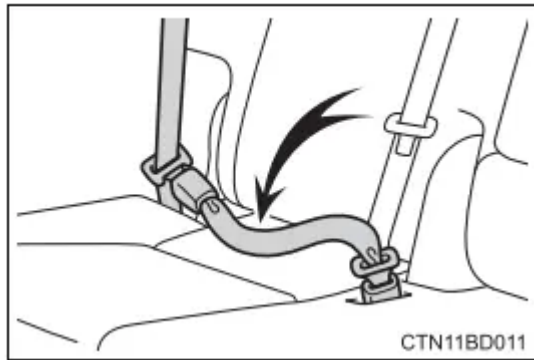

## Child restraint systems

A child restraint system for a small child or baby must itself be properly restrained on the seat with the LATCH anchors or the lap portion of the lap/shoulder belt. The laws of all 50 states of the U.S.A. and Canada now require the use of child restraint systems.

### Points to remember

Studies have shown that installing a child restraint on a rear seat is much safer than installing one on the front passenger seat.

- Choose a child restraint system that suits your vehicle and is appropriate to the age and size of the child.
- For installation details, follow the instructions provided with the child restraint system.

General installation instructions are provided in this manual.

### Types of child restraints

Child restraint systems are classified into the following 3 types according to the age and size of the child:

► Rear facing — Infant seat/convertible seat



► Forward facing — Convertible seat



► Booster seat



### Selecting an appropriate child restraint system

- Use a child restraint system appropriate for the child until the child becomes large enough to properly wear the vehicle's seat belt.
- If the child is too large for a child restraint system, sit the child on a rear seat and use the vehicle's seat belt.

### Child restraint precautions

- For effective protection in automobile accidents and sudden stops, a child must be properly restrained, using a seat belt or child restraint system depending on the age and size of the child. Holding a child in your arms is not a substitute for a child restraint system. In an accident, the child can be crushed against the windshield, or between you and the vehicle's interior.
- Toyota strongly urges the use of a proper child restraint system that conforms to the size of the child, installed on the rear seat. According to accident statistics, the child is safer when properly restrained in the rear seat than in the front seat.
- Never install a rear-facing child restraint system on the front passenger seat even if the "AIR BAG OFF" indicator light is illuminated.
- In the event of an accident, the force of the rapid inflation of the front passenger airbag can cause death or serious injury to the child if the rear-facing child restraint system is installed on the front passenger seat.

- A forward-facing child restraint system may be installed on the front passenger seat only when it is unavoidable. A child restraint system that requires a top tether strap should not be used in the front passenger seat since there is no top tether strap anchor for the front passenger seat. Adjust the seatback as upright as possible and always move the seat as far back as possible even if the “AIR BAG OFF” indicator light is illuminated, because the front passenger airbag could inflate with considerable speed and force. Otherwise, the child may be killed or seriously injured.
- Do not use the seat belt extender when installing a child restraint system on the front or rear passenger seat. If installing a child restraint system with the seat belt extender connected to the seat belt, the seat belt will not securely hold the child restraint system, which could cause death or serious injury to the child or other passengers in the event of an accident.

### **Child restraint precautions**

- Do not allow the child to lean his/her head or any part of his/her body against the door or the area of the seat, front and rear pillars or roof side rails from which the SRS side airbags or SRS curtain shield airbags deploy even if the child is seated in the child restraint system. It is dangerous if the SRS side airbags and curtain shield airbags inflate, and the impact could cause death or serious injury to the child.
- Make sure you have complied with all installation instructions provided by the child restraint manufacturer and that the system is properly secured. If it is not secured properly, it may cause death or serious injury to the child in the event of a sudden stop or accident.

### **When children are in the vehicle**

Do not allow children to play with the seat belt. If the seat belt becomes twisted around a child's neck, it may lead to choking or other serious injuries that could result in death.

If this occurs and the buckle cannot be unfastened, scissors should be used to cut the belt.

### **When the child restraint system is not in use**

- Keep the child restraint system properly secured on the seat even if it is not in use. Do not store the child restraint system unsecured in the passenger compartment.
- If it is necessary to detach the child restraint system, remove it from the vehicle or store it securely in the luggage compartment. If a head restraint was removed when installing a child restraint system, always install the head restraint before driving. This will prevent it from injuring passengers in the event of a sudden stop or accident.

# Adjusting the seats

## Front seats

### Adjustment procedure

#### ► Manual seat

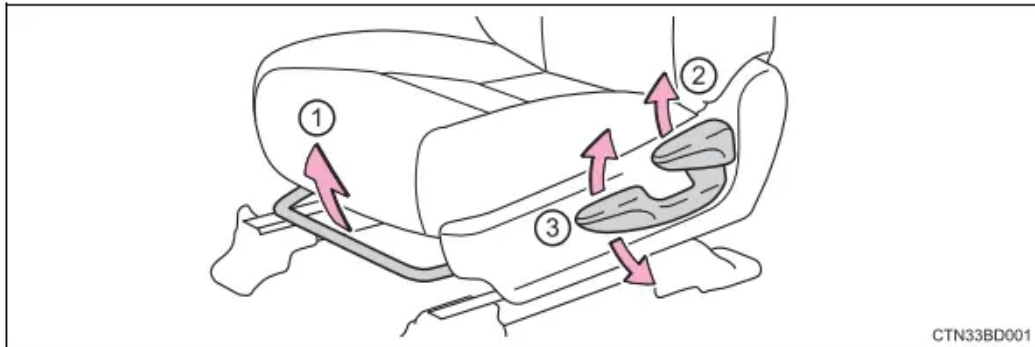

- ① Seat position adjustment lever
- ② Seatback angle adjustment lever
- ③ Vertical height adjustment lever (driver's side only)

#### ► Power seat

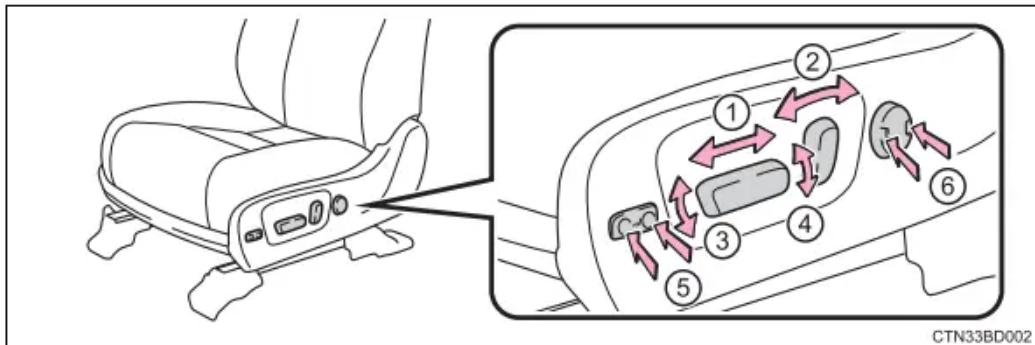

- ① Seat position adjustment switch
- ② Seatback angle adjustment switch
- ③ Seat cushion (front) angle adjustment switch (driver's side only)
- ④ Vertical height adjustment switch (driver's side only)
- ⑤ Seat cushion length adjustment switch (if equipped, for driver's seat only)
- ⑥ Lumbar support adjustment switch (driver's side only)

## Rear seats

### Adjustment procedure

#### Second seats

► Without a side table

► With a side table

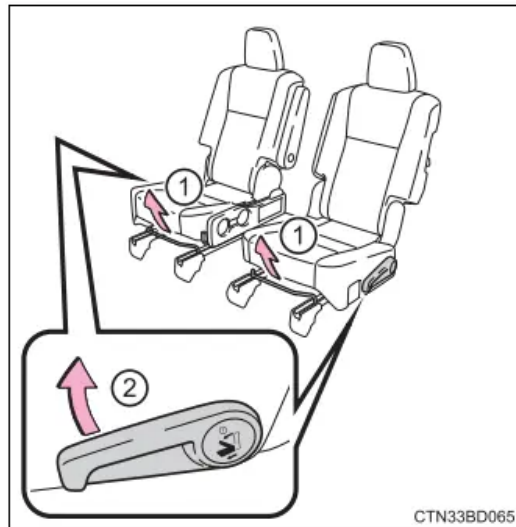
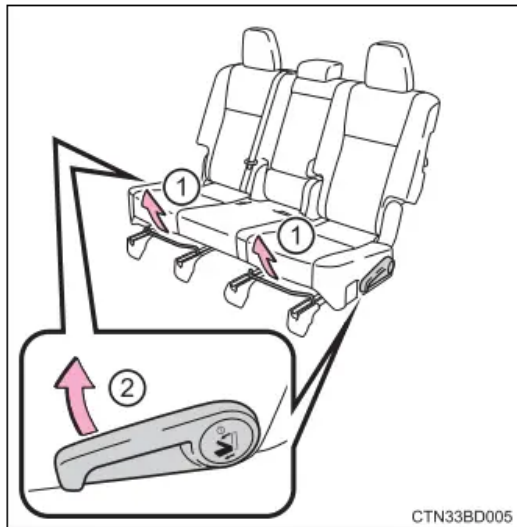

- ① Seat position adjustment lever
- ② Seatback angle adjustment lever

Pull the lever until the lock is completely released.

**Third seats**

Seatback angle adjustment strap

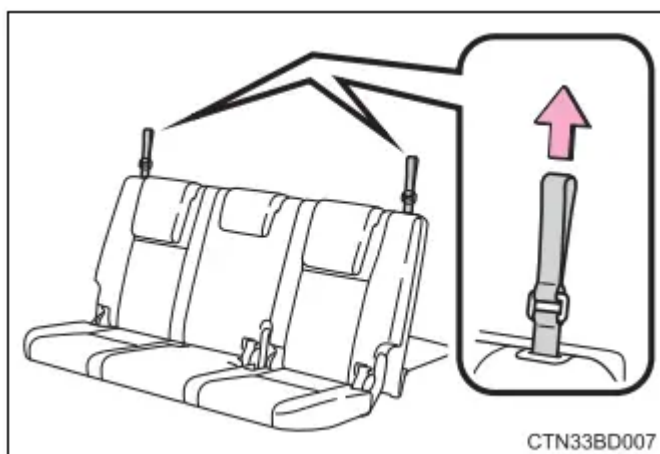

**Moving a second seat for third seat access**

**Getting in the vehicle**

Pull the lever and tilt the seat back forward. Move the seat to the front-most position.

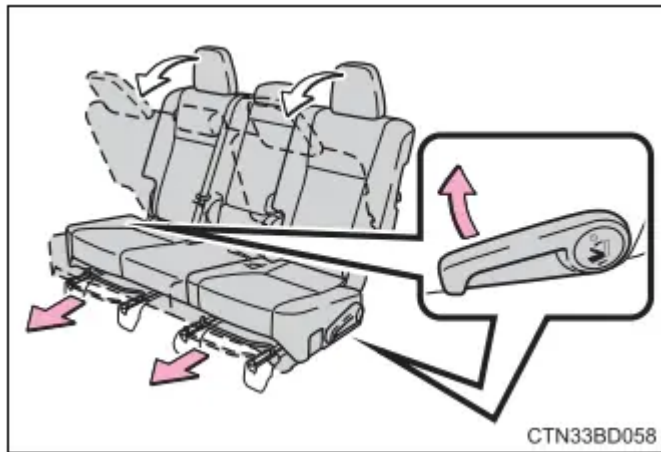

### ***Getting out of the vehicle***

Pull the lever on the side of the seatback and tilt the seatback forward. Move the seat to the front-most position.

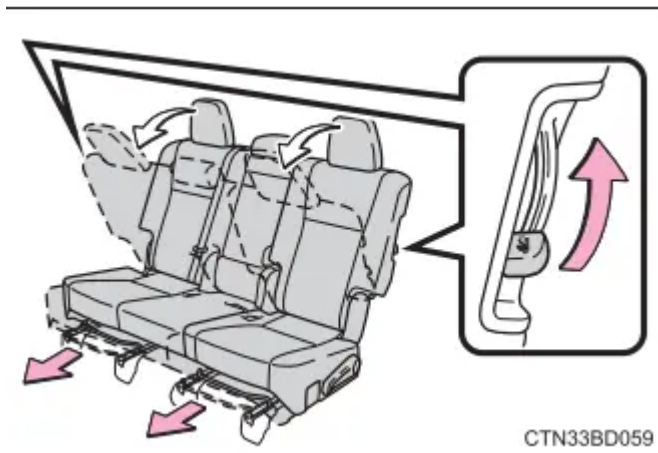

### ***After passengers have entered/exited the vehicle***

Lift up the seatback and slide the seat backward until it locks.

### **Folding down the second seats**

#### ***Before folding down the second seats***

1. Stow the armrest.
2. With a side table: Stow the side table.
3. Stow the second seat belt buckles

► Without a side table

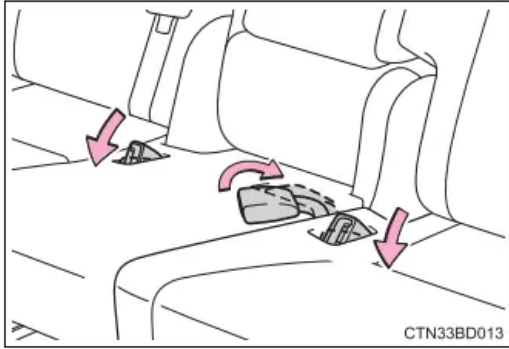

► With a side table

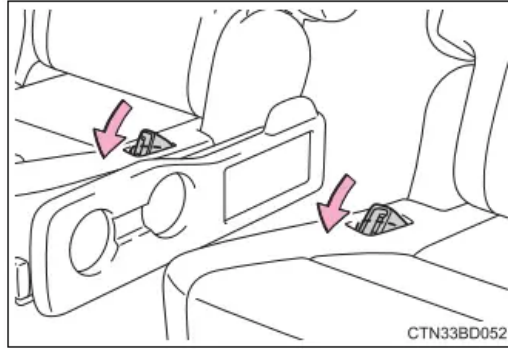

4. Pass the outer seat belts through the seat belt hangers and secure the seat belt plates.

This prevents the shoulder belts from being damaged. Make sure that the seat belts are removed from the hangers before using them.

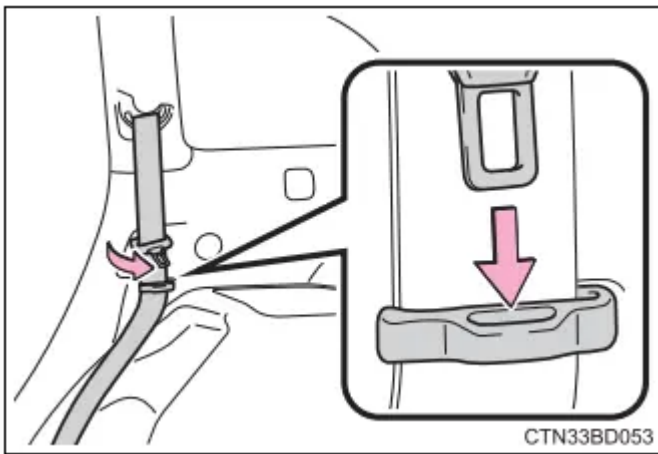

5. Lower the head restraints to the lowest position.

**Folding down the second seats**

1. Pull the lever and tilt the seatback forward.

Each seatback may be folded separately

► From inside

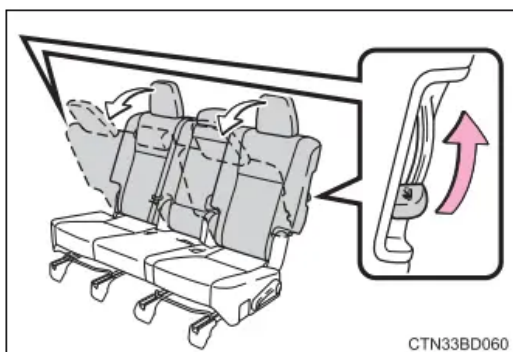

► From outside

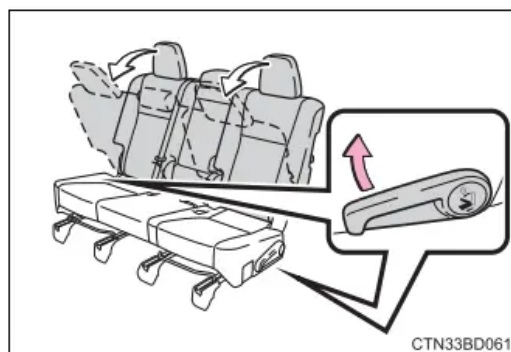

2. Pull the lever to unlock the seatback. The seatback will be folded down.

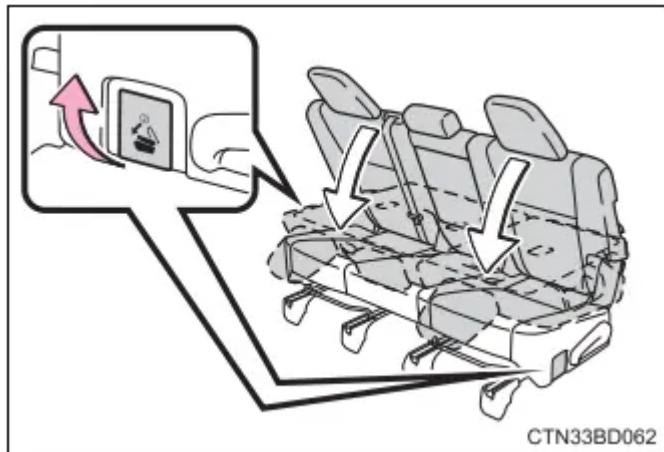

**After folding down the second seats**

Slide the folded second seats backward until they lock.

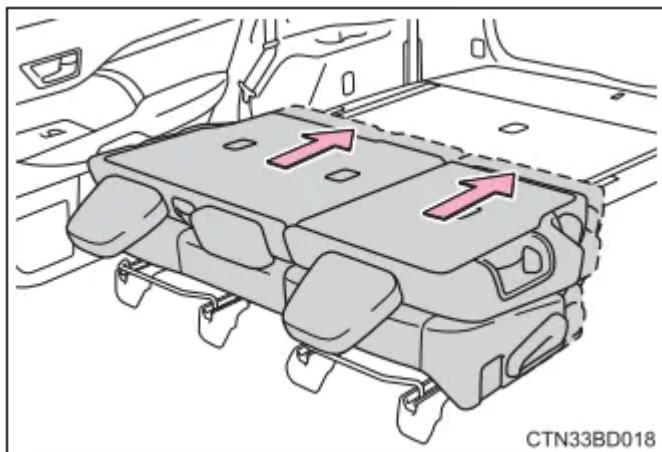

**Returning the second seats**

Lift up the seatbacks until they lock.

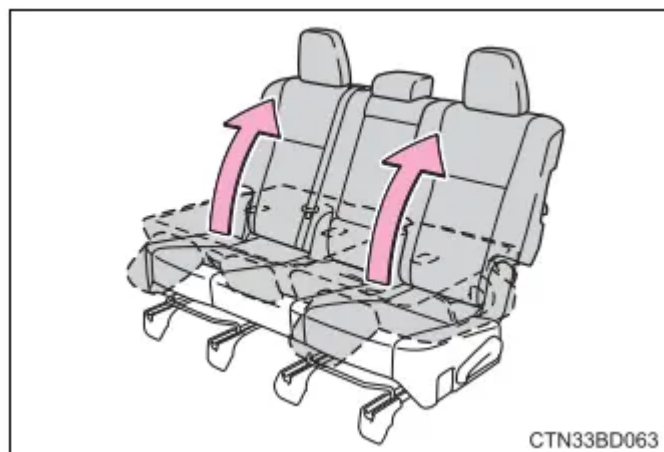

**Folding down the third seats**



**Before folding down the third seats**

1. Stow the third seat belt buckles

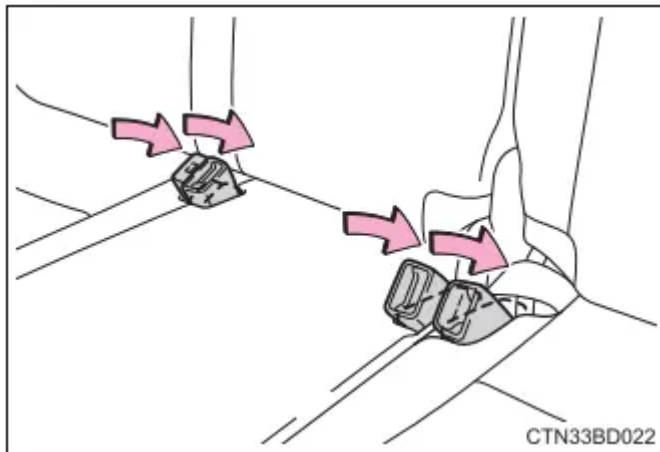

2. Pass the outer seat belts through the seat belt hangers and secure the seat belt plates.

This prevents the shoulder belts from being damaged. Make sure that the seat belts are removed from the hangers before using them.

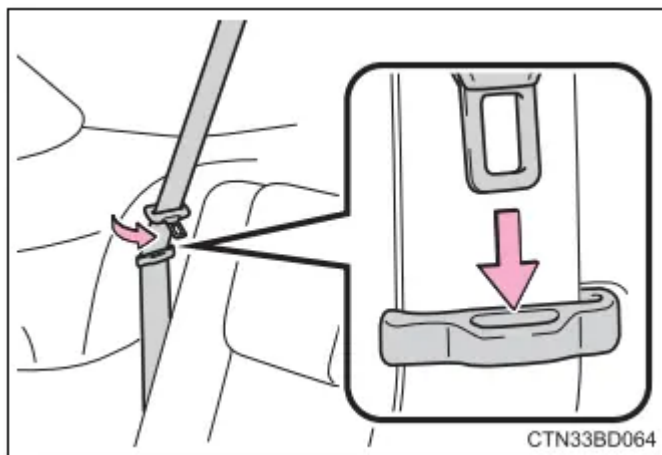

3. Lower the head restraints to the lowest position.

**Folding down the third seats**

While pulling the straps, fold down the seatbacks.

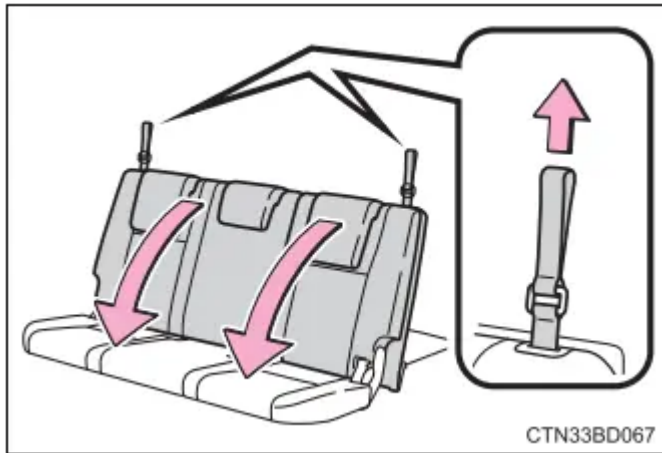

### *Returning the third seats*

#### ► From inside

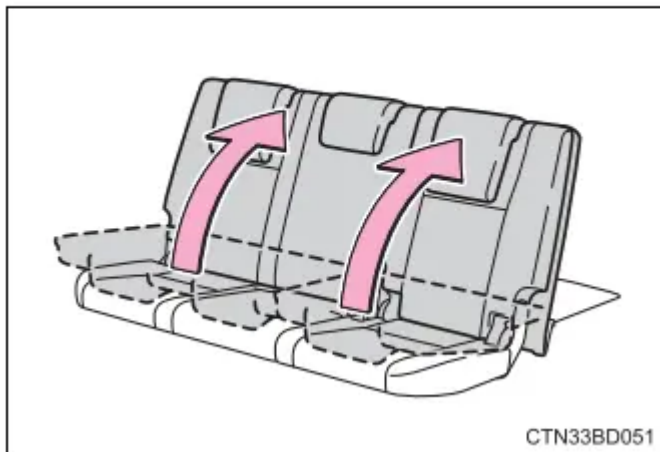

Lift up the seatbacks until they lock.

#### ► From outside

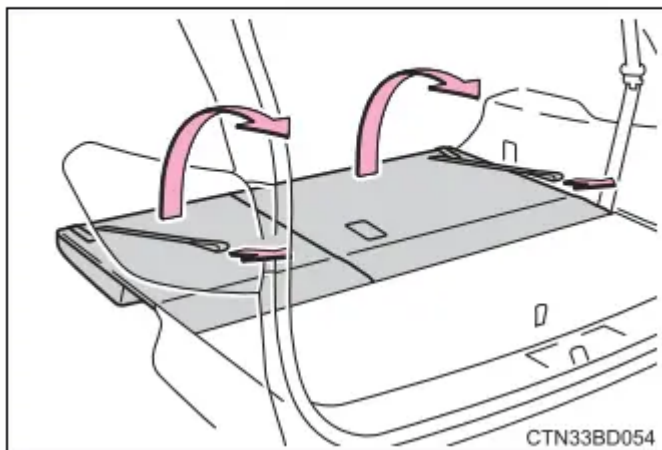

Pull the straps and raise the seatbacks until they lock. After using either strap, use the Velcro on the end of the strap to attach it to the seatback

## **Driving position memory**

This feature automatically adjusts the driver's seat and outside rear view mirrors to make entering and exiting the vehicle easier or to suit your preferences.

### **Driving position memory**

Your preferred driving position (the position of the driver's seat and outside rear view mirrors) can be recorded and recalled by pressing a button.

Two different driving positions can be recorded into memory.

### **Recording procedure**

1. Turn the engine switch to IGNITION ON mode.
2. Adjust the driver's seat and outside rear view mirrors to the desired positions.
3. While pressing the "SET" button, or within 3 seconds after the "SET" button is pressed, press button "1" or "2" until the buzzer sounds.

If the selected button has already been preset, the previously recorded position will be overwritten.

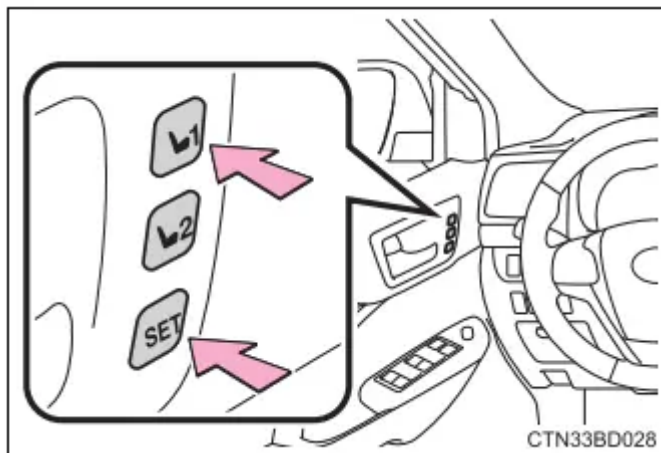

### **Recall procedure**

1. Check that the shift lever is in P.
2. Turn the engine switch to IGNITION ON mode.
3. Press one of the buttons for the driving position you want to recall until the buzzer sounds.

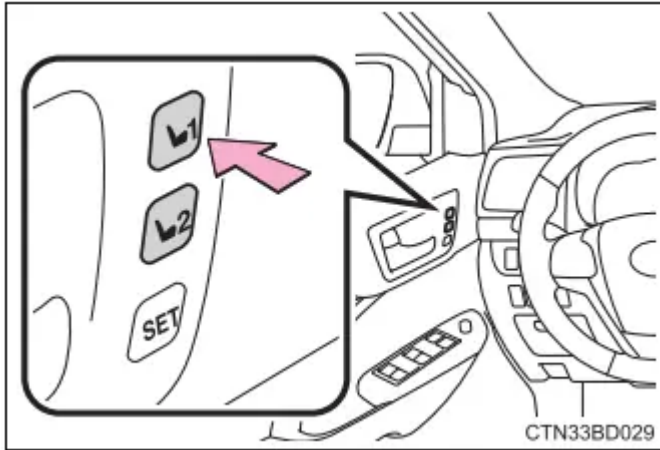

### ***To stop the position recall operation part-way through***

Perform any of the following:

- Press the “SET” button.
- Press button “1” or “2”.
- Operate any of the seat adjustment switches (only cancels seat position recall).

### ***Seat positions that can be memorized***

The seat position, with the exception of the portions adjusted by the seat cushion length switch and lumbar support switch, can be recorded.

### ***Operating the driving position memory after turning the engine switch off***

Recorded seat positions can be activated up to 180 seconds after the driver’s door is opened and another 60 seconds after it is closed again.

### ***In order to correctly use the driving position memory function***

If a seat position is already in the furthest possible position and the seat is operated in the same direction, the recorded position may be slightly different when it is recalled.

### **Memory recall function**

Each electronic key can be registered to recall your preferred driving position.

### ***Registering procedure***

Record your driving position to button “1” or “2” before performing the following: Carry only the key you want to register, and then close the driver’s door. If 2 or more keys are in the vehicle, the driving position cannot be recorded properly.

1. Check that the shift lever is in P.
2. Turn the engine switch to IGNITION ON mode.
3. Recall the driving position that you want to record.

4. While pressing the recalled button, press and hold the door lock switch (either lock or unlock) until the buzzer sounds.

If the button could not be registered, the buzzer sounds continuously for approximately 3 seconds.

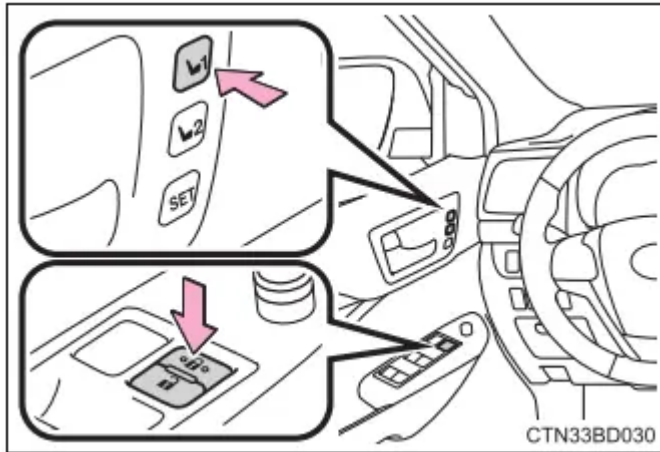

### ***Recall procedure***

Make sure that the doors are locked before recalling the driving position. Carry the electronic key that has been registered to the driving position, and then unlock and open the driver's door using the smart key system or wireless remote control.

The driving position will move to the recorded position. If the driving position is in a position that has already been recorded, the seat and outside rear view mirrors will not move.

### ***Cancelation procedure***

Carry only the key you want to cancel and then close the driver's door.

If 2 or more keys are in the vehicle, the driving position cannot be canceled properly.

1. Check that the shift lever is in P.
2. Turn the engine switch to IGNITION ON mode.
3. While pressing the "SET" button, press and hold the door lock switch (either lock or unlock) until the buzzer sounds twice.

If the button could not be canceled, the buzzer sounds continuously for approximately 3 seconds.

### ***Recalling the driving position using the memory recall function***

- Different driving positions can be registered for each electronic key. Therefore, the driving position that is recalled may be different depending on the key being carried.
- If a door other than the driver's door is unlocked with the smart key system, the driving position cannot be recalled. In this case, press the driving position button which has been set.

## Customization

The unlock door settings of the memory recall function can be customized.

## Head restraints

Head restraints are provided for all seats.

### Front seats and second seats (with a side table)

1. Up. Pull the head restraints up.
2. Down. Push the head restraint down while pressing the lock release button.

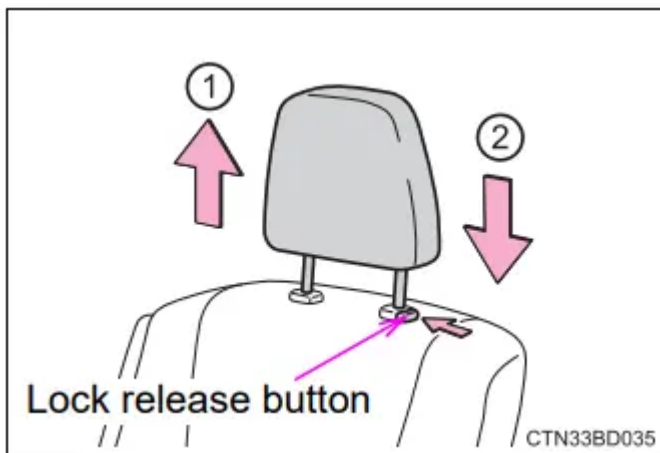

### Second seats (without a side table)

1. Up. Pull the head restraints up.
2. Down. Push the head restraint down while pressing the lock release button.

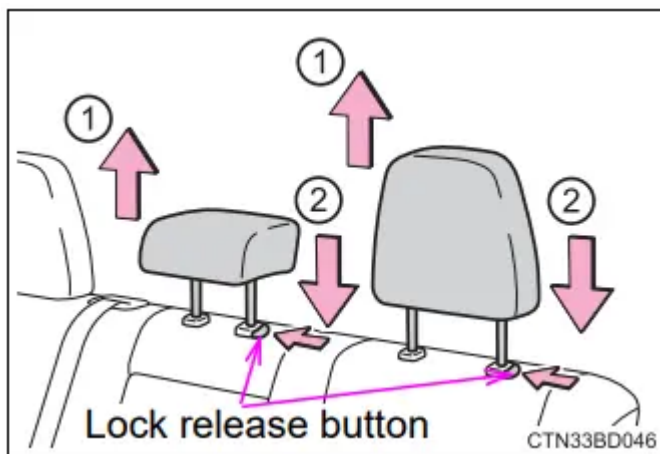

### Third seats

1. Up. Pull the head restraints up.
2. Down. Push the head restraint down while pressing the lock release button.

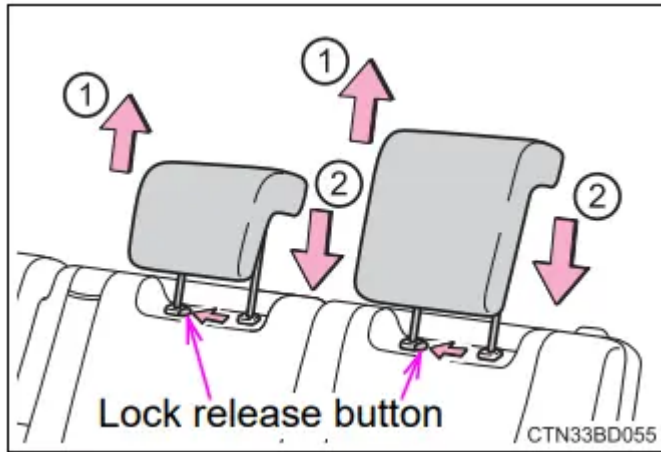

**Removing the head restraints**

- Front seats and second seats (with a side table)

Pull the head restraint up while pressing the lock release button.

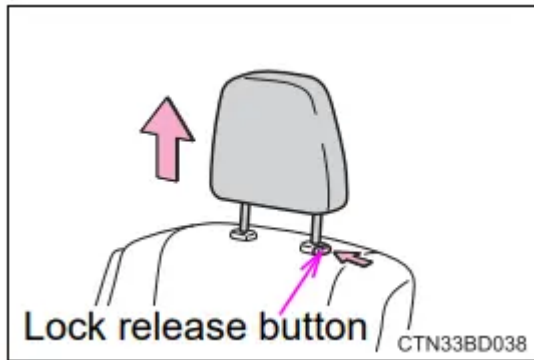

- Second seats (without a side table)

Pull the head restraint up while pressing the lock release button.

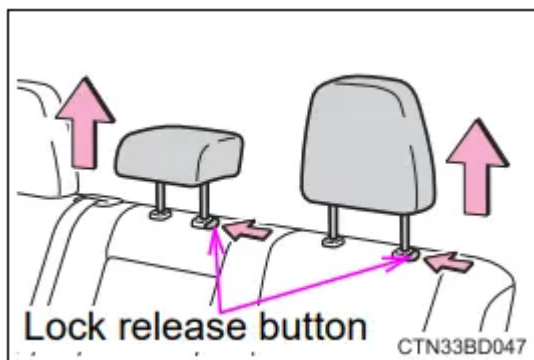

- Third seats

Pull the head restraint up while pressing the lock release button.



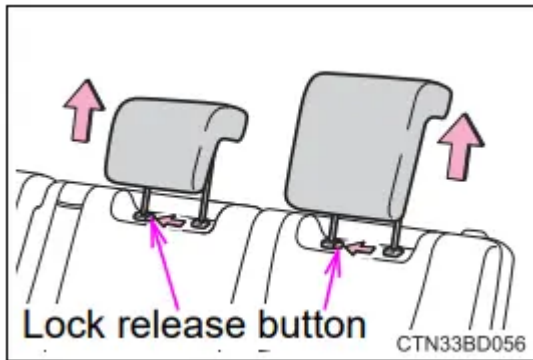

### ***Installing the head restraints***

- Front seats and second seats (with a side table)

Align the head restraint with the installation holes and push it down to the lock position.

Press and hold the lock release button when lowering the head restraint.

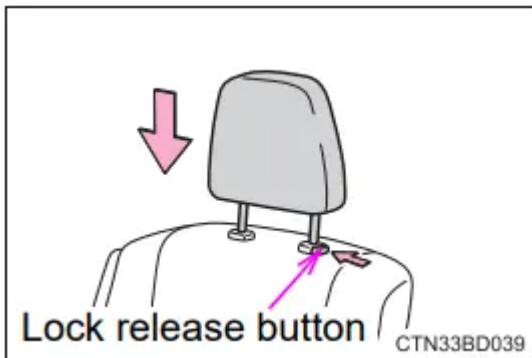

- Second seats (without a side table)

Align the head restraint with the installation holes and push it down to the lock position.

Press and hold the lock release button when lowering the head restraint.

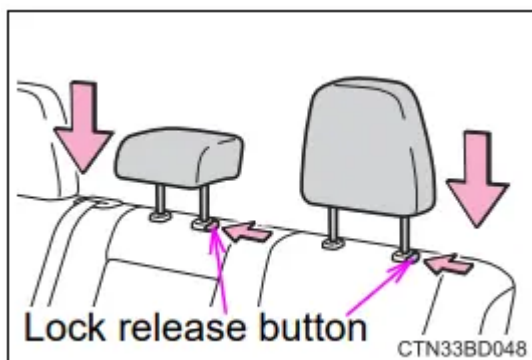

- Third seats

Align the head restraint with the installation holes and push it down to the lock position.

Press and hold the lock release button when lowering the head restraint.

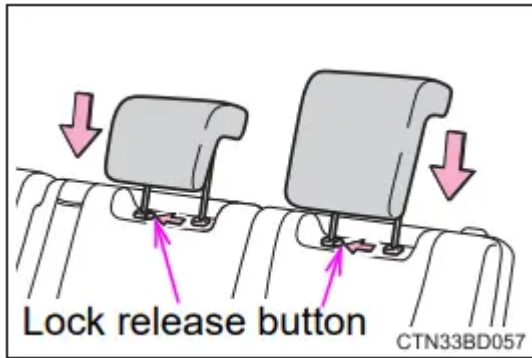

### ***Adjusting the height of the head restraints***

Make sure that the head restraints are adjusted so that the center of the head restraint is closest to the top of your ears.

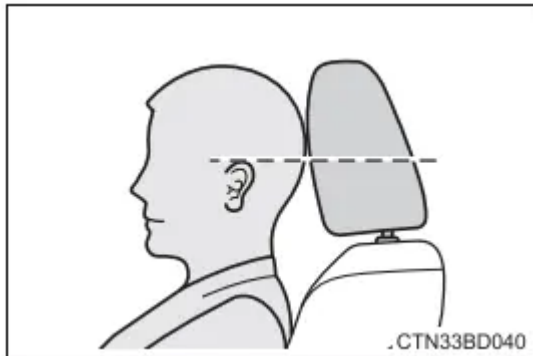

### ***Adjusting the third seat head restraints***

Always raise the head restraint one level from the stowed position when using.

## **Adjusting the steering wheel and mirrors**

### **Steering wheel**

#### **Adjustment procedure**

1. Hold the steering wheel and push the lever down.

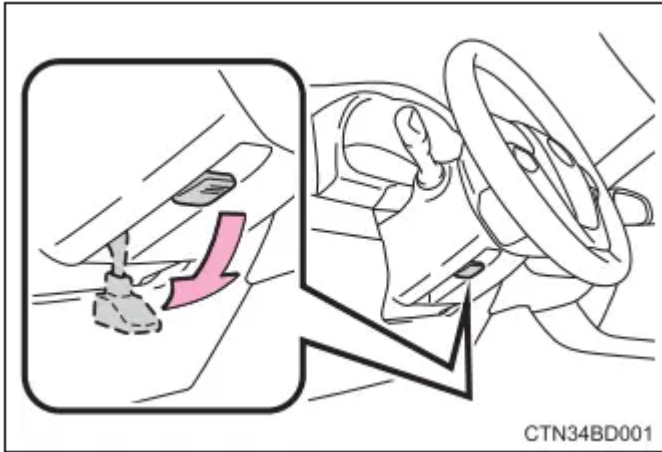

2. Adjust to the ideal position by moving the steering wheel horizontally and vertically. After adjustment, pull the lever up to secure the steering wheel.

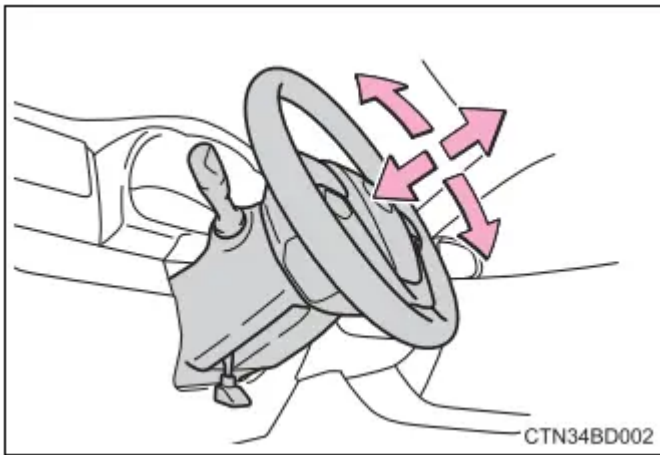

## Horn

To sound the horn, press on or close to the  mark.

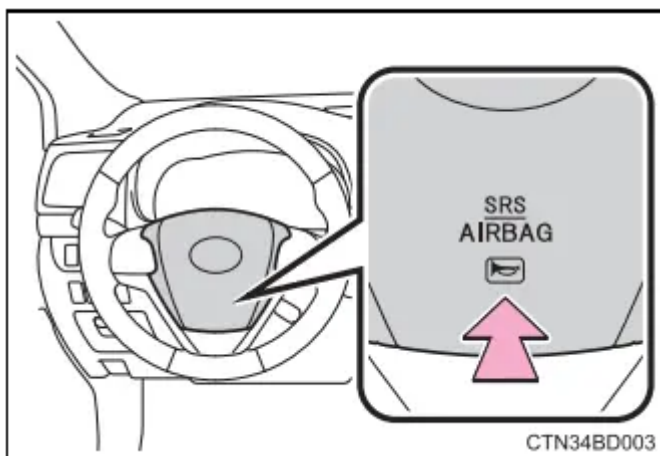

## Inside rear view mirror

The rear view mirror's position can be adjusted to enable sufficient confirmation of the rear view.

### Adjusting the height of rear view mirror

The height of the rear view mirror can be adjusted to suit your driving posture. Adjust the height of the rear view mirror by moving it up and down.

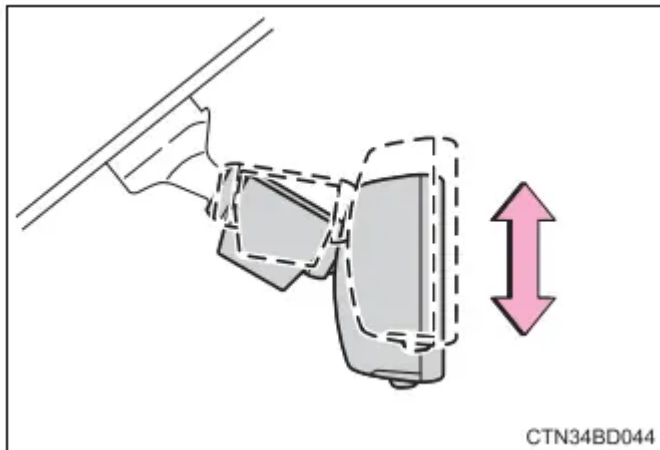

## Anti-glare function

- Manual anti-glare inside rear view mirror

Reflected light from the headlights of vehicles behind can be reduced by operating the lever.

- ① Normal position
- ② Anti-glare position

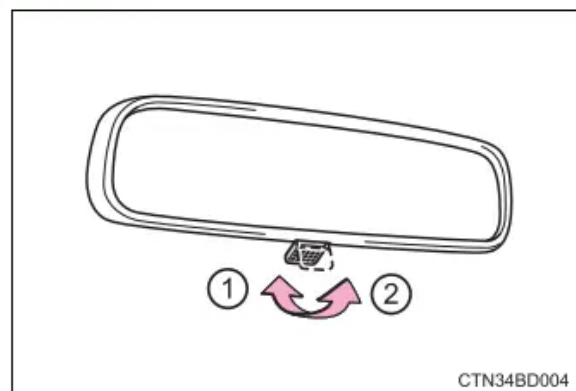

- Auto anti-glare inside rear view mirror

Responding to the level of brightness of the headlights of vehicles behind, the reflected light is automatically reduced.

Changing automatic anti-glare function mode ON/OFF

When the automatic anti-glare function is in ON mode, the indicator illuminates.

The function will set to ON mode each time the engine switch is turned to IGNITION ON mode.

Pressing the button turns the function to OFF mode. (The indicator also turns off.)

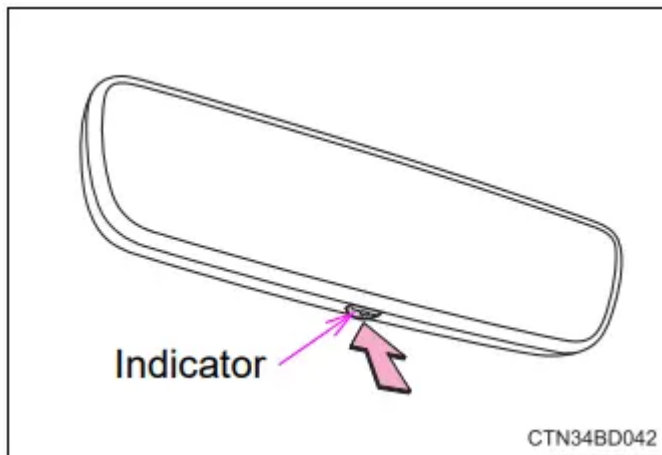

**To prevent sensor error (vehicles with an auto anti-glare inside rear view mirror)**

To ensure that the sensors operate properly, do not touch or cover them.

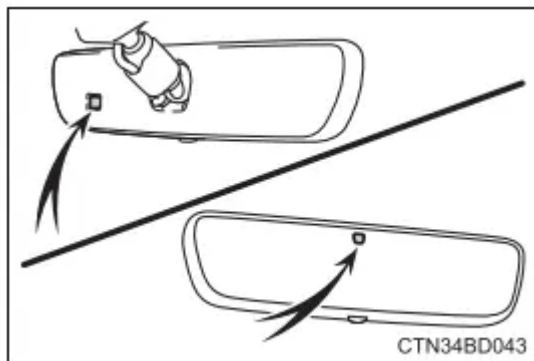

## Outside rear view mirrors

### Adjustment procedure

1. To select a mirror to adjust, turn the switch.

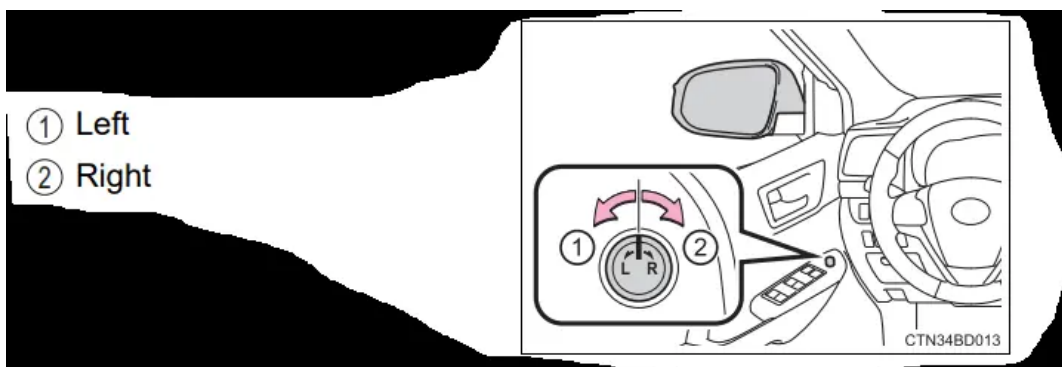

2. To adjust the mirror, move the switch.

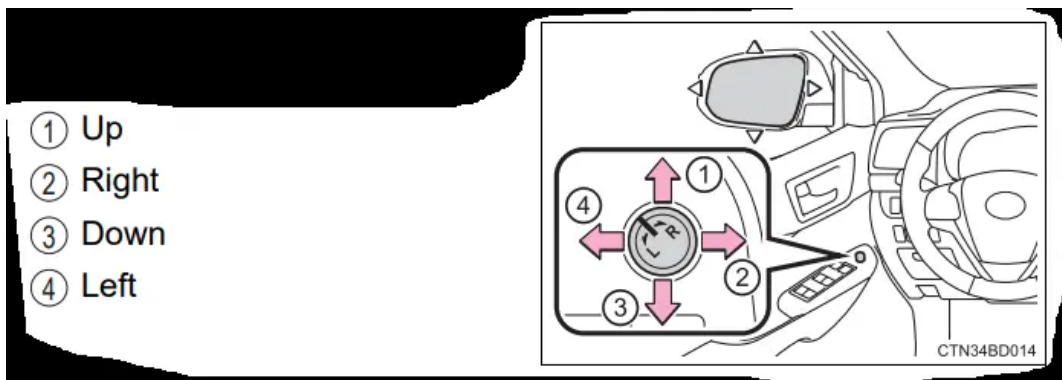

### Folding the mirrors

Push the mirror back in the direction of the vehicle's rear.

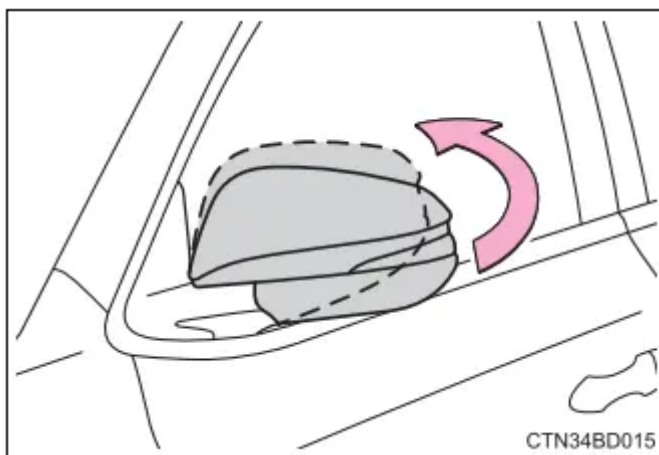

### ***Mirror angle can be adjusted when***

- Vehicles without a smart key system

The engine switch is in the “ACC” or “ON” position.

- Vehicles with a smart key system

The engine switch is in ACCESSORY or IGNITION ON mode.

### ***When the mirrors are fogged up***

The outside rear view mirrors can be cleared using the mirror defoggers. Turn on the rear window defogger to turn on the outside rear view mirror defoggers.

### ***Automatic adjustment of the mirror angle (if equipped)***

A desired mirror face angle can be entered to memory and recalled automatically by the driving position memory

## Driving procedures

### Engine (ignition) switch (vehicles without a smart key system)

#### Starting the engine

1. Check that the parking brake is set.
2. Check that the shift lever is set in P.
3. Firmly depress the brake pedal.
4. Turn the engine switch to the "START" position and start the engine.

#### Changing the engine switch positions

##### 1. "LOCK"

The steering wheel is locked and the key can be removed. (The key can be removed only when the shift lever is in P.)

##### 2. "ACC"

Some electrical components such as the power outlet can be used.

##### 3. "ON"

All electrical components can be used.

##### 4. "START"

For starting the engine.

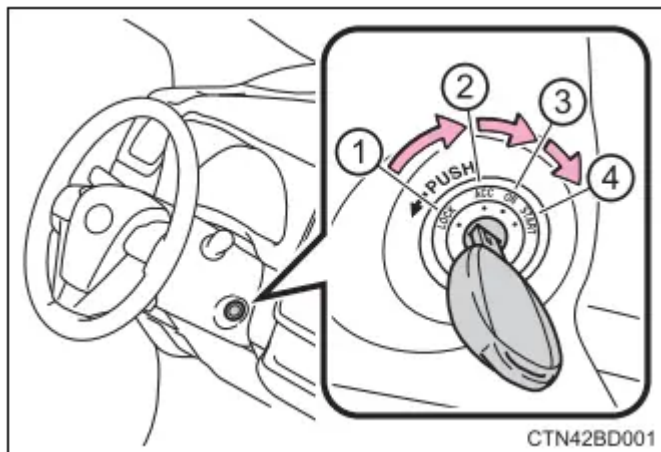

#### Turning the key from "ACC" to "LOCK"

1. Shift the shift lever to P.
2. Push in the key and turn it to the "LOCK" position

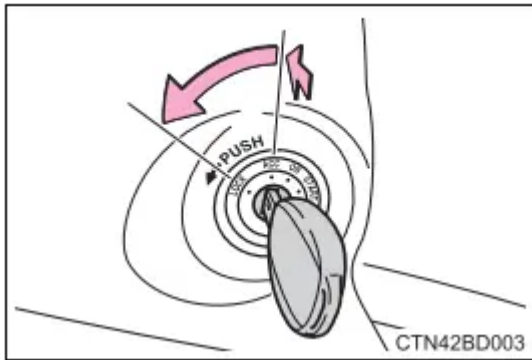

***If the engine does not start***

The engine immobilizer system may not have been deactivated. (P. 86) Contact your Toyota dealer

***When the steering lock cannot be released***

When starting the engine, the engine switch may seem stuck in the “LOCK” position. To free it, turn the key while turning the steering wheel slightly left and right.

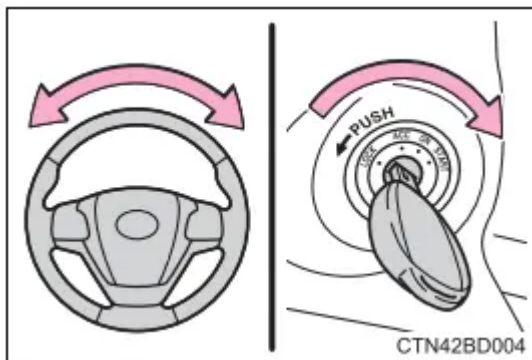

***Key reminder function***

A buzzer sounds if the driver’s door is opened while the engine switch is in the “LOCK” or “ACC” position to remind you to remove the key

**Engine (ignition) switch (vehicles with a smart key system)**

Performing the following operations when carrying the electronic key on your person starts the engine or changes engine switch modes.

**Starting the engine**

1. Check that the parking brake is set.
2. Check that the shift lever is set in P.
- 3.



Firmly depress the brake pedal. and a message will be displayed on the multi-information display. If it is not displayed, the engine cannot be started.



4. Press the engine switch shortly and firmly.

When operating the engine switch, one short, firm press is enough. It is not necessary to press and hold the switch.

The engine will crank until it starts or for up to 30 seconds, whichever is less.

Continue depressing the brake pedal until the engine is completely started.

The engine can be started from any engine switch mode.



### Stopping the engine

1. Stop the vehicle.
2. Set the parking brake (P. 240), and shift the shift lever to P.
3. Press the engine switch.
4. Release the brake pedal and check that "ACCESSORY" or "IGNITION ON" on the multi-information display is off.

### Changing engine switch modes

Modes can be changed by pressing the engine switch with brake pedal released. (The mode changes each time the switch is pressed.)

1. "Off"

The emergency flashers can be used.

The multi-information display will not be displayed.

2. ACCESSORY mode

Some electrical components such as the power outlet can be used.

"ACCESSORY" will be displayed on the multi-information display.

### 3. IGNITION ON mode

All electrical components can be used.

"IGNITION ON" will be displayed on the multi-information display.

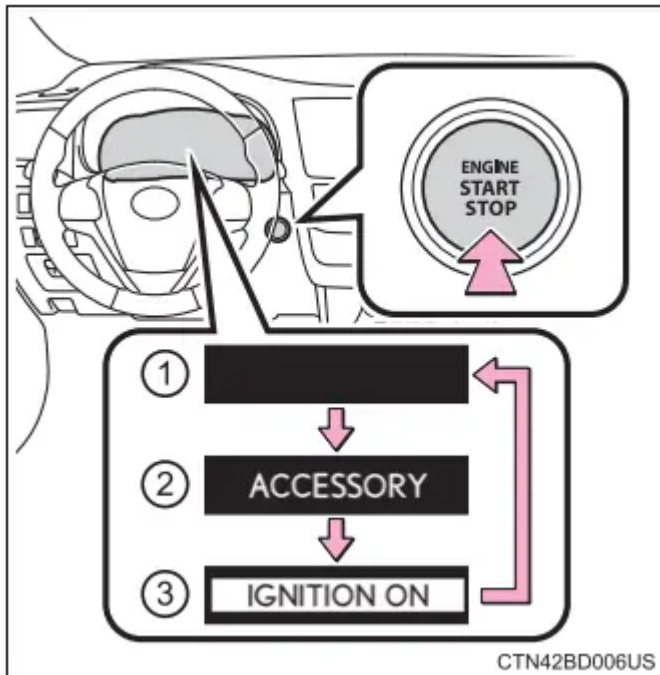

\*If the shift lever is in a position other than P when turning off the engine, the engine switch will be turned to ACCESSORY mode, not to off.

### **When stopping the engine with the shift lever in a position other than P**

If the engine is stopped with the shift lever in a position other than P, the engine switch will not be turned off but instead be turned to ACCESSORY mode. Perform the following procedure to turn the switch off:

1. Check that the parking brake is set.
2. Shift the shift lever to P.
3. Check that "Turn Power OFF" is displayed on the multi-information display and then press the engine switch once.
4. Check that "Turn Power OFF" on the multi-information display is off.

### **Message displays**

Message illustrations used in this section are intended as examples, and may differ from the image that is actually displayed on the multi-information display.

### **Auto power off function**

If the vehicle is left in ACCESSORY mode for more than 20 minutes or IGNITION ON mode (with the engine not running) for more than an hour with the shift lever in P, the engine switch will automatically turn off. However, this function cannot entirely prevent battery discharge. Do not leave the vehicle with the engine switch in ACCESSORY or IGNITION ON mode for long periods of time when the engine is not running.

### ***If the engine does not start***

- The engine immobilizer system may not have been deactivated. (P. 86) Contact your Toyota dealer.
- Check that the shift lever is securely set in P. The engine may not start if the shift lever is displaced out of P.

### ***Steering lock***

After turning the engine switch off and opening and closing the doors, the steering wheel will be locked due to the steering lock function. Operating the engine switch again automatically cancels the steering lock.

### ***When the steering lock cannot be released***

"Steering Lock active" will be displayed on the multi-information display.

Check that the shift lever is set in P. Press the engine switch while turning the steering wheel left and right.

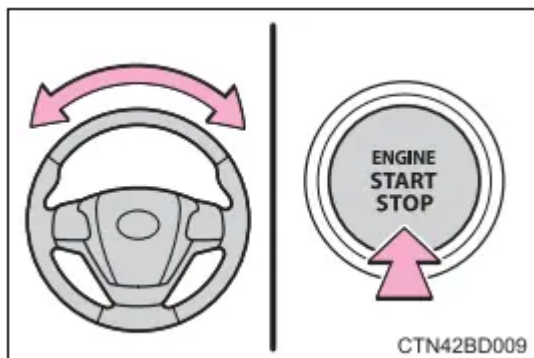

### ***Steering lock motor overheating prevention***

To prevent the steering lock motor from overheating, operation of the motor may be suspended if the engine is turned on and off repeatedly in a short period of time. In this case, refrain from operating the engine switch. After about 10 seconds, the steering lock motor will resume functioning.

### ***When "Check SMART Key System" is displayed on the multi-information display***

The system may be malfunctioning. Have the vehicle inspected by your Toyota dealer immediately.

## Operation of the engine switch

- If the switch is not pressed shortly and firmly, the engine switch mode may not change or the engine may not start.
- If attempting to restart the engine immediately after turning the engine switch off, the engine may not start in some cases. After turning the engine switch off, please wait a few seconds before restarting the engine.

## Automatic transmission

### Shifting the shift lever

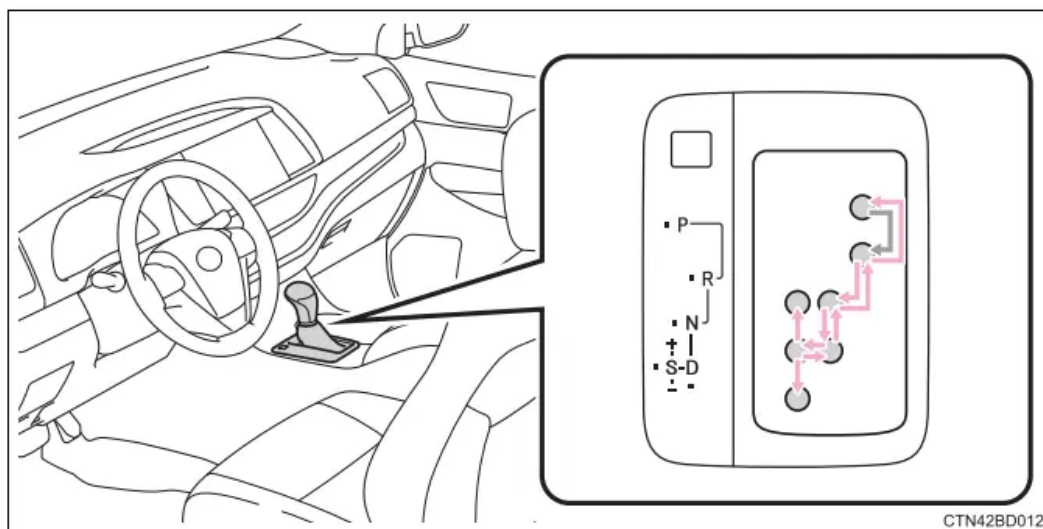

Vehicles without a smart key system:

While the engine switch is in the “ON” position, depress the brake pedal and move the shift lever.

When shifting the shift lever between P and D, make sure that the vehicle is completely stopped.

Vehicles with a smart key system:

While the engine switch is in IGNITION ON mode, depress the brake pedal and move the shift lever.

When shifting the shift lever between P and D, make sure that the vehicle is completely stopped.

### Shift position purpose

Shift position	Objective or function
P	Parking the vehicle/starting the engine
R	Reversing
N	Neutral
D	Normal driving <sup>*1</sup>
S	S mode driving <sup>*2</sup> (→P. 235)

\*1: Shifting the shift lever to D allows the system to select a gear suitable for the driving conditions. Setting the shift lever to D is recommended for normal driving.

\*2: Selecting shift ranges using S mode restricts the upper limit of the possible gear ranges, controls engine braking force, and prevents unnecessary upshifting.

## Selecting the driving mode

### **Snow mode**

Use snow mode for accelerating and driving on slippery road surfaces, such as on snow. Press the “SNOW” button to select snow mode. The “SNOW” indicator will be displayed on the multi-information display. Press the button again to cancel snow mode.

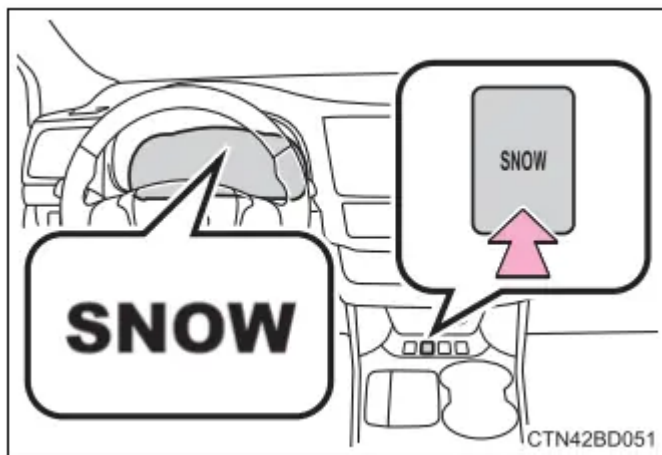

### **Power mode (if equipped)**

Use power mode for powerful acceleration or driving in mountainous regions.

1. Press “<” or “>” of the meter control switches, select .
2. Press “^” OR “v” of the meter control switches, select “PWR MODE”.

The “PWR MODE” indicator will be displayed on the multi-information display.

Select “PWR MODE” again to cancel power mode

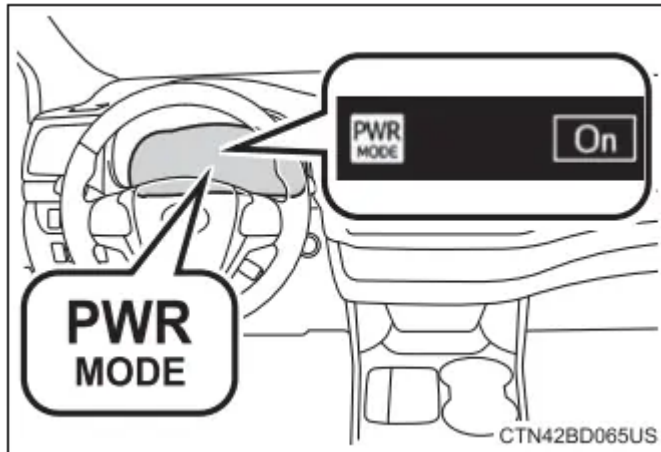

**Selecting shift ranges in the S position**

To enter S mode, shift the shift lever to S. Shift ranges can be selected by operating the shift lever, allowing you to drive in the shift range of your choosing. The shift range can be selected by the shift lever.

- ① Upshifting
- ② Downshifting



8-speed models: The selected shift range, from 1 to 8, will be displayed on the multi-information display.

The initial shift range in S mode is set automatically to 6, 5 or 4 according to vehicle speed. However, the initial shift range may be set to 3 if AI-SHIFT has operated while the shift lever was in D. (P. 240)



6-speed models: The selected shift range, from 1 to 6, will be displayed on the multi-information display.

The initial shift range in S mode is set automatically to 5 or 4 according to vehicle speed. However, the initial shift range may be set to 3 if AI-SHIFT has operated while the shift lever was in D.

**Shift ranges and their functions**

Meter display	Function
S2 - S8 (8-speed models)	A gear in the range between 1 and the selected gear is automatically chosen depending on vehicle speed and driving conditions
S2 - S6 (6-speed models)	
S1	Setting the gear at 1

A lower shift range will provide greater engine braking forces than a higher shift range.

**Message displays**

Message illustrations used in this section are intended as examples, and may differ from the image that is actually displayed on the multi-information display.

**S mode**

- 8-speed models: When the shift range is 7 or lower, holding the shift lever toward “+” sets the shift range to 8.
- 6-speed models: When the shift range is 5 or lower, holding the shift lever toward “+” sets the shift range to 6.
- To prevent excessive engine speed, a function was adopted that automatically selects a higher shift range before engine speed becomes too high.
- To protect the automatic transmission, a function is adopted that automatically selects a higher shift range when the fluid temperature is high.

**Downshifting restrictions warning buzzer**

To help ensure safety and driving performance, downshifting operation may sometimes be restricted. In some circumstances, downshifting may not be possible even when the shift lever is operated. (A buzzer will sound twice.)

**Deactivation of snow mode**

Snow mode will be canceled if the engine is turned off after driving in snow mode.

**Deactivation of power mode (if equipped)**

Power mode will be canceled if the engine is turned off after driving in power mode.

**If both snow mode and power mode (if equipped) are selected**



Snow mode will be selected and power mode will be suspended until snow mode is canceled.

### ***When driving with dynamic radar cruise control activated***

Even when performing the following actions with the intent of enabling engine braking, engine braking will not activate while driving in S mode and downshifting to 5 or 4 because dynamic radar cruise control will not be canceled.

### ***Shift lock system***

The shift lock system is a system to prevent accidental operation of the shift lever in starting.

The shift lever can be shifted from P only when the engine switch is in the "ON" position (vehicles without a smart key system) or IGNITION ON mode (vehicles with a smart key system) and the brake pedal is being depressed.

### ***If the shift lever cannot be shifted from P***

First, check whether the brake pedal is being depressed.

If the shift lever cannot be shifted with your foot on the brake pedal, there may be a problem with the shift lock system. Have the vehicle inspected by your Toyota dealer immediately.

The following steps may be used as an emergency measure to ensure that the shift lever can be shifted.

Releasing the shift lock:

1. Set the parking brake.
2. Vehicles without a smart key system: Turn the engine switch to the "LOCK" position.  
Vehicles with a smart key system: Turn the engine switch off.
3. Depress the brake pedal.
4. Pry the cover up with a flathead screwdriver or equivalent tool. To prevent damage to the cover, cover the tip of the screwdriver with a rag.
5. Press the shift lock override button. The shift lever can be shifted while the button is pressed

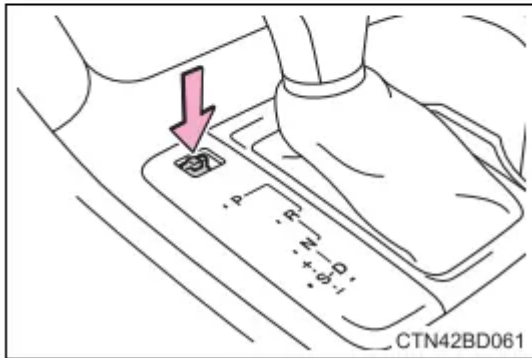
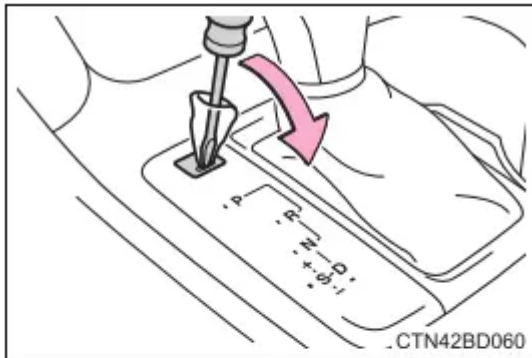

***If the S indicator does not come on or the D indicator is displayed even after shifting the shift lever to S***

This may indicate a malfunction in the automatic transmission system. Have the vehicle inspected by your Toyota dealer immediately.

(In this situation, the transmission will operate in the same manner as when the shift lever is in D.)

***If the automatic transmission fluid temperature warning message is displayed***

If the automatic transmission fluid temperature warning message is displayed while driving, make sure to return to D position driving and reduce speed by easing off the accelerator pedal. Stop the vehicle in a safe place, shift the shift lever to P and let the engine idle until the warning message goes out.

When the warning message goes out, the vehicle can be driven again. If the warning message does not go out after waiting a while, have your vehicle inspected by your Toyota dealer.

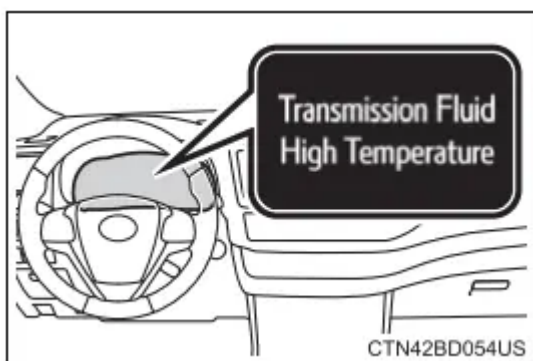

## AI-SHIFT

The AI-SHIFT automatically selects the suitable gear according to driver performance and driving conditions. The AI-SHIFT automatically operates when the shift lever is in D. (Shifting the shift lever to S cancels the function.)

## Turn signal lever

### Operating instructions

1. Right turn
2. Lane change to the right (move the lever partway and release it) The right hand signals will flash 3 times.
3. Lane change to the left (move the lever partway and release it) The left hand signals will flash 3 times.
4. Left turn



### Turn signals can be operated when

- Vehicles without a smart key system

The engine switch is in the "ON" position.

- Vehicles with a smart key system

The engine switch is in IGNITION ON mode.

### If the indicator flashes faster than usual

Check that a light bulb in the front or rear turn signal lights has not burned out.

## Customization

The number of times the turn signals flash during a lane change can be changed.

## Parking brake

### Operating instructions

To set the parking brake, fully depress the parking brake pedal with your left foot while depressing the brake pedal with your right foot. (Depressing the pedal again releases the parking brake.)

\*1: For U.S.A.

\*2: For Canada

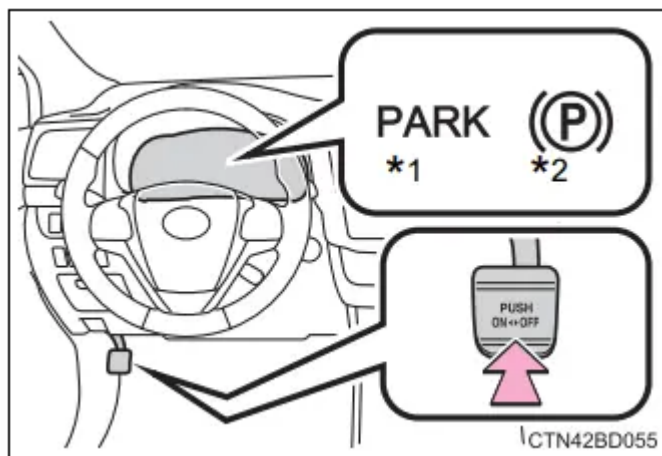

## Driving tips

### Winter driving tips

Carry out the necessary preparations and inspections before driving the vehicle in winter. Always drive the vehicle in a manner appropriate to the prevailing weather conditions

### Preparation for winter

Use fluids that are appropriate to the prevailing outside temperatures.

- Engine oil
- Engine coolant
- Washer fluid

Have a service technician inspect the condition of the battery.

Have the vehicle fitted with four snow tires or purchase a set of tire chains for the front tires.

Ensure that all tires are the same size and brand, and that chains match the size of the tires.

### Before driving the vehicle

Perform the following according to the driving conditions:

- Do not try to forcibly open a window or move a wiper that is frozen. Pour warm water over the frozen area to melt the ice. Wipe away the water immediately to prevent it from freezing.
- To ensure proper operation of the climate control system fan, remove any snow that has accumulated on the air inlet vents in front of the windshield.
- Check for and remove any excess ice or snow that may have accumulated on the exterior lights, vehicle's roof, chassis, around the tires or on the brakes.
- Remove any snow or mud from the bottom of your shoes before getting in the vehicle.

### When driving the vehicle

Accelerate the vehicle slowly, keep a safe distance between you and the vehicle ahead, and drive at a reduced speed suitable to road conditions.

### When parking the vehicle

- Park the vehicle and move the shift lever to P without setting the parking brake. The parking brake may freeze up, preventing it from being released. If the vehicle is parked without setting the parking brake, make sure to block the wheels. Failure to do so may be dangerous because it may cause the vehicle to move unexpectedly, possibly leading to an accident.
- If the vehicle is parked without setting the parking brake, confirm that the shift lever cannot be moved out of P

### Selecting tire chains

Use the correct tire chain size when mounting the snow chains. Chain size is regulated for each tire size.

#### Side chain:

- ① 0.12 in. (3 mm) in diameter
- ② 0.39 in. (10 mm) in width
- ③ 1.18 in. (30 mm) in length

#### Cross chain:

- ④ 0.16 in. (4 mm) in diameter
- ⑤ 0.55 in. (14 mm) in width
- ⑥ 0.98 in. (25 mm) in length

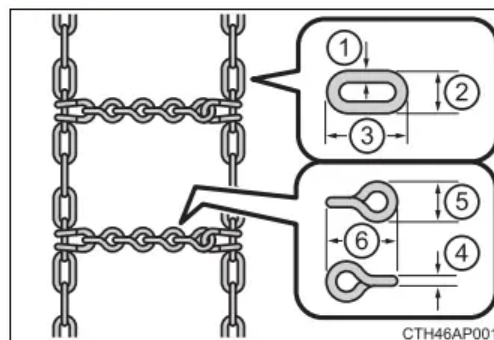

### Regulations on the use of tire chains

Regulations regarding the use of tire chains vary depending on location and type of road. Always check local regulations before installing chains.

## ***Tire chain installation***

Observe the following precautions when installing and removing chains:

- Install and remove tire chains in a safe location.
- Install tire chains on the front tires. Do not install tire chains on the rear tires.
- Install tire chains on front tires as tightly as possible. Retighten chains after driving 1/4 - 1/2 mile (0.5 - 1.0 km).
- Install tire chains following the instructions provided with the tire chains.

## **Utility vehicle precautions**

This vehicle belongs to the utility vehicle class, which has higher ground clearance and narrower tread in relation to the height of its center of gravity

### **Utility vehicle feature**

- Specific design characteristics give it a higher center of gravity than ordinary passenger cars. This vehicle design feature causes this type of vehicle to be more likely to rollover. And, utility vehicles have a significantly higher rollover rate than other types of vehicles.
- An advantage of the higher ground clearance is a better view of the road allowing you to anticipate problems.
- It is not designed for cornering at the same speeds as ordinary passenger cars any more than low-slung sports cars are designed to perform satisfactorily under off-road conditions. Therefore, sharp turns at excessive speeds may cause the vehicle to rollover.

### **Off-road driving**

Your vehicle is not designed to be driven off-road. However, in the event that off-road driving cannot be avoided, please observe the following precautions to help avoid the areas prohibited to vehicles.

- Drive your vehicle only in areas where off-road vehicles are permitted to travel.
- Respect private property. Get owner's permission before entering private property.
- Do not enter areas that are closed. Honor gates, barriers and signs that restrict travel.
- Stay on established roads. When conditions are wet, driving techniques should be changed or travel delayed to prevent damage to roads.
- AWD models: Avoid driving on very steep, slippery roads and other surfaces, such as sand, where the tires are liable to lose traction. Your vehicle may not perform as well as conventional AWD on-road vehicles on these surfaces.

### **Additional information for off-road driving**

For owners in U.S. mainland, Hawaii and Puerto Rico:

To obtain additional information pertaining to driving your vehicle off-road, consult the following organizations.

- State and Local Parks and Recreation Departments
- State Motor Vehicle Bureau
- Recreational Vehicle Clubs
- U.S. Forest Service and Bureau of Land Management

## **Maintenance and care**

### **Cleaning and protecting the vehicle exterior**

**Perform the following to protect the vehicle and maintain it in prime condition:**

- Working from top to bottom, liberally apply water to the vehicle body, wheel wells and underside of the vehicle to remove any dirt and dust.
- Wash the vehicle body using a sponge or soft cloth, such as a chamois.
- For hard-to-remove marks, use car wash soap and rinse thoroughly with water.
- Wipe away any water.
- Wax the vehicle when the waterproof coating deteriorates.

If water does not bead on a clean surface, apply wax when the vehicle body is cool.

#### ***Automatic car washes***

- Before washing the vehicle:
  - Fold the mirrors.
  - Turn off the power back door (if equipped). Start washing from the front of the vehicle. Make sure to extend the mirrors before driving.
- Brushes used in automatic car washes may scratch the vehicle surface and harm your vehicle's paint.

#### ***High pressure car washes***

- Do not allow the nozzles of the car wash to come within close proximity of the windows.
- Before using the car wash, check that the fuel filler door on your vehicle is closed properly

#### ***When using a car wash (vehicles with a smart key system)***

If the door handle becomes wet while the electronic key is within the effective range, the door may lock and unlock repeatedly. In that case, follow the following correction procedures to wash the vehicle:

- Place the key in a position 6 ft. (2 m) or more separate from the vehicle while the vehicle is being washed. (Take care to ensure that the key is not stolen.)
- Set the electronic key to battery-saving mode to disable the smart key system. ( P. 149)

### **Aluminum wheels**

- Remove any dirt immediately by using a neutral detergent.
- Wash detergent off with water immediately after use.
- To protect the paint from damage, make sure to observe the following precautions.
  - Do not use acidic, alkaline or abrasive detergent
  - Do not use hard brushes
  - Do not use detergent on the wheels when they are hot, such as after driving or parking in hot weather

### **Bumpers**

Do not scrub with abrasive cleaners

## **Cleaning and protecting the vehicle interior**

The following procedures will help protect your vehicle's interior and keep it in top condition:

### **Protecting the vehicle interior**

- Remove dirt and dust using a vacuum cleaner. Wipe dirty surfaces with a cloth dampened with lukewarm water.
- If dirt cannot be removed, wipe it off with a soft cloth dampened with neutral detergent diluted to approximately 1%. Wring out any excess water from the cloth and thoroughly wipe off remaining traces of detergent and water

### **Cleaning the leather areas**

- Remove dirt and dust using a vacuum cleaner.
- Wipe off any excess dirt and dust with a soft cloth dampened with diluted detergent. Use a diluted water solution of approximately 5% neutral wool detergent.
- Wring out any excess water from the cloth and thoroughly wipe off all remaining traces of detergent.
- Wipe the surface with a dry, soft cloth to remove any remaining moisture. Allow the leather to dry in a shaded and ventilated area.

## **Cleaning the synthetic leather areas**

- Remove dirt and dust using a vacuum cleaner.
- Wipe it off with a soft cloth dampened with neutral detergent diluted to approximately 1%.
- Wring out any excess water from the cloth and thoroughly wipe off remaining traces of detergent and water

## ***Caring for leather areas***

Toyota recommends cleaning the interior of the vehicle at least twice a year to maintain the quality of the vehicle's interior.

## ***Shampooing the carpets***

There are several commercial foaming-type cleaners available. Use a sponge or brush to apply the foam. Rub in overlapping circles. Do not use water.

Wipe dirty surfaces and let them dry. Excellent results are obtained by keeping the carpet as dry as possible.

## ***Seat belts***

Clean with mild soap and lukewarm water using a cloth or sponge. Also check the belts periodically for excessive wear, fraying or cuts

## **Troubleshooting**

If you have a problem, check the following before contacting your Toyota dealer.

### **The doors cannot be locked, unlocked, opened or closed**

#### **You lose your keys**

- If you lose your keys or mechanical keys, new genuine keys or mechanical keys can be made by your Toyota dealer.
- If you lose your keys or electronic keys, the risk of vehicle theft increases significantly. Contact your Toyota dealer immediately.

#### **The doors cannot be locked or unlocked**

- Is the key battery weak or depleted?
- Vehicles with a smart key system:
  - Is the engine switch in IGNITION ON mode?
  - When locking the doors, turn the engine switch off.
- Vehicles with a smart key system:
  - Is the electronic key left inside the vehicle?

- When locking the doors, make sure that you have the electronic key on your person.
- The function may not operate properly due to the condition of the radio wave.

### **The rear door cannot be opened**

- Is the child-protector lock set?
  - The rear door cannot be opened from inside the vehicle when the lock is set. Open the rear door from outside and then unlock the child-protector lock.

### **If you think something is wrong**



#### **The engine does not start (vehicles without a smart key system)**

- Is the shift lever in P?
- Is the steering wheel unlocked?
- Is the battery discharged?



#### **The engine does not start (vehicles with a smart key system)**

- Did you press the engine switch while firmly depressing the brake pedal?
- Is the shift lever in P?
- Is the electronic key anywhere detectable inside the vehicle?
- Is the steering wheel unlocked?
- Is the electronic key battery weak or depleted? In this case, the engine can be started in a temporary way.
- Is the battery discharged?



#### **The shift lever cannot be shifted from P even if you depress the brake pedal**

- Vehicles without a smart key system: Is the engine switch in the “ON” position?
  - If you cannot release the shift lever by depressing the brake pedal with the engine switch in the “ON” position.
- Vehicles with a smart key system: Is the engine switch in IGNITION ON mode?
  - If you cannot release the shift lever by depressing the brake pedal with the engine switch in IGNITION ON mode.



### **The steering wheel cannot be turned after the engine is stopped**

- Vehicles without a smart key system: It is locked to prevent theft of the vehicle if the key is pulled from the engine switch.
- Vehicles with a smart key system: It is locked automatically to prevent theft of the vehicle.



### **The windows do not open or close by operating the power window switches**

- Is the window lock switch pressed? The power window except for the one at the driver's seat cannot be operated if the window lock switch is pressed



### **The engine switch is turned off automatically (vehicles with a smart key system)**

- The auto power off function will be operated if the vehicle is left in ACCESSORY or IGNITION ON mode (with the engine not running) for a period of time.



### **A warning buzzer sounds during driving**

- The seat belt reminder light is flashing
  - Are the driver and the passengers wearing the seat belts?
- The parking brake indicator is on
  - Is the parking brake released?
    - Depending on the situation, other types of warning buzzer may also sound.



### **An alarm is activated and the horn sounds (vehicles with an alarm)**

- Did anyone inside the vehicle open a door during setting the alarm? The sensor detects it and the alarm sounds.

Vehicles without a smart key system:

To stop the alarm, turn the engine switch to the "ON" position or start the engine.

Vehicles with a smart key system:

To stop the alarm, turn the engine switch to IGNITION ON mode or start the engine.



**A warning buzzer sounds when leaving the vehicle (vehicles with a smart key system)**

- Is the electronic key left inside the vehicle or the moon roof or panoramic moon roof open? Check the message on the multi-information display.



**A warning light turns on or a warning message or indicator is displayed**

- When a warning light turns on or a warning message or indicator is displayed, refer to P. 583, 593

## When a problem has occurred



**If you have a flat tire**

- Stop the vehicle in a safe place and replace the flat tire with the spare tire.



**The vehicle becomes stuck**

- Try the procedure for when the vehicle becomes stuck in mud, dirt, or snow

### Warning

This content is compiled from multiple sources and is provided for reference purposes only. It may not be complete or fully applicable to all situations. If you are unable to resolve your issue, please contact the product manufacturer or an authorized service provider for official support.