

CONTROL PANEL AND FEATURES

NOTES:

- Not all features and cycles are on all models.
- If your model has a touch interface, the control panel features a sensitive surface that responds to a light touch of your finger. To ensure your selections are registered, touch the control panel with your fingertip, not your fingernail. When selecting a setting or option, simply touch its name.
- If your model has physical buttons, make sure to press the button firmly.
- At cycle completion, your setting and option choices will be remembered for the next cycle. However, if power to the washer is lost, the settings and options will go back to the factory defaults.

What items Do You Want to Wash?	"What to Wash" Cycle Selection:
Cottons, linens, and mixed garment loads	Regular
No-iron fabrics, dress shirts/pants, synthetics, sheer/lacy garments	Delicates
Large items such as small comforters, sleeping bags, jackets, and washable rugs	Bulky Items
White fabrics/garments	Whites
Bright- or dark-colored cottons, linens, and mixed loads	Colors
Sturdy towels and washcloths	Towels

How Do You Want to Wash Them?	"How to Wash" Cycle Selection:
Regular/Normal	Normal
With fewer wrinkles	Wrinkle Control
Intense Cleaning	Heavy Duty
Eliminate 99.9% of three common household bacteria	Sanitize* (with Oxi –on some models)
Gentle cleaning with cold water	Cold Wash
Fast	Quick

POWER

- Select to turn the washer on and off. Select to stop/cancel a cycle at any time.

WHAT TO WASH/HOW TO WASH

- First determine what items are in the load that you are trying to wash. Use that to guide your "What to Wash" selection.
- Then determine how you want the washer to wash them and make the appropriate "How to Wash" selection.
- See "Cycle Guide" for cycle details. If you do not make a
- "How to Wash" selection, the washer will automatically select the recommended or last-used "How to Wash" cycle.

START/PAUSE

- Touch and hold for 3 seconds until the light above Start/
- Pause comes on to start a cycle, or touch once while a cycle is in process to pause it.

CYCLE STATUS DISPLAY

1. The Cycle Status Display shows the progress of a cycle.
2. At each stage of the process, you may notice sounds or pauses that are different from traditional washers.

Estimated Time Remaining

- The Estimated Time Remaining shows the time required for the cycle to complete. Factors such as load size, modifiers, options selected, and water pressure may affect the time shown in the display.
- Tightly packed loads, unbalanced loads, or excessive suds may cause the washer to lengthen the cycle time as well.

Sensing

- When Start/Pause is touched the washer will chime, indicating it is starting. The drum will make a partial turn.

The door will click when it locks.

- Once the door has locked, the washer will begin spinning to sense the load size. This sensing process will continue throughout the cycle.
- After the load size is sensed, the estimated time based on load size will be displayed and water will be added.
- You may hear water flowing through the dispenser, adding detergent to the load. The actual cycle time may be lengthened; however, the display will continue to show the estimated time
- During the wash cycle, this will display to let you know the cycle is in progress.

Drying (on some models)

- During a drying cycle, this will display to let you know the drying cycle is in progress.

Cool Down (on some models)

- At the end of a drying cycle, your load will go through a cool-down period.

PreSoak

- This symbol will be displayed to let you know a presoak is in progress.

Detergent Low (on some models)

- When detergent in the bulk dispenser is running low, the display will show the detergent level (Low).

Add Garment

1. When “Add Garment” is displayed, you may pause the washer, open the door, and add items. Touch and hold
2. START/PAUSE to start the washer again.

Door Locked

- The Door Locked symbol will display to indicate that the door is locked and cannot be opened without first pausing or canceling the cycle.

Control Lock

1. When the Control Lock symbol is displayed, the buttons are disabled. Touch and hold EXTRA
2. RINSE for 3 seconds to enable the buttons.
3. FanFresh® (on some models)
4. This symbol will be displayed when the FanFresh® option is activated. The fan will turn on and the load will tumble periodically for up to 12 hours.

End

- Once the cycle is complete, “End” will display. Remove the load promptly for best results.

CYCLE MODIFIERS

1. When you select a cycle, its default settings will light up.
2. Touch to adjust cycle modifiers on the washer before touching START/PAUSE. Additional wash modifiers or options selected after touching Start/Pause may not activate.
3. Once a wash setting is selected, it is saved for the cycle selected. To return to factory default cycle settings, unplug washer for 30 seconds; then plug back in. See “Cycle Guide” for default cycle settings.

NOTE:

- Some modifiers may increase or decrease the estimated time remaining.

Temp

1. The recommended wash temperature is preset for each cycle. Some preset temperatures can be changed.
2. You may select a different wash temperature based on the level of soil and type of fabric being washed.

3. For best results, use the warmest wash water safe for your fabric, following the garment label instructions. All wash temperatures feature a cold rinse.

Spin

1. The recommended spin speed is preset for each cycle.
2. Some preset speeds can be changed.
3. Faster spin speeds mean shorter dry times, but may increase wrinkling in your load.
4. Slower spin speeds reduce wrinkling, but will leave your load more damp.

Soil

1. The recommended soil level is preset for each cycle.
2. Some preset soil levels can be changed. For heavily soiled and sturdy fabrics, select the Heavy Soil Level setting. For lightly soiled and delicate fabrics, select the
3. Light Soil Level setting. Lower soil level settings will help reduce tangling and wrinkling.
hold 3 sec for
4. Cycle Signal hold 3 sec for
5. Control Lock hold 3 sec for
6. FanFresh hold 3 sec for

UTILITY CYCLES

Clean Washer

1. Use this every 30 washes to keep the inside of your washer fresh and clean. This cycle uses a higher water level.
2. Use with affresh® Washer Cleaner tablets or liquid chlorine bleach to thoroughly clean the inside of your washer. When using this cycle, the drum should be empty. This cycle should not be interrupted. See the
3. Washer Care” section.

Drain & Spin

1. This cycle removes excess water from the load or special-care items washed by hand. Use this cycle after a power failure.
2. For some fabrics, you may choose to set a slower spin speed. On some models: Touch and hold DRAIN & SPIN for 3 seconds to set a Dry Only cycle.

CYCLE OPTIONS

- You may add or remove options for each cycle. Not all options can be used with all cycles, and some are preset to work with certain cycles. Options vary by model.

Steam Clean (on some models)

- The Steam Clean option adds additional soak and wash time to many cycles to help remove tough stains, as well as a steam boost for added cleaning power.
- An integrated heater helps to maintain optimal wash temperatures. See “Cycle Guide” for cycles that allow the Steam Clean option.
- You can also touch and hold STEAM CLEAN for 3 seconds to turn cycle signals on or off.

Extra Rinse

- Activate this option to add an extra rinse to most cycles.
- You can also touch and hold EXTRA RINSE for 3 seconds to disable/enable the Control Lock.

Wash & Dry (on some models)

- Touch to add a drying cycle to your load after the wash cycle has finished. The Wash & Dry option is designed to wash and dry small loads overnight.
- Cycle time will vary based on load composition. For optimal dry performance and cycle time, load the drum no more than one-quarter full. The cycle will automatically terminate after a maximum 12-hour cycle time.
- You can also touch and hold WASH & DRY for seconds to activate/deactivate the FanFresh® option. Use the FanFresh® option if you will be unable to remove the load promptly. The washer will automatically activate the fan after the cycle ends and tumble the load periodically for up to 12 hours.

IMPORTANT:

- Do not use dryer sheets.
- Do not dry comforters or large blankets.

Load & Go™ (on some models)

- Touch to select this option If you want to automatically add HE detergent to the wash load at the proper time.

IMPORTANT:

1. When using the dispenser cartridge with concentrated liquid detergent, be sure to change the detergent concentration settings in the control if the detergent used is different than factory preset of x concentration.
2. Change the detergent concentration setting by touching and holding TEMP and SOIL for seconds.
3. You can also touch and hold LOAD & GO™ for 3 seconds to set a presoak.

PreSoak (on some models)

- Touch to add a presoak time of your choice to a wash cycle.
- Load & Go™ Bulk Dispenser (only on some models – varies by model)
- The Load & Go™ bulk dispenser gives you the convenience of not having to add the HE detergent to the wash load every time. It also determines the best amount of detergent and the best time to add it to the load. See the “Using the
- Dispensers” section for information on using the dispenser drawer.

Single Load Dispenser Drawer

- The single load dispenser drawer gives you the convenience of adding HE detergent, liquid chlorine bleach, and liquid fabric softener to the wash load at the proper time. See the “Using the Dispensers” section for information on using the dispenser drawer.

A 2-Liter Bulk Liquid High Efficiency (HE) detergent dispenser

- This bulk dispenser holds up to 67.6 oz (2 L) of liquid HE detergent.

B 1-Liter Bulk Liquid High Efficiency (HE) detergent dispenser

- This bulk dispenser holds up to 33.8 oz (1 L) of liquid HE detergent.
- Each dispenser holds enough detergent for many loads of laundry. Each adds the appropriate quantity of HE detergent to the wash load at the proper time. See the
- Using the Dispensers” section for information on using the dispenser.

IMPORTANT:

- Do not use chlorine bleach or powdered detergent in the bulk dispenser. Powdered detergent must be added to the single load dispenser. See the “Using the

Washer” section.

C High Efficiency (HE) detergent compartment

- This compartment holds liquid or powdered HE detergent for your main wash cycle, and automatically dispenses detergent in the cycle.

D Liquid fabric softener compartment

- This compartment holds liquid fabric softener. It automatically dispenses liquid fabric softener at the optimum time in the cycle.

E Liquid chlorine bleach compartment

- This compartment automatically dilutes and dispenses liquid chlorine bleach at the optimum time during the first rinse after the wash cycle. It cannot dilute powdered bleach.

CYCLE GUIDE

- You can use this washer to wash only or to wash and dry. This washer has a unique user interface to help you select the best cycle for your load. The “What to Wash” “How to Wash” layout guides you to the optimal cycle in two easy steps:
- First determine what items are in the load that you are trying to wash. Use that to guide your “What to Wash” selection. Then determine how you want the washer to wash them and select the appropriate “How to Wash” selection.
- Selecting “What to Wash” will automatically select a default “How to Wash selection,” so selecting a “How to Wash” is optional. See chart below for more details

What	How	Basic Settings			Additional Options				
		Temp	Spin	Soil	Steam Clean	Extra Rinse	PreSoak	Wash & Dry	Load & Go™
Regular	Normal	Hot Very Warm Warm Cool Cold	Fast Medium Fast Medium Off	Light Normal Heavy	X	X	X	X	X
	Wrinkle Control	Hot Very Warm Warm Cool Cold	Fast Medium Fast Medium Slow Off	Light Normal Heavy	X	X	X	X	X
	Heavy Duty	Hot Very Warm Warm Cool Cold	Fast Medium Fast Medium Off	Light Normal Heavy	X	X	X	X	X
	Sanitize* (with Oxi – on some models)	Hot	Fast Medium Fast Medium	Light Normal Heavy	X	X		X	X
	Cold Wash	Hot Very Warm Warm Cool Cold	Fast Medium Fast Medium Off	Light Normal Heavy		X	X	X	X
	Quick	Hot Very Warm Warm Cool Cold	Fast Medium Fast Medium Off	Light Normal Heavy	X	X	X	X	X

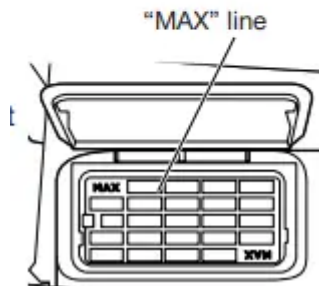
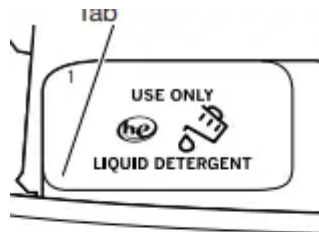

CHOOSING THE RIGHT DETERGENT

- Use only High Efficiency detergents. The package will be marked
- HE” or “High Efficiency.” Low-water washing creates excessive sudsing with a non-HE detergent. Using non-HE detergent will likely result in longer cycle times and reduced rinsing performance. It may also result in component malfunction and, over time, buildup of mold or mildew.
- HE detergents should be low-sudsing and quick-dispersing to produce the right amount of suds for the best performance.
- They should hold soil in suspension so it is not redeposited onto clean clothes. Not all detergents labeled as High Efficiency are identical in formulation and their ability to reduce suds. For example, natural, organic, or homemade HE detergents may generate a high level of suds.
- If you use one of these and see a “SUD” error code appear in the display, consider using a different HE detergent. Always follow the detergent manufacturer’s instructions to determine the amount of detergent to use.

USING THE DISPENSERS

- For automatic dispensing, open the bulk dispenser drawer using the handle at the base of the washer. For a single load, open the single load dispenser drawer at the top left corner of the washer and disable the Load & Go™ option.
- Add laundry products as described below.
- Slowly close the dispenser drawer. Make sure it is completely closed.

NOTES:

- A small amount of water may remain in the single load dispenser from the previous wash cycle. This is normal.
- See “About Detergent Concentration” for information on detergent concentration.
- On some models: When detergent in the bulk dispenser is running low, the display will show the detergent level (Low).
- Add single-dose and Oxi-type boosters to the drum before loading items. See the “Using Your Washer” section.

Load & Go™ bulk dispenser (on some models)

- Use only High Efficiency (HE) liquid detergents. The bulk dispensers will hold about 67.6 oz (2 L) or 33.8 oz (1 L) of liquid HE detergent, depending on dispenser, or enough for many loads of laundry.

To Fill Bulk Dispensers:

- Open the dispenser drawer by pulling on the handle at the base of the washer. If desired, the drawer can be completely removed from the washer.
- Locate the Load & Go™ bulk dispenser. Gently pull up on the tab located on the bulk dispenser lid to lift the fill door.
- Fill to the “MAX” line (see illustrations at right) with HE liquid detergent. Close fill door.
- It will click into place. Make sure the concentration is correct (see the “Choosing the Right Detergent” section).
- The dispensers should be rinsed out when changing detergents or when the washer will not be used for extended periods. For instructions on cleaning the dispenser cartridge, see the “Washer Care” section

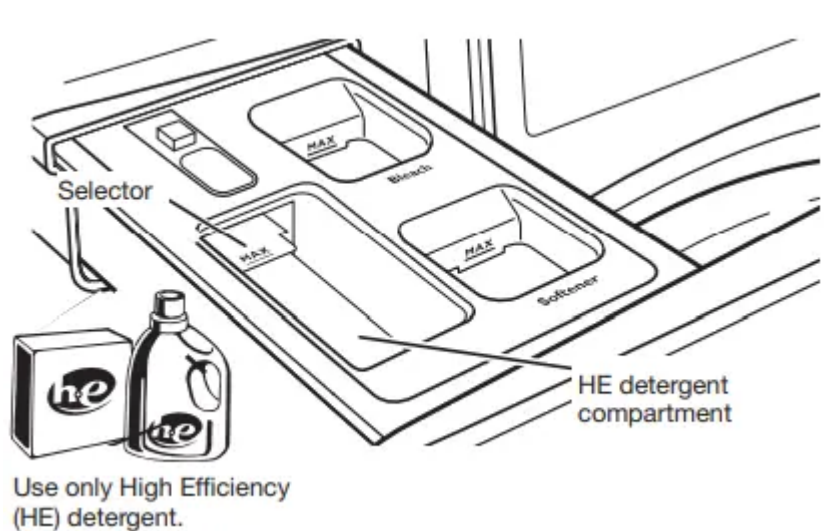

Adding detergent for a single load

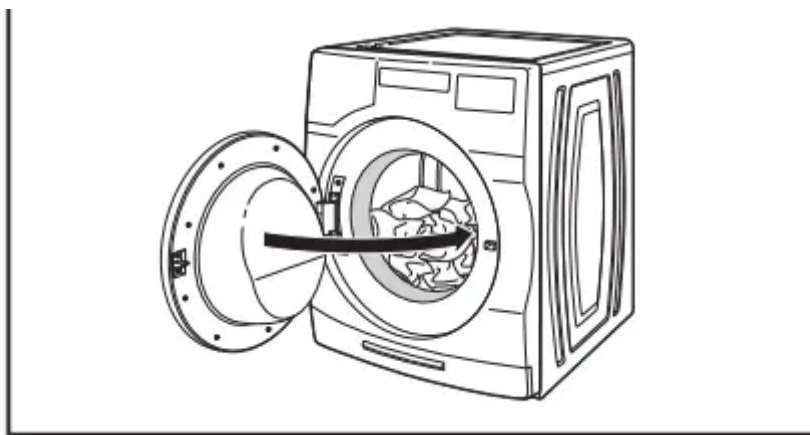

- For automatic dispensing, open the bulk dispenser drawer using the handle at the base of the washer. For a single load, open the single load dispenser drawer at the top left corner of the washer and disable the Load & Go™ option.

Add laundry products as described below.

- Slowly close the dispenser drawer. Make sure it is completely closed.

NOTES:

1. A small amount of water may remain in the single load dispenser from the previous wash cycle. This is normal.
2. See “About Detergent Concentration” for information on detergent concentration.
3. On some models: When detergent in the bulk dispenser is running low, the display will show the detergent level (Low).
4. Add single-dose and Oxi-type boosters to the drum before loading items. See the “Using Your Washer” section.

Adding HE detergent to dispenser

1. Powdered detergent:
2. Lift the selector to the high position. Add directly to the compartment. Use only High Efficiency (HE) detergent.
3. Load & Go™ bulk dispenser (on some models) Adding detergent for a single load

IMPORTANT:

1. Disable the Load & Go™ option before starting a single load.
2. Do not add single-dose laundry packet to dispenser drawer.

HE detergent compartment

- Use only High Efficiency (HE) liquid detergents. The bulk dispensers will hold about 67.6 oz
- L) or 33.8 oz (1 L) of liquid HE detergent, depending on dispenser, or enough for many loads of laundry.

To Fill Bulk Dispensers:

1. Open the dispenser drawer by pulling on the handle at the base of the washer. If desired, the drawer can be completely removed from the washer.
2. Locate the Load & Go™ bulk dispenser. Gently pull up on the tab located on the bulk dispenser lid to lift the fill door.
3. Fill to the “MAX” line (see illustrations at right) with HE liquid detergent. Close fill door.
4. It will click into place. Make sure the concentration is correct (see the “Choosing the Right Detergent” section).
5. The dispensers should be rinsed out when changing detergents or when the washer will not be used for extended periods. For instructions on cleaning the dispenser cartridge, see the “Washer Care” section.

Use only High

- Push down the selector to the low position. Add directly to the compartment.
- Pour a measured amount of HE detergent into detergent compartment. For powdered detergent, lift the selector to the high position. For liquid detergent, push down the selector to the low position.
- Do not overfill; adding too much detergent may cause detergent to be dispensed into the washer too early.

USING YOUR WASHER

Sort and prepare your laundry

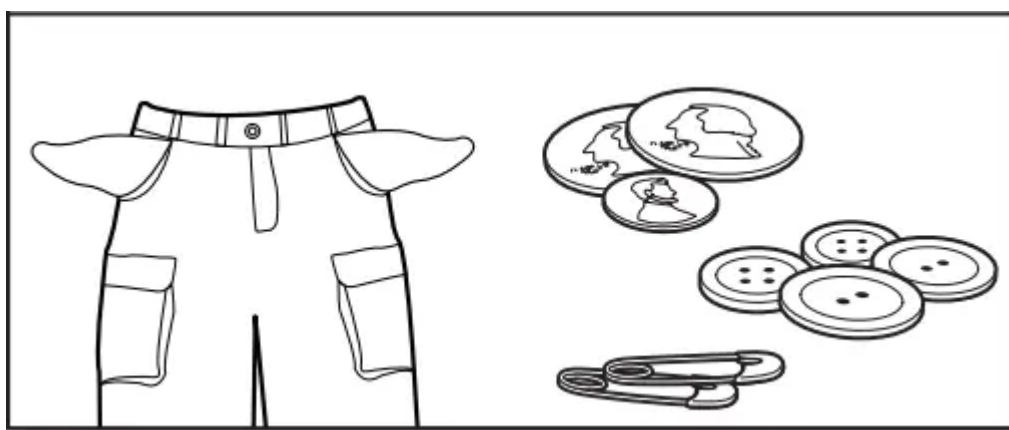

- Empty pockets. Loose change, buttons, or any small object can pass under the washplate and become trapped, causing unexpected sounds.
- Sort items by recommended cycle, water temperature, and colorfastness.
- Separate heavily soiled items from lightly soiled.
- Separate delicate items from sturdy fabrics.
- Do not dry items if stains remain after washing, because heat can set stains into fabric.
- Treat stains promptly.
- Close zippers, fasten hooks, tie strings and sashes, and remove non-washable trim and ornaments. • Mend rips and tears to avoid further damage to items during washing.

Helpful Tips:

1. For best performance, use HE liquid detergent when washing bulky items.
2. When washing water-proof or water-resistant items, load evenly. See “Cycle Guide” for tips and more information on using the Bedding cycle.
3. Use mesh garment bags to help avoid tangling when washing delicate or small items.

4. Turn knits inside out to avoid pilling. Separate lint-takers from lint-givers. Synthetics, knits, and corduroy fabrics will pick up lint from towels, rugs, and chenille fabrics. Always read and follow fabric care label instructions to avoid damage to your garments.

Add laundry products

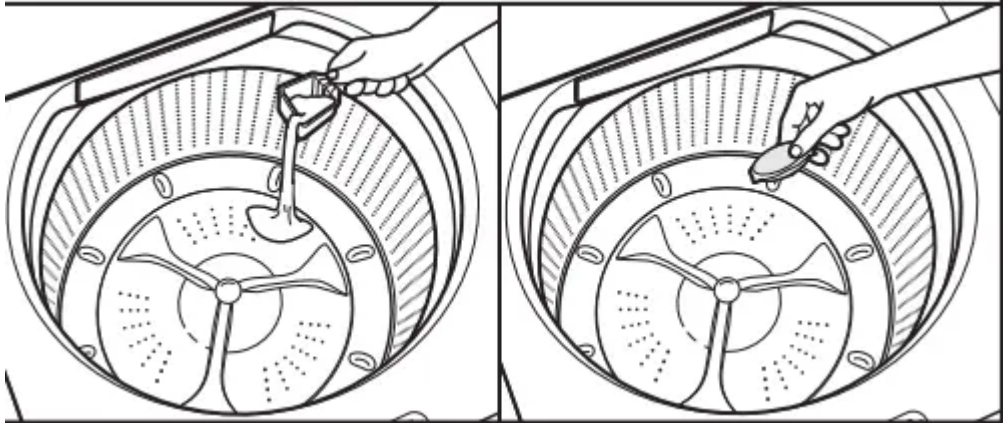

- Single-dose laundry packet, color-safe bleach, or fabric softener crystals can be added to the basket prior to adding laundry.

NOTE:

- Do not add clothes to washer basket prior to adding laundry products. Always follow manufacturer's instructions.

Load laundry into washer

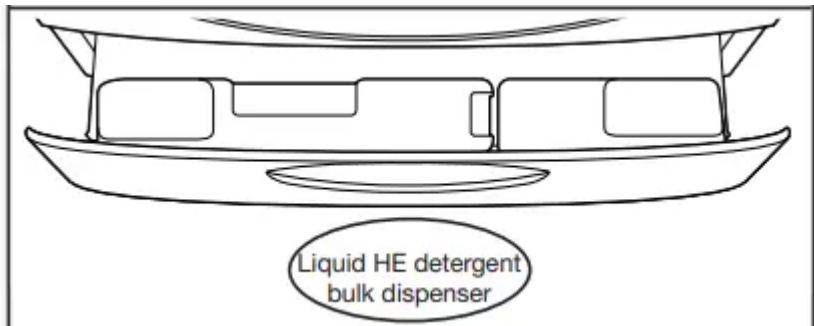

1. Place a load of sorted items loosely in the washer. Items need to move freely for best cleaning and to reduce wrinkling and tangling.
2. If using the Wash & Dry option, loading the drum half full or less and not interrupting the drying cycle by opening the door will improve drying performance and cycle time.
3. Close the washer door by pushing it firmly until the latch clicks.
4. Push load fully into the washer. Make sure no items are resting on the rubber seal to avoid trapping them between the seal and the door window.
5. Mix large and small items and avoid washing single items. Load evenly.
6. Wash small items in mesh garment bags. For multiple items, use more than one bag and fill bags equally

Add HE detergent

- Add a measured amount of HE liquid detergent into detergent tray. This tray holds 3 oz. (89 mL).
- If adding powder HE detergent remove inside tray. Do not overfill tray – adding too much detergent may cause detergent to be dispensed into the washer too early.

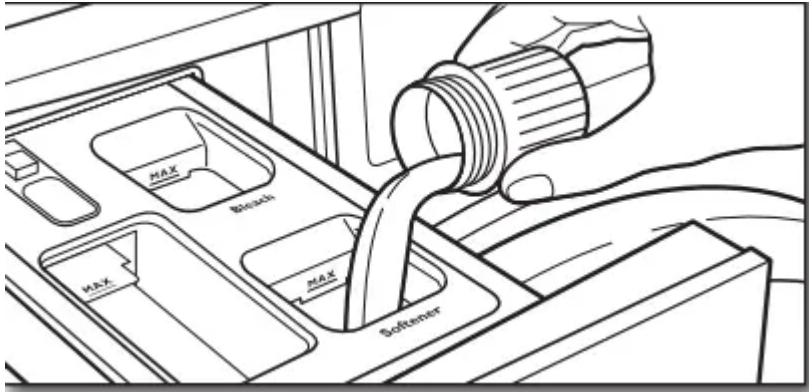

NOTE:

- Make sure tray is in drawer when using liquid detergent and removed when using powder detergent. Do not go over the

Max line.

- Use only High Efficiency detergents. The package will be marked “HE” or “High Efficiency.” Low-water washing creates excessive sudsing with a non-HE detergent. Using nonHE detergent will likely result in longer cycle times and reduced rinsing performance.
- It may also result in component malfunction and, over time, buildup of mold or mildew. HE detergents should be low-sudsing and quick-dispersing to produce the right amount of suds for the best performance. They should hold soil in suspension so it is not redeposited onto clean cloth
- Not all detergents labeled as High Efficiency are identical in formulation and their ability to reduce suds. For example, natural, organic, or homemade HE detergents may generate a high level of suds.
- If you use one of these and see an “F0E2” error code appear in the display, consider using a different HE detergent. Always follow the detergent manufacturer’s instructions to determine the amount of detergent to use. Do not go over the Max line on the dispenser.

HELPFUL TIP:

- See “Washer Maintenance” for information recommended method of cleaning washer dispenser trays.

Add liquid fabric softener or Oxi to dispenser

- Pour a measured amount of liquid fabric softener or Oxi-type boosters, into tray; always follow manufacturer's directions for correct amount of fabric softener or Oxi based on your load size. Close dispenser drawer, then select Oxi option

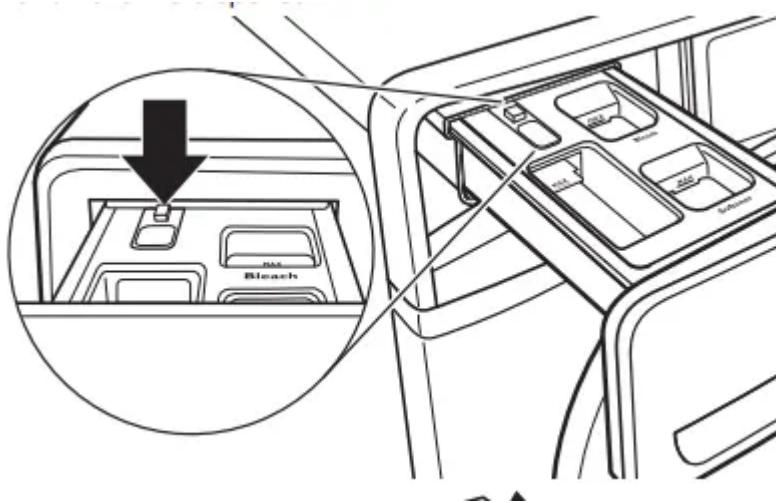

- Oxi is added during main wash and Fabric Softener is added during rinse. **IMPORTANT:** Oxi option must be selected to ensure proper distribution at correct time in cycle. Do not overfill or dilute. Overfilling dispenser will cause fabric softener to immediately dispense into washer.
- If Extra Rinse option is selected, fabric softener will be dispensed into the last rinse. It is normal for a small amount of water to remain in the dispenser at the end of a cycle.

Unlocking the lid to add items

- If you need to open the lid to add 1 or 2 missed items: Touch the Start/Pause button to pause the washer; the lid will unlock once the washer movement has stopped. This may take several minutes if the load was spinning at a high speed.
- Then close the lid and touch and hold the Start/Pause button again for up to 3 seconds to restart the cycle.

IMPORTANT:

- If the lid is left open for more than 10 minutes the water will pump out and the F8E6 error code will appear on the display.

WASHER MAINTENANCE

Clean and Performing at Its Best

1. Always use High Efficiency (HE) detergents and follow the HE detergent manufacturer's instructions regarding the amount of HE detergent to use.

2. Never use more than the recommended amount because that may increase the rate at which detergent and soil residue accumulate inside your washer, which in turn may result in undesirable odor.
3. Use warm and hot wash water settings sometimes (not exclusively cold water washes), because they do a better job of controlling the rate at which soils and detergent accumulate.
4. Always leave the washer lid open between uses to help dry out the washer and prevent the buildup of odor-causing residue.

Cleaning Your Top-Loading Washer

- Read these instructions completely before beginning the routine cleaning processes recommended below. This Washer
- Maintenance Procedure should be performed, at a minimum, once per month or every 30 wash cycles, whichever occurs sooner, to control the rate at which soils and detergent may otherwise accumulate in your washer.

Cleaning the Inside of the Washer

- To keep your washer odor-free, follow the usage instructions provided above, and use this recommended monthly cleaning procedure:

Clean Washer Cycle

- This washer has a special cycle that uses higher water volumes in combination with affresh® Washer Cleaner or liquid chlorine bleach to clean the inside of the washer.

Begin procedure affresh® Washer Cleaner Cycle Procedure

- Recommended for Best Performance):
- Open the washer lid and remove any clothing or items.
- Place an affresh® Washer Cleaner tablet in the bottom of the washer basket.
- Do not place an affresh® Washer Cleaner tablet in the detergent dispenser.
- Do not add any detergent or other chemical to the washer when following this procedure.
- Close the washer lid.
- Select the Clean Washer cycle.
- Touch and hold the Start/Pause button to begin the cycle.
- The Clean Washer Cycle Operation is described below.

NOTE:

- For best results, do not interrupt cycle. If cycle must be interrupted, touch POWER. After the Clean Washer cycle has stopped, run a Rinse & Spin cycle to rinse cleaner from washer.

Description of Clean Washer Cycle Operation:

- This cycle will fill to a water level higher than in normal wash cycles to provide rinsing at a level above the water line for normal wash cycle.
- During this cycle, there will be some agitation and spinning to increase the removal of soils.
- After this cycle is complete, leave the lid open to allow for better ventilation and drying of the washer interior.

Cleaning the Dispensers

1. After a period of using your washer, you may find some residue buildup in the washer's dispensers. To remove residue from the dispensers, wipe them with a damp cloth and towel dry.
2. Do not attempt to remove the dispensers or trim for cleaning.
3. The dispensers and trim are not removable. If your model has a dispenser drawer, however, remove the drawer and clean it before or after you run the Clean Washer cycle. Use an all-purpose surface cleaner, if needed.

Cleaning the Outside of the Washer

- Use a soft, damp cloth or sponge to wipe away any spills.
- Use only mild soaps or cleaners when cleaning external washer surfaces.

IMPORTANT:

- To avoid damaging the washer's finish, do not use abrasive products.

Single Load Dispenser Drawer

1. Pull dispenser drawer out until it stops.
2. Press down on the release tab and pull straight out to remove the dispenser.
3. Lift off cover panel by pulling straight up.

To replace:

- Position cover panel back onto posts on dispenser.
- Apply slight pressure on cover panel to seat it.
- Align edges of dispenser with guides in washer; then slide dispenser back into slot.

TRANSPORTING YOUR WASHER

- Shut off both water faucets. Disconnect and drain water inlet hoses.
- If washer will be moved during freezing weather, follow
- Winter Storage Care" directions before moving.
- Disconnect drain hose from drain system and from back of washer.

- Unplug power cord.
- Place inlet hoses and drain hose inside washer drum.
- Bundle power cord with a rubber band or cable tie to keep it from hanging to the ground.

IMPORTANT:

1. Call for service to install new transport bolts.
2. Do not reuse transport bolts. Washer must be transported in the upright position. To avoid structural damage to your washer, it must be properly set up for relocation by a certified technician.

WINTER STORAGE CARE

- To avoid damage, install and store washer where it will not freeze
- . Because some water may stay in hoses, freezing can damage washer. If storing or moving during freezing weather, winterize your washer.

To winterize washer:

1. Shut off both water faucets; then disconnect and drain water inlet hoses.
2. HELPFUL TIP: Attach a reminder note to the washer to turn the water back on before washer's next use.
3. Put 1 qt. (1 L) of R.V.-type antifreeze in washer drum and run washer on Normal cycle for about 2 minutes to mix antifreeze and remaining water.
4. Unplug washer or disconnect power.

CLEANING THE DRAIN PUMP FILTER/DRAINING RESIDUAL WATER

- Open the dispenser drawer by pulling on the handle at the base of the washer/dryer. This will reveal the drain pump filter. Remove the drawer by releasing the tab on each side.
- Place a broad, flat container beneath the drain pump filter to collect the drain water. Release the black hose from the hose clip, remove the plug, and drain the hose into the container.
- Empty the container. Repeat this procedure if necessary until all the water has drained. Make sure that the black hose is completely dry, replace the plug, and secure the hose in the clip.

NOTE:

1. If water does not drain well, push in hose slightly to remove any possible kinks.
2. Lay a cotton cloth beneath the drain pump filter to absorb any water still in it. Then remove the drain pump filter by turning it counterclockwise.

TROUBLESHOOTING

“Sd” or “SUD” (excess suds) appears in display

- Excessive suds in washer. Washer is running a suds reduction routine. Allow the washer to continue. Use only HE detergent.
 - Allow the washer to continue.
 - Use only HE detergent. Always follow the detergent manufacturer’s instructions to determine the amount of detergent to use, and base detergent quantity on load size.
 - Not all detergents labeled as High Efficiency are identical in formulation and their ability to reduce suds.
 - For example, natural, organic, or homemade HE detergents may generate a high level of suds. If you use one of these and see a “SUD” error code

“F08” followed by “E01” (water supply error) appears in display

- Check for proper water supply.
- Check for proper inlet hoses.
 - Unit will drain for 8 minutes while door remains locked. The drain cycle must be allowed to complete, or the error code cannot reset. When complete, touch POWER once to clear the code. Then touch POWER again to restart washer. If code appears again, call for service.
 - Both hoses must be attached and have water flowing to the inlet valve.
 - Both hot and cold water faucets must be on.
 - Inlet valve screens on washer may be clogged.
 - Remove any kinks in the inlet hose.
 - If used, auto shut-off connectors and hoses must be properly installed and in working order.

Washer making error beeps

- System error code.
- Door has not been opened and closed for at least three cycles.
 - Touch POWER once to clear the code. Then touch POWER again to restart washer. If code appears again, call for service. Unplug washer for 30 seconds; then plug back in.
 - This code may occur when the washer is first turned on. Open and close the door to clear the display.

Clean Washer LED flashing at end of wash cycle (on some models)

- The washer has run 30 wash cycles and is indicating a reminder to run the Clean Washer with affresh® cycle.
 - Run the Clean Washer with affresh® cycle.
 - If the Clean Washer with affresh® cycle is not turned on, the LED will stop flashing at the end of a wash cycle after running three more regular wash cycles.
 - After 30 more wash cycles are completed, the Clean Washer with affresh® LED will again flash at the end of a wash cycle as a reminder.

Vibration, rocking, or “walking”

- Feet may not be in contact with the floor and locked.
 - Load could be unbalanced.
1. Front and rear feet must be in firm contact with floor, and washer must be level to operate properly. See Installation Instructions.
 2. Washer may not be level. Check floor for flexing or sagging.
 3. If flooring is uneven, a ¾" (19 mm) piece of plywood under your washer will reduce sound. See “Level the Washer” in Installation Instructions.

Vibration during spinning or washer stopped

- Load could be unbalanced.
1. Load items in loose heaps evenly around the washplate. Adding wet items to washer or adding more water to basket could unbalance washer.
 2. Avoid washing single items. Balance a single item such as a rug or jeans jacket with a few extra items. Redistribute the load, close the lid, and touch and hold the Start/Pause button.
 3. Use Bedding cycle for oversized, non-absorbent items such as jackets and small comforters.
 4. Item or load not suitable for selected cycle. See “Cycle Guide” and
 5. Using Your Washer” in this Use and Care Guide.

Clicking or metallic noises

- Objects may be caught in washer drain system.
 1. Empty pockets before washing. Loose items such as coins could fall between basket and tub or may block pump. It may be necessary to call for service to remove items.
 2. It is normal to hear metal items on clothing such as metal snaps, buckles, or zippers touch against the stainless steel basket.

Check the following for proper installation:

- Washer not level.

Water may splash off basket if washer is not level.

- Check that load is not unbalanced or tightly packed.

Fill hoses not attached tightly.

- Tighten fill-hose connection.

Fill hose washers. Make sure all four fill hose flat washers are properly seated.

- Drain hose connection.

Pull drain hose from washer cabinet and properly secure it to drainpipe or laundry tub. Do not place tape over drain opening.

- Check household plumbing for leaks or clogged sink or drain.

Water can back up out of a clogged sink or drainpipe.

- Check all household plumbing for leaks (laundry tubs, drain pipe, water pipes, and faucets.) Washer not loaded as recommended

Washer not draining/ spinning, loads are still wet, or spin light remains on (indicating that the washer was unable to pump out water within 10 minutes)

1. Small items may have been caught in pump or between basket and tub, which can slow draining.
2. Using a cycle with a low spin speed.
3. The washer may be tightly packed or unbalanced
4. Load off balanced.
5. Check plumbing for correct drain hose installation. Drain hose extends into standpipe farther than 4.5" (114 mm).
6. Too much detergent causing suds to slow or stop draining and spinning
 - Empty pockets and use garment bags for small items. Using a cycle with a low spin speed. Cycles with lower spin speeds remove less water than cycles with high spin speeds. Use the recommended cycle/spin speed for your item.
 - To remove extra water in the load, select DRAIN & SPIN. Load may need to be rearranged to allow even distribution of the load in the basket. The washer may be tightly packed or unbalanced.
 - Tightly packed or unbalanced loads may not allow the washer to spin correctly, leaving the load wetter than normal.
 - Evenly arrange the wet load for balanced spinning. Select the Drain & Spin cycle to remove excess water.

- See “Using Your Washer” for loading recommendations. Load off balanced. See “Vibration or Off-Balance” in the “Troubleshooting” section for more information. Check plumbing for correct drain hose installation.
- Drain hose extends into standpipe farther than 4.5" (114 mm). Check drain hose for proper installation. Use drain hose form and securely attach to drainpipe or tub. Do not tape over drain opening. Lower drain hose if the end is higher than

WARRANTY

1. Commercial, non-residential, multiple-family use, or use inconsistent with published user, operator, or installation instructions.
2. In-home instruction on how to use your product.
3. Service to correct improper product maintenance or installation, installation not in accordance with electrical or plumbing codes, or correction of household electrical or plumbing (i.e. house wiring, fuses, or water inlet hoses).
4. Consumable parts (i.e. light bulbs, batteries, air or water filters, preservation solutions, etc.).
5. Defects or damage caused by the use of non-genuine Maytag parts or accessories.
6. Conversion of your product from natural gas or L.P. gas or reversal of appliance doors.
7. Damage from accident, misuse, abuse, fire, floods, acts of God, or use with products not approved by Maytag.
8. Repairs to parts or systems to correct product damage or defects caused by unauthorized service, alteration, or modification of the appliance.
9. Cosmetic damage including scratches, dents, chips, and other damage to appliance finishes unless such damage results from defects in materials and workmanship and is reported to Maytag within 30 days.

ASSISTANCE OR SERVICE

- **DISCLAIMER OF IMPLIED WARRANTIES** IMPLIED WARRANTIES, INCLUDING ANY IMPLIED WARRANTY OF MERCHANTABILITY OR IMPLIED WARRANTY OF FITNESS FOR A PARTICULAR PURPOSE, ARE LIMITED TO ONE YEAR OR THE SHORTEST PERIOD ALLOWED BY LAW.
- Some states and provinces do not allow limitations on the duration of implied warranties of merchantability or fitness, so this limitation may not apply to you. This warranty gives

you specific legal rights, and you also may have other rights that vary from state to state or province to province.

BACK COVER

1. LIMITATION OF REMEDIES; EXCLUSION OF INCIDENTAL AND CONSEQUENTIAL DAMAGES YOUR SOLE AND EXCLUSIVE REMEDY UNDER THIS LIMITED WARRANTY SHALL BE PRODUCT REPAIR AS PROVIDED HEREIN. MAYTAG SHALL NOT BE LIABLE FOR INCIDENTAL OR CONSEQUENTIAL DAMAGES.
2. Some states and provinces do not allow the exclusion or limitation of incidental or consequential damages, so these limitations and exclusions may not apply to you. This warranty gives you specific legal rights, and you also may have other rights that vary from state to state or province to province.

Warning

This content is compiled from multiple sources and is provided for reference purposes only. It may not be complete or fully applicable to all situations. If you are unable to resolve your issue, please contact the product manufacturer or an authorized service provider for official support.