

PARTS AND FEATURES

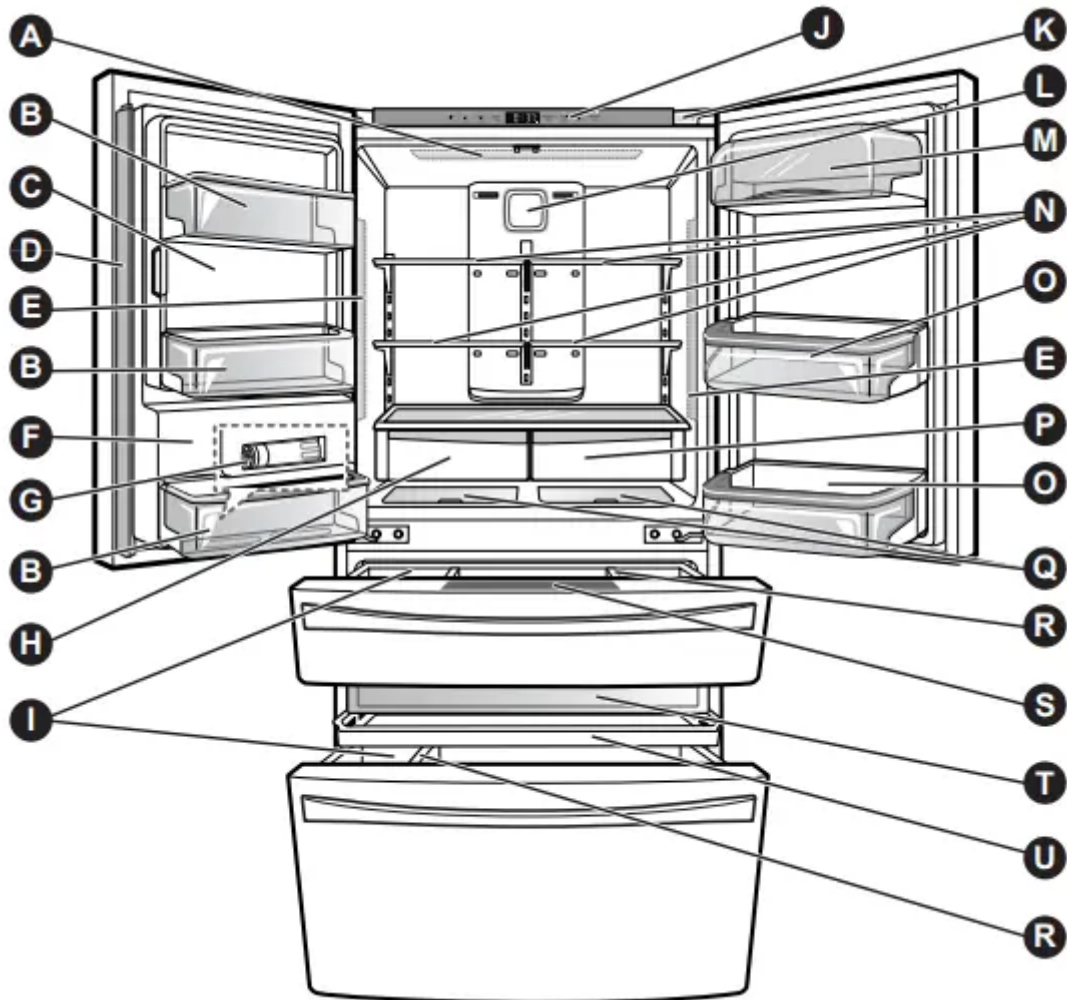

Use this page to become more familiar with the parts and features of your refrigerator.

NOTE: This guide covers several different models. The refrigerator you have purchased may have some or all of the items listed below. The locations of the features shown below may not match your model.

- A Refrigerator Light
- B Fixed Door Bins
- C Ice Compartment (Icemaker and Ice Bin)
- D Articulating Mullion
- E Refrigerator Light (side)
- F Water Tank Cover
- G Water Filter
- H Humidity Controlled Crisper

- I Durabase
- J Control Panel
- K Kenmore Connect™ Speaker
- L Air Filter
- M Adjustable Dairy Bin
- N Refrigerator Shelves
- O Adjustable Door Bins
- P Air Tight Crisper
- Q Convenience Bin
- R Durabase Divider
- S CustomChill™ Controls
- T Top Pullout Drawer
- U Middle Pullout Drawer

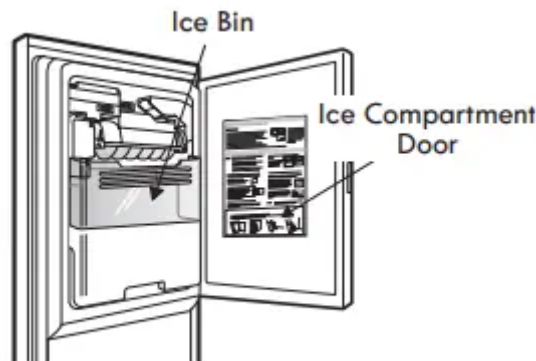

USING YOUR REFRIGERATOR

SETTING THE CONTROLS

Temperature



- The Refrigerator Temp Control ranges from 33°F to 46°F (1°C to 8°C). Press the Refrigerator Temp button to cycle through the available temperature settings one increment at a time.
- The Freezer Temp Control range is from -6°F to 8°F (-21°C to -13°C). Press the Freezer Temp button to cycle through the available temperature settings one increment at a time.

NOTE: When changing control settings, wait 24 hours before making additional adjustments. The controls are set correctly when milk or juice is as cold as you would like and when ice cream is

firm. If the temperature in either compartment is too cold or too warm, change the setting one increment at a time. Wait 24 hours for the change to stabilize before adjusting again.

Airflow

Be sure not to block vents while packing your refrigerator. Doing so will restrict airflow and may cause the refrigerator temperature to become too warm or cause interior moisture buildup. (See air flow diagram below.)

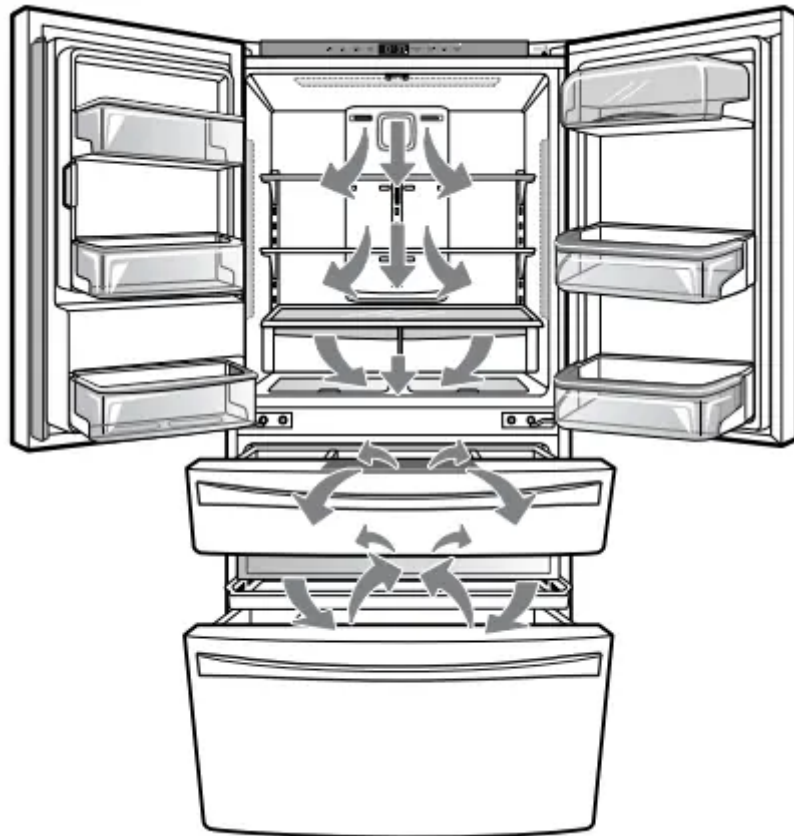

Dispenser

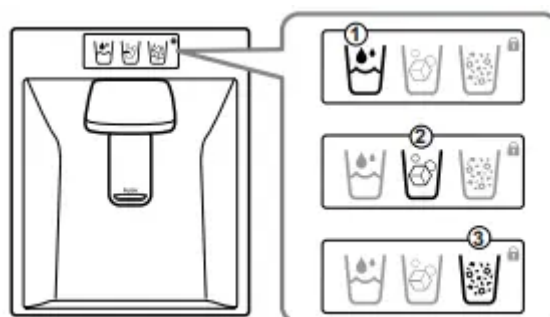

- When you press the water icon (1), the icon will illuminate.
- When you press the cubed ice icon (2), the icon will illuminate.
- When you press the crushed ice icon (3), the icon will illuminate.

- Some dripping may occur after dispensing. Hold your cup beneath the dispenser for a few seconds after dispensing to catch all of the drops.

NOTE: The dispenser will not work if any door is left open or if the control lock is engaged.

NOTE: If the lock icon is illuminated, you can not control the dispenser type. Please check the control lock ON/OFF mode on the control panel.

CAUTION: The control display is operated by touch. Excessive moisture on the display may cause a malfunction. Please keep the display clean and dry



Air Filter

The Air Filter helps remove odors from the refrigerator. The Air Filter has two settings, Auto and MAX. In Auto mode, the Air Filter will cycle on and off in increments of ten minutes on and one hundred and ten minutes off . If set to the MAX mode, the Air Filter will stay on continuously for four hours, cycling on and off in increments of ten minutes on and five minutes off . After four hours, the Air Filter will switch to Auto mode.

- Auto mode is the default mode.
- Press the Air Filter button once for MAX mode.



Air Filter Reset

When the CHANGE icon turns on, the air filter needs to be replaced. After replacing the air filter, press and hold the Air Filter button for three seconds to turn the icon light off . It is recommended to change the air filter approximately every 6 months.



Ultra Ice

- When you press and hold the Ultra Ice button, the Ultra Ice graphic will illuminate in the display and will continue for 24 hours. The function will automatically shut off after 24 hours.
- You can stop this function manually by pressing the button one more time.
- This function increases both ice making and freezing capabilities.

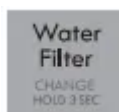

Water Filter Reset

When the water filter indicator turns on, you need to change the water filter. After changing the water filter, press and hold the Water Filter button for three seconds to turn the indicator light off . You need to change the water filter approximately every six months.



Accent Light/Light Sensor

This light has three settings: On, Off and Auto. If the light is set to the Auto mode, the Accent Light will automatically turn on and off according to the brightness of the room, as detected by the light sensor.

Articulating Mullion

This feature is a metal strip attached to the left door that articulates (rotates) 90 degrees as the door is closed, forming a mullion (base) for the left and right door gaskets to seal against.

CAUTION

To reduce the risk of scratching the door or breaking the door mullion, please make sure that the refrigerator door mullion is always folded in.

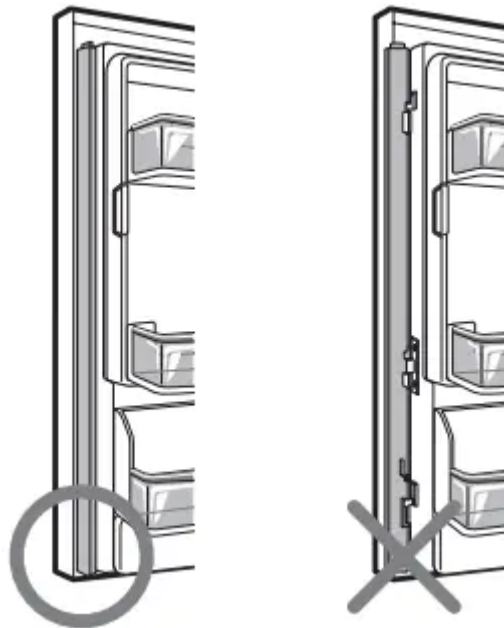

Door Alarm

- When power is connected to the refrigerator, the door alarm is initially set to ON. When you press the Door Alarm button, the display will change to OFF and the Door Alarm function will deactivate.
- When either the refrigerator or the freezer door is left open for more than 60 seconds, the alarm tone will sound to let you know that the door is open.

- When you close the door, the door alarm will stop.

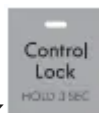

Control Lock

- When power is initially connected to the refrigerator, the Lock function is off .
- If you want to activate the Lock function to lock other buttons, press and hold the Control Lock button for three seconds or more. The Control Lock icon will display and the Lock function is now enabled.
- When the Lock function is activated, no other buttons will work. The dispenser pad is also deactivated.
- To disable the Lock function, press and hold the Control Lock button for approximately three seconds.

Temperature Mode Switch Function (°F °C)

If you want to convert °F to °C or vice versa, press and hold the Freezer Temp and Refrigerator Temp buttons at the same time for approximately five seconds.

Demo Mode (For Store Use Only)

The Demo Mode disables all cooling in the refrigerator and freezer sections to conserve energy while on display in a retail store. When activated, OFF will display on the control panel.



To deactivate:

With either refrigerator door opened, press and hold the Refrigerator Temp and Ultra Ice buttons at the same time for five seconds. The control panel will beep and the temperature settings will display to confirm that Demo Mode is deactivated. Use the same procedure to activate the Demo Mode.

IN-DOOR ICE BIN

CAUTION

Keep hands and tools out of the ice compartment door and dispenser chute. Failure to do so may result in damage or personal injury.

The icemaker will stop producing ice when the in-door ice bin is full. If you need more ice, empty the ice bin into the extra ice bin in the freezer compartment. During use, the ice can

become uneven causing the icemaker to misread the amount of ice cubes and stop producing ice. Shaking the ice bin to level the ice within it can reduce this problem.

NOTE: Storing cans or other items in the ice bin will damage the icemaker.

Keep the ice compartment door closed tightly. If the ice compartment door is not closed tightly, the cold air in the ice bin will freeze food in the refrigerator compartment. This could also cause the icemaker to stop producing ice.

NOTE: Emptying the ice bin is recommended if the icemaker ON/OFF button on the Ice maker is set to OFF for an extended period of time.

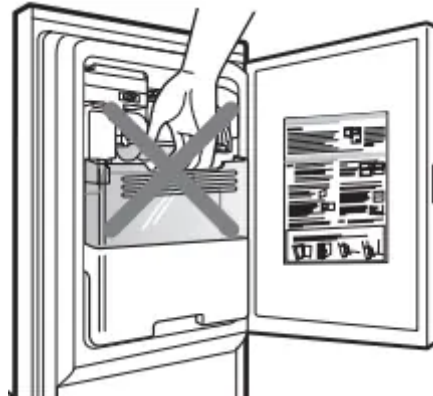

CAUTION When handling the ice bin, keep hands away from the icemaker tray area to avoid personal injury

1. Pull or push the door handle to open or close the ice compartment.

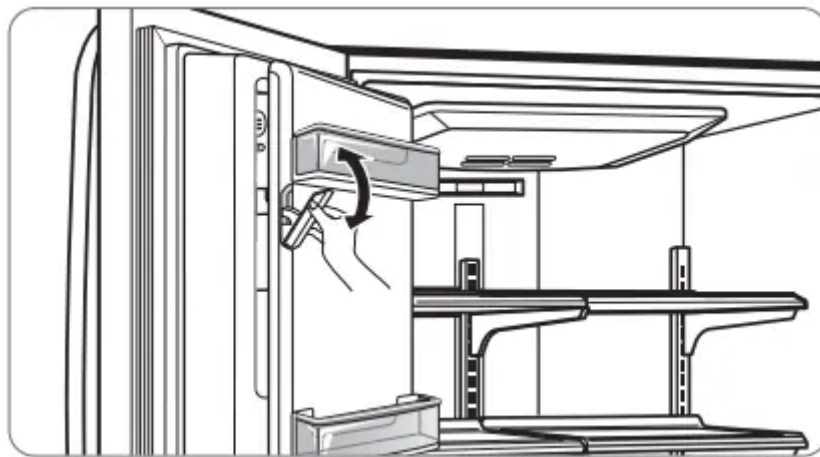

2. To remove the in-door ice bin, grip the front handle, slightly lift the lower part, and slowly pull out the bin as shown.

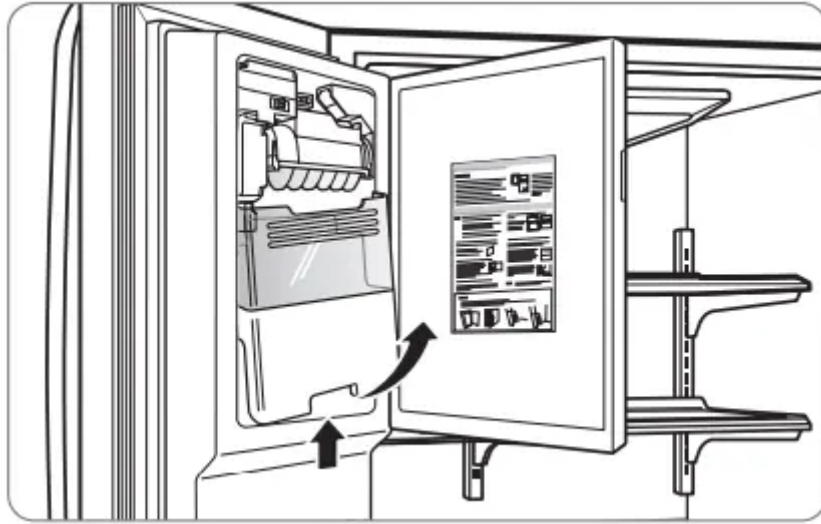

3. To reinstall the in-door ice bin, slightly slant the bin during replacement to avoid contact with the icemaker.

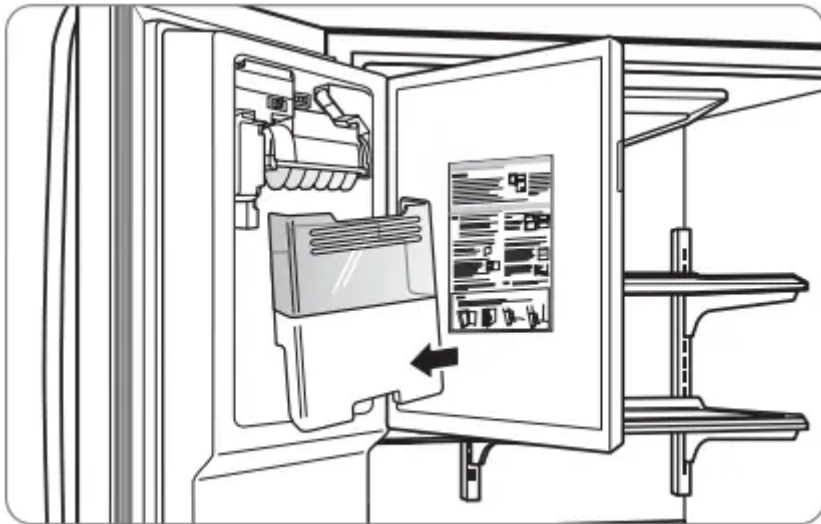

4. Avoid touching the ice-detecting sensor when replacing the ice bin. See the label on the ice compartment door for details.



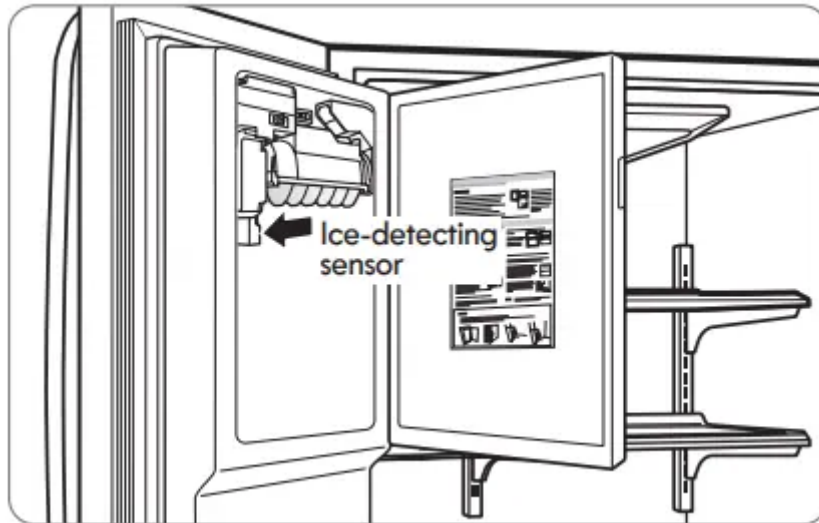

AUTOMATIC ICEMAKER

Ice is made in the automatic icemaker and sent to the dispenser. The icemaker will produce 70-210 cubes in a 24-hour period, depending on freezer compartment temperature, room temperature, number of door openings and other operating conditions.

- It takes about 12 to 24 hours for a newly installed refrigerator to begin making ice. Wait 72 hours for full ice production to occur.
- Ice making stops when the in-door ice bin is full. When full, the in-door ice bin holds approximately 6 to 8 (12- 16 oz) glasses of ice.
- To turn off the automatic icemaker, set the icemaker switch to OFF (O). To turn on the automatic icemaker, set the switch to ON (I).
- The water pressure must be between 20 and 120 psi on models without a water filter and between 40 and 120 psi on models with a water filter to produce the normal amount and size of ice cubes.
- Foreign substances or frost on the ice-detecting sensor can interrupt ice production. Make sure the sensor area is clean at all times for proper operation.

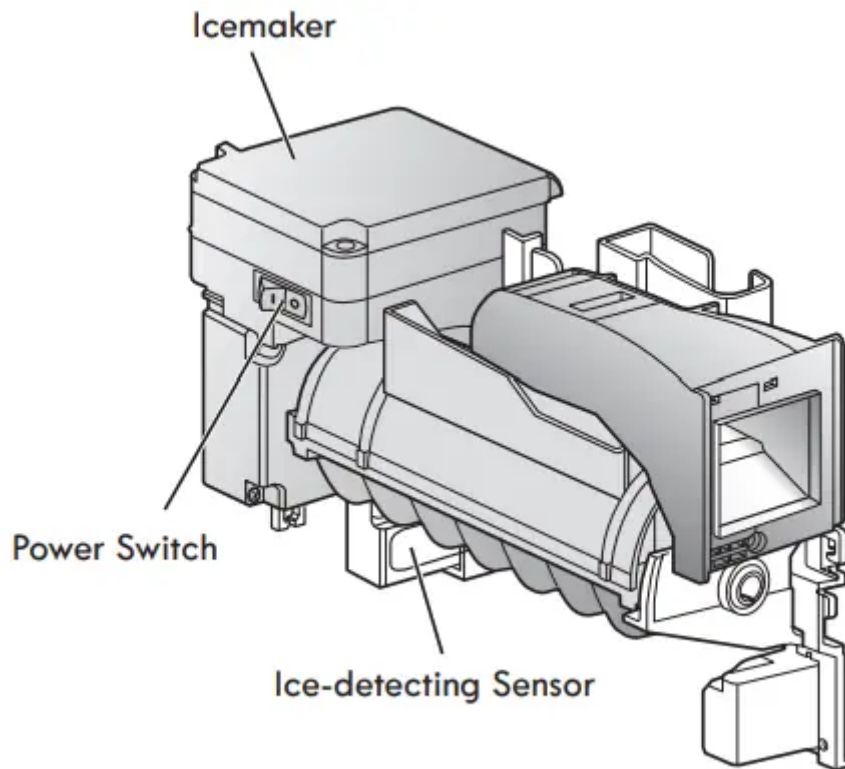

CAUTION

- The first ice and water dispensed may include particles or odor from the water supply line or the water tank.
- Throw away the first few batches of ice. This is also necessary if the refrigerator has not been used for a long time.
- Never store beverage cans or other items in the ice bin for the purpose of rapid cooling. Doing so may damage the icemaker or the containers may burst.
- If discolored ice is dispensed, check the water filter and water supply. If the problem continues, contact a Sears or other qualified service center. Do not use the ice or water until the problem is corrected.
- Keep children away from the dispenser. Children may play with or damage the controls.
- The ice passage may become blocked with frost if only crushed ice is used. Remove the frost that accumulates by removing the ice bin and clearing the passage with a rubber spatula. Dispensing cubed ice can also help prevent frost buildup.
- Never use thin crystal glass or crockery to collect ice. Such containers may chip or break resulting in glass fragments in the ice.
- Dispense ice into a glass before filling it with water or other beverages. Splashing may occur if ice is dispensed into a glass that already contains liquid.
- Never use a glass that is exceptionally narrow or deep. Ice may jam in the ice passage and refrigerator performance may be affected.

- Keep the glass at a proper distance from the ice outlet. A glass held too close to the outlet may prevent ice from dispensing.
- To avoid personal injury, keep hands out of the ice door and passage.
- Never remove the dispenser cover.
- If ice or water dispenses unexpectedly, turn off the water supply and contact Sears Home Service at 1-800-4-MY HOME®.

WHEN YOU SHOULD SET THE ICEMAKER POWER SWITCH TO OFF (O)

- When the water supply will be shut off for several hours.
- When the ice bin is removed for more than one or two minutes.
- When the refrigerator will not be used for several days.

NOTE: The ice bin should be emptied when the icemaker ON/OFF switch is turned to the OFF position.

NORMAL SOUNDS YOU MAY HEAR

- The icemaker water valve will buzz as the icemaker fills with water. If the power switch is in the ON (I) position, it will buzz even if it has not yet been hooked up to water. To stop the buzzing, move the power switch to OFF (O).

NOTE: Keeping the power switch in the ON (I) position before the water line is connected can damage the icemaker.

- You will hear the sound of cubes dropping into the bin and water running in the pipes as the icemaker refills.

PREPARING FOR VACATION

Set the icemaker power switch to OFF (O) and shut off the water supply to the refrigerator.

NOTE: The ice bin should be emptied anytime the icemaker ON/OFF switch is turned to the OFF (O) position.

If the ambient temperature will drop below freezing, have a qualified technician drain the water supply system to prevent serious property damage due to flooding caused by ruptured water lines or connections.

FOOD STORAGE GUIDE

Wrap or store food in the refrigerator in airtight and moisture-proof material unless otherwise noted. This prevents food odor and taste transfer throughout the refrigerator. For dated products, check date code to ensure freshness.

| Items | How to |
|--|--|
| Butter or margarine | Keep opened butter in a covered dish or closed compartment. When storing an extra supply, wrap in freezer packaging and freeze. |
| Cheese | Store in the original wrapping until you are ready to use it. Once opened, rewrap tightly in plastic wrap or aluminum foil. |
| Milk | Wipe milk cartons. For best storage, place milk on interior shelf, not on door shelf. |
| Eggs | Store in original carton on interior shelf, not on door shelf. |
| Fruit | Do not wash or hull the fruit until it is ready to be used. Sort and keep fruit in its original container, in a crisper, or store in a completely closed paper bag on a refrigerator shelf. |
| Leafy vegetables | Remove store wrapping and trim or tear off bruised and discolored areas. Wash in cold water and drain. Place in plastic bag or plastic container and store in crisper. |
| Vegetables with skins (carrots, peppers) | Place in plastic bags or plastic container and store in crisper. |
| Fish | Store fresh fish and shellfish in the freezer section if they are not being consumed the same day of purchase. It is recommended to consume fresh fish and shellfish the same day purchased. |
| Leftovers | Cover leftovers with plastic wrap or aluminum foil, or store in plastic, or plastic containers with tight lids. |

STORING FROZEN FOOD

NOTE: Check a freezer guide or a reliable cookbook for further information about preparing food for freezing or food storage times.

Freezing

Your freezer will not quick-freeze a large quantity of food. Do not put more unfrozen food into the freezer than will freeze within 24 hours (no more than 2 to 3 lbs. of food per cubic foot of freezer space). Leave enough space in the freezer for air to circulate around packages. Be careful to leave enough room at the front so the door can close tightly.

Storage times will vary according to the quality and type of food, the type of packaging or wrap used (how airtight and moisture-proof) and the storage temperature. Ice crystals inside

a sealed package are normal. This simply means that moisture in the food and air inside the package have condensed, creating ice crystals.

NOTE: Allow hot foods to cool at room temperature for 30 minutes, then package and freeze. Cooling hot foods before freezing saves energy.

Packaging

Successful freezing depends on correct packaging. When you close and seal the package, it must not allow air or moisture in or out. If it does, you could have food odor and taste transfer throughout the refrigerator and could also dry out frozen food.

Packaging recommendations:

- Rigid plastic containers with tight-fitting lids
- Straight-sided canning/freezing jars
- Heavy-duty aluminum foil
- Plastic-coated paper
- Non-permeable plastic wraps
- Specified freezer-grade self-sealing plastic bags
- Follow package or container instructions for proper freezing methods.

Do not use

- Bread wrappers
- Non-polyethylene plastic containers
- Containers without tight lids
- Wax paper or wax-coated freezer wrap
- Thin, semi-permeable wrap

CAUTION: Do not keep beverage cans or plastic food containers in the freezer compartment. They may break or burst if they freeze.

REFRIGERATOR SECTION

WATER DISPENSER

To dispense cold water, push on the dispenser switch with a glass.

NOTE: The dispenser is equipped with a light that turns on when the dispenser pad is engaged.

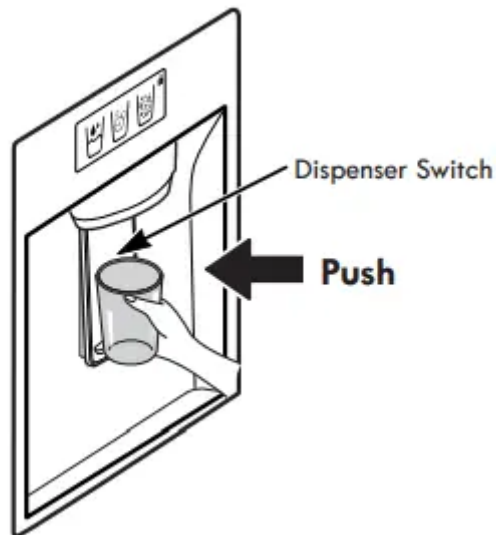

Some dripping may occur after dispensing. Hold your cup beneath the dispenser for a few seconds after dispensing to catch all of the drops.

WARNING: Do not put your fingers up the ice chute opening. Doing so can result in severe injury.

CAUTION: Do not dispense ice into fine china or crystal glasses. China or crystal can break.



REFRIGERATOR SHELVES

The shelves in your refrigerator are adjustable to meet your individual storage needs. Your model may have glass or wire shelves.

Adjusting the shelves to fit items of different heights will make finding the exact item you want easier. Doing so will also reduce the amount of time the refrigerator door is open which will save energy.

IMPORTANT: Do not clean glass shelves with warm water while they are cold. Shelves may break if exposed to sudden temperature changes or impact.

CAUTION: Glass shelves are heavy. Use special care when removing them.

Adjusting Shelves (Cantilever)

Remove shelves from the shipping position and replace shelves in the position you want.

To remove a shelf—Tilt up the front of the shelf 1 and lift the shelf from beneath 2 . Pull the shelf out.

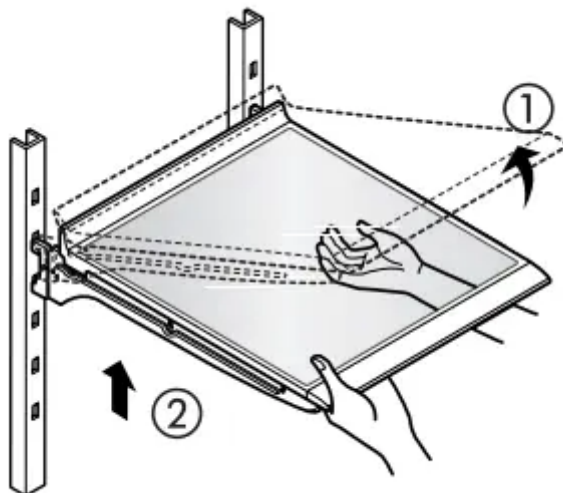

To reinstall a shelf—Tilt the front of the shelf up and guide the shelf hooks into the slots at a desired height. Then, lower the front of the shelf so that the hooks drop into the slots.

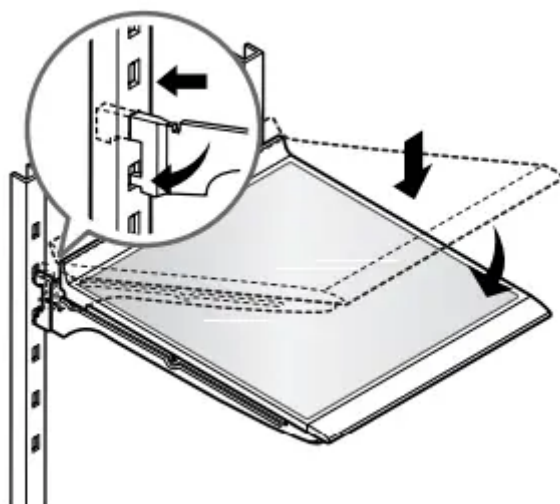

CAUTION: Make sure that shelves are level from one side to the other. Failure to do so may result in the shelf falling or spilling food.

Folding Shelf (on some models)

You can store taller items, such as a gallon container or bottles, by simply pushing the front half of the shelf underneath the back half of the shelf. Pull the front of the shelf toward you to return to a full shelf.

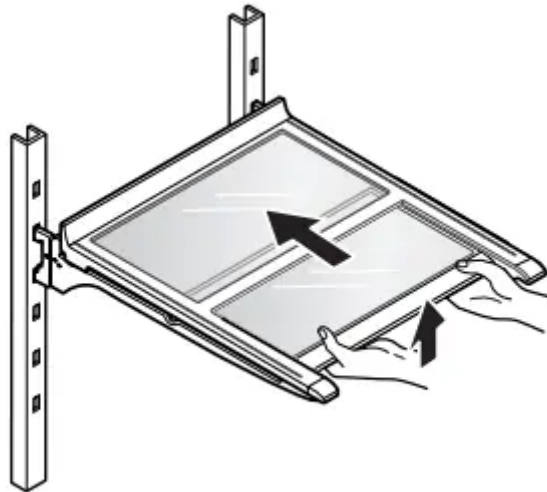

HUMIDITY CONTROLLED CRISPER

The crispers provide fresher tasting fruit and vegetables by letting you easily control humidity inside the drawer.

You can control the amount of humidity in the moisturesealed crispers by adjusting the control to any setting between VEGETABLES and FRUIT.

- VEGETABLES keeps moist air in the crisper for best storage of fresh, leafy vegetables.
- FRUIT lets moist air out of the crisper for best storage of fruit.



REMOVING THE HUMIDITY CONTROLLED CRISPER

1. To remove, pull the drawer out to full extension.
2. Lift the front of the crisper up, then pull it straight out.

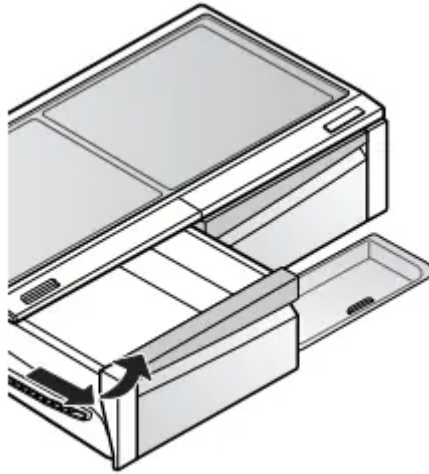

3. To install, slightly tilt up the front, insert the drawer into the frame and push it back into place.

To remove the glass

1. Lift up the glass under the crisper cover.
2. Pull the glass up and out.

NOTE: Pantry drawer not shown for clarity.

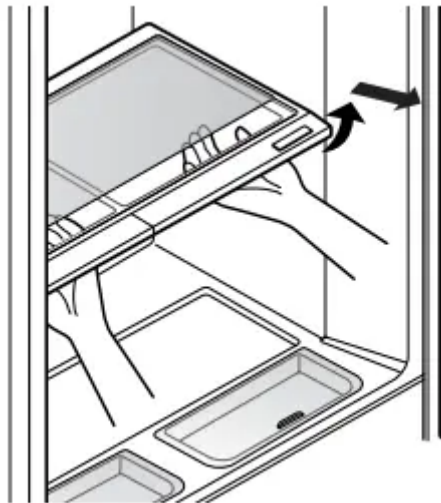

CONVENIENCE BIN

Open and close by pulling the handle of the lid.

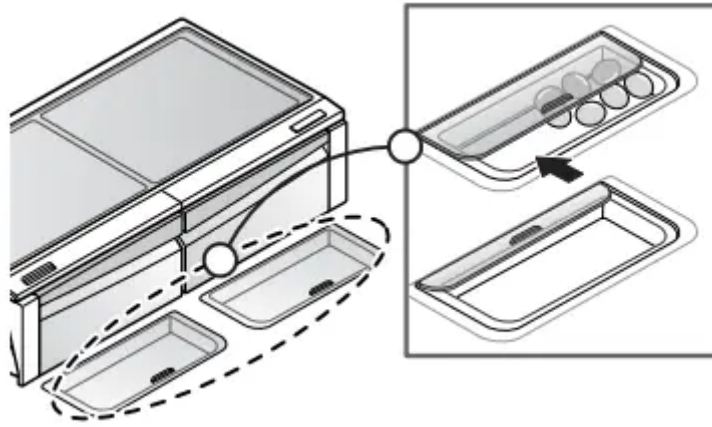

REMOVING THE CONVENIENCE BIN LID

1. Open the lid about half way 1 .
2. Lift the lid up and pull out 2 .

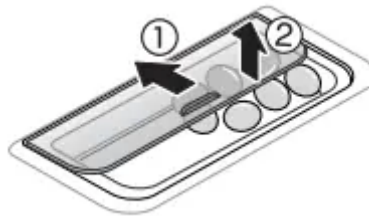

DOOR BIN

The door bins are removable for easy cleaning and adjustment.

1. To remove the bin, simply lift the bin up and pull straight out.
2. To replace the bin, slide it in above the desired support and push down until it snaps into place.

NOTE: Some bins may vary in appearance and will only fit in one location.

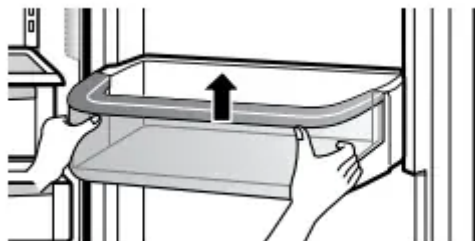

REPLACING THE AIR FILTER

It is recommended that you replace the air filter:

- Approximately every six months.
- When the CHANGE AIR FILTER light turns on.



1. Remove the Old Filter

Turn the filter cover to the left to detach it from the refrigerator wall. The filter is located on the inside of the filter cover. Remove the filter from the cover and replace it with a new filter.

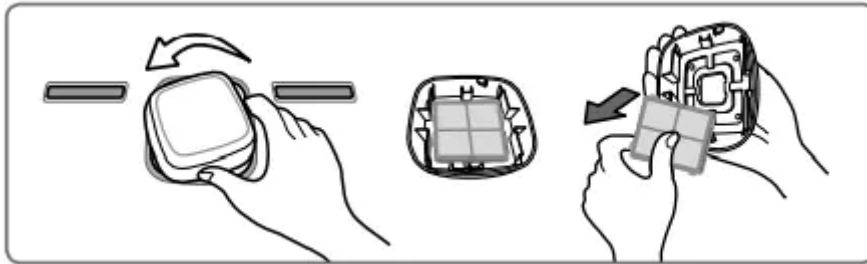

2. Install a New Air Filter

Place the new filter inside of the cover with the side that says "Front" facing outward. Turn the filter cover to the right to attach it to the refrigerator wall.

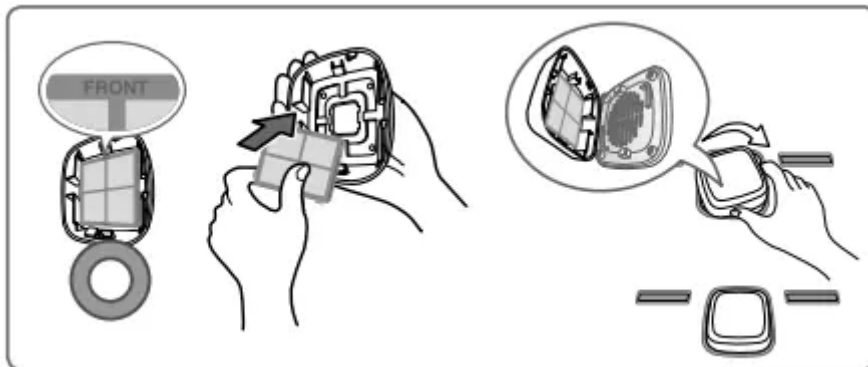

After changing the filter, push and hold the Air Filter button for three seconds to reset the filter sensor.

NOTE: To purchase a replacement air filter, visit a Sears store or call 1-800-4-MY-HOME®. Also, you may order online at www.sears.com/partsdirect

FREEZER SECTION

CUSTOMCHILL™ DRAWER



The CustomChill™ Drawer provides storage space with a variable temperature control that can be adjusted to keep the compartment either colder or warmer than the refrigerator.

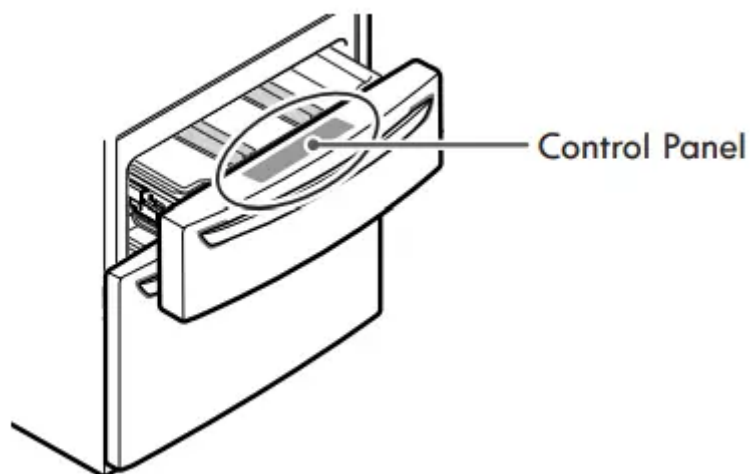

Setting the Temperature

Press the Select/Lock button repeatedly to toggle through the four temperature settings.

Store meat and seafood at 29°F/-1°C, cold drinks at 33°F/1°C, deli snacks at 37°F/3°C, or chilled wine at 42°F/5°C.

Lock



Control Lock

The controls can also be locked to prevent the temperature from accidentally being changed or tampered with by children. To lock the controls, press and hold the Select/Lock button for three seconds until the Lock icon lights up. To unlock the controls, press and hold the Select/Lock button until the Lock icon light turns off .

PULLOUT DRAWERS

Top Drawer

1. To remove, pull the drawer out to full extension. On the left rail, use a flat blade screwdriver to push in on the tab to release the drawer from the rail, as shown below. Once the left side is loose, push the tab on the right side with your finger to release the drawer. Lift the front of the drawer up, then pull it straight out.

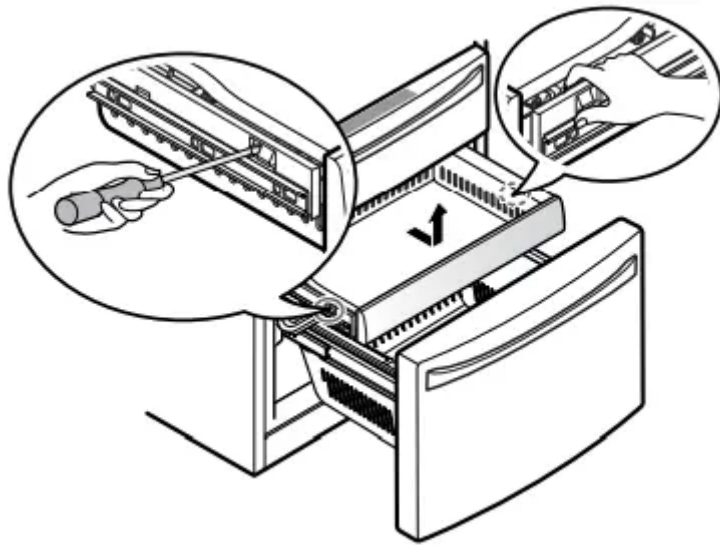

2. To replace, slightly tilt up the front of the drawer, insert the drawer into the frame, and push the drawer back into place until you hear a click.

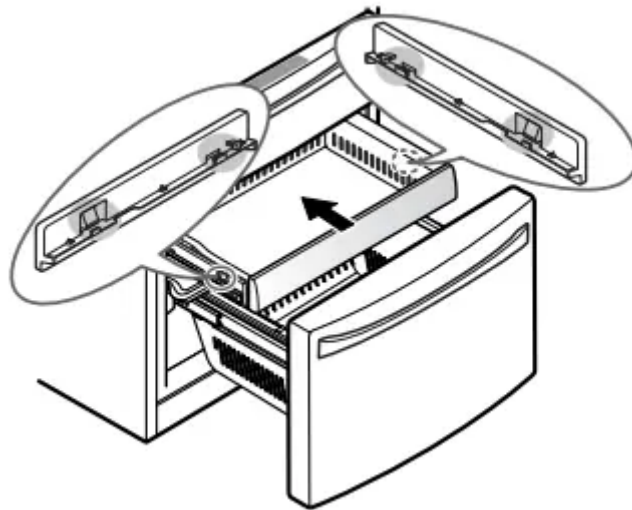

Middle Drawer

1. To remove, pull the drawer out to full extension. Lift the front of the drawer up, then pull it straight out.

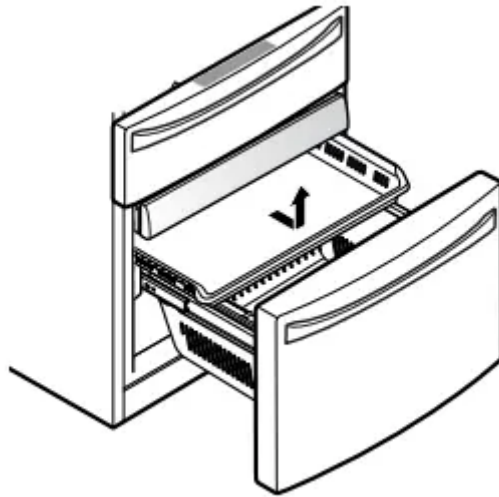

2. To replace, slightly tilt up the front of the drawer, insert the drawer into the frame, and push it back into place.

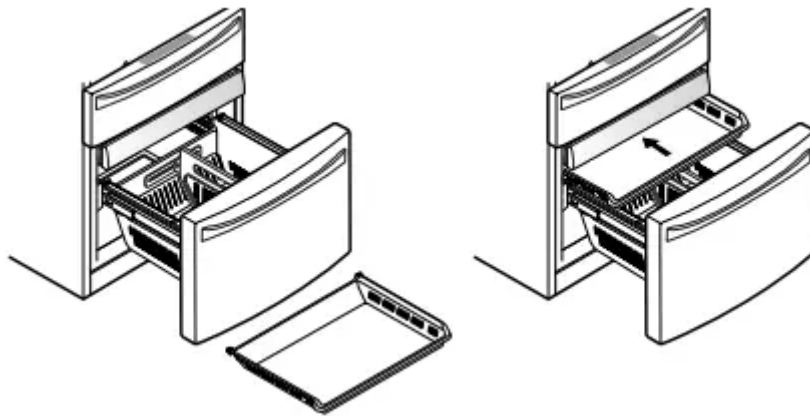

DURABASE

1. To remove the Durabase, push it to the back as much as possible. Tilt up the front of the Durabase and pull straight out.
2. To replace, insert the Durabase in the rail assembly.

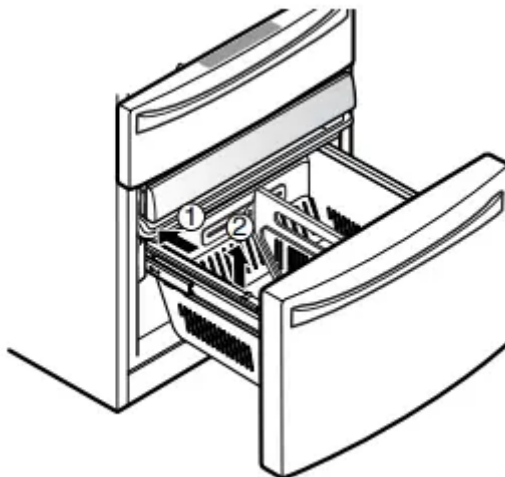

DURABASE DIVIDER

The Durabase divider allows you to organize the Durabase area into sections. It can be adjusted from side to side to accommodate items of different sizes

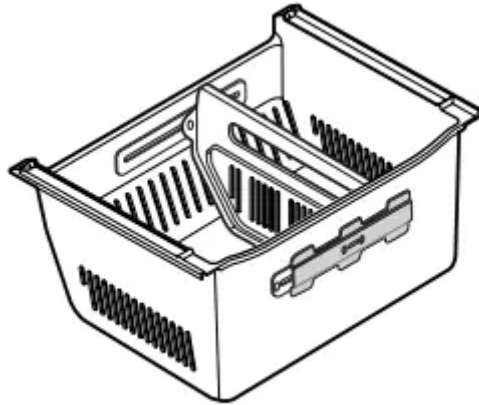

WARNING: If the Durabase divider is removed, there is enough open space for children or pets to crawl inside. To prevent accidental child and pet entrapment or suffocation risk, DO NOT allow children or pets to touch or go near the drawer.

CARE AND CLEANING

Both the refrigerator and freezer sections defrost automatically; however, clean both sections about once a month to prevent odors. Wipe up spills immediately.

GENERAL CLEANING TIPS

- Unplug the refrigerator or disconnect power.
- Remove all removable parts, such as shelves, crispers, etc. Refer to sections in Using Your Refrigerator for removal instructions.
- Use a clean sponge or soft cloth and a mild detergent in warm water. Do not use abrasive or harsh cleaners.
- Hand wash, rinse and dry all surfaces thoroughly.
- Plug in the refrigerator or reconnect power.

EXTERIOR

Waxing external painted metal surfaces helps provide rust protection. Do not wax plastic parts. Wax painted metal surfaces at least twice a year using appliance wax (or auto paste wax). Apply wax with a clean, soft cloth.

For products with a stainless steel exterior, use a clean sponge or soft cloth and a mild detergent in warm water. Do not use abrasive or harsh cleaners. Dry thoroughly with a soft cloth.

INSIDE WALLS (allow the freezer to warm up so the cloth will not stick)

To help remove odors, you can wash the inside of the refrigerator with a mixture of baking soda and warm water. Mix 2 tablespoons of baking soda to 1 quart of water (26 g soda to 1 liter water.) Be sure the baking soda is completely dissolved so it does not scratch the surfaces of the refrigerator.

CAUTION: While cleaning the inside of the refrigerator, do not spray water.

DOOR LINERS AND GASKETS

Use a clean sponge or soft cloth and a mild detergent in warm water. Do not use cleaning waxes, concentrated detergents, bleaches, or cleaners containing petroleum on plastic refrigerator parts.

PLASTIC PARTS (Covers and Panels)

Use a clean sponge or soft cloth and a mild detergent in warm water. Do not use window sprays, abrasive cleansers, or flammable fluids. These can scratch or damage the material.

CONDENSER COILS

Use a vacuum cleaner with an attachment to clean the condenser cover and vents. Do not remove the panel covering the condenser coil area.

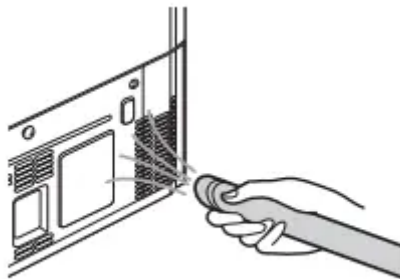

LIGHT BULB REPLACEMENT

Warning

Electrical Shock Hazard Before replacing a Compartment Lamp, either unplug the refrigerator or turn off power at the circuit breaker or fuse box.

NOTE: The refrigerator and freezer compartment lights have LED interior lighting, and service should be performed by a qualified technician.

POWER INTERRUPTIONS

1. If the power will be out for 24 hours or less, keep all refrigerator doors closed to help foods stay cold and frozen.

2. If the power will be out for more than 24 hours, remove all frozen food and store it in a frozen food locker.

WHEN YOU GO ON VACATION

If you choose to leave the refrigerator on while you are away, follow these steps to prepare your refrigerator before you leave.

1. Use up any perishables and freeze other items.
2. Turn off the icemaker and empty the ice bin.

If you choose to turn the refrigerator off before you leave, follow these steps.

1. Remove all food from the refrigerator.
2. Depending on your model, set the thermostat control (refrigerator control) to OFF. See the Setting the Controls section.
3. Clean the refrigerator, wipe it and dry well.
4. Tape rubber or wood blocks to the tops of both doors to prop them open far enough for air to get in. This stops odor and mold from building up.

WHEN YOU MOVE

When you are moving your refrigerator to a new home, follow these steps to prepare it for the move.

1. Remove all food from the refrigerator and pack all frozen food in dry ice.
2. Unplug the refrigerator.
3. Clean, wipe and dry thoroughly.
4. Take out all removable parts, wrap them well and tape them together so they do not shift and rattle during the move. Refer to the Using your Refrigerator section for removal instructions.
5. Depending on the model, raise the front of the refrigerator so it rolls easier OR screw in the leveling legs all the way so they do not scrape the floor. See the Door Closing section.
6. Tape the doors shut and tape the power cord to the refrigerator cabinet.

When you get to your new home, put everything back and refer to the Refrigerator Installation section for preparation instructions.

TROUBLESHOOTING GUIDE

Before conducting troubleshooting, make sure that the following basic requirements are met:

COOLING

| Problem | Possible Causes | Solutions |
|--|--|--|
| Refrigerator and Freezer section are not cooling. | The refrigerator control is set to OFF (some models). | Turn the control ON. Refer to the Controls section for proper temperature settings. |
| | Refrigerator is set to demo mode. | Demo Mode allows the lights and display to work normally while disabling cooling to save energy while on the showroom floor. Refer to the Settings Controls section for instructions on how to disable Demo Mode. |
| | Refrigerator is in the defrost cycle. | During the defrost cycle, the temperature in each compartment may rise slightly for a few minutes and confirm the proper temperature has been restored once the defrost cycle is completed. |
| | Refrigerator was recently installed. | It may take up to 24 hours for each compartment to reach the desired temperature. |
| | Refrigerator was recently relocated. | If the refrigerator was stored for a long period of time or moved on its side, it is necessary for the refrigerator to stand upright for 24 hours before connecting to power. |
| Cooling System runs too much. | Refrigerator is replacing an older model. | Modern refrigerators require more run time but use less energy due to more efficient technology. |
| | Refrigerator was recently plugged in or power restored. | The refrigerator will take up to 24 hours to cool completely. |



| | | |
|--|---|---|
| | <p>Door opened often or a large amount of food / hot food was added.</p> | <p>Adding food and opening the door the refrigerator, requiring the compressor to run longer in order to cool the refrigerator back down. In order to conserve energy, to get everything you need out of the refrigerator at once, keep food organized so it is easy to find, and close the door as the food is removed. (Refer to the Storage Guide.)</p> |
| | <p>Doors are not closed completely.</p> | <p>Firmly push the doors shut. If the doors do not shut all the way, see the Doors won't shut completely or pop open section of the Features Troubleshooting.</p> |
| | <p>Refrigerator is installed in a hot location.</p> | <p>The compressor will run longer under hot conditions. At normal room temperature (70°F) expect your compressor to run 40% to 80% of the time. Under warmer conditions, expect it to run even longer. The refrigerator should not be operated in a location above 110°F.</p> |
| | <p>Condenser / back cover is clogged.</p> | <p>Use a vacuum cleaner with an attachment to clean the condenser cover and vent. Remove the panel covering the condenser coil area.</p> |



| Problem | Possible Causes | Solutions |
|---|--|--|
| Refrigerator or Freezer section is too warm. | Refrigerator was recently installed. | It may take up to 24 hours for each compartment to reach the desired temperature. |
| | Air vents are blocked. | Rearrange items to allow air to flow throughout the compartment. Refer to the Airflow diagram in the Using Your Refrigerator section. |
| | Doors are opened often or for long periods of time. | When the doors are opened often or for long periods of time, warm, humid air enters the compartment. This raises the temperature and humidity level within the compartment. To reduce humidity, reduce the frequency and duration of door openings. |
| | Unit is installed in a hot location. | The refrigerator should not be operated in temperatures above 110F. |
| | A large amount of food or hot food was added to either compartment. | Adding food warms the compartment, requiring the cooling system to run longer. Allowing hot food to cool to room temperature before putting it in the refrigerator will reduce this effect. |
| | Doors not closed correctly. | See the Doors will not close correctly section in Parts & Features Troubleshooting. |
| | Temperature control is not set correctly. | If the temperature is too warm, adjust the control one increment at a time and allow the temperature to stabilize. Refer to the Setting the Controls section for more information. |



| | | |
|-----------------------------------|--|--|
| | Defrost cycle has recently completed. | During the defrost cycle, the temperature in each compartment may rise slightly and condensation may form on the back of the door. Wait 30 minutes and confirm that the temperature has been restored once the defrost cycle has completed. |
| Interior moisture buildup. | Doors are opened often or for long periods of time. | When the doors are opened often or for long periods of time, warm, humid air enters the compartment. This raises the temperature and moisture level within the compartment. To reduce moisture buildup, reduce the frequency and duration of door openings. |
| | Doors not closed correctly. | See the Doors will not close correctly section in the Troubleshooting section. |
| | Weather is humid. | Humid weather allows additional moisture to enter the compartments when the doors are opened leading to condensation on the back of the door. Maintaining a reasonable level of humidity in the home will help to control the amount of moisture that can enter the compartments. |
| | Defrost cycle recently completed. | During the defrost cycle, the temperature in each compartment may rise slightly and condensation may form on the back of the door. Wait 30 minutes and confirm that the temperature has been restored once the defrost cycle has completed. |



| | | |
|--|---|--|
| | <p>Food is not packaged correctly.</p> | <p>Food stored uncovered or unwrapped damp containers can lead to moisture accumulation within each compartment. Wipe all containers dry and store in sealed packaging to prevent condensation and frost.</p> |
|--|---|--|



COOLING/ICE & WATER

| Problem | Possible Causes | Solutions |
|--|--|--|
| Food is freezing in the refrigerator compartment. | Food with high water content was placed near an air vent. | Rearrange items with high water content away from air vents. |
| | Refrigerator temperature control is set incorrectly. | If the temperature is too cold, adjust control one increment at a time and allow the temperature to stabilize. |
| | Refrigerator is installed in a cold location. | When the refrigerator is operated in temperatures below 41°F (5°C), food may freeze in the refrigerator compartment. The refrigerator should not be operated in temperatures below 55°F (13°C). |
| Frost or ice crystals form on frozen food (outside of package). | Door is opened frequently or for long periods of time. | When the doors are opened often or for long periods of time, warm, humid air enters the compartment. This raises the temperature and moisture level within the compartment. Increased moisture will lead to frost and condensation. To lessen the effect, reduce the frequency and duration of door openings. |
| | Door is not closing properly. | Refer to the Doors will not close completely pop open section in the Troubleshooting section. |
| Refrigerator or Freezer section is too cold. | Incorrect temperature control settings. | If the temperature is too cold, adjust control one increment at a time and allow the temperature to stabilize. Refer to the Setting the Controls section for more information. |
| Frost or ice crystals on frozen food | Condensation from food with a high water content has frozen inside of the food package. | This is normal for food items with a high water content. |



| | | |
|---|--|--|
| (inside of sealed package). | Food has been left in the freezer for a long period of time. | Do not store food items with high water content in the freezer for a long period of time. |
| Icemaker is not making enough ice. | Demand exceeds ice storage capacity. | The icemaker will produce approximately 70-210 cubes in a 24 hour period. |
| | House water supply is not connected, valve is not turned on fully, or valve is clogged. | Connect the refrigerator to a cold water supply with adequate pressure and ensure the water shutoff valve is fully open. If the problem persists, it may be necessary to contact a plumber. |
| | Water filter has been exhausted. | It is recommended that you replace the water filter: <ul style="list-style-type: none"> • Approximately every six months. • When the water filter indicator turns on. • When the water dispensing rate noticeably decreases. • When the ice cubes are smaller than normal. |
| | Low house water supply pressure. | The water pressure must be between 40 and 120 psi on models without a water filter and between 40 and 120 psi on models with a water filter. |
| | Reverse Osmosis filtration system is used. | Reverse osmosis filtration systems reduce the water pressure below the minimum required amount and result in icemaker issues. (See the section on Water Pressure to Water Pressure section.) |
| | Tubing connecting refrigerator to house supply valve is kinked. | Straighten or repair the water supply tubing and arrange it to prevent future kinks. |



ICE & WATER

| Problem | Possible Causes | Solutions |
|--|--|--|
| <p>Icemaker is not making enough ice (continued).</p> | <p>Doors are opened often or for long periods of time.</p> | <p>If the doors of the unit are opened often, ambient air will warm the refrigerator. This will prevent the unit from maintaining the set temperature. Lowering the refrigerator temperature can help, as well as not opening the doors as frequently.</p> |
| | <p>Doors are not closed completely.</p> | <p>If the doors are not properly closed, ice production will be affected. See the Troubleshooting section in Parts & Features Troubleshooting for more information.</p> |
| | <p>The temperature setting for the freezer is too warm.</p> | <p>The recommended temperature for the freezer compartment for normal ice production is 0°F. If the freezer temperature is warmer, ice production will be affected.</p> |
| <p>Dispensing water slowly.</p> | <p>Water filter has been exhausted.</p> | <p>It is recommended that you replace the water filter:</p> <ul style="list-style-type: none"> • Approximately every six months. • When the water filter indicator light comes on. • When the water dispensing rate decreases. • When the ice cubes are smaller than normal. |
| | <p>Reverse osmosis filtration system is used.</p> | <p>Reverse osmosis filtration systems can reduce the water pressure below the minimum amount and result in ice-making issues.</p> <p>If the problem persists, it may be necessary to contact a plumber.</p> |



| | | |
|-----------------------------------|--|---|
| | <p>Low house water supply pressure.</p> | <p>The water pressure must be between 40 and 120 psi on models without a water filter. The water pressure must be between 120 psi on models with a water filter.</p> <p>If the problem persists, it may be necessary to contact a plumber.</p> |
| <p>Not dispensing ice.</p> | <p>Doors are not closed completely.</p> | <p>Ice will not dispense if any of the refrigerator doors are left open.</p> |
| | <p>Infrequent use of the dispenser.</p> | <p>Infrequent use of the ice dispenser can cause the cubes to stick together, which will prevent them from properly dispensing. Check the ice bin for clumping/sticking together. If the ice is clumped, break up the ice cubes to allow for normal operation.</p> |
| | <p>The delivery chute is clogged with frost or ice fragments.</p> | <p>Eliminate the frost or ice fragments by removing the ice bin and clearing the chute with a plastic utensil. Dispensing water can also help prevent frost or ice buildup.</p> |
| | <p>The dispenser display is locked.</p> | <p>Press and hold the Lock button for 3 seconds to unlock the control panel of the dispenser.</p> |
| | <p>Ice bin is empty.</p> | <p>It may take up to 24 hours for each compartment to reach the desired temperature and for the icemaker to start making ice. Make sure that the sensor (if applicable) is not obstructed.</p> <p>Once the ice supply in the bin has been completely exhausted, it may take 15-20 minutes before additional ice is available and approximately 24 hours to completely refill the bin.</p> |



| Problem | Possible Causes | Solutions |
|---|---|--|
| <p>Icemaker is not making ice.</p> | <p>Refrigerator was recently installed or icemaker recently connected.</p> | <p>It may take up to 24 hours for each compartment to reach the desired temperature and for the icemaker to start making ice.</p> |
| | <p>Icemaker not turned on.</p> | <p>Locate the icemaker ON/OFF switch and confirm that it is in the ON (I) position.</p> |
| | <p>The ice detecting sensor is obstructed.</p> | <p>Foreign substances or frost on the ice detecting sensor can interfere with ice production. Make sure that the sensor is clean at all times for proper operation.</p> |
| | <p>The refrigerator is not connected to a water supply or the supply shutoff valve is not turned on.</p> | <p>Connect the refrigerator to the water supply and turn the water shutoff valve to the ON position.</p> |
| | <p>Icemaker shutoff (arm or sensor) obstructed.</p> | <p>If your icemaker is equipped with a shutoff arm, make sure that the arm is free to move freely. If your icemaker is equipped with an electronic ice shutoff sensor, make sure there is a clear path between the sensors.</p> |
| | <p>Reverse osmosis water filtration system is connected to your cold water supply.</p> | <p>Reverse osmosis filtration systems can reduce the water pressure below the minimum amount and result in icemaker issues. (Refer to the Water Pressure section.)</p> |
| <p>Not dispensing water.</p> | <p>New installation or water line recently connected.</p> | <p>Dispense 2.5 gallons of water (flush for approximately 5 minutes) to remove trapped air and contaminants from the system. Do not dispense the entire gallon amount continuously. Depress</p> |



| | |
|--|---|
| | release the dispenser pad for cycles of 30 seconds ON and 60 seconds OFF. |
| The dispenser panel is locked. | Press and hold the Lock button for 3 seconds to unlock the control panel and the dispenser. |
| The dispenser is not set for water dispensing. | The dispenser can be set for ice or water. Make certain that the control panel is set for the proper operation. Press the Water button on the control panel to dispense water. |
| Refrigerator or freezer doors are not closed properly. | Water will not dispense if any of the refrigerator doors are left open. |
| Water filter has been recently removed or replaced. | After the water filter is replaced, dispense 2.5 gallons of water (flush for approximately 5 minutes) to remove trapped air and contaminants from the system. Do not dispense the entire 2.5 gallon amount continuously. Depress and release the dispenser pad for cycles of 30 seconds ON and 60 seconds OFF. |
| Tubing connecting refrigerator to house supply valve is kinked. | The tubing can kink when the refrigerator is moved during installation or cleaning, resulting in reduced water flow. Stop the refrigerator and repair the water supply line and tubing to prevent future kinks. |
| The house water supply is not connected, the valve is not turned on fully, or the valve is clogged. | Connect the refrigerator to the water supply and turn the water shutoff valve to the ON position. If the problem persists, it may be necessary to contact a plumber. |



| Problem | Possible Causes | Solutions |
|----------------------------|--|--|
| Ice has bad taste or odor. | Water supply contains minerals such as sulfur. | A water filter may need to be installed to eliminate taste and odor problems. NOTE: In some cases, a filter may not be possible to remove a taste or odor / taste in all water supplies. |
| | Icemaker was recently installed. | Discard the first few batches of discolored or bad tasting ice. |
| | Ice has been stored for too long. | Ice that has been stored for too long will shrink, become cloudy, and may have a stale taste. Throw away old ice and use a new supply. |
| | The food has not been stored properly in either compartment. | Rewrap the food. Odors may migrate to the ice if food is not wrapped properly. |
| | The interior of the refrigerator needs to be cleaned. | See the Care and Cleaning section for more information. |
| | The ice storage bin needs to be cleaned. | Empty and wash the bin (discard old ice). Make sure that the bin is completely dry before reinstalling it. |
| Dispensing warm water. | Refrigerator was recently installed. | Allow 24 hours after installation for the water storage tank to cool completely. |
| | The water dispenser has been used recently and the storage tank was exhausted. | Depending on your specific model, the storage capacity will range from approximately 20 to 30 oz. |
| | Dispenser has not been used for several hours. | |



| | | |
|---|---|--|
| | | <p>If the dispenser has not been used for several hours, the first glass dispensed may be warm. Discard the first 10 oz.</p> |
| | <p>Refrigerator is connected to the hot water supply.</p> | <p>Make sure that the refrigerator is connected to a cold water pipe.</p> <p>A WARNING: Connecting the refrigerator to a hot water line may damage the icemaker.</p> |
| <p>Water has bad taste or odor.</p> | <p>Water supply contains minerals such as sulfur.</p> | <p>A water filter may need to be installed to eliminate taste and odor problems.</p> |
| | <p>Water filter has been exhausted.</p> | <p>It is recommended that you replace the water filter:</p> <ul style="list-style-type: none"> • Approximately every 6 months. • When the water filter indicator light comes on. • When the water dispensing rate decreases. • When the ice cubes are smaller than normal. |
| | <p>Refrigerator was recently installed.</p> | <p>Dispense 2.5 gallons of water (flush) for approximately 5 minutes to remove air and contaminants from the system. Do not dispense the entire 2.5 gallons continuously. Depress and release the dispenser pad for cycles of 30 seconds ON and 60 seconds OFF.</p> |
| <p>Icemaker is making too much ice.</p> | <p>Icemaker shutoff (arm/sensor) is obstructed.</p> | <p>Empty the ice bin. If your icemaker is equipped with an ice shutoff arm, make sure that the arm moves freely. If your icemaker is equipped with the electronic ice shutoff sensor, make sure that there is a 1/4 inch gap between the two sensors. Reinstall the ice bin and wait 24 hours to confirm normal operation.</p> |



NOISE



| Problem | Possible Causes | Solutions |
|------------------|--|---|
| Clicking | The defrost control will click when the automatic defrost cycle begins and ends. The thermostat control (or refrigerator control on some models) will also click when cycling on and off. | Normal Operation |
| Rattling | Rattling noises may come from the flow of refrigerant, the water line on the back of the unit, or items stored on top of or around the refrigerator. | Normal Operation |
| | Refrigerator is not resting solidly on the floor. | Floor is weak or uneven or leveling need to be adjusted. See the Door Alignment section. |
| | Refrigerator with linear compressor was jarred while running. | Normal Operation |
| Whooshing | Evaporator fan motor is circulating air through the refrigerator and freezer compartments. | Normal Operation |
| | Air is being forced over the condenser by the condenser fan. | Normal Operation |
| Gurgling | Refrigerant flowing through the cooling system. | Normal Operation |



| | | |
|--|---|---|
| Popping | Contraction and expansion of the inside walls due to changes in temperature. | Normal Operation |
| Sizzling | Water dripping on the defrost heater during a defrost cycle. | Normal Operation |
| Vibrating | If the side or back of the refrigerator is touching a cabinet or wall, some of the normal vibrations may make an audible sound. | To eliminate the noise, make sure sides and back cannot vibrate against wall or cabinet. |
| Dripping | Water running into the drain pan during the defrost cycle. | Normal Operation |
| Pulsating or High-Pitched Sound | Your refrigerator is designed to run more efficiently to keep your food items at the desired temperature. The high efficiency compressor may cause your new refrigerator to run longer than your old one, but it is still more energy efficient than previous models. While the refrigerator is running, it is normal to hear a pulsating or high-pitched sound. | Normal Operation |



PARTS & FEATURES



| Problem | Possible Causes | Solutions |
|---|---|---|
| <p>Doors will not close correctly or pop open.</p> | <p>Food packages are blocking the door open.</p> | <p>Rearrange food containers to clear door and door shelves.</p> |
| | <p>Ice bin, crisper cover, pans, shelves, door bins, or baskets are out of position.</p> | <p>Push bins all the way in and put crisper cover, pans, shelves and baskets in correct positions. See the Using Your Refrigerator section for more information.</p> |
| | <p>The doors were removed during product installation and not properly replaced.</p> | <p>Remove and replace the doors according to the Removing and Replacing Refrigerator Handles and Doors section.</p> |
| | <p>Refrigerator is not leveled properly.</p> | <p>See Door Alignment in the Refrigerator Installation section to level refrigerator.</p> |
| <p>Doors are difficult to open.</p> | <p>The gaskets are dirty or sticky.</p> | <p>Clean the gaskets and the surface of the door with a soft cloth. Rub a thin coat of appliance polish or kitchen wax on the gaskets after cleaning.</p> |
| | <p>Door was recently closed.</p> | <p>When you open the door, warmer air enters the refrigerator. As the warm air cools, it can create a vacuum. If the door is difficult to open, wait one minute to allow the air pressure to equalize, then see if it opens more easily.</p> |
| <p>Refrigerator wobbles or seems unstable.</p> | <p>Leveling legs are not adjusted properly.</p> | <p>Refer to the Leveling and Door Alignment section.</p> |
| | <p>Floor is not level.</p> | <p>It may be necessary to add shims under the leveling legs or rollers to complete the installation.</p> |



| | | |
|---|--|---|
| Lights do not work. | LED interior lighting failure. | The refrigerator compartment lamp, LED interior lighting, and service should be performed by a qualified technician. See the Light Bulb Replacement section for more information. |
| Refrigerator has an unusual odor. | The Air Filter may need to be set to the MAX setting or replaced. | Set the Air Filter to the MAX setting. If the odor does not go away within 24 hours, the air filter may need to be replaced. See the Replacing the Air Filter section for more information and replacement instructions. |
| The interior of the refrigerator is covered with dust or soot. | The refrigerator is located near a fire source, such as a fireplace, chimney or candle. | Make sure that the refrigerator is not located near a fire source, such as a fireplace, chimney or candle. |

Warning

This content is compiled from multiple sources and is provided for reference purposes only. It may not be complete or fully applicable to all situations. If you are unable to resolve your issue, please contact the product manufacturer or an authorized service provider for official support.

