

PARTS DIAGRAM



- 1. Front Water Reservoir Lid
- 2. Coffee Scoop
- 3. Carafe
- 4. Warming Plate
- 5. Control Panel

- 6. Removable Filter Basket
- 7. Front Loading Brew Basket Door
- 8. Removable Splash Guard
- 9. Water Window

Control Panel

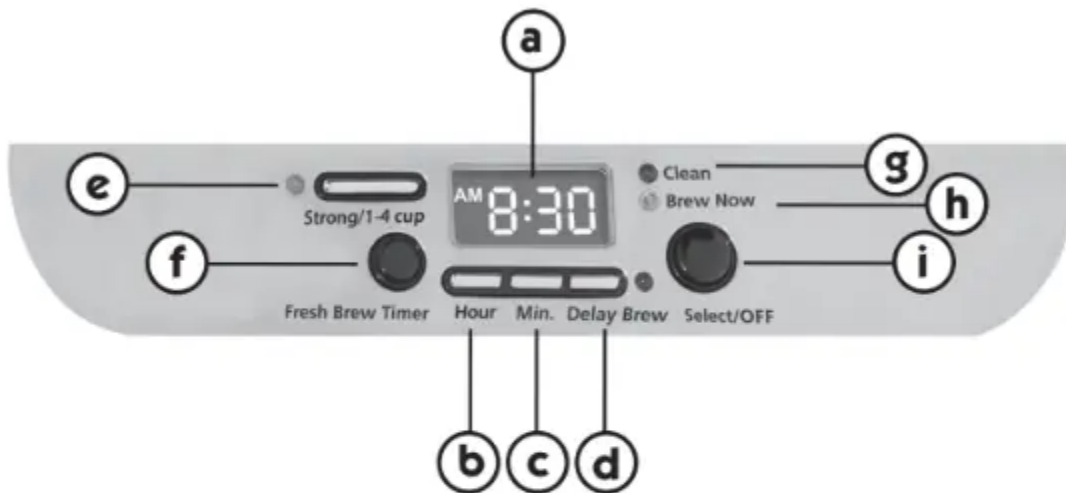

- a. Clock Display
- b. Hour Button
- c. Minute Button
- d. Delay Brew Button/Indicator
- e. Strong/1-4 Cup/Indicator
- f. Fresh Brew Timer Button
- g. Clean Cycle Indicator
- h. Brew Now Indicator
- i. Select/Off Button

Coffeemaker Extras (not included in all models)



**Mr. Coffee™ Brand
Water Filtration
System**
Frame Part Number: 189274
Replacement Disk Part Number:
113035



**Mr. Coffee™ Brand
Gold Tone
Reusable Filter**
Part Number: 189275



**Mr. Coffee™ Brand
10-12 cup Basket-Style
Paper Filters**



**Mr. Coffee™ Brand
Coffee Scoop**
Part Number: 189273

COFFEEMAKER FEATURES AND BENEFITS

Your new Mr. Coffee® coffeemaker has the following features:

- **PRESOAK FEATURE** – This feature presoaks your coffee with water to release more flavor. The effect is similar to the pour-over artisan coffee-making process “blooming,” which fully extracts your grounds to create a fuller, richer taste.

- **EASY FRONT ACCESS** – The design of this coffeemaker makes it easy to fill the water reservoir and add coffee grounds to the filter basket from the front of the coffeemaker saving you time when you need it most.
- **FRONT LOADING BREW BASKET DOOR** – Swings open and close to easily add your coffee grounds.
- **GRAB-A-CUP AUTO-PAUSE** – When you need a cup before brewing is finished, carefully remove the carafe and the grab-a-cup auto-pause feature will automatically activate, temporarily stopping the flow of coffee into the carafe.
- **REMOVABLE FILTER BASKET** – The removable filter basket has more capacity to hold coffee grounds compared to our other coffeemakers, so you can add more coffee for a bolder cup.
- **WATER WINDOW** – No Overflow! See exact water level as you fill.
- **WARMING PLATE** – This warming plate was designed with a lower wattage heater to allow you to keep your coffee hot after brewing. It's also non-stick, so your carafe slides smoothly on and off the warming plate.
- **STRONG/1-4 CUP BUTTON** – Select this feaure for a bolder, more full- bodied flavor coffee and use when brewing 1-4 cups for the best extraction of flavor from a smaller amount of coffee.
- **WATER FILTRATION (IF INCLUDED)** – Great tasting coffee begins with great water. We suggest using filtered water along with the included Mr. Coffee® carbon-based water filtration system. During the brewing process the filtration system helps remove up to 97% of chlorine from the water and improves the taste of your coffee.
- **CORD STORAGE** – Safely stores excess cord to keep your countertop neat.
- **TWO-HOUR AUTO SHUT-OFF** – Automatically turns off coffeemaker so you don't have to.

PROGRAMMABLE CONTROLS:

- **CLOCK** – The clock serves as a handy kitchen clock and displays the time for Delay Brew and Fresh Brew™ Timer features.
- **FRESH BREW™ TIMER** – Tracks the freshness of coffee since the last brew.
- **DELAY BREW** – Would you like to wake up to a fresh pot of coffee? The timer allows you to preset when you would like the coffeemaker to automatically begin brewing your coffee, up to 24 hours in advance.
- **SPECIAL CLEANING CYCLE** – Enables you to easily maintain and clean mineral deposits from your coffeemaker

NOTE: If you have selected any of the operating functions, the coffeemaker will act upon the last operation selected if the power is restored within 10 seconds after a power outage.

Unpack Your Coffeemaker

1. Unpack your coffeemaker and remove plastic bags, cartons and any tape adhered to the unit. Important: Keep plastic bags away from children.
2. Remove literature.
3. Read literature and save for future reference.

Before First Use or After Long Storage

Make sure your first cup of coffee is as good as can be by cleaning your Mr. Coffee® coffeemaker before its first use. Just follow these simple steps:

1. Wash the Carafe, Carafe lid, Removable Splash Guard, Reusable Filter (if included) and the Removable Filter Basket in a mixture of mild detergent and water. (Figure 1) Rinse each part and the Water Filtration Frame and Disk (if included) in water thoroughly. (Refer to the PARTS DIAGRAM section)



2. Run a brew cycle with water only. Do not add coffee, paper or reusable filter. Make sure the Carafe and Removable Filter Basket are securely in place and close the Front Loading Brew Basket door. (Figure 2)



3. When brewing is complete, turn the coffeemaker off, discard the water in the Carafe and rinse the Carafe, Carafe lid, Removable Splash Guard and Removable Filter Basket. (Figure 3)



Your coffeemaker is now ready to use. Enjoy!

CAUTION: Do not place or immerse cord, plug, or appliance in water or other liquid.

SETTING THE CLOCK

1. Plug power cord into a standard electrical outlet. (Figure 4) The digital clock flashes "AM 12:00" indicating the time needs to be set.

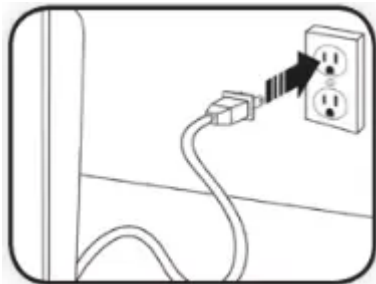

2. To change the time, press the Hour and Minute buttons until you reach the current time. (Figure 5)



Figure 5

The clock is now set!

SETTING DELAY BREW TIME:

Important: You must set the clock before using this feature. Pressing the Delay Brew button before setting the clock will result in the clock keeping time from 12:00 a.m.

1. Press the Delay Brew button. The Delay Brew indicator light will flash and the digital clocks flashes "AM". To set desired brew time, press the Hour and Minute buttons. Figure 6)



2. Press the Delay Brew button again to accept the time. The Delay Brew indicator light will remain lit. The coffeemaker is now set to automatically brew coffee at the preset later time. (Figure 7)



TIP: If you wait a few seconds to press the button, the display changes back to current time of day.

Note: To cancel Delay Brew once it is set, press the Delay Brew button once and the Delay Brew indicator light will turn off.(Figure 8)



Figure 8

3. Refer to steps 1-8 in the BREWING COFFEE NOW section for instructions on adding water and coffee to the coffeemaker.

4. Refer to BREWING COFFEE LATER section for more information on brewing coffee at a later time.

5. To check the preset time while Delay Brew is active, press the Delay Brew button twice. The Delay Brew indicator will flash and the clock will display the preset time the coffeemaker is set to brew coffee. (Figure 8)

Note: To check the Delay Brew time when it is not active (Delay Brew indicator light is not lit) press the Delay Brew button once.

Preparing For Use

Selecting and Measuring Ground Coffee:

For best results, use medium ground coffee and the Coffee Scoop that is included with your coffeemaker for accurate measurements. Coffee experts agree that one factor to create the perfect cup is using more coffee. This coffeemakers

Removable Filter Basket holds more capacity for coffee grounds compared to our other coffeemakers. Use the suggested coffee measurements as a guide for creating your perfect cup.

Suggested Coffee Measurement Chart:

To Brew	Ground Coffee	1 level scoop = 1 tablespoon = 5 gr./0.17 oz./15 ml 1 cup = 5 fl. oz. /148 ml of brewed coffee Use more or less coffee to suit your taste *(max 60 grams of ground coffee) Caution: The maximum capacity for ground coffee is 12 rounded tablespoons/scoops. Exceeding this amount or using fine coffee may cause overflow.
12 Cups	12 scoops	
10 Cups	10 scoops	
8 Cups	8 scoops	
6 Cups	6 scoops	
4 Cups	4 scoops	

BREWING COFFEE NOW

There are two convenient ways to add water to your Mr. Coffee® coffeemaker:

1. Lift up the front water reservoir lid and pour in cold, fresh filtered water until the water window fills to the desired capacity. (Figure 9)



Figure 9

TIP: This is convenient if the back of your coffeemaker is underneath a cabinet or other obstruction.

2. You can also pour water directly into the reservoir through the back lid by sliding the rear reservoir lid back and pour water.



Figure 10

TIP: This is convenient for cleaning/ descaling the inside of the reservoir.

Note:

- For easy and accurate filling, the water markings on the glass Carafe and on the water window show the amount of water needed to make the corresponding desired number of cups.
- Do not fill past the “12 cup MAX line” on the water window or water will flow out of the overflow hole in the back of the coffeemaker. (Figure 11)
- The amount of coffee brewed will always be slightly less than the amount of water poured in the water reservoir. This is due to absorption of water by the coffee grounds.

- Make sure the Carafe is securely placed on the warming plate or the water and the grounds will overflow from the Removable Filter Basket.

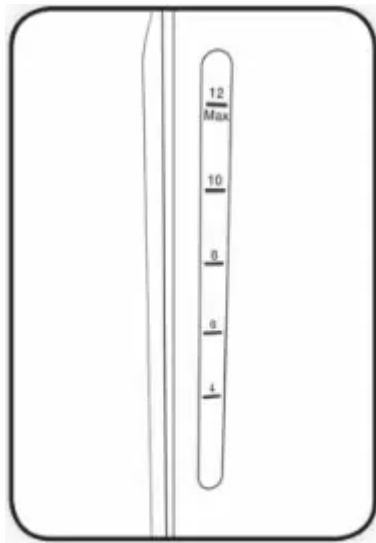

Figure 11

CAUTION: To reduce the risk of personal injury or damaging the carafe, do not add cold water to the carafe if it is hot. Allow it to cool before using.



Figure 12

3. Open the Front Loading Brew Basket door. (Figure 12)



Figure 13

4. Place 10-12 cup basket-style paper filter or Reusable Filter in Removable Filter Basket (Figure 13) **Note:** The Removable Filter Basket can remain in the Front Loading Brew Basket door.



Figure 14

5. Use the included Coffee Scoop to add the desired amount of coffee. (Figure 14) (Refer to SUGGESTED COFFEE MEASUREMENT section).

Note: If using 10-12 cup basket-style paper filters, the sides of the filter must fit flush against the side of the Removable Filter Basket. If filter collapse occurs, dampen the filter before placing in the Removable Filter Basket and adding ground coffee.



Figure 15

6. If included, place the Water Filtration Disk with Frame on top of the Removable Filter Basket. (Refer to the USING THE WATER FILTRATION SYSTEM section). (Figure 15) **Note:** Water Filtration Frame must sit flat on the top of the Removable Filter Basket.

TIP: For optimum results, use the water filtration system with a reusable filter (not included with all models).

7. Make sure the Carafe and the Removable Filter Basket are securely in place.

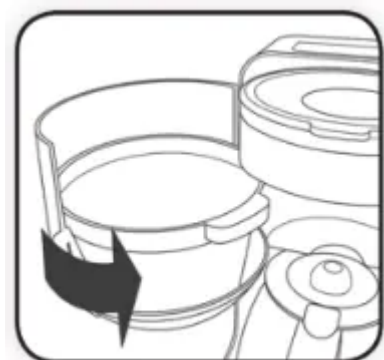

Figure 16

8. Close the Front Loading Brew Basket door. (Figure 16)

CAUTION: Do not open until the brew cycle is complete and coffeemaker is cooled.

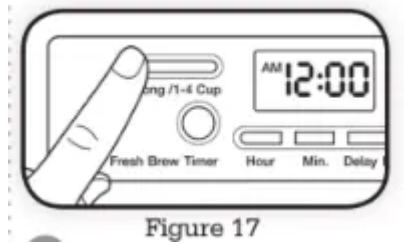

Figure 17

9. To enjoy a bolder cup of coffee or if brewing 4 cups or less, press the Strong/1-4 Cup Button now. (Figure 17) (Refer to the STRONG/1-4 CUP BUTTON section)

Note: You cannot turn off the Strong/1-4 cup mode once brewing has started.

TIP: During the presoak process there may be up to 2 cups of brewed coffee in the carafe.



Figure 18

10. Turn the coffeemaker on by pressing the Select/Off button once. (Figure 18) The Brew Now indicator light will turn on and pulse to signal that the coffeemaker is on and brewing coffee.

11. Once the brew cycle begins, the presoak process will begin by presoaking the coffee grounds. The coffeemaker will pause for 30 seconds before the full brew cycle begins. As the brew cycle continues, the water control system will evenly distribute water over the coffee grounds for full flavor extraction. (Refer to the PRESOAK FEATURE section) **Note:** To deactivate this feature, press and hold the Select/Off button for 5 seconds.



Figure 19

12. After brewing is complete, an audible ready signal will sound to let you know your coffee is ready. (Figure 19)

Note: To deactivate the audible signal, press and hold the Delay Brew button for 5 seconds.

13. The coffeemaker warming plate will keep your coffee hot for 2 hours and then automatically turn off. To track the freshness of your coffee (Refer to the FRESH BREW™ TIMER section).

TIP: This coffeemaker has a low wattage heater in the warming plate to keep your coffee hot after brewing.



Figure 20

After the used coffee grounds have cooled, carefully open the Front Loading Brew Basket door and remove the paper or Reusable Filter and discard the grounds (Figure 20)

CAUTION: The brew basket door is hot after brewing. Always allow the coffeemaker to cool down before cleaning.



Figure 21

15. Prior to making a second pot of coffee, turn the coffeemaker off. This will reset the Fresh Brew™ Timer. To turn the coffeemaker off, press the Select/Off button once and all lights will turn off. (Figure 21)

10. Make sure the Carafe is empty before starting to brew coffee.

17. Be sure to turn your coffeemaker off when you are no longer using it.

Using the Water Filtration System

Congratulations! You are the owner of a MR.COFFEETM water filtration system. This carbon- based water filter improves the taste of your coffee by removing up to 97% of the chlorine from the water you use to brew your coffee. Before using, look for the Mr. CoffeeTM Water Filtration Friendly symbol on the bottom of your filter basket. If you do not see this symbol, please call 1-800-672-6333. If you see the symbol, follow these steps to use your filter:



Figure 19

1. Align the red indicator on the frame to the letter that corresponds with the month that you are using the disk for the first time. This serves to remind you to change the disk every month (approx. 30 brewing cycles).
2. When you are done brewing your coffee, rinse the water filter with fresh water. Do not put your water filter in the dishwasher.
3. To replace the water filter disks: slide the used disk from your water filtration system. To insert the new disk, slide disk into the frame.



Figure 20

Water Filtration Disk Replacement:

Your water filtration disk will need to be replaced once a month (approx. 30 brew cycles). If the machine will not be in use for an extended period of time, rinse the water filter with running water and clean the coffeemaker before use.

Replacement water filtration frames part number:189274 and disks can be purchased online at web mrcoffee or by calling 1-800-MRCOFFEE(1-800-672-6333) in the U.S. or 1-800-667-8623 in Canada.

Note: This coffeemaker uses Water Filtration Grey Frame part number 189274.



Figure 21

Strong/1-4 Cup Button

Select the Strong/1-4 Cup button to give any cup size a bolder taste. It is ideal for brewing 1-4 cups because it slows down the water flow to extract the water evenly over a smaller amount of coffee, which enhances strength and flavor for smaller batches. The result is bolder, more full-bodied cup of coffee. To activate, press the Strong/1-4 Cup button.

Note:This feature must be activated before you press Select/Off button to activate Brew Now. You cannot turn on/off this feature once brewing has started.

The coffeemaker will remain in Strong/1-4 Cup mode until you change it back to regular strength by pressing the Strong/1-4 Cup button again, or until you unplug the coffeemaker.

Presoak Feature

This feature presoaks your coffee with water to release more flavor. The effect is similar to the pour-over artisan coffee-making process “blooming”, which fully extracts your grounds to create a fuller, richer taste.

The Fresh Brew™ Timer Feature

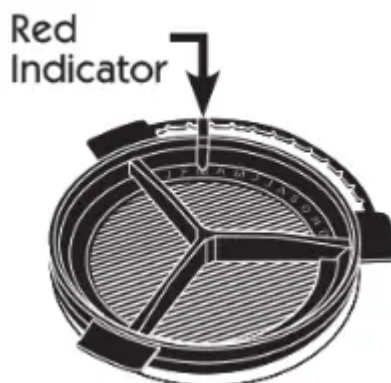

The Fresh Brew™ Timer tracks the freshness of coffee since the last brew. The timer automatically activates at the start of the brewing cycle. Press the Fresh Brew™ Timer button once and the clock will change to display the amount of time that has passed since brewing started. Push again to display current time. (Figure 22)

Note: The Brew Now indicator light must be lit for the Fresh Brew™ Timer feature to operate. The clock time and the Delay Brew time will not be displayed when the fresh brew time is displayed.

BREWING COFFEE LATER (DELAY BREW)



1. You must first set the time when you would like the coffeemaker to begin brewing your coffee as described in the SETTING THE DELAY BREW TIME section. (Figure 23)

2. Prepare your coffeemaker as described in steps 1-8 of the BREWING COFFEE NOW section.



3. Press the Strong/1-4 Cup button now to activate this feature at the preset later time. (Figure 24)

Note: The coffeemaker will remain in Strong/1-4 Cup mode until you change it back to regular strength by pressing the Strong/1-4 Cup button or until you unplug the coffeemaker.



Figure 22

4. At the preset time, the Brew Now indicator light will turn on and pulse. The Delay Brew indicator light will turn off, and the brew cycle will begin. (Figure 25)

5. The coffeemaker warming plate will keep your coffee hot for 2 hours and then automatically turn off. To track the freshness of your coffee, refer to the FRESH BREW TIMER section.

TIP: This coffeemaker has a low wattage heater in the warming plate to keep your coffee hot after brewing.

As a safety feature, your coffeemaker will not start again automatically the next day. If you want your coffee to brew at the same time the following day, simply add a new filter, coffee and water, and set Delay Brew by referring to SETTING THE DELAY BREW TIME section. To cancel Delay Brew, press the Delay Brew button once. The light will turn off.

CLEANING AND MAINTAINING YOUR COFFEEMAKER

Note: This appliance has no user-serviceable parts. Any servicing beyond that described in the CLEANING AND MAINTAINING YOUR COFFEEMAKER section should be performed by an Authorized Service Representative only.

Daily Cleaning:

CAUTION: Never immerse the coffeemaker itself in water, in any other liquid or place in the dishwasher.

1. Remove the Removable Splash Guard, Removable Filter Basket, Reusable Filter (If included), Carafe and Carafe lid and wash them in a solution of hot water and mild liquid soap. (Figure26)



Figure 26

2. Never use abrasive cleansers, steel wool pads or other abrasive materials. Dishwasher top rack safe parts: Carafe and lid, Removable Filter Basket and Reusable Filter. The Water Filtration Frame and Disk are not dishwasher safe. (Figure 27)



Figure 27

Regular Cleaning and Maintenance

The red Clean indicator light will turn on and flash to let you know that your coffeemaker needs to be cleaned. The red light will turn off after the clean cycle has been completed.

Decalcifying your MR. COFFEE® Coffeemaker

Minerals (calcium/limestone) found in water will leave deposits in your coffeemaker and affect its performance. To order the Mr. Coffee® cleaner, please call our Service Department at 1-800-MRCOFFEE (1-800-672-6333).

1. Follow package instructions to prepare one batch of Mr. Coffee® Cleaner. Pour the mixture into the water reservoir. Before decalcifying, remove the water filtration disk from the machine.

Note: cups or 20 fl. oz. / ml of undiluted, white household vinegar may be used as a substitute for the cleaner.

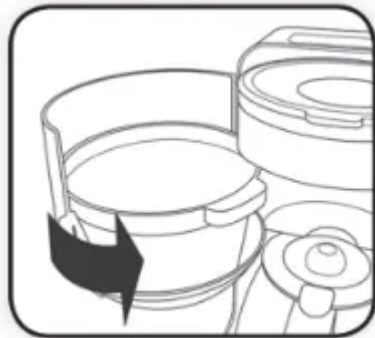

Figure 28

2. Place an empty Mr. Coffee® 10-12 cup basket-style paper filter or Mr. Coffee™ Reusable Filter into the Removable Filter Basket and close the Front Loading Brew Basket door. (Figure 28)

3. Place the empty Carafe on the warming plate. Make sure it is securely in place.

4. Press the Select/ Off button twice. The Clean indicator light will turn on. The clock display will show “CLn” for the duration of the clean cycle. For your convenience the cleaning cycle is automatic. The entire cycle will take 45-60 minutes to complete. During the cleaning cycle the coffeemaker will go through the following steps:

1. Slow brew approx. 3 cups of cleaning solution.
2. Pause for 30 minutes (the Clean indicator light will remain on to alert you that the process is active).
3. After 30 minutes, your coffeemaker will brew the remainder of the cleaning solution.
4. When complete, the coffeemaker will beep 3 times and the Clean indicator light will turn off and your coffeemaker will turn off.

5. Discard the cleaning solution and rinse the carafe thoroughly with clean water.

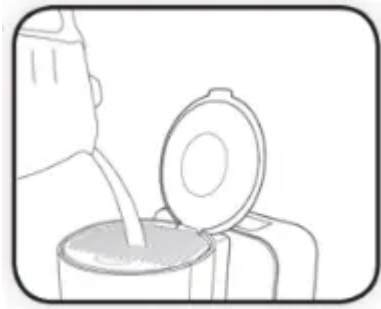

Figure 29

6. Fill the water reservoir with clean, fresh water. (figure 29)
7. Place the empty Carafe on the warming plate. Make sure it is securely in place.
8. Remove and discard the paper filter used during the cleaning cycle. If a Mr. Coffee™ Reusable Filter was used during cleaning, remove it and rinse it thoroughly before replacing it in the Removable Filter Basket.
9. Begin brewing and allow the full brew cycle to complete.
10. Repeat steps 5 through 9 one more time.

Your coffeemaker is now clean and ready to brew the next pot of delicious, hot coffee!

Cleaning the Carafe:

Hard water can leave a whitish stain on the carafe, and coffee may then turn this stain brown. To remove carafe stains:

1. Fill the carafe with a solution of equal parts water and vinegar and let the solution stand in the carafe for approximately 20 minutes. (Figure 30)

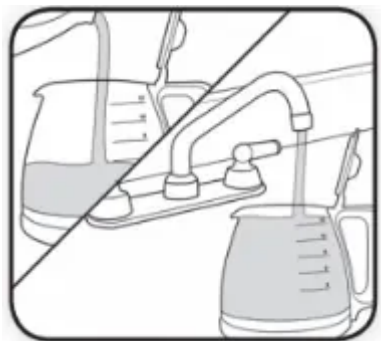

Figure 30

2. Discard the solution, then wash and rinse the carafe. (Figure 31)

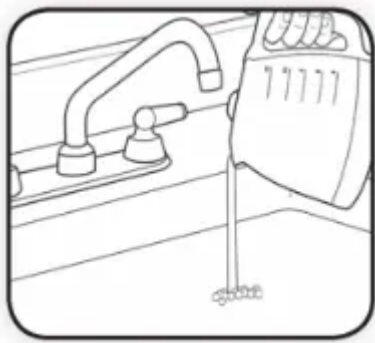

Figure 31

CAUTION: Do not clean carafe with cleansers, steel wool pads, or other abrasive material. (Figure 32)



Figure 32

TROUBLESHOOTING YOUR COFFEEMAKER

Your Mr. Coffee® coffeemaker has been carefully designed to give you many years of trouble-free service. In the unlikely event that your new coffeemaker does not operate satisfactorily, please review the following potential problems and try the steps recommended before you call an Authorized Sunbeam Service Center.

THE BREW NOW INDICATOR LIGHT DOES NOT TURN ON

- The appliance is unplugged.
 - PLUG UNIT IN.
- There is a power outage or the fuse for that outlet is blown.
 - WAIT FOR POWER TO BE RESTORED OR RESET FUSE, PLUG APPLIANCE ON A DIFFERENT OUTLET OR DO NOT RUN MANY APPLIANCES AT THE SAME TIME.

THE COFFEEMAKER IS NOT BREWING

- The appliance is unplugged.
 - PLUG UNIT IN.

- There is a power outage or the fuse for that outlet is blown.
 - WAIT FOR POWER TO BE RESTORED OR RESET FUSE, PLUG APPLIANCE ON A DIFFERENT OUTLET OR DO NOT RUN MANY APPLIANCES AT THE SAME TIME.
- The water reservoir is empty.
 - ADD WATER TO THE WATER RESERVOIR.
- The carafe is not securely placed on the warming plate.
 - PLACE CARAFE CORRECTLY ON WARMING PLATE.

THE COFFEEMAKER ONLY BREWS WATER

- There are no coffee grounds in the filter basket.
 - ADD THE DESIRED AMOUNT OF COFFEE TO THE FILTER.
- The Front Loading Brew Basket door was not securely closed.
 - MAKE SURE THE FRONT LOADING BREW BASKET DOOR IS SECURELY CLOSED.

THE COFFEEMAKER BREWS SLOWLY

- The coffeemaker needs cleaning.
 - CLEAN COFFEEMAKER AS DESCRIBED IN “CLEANING AND MAINTAINING” SECTION.
- The carafe was not securely placed on the warming plate.
 - PLACE THE CARAFE CORRECTLY ON WARMING PLATE.
- The Strong/1-4 cup button was activated.
 - THIS FEATURE SLOWS DOWN THE BREWING CYCLE. REFER TO THE STRONG/1-4 CUP SECTION.
- Presoak feature is activated.
 - IF THE PRESOAK FEATURE IS NOT DESIRED, DEACTIVATE IT BY PRESSING AND HOLDING THE SELECT/OFF BUTTON FOR 5 SECONDS.

THE COFFEE IS NOT HOT

- There's a power outage.
 - WAIT FOR POWER TO BE RESTORED OR TRY ANOTHER OUTLET.

- The coffeemaker shut off after hours.
 - THE 2 HOUR AUTO SHUT OFF FEATURE WAS ACTIVATED. FOR BEST RESULTS BREW A FRESH POT OF COFFEE.

THE FILTER BASKET OVERFLOWS

- The filter basket is not properly inserted.
 - INSERT FILTER BASKET CORRECTLY.
- The carafe is not securely placed on the warming plate.
 - PLACE CARAFE CORRECTLY ON WARMING PLATE.
- Too many coffee grounds were placed in the filter.
 - REMOVE FILTER, DISCARD GROUNDS. IF PAPER FILTER, REPLACE. IF REUSABLE FILTER, RINSE. START BREWING PROCESS AGAIN.
- The carafe was removed from the warming plate for more than 20 seconds.
 - TURN OFF AND UNPLUG THE UNIT. ALLOW TO COOL. WIPE UP THE SPILL. DO NOT SET HOT CARAFE BACK ON THE WET WARMING PLATE OR IT MIGHT CRACK.
- The front loading brew basket door was not securely closed.
 - MAKE SURE THE FRONT LOADING BREW BASKET DOOR IS SECURELY CLOSED.
- Paper filter has collapsed.
 - MAKE SURE THE SIDES OF THE PAPER FILTER ARE ALIGNED WITH THE WALL OF THE BREW BASKET.

THE COFFEE TASTES BAD

- Coffee grounds other than for an automatic drip coffeemaker were used.
 - USE COFFEE GROUNDS RECOMMENDED FOR AUTOMATIC DRIP COFFEEMAKERS.
- The ground coffee-to-water ratio was unbalanced.
 - USE CORRECT GROUND COFFEE-TO- WATER RATIO.
- The coffeemaker needs cleaning.
 - CLEAN COFFEEMAKER AS DESCRIBED IN “CLEANING AND MAINTAINING YOUR COFFEEMAKER” SECTION.
- Expired or stale coffee was used.
 - USE FRESHLY GROUND COFFEE.

THE GROUNDS ARE IN THE COFFEE

- The paper or reusable filter is not properly inserted in the removable filter basket.
 - PLACE FILTER PROPERLY WITHIN THE FILTER BASKET.
- Paper filter has collapsed.
 - REMOVE FILTER AND REPLACE.

LONG BREW CYCLE

- The presoak feature adds 30 -45 seconds to the brew time.
 - IF THE PRESOAK FEATURE IS NOT DESIRED, SHUT IT OFF BY PRESSING AND HOLDING THE SELECT/OFF BUTTON FOR SECONDS.

AUDIBLE SIGNAL SOUND IS LOUD

- The coffeemaker beeps to indicate the end of the brew and clean cycles.
 - TO SHUT OFF THE AUDIBLE SOUND. PRESS AND HOLD THE DELAY BREW BUTTON FOR 5 SECONDS.

Service and Maintenance

Replacement Parts:

- Coffee Filters – For better tasting coffee, we recommend that you use a Mr. Coffee® brand 10-12 cup basket-style paper filter or a Mr. Coffee™ brand permanent filter. These filters are available at most grocery stores.
- Water Filtration – Replacement water filtration frames (part number: 189274) and disk (part number: 113035) can be purchased online at web mrcoffee, or by calling 1-800-MRCOFFEE 1-800- in the U.S. or 1-800-667-8623 in Canada.
- Carafes – Replacement carafes (part number: 189270) can be purchased online at web mrcoffee, or call 1-800-MRCOFFEE, in the U.S. or 1-800-667-8623 in Canada for information on where you can find a store that carries replacement carafes.
- Coffee Scoop – Replacement coffee scoop (part number: 189273) can be purchased online at web mrcoffee, or by calling MRCOFFEE 1-800-672-6333 in the U.S. or 1-800-667-8623 in Canada.
- Filter Basket – Replacement Filter basket (part number: 189269) can be purchased online at web mrcoffee, or by calling 1-800-MRCOFFEE in the U.S. or 1-800-667-8623 in Canada.

Repairs:

If your coffeemaker requires service, do not return it to the store where you purchased it. All repairs and replacements must be made by Sunbeam or an authorized Sunbeam Service Center. If you live in the U.S. or Canada, please call us at the following toll-free telephone numbers to find the location of the nearest authorized service center:

U.S. 1-800-MRCOFFEE (1-800-672-6333)

Canada 1-800-667-8623

You may also visit our website at web.mrcoffee for a list of service centers.

To assist us in serving you, please have the coffeemaker model number and date of purchase available when you call. The model number is stamped on the bottom of the coffeemaker.

We welcome your questions, comments or suggestions.

In all your communications, please include your complete name, address and telephone number and a description of the problem.

PRODUCT REGISTRATION

Please visit web.mrcoffee register or call toll free at MRCOFFEE (1-800-672-6333) to register your new Mr. Coffee® product.

The registration will enable us to contact you in the unlikely event of a product safety notification. As part of our privacy policy, we never sell or giveaway your private information.

Visit our website at web.mrcoffee and discover the secret to brewing the perfect cup of coffee.

You will also find a rich blend of gourmet recipes, entertaining tips and the latest information on Mr. Coffee™ products.



See what's Brewing    

Warning

This content is compiled from multiple sources and is provided for reference purposes only. It may not be complete or fully applicable to all situations. If you are unable to resolve your issue, please contact the product manufacturer or an authorized service provider for official support.