

## Overview Of Your Washer

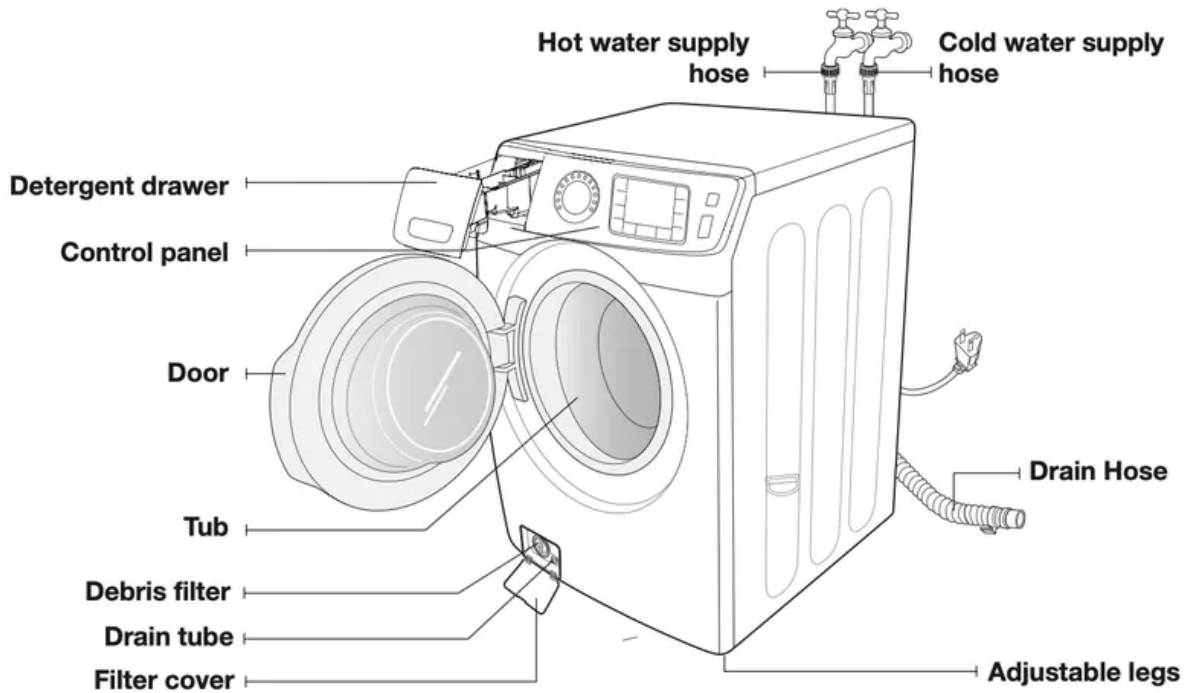

## Operating Instructions

**Warning:** To reduce the risk of fire, electric shock, or injury to persons, read the IMPORTANT SAFETY INSTRUCTIONS before operating this appliance.

### LOADING YOUR WASHER

- Fill the tub with dry, unfolded clothes evenly around in order to enhance washing efficiency and prevent excess wear, or wrinkling of the load.
- Wash delicate items such as bras, hosiery, and other lingerie in the Delicates cycle with similar lightweight items.
- When washing big bulky items or a few smaller items that don't fill the tub completely – a rug, a pillow, stuffed toys, or one or two sweaters, for example – add a few towels to improve tumbling and spin performance.

**Note:** During the spin cycle, the washer may add additional water to redistribute the clothes and correct an imbalance inside the drum.

- To ensure good cleaning result when washing heavily soiled loads, do not overload your washer.

- When the “” light is ON (see page 23), you can add or remove laundry items during a wash.
1. Press the **start/pause** Button.
  2. Wait for the Door Lock light to go out (5 seconds).
  3. Add the item, close the door, and press the **start/pause** Button. After a 10-second pause, the cycle will resume.

**Note:** To ensure thorough cleaning, add items within five minutes of starting the wash cycle.

## WASHING CLOTHES: BASIC INSTRUCTIONS

1. Press the power button, open the door, and then load the washer.
2. Close the door.
 

**CAUTION:** Push the laundry into the drum completely to prevent the laundry from being caught in the door or from falling out of the drum.
3. Add detergent and additives to the dispenser (see pages 28~29).
4. Select the appropriate cycle and options for the load (see pages 20 ~22 and 25).
5. Press the start/pause Button.
 

**Note:** The drum automatically rotates and measures the weight of the laundry without supplying water in order to adjust the wash time. (The rotating display on the display panel indicates that the weight of the laundry is being measured.)
6. The Wash Indicator light will illuminate.
7. The estimated cycle time will appear in the display. The time may fluctuate to indicate the time remaining in the cycle.
 

**Note:** The actual time required for a cycle may differ from the estimated time in the display depending on the water pressure, water temperature, detergent, and laundry.
8. Before your washer starts to fill, it will make a series of clicking noises to check the door lock and do a quick drain.
 

**Note:**  
When the cycle is complete, the Door Lock light will go out and “End” will appear in the display.  
DO NOT attempt to open the door until the Door Lock light is off. To add a forgotten item, see the “Loading your Washer” section above.  
When your washer is restarted after a pause, expect a delay of up to 15 seconds before the cycle continues.  
Pressing the **power** button cancels the cycle and stops your washer.  
The Pre Wash, Wash, Rinse, and Spin indicator lights will illuminate during those portions of the cycle.

**Warning:** Do not place anything on top of your washer while it is running.

# Washing a Load of Laundry

## OVERVIEW OF THE CONTROL PANEL

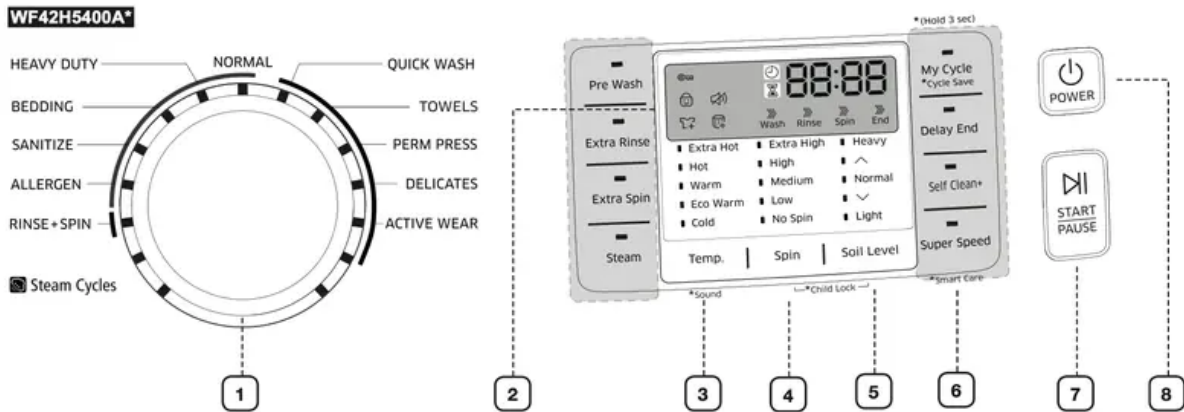

### 1 Cycle Selector

Select the appropriate cycle for the type of load.

This will determine the tumble pattern and spin speed for the cycle.

To minimize wrinkling of laundry, select the Perm Press cycle.

**HEAVY DUTY** - For sturdy, colorfast fabrics and heavily soiled garments.

**BEDDING** - For bulky items such as blankets, comforters and sheets. When you are washing bulky items, use liquid detergent.

**SANITIZE** - For heavily soiled, colorfast garments. This cycle heats the water to 150 °F to eliminate bacteria.

If you select pause during the heating portion of the Sanitize Cycle, your Washer door will remain locked for your safety.

When selecting this cycle, the water heats to an extra high temperature to remove 99.9% of certain bacteria typically found on clothing, bedding, or towels. This certification is conducted by NSF International, an independent third-party testing and certification organization. Please check the garment care label to avoid garment damage. Only sanitizing cycles have been designed to meet the requirements of this protocol for sanitization efficacy.



NSF Protocol P172  
Sanitization Performance of Residential and Commercial, Family-Sized Clothes Washers

**ALLERGEN** - This course is applied to remove dust mites, pet dander or other allergic substances of the fabric.

Only ALLERGEN cycle has been designed to meet the requirement of P351 for allergen reduction efficacy.



NSF Protocol P351  
Allergen Reduction Performance of Residential and Commercial, Family-Sized Clothes Washers

|  |   |
|--|---|
|  | <p><b>RINSE + SPIN</b> - Use for loads that need rinsing only or to add rinse-added fabric softener to a load.</p> <p><b>NORMAL</b> - For most fabrics including cottons, linens, and normally soiled garments.</p> <p><b>ECO COLD</b> - It provides useful daily care for normally and lightly soiled laundry by using only cold water, saving energy and caring fabric. (Only for WF42H5500A*)</p> <p><b>QUICK WASH</b> - For lightly soiled garments needed quickly.</p> <p><b>TOWELS</b> - For bath towels, washcloths, and mats. (Only for WF42H5400A*)</p> <p><b>PERM PRESS</b> - For wash-and-wear, synthetic fabrics, and lightly to normally soiled garments.</p> <p><b>DELICATES</b> - For sheer fabrics, bras, lingerie silk, and other handwash-only fabrics. For best results, use liquid detergent.</p> <p><b>ACTIVE WEAR</b> - Use this cycle to wash exercise wear such as sports jerseys, training pants, shirts/tops and other performance clothing. This cycle provides effective soil removal with gentle action for special fabric care.</p> |
| <p><b>2 Digital display</b></p>              | <p>The large Digital Display is easy to use. It provides instructions and diagnostics while keeping you updated on the cycle status and time remaining.</p>   |
| <p><b>3 Temperature selection button</b></p> | <p>Press the button repeatedly to cycle through the different water temperature options.</p> <p><b>Extra Hot</b> - Heavily soiled, colorfast items. Only available with the Sanitize cycle.</p> <p><b>Hot</b> - Whites and heavily soiled, colorfast items.</p> <p><b>Warm</b> - Colorfast items. When warm rinse is selected, only the final rinse will be warm.</p> <p>The other rinses will be cold to conserve energy.</p> <p><b>Eco Warm</b> - Moderately soiled, colorfast items; most wrinkle-free items.</p> <p><b>Cold</b> - Brightly colored, very lightly soiled items.</p>  |
| <p><b>4 Spin selection button</b></p>        | <p>Press the button repeatedly to cycle through the different spin speed options. (Rins hold (All Lamp Turn Off) → No Spin → Low → Medium → High → Extra High)</p> <p><b>Extra High</b> - Removes more water from loads during spin.</p> <p> To minimize wrinkling of wrinkle-free and no-iron fabrics, DO NOT use the Extra High spin option for these loads, nor overload your Washer.</p> <p><b>High</b> - Use for underwear, t-shirts, jeans and sturdy cottons.</p> <p><b>Medium</b> - Use for jeans, wrinkle-free or wash-and-wear items and synthetics.</p> <p><b>Low</b> - Use for delicate items needing a slow spin speed.</p> <p><b>No Spin</b> - Drains your Washer without spinning. Use for extremely delicate items that cannot tolerate any spin.</p> <p><b>Rinse Hold (All Lamp Turn Off)</b> - The laundry remains soaking in the final rinse water. Either a drain or spin cycle must be performed to unload the laundry.</p>                               |
| <p><b>5 Soil Level selection button</b></p>  | <p>Press the button to select the soil level/washing time. (Light → √ → Normal → ^ → Heavy)</p> <p><b>Heavy</b> - For heavily soiled loads.</p> <p>^</p> <p><b>Normal</b> - For moderately soiled loads. This setting is best for most loads.</p> <p>√</p> <p><b>Light</b> - For lightly soiled loads.</p>  |
| <p><b>6 Select Cycle Option</b></p>          | <p>Press these buttons to select different cycle options.</p> <p><b>Pre Wash</b> - To use this feature, add detergent to the pre wash section of the detergent compartment. When turned on, the washer fills with cold water and detergent, tumbles, then drains and advances to the selected wash cycle. Some cycles cannot be selected with this option (See page 27~28).</p> <p><b>Extra Rinse</b> - Add an additional rinse at the end of the cycle to remove laundry additives and perfumes more thoroughly.</p>   |

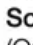
|                                       |   |
|---------------------------------------|---|
|                                       | <p><b>Extra Spin</b> - Add additional time to remove more water from loads.</p> <p><b>Steam</b> - Press this button to use the Steam Wash function. Steam Wash is available with the Normal, Heavy Duty, Bedding, Sanitize, Deep Steam and Allergen cycles. For heavily soiled, colorfast garments, Steam Wash improves stain treatment and uses less water (See page 26).</p> <p><b>Sound</b> - When you activate Sound off function, the “” lamp illuminates. (Only for WF42H5500A*)</p> <p><b>My Cycle</b> - Choose your favorite cycle including temperature, spin, soil level, options, etc. (see page 24)</p> <p><b>Delay End</b> - Any cycle can be delayed for up to 24 hours in one-hour increments. Displayed hour indicates the time at which the wash will be ended. (See page 23).</p> <p><b>Self Clean+</b> - Use to clean dirt and mold from the drum. Regular use (after every 40 washes) is recommended. No detergent or bleach is needed (see page 32).</p> <p><b>SuperSpeed</b> - Press this button if you need to shorten the washing time, applicable for Normal, Deep steam, Heavy Duty, Bedding or Allergen course. The shortened time may differ depending on the Course/Load/Option. (Only for WF42H5400A*)</p> |
| <b>7 Start/Pause selection button</b> | Press to pause and restart programs.  |
| <b>8 Power button</b>                 | Press once to turn your washer on, press again to turn your washer off. If the washer is left on for more than 10 minutes without any buttons being touched, the power automatically turns off.   |



## Child Lock

Child Lock prevents children from playing with your washer.

Once you have activated the Child Lock function, the control panel cannot be activated, preventing children from playing with the washer.

### Activating the Child Lock function

Press and hold both the **Soil Level** and **Spin** buttons simultaneously for 3 seconds.

- When you activate the Child Lock function, the door locks and the “Child Lock ” lamp illuminates.
- If you press the **start/pause** button after you have activated the Child Lock function, none of the buttons will work except for the **power** button.
- If you press a button when the buttons are locked, the “Child Lock ” lamp blinks.

### Pausing the Child Lock function

When the door is locked or the buttons are locked by the Child Lock function, you can pause the Child Lock operation for 1 minute by pressing and holding both the **soil level** and **spin** buttons simultaneously for 3 seconds.

- If you pause the Child Lock mode temporarily, the door lock is released for 1 minute for user convenience. During this period, the “Child Lock ” lamp blinks.

- If you open the door after the minute is over, an alarm sounds for up to 2 minutes.
- If you close the door within the 2 minutes, the door is locked and the Child Lock function is reactivated. If you close the door after the 2 minutes, the door is not locked automatically and no alarm sounds.

### Deactivating the Child Lock function

Press and hold both the **soil level** and **spin** buttons simultaneously for approximately 6 seconds.

- When you deactivate the Child Lock function, the door is unlocked and the “Child Lock



” is turned off.

### Warning:

- The Child Lock function prevents children or the infirm from accidentally operating the washer and warning injuring themselves.
- If a child enters the washing machine, the child may become trapped and suffocate.
- Once you have activated the Child Lock function, it continues working even if the power is turned off.
- Opening the door by force can result in injury due to damage to the product.

**Caution:** To add laundry after you have activated the Child Lock function, you must first pause or deactivate the Child Lock function.

**Note:** If you want to open the door of the washing machine when the Child Lock function is activated:

- Pause or deactivate the Child Lock function.
- Turn the washing machine off and then on again.

### Spin Only

If you press the power button and then press and hold the spin button for 3 seconds, the spin time will be displayed on the display panel.

Then, press the spin button repeatedly until the required spin level is selected, and then press the start/pause button.

**Note:** Before pressing the Spin Only button to use the Spin Only function, you can select a cycle with the Cycle Selector. If you have selected a cycle, you can only select the spin level corresponding to the selected cycle.

### Garment+

You can add or take out laundry items even after the wash has started, as long as the “” light is on. Pushing the **start/pause** button unlocks the door, unless the water is too hot or if there is too

much water in your washer. If you are able to unlock the door and wish to continue the wash cycle, close the door, and then press the **start/pause** button.

## Delay End

You can set the washing machine to start your wash automatically at a later time, choosing a delay time. The hour displayed indicates the time at which the wash will be ended.

1. Set your wash cycle.
2. Press the **Delay End** button repeatedly until the delay time is set.
3. Press the **start/pause** button. The “**Delay end**  ” indicator will be lit, and the clock will begin counting down until it reaches the set time.
4. To cancel a Delay End function, press the **power** button and then turn the washing machine on again.

## Sound

The Sound Off function can be selected during all cycle.

## My Cycle

Lets you save a custom wash cycle (temperature, spin, soil level, etc.) and then recall and use it with one button convenience.

To save a cycle and selected options as your My Cycle, follow these steps:

1. Select the cycle using the **Cycle Selector** dial.
2. After cycle selection, set each option.  
**Note:** See page 38~39 for available option settings with each cycle.
3. You can then store the selected cycle and options by pressing and holding the **My Cycle** button for longer than 3 seconds. The cycle and options you select will be displayed the next time you choose the My Cycle function.
4. Press the My Cycle button to load and use the saved My Cycle options. The “My Cycle” light will indicate activation. Also, the chosen cycle and option lights will flicker.

**Note:** You can change the “my Cycle” settings by repeating the process above. The washer displays the last settings used the next time you choose “my Cycle”.

**Note:** If you press My Cycle and release it within 3 seconds, the previously saved cycle and options appear. If you press and hold My Cycle for 3 second or longer, the currently set cycle and options are saved and the LED blinks for 3 seconds.

## Smart Care

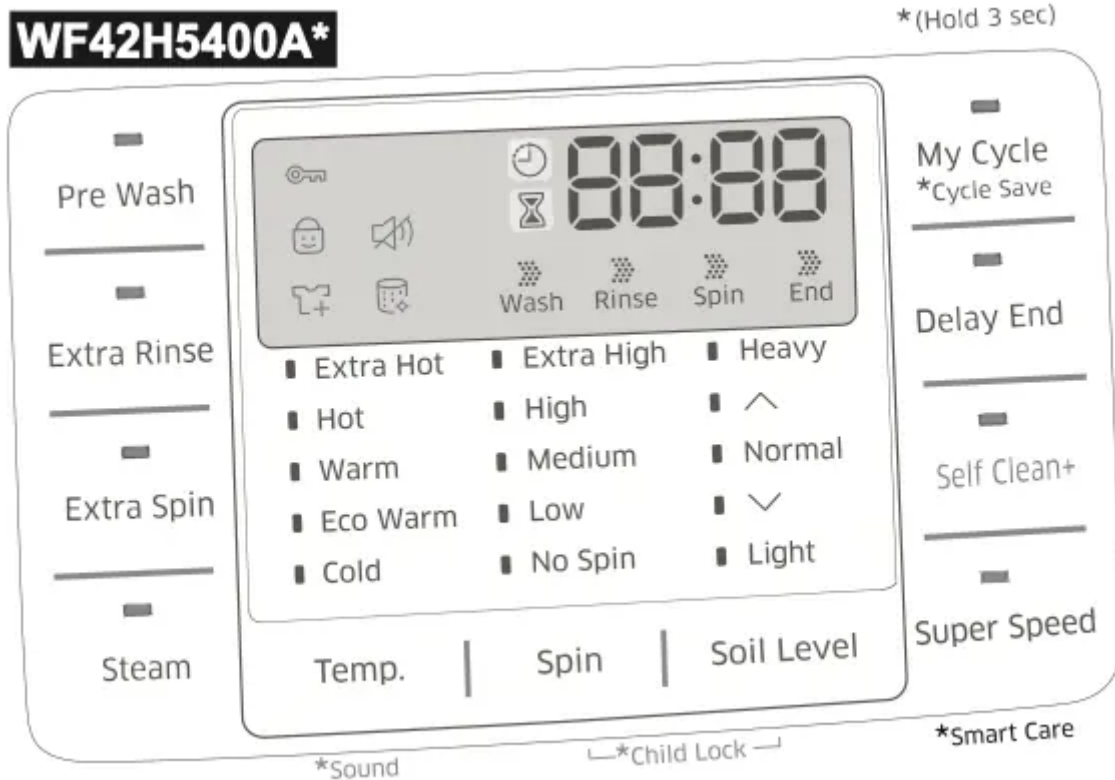

This function enables you to check the status of the washing machine using a smartphone.

1. To enable the Smart Care function, press and hold the WF42H5500A\* model press and hold the **Sound** button; WF42H5400A\* model Press the **Super Speed** button for 3 seconds within 10seconds after turning the **Power** on by pressing the power button.
2. If the Smart Care function is activated, the LED on the window display rotates for 2 or 3 seconds and then the Smart Care indicator is lit on the display.
3. Run the Smart Care app on your smart phone.
4. The Smart Care function is optimized with Galaxy and iPhone Series.
5. Focus your smart phone's camera on the display panel of the washing machine.
6. If the smart phone's camera is focused on the display panel of the washing machine, the panel and error message is automatically recognized and the error type and countermeasures are displayed on the smart phone.
7. If the smartphone fails to recognize the error code more than twice, please enter the error code displayed on the display panel of the washer manually into the Smart Care app.

**Note:** Downloading the Smart Care app

- Download the Samsung Laundry App into your mobile phone from the Android market or Apple App store. (**Search word : Samsung Smart Washer/Dryer**)

**Note:** Precautions when using Smart Care

- If a lighting device (e.g. fluorescent or lamp) is reflected on the display panel of the washing machine, the result on the display panel may not be recognized easily.
- If an error occurs more than twice, please manually enter the error code displayed on the display panel of the washing machine into the Smart Care app.
- If the angle of the smartphone camera and the display panel of the washing machine is incorrect, the error may not be recognized properly. Please try to hold the smart phone at an angle to the display panel as shown by the figure.

## Washing clothes using the cycle selector

Your new washing machine makes washing clothes easy, using Samsung's "Fuzzy Control" automatic control system. When you select a wash program, the machine will set the correct temperature, washing time, and washing speed.

1. Turn on your sink's water tap.
2. Press the Power button.
3. Open the door.
4. Load the articles of clothing one at a time loosely into the drum, without overfilling it.
5. Close the door.
6. Add detergent, softener, and pre-wash detergent (if necessary) into the appropriate compartments.

**Note:** Pre-wash is only available when selecting the Normal, Deep Steam, Heavy Duty, Bedding, Sanitize, Allergen, Active Wear, Perm Press, Towels (Only for WF42H5400A\* model), Eco Cold (Only for WF42H5500A\* model) cycles. It is only necessary if your clothing is heavily soiled.

7. Use the Cycle Selector to select the appropriate cycle according to the type of material: NORMAL, HEAVY DUTY, BEDDING, SANITIZE, ALLERGEN, RINSE+SPIN, ECO COLD (Only for WF42H5500A\* model), QUICK WASH, TOWELS (Only for WF42H5400A\* model), PERM PRESS, DELICATES, ACTIVE WEAR. The relevant indicators will illuminate on the control panel.
8. At this time, you can control the wash temperature, the number of rinse cycles, the spinning speed, and the delay time by pressing the appropriate option button.
9. Press the **start/pause** button on the Cycle Selector and the wash will begin. The process indicator will light up and the remaining time for the cycle will appear in the display.

## Pause Option

1. Within 5 minutes of starting a wash, it is possible to add/remove laundry items to/from the wash.

2. Press the Start/Pause button to unlock the door.
3. The door cannot be opened when the water is too HOT or the water level is too HIGH.
4. After closing the door, press the Start/Pause button to restart the wash.

When the cycle is finished: After the total cycle has finished, the power will turn off automatically.

1. Open the door.
2. Remove laundry.

## USING STEAM WASH

If you select steam, the steam acts at the most effective times for the detected amount of laundry, maximizing the effect of the steam, increasing the wash temperature, enhancing the Soak effect, and improving wash performance.

1. Load the washer.
2. Press the **Power** button.
3. Turn the Cycle Selector and select a **Steam Cycle**. (The Deep Steam cycle automatically selects Steam.)
4. Press the **Steam** button.
5. Add detergent to the dispenser tray and add fabric softener up to the marked line.
6. Press the **start/pause** button. The washer automatically selects the optimal wash conditions by sensing the weight of the laundry.

**Note:** Steam may not necessarily be visible during the steam cycles. Steam may not be present during the entire steam wash cycle.

## ATC (AUTO TEMPERATURE CONTROL)

ATC is the control function that the washer controls water temperature with temperature sensor (thermistor).

### NOTE:

- Because there are numerous water temperatures depending on the customer's environments (cold areas, warm areas, various water temperature, settings of heater temperature, etc), ATC function in our washer maintains the certain level of wash temperature to output the best washing performance at each cycle.
- If you select normal & heavy duty cycle, those courses are the regulation and UL cycle. Since new washer must reduce the amount of energy usage at first priority, customer will notice more cold water entering the washer. But this is Normal, not a problem.
- In those regulation cycle, Hot temperature is similar to acceptable adult bath-water temperature and warm temperature is similar to comfortable swimming-pool water temperature.

If customer want to wash clothes in specific water temperature, customer should choose a different cycle at each temperature (Hot/Warm/Eco Warm) .

## FEATURES

### Automatic dispenser

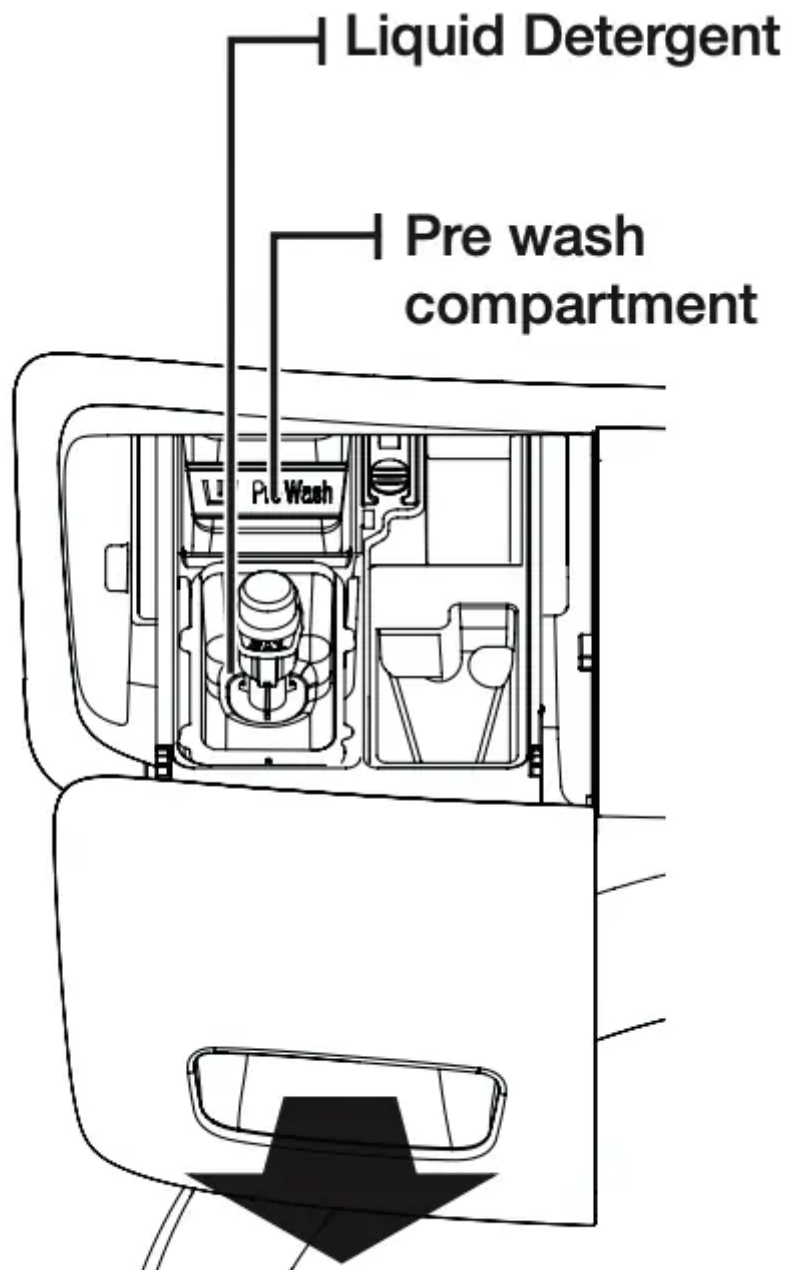

Your washer has separate compartments for dispensing detergent and color-safe bleach, chlorine bleach, and fabric softener. Add all laundry additives to their respective compartments before starting your washer.

The automatic dispenser **MUST ALWAYS** be in place before you start your washer.

DO NOT open the automatic dispenser when your washer is running.

Usage Pointers:

- Never exceed the manufacturer's recommendations when adding detergent.
- This compartment holds liquid detergent for the main wash cycle, which the washer adds to the load at the beginning of the cycle.

**Note:** Before using powdered detergent, remove the Liquid Detergent holder from the compartment. Powdered detergent will not dispense from the Liquid Detergent holder.

### **Detergent compartment**

- Pour the recommended amount of laundry detergent directly into the detergent compartment before starting your washer.

### **Pre wash compartment**

When using the Pre Wash option, add detergent to both the Pre Wash compartment and the detergent compartment. The washer will automatically dispense the detergent during Pre Wash.

- If you use a high efficiency (HE) detergent, add 1/3 of the recommended amount to the Pre Wash compartment and 2/3 of the recommended amount to the detergent compartment.

### **Bleach compartment**

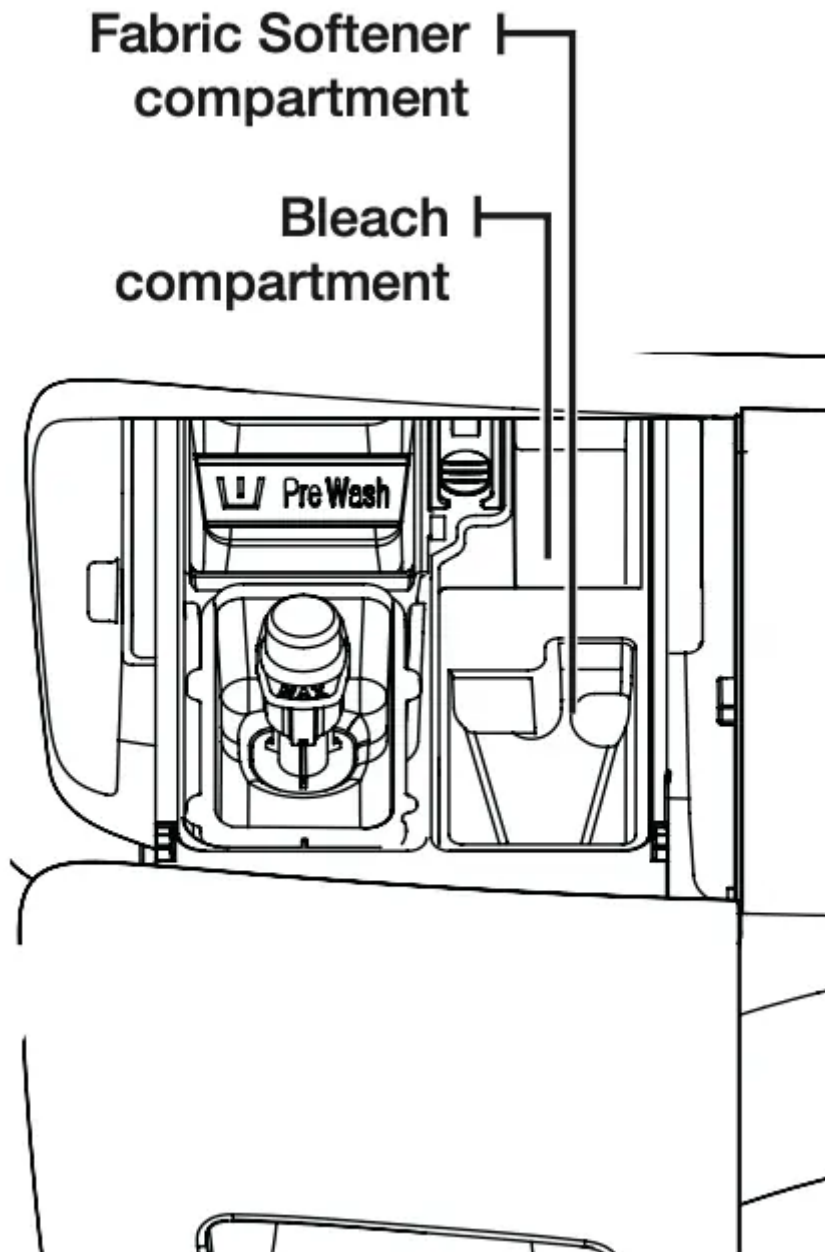

(Liquid chlorine bleach only)

1. Add chlorine bleach to the bleach compartment. DO NOT exceed the MAX FILL line.
2. Avoid splashing or over-filling the compartment.
3. Your washer automatically dispenses bleach into the tub at the appropriate time.
4. The dispenser automatically dilutes liquid chlorine bleach before it reaches the wash load.

**Note:**

- Never pour undiluted liquid chlorine bleach directly onto the load or into the tub. It is a powerful chemical and can cause fabric damage, such as weakening of the fibers or color loss, if not used properly.
- Oxi-type boosters or color-safe bleach can be added to the drum prior to adding laundry.
- Put the laundry into the drum only after confirming that the oxi-type boosters or color-safe bleach has completely entered the hole of the drum.
- To use powdered detergent and powder oxi-type boosters or powdered color-safe bleach at the same time, it is more effective to put them in the drum together before adding the laundry. When you use powdered detergent, remember to remove the Liquid Detergent holder from the detergent compartment.

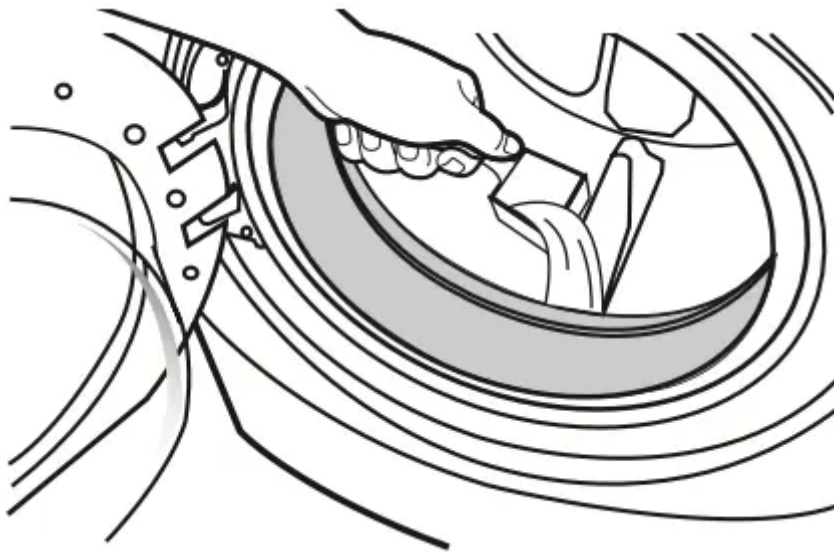

**Fabric softener compartment**

1. Pour the recommended amount of liquid fabric softener into the softener compartment. For smaller loads, use less than one capful.
2. Dilute the fabric softener with water until it reaches MAX FILL in the compartment.
3. The dispenser automatically releases liquid fabric softener at the proper time during the rinse cycle.

**Note:**

- Use the softener compartment ONLY for liquid fabric softeners.
- DO NOT use a Downy Ball\* in the Fabric softener compartment of this washer. It will not be added at the appropriate time.
- Use the detergent compartment.

\* Brand names are trademarks of their respective manufacturers.

**Note:** If you overfill the detergent, bleach, or softener compartments, the contents of the compartment will automatically be released into the washer. This could damage any garments that are in the drum.

## Maintaining Your Washer

### CLEANING THE EXTERIOR

- Turn off the water faucets after finishing the day's washing.
- This will shut off the water supply to your washer and prevent the unlikely possibility of damage from escaping water. Leave the door open to allow the inside of your washer to dry out.
- Use a soft cloth to wipe up all detergent, bleach or other spills as they occur.
- Clean the following as recommended below:
- Control Panel – Clean with a soft, damp cloth. Do not use abrasive powders or cleaning pads. Do not spray cleaners directly on the panel.
- Cabinet – Clean with soap and water.

### CLEANING THE INTERIOR

- Clean the interior of your washer periodically to remove any dirt, soil, odor, mold, mildew, or bacterial residue that may remain in your washer as a result of washing clothes.
- Failure to follow these instructions may result in unpleasant conditions, including odors and/or permanent stains on your washer or laundry.
- Hard water deposits may be removed, if needed. Use a cleaner labeled “Washer safe”.

## CLEANING THE DISPENSERS

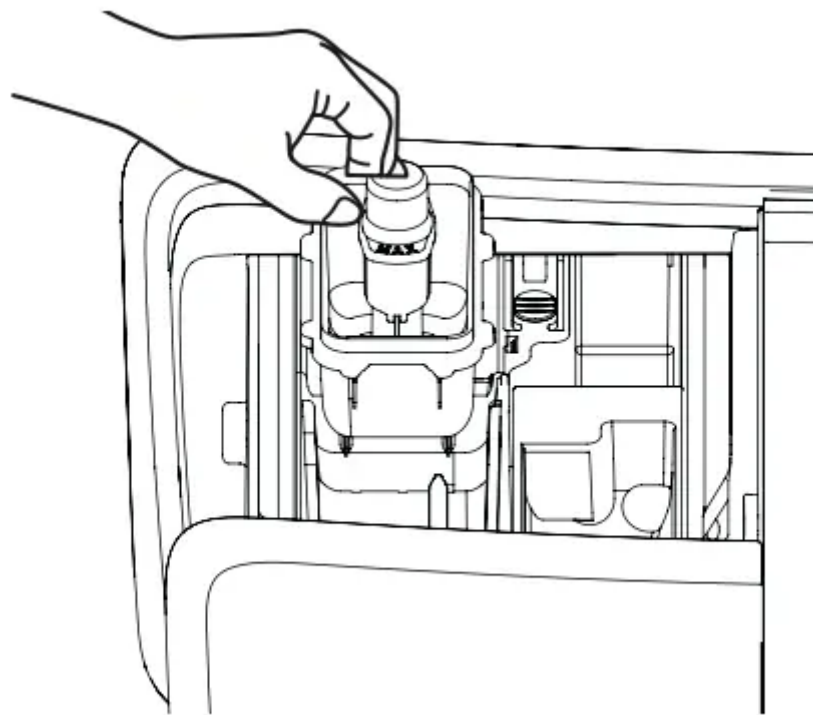

**Siphon cap**

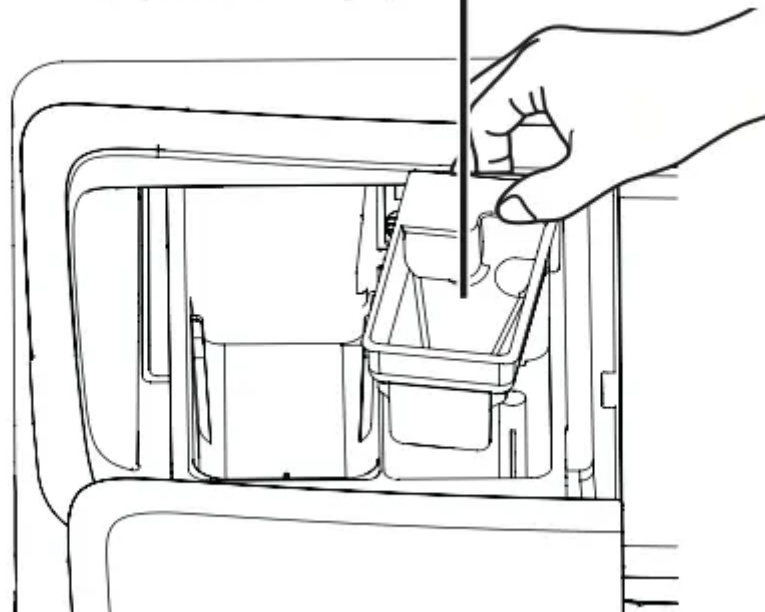

You may need to clean the automatic dispenser periodically to remove laundry additive buildup.

1. Pull out the Liquid Detergent holder from the detergent compartment.
2. Remove the siphon cap from the fabric softener and bleach compartments.
3. Wash all of the parts under running water.
4. Clean the dispenser recess with a soft brush.
5. Reinsert the siphon cap and push it firmly into place.

6. Push the Liquid Detergent holder back into place.
7. Run a rinse+Spin cycle without any load in your washer.

## STORING YOUR WASHER

Washers can be damaged if water is not removed from hoses and internal components before storage. Prepare your washer for storage as follows:

- Select the Quick Wash cycle and add bleach to the automatic dispenser. Run your washer through the cycle without a load.
- Turn the water faucets off and disconnect the inlet hoses.
- Unplug your washer from the electrical outlet and leave your washer door open to let air circulate inside the tumbler.
- If you store your washer in below-freezing temperatures, make sure you allow time for any leftover water in your washer to thaw before use.

## CLEANING THE DEBRIS FILTER

We recommend cleaning the debris filter when water does not drain well or the “5E” error message is displayed.

1. Unplug the washing machine from the power supply.
2. Gently press the top area of the filter cover to open.

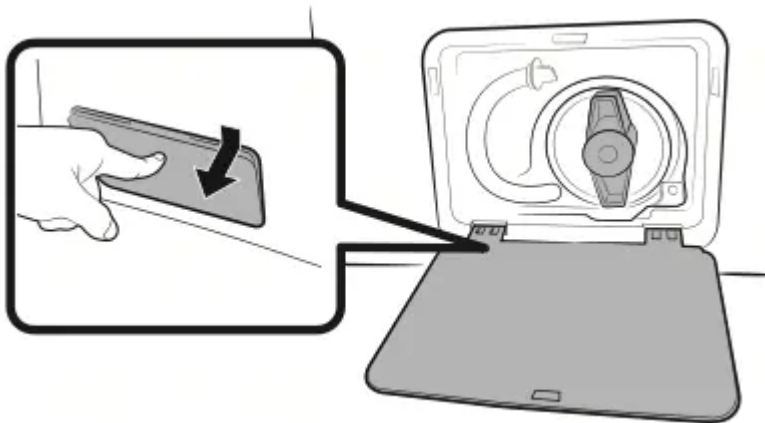

3. Holding the drain cap, pull the drain tube that is hooked on the guide hook to the front. Do not pull the drain tube with excessive force.
4. Place a bowl under the washing machine to catch any remaining water. Then, hold the drain tube with one hand, and turn the drain cap counter clockwise with the other hand to separate it from the drain tube.

5. Drain the remaining water completely.

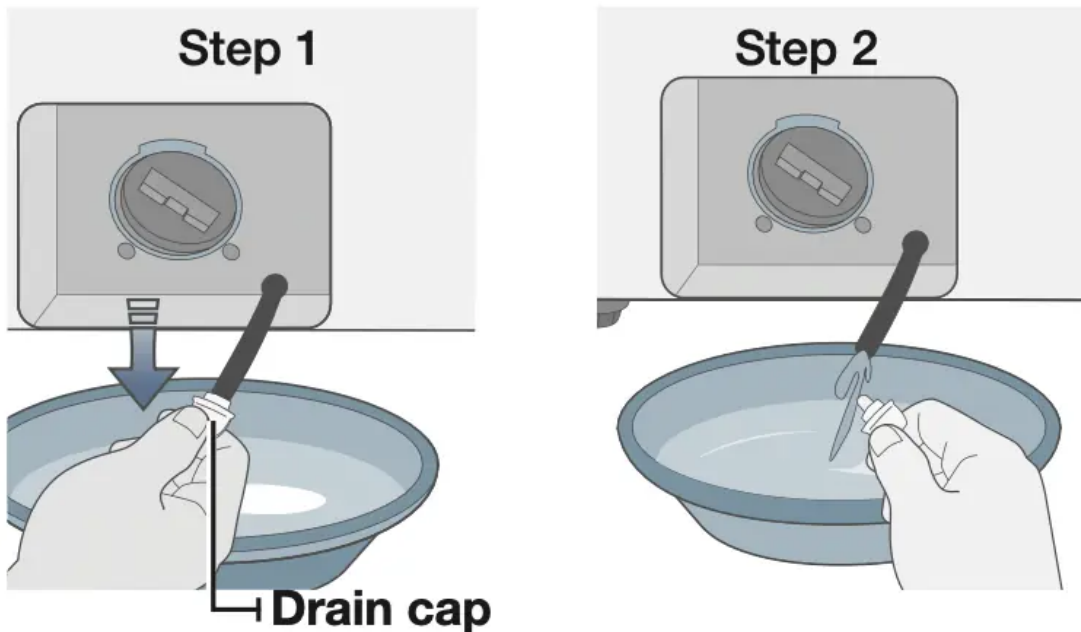

6. Turn the debris cap counterclockwise, and then pull the debris cap and debris filter assembly out of the washer.

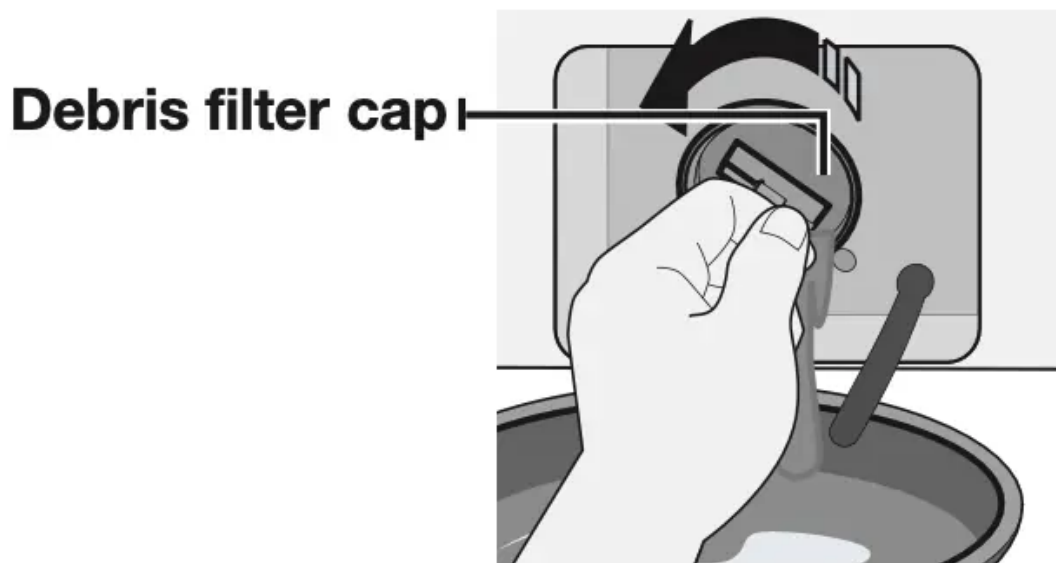

7. Wash any dirt or other material from the debris filter. Make sure the drain pump propeller behind the debris filter is not blocked.

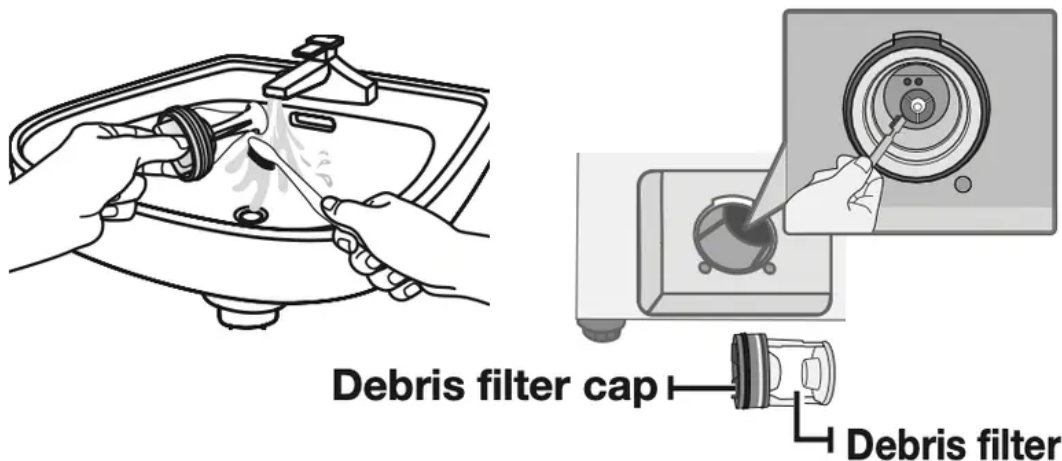

8. When you have finished cleaning the filter, insert the debris cap and filter assembly back into the washer. Turn the debris filter cap clockwise until the indicator on the debris filter cap is in the 12 o'clock position, pointing to the indicator on the washer.
9. Re-attach the emergency drain cap to the drain tube, and then hook the tube to the hook guide.
10. Re-install the filter cover.

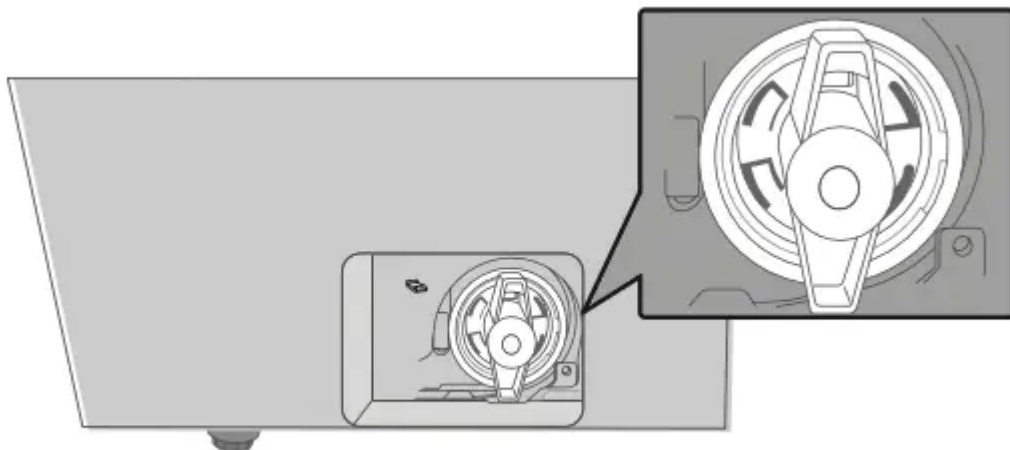

**Note: For models with the safety filter cap**

- To open, push in, and then turn the safety filter cap counterclockwise. The spring in the cap will make opening the cap easy
- To close, turn the safety filter cap clockwise. As you turn the cap, the spring will make a rattling sound. The rattling sound is normal.

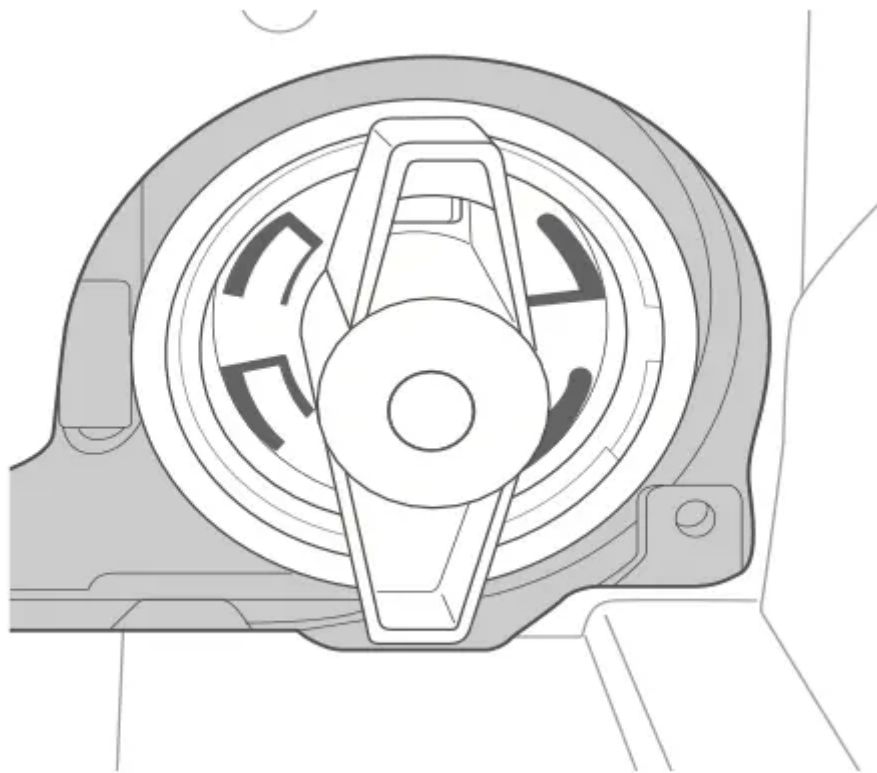

## CLEANING THE DOOR DIAPHRAGM

1. Open the washer door and remove any clothing or items from the washer.
2. Check if there are any foreign substances on the grey Diaphragm (1) between the lid and the drum. To check this, turn the Diaphragm (2) out.

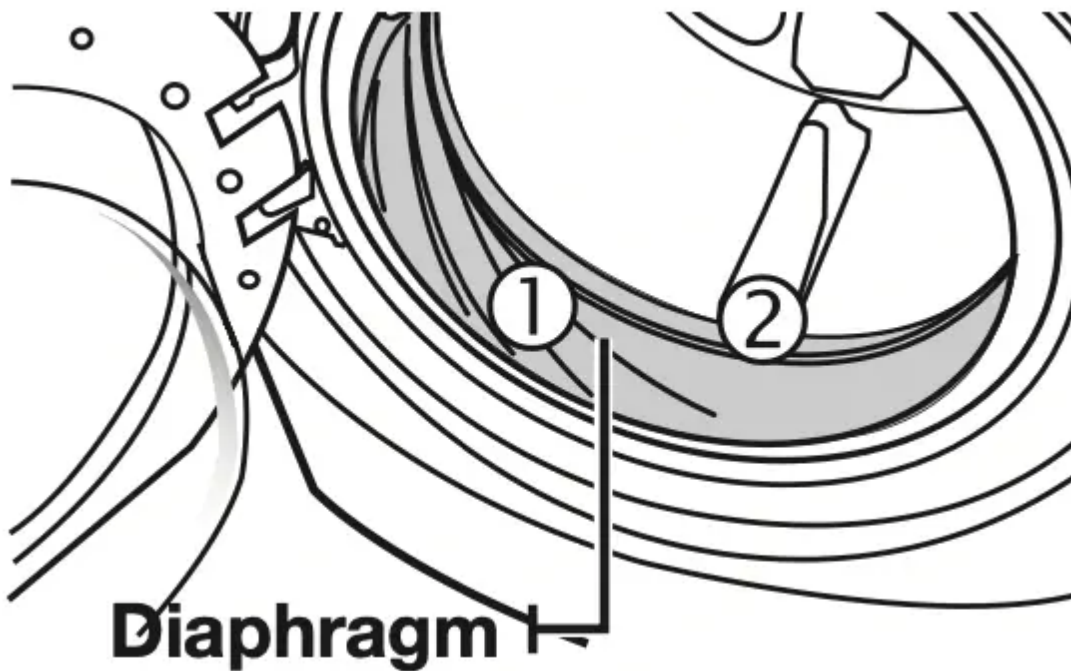

3. If there are any foreign substances, remove them.
4. If you find stained areas, wipe them down using the procedure below:
  - a) Carefully combine  $\frac{3}{4}$  cup (177 mL) of liquid chlorine bleach with 1 gal. (3.8 L) of warm tap water.
  - b) Wipe the Diaphragm area with the dilute solution using a damp cloth.
  - c) Let stand 5 minutes.
  - d) Wipe down the area thoroughly with a dry cloth and let the washer interior air dry with the door open.

**Important:**

- Wear rubber gloves when cleaning for prolonged periods.
- Refer to the bleach manufacturer's instructions for proper use.

**PRESERVING THE TOP COVER AND THE FRONT FRAME**

Do not place any heavy or sharp objects or a detergent box on the washing machine. They can scratch or damage its top cover. Keep them in the pedestal (if purchased) or in a separate storage box.

Since the entire washing machine has a high-gloss finish, the surface can be scratched or damaged. Avoid scratching or damaging the surface when using the washing machine.

**SELF CLEAN+**

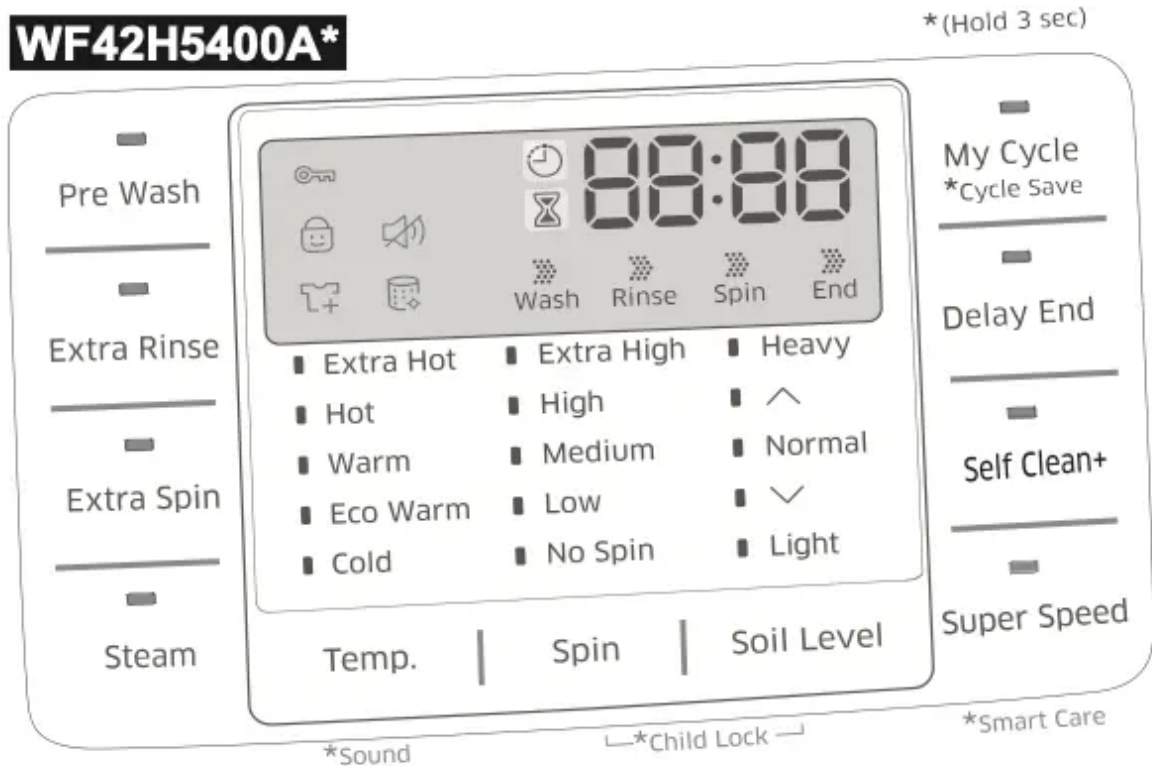

Self Clean+ is a self-cleaning cycle that removes mold that may occur inside the washing machine.

1. Press the **Power** button.
2. Press the **Self Clean+** button. Once the Self Clean+ button is pressed, the only function that can be set is Delay End.
3. Press the **start/pause** button. When you press the Start/Pause button, Self Clean+ begins.

**CAUTION:**

- Using Self Clean+, you can clean the drum, tub and diaphragm without using a cleansing agent.
- Never use Self Clean+ when laundry is in the washing machine. It may cause damage to the laundry or a problem with the washing machine.
- If you want to use a drum cleansing agent, use only 1/10 of the amount of the drum cleansing agent recommended by the cleansing agent manufacturer. (When using a powder-type cleansing agent, remove the liquid detergent compartment.)

**NOTE: The Self Clean+ Auto Indicator Function**

**WF42H5400A\***

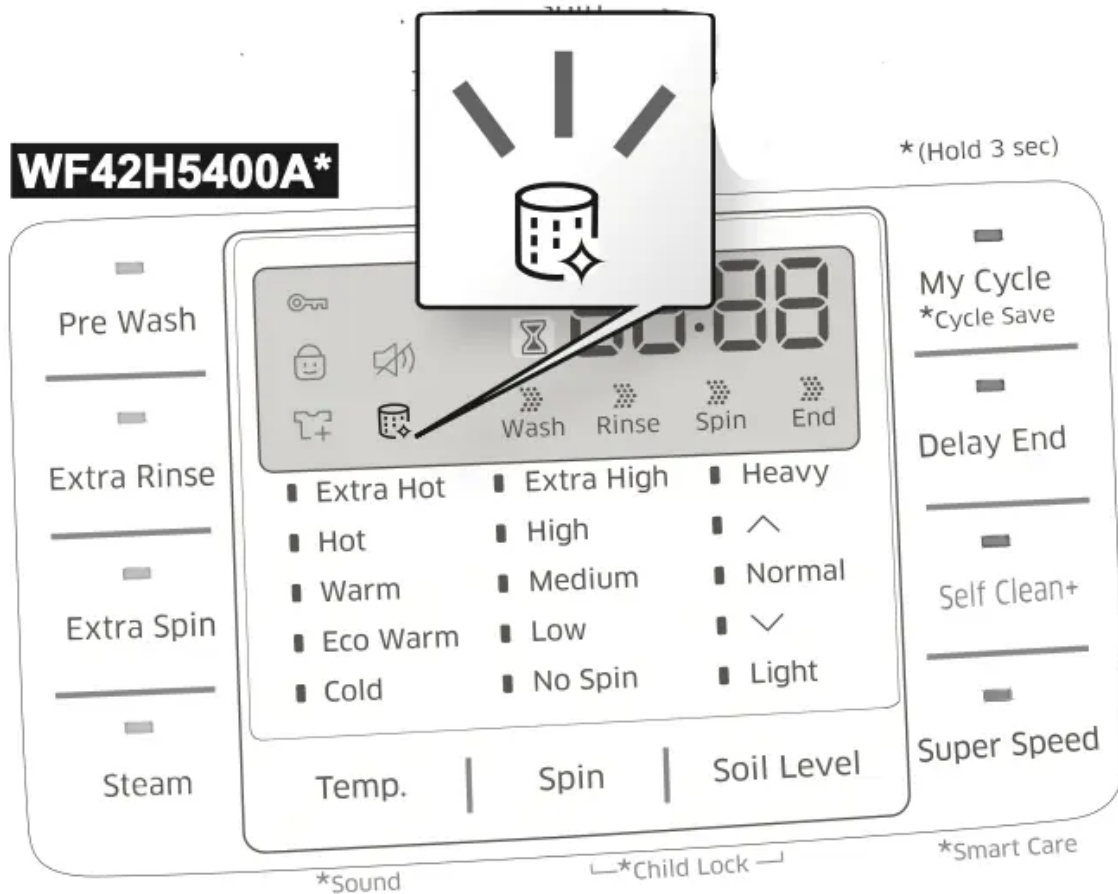

- If the **“Self Clean+”** button is lit after a wash, it indicates that tub (drum) cleaning is required. In this case, remove the laundry from the washing machine, turn the power on, and clean the drum by running Self Clean+.
- If you do not run Self Clean+ after every 40 washes, the **“Self Clean+”** indicator turns off after one hour. However, the **“Self Clean+”** indicator will light again after five washes. Not running Self Clean+ at this point will not cause a problem with the washing machine.
- Although the Self Clean+ Auto Indicator appears once a month or so, the frequency may differ depending on the number of times the washing machine is used.

## Troubleshooting

**CHECK THESE SOLUTIONS IF YOUR WASHER...**

| Problem  | Solution  |
|--|---|
| Will not start.  | <ul style="list-style-type: none"> <li>• Make sure the door is firmly closed.</li> <li>• Make sure your washer is plugged in.</li> <li>• Make sure the water source faucets are open.</li> <li>• Make sure to press the Start/Pause Button to start your washer.</li> <li>• Make sure the Child Lock is not activated. See page 22.</li> <li>• Before your washer starts to fill, it will make a series of clicking noises to check the door lock and do a quick drain.</li> <li>• Check the fuse or reset the circuit breaker</li> </ul> |
| Has no water or not enough water.  | <ul style="list-style-type: none"> <li>• Turn both faucets on fully.</li> <li>• Make sure the door is tightly closed.</li> <li>• Straighten the water inlet hoses.</li> <li>• Disconnect hoses and clean the screens. Hose filter screens may be clogged.</li> <li>• Open and close the door, then press the Start/Pause Button.</li> </ul>   |
| Has detergent remains in the automatic dispenser after the wash cycle is complete. | <ul style="list-style-type: none"> <li>• Make sure your washer is running with sufficient water pressure.</li> <li>• Make sure the Detergent Selector dial is in the upper position when using granular detergent.</li> </ul>   |
| Vibrates or is too noisy.  | <ul style="list-style-type: none"> <li>• Make sure your washer is set on a level surface. If the surface is not level, adjust your washer feet to level the appliance.</li> <li>• Make sure that the shipping bolts are removed.</li> <li>• Make sure your washer is not touching any other object.</li> <li>• Make sure the laundry load is balanced.</li> </ul>   |
| Stops  | <ul style="list-style-type: none"> <li>• Plug the power cord into a live electrical outlet.</li> <li>• Check the fuse or reset the circuit breaker.</li> <li>• Close the door and press the Start/Pause Button to start your washer.</li> </ul>   |



|  |   |
|--|---|
|  | <p>For your safety, your washer will not tumble or spin unless the door is closed.</p> <ul style="list-style-type: none"> <li>• Before your washer starts to fill, it will make a series of clicking noises to check the door lock and do a quick drain.</li> <li>• There may be a pause or soak period in the cycle. Wait and it may start.</li> <li>• Check the screens on the inlet hoses at the faucets for obstructions.<br/>Clean the screens periodically.</li> </ul>  |
| <p>Fills with the wrong temperature water.</p> | <ul style="list-style-type: none"> <li>• Turn both faucets on fully.</li> <li>• Make sure the temperature selection is correct.</li> <li>• Make sure the hoses are connected to the correct faucets.<br/>Flush water lines.</li> <li>• Check the water heater. It should be set to deliver a minimum 120°F (49 °C) hot water at the tap. Also check the water heater capacity and recovery rate.</li> <li>• Disconnect the hoses and clean the screens. The hose filter screens may be plugged.</li> <li>• As your washer is filling, the water temperature may change as the automatic temperature control feature checks incoming water temperature. This is normal.</li> <li>• While your washer is filling, you may notice just hot and/or just cold water going through the dispenser when you have selected cold or warm wash temperatures. This is a normal function of the automatic temperature control feature as your washer determines the temperature of the water.</li> </ul> |
| <p>Door locked or will not open.</p>           | <ul style="list-style-type: none"> <li>• Press the Start/Pause Button to stop your washer.</li> <li>• Your washer door will remain locked during the heating portion of the Sanitize Cycle</li> <li>• It may take a few moments for the door lock mechanism to disengage.</li> </ul>  |
| <p>Does not drain and/or spin.</p>             | <ul style="list-style-type: none"> <li>• Check the fuse or reset the circuit breaker.</li> <li>• Straighten the drain hoses. Eliminate kinked hoses. If there is a drain restriction, call for service.</li> </ul>  |



|  |   |
|--|---|
|  | <ul style="list-style-type: none"> <li>• Close the door and press the Start/Pause Button. For your safety, your washer will not tumble or spin unless the door is closed.</li> <li>• Make sure the debris filter is not clogged.</li> </ul>   |
| Load is too wet at the end of the cycle. | <ul style="list-style-type: none"> <li>• Use the High or Extra High spin speed.</li> <li>• Use high efficiency detergent to reduce over-sudsing.</li> <li>• The load is too small. Very small loads (one or two items) may become unbalanced and not spin out completely.</li> </ul>  |
| Leaks water.                             | <ul style="list-style-type: none"> <li>• Make sure the door is firmly closed.</li> <li>• Make sure all hose connections are tight.</li> <li>• Make sure the end of the drain hose is correctly inserted and secured to the drainage system.</li> <li>• Avoid overloading.</li> <li>• Use high efficiency detergent to prevent over-sudsing.</li> </ul>      |
| Has excessive suds.                      | <ul style="list-style-type: none"> <li>• Use high efficiency detergent to prevent over-sudsing.</li> <li>• Reduce the detergent amount for soft water, small or lightly soiled loads.</li> <li>• Non-HE detergent is NOT recommended.</li> </ul>  |
| Has an odor.                             | <ul style="list-style-type: none"> <li>• Excessive suds collect in nooks and crannies and can cause foul odors.</li> <li>• Run cleansing cycles to sanitize the machine periodically. (Sanitize Cycle or Self Clean+)</li> <li>• Clean the door seal (Diaphragm).</li> <li>• Dry the interior of your washer after the total cycle has finished.</li> </ul> |

## INFORMATION CODES

The washer may display information codes to help you better understand what is occurring with your washer.

| Error Code | Meaning & Solution  |
|------------|---|
| UE         | <p>Unbalanced load prevented your washer from spinning.</p> <p>Redistribute the load, press the Start/Pause button.</p>   |
| dE         | <p>The door is open when the washer is running.</p> <p>Close the door tightly and restart the cycle. If the code reappears, call customer service.</p>  |
| dE1        | <p>Your washer failed to lock or unlock the door.</p>   |
| HE         | <p>A water temperature control problem. (Heater control problem).</p> <p>Call customer service.</p>   |
| LE         | <p>Your washer has tried to fill, but has not reached the proper water level. Call customer service.</p> <p><b>Note:</b> When washer displays “LE”, washer do draining for 3 minutes,At this time, Power button is invalid.</p>   |
| 5E         | <p>Your washer is not draining. This can also mean that the unit senses a small clog while draining.</p> <ol style="list-style-type: none"> <li>1. Turn off the unit for 10 seconds and then turn it on again.</li> <li>2. Select the Spin Only cycle.</li> <li>3. Press the Start/Pause to drain the water.</li> </ol> <p>If it still does not drain, call for service.</p>  |
| 4E         | <p>Your washer has tried to fill but was unsuccessful.</p> <p>Make sure the water faucets are open all the way. Check for bent hoses. Check the inlet screens on the hoses. If you are using a Flood Safety Device, please remove the device and connect the water hoses directly to the unit.</p> <p>Check if the hot water supply hose is connected.</p> <p>You must connect the hot water supply hose because hot water is supplied by the Auto Temperature Control (A.T.C.) function if the temperature of the cold water is lower than 59°F.</p> |



| Error Code | Meaning & Solution  |
|------------|---|
|            | <p><b>Note:</b> When washer displays “4E”, washer do draining for 3 minutes. At this time, power button is invalid.</p>   |
| 4E2        | <p>The hot/cold water hose connection is not correct.</p> <p>Please connect the hot/cold water hose connection correctly.</p>   |
| OE         | <p>A fault is detected in the water level sensor.</p> <p>Call customer service.</p>   |
| 1E         | <p>The Water Level sensor is not working properly. Call customer service.</p> <p><b>Note:</b> When washer displays “1E”, washer do draining for 3 minutes,At this time, Power button is invalid</p> |
| bE2        | <p>A jammed key.</p> <p>Call customer service.</p>  |
| tE1        | <p>A temperature sensor problem.</p> <p>Restart the cycle. If the code reappears, call customer service..</p>   |
| 3E         | <p>A motor problem.</p> <p>Restart the cycle. If the code reappears, call customer service.</p>   |
| 9E1/9E2    | <p>High/Low voltage detected.</p> <p>Restart the cycle. If the code reappears, call customer service.</p>   |
| aE         | <p>A Communication error between the SUB (Sensor) PBA and the MAIN PBA</p> <p>Call customer service.</p>  |
| aE6        | <p>A Communication error between the MAIN PBA and the INVERTER PBA.</p> <p>Call customer service.</p>   |



| Error Code                   | Meaning & Solution  |
|------------------------------|---|
| <b>8E</b>                    | <p>A MEMS sensor problem.</p> <p>Call customer service.</p>   |
| <b>SF1 SF2</b><br><b>SF3</b> | <p>A system error.</p> <p>Call customer service.</p>  |
| <b>sud</b>                   | <p>Too many suds are detected during the wash session.</p> <p>The unit is put on hold until the amount of suds have been reduced.</p> <p>The unit will then go back to operating.</p> |

**Warning**

This content is compiled from multiple sources and is provided for reference purposes only. It may not be complete or fully applicable to all situations. If you are unable to resolve your issue, please contact the product manufacturer or an authorized service provider for official support.

