

Before Using the Product

Cleaning

Exercise care when cleaning as the panel and exterior of advanced LCDs are easily scratched.

Take the following steps when cleaning.

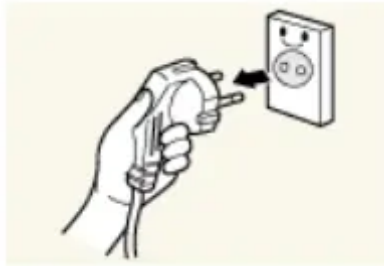

1. Power off the monitor and computer.
2. Disconnect the power cord from the monitor. Hold the power cable by the plug and do not touch the cable with wet hands. Otherwise, an electric shock may result.

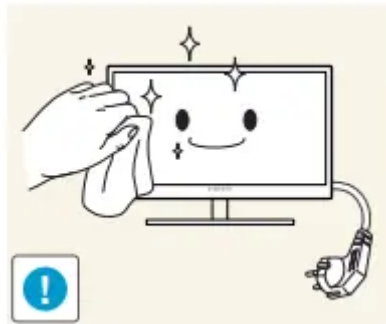

3. Wipe the monitor screen using a clean, soft and dry cloth.



Do not apply a cleaning agent that contains alcohol, solvent, or surfactant to the monitor.



Do not spray water or detergent directly on the product.

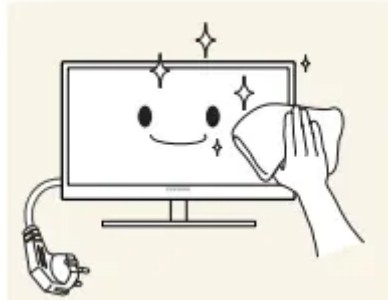

4. Wet a soft and dry cloth in water and wring thoroughly to clean the exterior of the monitor.

Correct posture to use the product

Use the product in the correct posture as follows:



- Straighten your back.
- Allow a distance of 45 to 50 cm between your eye and the screen, and look slightly downward at the screen. Keep your eyes directly in front of the screen.
- Adjust the angle so light does not reflect on the screen.
- Keep your forearms perpendicular to your upper arms and level with the back of your hands.
- Keep your elbows at about a right angle.
- Adjust the height of the product so you can keep your knees bent at 90 degrees or more, your heels attached to the floor, and your arms lower than your heart.

Preparations

Parts

Control Panel

The color and shape of parts may differ from what is shown. Specifications are subject to change without notice to improve quality

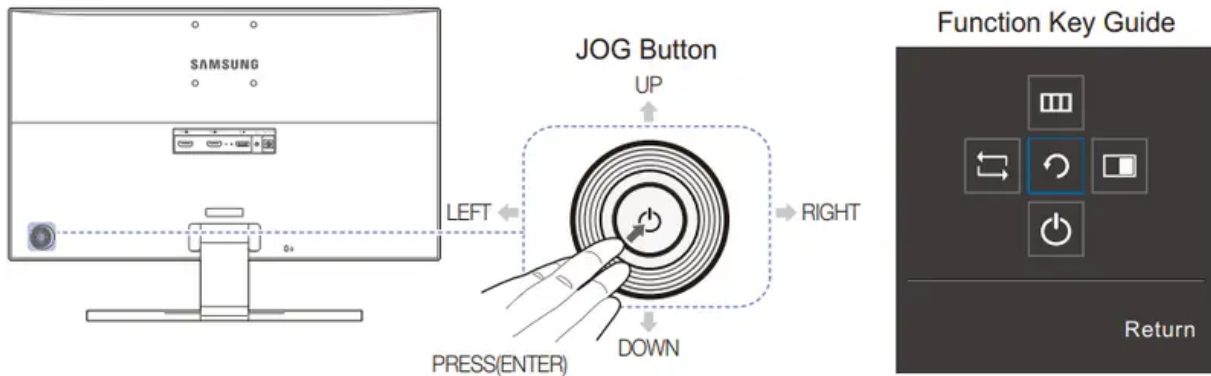

Icons	Description
JOG Button	<p>Multi directional button that helps navigate. The JOG button is located on the rear left side of the product.</p> <p>The button can be used to move up, down, left or right, or as Enter.</p>
Function Key Guide	<p>Press the JOG button when the screen is turned on. The Function Key Guide will appear. To access the onscreen menu when the guide is displayed, press the corresponding direction button again.</p> <p>Function Key Guide may vary depending on the function or product model. Please refer to the actual product.</p>

Direct Key guide

For guidance on shortcut keys, the below OSD (On Screen Display) will be displayed if you switch the source or turn on the monitor.



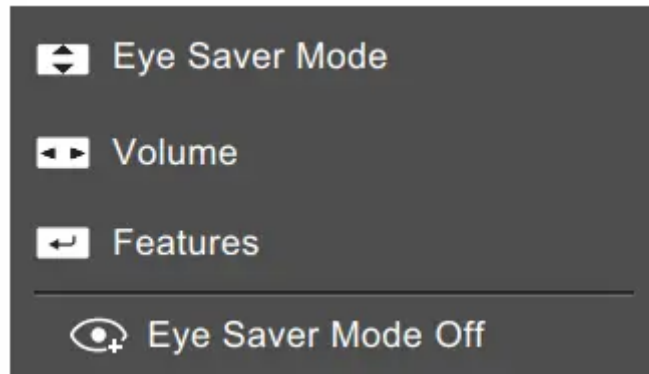







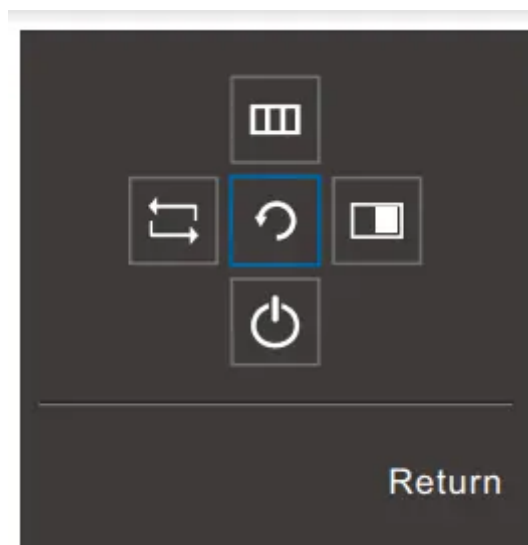

- UP/DOWN: Adjust Brightness / Contrast / Eye Saver Mode
- LEFT/RIGHT: Adjust Volume.
- PRESS(ENTER): Display Function Key Guide.

Function Key Guide

To enter the main menu or to use other items, press the JOG button to display the Function Key Guide. You can exit by pressing the JOG button again.

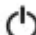

- UP/DOWN/LEFT/RIGHT: Move to the item you want. The description for each item will appear when the focus changes.
- PRESS(ENTER): The selected item will be applied.

Icons	Description
	Selects [] to change the input signal by moving the JOG button in the Function Key Guide screen. A message will appear on the top left corner of the screen if the input signal has been changed.
	Selects [] by moving the JOG button in the function key guide screen. The OSD (On Screen Display) of your Monitor's feature appears. OSD control lock: Maintain the current settings, or lock the OSD control to prevent unintended changes to settings. Enable/Disable: To lock/unlock the OSD control, press the LEFT button for 10 seconds when the main menu displayed. If the OSD control is locked, Brightness and Contrast can be adjusted. PIP/PBP is available. Eye Saver Mode is available. Information can be viewed.
	Selects [] by moving the JOG button in the function key guide screen. Press the button when configuring settings for the PIP/PBP function is required
	Selects [] to turn the Monitor off by moving the JOG button in the function key guide screen.

Actual models because of functional variation, Function key guide options will be different. Please run the corresponding function based on the actual icon and description.

When the monitor displays nothing (i.e. Power saving mode or Non-signal mode), 2 direct keys for control source and power could be used as below.

JOG Button	Power saving/Non-signal mode
UP	Source Change
Down	
PRESS(ENTER) for 2 seconds	Power Off

When the monitor displays the Main menu the JOG Button could be used as below.







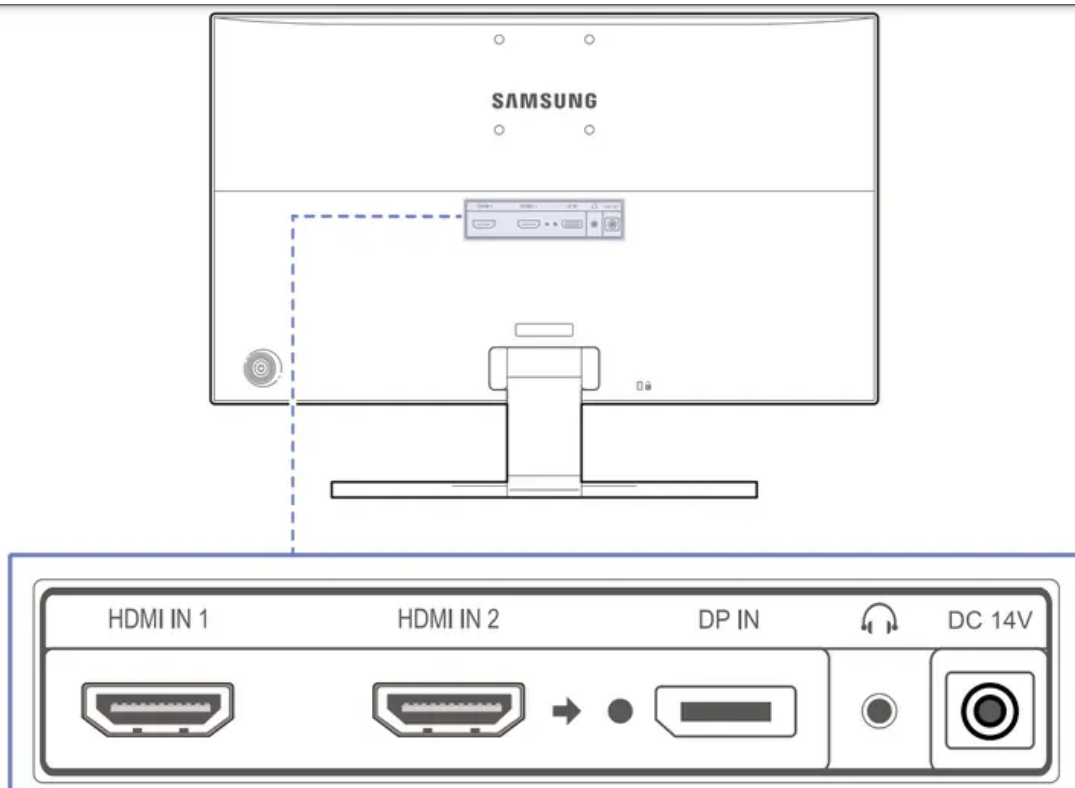

JOG Button	Power saving/Non-signal mode
UP/DOWN	<ul style="list-style-type: none"> • Move the option
LEFT	<ul style="list-style-type: none"> • Exit the Main menu. • Close Sublist without saving value. • Value decreases in the slider
RIGHT	<ul style="list-style-type: none"> • Move to next depth. • Value increases in the slider
PRESS(ENTER)	<ul style="list-style-type: none"> • Move to next depth. • Save the value and close Sublist.

Reverse Side

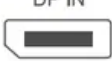
The color and shape of parts may differ from what is shown. Specifications are subject to change without notice to improve quality



Port	About ports
	Connect to a source device using an HDMI cable.  HDMI 1 support 3840 x 2160 30 Hz  HDMI 2 support 3840 x 2160 60 Hz
	Connects to a PC using a DP cable.
	Connect to an audio output device such as headphones.  The sound could only be heard when using the HDMI to HDMI cable or DP cable.
	Connects to the DC power adapter.

Connecting and Using a Source Device

Before Connecting

Pre-connection Checkpoints

- Before connecting a source device, read the user manual provided with it. The number and locations of ports on source devices may differ from device to device.
- Do not connect the power cable until all connections are completed. Connecting the power cable during connection may damage the product.
- Check the types of ports at the back of the product you want to connect.

Connecting and Using a PC

Select a connection method suitable for your PC.

- Connecting parts may differ in different products.
- If you don't use the cable that came with the components of the monitor, the monitor may not support the best resolution.

Connection Using the HDMI Cable

Do not connect the power cable before connecting all other cables. Ensure you connect a source device first before connecting the power cable

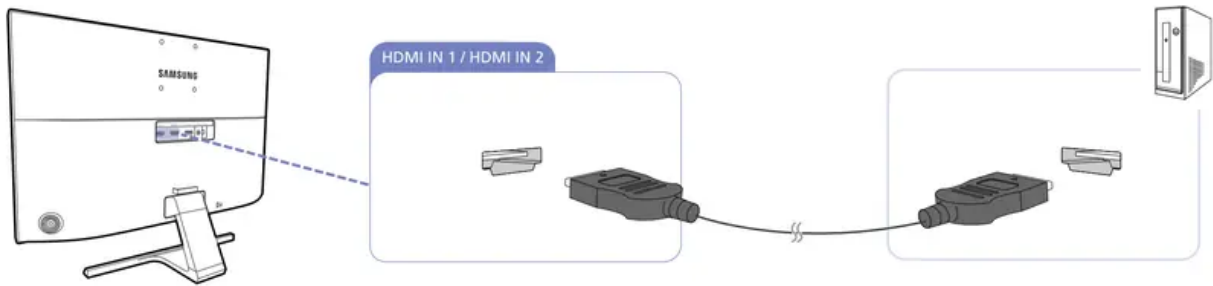

1. Connect the [HDMI IN 1] or [HDMI IN 2] port on the back of the product to the HDMI port on the PC using an HDMI cable.
2. Connect the DC power adapter to the product and a power socket. Next, turn on the power switch on the PC. (For details, refer to "2.2.5 Connecting the Power".)
3. Change the input source to HDMI 1 or HDMI 2 controlling the JOG button UP/DOWN, when input source is not set
 - Provided ports may vary depending on the product.
 - To display 3840 x 2160 at 30 Hz, use an HDMI cable that supports 3840 x 2160 at 30 Hz to connect HDMI 1. Make sure that the graphics card of the HDMI source supports 3840 x 2160 at 30 Hz.
 - To display 3840 x 2160 at 60 Hz, use an HDMI cable that supports 3840 x 2160 at 60 Hz to connect HDMI 2. Make sure that the graphics card of the HDMI source supports 3840 x 2160 at 60 Hz.
 - When connecting an HDMI cable, use the cable that came with the components of the monitor. If you use an HDMI cable other than provided by Samsung, the image quality may be degraded.

Connection Using an DP Cable

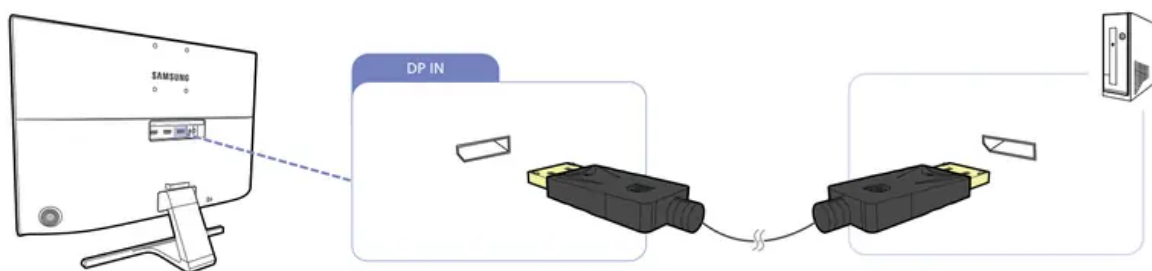

1. Connect the DP cable to the [DP IN] port on the back of the product and the DP port on the PC.
2. Connect the DC power adapter to the product and a power socket. Next, turn on the power switch on the PC. (For details, refer to "2.2.5 Connecting the Power".)

3. Change the input source to DisplayPort controlling the JOG button UP/DOWN, when input source is not set.

- Provided ports may vary depending on the product.
- To display 3840 x 2160 at 60 Hz, use a DP cable that supports 3840 x 2160 at 60 Hz. Make sure that the graphics card of the DP source supports 3840 x 2160 at 60 Hz.

Connecting to Headphones

Do not connect the power cable before connecting all other cables. Ensure you connect a source device first before connecting the power cable.

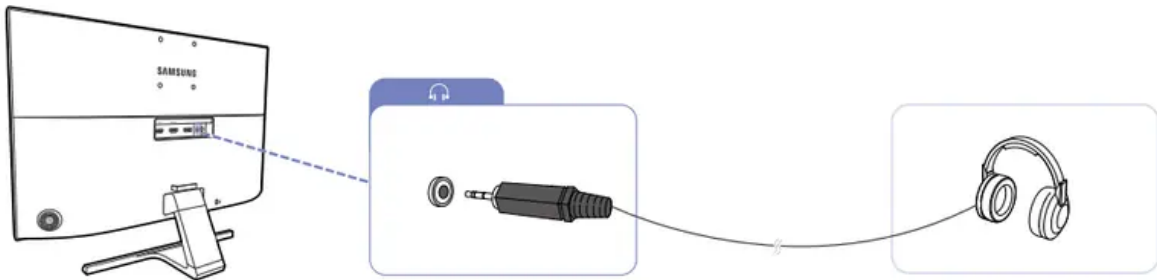

1. Connect an audio output device such as headphones to [] port on the product.

The sound could only be heard when you video card's ports support audio out.

Tidying Up the Connected Cables

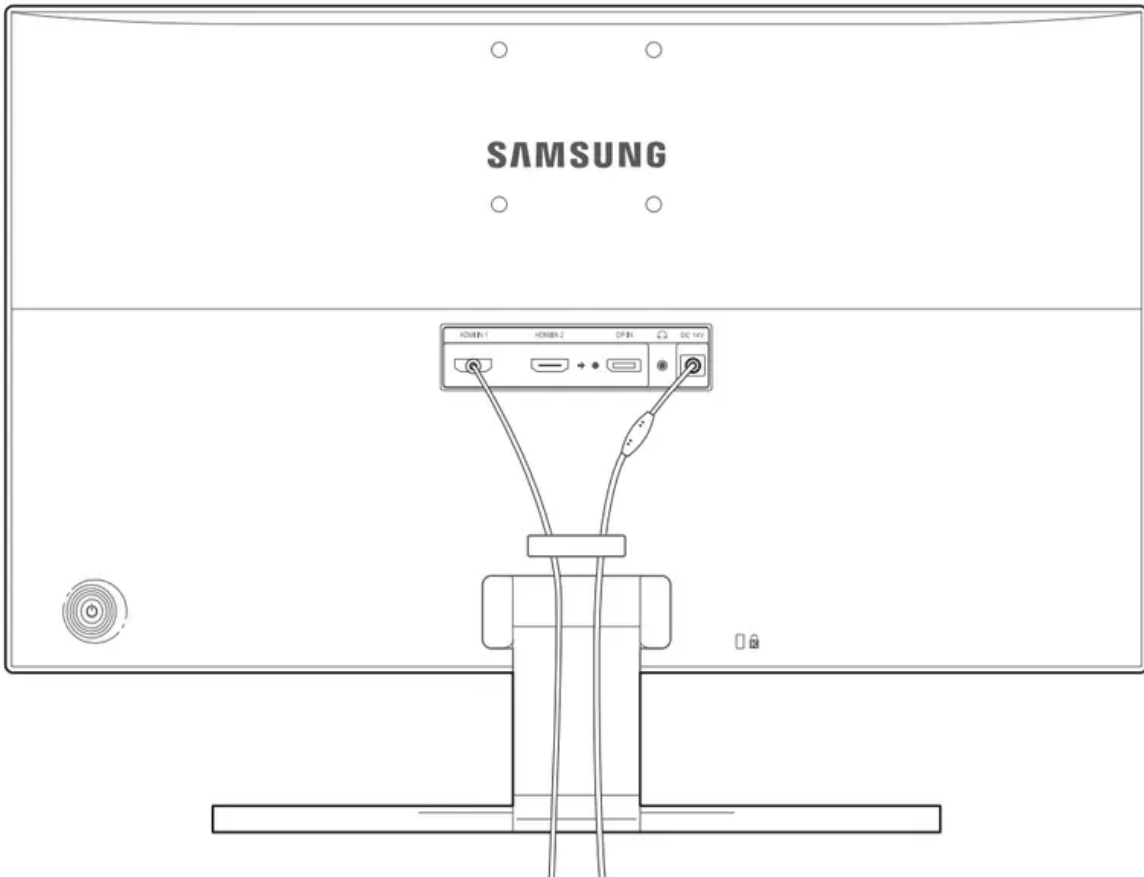

Connecting the Power

Power connection using integrated DC power adapter

- Connect the power adapter to [DC 14V] jack on the rear of the product. Plug in the power cable to the power socket.

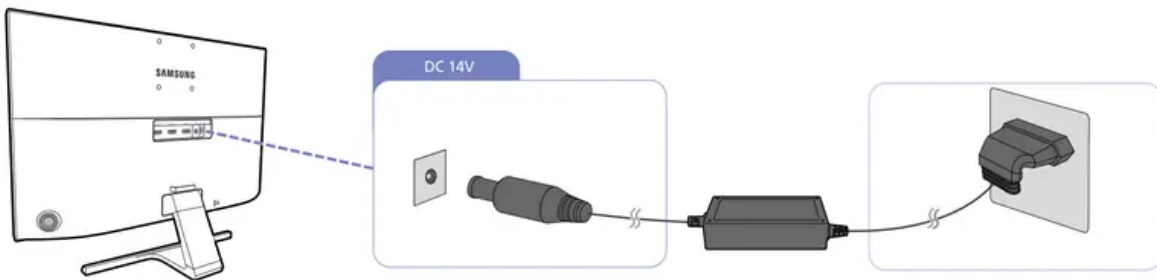

The input voltage is switched automatically.

Power connection using detachable DC power adapter

- Connect the power cable to the DC power adapter. Then, connect the DC power adapter to the [DC 14V] port on the back of the product. Next, connect the power cable to the power outlet.

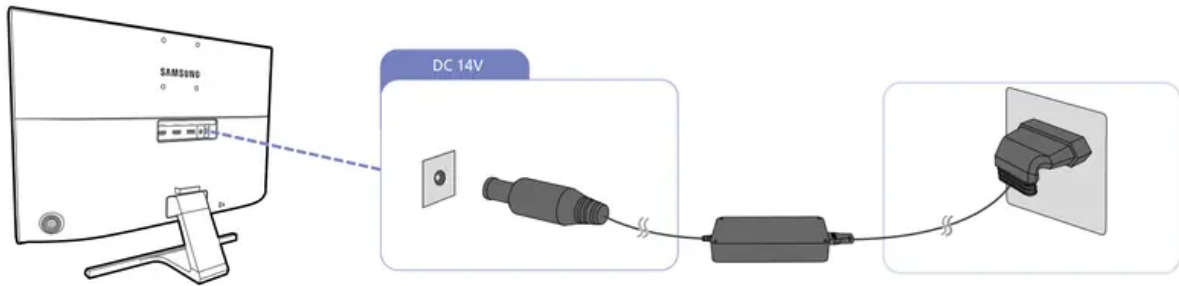

The input voltage is switched automatically.

Changing the sound settings on Windows

- Control Panel → Audio → Speaker → Speaker Setup

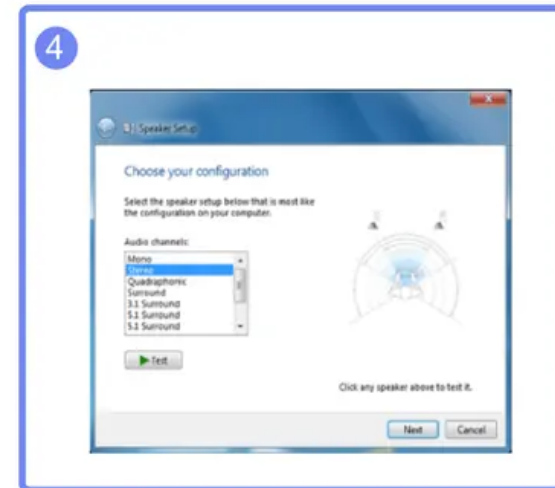
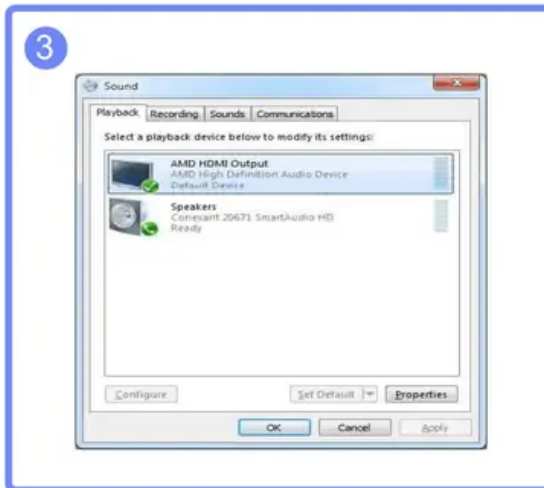
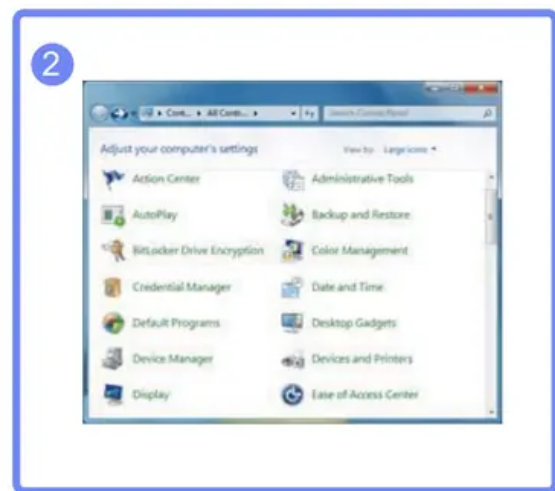

Driver Installation

- You can set the optimum resolution and frequency for this product by installing the corresponding drivers.
- An installation driver is contained on the CD supplied with the product.

- If the file provided is faulty, visit the Samsung homepage (<http://www.samsung.com/>) and download the file.
1. Insert the user manual CD provided with the product into the CD-ROM drive.
 2. Click "Windows Driver".
 3. Follow the instructions given on the screen to proceed with installation.
 4. Select your product model from the list of models.

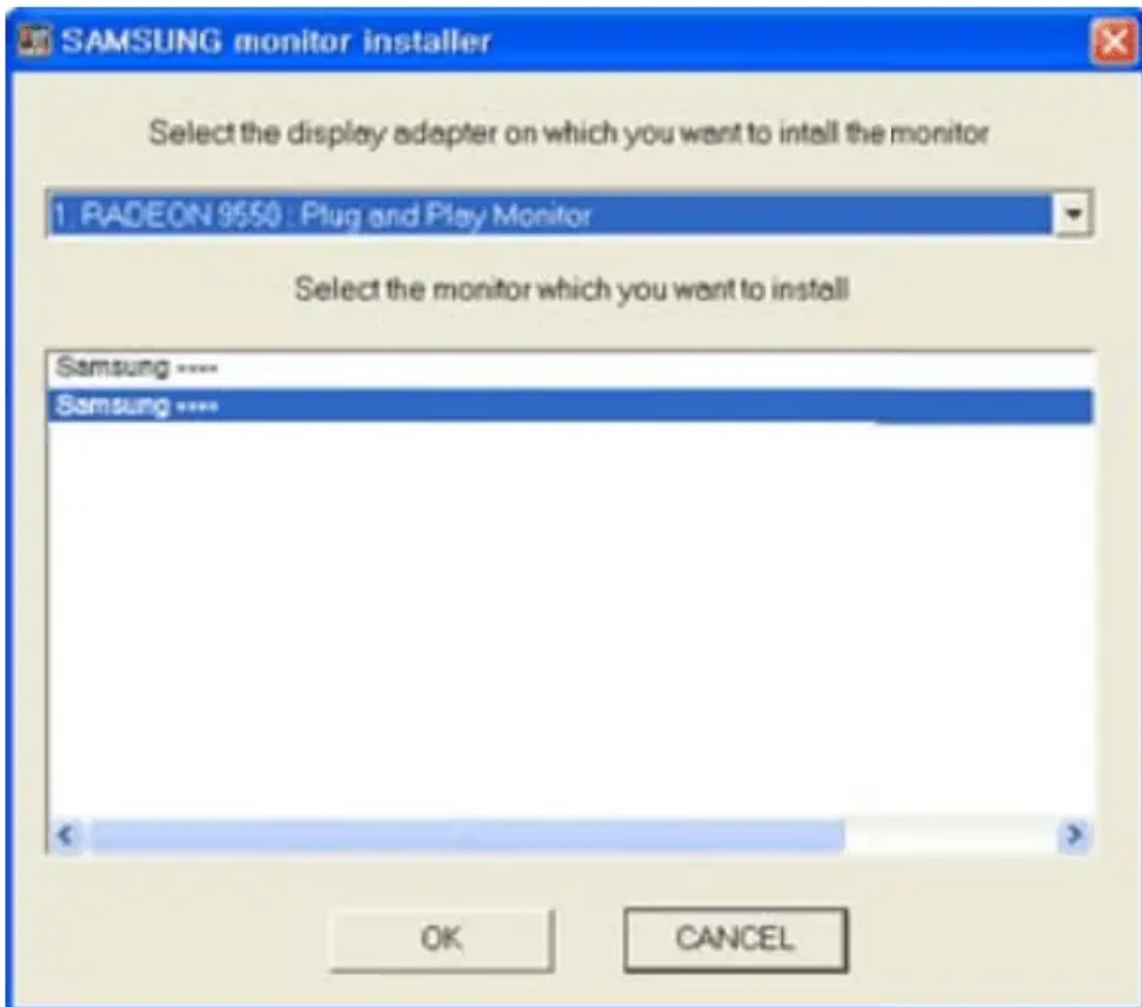

5. Go to Display Properties and check that the resolution and refresh rate are appropriate. Refer to your Windows OS manual for further details.

Setting Optimum Resolution

An information message about setting optimum resolution will appear if you power on the product for the first time after purchase.

Select a language on the product and change the resolution on your PC to the optimum setting.

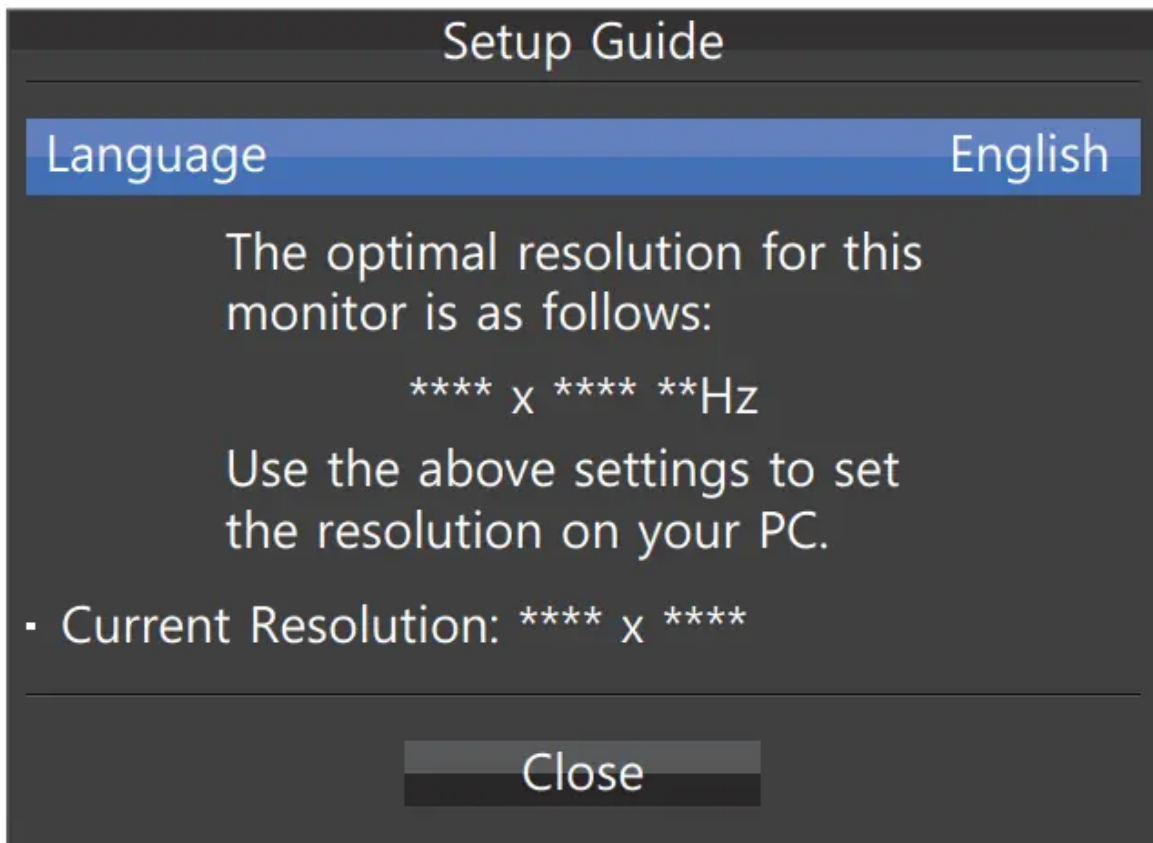

1. Press the JOG button to display the language settings menu.
2. To hide the message, move to Close with the JOG button. Next, press the JOG button.
 - If the optimum resolution is not selected, the message will appear up to three times for a specified time even when the product is turned off and on again.
 - The optimum resolution can also be selected in Control Panel on your PC.

Setup and Reset

A detailed description of each function is provided. Refer to your product for details

FreeSync

- The functions available on the monitor may vary depending on the model. Refer to the actual product.
- FreeSync is a DisplayPort 1.2 function, so the choice of the DisplayPort Ver. 1.1 in OSD, or when the access of HDMI signal, the FreeSync function is not available. Make sure to use a Samsung DP cable. DP cables not supplied by Samsung may not be compatible with the product.
- Not available when PIP/PBP Mode is set to On.
- The sound quality of the monitor may decrease if FreeSync is enabled.

Configuring FreeSync

1. When the Function Key Guide appears, select [] by moving the JOG button UP. Next, press the JOG button.
2. Move to System controlling the JOG button UP/DOWN and press the JOG button.
3. Move to FreeSync controlling the JOG button UP/DOWN and press the JOG button. The following screen will appear.

U28E590D

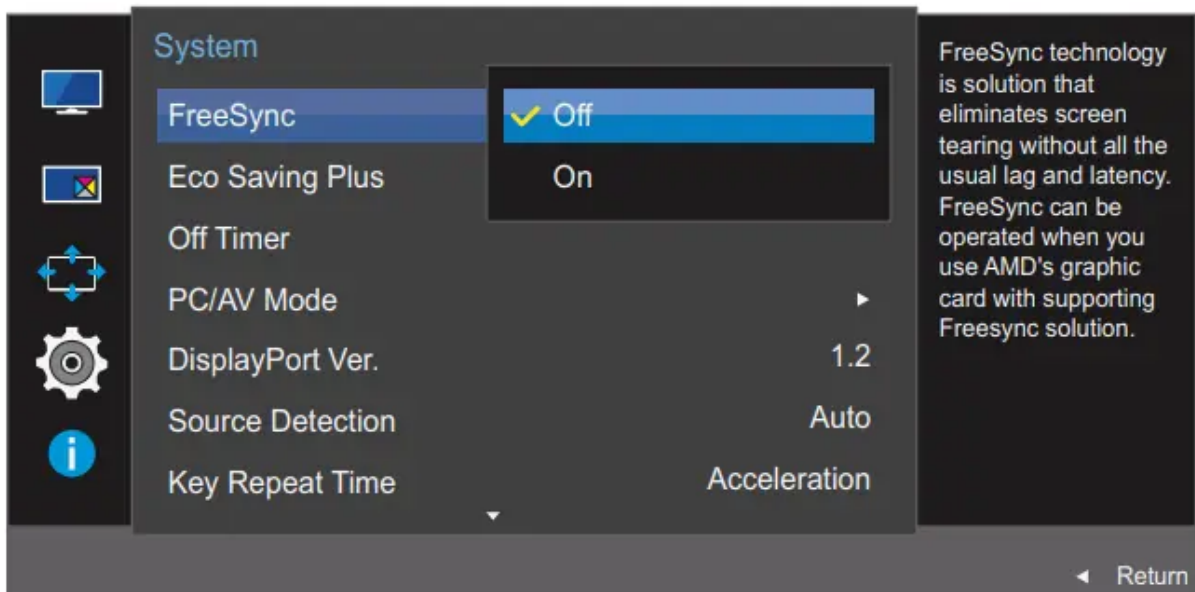

- Off: Disable FreeSync.
- On: Enable the basic FreeSync functions of the AMD graphics card.

U24E590D

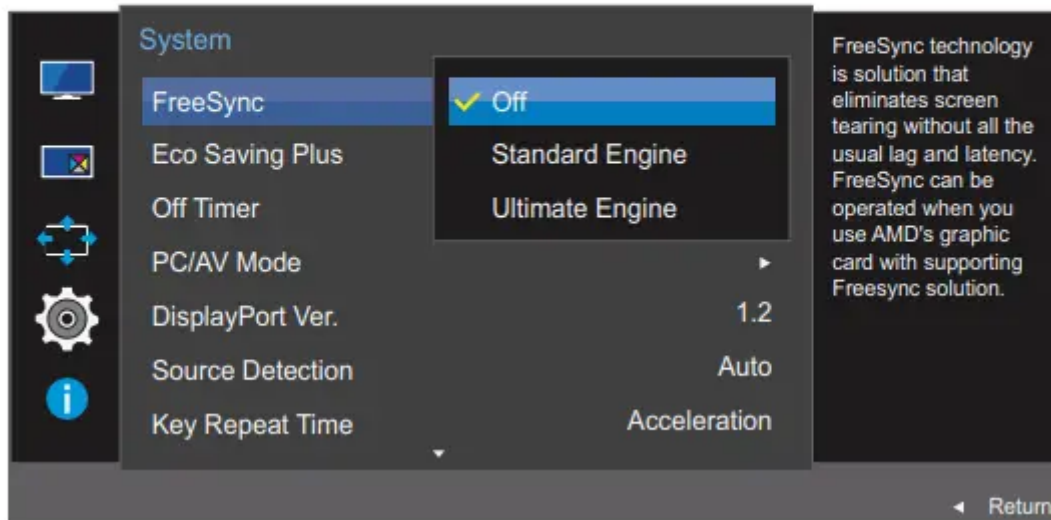

- Off: Disable FreeSync.
- Standard Engine: Enable the basic FreeSync functions of the AMD graphics card.
- Ultimate Engine: Enable the FreeSync feature with a higher screen frame rate. Screen tearing (abnormal sync between the screen and content) is reduced in this mode. Note that screen flickering may occur during game play.

If the FreeSync function is enabled, the screen may flicker when you play games

4. Move to the desired option controlling the JOG button UP/DOWN and press the JOG button.
5. The selected option will be applied.

FreeSync technology is solution that eliminates screen tearing without all the usual lag and latency.

FreeSync can be operated when you use AMD's graphic card with supporting FreeSync solution.

FreeSync is only supported by AMD graphics cards.

Select FreeSync Off if you are using a graphics card from a different manufacturer.

Please refer to the AMD's official website related situation.

Only a few of the following types of AMD graphics card can support FreeSync, and need to install the AMD's latest official FreeSync driver.

- Radeon R9 290X/290
- Radeon R9 285
- Radeon R7 260X/260
- AMD A10 "Kaveri" APU (ex. A10 7850K)

- For additional AMD graphics card models that support the FreeSync feature, visit the official AMD website.
- If the FreeSync function is enabled, the response rate during the game may fluctuate depending on the resolution. A higher resolution generally decreases the response rate.
- If the FreeSync function is enabled, the screen can flicker depending on the game option settings. Decreasing the game setting values might help to remove the flicker. Installing the latest drivers from the AMD website may also fix this issue.

Point the right mouse button, select the AMD Catalyst Control Center.

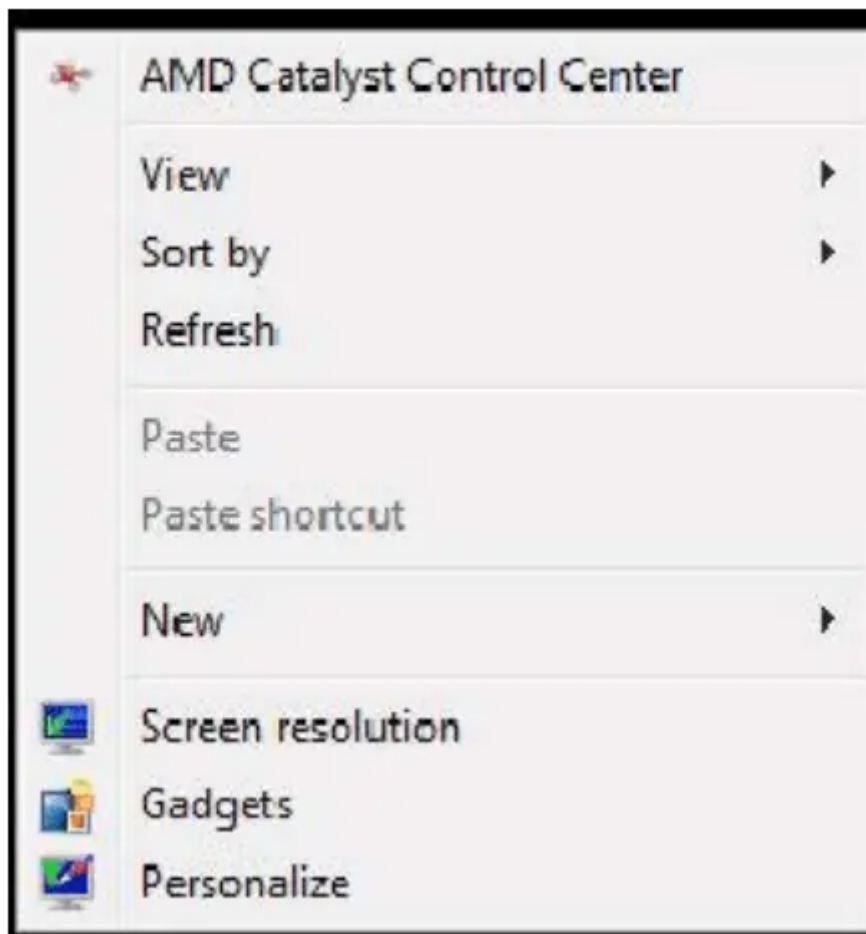

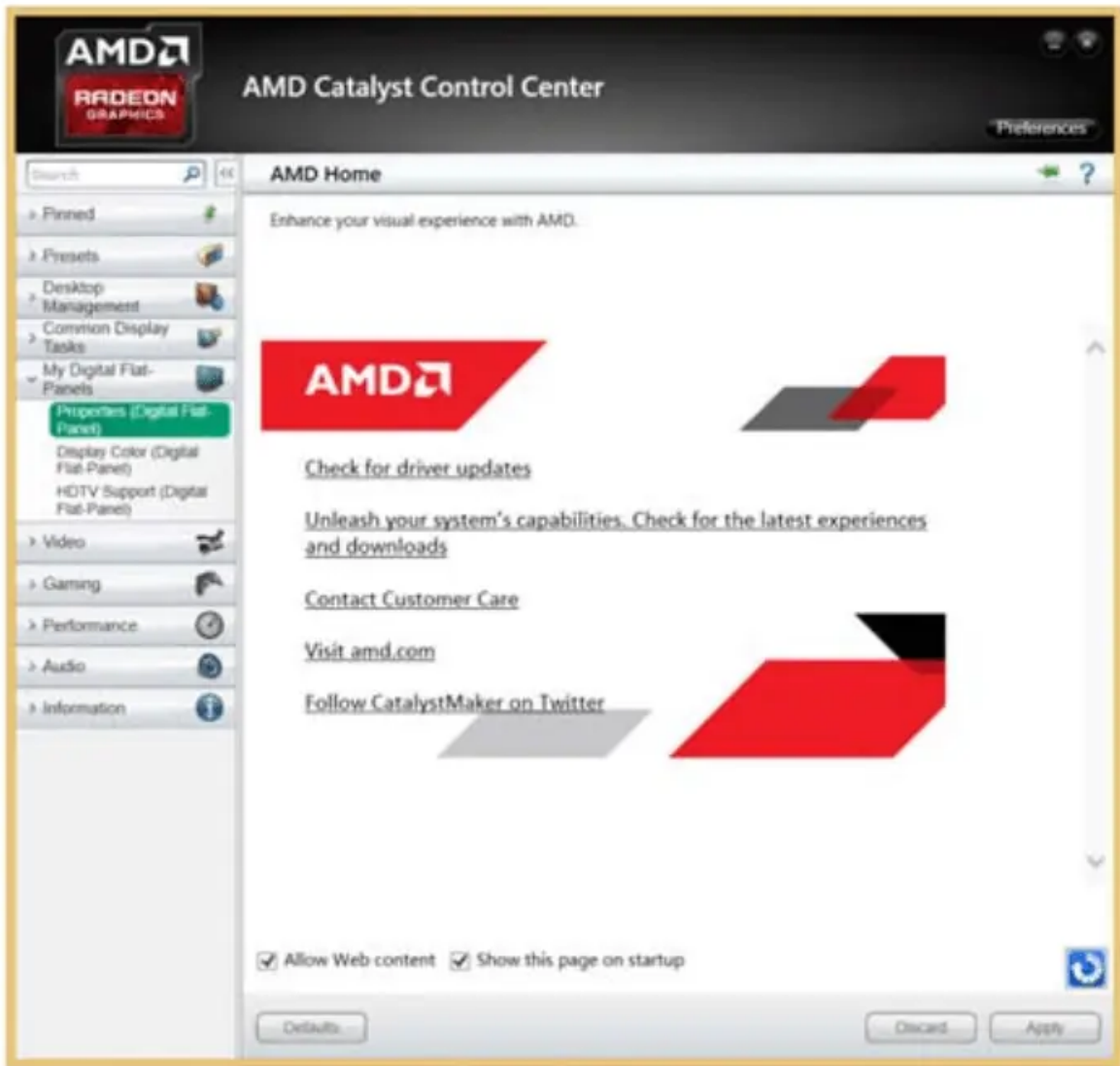

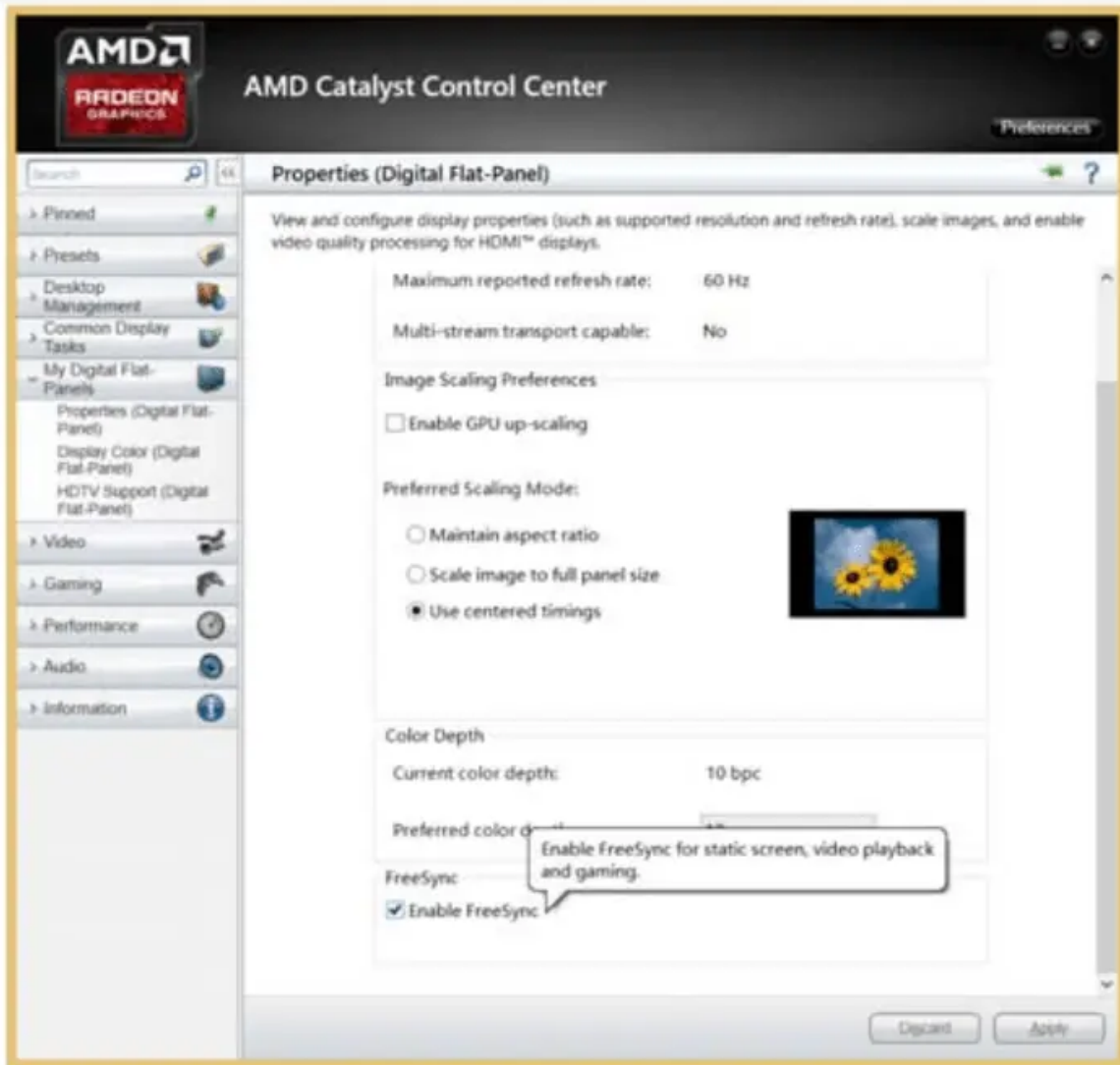

Eco Saving Plus

The Eco Saving Plus function reduces power consumption by controlling the electric current used by the monitor panel.

-

**SAMSUNG
MAGIC**

This menu is not available when

Bright is in Dynamic Contrast mode.

- This menu is not available when Game Mode is enabled.
- This menu is not available when Eye Saver Mode is enabled.
- Not available when PIP/PBP Mode is set to On.

Configuring Eco Saving Plus

1. When the Function Key Guide appears, select [] by moving the JOG button UP. Next, press the JOG button.
2. Move to System controlling the JOG button UP/DOWN and press the JOG button.
3. Move to Eco Saving Plus controlling the JOG button UP/DOWN and press the JOG button. The following screen will appear.

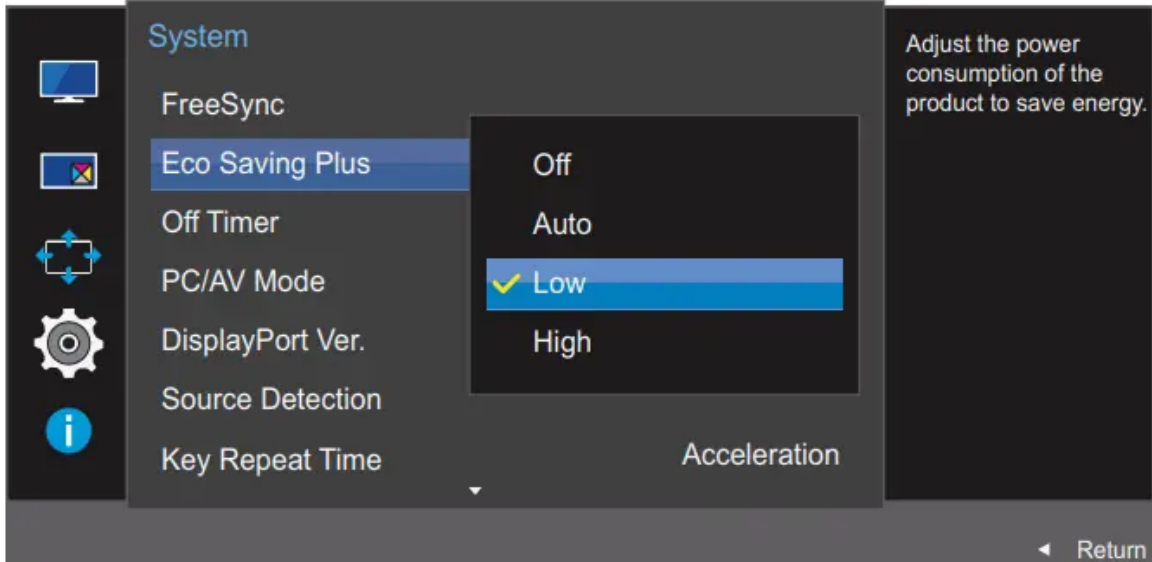

- Off: Deactivate the Eco Saving Plus function.
 - Auto: The power consumption will automatically be reduced by about 10% over the current setting. (The reduction of power consumption depends on the customer screen brightness condition.)
 - Low: The power consumption will be reduced by 25% over the default setting.
 - High: The power consumption will be reduced by 50% over the default setting.
4. Move to the desired option controlling the JOG button UP/DOWN and press the JOG button.
 5. The selected option will be applied.

Off Timer

You can set the product to automatically turn off.

Configuring Off Timer

1. When the Function Key Guide appears, select [] by moving the JOG button UP. Next, press the JOG button.
2. Move to System controlling the JOG button UP/DOWN and press the JOG button.

3. Move to Off Timer controlling the JOG button UP/DOWN and press the JOG button.
4. Move to Off Timer controlling the JOG button UP/DOWN and press the JOG button. The following screen will appear.

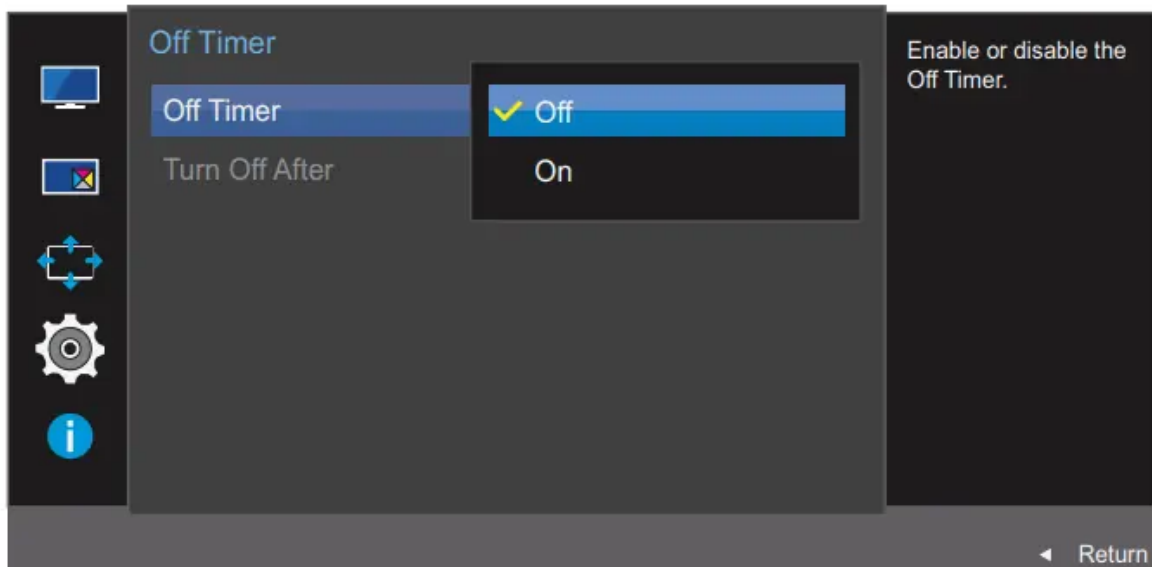
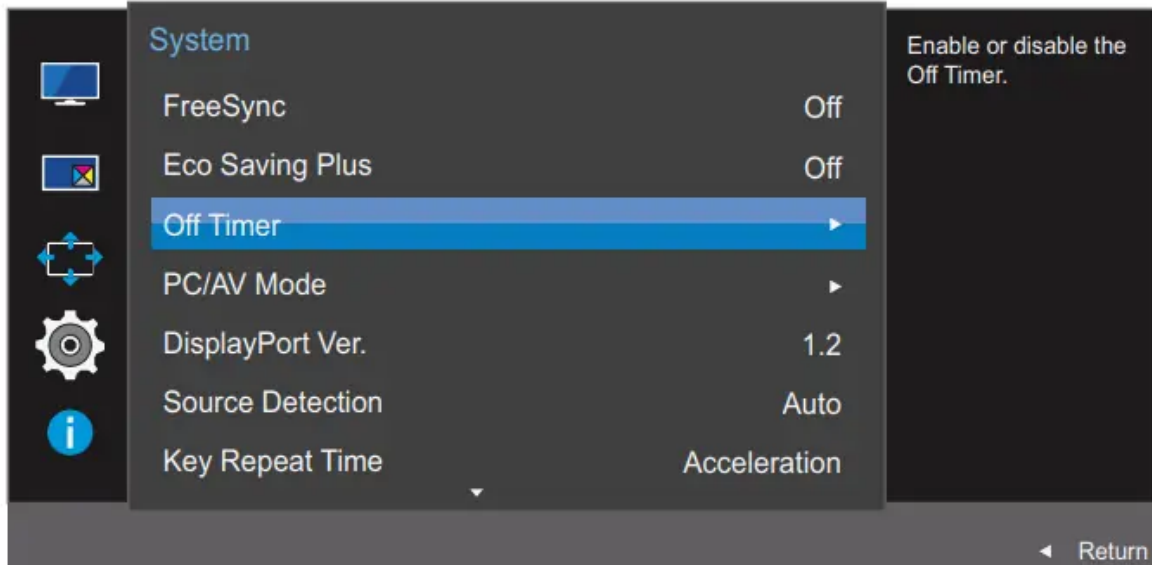

- Off: Deactivate the off timer so that the product does not power off automatically.
- On: Activate the off timer so that the product powers off automatically.

5. Move to the desired option controlling the JOG button UP/DOWN and press the JOG button.

6. The selected option will be applied.

Configuring Turn Off After

1. When the Function Key Guide appears, select [] by moving the JOG button UP. Next, press the JOG button.
- 2 Move to System controlling the JOG button UP/DOWN and press the JOG button.
3. Move to Off Timer controlling the JOG button UP/DOWN and press the JOG button.
4. Move to Turn Off After controlling the JOG button UP/DOWN and press the JOG button. The following screen will appear.

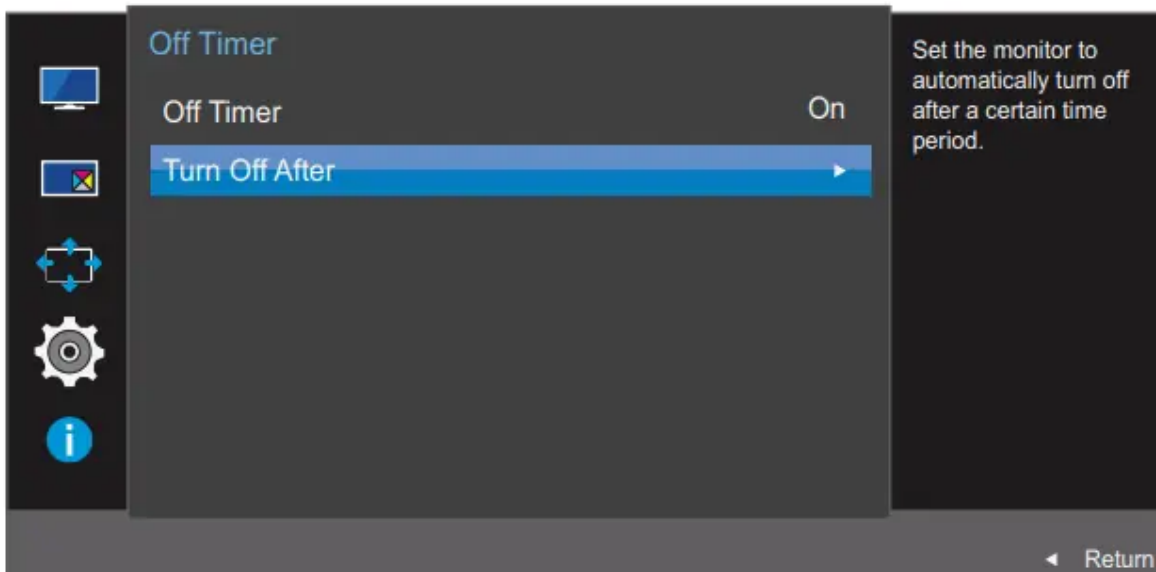

5. Adjust the Turn Off After controlling the JOG button LEFT/RIGHT.
6. The selected option will be applied.
 - The off timer can be set within a range of 1 to 23 hours. The product will automatically power off after the specified number of hours.
 - This option is only available when Off Timer is set to On.
 - For products for the market in some regions, the Off Timer is set to automatically activate 4 hours after the product powers on. This is done in accordance with power supply regulations. If you do not want the timer to activate, go to MENU -> System and set Off Timer to Off.

PC/AV Mode

Set PC/AV Mode to AV. The picture size will be enlarged. This option is useful when you view a movie.

- Supplied for the wide models only such as 16:9 or 16:10.
- If the monitor (when set to HDMI 1, HDMI 2 or DisplayPort) is in power saving mode or is displaying the message Check Signal Cable, press the MENU button to display the On Screen Display(OSD). You can select PC or AV.

Configuring PC/AV Mode

1. When the Function Key Guide appears, select [] by moving the JOG button UP. Next, press the JOG button.
2. Move to System controlling the JOG button UP/DOWN and press the JOG button.
3. Move to PC/AV Mode controlling the JOG button UP/DOWN and press the JOG button.
4. Move to the HDMI 1, HDMI 2 or DisplayPort controlling the JOG button UP/DOWN and press the JOG button. The following screen will appear.

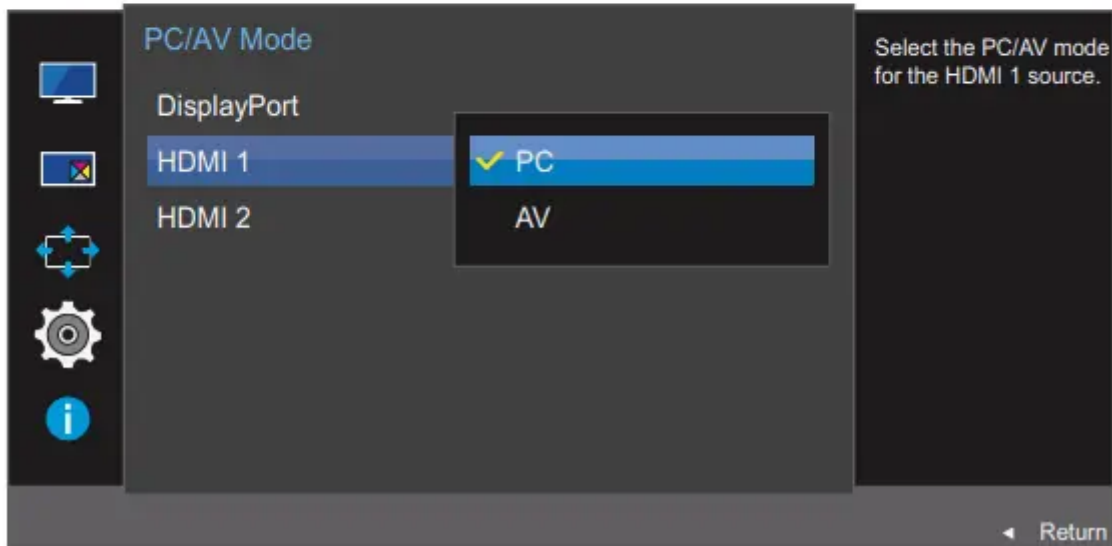
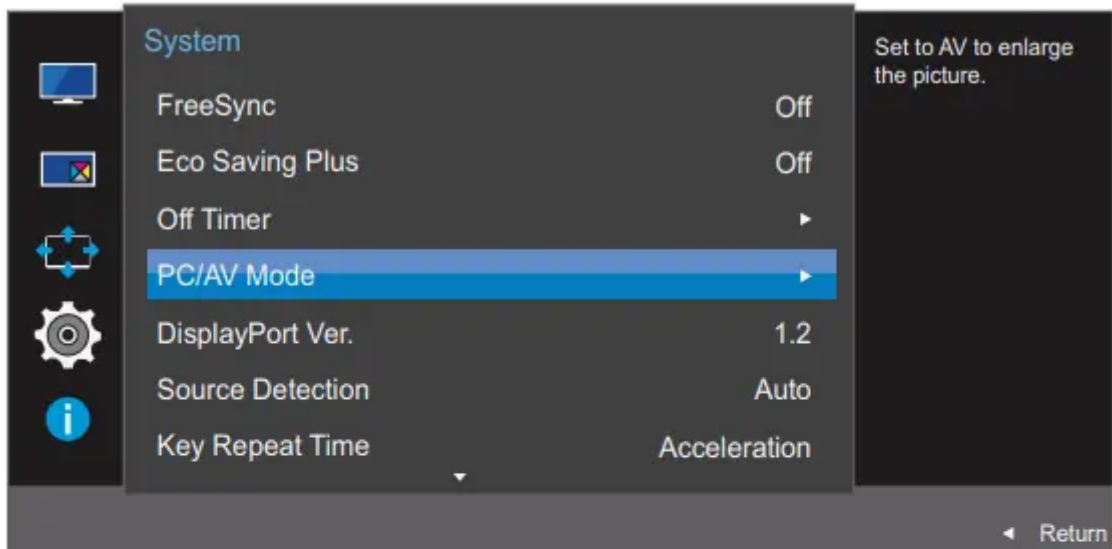

5. Move to the desired option controlling the JOG button UP/DOWN and press the JOG button.
6. The selected option will be applied.

DisplayPort Ver

Select your Displayport. Displayport 1.1 supports High Bit Rate 1, while 1.2 supports High Bit Rate 2.

- Incorrect settings may cause the screen to go blank. If this occurs, check the device specifications.
- If the monitor (when set to HDMI 1, HDMI 2 or DisplayPort) is in power saving mode or is displaying the message Check Signal Cable, press the [] button to display the On Screen Display (OSD). You can select 1.1 or 1.2.
- If you select 1.1, the maximum resolution of your screen drops to 2560 x 1440 due to the limitations in HBR1 transmission speeds.

Configuring DisplayPort Ver.

1. When the Function Key Guide appears, select [] by moving the JOG button UP. Next, press the JOG button.
2. Move to System controlling the JOG button UP/DOWN and press the JOG button.
3. Move to DisplayPort Ver. controlling the JOG button UP/DOWN and press the JOG button. The following screen will appear.

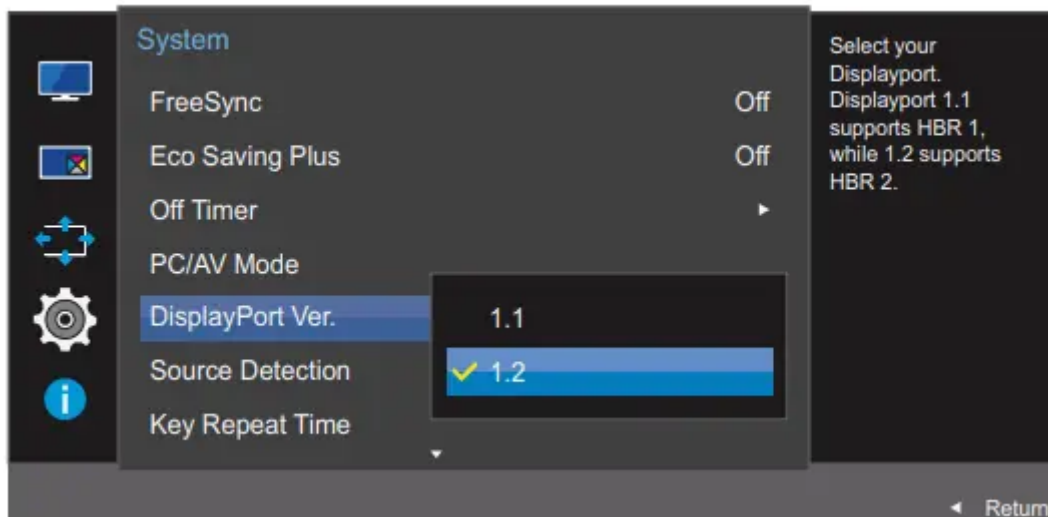

- 1.1 / 1.2

4. Move to the desired option controlling the JOG button UP/DOWN and press the JOG button.
5. The selected option will be applied.

Source Detection

You can activate Source Detection.

Not available when PIP/PBP Mode is set to On.

Configuring Source Detection

1. When the Function Key Guide appears, select [] by moving the JOG button UP. Next, press the JOG button.
2. Move to System controlling the JOG button UP/DOWN and press the JOG button.
3. Move to Source Detection controlling the JOG button UP/DOWN and press the JOG button. The following screen will appear.

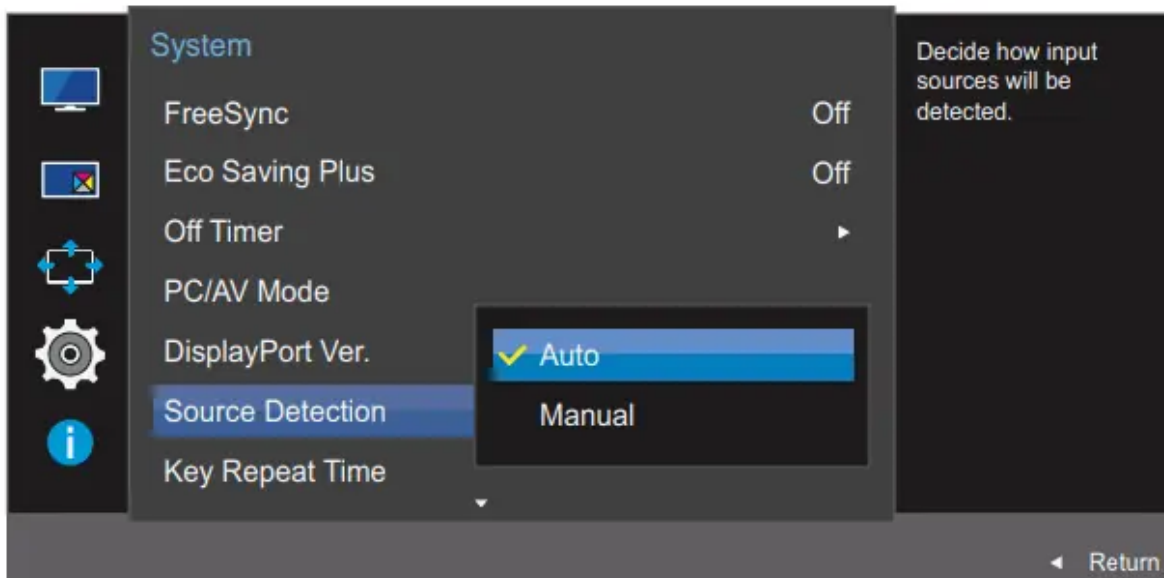

- Auto: The input source is automatically recognized.
 - Manual: Manually select an input source.
4. Move to the desired option controlling the JOG button UP/DOWN and press the JOG button.
 5. The selected option will be applied.

Key Repeat Time

Control the response rate of a button when the button is pressed.

Configuring Key Repeat Time

1. When the Function Key Guide appears, select [] by moving the JOG button UP. Next, press the JOG button.
2. Move to System controlling the JOG button UP/DOWN and press the JOG button.

3. Move to Key Repeat Time controlling the JOG button UP/DOWN and press the JOG button. The following screen will appear.

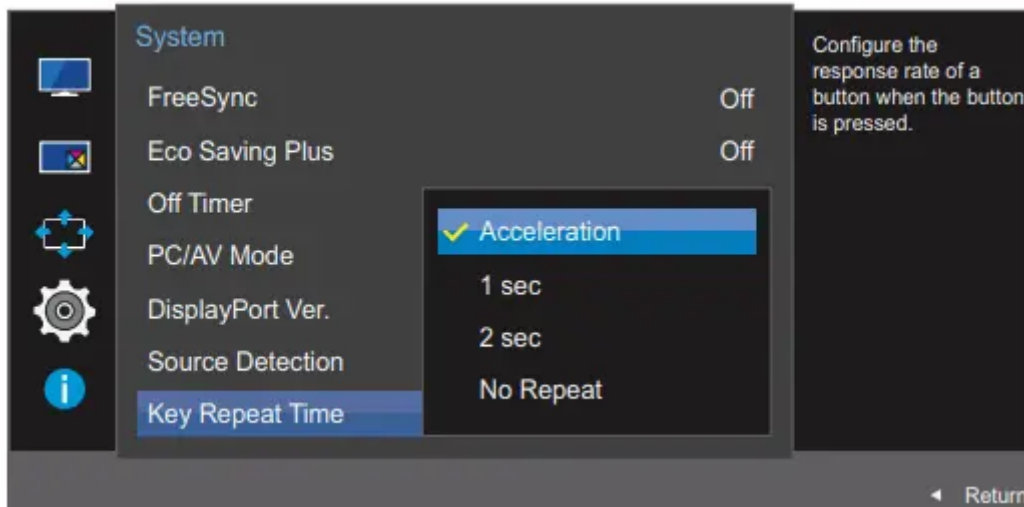

- Acceleration, 1 sec, or 2 sec can be selected. If No Repeat is selected, a command responds only once when a button is pressed.

4. Move to the desired option controlling the JOG button UP/DOWN and press the JOG button.

5. The selected option will be applied.

Power LED On

Configure the settings to enable or disable the power LED located at the lower part of the product.

Configuring Power LED On

1. When the Function Key Guide appears, select [] by moving the JOG button UP. Next, press the JOG button.
2. Move to System controlling the JOG button UP/DOWN and press the JOG button.
3. Move to Power LED On controlling the JOG button UP/DOWN and press the JOG button. The following screen will appear.

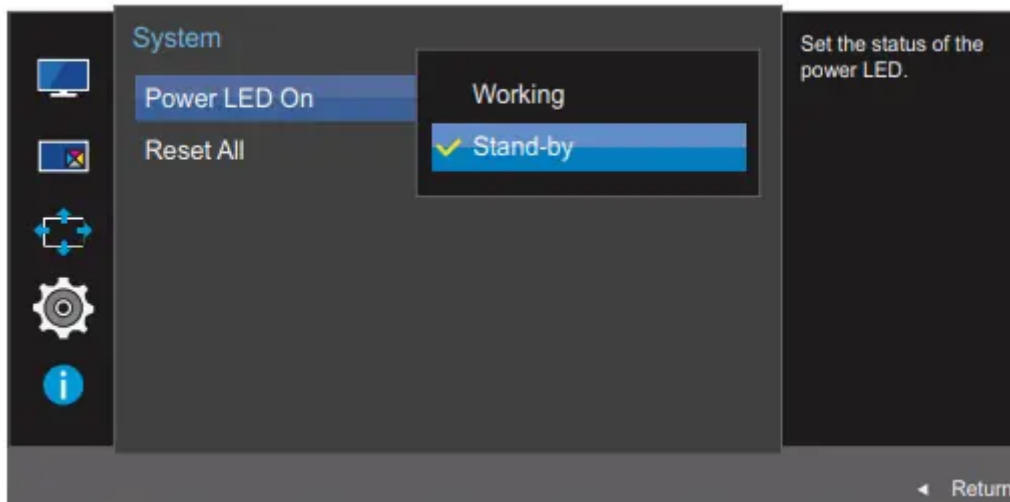

- Working: The power LED is on when the product is turned on.
 - Stand-by: The power LED is on when the product is turned off.
4. Move to the desired option controlling the JOG button UP/DOWN and press the JOG button.
 5. The selected option will be applied.

Reset All

Return all the settings for the product to the default factory settings.

Initializing Settings (Reset All)

1. When the Function Key Guide appears, select [] by moving the JOG button UP. Next, press the JOG button.
2. Move to System controlling the JOG button UP/DOWN and press the JOG button.
3. Move to Reset All controlling the JOG button UP/DOWN and press the JOG button. The following screen will appear.

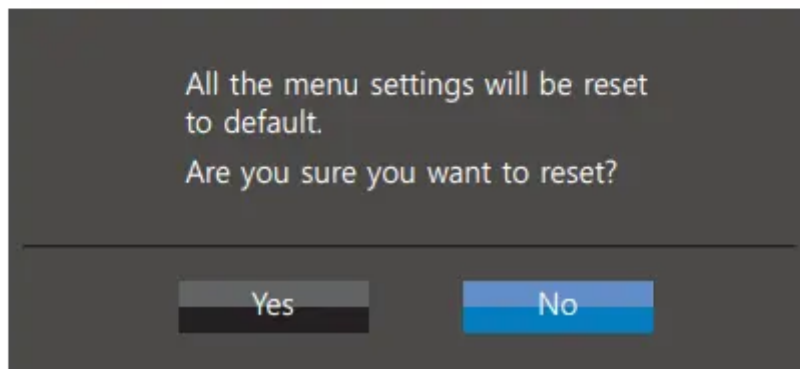
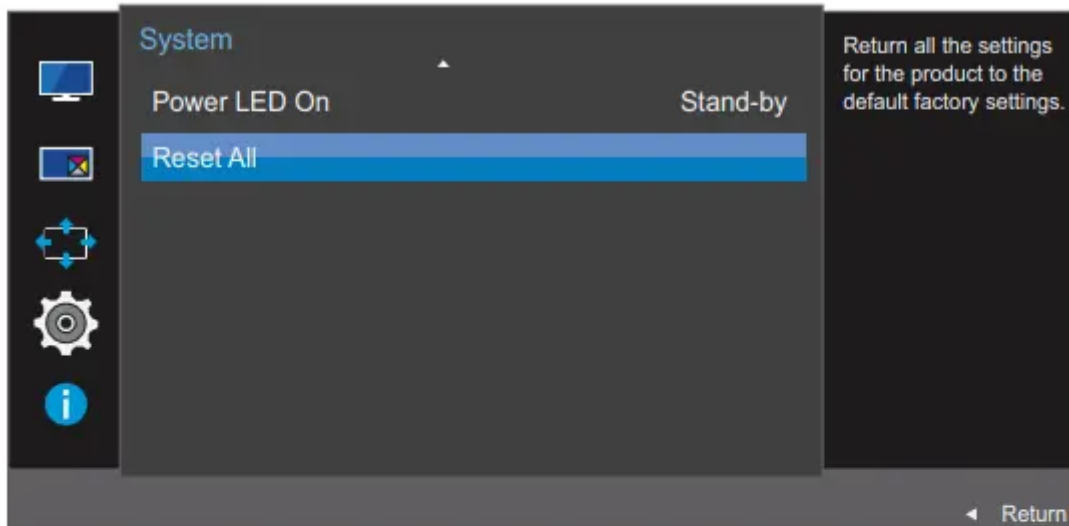

4. Move to the desired option controlling the JOG button LEFT/RIGHT and press the JOG button.
5. The selected option will be applied.

Troubleshooting Guide

Requirements Before Contacting Samsung Customer Service Center

Testing the Product

Before calling Samsung Customer Service Center, test your product as follows. If the problem persists, contact Samsung Customer Service Center.

Check if your product is operating normally by using the product test function.

If the screen is turned off and the power indicator blinks even though the product is properly connected to a PC, perform a self-diagnosis test.

1. Power off both the PC and product.
2. Disconnect the cables from the product.

3. Power on the product.

4. If the message Check Signal Cable appears, the product is working normally.

If the screen remains blank, check the PC system, video controller and cable.

Checking the Resolution and Frequency

- For a mode that exceeds the supported resolution (refer to "10.3 Standard Signal Mode Table"), the message Not Optimum Mode will appear for a short time.

Check the following.

Installation issue (PC mode)

Issues	Solutions
The screen keeps switching on and off.	Check the cable connection between the product and PC, and ensure the connectors are locked. (Refer to "2.2 Connecting and Using a PC")

Screen issue



Issues	Solutions
The power LED is off. The screen will not switch on.	Check that the power cable is connected properly. (Refer to "2.2 Connecting and Using a PC")
The message Check Signal Cable appears.	Check that the cable is properly connected to the product. (Refer to "2.2 Connecting and Using a PC")
	Check that the device connected to the product is powered on
Not Optimum Mode is displayed.	This message appears when the signal from the graphics card exceeds the maximum resolution or frequency for the product.
	Change the maximum resolution and frequency to suit the product performance, referring to Standard Signal Mode Table (page 92).
The images on the screen look distorted.	Check the cable connection to the product. (Refer to "2.2 Connecting and Using a PC")
The screen appears unstable and shaky.	Check that the resolution and frequency for the PC are within the range of resolution and frequency compatible with the product. Next, if required, change the settings, referring to Standard Signal Mode Table (page 92) in this manual and the Information menu on the product.
There are shadows or ghost images left on the screen	
The screen is too bright. The screen is too dark.	Adjust Brightness (page 38) and Contrast (page 39).
Screen color is inconsistent.	Change the Color settings. (Refer to "3.5 Color")
The colors on the screen have a shadow and are distorted.	Change the Color settings. (Refer to "3.5 Color")
White does not really look white.	Change the Color settings. (Refer to "3.5 Color")
There is no image on the screen and the power LED blinks every 0.5 to 1 second.	The product is operating in power-saving mode.
	Press any key on the keyboard or move the mouse to return to normal operating mode.

Sound issue



Issues	Solutions
There is no sound.	Check the connection of the audio cable or adjust the volume.
	Check the volume.
The volume is too low.	Adjust the volume
	If the volume is still low after turning it up to the maximum level, adjust the volume on your PC sound card or software program.

Source device issue

Issues	Solutions
A beeping sound is heard when my PC is booting	If a beeping sound is heard when your PC is booting, have your PC serviced.

The LED lights on the frame of the product may be seen depending on the user's viewing angle. The light is harmless to people and has no bearing on product features and performance. The product is safe to use



Q & A

Question	Answer
<p>How can I change the frequency?</p>	<p>Set the frequency on your graphics card.</p> <ul style="list-style-type: none"> • Windows XP: Go to Control Panel -> Appearance and Themes -> Display -> Settings -> Advanced -> Monitor, and adjust Refresh rate under Monitor settings. • Windows ME/2000: Go to Control Panel -> Display -> Settings -> Advanced -> Monitor, and adjust Refresh rate under Monitor settings. • Windows Vista: Go to Control Panel -> Appearance and Personalization -> Personalization -> Display Settings Advanced Settings -> Monitor, and adjust Refresh rate under Monitor settings. • Windows 7: Go to Control Panel -> Appearance and Personalization -> Display -> Screen Resolution -> Advanced settings -> Monitor, and adjust Refresh rate under Monitor settings. • Windows 8: Go to Settings -> Control Panel -> Appearance and Personalization -> Display -> Screen Resolution -> Advanced settings -> Monitor, and adjust Refresh rate under Monitor settings. • Windows 10: Go to Settings -> System -> Display -> Advanced display settings -> Display adapter properties Monitor, and adjust Screen refresh rate under Monitor settings.
<p>How can I change the resolution?</p>	<ul style="list-style-type: none"> • Windows XP: Go to Control Panel -> Appearance and Themes -> Display -> Settings, and adjust the resolution. • Windows ME/2000: Go to Control Panel -> Display Settings, and adjust the resolution. • Windows Vista: Go to Control Panel -> Appearance and Personalization -> Personalize Display Settings, and adjust the resolution. • Windows 7: Go to Control Panel -> Appearance and Personalization -> Display -> Adjust Resolution, and adjust the resolution. • Windows 8: Go to Settings -> Control Panel -> Appearance and Personalization -> Display -> Adjust Resolution, and adjust the resolution. • Windows 10: Go to Settings -> System -> Display -> Advanced display settings, and adjust the resolution

<p>How do I set power-saving mode?</p>	<ul style="list-style-type: none">• Windows XP: Set power-saving mode in Control Panel -> Appearance and Themes -> Display -> Screen Saver Settings -> Power options or BIOS SETUP on the PC.• Windows ME/2000: Set power-saving mode in Control Panel -> Display -> Screen -> Saver Settings -> Power options or BIOS SETUP on the PC.• Windows Vista: Set power-saving mode in Control Panel -> Appearance and Personalization -> Personalize -> Screen Saver Settings -> Power options or BIOS SETUP on the PC.• Windows 7: Set power-saving mode in Control Panel -> Appearance and Personalization -> Personalize -> Screen Saver -> Settings -> Power options or BIOS SETUP on the PC.• Windows 8: Set power-saving mode in Settings -> Control Panel -> Appearance and Personalization -> Personalize -> Screen Saver -> Settings -> Power options or BIOS SETUP on the PC.• Windows 10: Set power-saving mode in Settings Personalization Lock screen Screen timeout settings Power & sleep or BIOS SETUP on the PC
--	---

Refer to the user manual for your PC or graphics card for further instructions on adjustment.



Specifications

General

Model Name		U28E590D	U24E590D
Panel	Size	70.8 cm	59.8 cm
	Display area	620.93 mm (H) x 341.28 mm (V)	521.28 mm (H) x 293.22 mm (V)
	Pixel Pitch	0.16 mm (H) x 0.16 mm (V)	0.4525 mm (H) x 0.13575 mm (V)
Power Supply		AC 100 - 240 V ~ (+/- 10 %), 50/60 Hz ± 3 Hz Refer to the label at the back of the product as the standard voltage can vary in different countries.	
Dimensions (W x H x D) / Weight	Without Stand	660.9 x 381.3 x 73.5 mm	561.1 x 333.0 x 62.8 mm
	With Stand	660.9 x 468.5 x 187.1 mm / 5.28 kg	561.1 x 428.0 x 187.1 mm / 4.61 kg
VESA Mounting Interface		75 mm x 75 mm (For use with Specialty(Arm) Mounting hardware.)	
Environmental considerations	Operating	Temperature : 10 °C – 40 °C (50 °F – 104 °F) Humidity : 10 % – 80 %, non-condensing	
	Storage	Temperature : -20 °C – 45 °C (-4 °F – 113 °F) Humidity : 5 % – 95 %, non-condensing	

- Plug-and-Play: This monitor can be installed and used with any Plug-and-Play compatible systems. Two-way data exchange between the monitor and PC system optimizes the monitor settings. Monitor installation takes place automatically. However, you can customize the installation settings if desired.
- Panel Dots (Pixels): Due to the nature of the manufacturing of this product, approximately 1 pixel per million (1ppm) may be brighter or darker on the LCD panel. This does not affect product performance.
- The above specifications are subject to change without notice to improve quality.
- This device is a Class B digital apparatus.

PowerSaver

The power-saving function of this product reduces power consumption by switching off the screen and changing the color of the power LED if the product is not used for a specified period of time. The power is not turned off in power-saving mode. To switch the screen back on, press any key on the keyboard or move the mouse. Power-saving mode functions only when the product is connected to a PC that has a power-saving function.

PowerSaver	Energy Star Test Condition	Power saving mode	Power off (Power button)
Power Indicator	Off	Blinking	On
Power Consumption (U28E590D)	Typical 29.6 W	Typical 0.3 W	Less than 0.3 W
Power Consumption (U24E590D)	Typical 34.3 W	Typical 0.3 W	Less than 0.3 W

- The power consumption level can vary in different operating conditions or when settings are changed.
- ENERGY STAR® is a US registered mark of the United States Environmental Protection Agency. Energy Star power is measured with the test method in the current Energy Star® Standard.
- To reduce the power consumption to 0, disconnect the power cord. Be sure to disconnect the power cable when you will not be using the product for an extended period of time. To reduce the power consumption to 0 watts when the power switch is not available, disconnect the power cable.

Warning

This content is compiled from multiple sources and is provided for reference purposes only. It may not be complete or fully applicable to all situations. If you are unable to resolve your issue, please contact the product manufacturer or an authorized service provider for official support.

