

REMOTE CONTROL

Remote control instructions in TV mode



- ⏻**: Switch the TV between on and standby mode
- USB**: Select USB mode
- P.MODE**: Select picture mode
- S.MODE**: Select sound mode
- SLEEP**: Set the TV sleep timer: OFF/5/10.../180/240 min
- ASPECT**: Select the aspect ratio settings
- 0-10**: Select a program (ATV/DTV mode)
- /10+**: Enter multiple program channel number such as 2-1
- ↶**: Return to previous viewing channel
- VOL +/-**: Adjust the volume
- MUTE**: Press this button to mute or restore sound.
- 🔇**: Mute and restore your TV sound
- SOURCE**: Select among the different input signal sources
- CH +/-**: Select a channel
- AUDIO**: Change the audio language or audio channel (DVD mode).
- MTS**: Switch among different audio channels: STEREO/MONO/SAP
- MENU**: Display the OSD (on screen display) menu
- FREEZE**: Freeze the picture.
- INFO**: Display the present screen information such as the current channel and input source
- RETURN/▲**: Open/Close the DVD.
- OK**: Confirm the selection in the OSD'on screen display' menus
- ◀ ▲ ▼ ▶**: Allows you to navigate the OSD menus and adjust the system settings to your preference.
- CH.LIST**: Display program list.
- DVD.SETUP**: Displays the DVD OSD menu.
- EXIT**: Exit the OSD menu
- ▶||**: Start playback or pause
- : .Press once to stop.
- ⏮**: Skip to the beginning of the previous chapter/track/photo.

▶▶: Skip to the beginning of the next chapter/track/photo.

REPEAT: Select between different repeat modes.

CC: Closed Caption selection: ON/OFF/CC On Mute

◀◀: Reverse playback rapidly.

V-CHIP: Set up parental control

▶▶: Advance playback rapidly.

SUBTITLE: Display the subtitle.

AUTO: Press to adjust the picture automatically in VGA source

TITLE: Press to return to the main title page. (DVD mode).

ADD/ERASE: Add or delete favorite channels

DVD.MENU: To show the menu of the DVD disc.

FAV: Display the favorite channel list.

GOTO: Skips to a specific location on a DVD / CD. (DVD mode).

SLOW: Press to select the slow speed playing. (DVD mode).

A-B: Repeats a segment between A and B. (DVD mode).

Remote control setup

1. Open the cover
2. Uses AAA size batteries. When inserting the batteries, make sure correct polarities "+" and "-" marks on the batteries line up correctly with compartment markings.
3. Replace the battery cover.

To prevent battery leakage which may result in bodily injury or damage to the remote:

1. Install all batteries correctly, and as marked on the remote control.
2. Do not mix batteries: (OLD and NEW or CARBON and ALKALINE, etc)
Remove batteries when the remote is not used for a long period of time.



MENU OPERATION

Setup Wizard

Select Language

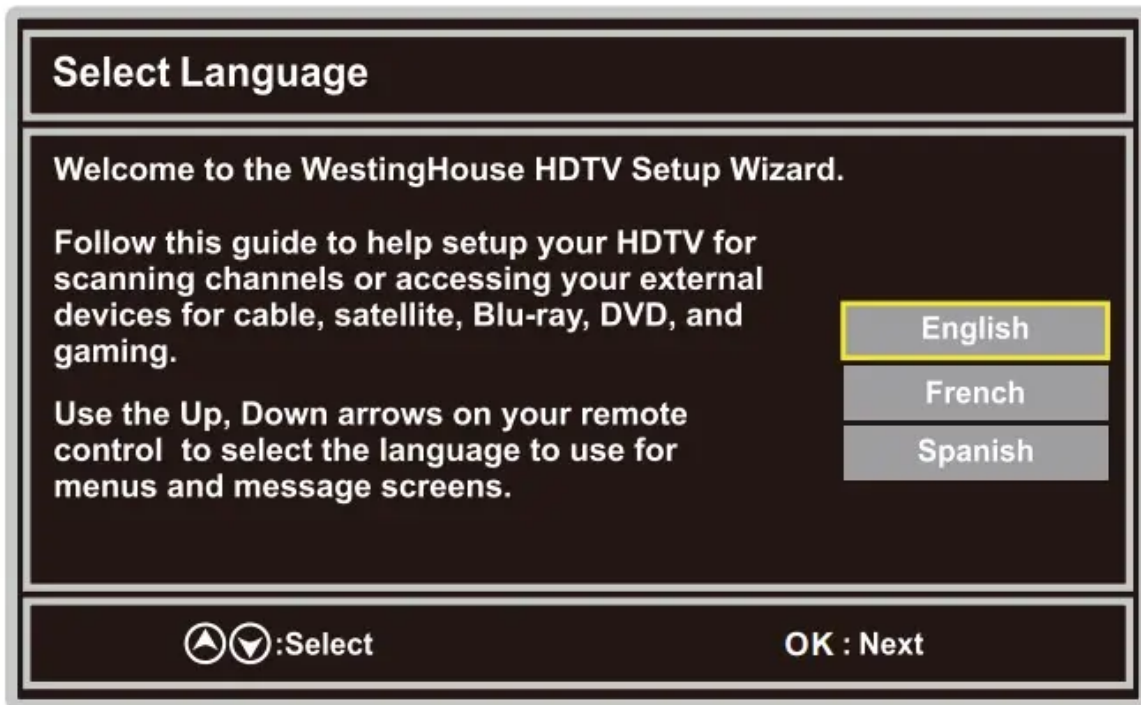

Power On Mode

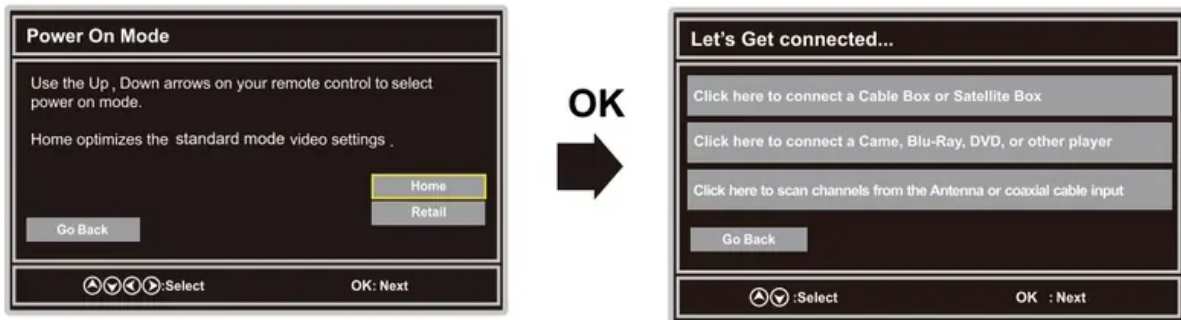

The SLEEP-MODE Power should be less than 0.5W

Channel Scan

Let's Get connected...

Click here to connect a Cable Box or Satellite Box

Click here to connect a Game, Blu-Ray, DVD, or other player

Click here to scan channels from the Antenna or coaxial cable input

Go Back

⬆️⬇️⬆️>Select OK: Next

Scan Channels from the Antenna or coaxial cable input

Use the Up , Down arrows on your remote control to select the channel scan type.

Antenna[ATSC]

Cable

Go Back

⬆️⬇️⬆️⬆️>Select OK: Next

Cable or Satellite Source Input

Use the Left, Right arrows on your remote control to select the input connected to the set top box?
For optimal video quality, we recommend HDMI or YPbPr (refer to Quick Connect Guide or User Manual to help you determine what connection you are using).

HDMI1 HDMI2 HDMI3 YPbPr/AV

Antenna

Go Back

⬆️⬇️⬆️⬆️>Select OK: Next

Scanning Channels

Analog	:	0
Digital	:	0
RF CH	:	5
Total Found	:	0

Menu: Skip DTV

Antenna RF Warning

Notice:Westinghouse Electronics does not recommend using the RF Antenna input as your cable or satellite connection because it will provide poor video quality to your HDTV.Use a different connection for optimum conditions.If you do not have a cable box that provides an HD quality signal,we recommend that you call your cable provider for an upgrade.Otherwise,select Proceed.

Exit Setup Proceed

Go Back

⬆️⬇️⬆️⬆️>Select OK: Next

Source Input List

YPbPr/AV

DVD

HDMI1

HDMI2

HDMI3

VGA

USB

Go Back

⬆️⬇️⬆️⬆️>Select OK: Next



Select Input Source



- Press **SOURCE** button to display the input source list.
- Press **▼/▲** button to select the input source you want to watch.
- Press **ok** button to enter the selected source.

Basic Operation





- Press MENU button to display the MAIN OSD MENU.
- Press **◀/▶** button to select the MENU you want.
- Press **▼** button to enter the sub menu.
- Press **▼/▲** button to select the option and then press **◀/▶** to adjust the value in the sub menu.
- You can press MENU button to go back to the upper menu or EXIT button to close the OSD.



For TV Mode

Picture Menu





1. Press 
2. Press  button to select the option that you want to adjust in the Picture menu.
3. Press  button to desired level.
4. When you have changed the settings. you can exit from the menu by pressing MENU.



Picture Mode

Press  button to select Picture Mode. then press button  to adjust.
Available picture mode: Standard. Retail. Movie. User.



Brightness

Press  button to select Brightness. then press button  to adjust.



Contrast

Press  button to select Contrast. then press button  to adjust.

Color

Press  button to select Color. then press button  to adjust.

Tint

Press  button to select Tint. then press button  to adjust.

Sharpness

Press ▼/▲ button to select Sharpness. then press button ◀/▶ to adjust.

Color Temperature

Press ▼/▲ button to select Color Temperature. then press ◀/▶ to adjust.

Advanced Settings

Press ▼/▲ button to select Advanced Settings. then press **ok** button to enter.
Adjust advanced video features to fine tune the picture.



Aspect Ratio

Press ◀/▶ button to select Aspect Ratio. then press button ◀/▶ to adjust. Available Aspect Ratio:
Standard. Fill. Over Scan.

Noise Reduction

Press ▼/▲ button to select the item Noise Reduction. then press button ◀/▶ to adjust.
Available Noise Reduction: Off. Weak. edium. trong.

Dynamic Contrast

Press ▼/▲ button to select Dynamic Contrast. then press button ◀/▶ to adjust On or Off. It can adjust the contrast corresponding to the input signal in order to improve the picture quality displayed.

Color Space

Press ▼/▲ button to select Color Space. then press **ok** button to enter.

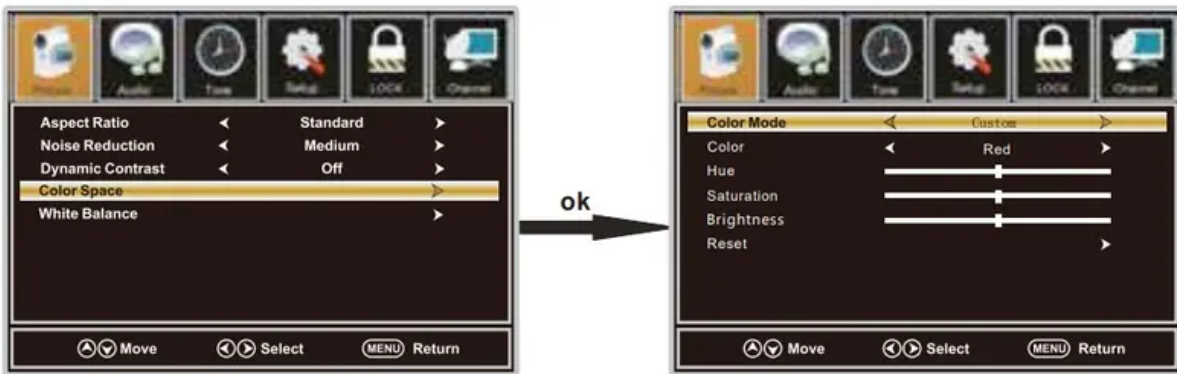

Color Mode

Press ▼/▲ button to select Color Mode. then press button ◀/▶ to adjust. Available Color Mode: Auto. Native. Custom.

Color

Press ▼/▲ button to select Color. then press button ◀/▶ to adjust. Available Color Mode: Red. Green. Blue. Yellow. Cyan. Magenta.(It is available in Custom mode.)

Hue

Press ▼/▲ button to select Hue. then press button ◀/▶ to adjust.(It is available in Custom mode.)

Saturation

Press ▼/▲ button to select Saturation. then press button ◀/▶ to adjust.(It is available in Custom mode.)

Brightness

Press ▼/▲ button to select Brightness. then press button ◀/▶ to adjust.(It is available in Custom mode.)

Reset

Press ▼/▲ button to select Reset. Press ok to enter. then press button to select No or Yes.

White Balance

Press ▼/▲ button to select White Balance. then press ok button to enter.

Press ▼/▲ button to select the option you want. hen press button ◀/▶ to adjust.

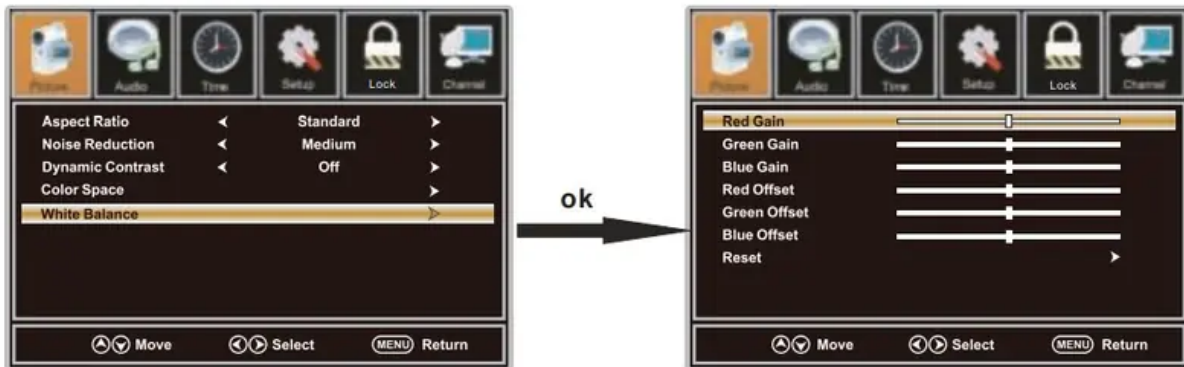

Audiomenu

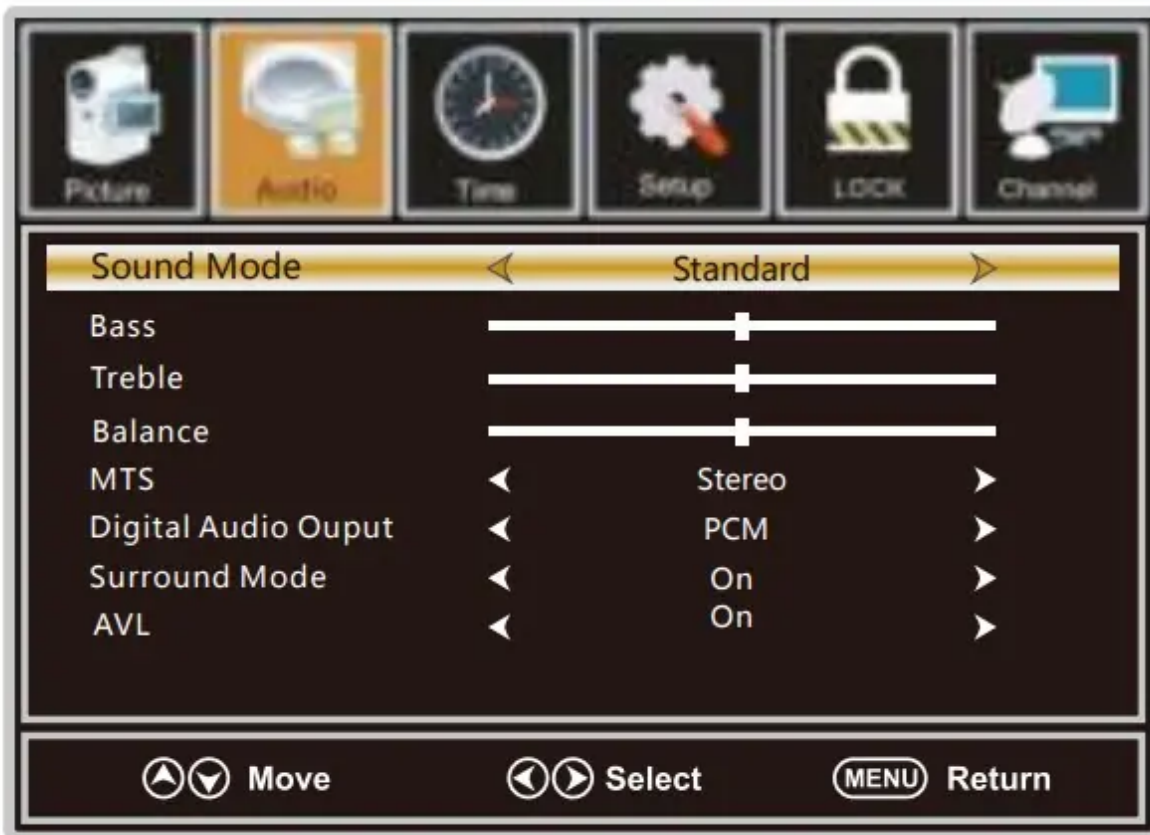

1. Press / button to select Audio in the main menu.
2. Press / button to select the option that you want to adjust in the Audio menu
3. Press / button to desired level.
4. When you have changed the settings. you can exit from the menu by pressing MENU.

Sound Mode

Press / button to select the item Sound Mode. then press button / to select the desired mode.

Available Sound Mode: Sports. User. Standard. Music. Movie. Select a sound mode to achieve ideal sound.

Bass

Press ▼/▲ button to select Bass. then press button ◀/▶ to adjust.

Treble

Press ▼/▲ button to select Treble. then press button ◀/▶ to adjust.

Balance

Press ▼/▲ button to select Balance. then press button ◀/▶ to adjust.

MTS

Press ▼/▲ button to select MTS. then press button ◀/▶ to adjust.

Digital Audio Output

Press ▼/▲ button to select the item Digital Audio Output. then press button ◀/▶ to select the desired digital audio output. Available digital audio output: PCM. Raw and Off .

Surround Mode

Press ▼/▲ button to select the item Surround Mode. then press button ◀/▶ to select On or Off.

AVL

Press ▼/▲ button to select the item AVL. then press ◀/▶ to select On or Off.

Volume Level can set the volume automatically adjust corresponding to the input audio.

Time menu



1. Press button to select Time in the main menu.
2. Press button to select the option that you want to adjust in the Time menu.
3. .Press to desired level
4. When you have changed the settings. you can exit from the menu by pressing MENU.

Sleep Time

Press button to select Sleep Timer. then press button to set.
 Available Sleep Timer: Off. 5Min. 10Min. 15Min. 30Min. 60Min. 90Min. 120Min. 180Min. 240Min.

Time Zone

Select a Timezone among: Pacific/Alaska/Hawaii/Eastern/Central/Moutain/Atlantic or Newfoundland.

Daylight Saving Time

Select to turn On/Off daylight saving time.

Setup Menu



1. Press button to select Setup in the main menu.
2. Press button to select the option that you want to adjust in the Setup menu.
3. Press button to desired level.
4. When you have changed the settings. you can exit from the menu by pressing MENU.

Menu Language

Press button to select the item Menu Language. then press button to adjust.
Available Language: English. French. Spanish.

OSD Timeout

Press button to select OSD Timeout. then press button to set.
Available OSD Timeout: 5Sec. 15Sec. 30Sec. 45Sec. 60Sec..

Closed Caption

Press button to select Closed Caption. then press OK button to enter.



CC mode

Press **▼/▲** button to select CC mode, then press button **◀/▶** to select CC off, CC on, CCon Mute

Analog CC

Press **▼/▲** button to select Analog CC. then press button **◀/▶** to select.

Available Analog CC: CC1. CC2. CC3. CC4. Text1. Text2. Text3. Text4.

Digital CC

Press **▼/▲** button to select Digital CC. hen press Service3. Service4. Service5. Services6.

Option

Press **▼/▲** button to select Option. hen press **▶** button enter submenu.

Other Settings

Press **▼/▲** button to select Other Settings. then press OK button to enter.

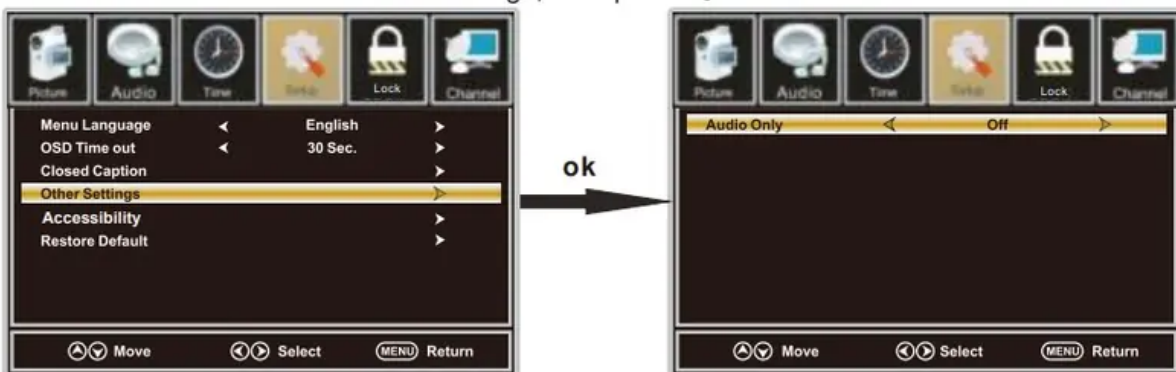

Audio Only

Press **▼/▲** button to select Audio Only. then press **◀/▶** button to set On or Off.

Accessibility



Press **▼/▲** button to select Accessibility. then press button **◀/▶** to set On or Off.

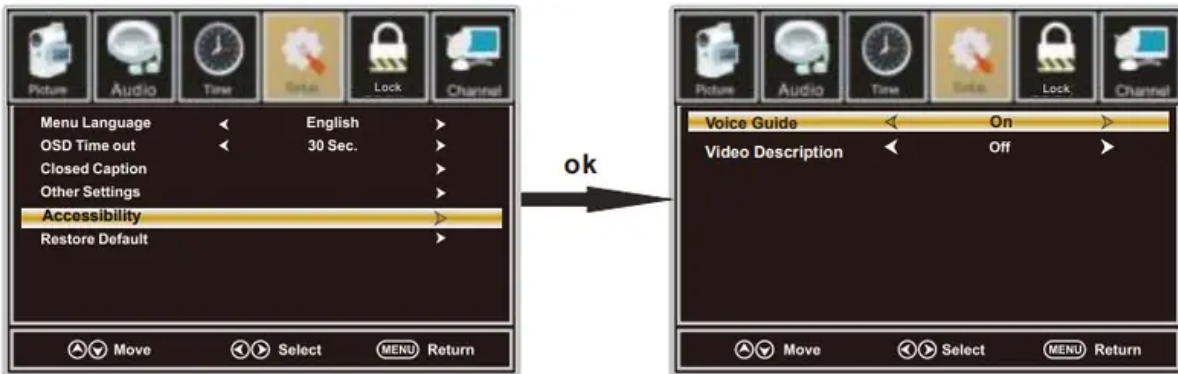

Restore Default

Press **▼/▲** button to select Restore Default. then press **ok** button to select No or Yes.
Change power on options or reset TV to factory default. (0000)

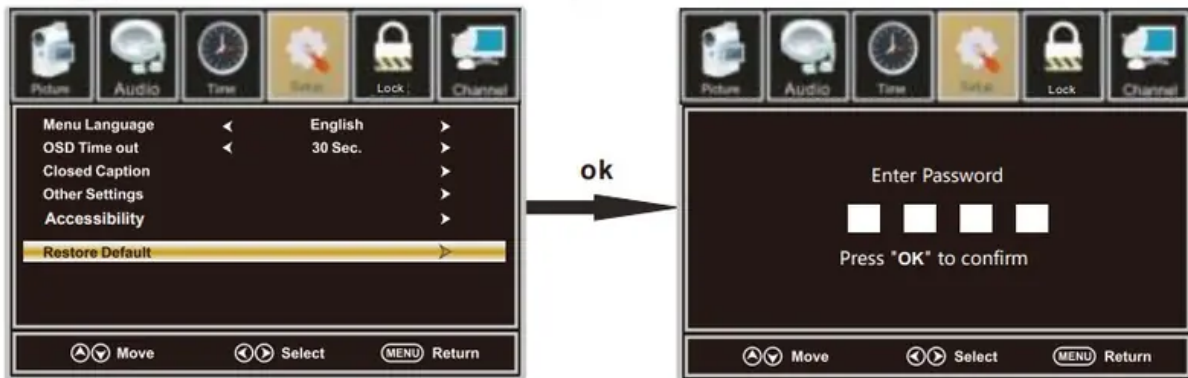

Lock menu

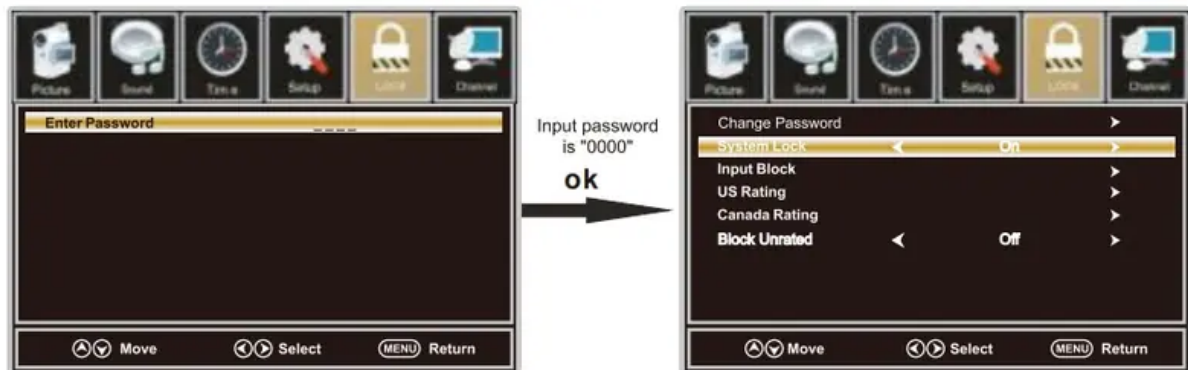

1. Press button to select Lock in the main menu.
2. Press **▼/▲** button to select the option that you want to adjust in the Lock menu.
3. Press button **◀/▶** to desired level.
4. When you have changed the settings. ou can exit from the menu by pressing MENU.
Input password to enter. efault password is "0000".

Change Password

Press **▼/▲** & button to select Change Password. then press **OK** button to adjust the value. a sub menu will appear as below. If the password is changed. all of the passwords in the menu will be changed at the same time.

Note: If you forget your password. you can use “8899” to enter any menu locked.



System Lock

Press **▼/▲** button to select System Lock. then press **◀/▶** button to set On or Off
Only available when “System Lock” is “On”.



Input Block

Press **▼/▲** button to select Input Block. then press **◀/▶** button to enter.

Press **◀/▶** button to select Unblock or Block the input sources.



US Rating

Press **▼/▲** button to select US Rating. then press **◀/▶** button to enter. A sub menu will appear as below.

The TV rating composes of two aspects: age-based and content -based.

This system defines the rating control which comes from MPAA rules.



Canada Rating

Press **▼/▲** button to select Canada Rating. then press button **◀/▶** to select.



Canada English

Press **▼/▲** button to select Canada English. then press button **◀/▶** to set.

Available Canada English: Off. C. C8+.. PG. 14+. 8+.



Canada French

Press **▼/▲** button to select Canada French. then press **◀/▶** button to set.
Available Canada French: Off. G. 8ans+. 13ans+. 16ans+. 18ans+.

Channel Menu

Note: This menu is only shown when the input source is TV.



1. Press **◀/▶** button to select Channel in the main menu.
2. Press **▼/▲** button to select the option that you want to adjust in the Channel menu
3. Press **◀/▶** button to desired level.
4. When you have changed the settings. you can exit from the menu by pressing MENU.

Signal Type

Press **▼/▲** button to select Signal Type. then press **◀/▶** button to set. Available Signal Type: Air. Cable.

Auto Scan

Press **▼/▲** button to select Auto Scan. then press **ok** button to search channel.
A Channel Search Menu will appear as below.



Favorite

Press **▼/▲** button to select Favorite. then press ok button to scan the Favorite channel list.



Channel List

Press **▼/▲** button to select Channel List. then press **ok** button to scan the Channel List.



Show/Hide

Press **▼/▲** button to select Show. then press ok button to enter .
Show or hide the channels in your program list.

Channel Number

Press **▼/▲** button to select Channel Number. then press **◀/▶** button to adjust.

Channel Label

Press **▼/▲** button to select Channel Label. then press **ok** button to enter.
Create labels for channels. up to 7 characters.



Setup Menu

For VGA Mode:

1. Press button to select Setup in the main menu
2. Press button to select VGA Settings. then press ok button to enter.
A sub menu will appear as below.



H-Pos

Press button to select H-Pos. then press button to adjust.

V-Pos

Press button to select V-Pos. then press button to adjust.

Clock

Press ▼/▲ button to select Clock. then press ◀/▶ button to adjust.

Phase

Press ▼/▲ button to select Phase. then press ◀/▶ to adjust

Auto

Press ▼/▲ button to select Auto. then press **ok** button to enter.
Adjust to the PC signal timing automatically.

1. PICTURE menu and description are the same as that for TV mode.
2. Audio Language in AUDIO menu is invalid.
3. TIME menu and description are the same as that for TV mode.
4. Close Caption in SETUP menu is invalid.
5. US, Canada, RRT Setting and Reset RRT in LOCK menu is invalid
6. PC mode has no CHANNEL menu.

Note: The operation and description of the hot key are programmable on your remote control.

USB menu

Note: Before operating Media menu. Insert USB device. then press SOURCE button to set the Input Source to USB.

Press ▼/▲ button to select USB in the Source menu. then press OK button to enter.

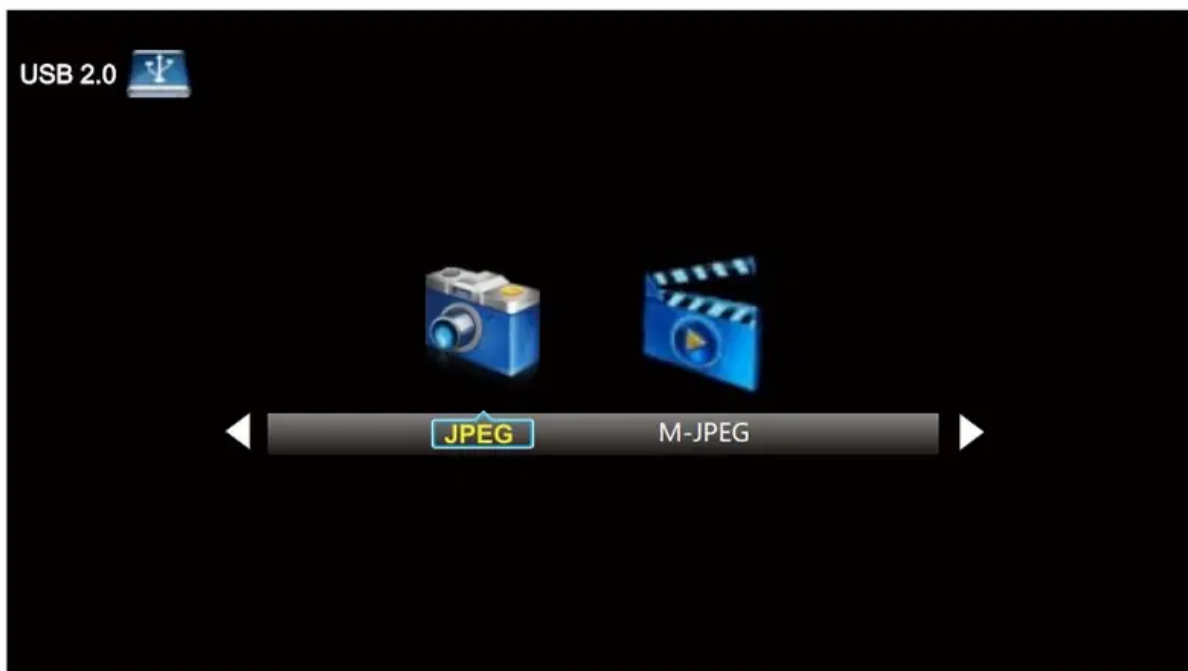



Press  button to select the option you want to adjust in the main Media menu. then press OK button to enter.the

Press  button to select JPEG in the main menu. hen press OK button to enter.

Press Exit button to return back to the previous menu.



Press  button to select drive disk you want to watch. then press OK button to enter.

Press  button to select Return option to go back to the previous menu.

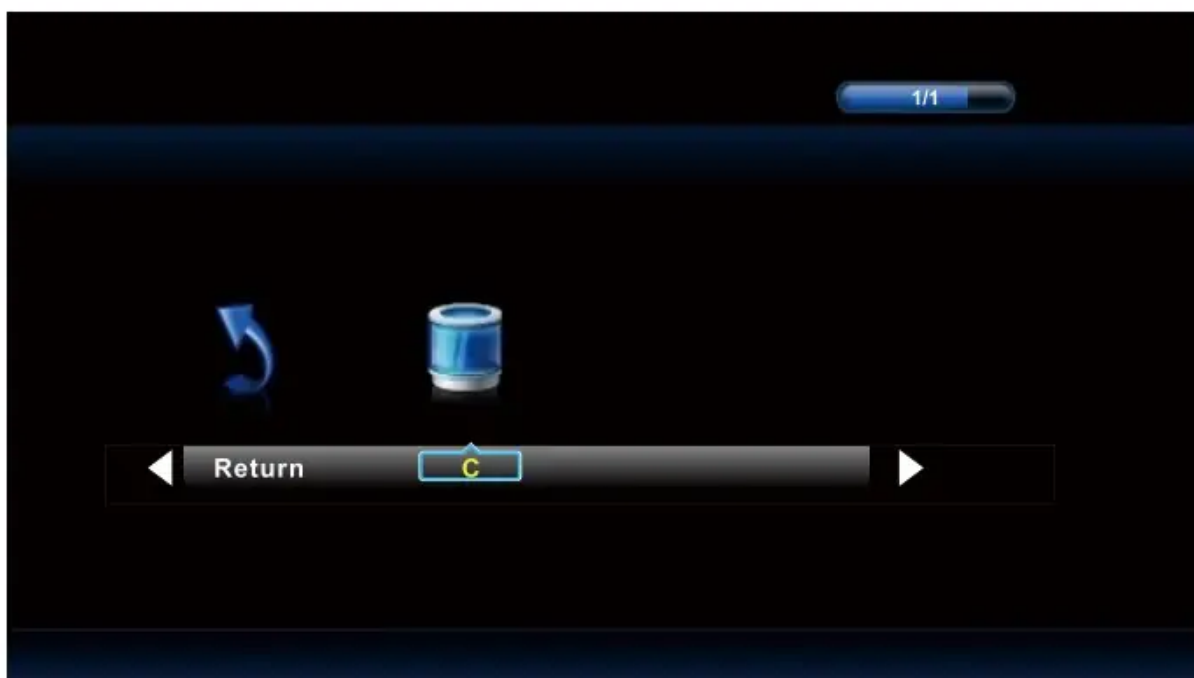

Press ◀/▶ button to select the file you want to watch in the file selecting menu. then press OK button to display picture.

When highlighting the option you select. the file information will appear on the right and picture will be previewed in the center.

Press ◀/▶ button to select M-JPEG in the main menu. then press OK button to enter. Press Exit button to return back to the previous menu.



Press ◀/▶ button to select drive disk you want to watch. then press OK button to enter.

Press ◀/▶ button to select Return option to go back to the previous menu.

When highlighting the option you select. the file information will appear on the right and Movie will be previewed in the center.

Press OK button to play the selected movie.

Press display button to show select menu in the bottom.

Press ◀/▶ button to select menu in the bottom you want to run. then press OK button to operate.

DVD OPERATION

Preparation before playing disc

- The display language is set to English. Please refer to setup operation
- Most functions are operated by the remote control or use the buttons on the front panel.

Preparatio

- Turn the TV on and select DVD as the TV input.
- Turn on any related system power if the player has been connected to amplifier equipment. etc.

PLAY

1. Turn on the power. the display shows "LOADING". (Note: the disc information appears after several seconds if a disc has been inserted. Otherwise NO DISC appears.)
2. To insert a disc. place the disc with the printed label side facing the back. into the DVD slot. The disc will automatically be loaded into the player.
3. To remove the disc. press the OPEN/CLOSE button and the disc will eject.
4. Press PLAY on playback disc. You may also start playback according to the MENU screen once the MENU displays. Press ENTER button to start playback. Some discs may play automatically once loaded.

Disc Type	Disc Size (Diameter)	Recorded Time	Recorded Content	Remarks
DVD	12 cm	Single side: 120 mins. Approx Double side: 240 mins. Approx	DVD format: Compressed digital audio and video	
Super VCD	12 cm	45 mins. Approx	MPEG2 Compressed digital audio and video	Includes SVCD
VCD	12 cm	74 mins. Approx	MPEG1 Compressed digital audio and video	Includes: VCD2.0/VCD1.1 VCD1.0/DVCD
CD	12 cm	74 mins. Approx	CD-DA: Digital audio	
HD-CD	12 cm	75 mins. Approx	HD-DA: Digital audio	
MP3/JPEG	12 cm	600 mins. Approx	Digital audio	

• STOP

Press STOP button to stop playing. When playback is stopped the unit keeps in memory the point where STOP was pressed (resume function). Press PLAY again. and play will resume again at this point. Press the STOP button twice. the resume function will be cancelled. The resume function is suitable for discs showing playing time during playback.

• PRESS

Press PREV button or NEXT button on the remote control when playing a disc. a chapter (DVD) or a track (CD) to skip backward or forward correspondingly each time the button is pressed.

Note: When skipping backward. playback starts at the beginning of the previous track. NOT the beginning of the current track.

•

Press the FB/FF button on the remote control during playback. the disc will be played forward or backward correspondingly. The forward or reverse speed is relatively slow at first. When pressed again. the speed becomes faster. The more times the buttons are pressed. the faster the Fast Forward or Reverse speed will be. There are five levels of speed: X2. X4. X8. X16 and X32. To return to normal play. press the PLAY button on the player or the remote control.

- **SETUP**

Press the SETUP button during play. the player will enter into still picture mode. If the button is pressed again the disc is advanced by one frame (step). When the button is continually pressed. there will be consecutive frame advance. To return to normal play. press the PLAY button on the player or the remote control.

- **PAUSE**

Press the pause button to stop playing. Restore play by pressing the PLAY button again.

- **NUMBER (0-9. 10+) Buttons**

Press the number (0-9) buttons. to go directly to the desired track or chapters while a disc is being played. For a track or chapter over 10. press 10+ first and then the 0-9 button.

- **MUTE**

Press the MUTE button during play. the player shows mute and there is no audio output (silence).

Press again to cancel MUTE.

- **VOL+/VOL-Press**

the VOL+/VOL- button to change the volume for audio output.

- **A-B**

Press the A-B button during playback at the point where repeat play is to commence (A). then press again at the point where repeat play is to be concluded (B). Repeat playback between point (A) and point (B) starts. Press A-B button once more where TV screen appears REP OFF to return to normal play.

- **REPEAT**

Press the repeat button to choose to repeat play chapter or title (DVD) and play single audio or full disc (VCD. CD. MP3). Note: Some VCDs do not have repeat function with PBC ON state.

- **SLOW**

When playing SVCD. VCD. DVD discs. press SLOW to select slow speed playing. Press PLAY/PAUSE to resume to normal play.

- **GO TO**

During play, press the GO TO button on the remote control. You can search the disc based on its title/ chapter/track. Press the GO TO button and a search menu will be displayed. Use the < or > button to select the search item/time/title/chapter. The selection will be shown as highlighted. Use the number button to select the search item time/title/chapter. and press the ENTER button to play.

For example:

- Time search (press “GO TO” button twice while playing a DVD): To search 16 min 50 seconds. input 1. 6. 5 and 0. To search 1 hour 14 minutes: input 1. 1. 4. 0. 0. Title/ chapter search: To search title 1. chapter 2. input 1 in the highlight title column. move the cursor right to the highlighted area and input 2.

Notes

- For some DVD discs which cannot be searched. “invalid” will appear on the TV screen.
- Input the time. title and chapter of the disc to be searched.
- For VCDs with the PBC mode ON. it can only search for a time.

- **AUDIO**

Press AUDIO button to switch the audio output among L/L. R/R and L/R.

- **MENU**

Press MENU button to show the setup information of DVD disc source.



Press OPEN/CLOSE when power is on and insert disc with label towards the back.
Press OPEN/CLOSE to close.

- **TITLE**

When playing the DVD. press TITLE to return to the main title page.

- **SUBTITLE (FOR DVD AND SUPER VCD DISCS)**

To change the subtitle language. refer to Language Setup (page 28).

Supporting DVD Format

For DVD discs with 5 pages, press INFO button :

Once	Twice	Three times	Four times
Title Elapsed TT: 01/08 CH:01/01 0:00:47	Title Remain TT: 01/08 CH:01/01 0:04:47	Chapter Elapsed TT: 01/08 CH:01/01 0:00:16	Chapter Remain TT: 01/08 CH:01/01 0:04:41
Five times			
Display off			

MP3 / JPEG Playback

After loading the MP3/JPEG disc, it will start to scan for the stored MP3/JPEG folders. The folder will display the MP3 contents automatically and start to play the (highlighted Screen will show as below:

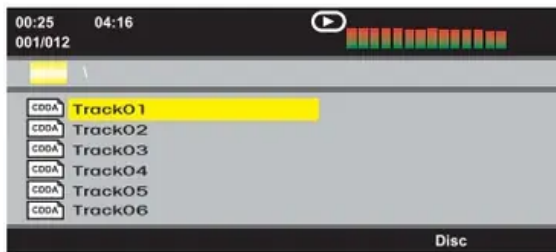

MP3 File



JPEG File

Use the navigation buttons to check for your favourite folder and playback the or move to your favourite NOTE: Press the ◀/▶ buttons to move the highlight to folders, documents or mode selection. Press the numeric buttons to select the contents directly. For numbers over 10, press the - button (eg. for number 15, press - and 5). When playing MP3 there is no picture display, only audio output.

DVD Function General Set Up

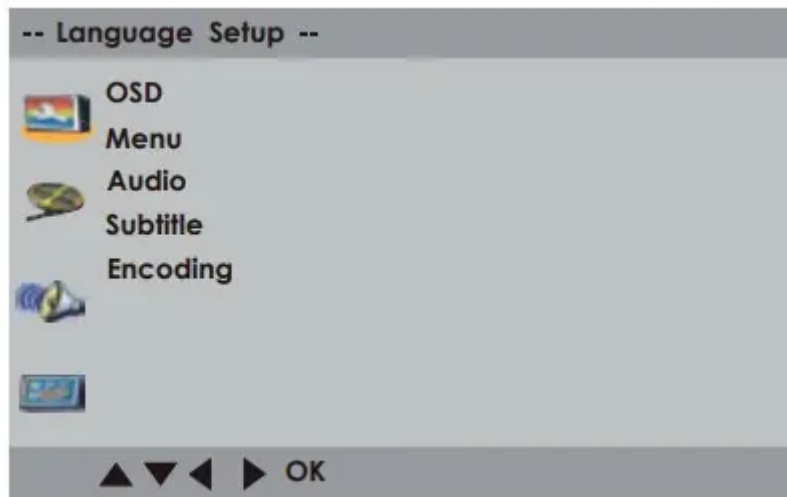

Press DVD setup button to activate the DVD player's OSD menu. Press the ◀/▶ buttons to move and highlight between different submenus. Press the OK button to enter the highlighted sub-menu. Press DVD SETUP button to exit the OSD menu. Note: In Setup mode, the disc playback functions will be cancelled or paused.

Language Set Up

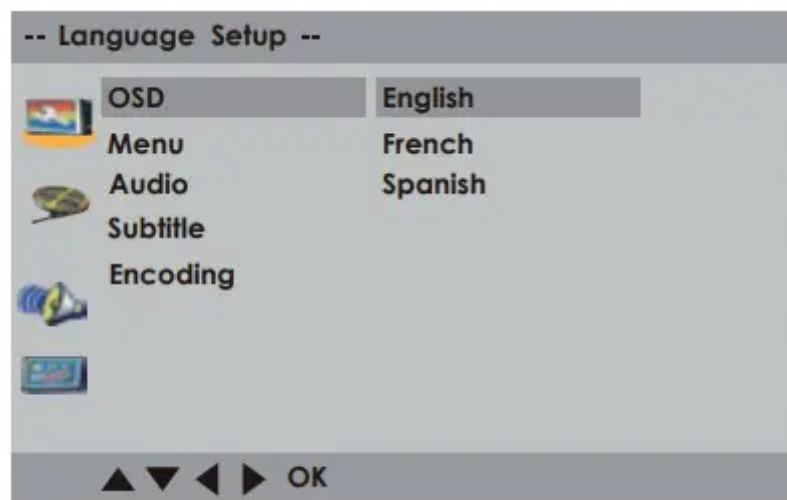

OSD

Menu Audio Press DVD setup button to activate the DVD player's OSD menu. Press the ▶/▲/▼ buttons to move and highlight between different submenus. Press the OK button to enter the highlighted sub-menu. Press DVD SETUP button to exit the OSD menu. Note: In Setup mode, the disc playback functions will be cancelled. Use the navigation buttons to select the OSD setup, there are six languages for your selection. Press the // buttons to toggle between the different languages: English, French, Spanish and Press the OK button to confirm.

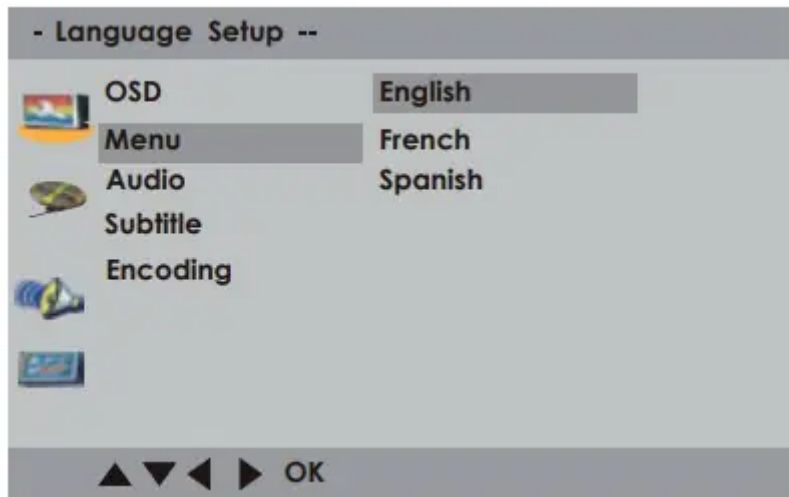

Menu

Use the navigation buttons to select the Menu setup, there are seven languages for your selection. Press the ► / ▲ / ▼ buttons to toggle between the different languages: English, French, Spanish, Portuguese, German, Italian, Dutch, and Polish. Press the OK button to confirm.



Audio

Use the navigation buttons to select the Audio setup, there are seven languages for your selection. Press the ► / ▲ / ▼ buttons to toggle between the different languages: English, French, Spanish, Portuguese, German, Italian, Dutch, and Polish. Press the OK button to confirm.

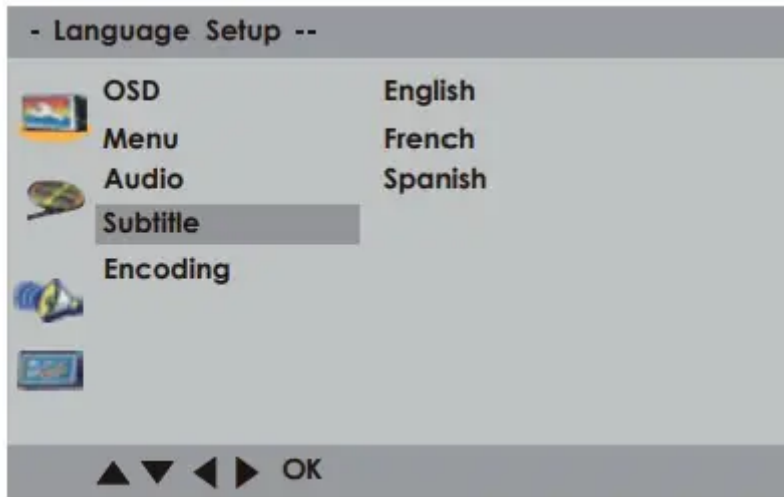

Subtitle

Use the navigation buttons to select the Subtitle setup, there are seven languages for your selection. Press the ► / ▲ / ▼ buttons to toggle between the different languages: English, French, Spanish, Portuguese, German, Italian, Dutch , Polish, and Off. Press the OK button to confirm.

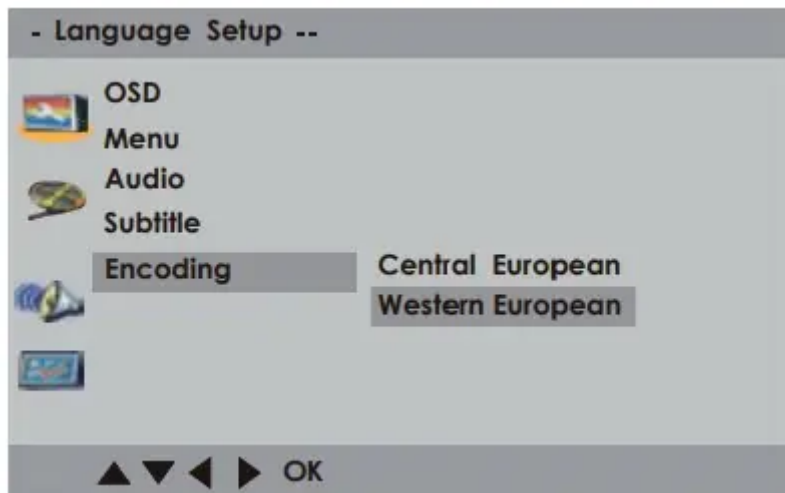

Encoding

Use the navigation buttons to select the Encoding setup. Press the ► / ▲ / ▼ buttons to select Central European or Western European. Press the OK button to confirm. Note: This function only applies to discs with subtitles using Western or Central European character sets.

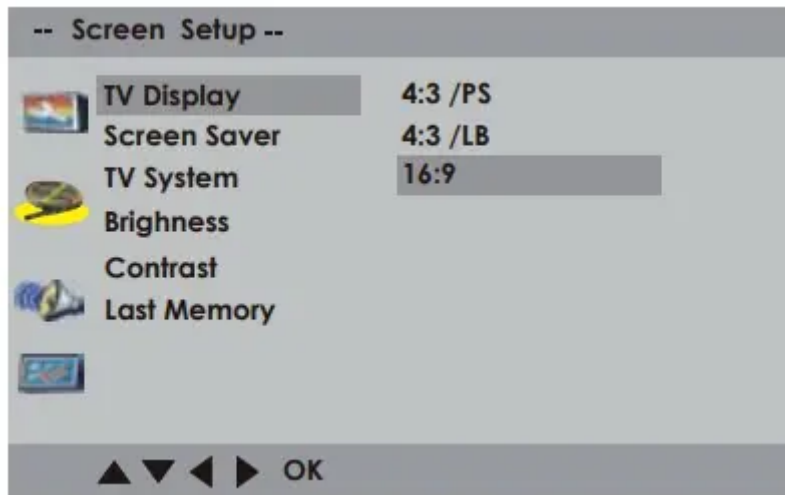

TV Display

Use the navigation buttons to select the TV Type setup. Press the **▶ / ▲ / ▼** buttons to select 4:3 PS, 4:3 LB or 16:9. Press the OK button to confirm. Select the most appropriate aspect ratio for the DVD being viewed.



4:3 PS (Normal)

Normal Pan and Scan is used for most normal television broadcasts and it is the default setting. It has an aspect ratio of 4:3. If you select this setting when viewing a DVD, the picture will fill the screen, but you will not see the left and right edges of the picture.

4:3 LB (Normal)

Normal Letter Box will show the DVD in its original aspect ratio, so depending on the size of your television screen, you may see black borders above and below the picture.

16:9 (Wide)

Choose this setting if you have a widescreen television.

NOTE: Playback screen size may vary according to the disc's contents. For discs with 4:3 contents, using any mode would display a 4:3 screen. Screen ratio selection should be chosen according to the connected TV/Display aspect ratio.

Screen Saver

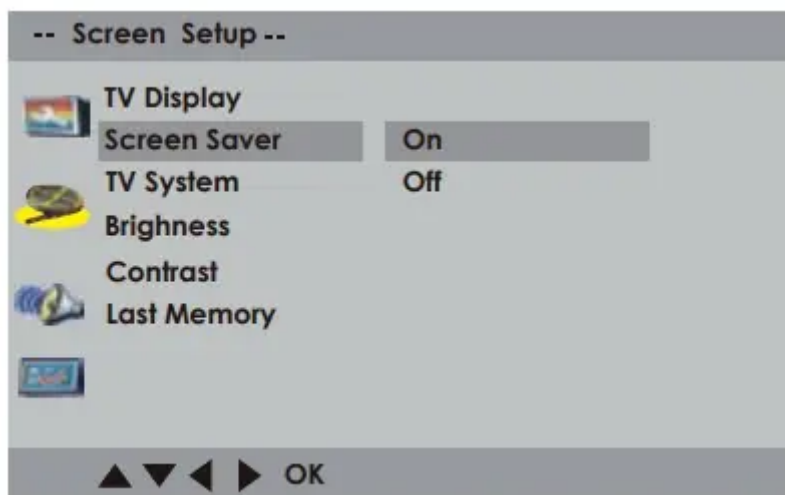

Use the navigation buttons to select the Screen Saver setup. Press the **▶ / ▲ / ▼** buttons to select On or Off. Press the OK button to confirm.

TV System



Use the navigation buttons to select the TV System setup. Press the **▶ / ▲ / ▼** buttons to select NTSC, PAL or Auto. Press the OK button to confirm. Note: NTSC format is generally used for TVs in Canada. Check your TV user guide for supported formats. If PAL is selected with a noncompatible television, you may experience interference or picture scrolling.

Brightness

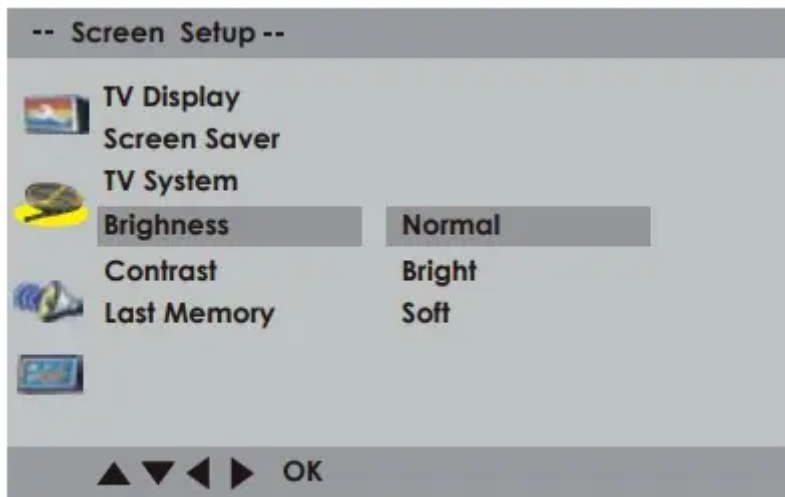

Use the navigation buttons to select the Brighness setup. Press the **▶ / ▲ / ▼** buttons to select Normal, Bright or Soft. Press the OK button to con rm.

Contrast

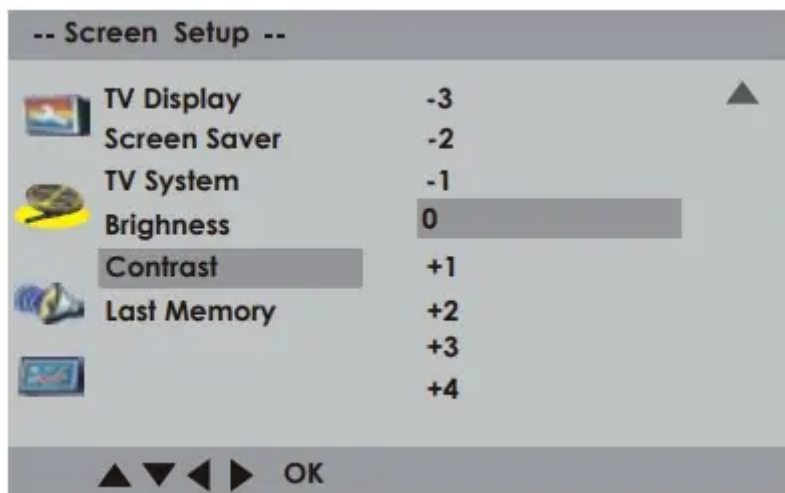

Use the navigation buttons to select the Contrast setup. Press the **▶ / ▲ / ▼** buttons to select 0 to +/-4. Press the OK button to con rm.

Last Memory

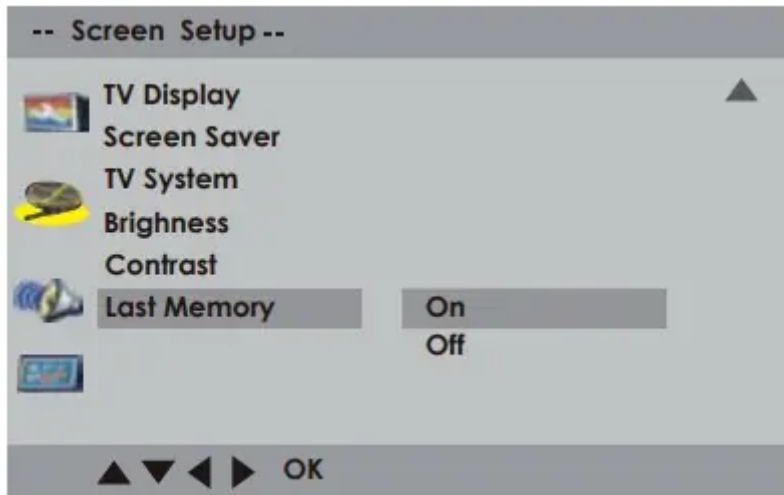

Use the navigation buttons to select the Last Memory setup. Press the **▶ / ▲ / ▼** buttons to select On or Off . Press the OK button to con rm.

Audio Set Up

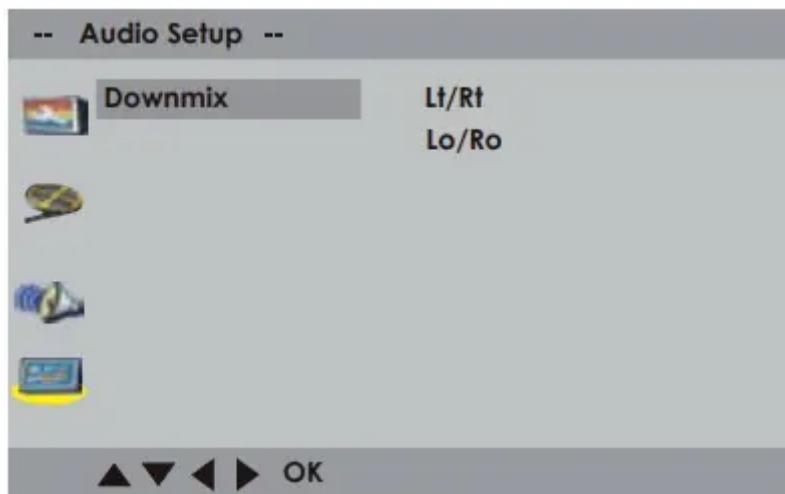

Downmix

Use the navigation buttons to select the Downmix setup. Press the **▶ / ▲ / ▼** buttons to select Lt/Rt or Lo/Ro . Press the OK button to con rm.

Custom Set Up

Parental Control



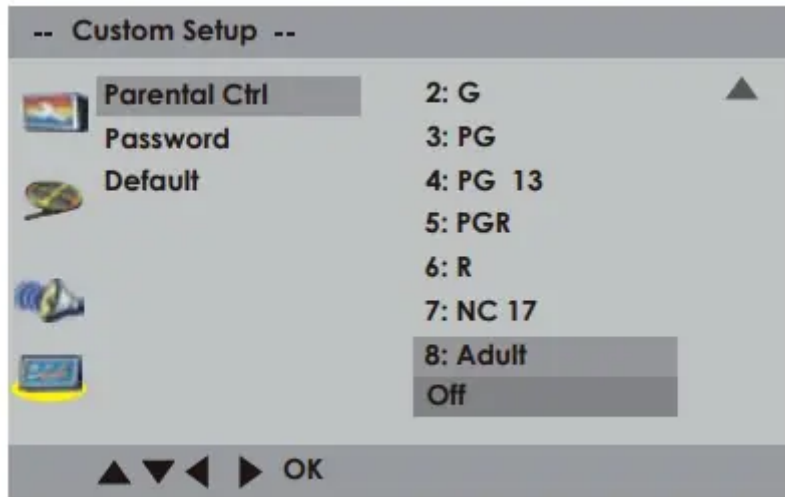

Use the navigation buttons to select the Parental Control setup. Press the ► button or OK to enter password, then select the V-chip grade or Off.

Password

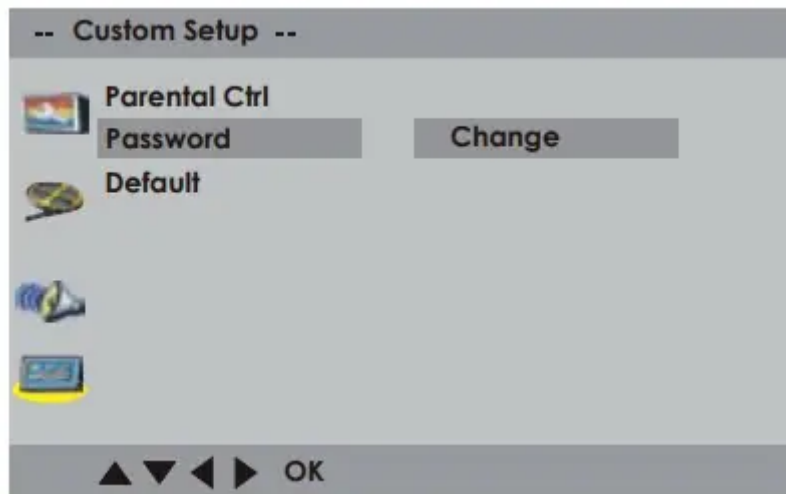

Use the navigation buttons to select the Password setup. Press the ► or OK button to change the password, then select the V-chip grade or Off.

The default setting is 8899.

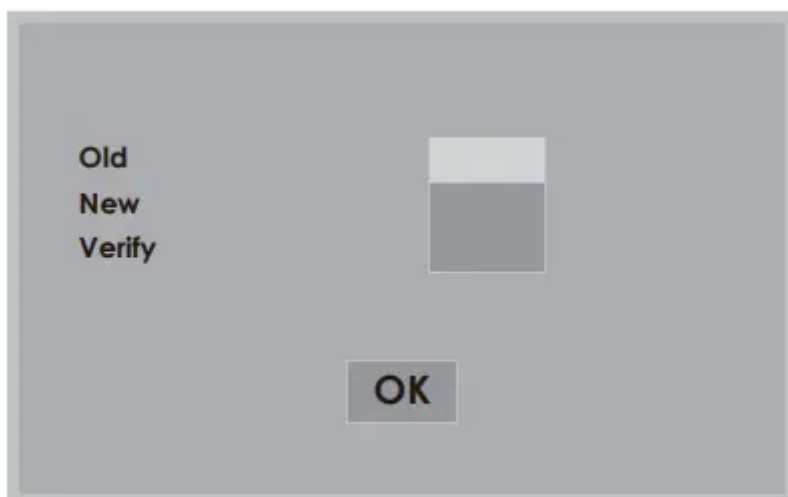

Default

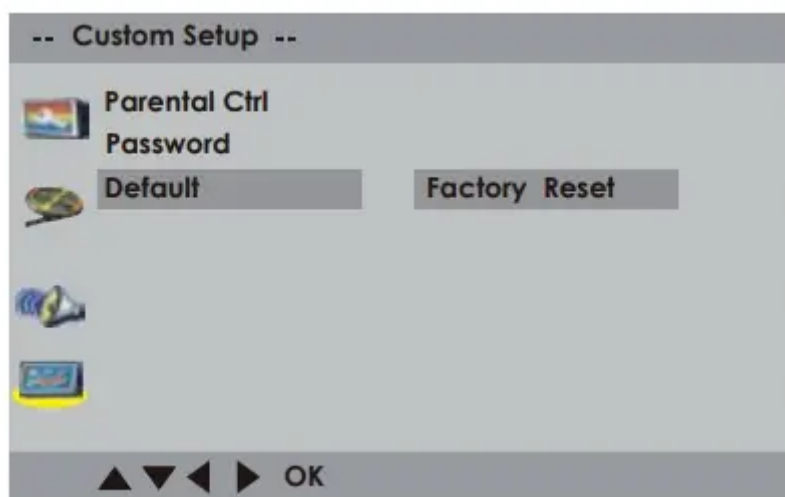

Use the navigation buttons to select the Default setup. Press the ► button to select Reset. Press the OK button to return to the factory setup.

Troubleshooting

Please check if you can solve problems by troubleshooting yourself.

- No signal
 - Please check that all cables are correctly plugged in.
- No color shades
 - Adjust the contrast, the color and the brightness.
- Stain on the screen
 - May be the result from a lighting signal from car, motor, neon light and other electrical devices or appliances.

- Double or multiple display image
 - May be the result of an electrical wave disturb from other TV. Computer and Game machine or Radio
- Snow on the screen
 - The cables of the antenna are not correctly plugged in.
- The remote control does not work
 - Please check the batteries order and alignment. Check that the IR of the remote control is not hidden by something.
- "Zip" made noise on TV cover
 - Even if the display image is correct. the noise may come from an unsteady fixation of the panel.
- No sound
 - Make sure that you have not press the MUTE button of the remote control.

Warning

This content is compiled from multiple sources and is provided for reference purposes only. It may not be complete or fully applicable to all situations. If you are unable to resolve your issue, please contact the product manufacturer or an authorized service provider for official support.