

## **Important**

Read this user manual carefully before you use the appliance and save it for future reference.

### **Danger**

- Never immerse the appliance in water.
- To prevent a short circuit or an electric shock, do not use water to rinse the outside of the pot unit or top unit (including handgrip, control panel, motor unit connector, jug connector, and main cord socket) and keep them away from drip or splash.
- Make sure the surface of both motor unit connector and jug connector is free from liquid or any conductive medium before putting the motor unit onto the jug.

### **Warning**

- Keep the appliance and its mains cord out of reach of children when the appliance is switched on or cooling down.
- Keep the appliance and the mains cord away from hot surfaces.
- The temperature of accessible surfaces is high when the appliance is operating. Do not touch the surface of the jug or other parts that are hot after use (Fig. 2).
- Check if the voltage indicated on the appliance corresponds to the local mains voltage before you connect the appliance.
- Do not use the appliance if the plugs, the mains cord or the appliance itself are damaged.
- Only the cord set provided by Philips can be used.
- Make sure that your hands are dry when you insert the mains cord into the appliance and in the wall socket.
- This appliance shall not be used by children.
- Keep the appliance and its cord out of reach of children.
- This appliance can be used by persons with reduced physical, sensory or mental capabilities or lack of experience and knowledge if they have been given supervision or instruction concerning use of the appliance in a safe way and if they understand the hazards involved.
- Children should be supervised to ensure that they do not play with the appliance.
- Do not use abrasive clean agents to clean the surfaces in contact with food.

## Caution

- This appliance is intended for household use only. If the appliance is used improperly or for professional or semi-professional purposes or if it is not used according to the instructions in the user manual, it may cause potential injury, and the guarantee becomes invalid and Philips refuses any liability for damage caused.
- Always place the appliance on a dry, flat and stable surface.
- Only connect the appliance to an earthed wall socket.
- Never use any accessories or parts from other manufacturers or that Philips does not specifically recommend. If you use such accessories or parts, your guarantee becomes invalid.
- This appliance is not intended to be operated by means of an external timer or a separate remote-control system.
- Always disconnect the appliance from the supply if it is left unattended and before assembling, disassembling or cleaning.
- Do not let the appliance run unattended.
- Do not operate the appliance continuously.
- Do not let the appliance operate when it is empty.
- Never add contents (including liquid) above the MAX or below the MIN indication.
- Beware of hot steam coming out of the edge of the lid during processing, or hot steam coming out of the appliance when you remove the motor unit after preparing hot soup.
- Do not touch the blades. The blades are very sharp.
- Do not lift the motor unit and move the appliance when it is operating.
- This appliance is not suitable for frozen ingredients.
- Always defrost the ingredients before putting into the jug.
- Always hold the appliance by the handle on the jug. Do not hold the appliance by the handgrip on the motor unit, as it may tip over. (Fig. 3)

## Electromagnetic fields (EMF)

This Philips appliance complies with all applicable standards and regulations regarding exposure to electromagnetic fields.

## General description

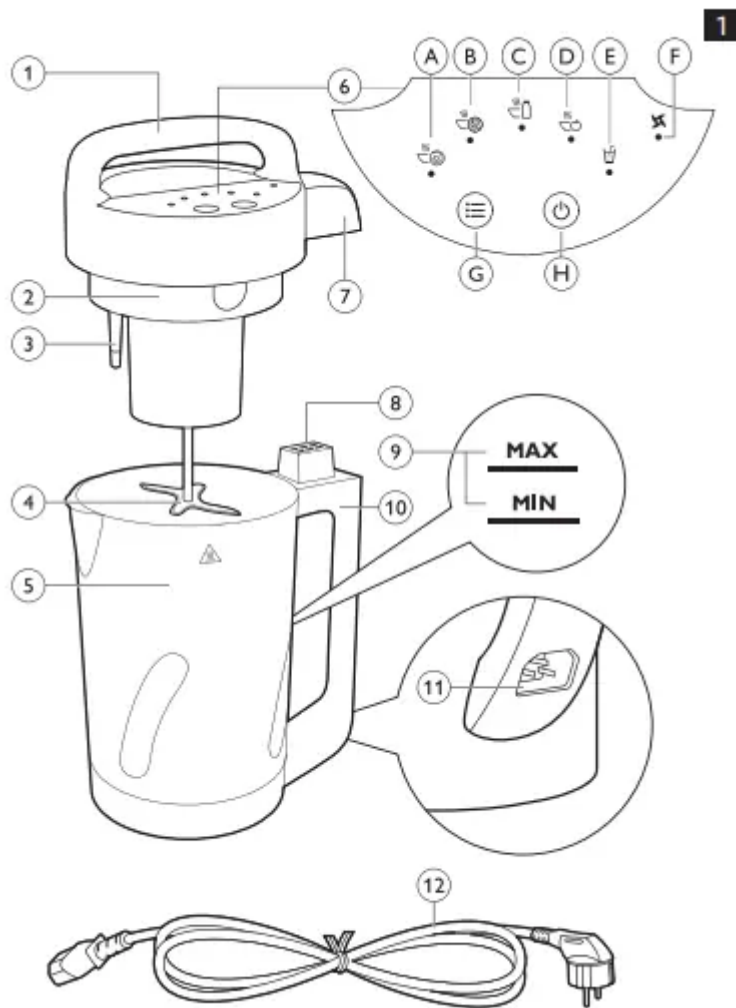

1 Handgrip

2 Motor unit

3 Overflow sensor

4 Blade unit

5 Jug

6 Control panel

A. Pureed soup program with light - 18 minutes

B. Chunky soup program with light - 18 minutes

C. Milk-based soup program with light - 35 minutes

D. Compote program (heating only) with light - 12 minutes

E. Smoothie program (blending only) with light - 3 minutes

F. Manual blending program with indicator light

G. Program selection button

H. Start/stop button

- 7 Motor unit connector
- 8 Jug connector
- 9 Level indications (The MAX and MIN indications are on the inside of the jug.)
- 10 Handle
- 11 Power cord socket
- 12 Power cord

## Preparing for use

Clean the appliance before you use it for the first time.

1. Hold the handle of the jug with one hand and with the other hand lift the motor unit off the jug by its handgrip (Fig. 4).
2. Fill the jug with water up to the MAX indication (Fig. 5).
3. Hold the motor unit above the jug with both connectors aligned and then lower the motor unit into the jug (Fig. 6).
4. Put the small plug in the socket of the jug (1) and put the mains plug in the wall socket (2) (Fig. 7).
5. Press the program selection button repeatedly to select the compote program (Fig. 8) and then press the start/stop button (Fig. 9).
  - The compote light goes on (Fig. 10).
  - When the program has finished, the appliance beeps and the compote light blinks.
6. Hold the handle of the jug with one hand and with the other hand lift the motor unit off the jug by its handgrip (Fig. 4).
7. Pour the water out of the soup jug and rinse the inside of the jug under the tap (Fig. 11).

**Note** Never immerse the appliance in water.

## Using the appliance

The SoupMaker has a blade unit for blending ingredients and a heating element to heat the ingredients to cook soup. You can also use the appliance to make compotes or smoothie. It has five preset modes and a manual program button. Various recipes and tips are available in the separate recipe booklet.

The general steps below apply to all six programs.

1. Prepare the ingredients.

**Tip:**

- For best taste, use fresh seasonal ingredients.

- Cut the ingredients in cubes of 2cm to get perfect results.
  - Defrost ingredients before putting them in the jug.
  - This appliance is not suitable for making pastry such as making batter, or baking.
2. Hold the handle of the jug with one hand and with the other hand lift the motor unit off the jug by its handgrip (Fig. 4).
  3. Put the ingredients in the jug (Fig. 12).

**Note:**

- If you are cooking meat and vegetables, make sure you put the vegetables in the jug first.
  - Make sure the ingredients are spread evenly over the bottom of the jug.
4. Add water or another liquid to the ingredients in the jug (Fig. 12).

**Caution:** Make sure the content (including liquid) is somewhere between the MIN and MAX indication.

5. Stir the liquid and ingredients (Fig. 13).
6. Hold the motor unit above the jug with both connectors aligned and then lower the motor unit into the jug (Fig. 6).
7. Put the small plug in the socket of the jug (1) and put the mains plug in the wall socket (2) (Fig. 7).
8. Press the program selection button to select the desired program (Fig. 8).
9. Press the start/stop button to start the cooking process (Fig. 9).
  - The corresponding light goes on and the SoupMaker starts the cooking and/or blending process (Fig. 10).
  - When the program has finished, the appliance beeps, and the indicator light blinks (Fig. 14).

**Tip:**

- If you prefer your soup even finer, or would like to do some blending in your chunky soup or compote, select the manual blending program. Press and hold the start button to start blending. To stop blending, simply release the start button.

**Note:**

- To stop the ongoing cooking process, press and hold the start/stop button for 2 seconds.
- The maximum operating time for one manual blending cycle is 30 seconds.
- To keep the appliance more durable, wait at least 30 minutes until the appliance cools down before next use.

10. Remove the power plug from the wall socket and from the appliance (Fig. 15).
11. Hold the handle of the jug with one hand and with the other hand lift the motor unit off the jug by its handgrip (Fig. 4).
12. You can now pour the soup, smoothie or compote into a bowl (Fig. 16).

**Note** Clean the appliance after every use. Refer to the chapter 'Cleaning'

## Cleaning

### Caution

- Never immerse the appliance in water. Do not clean the appliance in the dishwasher.
- Keep both the motor unit connector and jug connector clean and dry.

### Note

- Always unplug the appliance and wait until it cools down before you clean it.
  - Never use scouring pads, abrasive cleaning agents or aggressive liquids such as petrol or acetone to clean the appliance.
1. Remove the mains plug from the wall socket and from the appliance (Fig. 15).
  2. Hold the handle of the jug with one hand and with the other hand lift the motor unit off the jug by its handgrip (Fig. 4).
  3. Clean the blade unit and overflow sensor by rinsing them under the tap (Fig. 17).
- Note:** Do not touch the blades. The blades are very sharp.
- Tip:** If necessary, clean the blade unit and overflow sensor with a soft brush.
4. Clean the inside of the jug under the tap. If necessary use a soft brush (Fig. 18).
  5. Clean the top part of the motor unit and the outside of the jug with a moist cloth (Fig. 19).
- Tip:** If the appliance and the blade unit are very dirty, pour boiling hot water into the jug and place the motor unit on the jug. Let the jug and the motor unit soak for 10 minutes.

## Storage

1. Dry the jug and motor unit before storage.
2. Store the appliance in a cool, dry place away from direct sunlight or other heat source.

## Technical specifications

**Note:** The product information below is subject to change without prior notice.

Rated voltage: 230V

Rated frequency: 50Hz

Motor power: 120W

Heating power: 1000W

Dimensions:

- SoupMaker: 205x153x310mm
- Packaging: 220x220x340mm

Weight:

- Net weight: 2.1kg
- Gross weight: 3.0kg

Capacity: 1200ml (for 2-4 persons)

## Recycling

- This symbol means that this product shall not be disposed of with normal household waste (2012/19/EU). (Fig. 20).
- Follow your country's rules for the separate collection of electrical and electronic products. Correct disposal helps prevent negative consequences for the environment and human health.

# Troubleshooting



<b>Problem</b>	<b>Cause</b>	<b>Solution</b>
The light of the selected mode does not go on.	There is a connection problem.	Make sure the small plug is inserted in the appliance properly, the mains plug is inserted in the wall socket properly and the motor unit fits onto the jug properly.
The light of the selected program is on, but the appliance does not work.	You have not pressed the start button.	Press the start/stop button.
The appliance makes alarm sounds at the beginning.	The overflow sensor is dirty	Clean the overflow sensor.
	You have put ingredients over the MAX indication in the jug.	Remove some of the ingredients (Follow the user manual instruction or the recipe booklet).
The appliance stops working and makes alarm sounds during the cooking process.	The food is burnt on the bottom of the jug.	Remove the ingredients and clean the burnt area. Follow the recipe booklet to restart the program.
	You have started the program without adding ingredients and/ or liquid.	Add the ingredients and/ or liquid before starting the program (Follow the user manual instruction or the recipe booklet).
The appliance stops working during the cooking process.	The motor unit is detached from the jug during the cooking process, as too many ingredients are put in the jug or the ingredients are oversized.	Remove some of the ingredients and cut the ingredients into 2x2x2cm pieces (Follow the user manual instruction or the recipe booklet).
The appliance overflows.	You have put ingredients over the MAX indication.	Remove some of the ingredients (Follow the user manual instruction or the recipe booklet).
	You have selected the wrong program when preparing milk-based soup.	Select the milk-based soup program (Follow the user manual instruction or the recipe booklet).

	The ingredients used are not recommended.	Follow the user manual instruction or the recipe booklet.
The program has completed but the ingredients have not been blended well.	You have put liquid below the MIN indication in the jug.	Make sure the liquid level is between the MAX and MIN indication.
	You have put too many ingredients in the jug or used oversized ingredients.	Remove some of the ingredients and cut the ingredients into 2x2x2cm pieces (Follow the user manual instruction or the recipe booklet).
	You have used frozen ingredients.	This appliance is not suitable for frozen ingredients. Always defrost the ingredients before putting into the jug.
	You have been using the appliance continuously.	Leave the appliance to cool down for at least 30 minutes.
The motor does not work when using Smoothie or Manual blending program.	You have been using the appliance continuously	Leave the appliance to cool down for at least 30 minutes.

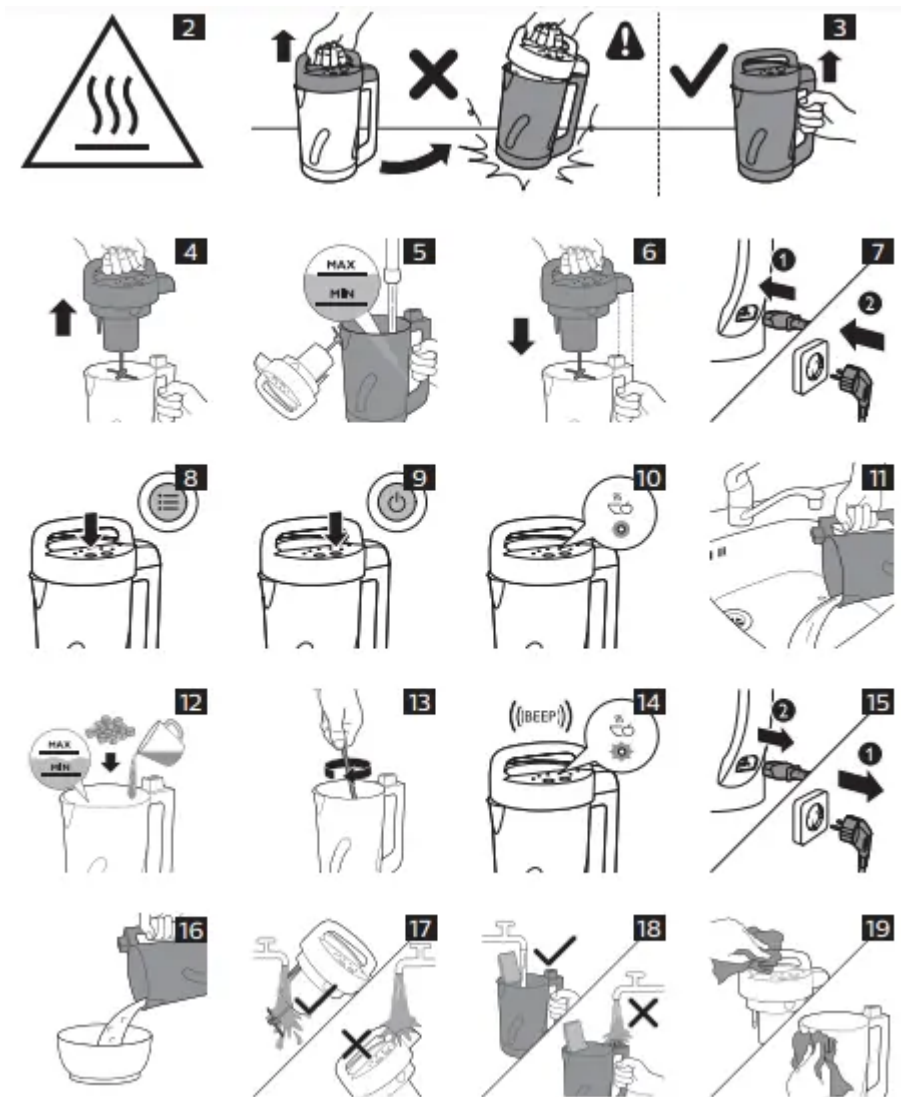

### Warning

This content is compiled from multiple sources and is provided for reference purposes only. It may not be complete or fully applicable to all situations. If you are unable to resolve your issue, please contact the product manufacturer or an authorized service provider for official support.