

Before using your machine for the first time

Transport protection

Remove any transport protection devices before installing the machine. See the "Transport protection" chapter.

Packing material

Please sort waste materials in accordance with local guidelines.

Washer door

- The machine cannot be started when the door is open.
- To open the washer door while a programme is running, see "Close the door and press the" Start button" in the "Washing" chapter.

Language selection

You will be prompted to select the display language when you have connected your machine and start it for the first time. Do as follows:

1. Turn the programme selector to choose from: US English, English, Svenska, Dansk, Norsk, Suomi, Français, Deutsch, Italiano, Español, Nederlands.
2. Press Start once to save the setting.

Checking water hardness

The quantity of detergent needed depends, amongst other things, on how hard the water is. See the detergent pack for details. Phone your local water company to check the water hardness in your area.

NOTE!:

Each machine is tested before leaving the factory. A small amount of water may remain in the drain pump, though this does not affect quality or damage the machine.



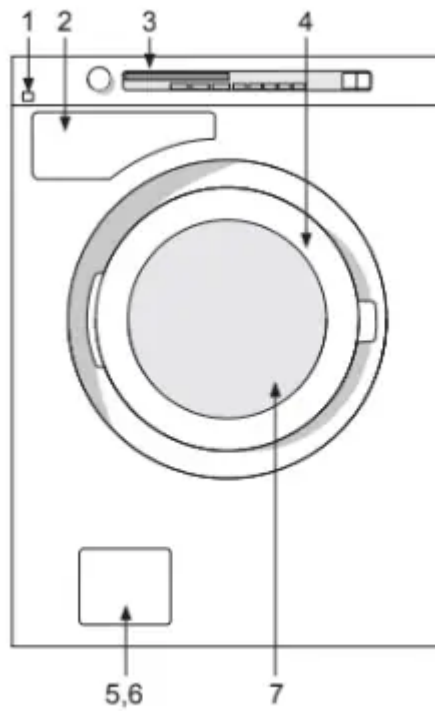

Description of the washing machine

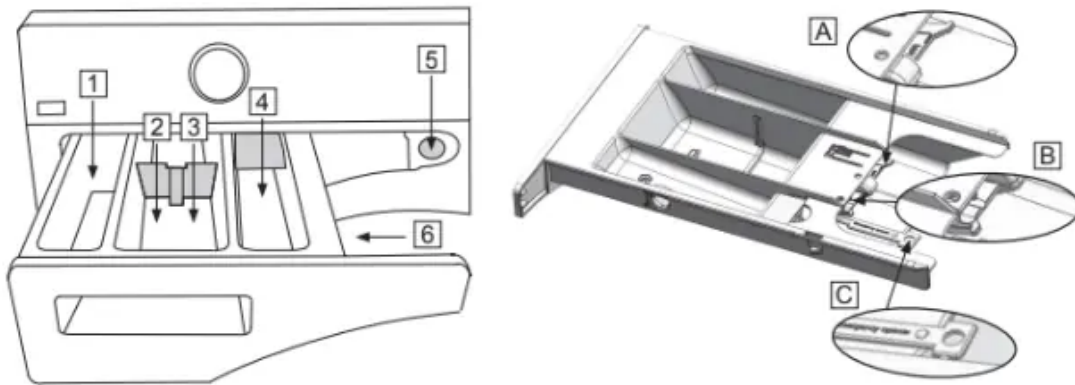

1. Main power switch
2. Dispenser
3. Programme panel
4. Serial number plate (on inside of washer door)
5. Drainage pump cover
6. Drainage pump (behind cover)
7. Washer door

Dispenser



1. Pre-wash 
2. Main wash with liquid detergent. Use the separator. (A) 
3. Main wash with powder detergent. Do not use the separator. 
4. Fabric softener 
5. Release button
6. Child safety catch

Advice and tips before washing

Here are some tips that may help you before washing.

Sorting your laundry

Sort items according to:

- how soiled they are
- colour
- material

Clothing

1. Do up zips and close Velcro straps so that they don't harm fabrics.
2. New coloured items may contain excess dye and should therefore be washed separately the first few times.
3. Turn delicate items inside out. This reduces the risk of burling and fading.
4. Empty pockets and wash them inside out if possible.

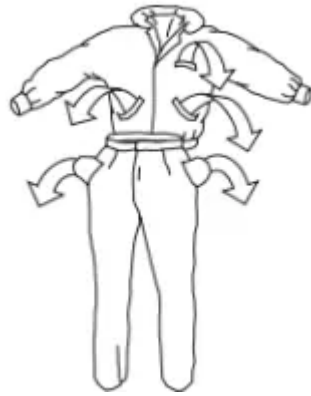

Laundry labels

Look at the item's laundry label. The table below shows suitable wash programmes for different materials and wash loads. Using modern washing machines and detergents, for example compact detergents, you can usually wash at lower temperatures. It is a good idea to use trial and error to find out what produces the best results.

Laundry label symbols

Examples of washing instructions and recommended programs. Always follow the washing instructions for each garment.

Laundry labels	Material	Program
	Cotton, linen, white and light-coloured items.	Everyday wash 60 °C to 95 °C
	Cotton, linen, cotton/polyester. Light and dark-coloured garments.	Quick 60 °C
	Acrylic, viscose, modal, acetate, polyester, polyamide and elastane. Light and dark-coloured garments.	Easy Care 40 °C
	Wool, silk and other very delicate garments	Wool/hand wash 30 °C to 40 °C

Coloured cotton

Coloured cotton items with the washing instruction 60 °C should be washed at 60 °C for the first time in order to remove any excess dye. If you do not do so, there is a risk that the colour will run. Use detergent without bleach in order to preserve the colour of the fabric.

Unbleached linen

Unbleached linen fabrics should be washed at 60°C, using detergent containing no bleach or optical whiteners. Heavily-soiled linen can occasionally be washed at higher temperatures, but not too often because the heat can destroy the linen's shine and strength.

Wool

These fabrics are labelled either machine wash or hand wash. The Wool/hand wash program is at least as gentle as washing by hand.

Wool is especially sensitive to processes such as washing.

If you do not wish to spin dry, you can squeeze out the water using terry towels. In this case select No spin.

To find out how to choose this setting, see the "Washing" chapter. However, most garments can withstand a short spin. Choose a short spin by selecting a spin speed of 800 rpm or less.

Rayon fibres and synthetic fibres

Materials made of rayon fibres, such as viscose, and some synthetic fibres are very delicate and require much space so as not to crease. Only half fill the drum when washing and choose a spin speed of 800 rpm or lower.

NOTE!: Viscose and acetates are fragile when wet.

Reducing allergic reactions

The washing machine has a Super Rinse option. Use this for people with sensitive skin, such as those with allergies and small children.

Save time and energy

Use the Everyday wash program to save time and energy. This program has a shorter main wash than Normal, but is often sufficient for lightly soiled washing.

High water level

If you want more water for the main wash and rinses, you can use the High water level option. This is automatically selected in the Wool/Hand program.

Economy and efficiency

You can save energy by not using higher temperature programs than necessary.

- Select Quick if you just need to freshen up shirts or exercise clothes, for example. This will save both water and energy.
- If you select a fast spin speed, this reduces energy consumption when drying in a tumble dryer or drying cabinet.
- Always wash with a full load when using the Heavy, Everyday wash and Normal programs.

- Avoid pre-washing. Modern machines and detergents clean effectively without pre-washing. Pre-washing is only necessary for heavily soiled washing.

Detergents

Eco-labelled detergents are less harmful to the environment. Detergent overdosing does not give better washing results; it merely causes a greater impact on the environment; can also hinder the wash performance. Try to use less detergent, and increase only if you are not satisfied with the results.

Dyeing fabrics

If you want to dye fabrics in the machine, select the Everyday wash program with the Super Rinse option. Select temperature according to the dye manufacturer's recommendations. Choose a low spin speed if the fabric to be dyed is a blended material such as polyester/cotton.

NOTE!: Add the dye directly to the washing drum – not to the detergent compartment. After dyeing, you should run the machine empty using the same program. Use the normal amount of detergent.

NOTE!: Due to environmental concerns, we discourage the use of strong chemicals. When using agents for bleaching or stain removal, there is a risk of rust (corrosion) and discolouration of the machine.

Washing

1. Sort your laundry.

See the "Advice and tips before washing" chapter.

Place underwired bras in a laundry net. Empty pockets. Coins, nails and the like can cause damage to the machine and fabrics. See the "Advice and Tips" section before washing.

2. Turn on the main power switch

3. Open the washer door and load the washing

Open the washing machine door. Load the washing. The wash program chart shows how much washing can be washed with each program.

4. Add detergent and fabric softener, as required

The detergent packaging will have recommendations for how much detergent you should use. The machine holds 7 kg of washing. If you only have a small amount of laundry in the machine, you can reduce the amount of detergent used.

Powder detergent

Pour the powder into the compartment for the main wash, and pre-wash as well if desired.

Liquid detergent

When using a liquid detergent, observe the detergent manufacturer's recommendations. We recommend using a laundry ball with thick detergents. In the main detergent compartment, use the section wall (A) – see figure in the section Dispenser. Add the detergent into the front compartment of the detergent dispenser.

Wash ball or net

If you use a wash ball or net, place it directly in the drum and select a program without pre-wash.

NOTE! Detergent overdosing does not give better washing results; it merely causes a greater impact on the environment; can also hinder the wash performance.

Try using less detergent, and increase only if you are not satisfied with the results.

Fabric softener

Pour the fabric softener into the compartment with the  symbol. Follow the recommendations on the fabric softener packaging.

NOTE! Do not fill above the compartment's maximum fill level. Otherwise fabric softener will run in too early, and will impair washing results.

5. Program selection

You select a programme by turning the programme selector. The selected programme is shown in the display. Now use the option buttons to select any options. See chapter Selecting Options.



1. Auto

This program automatically adjusts the length of the main wash and the number of rinses to the amount and type of laundry loaded in the machine.

2. Time program

This program adjusts itself to the specified time frame or finish time. When using this program, it is however important to select a temperature and time suited to how soiled the laundry is. The spin speed can be selected freely. Specify the desired program time by pressing or - on the Time button. The symbol for the program lights beside the selected time. You can choose a program time between 30 minutes and hours. If you choose a 30-minute program time the maximum wash temperature will be 30 °C

3. Heavy

Program for heavily soiled laundry, with dirt that needs to be fully dissolved before the main wash. A pre-wash is used to do this. The machine adapts the program time and water consumption to the load size.

4. Normal

Program for normal to heavily soiled laundry, whites and colours. You can select the temperature freely, so follow the washing instructions for each garment. 60 °C is a good Washing temperature for heavily soiled cotton garments, as well as for garments worn next to the skin. Select 40 °C if the laundry is less soiled. The spin speed can be selected freely. The machine adapts the program time and water consumption to the load size.

5. Everyday wash

A standard program for lightly to moderately soiled laundry. The temperature can be selected freely, so follow the washing instructions for each garment. Garments worn next to the skin ought to be washed at 60 °C. Very lightly soiled laundry often comes clean already at 40 °C. The spin speed can be selected freely.

6. Quick

Fast program for laundry that just needs freshening up. The program can be run at any temperature, so follow the washing instructions for each garment. The lower the selected temperature, the shorter the program time. Garments worn next to the skin ought to be washed at 60 °C. The spin speed can be selected freely.

7. Easy Care

Program for synthetic, mixed fibre and easy care cotton. The program has a high water level and as such is also suitable for cushions, quilted jackets and the like. Read the washing instructions carefully and remember, for example, that fabric softener must not be used with the membranes found in some outer garments. A washing temperature up to 60°C and a spin speed up to 1200 rpm can be selected.

8. Synthetics

Program for delicate garments made of synthetic fibre, mixed fibre, rayon and easy care cotton. The maximum temperature is 60 °C, but follow the washing instructions for each

garment. Many synthetics will come clean at 40 °C. Garments worn next to the skin ought to be washed at 60 °C. The maximum spin speed is 800 rpm.

9. Wool/hand wash

A gentle laundry program for wool, silk and garments that should be washed by hand. The highest temperature is 30 °C. This program has a short spin. The maximum spin speed is 800 rpm.

10. Rinse

This program performs one cold rinse cycle + spin. Suitable for laundry that just needs to be dampened and for cleaning cloths and mops.

11. Spin

Used to just spin the wash.

12. Drain

Used when you only want to drain the water from the machine.



6. Selecting options

You can select options to adjust the wash programme to suit your own specific requirements. The available options depend on the selected programme. If the option is available for the selected programme, the symbol lights up when you press the button.



The machine will remember the options you select for each programme (applies to Super rinse, High water level and Super wash). You can still change the selected options the next time you select the same programme.



Temperature

- Select the temperature by pressing the -/+ buttons until the desired temperature is displayed.
- You can select temperatures between cold (-) and 90 °C. By selecting cold, the wash temperature will be the same as the temperature of the water entering the machine. For Wool/hand wash it is not possible to select a temperature above 40 C, when selecting Time program, Synthetics and Easy Care the maximum temperature is 60°C

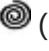
Spin

- Select the spin speed by pressing the +/- buttons until the desired spin speed is displayed.
- You can select speeds between 400 and rpm,  (no spin) or No D(no drain). The maximum spin speed varies according to the program selected. The speed is shown in the display.
-  means that the program does not include a spin cycle and ends by draining.
- No D, No drain means that the program does not include a spin cycle and ends with the water from the final rinse still in the machine. The washing will remain covered by the water from the final rinse, stopping it from getting creased. If you have selected “No drain”, once the program has ended you must select the Spin or Drain program to drain the water from the machine before you open the washer door.

Delayed start

When you select Delayed start the machine will start 1-24 hours after you press the Start button. This option cannot be used with Time program.

- Select Delayed start by pressing the + button under the time display. Delayed Start is shown for three seconds.
- By pressing the +/- buttons under the time display you can delay the start in whole hours up to a maximum of 24 hours. The symbol for Delayed start lights beside the number of hours.
- Press Start, and the machine counts down 1 hour at a time and starts after the selected delay.

If you change your mind and want to cancel Delayed start, you must press and hold the Stop button for three seconds.

NOTE!: Remember to press the Start button to start the program..

NOTE!: Make sure the detergent compartment is completely dry before you add detergent, otherwise there is a risk that the detergent will clump before the machine starts.

Super rinse

Use the Super rinse option if you want to increase the number of rinses. The maximum number of rinses is seven, and the number of rinses varies depending on the selected programme. Recommended for persons with extremely sensitive skin and/or in areas with very soft water.

Select Super rinse by pressing the button under the symbol.

The symbol above the button lights when this option is activated.

High water level

Use High water level if a garment's laundry label shows this symbol. High water level means that additional water is used during the main wash and rinse cycles.

- Select High water level by pressing the button under the symbol.
- The symbol above the button lights when this option is activated.

NOTE! The machine takes in the additional water for the High water level about 15 minutes after the main wash has started.

Anti crease

Anti crease means that the drum will rotate for three seconds per minute for two hours once the wash programme has finished. This function prevents the clothes from lying in the same position and getting creased.

- Select Anti crease by pressing the button under the symbol.

The symbol above the button lights when this option is activated.

Super wash

Super wash can be selected to better dissolve difficult stains and heavy soiling on clothing. This options adds a cold pre-wash and the the wash time in cold water is extended by approximately six minutes. The main wash time is also extended.

- Select Super wash by pressing the button under the symbol.
- The symbol above the button lights when this option is activated.

Pre-soak

Super wash can be selected to better dissolve difficult stains and heavy soiling on clothing. This option adds a cold pre-wash and the wash time in cold water is extended by approximately six minutes. The main wash time is also extended.

If the washing is stained, such as with blood, we recommend Pre-soak. The washing will soak in cold water for two hours before the wash programme starts.

- Select Pre-soak by pressing the button under the symbol.
- The symbol above the button lights when this option is activated.

7. Close the washer door and press the Start button

NOTE!

A few seconds after you start a program the washing machine will begin to fill with water from both the hot and the cold supplies. If for some reason no hot water is available, the machine waits for one minute and then fills with cold water only. The wash drum does not start to rotate until it begins to fill with water.

Time remaining

The time remaining is shown in hours and minutes. Once a program is selected, the estimated program time is displayed. This may differ from time to time depending on the temperature of the water entering the machine and the size of the load. If the program time is longer than the previous wash with the same program, "0:01" will be displayed until the program finishes. This is normal! The next time you use the program under similar conditions, the estimated program time will be more **accurate**.

Stopping or changing a programme

You can stop a programme by pressing the Stop button for three seconds. "Stop" appears in the display. To restart the machine, select a new programme, add any extra detergent needed and press the Start button. press the Start button

NOTE!

A few seconds after you start a program the washing machine will begin to fill with water from both the hot and the cold supplies. If for some reason no hot water is available, the machine waits for one minute and then fills with cold water only. The wash drum does not start to rotate until it begins to fill with water.

Time remaining

The time remaining is shown in hours and minutes. Once a program is selected, the estimated program time is displayed. This may differ from time to time depending on the temperature of the water entering the machine and the size of the load. If the program time is longer than the previous wash with the same program, "0:01" will be displayed until the program finishes. This is normal! The next time you use the program under similar conditions, the estimated program time will be more accurate.

Stopping or changing a programme

You can stop a programme by pressing the Stop button for three seconds. "Stop" appears in the display. To restart the machine, select a new programme, add any extra detergent needed and press the Start button.

NOTE!: Do not open the detergent compartment while the machine is running.

8. Once the program has finished

The text "Done" is shown on the display for 2 minutes. The machine then turns off. The washer door opens automatically once the program has finished. If you want to deactivate the automatic door opening function, see the "Selecting settings" section. Remove the load.

If you have small children or pets at home, close the washer door once you have removed the laundry.

NOTE! Upon completion of the washing cycle, close the water faucet and unplug the mains cord.

Settings

You can change the following settings:

- Child-safe
- Language
- Temperature
- Extra rinses
- Hot water

How to choose the settings:

1. Turn off the machine using the main power switch.
2. Press and hold the Stop button and then press the main power switch. Then press the Stop button 5 times within 10 seconds.
3. Select the setting you want to change by turning the program selector.
4. Press the Stop button once to select the setting.
5. Change and save the setting as described below.
6. Press Start to go to the program menu.

Child-safe

You can activate the Child-safe start option to prevent children from starting the machine.

1. Turn the program selector and choose "Child- safe On" or "Child-safe Off".
2. Press the Stop button once to save the setting.

You can temporarily deactivate Child-safe start by pressing the Super Rinse button and the minus button under Delayed Start at the same time.

Child-safe start will be deactivated for three minutes.

Language

1. Turn the program selector to choose from: US English, English, Svenska, Dansk, Norsk, Suomi, Français, Deutsch, Italiano, Espanol, Nederlands.
2. Press the Stop button once to save the setting.

Temperature

1. Turn the programme selector to choose between: °C and °F.

2. Press the Stop button once to save the setting.

Extra rinses

Upon delivery, your washing machine is set to use three rinses in the Normal and Everyday wash programs. If you want to increase the number of rinses to five for these programs, do as follows:

1. Turn the program selector and select "Rinses On" for five rinses or "Rinses Off" for three rinses.
2. Press the Stop button once to save the setting.

Care and cleaning

Cleaning the trap and the drainage pump

The washing machine has a trap where smaller objects such as coins and hairpins can collect. To clean the trap and the drainage pump, do as follows:

1. Make sure the machine is empty of water and switched off at the mains.



2. Open the door.



3. Unhook the drainage hose from the connector inside the door and drain the water into a suitable container, such as a shallow bowl.



4. Turn the cover anti-clockwise to open the pump. Remove the cover.

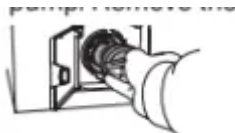

5. Remove any items and so forth from the pump housing and the cover. Also check that the pump blades right at the back rotate.



6. Screw on the cover, replace the drainage hose on the hatch pin and close the hatch.

Cleaning the detergent compartment

Pull out the detergent compartment using the release button.

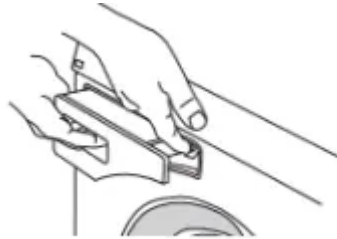

Rinse the compartment and scrub it clean. The cover in the fabric softener compartment can be removed.



NOTE!: Do not run the detergent compartment through a dishwasher!

Cleaning the outside of the machine

Clean the outside of the machine and the program panel with a mild cleaner. Do not use any solvents, as these can damage the machine.

Cleaning the inside of the machine to avoid unpleasant smells

Modern detergents often allow clothes to be washed at low temperatures. This means that small deposits can build up in the machine. These, in turn, may lead to unpleasant smells developing.

To avoid this, we recommend running a 95 °C wash programme once a month. When you do this, use a small quantity of detergent. It is not necessary to put any washing in the machine.

Rinse holes under the agitator

If you suspect that objects such as nails or paper clips may have fallen into the wash drum, you should check the space under the agitator. Such objects can rust and cause spots on clothing. Nails and other sharp objects can cause holes in fabrics.

Do as follows:

1. Insert a screwdriver or the like into the hole on the agitator as illustrated and carefully pry to the left.



2. Use your other hand to grasp the agitator and pull it towards you.



3. Lift the agitator.
4. Remove any objects.
5. Place the agitator in the mounting hole with the F-mark towards you. Ensure that all the agitator fasteners are in their holes in the drum. Push it in until it catches.

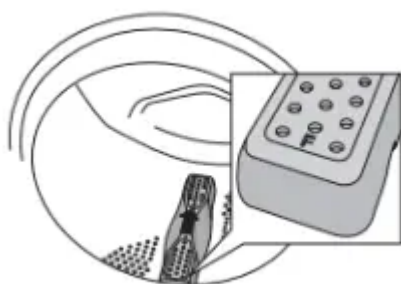

If you have hard water

If you live in an area with hard water (high limescale content), a greyish-white coating may form on the wash drum. To remove this coating, pour approximately 20 gram of citric acid into the wash drum and run any 95 °C programme. Repeat if necessary.

Troubleshooting

The washer door will not open

1. Check that the main power switch is on.
2. Has the power supply been cut off? Check the house fuses (circuit breakers).

Opening the door in an emergency

WARNING!: The door may only be opened manually if the electric power is cut and the machine has been drained of water.

A Run the Drain programme to empty the water from the machine. If this does not work the machine must be drained manually. See

Cleaning the trap and the drainage pump" in the "Care and cleaning" chapter.

B Ensure that the main power switch is turned off and that the plug has been removed from the wall socket.

C Take the emergency door opening key (C) see figure in the section Dispenser) and insert it into the slot on the right-hand side of the washing machine door latch. The key is attached on the back wall of the detergent dispenser. Remove the detergent dispenser from the washing machine and take the door opening key.

D Push the tool downwards to open the washer door.

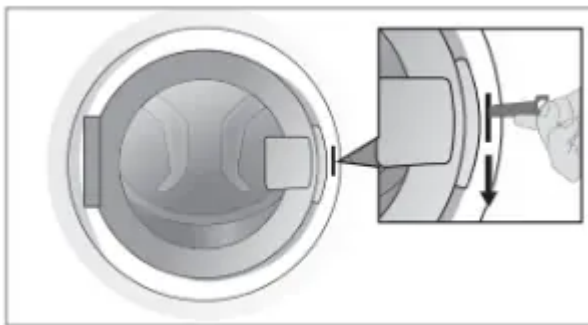

After use, store the emergency door opening key (C) in the dedicated compartment (B) (see image in the section Dispenser).

The machine will not start

1. Is the washer door properly closed? Push it firmly. Then press the Start button.
2. Is there power? Check the fuses and residual current devices (circuit breakers) in the building.
3. Check that you have not selected Delayed start. To cancel Delayed start, press the Stop button for three seconds.

After power failure

Press the main power switch to resume the current programme.

Wet washing still in the machine

A small load can under certain circumstances cause imbalance Unbalance (see "Unbalance"). Rearrange the load and start the spin programme, or load more washing and restart the washing programme.

Error messages

If an error occurs during the programme a message is shown on the display. To exit the message after taking measures, turn the machine off and then back on.

The error messages that may be shown in the display are:

Close the Door

Close the washer door and press Start to start the programme.

Over flow fault

1. Shut off the water tap.
2. See "Drainage error".

Water outlet fault

Check:

- that no objects are stuck in the drainage hose outlet.
- that the drainage pump is not blocked by foreign objects. Clean the pump. See the "Care and cleaning" chapter.
- that there are no kinks in the drainage hose.

After the above, run Drain to empty the machine. If this does not resolve the problem, call the service division.

Water inlet fault

Check:

- that the tap on the water pipe is open.
- that the filter in the machine's water intake is not blocked.

Action:

1. Shut off the water tap and unscrew the hose.

2. Clean the filter in the intake valve on the machine.
3. Screw the hose back on and turn on the tap.
4. Run the program again to check if the fault is fixed.
5. If this does not resolve the problem, call the service division.

Wash motor fault

Call the service division!

Unbalance

The machine stops the spin cycle if there is too much imbalance. The washing machine restarts the spin cycle and hopefully the washing is better distributed in the drum. This procedure can be repeated up to times. If the machine still fails to find a good balance, the programme jumps to the next step. The error message requires no action.

Transport protection

Remove the three transport bolts and the plastic plugs for locking the machine for transport before using the machine.

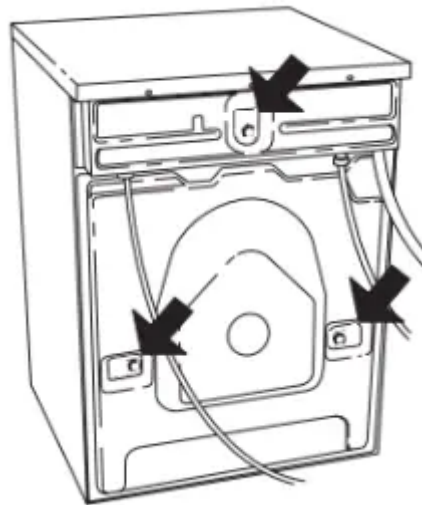

1. Loosen and remove the bolts as illustrated below.

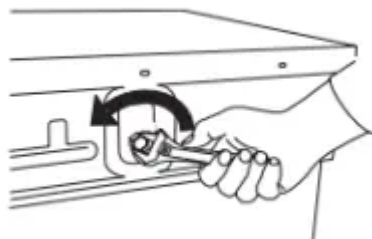

2. To remove the plastic plugs that held the bolts, squeeze together and pull out.

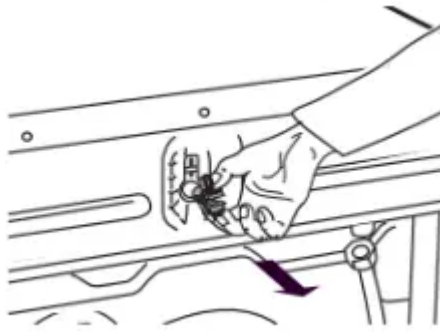

3. Remove the plastic covers from the plugs. Push the plastic covers into the three holes that contained the plugs. Save the plastic plugs in case the machine is moved in the future.

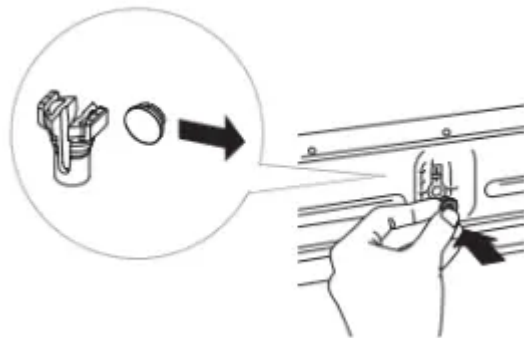

NOTE!

If the machine is to be transported, the bolts and plastic plugs for locking the machine during transport must be installed to prevent damage to the machine through shaking. If the transport bolts or plastic plugs have been lost, you can order new ones from your retailer.

Article number	Designation
80 882 77	Screw
80 901 05	Plastic plug, transport lock

Order three of each item!

Installation

Positioning the washing machine

The washing machine can be installed as a built-in or freestanding unit. Place the machine on a firm surface with easy access to the plug.

A. Built-in

The washing machine can be installed under a counter top with a working height of 850-900 mm. Leave a 5 cm space around the entire machine, including between the rear edge of the top cover and the wall behind it.

B. Freestanding

The washing machine can be positioned beside or under a tumble dryer.

Adjusting the feet

Keep the noise that the machine produces to a minimum by adjusting the feet so that the machine is steady and balanced on the floor.

Tighten the lock nuts.

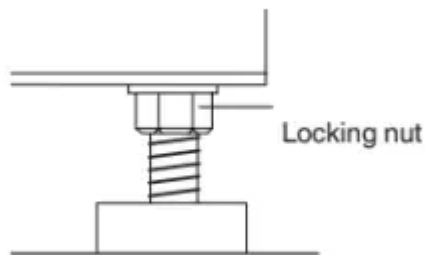

Connection to water supply

Water connection should be carried out by an appropriately qualified person. Connect the machine using the accompanying supply hose.

Water pressure should be 0.1–1MPa (approx. 1–10kp/cm² ; 10–100N/cm²). There should be a stopcock on the water pipe.

If the pipes are newly installed, it may be wise to flush them through so that any dirt is washed away. Otherwise, dirt can clog the filter in the machine's water intake and cut off or reduce water flow to the machine. Check for leaks.

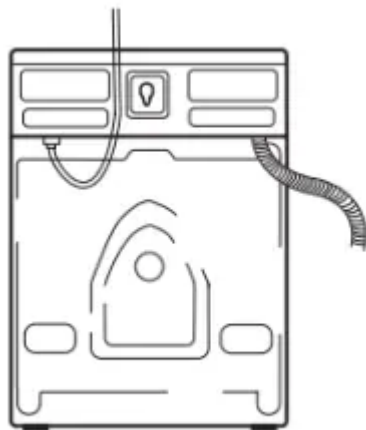

Use only the supply hose supplied with the machine.

Do not re-use old hoses or other loose supply hoses.

Drainage connection

The machine is supplied with a drainage hose attached, which must be connected to a drain. See the examples below. The height must be mm above floor level.

The lower position (600 mm) is always preferable. Ensure that the drainage hose has no kinks.

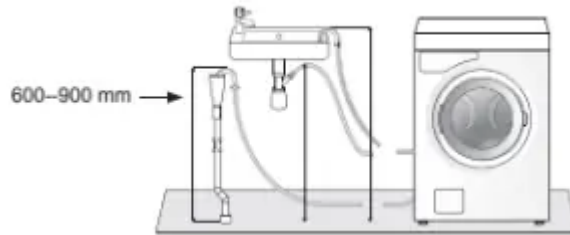

The machine can also be connected to the drain via a spigot connection. In this case the hose should also be 600-900 mm above the floor. The internal diameter of the hole should be at least mm.

- Cut the nipple
- Remove burrs from the hole.

See the illustration.

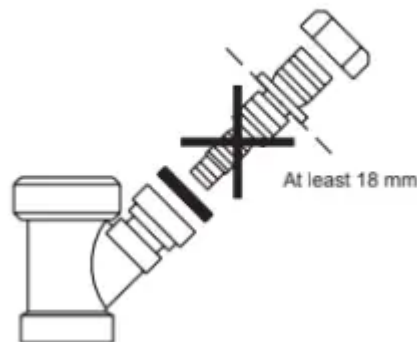

Electrical installation

Connect the machine by plugging it into an earthed wall socket. The electrical wall socket must be placed outside of the installation area to be easily accessible.

CAUTION! If this appliance is supplied from a cord extensions set or electrical portable outlet device, the cord extension set or electrical portable outlet device must be positioned so that it is not subject to splashing or ingress of moisture.

Connection on delivery

The machine is supplied as 1-Phase, 230-240 V, 50-60 Hz, heat output 2000 W and has a 10 A plug. Any residual current devices must be type A.

NOTE!: Repairs and maintenance must be carried out by a qualified professional.

Service

Before contacting the service division

Before you contact the service division, make sure that you know the model number (located on the front panel), and serial number. The model designation can be found on the panel. The type designation and serial number can be found on the type plate on the inside of the washer door.

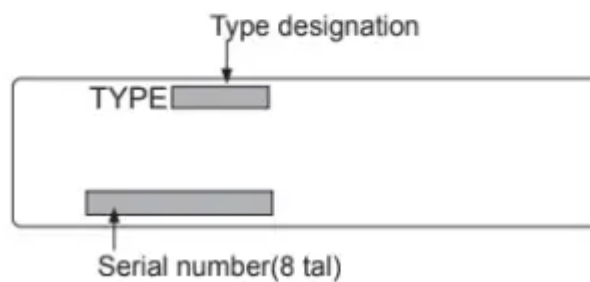
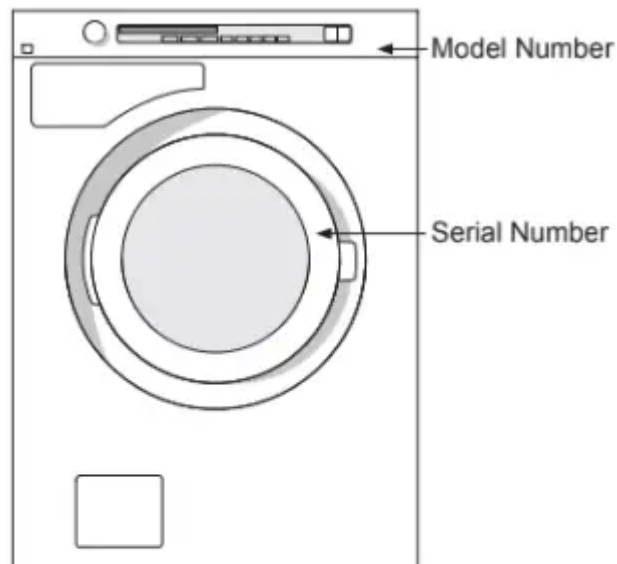

QUICK GUIDE



1. SORT THE WASHING, OPEN THE WASHER DOOR AND LOAD THE WASHING

Refasten zips.

Look at the item's laundry label. Sort the washing according to how soiled it is, colour and material. NB! Place underwired bras in a laundry net.

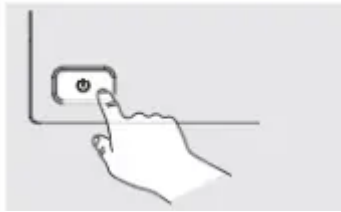

2. TURN ON THE MAIN POWER SWITCH

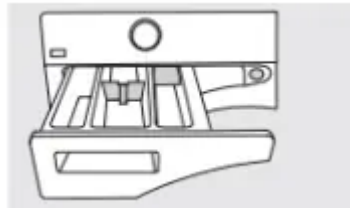

3. ADD DETERGENT AND FABRIC SOFTENER, AS REQUIRED

The detergent packaging will have recommendations for how much detergent you should use. With only a small amount of washing in the machine, you can reduce the amount of detergent used.



4. SELECT A PROGRAMME

You select a programme by turning the programme selector. The selected programme is shown in the display.

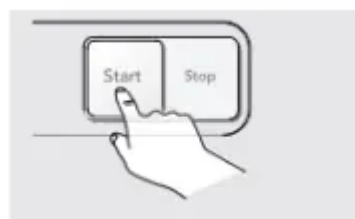

5. CLOSE THE WASHER DOOR AND PRESS THE START BUTTON

The time remaining is shown in hours and minutes.

Warning

This content is compiled from multiple sources and is provided for reference purposes only. It may not be complete or fully applicable to all situations. If you are unable to resolve your issue, please contact the product manufacturer or an authorized service provider for official support.

Document generated by [ManualsFile](#)