

1.COMPONENT LIST

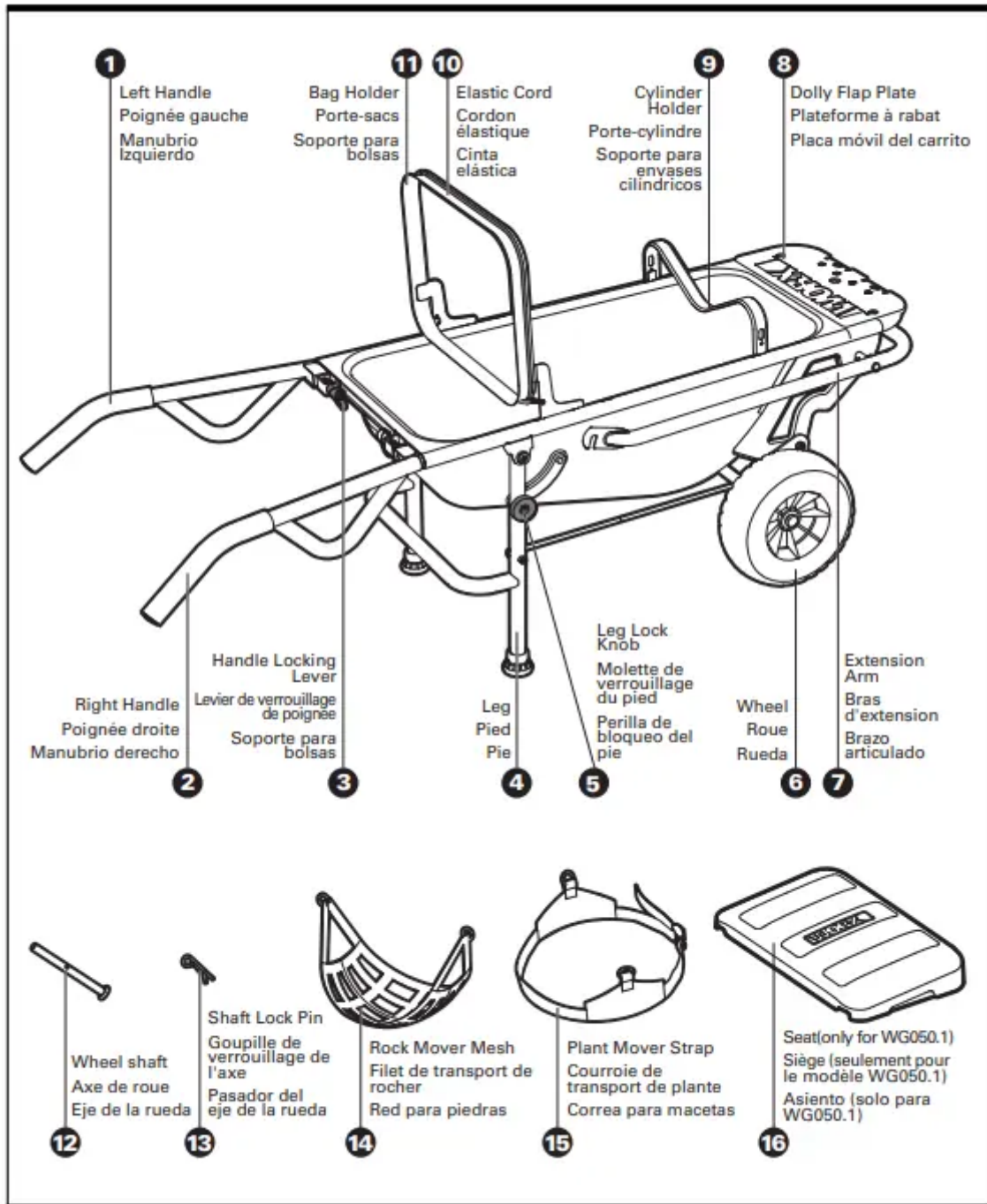

2.ASSEMBLY

The main body of the AerocartTM is assembled at the factory. If you find any parts damaged or missing, please contact the retailer immediately. Please keep all proof of purchase and original

packaging. Before beginning, remove all packing material, including black rubber corner pieces which are attached to corners of tub.

2.1 Attach wheels

1. Insert Wheel Shaft through Wheel and into Axle. *Please make sure the concave side of the wheel is outward.
2. Secure by inserting Shaft Lock Pin through Wheel Shaft and Axle.

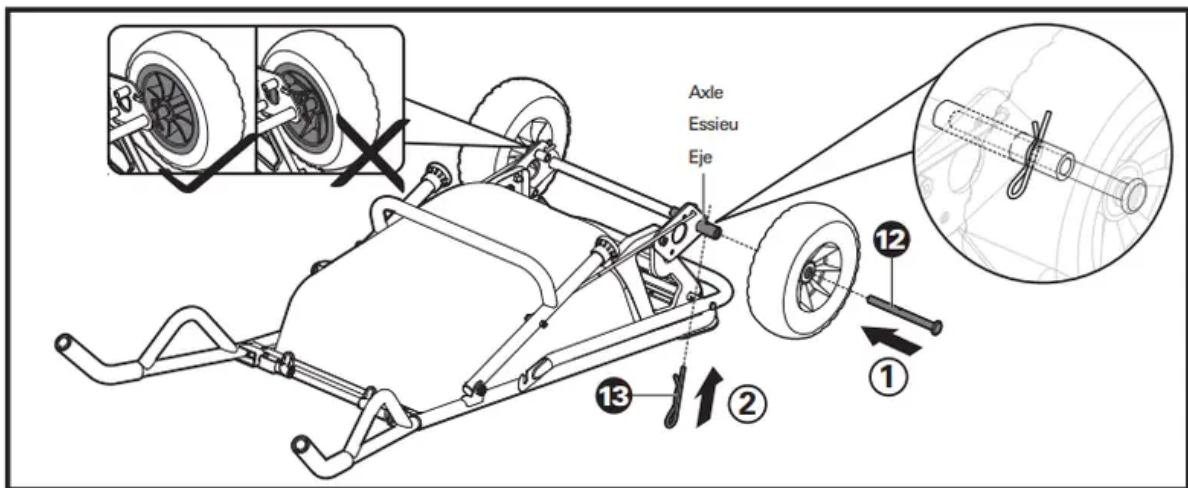

2.2. Attach Handles:

1. Lift the Handle Locking Lever.
2. Insert Handle.
3. Return Handle Locking Lever to locked position. Note that the two handles are different, and must be attached to proper side of the cart.

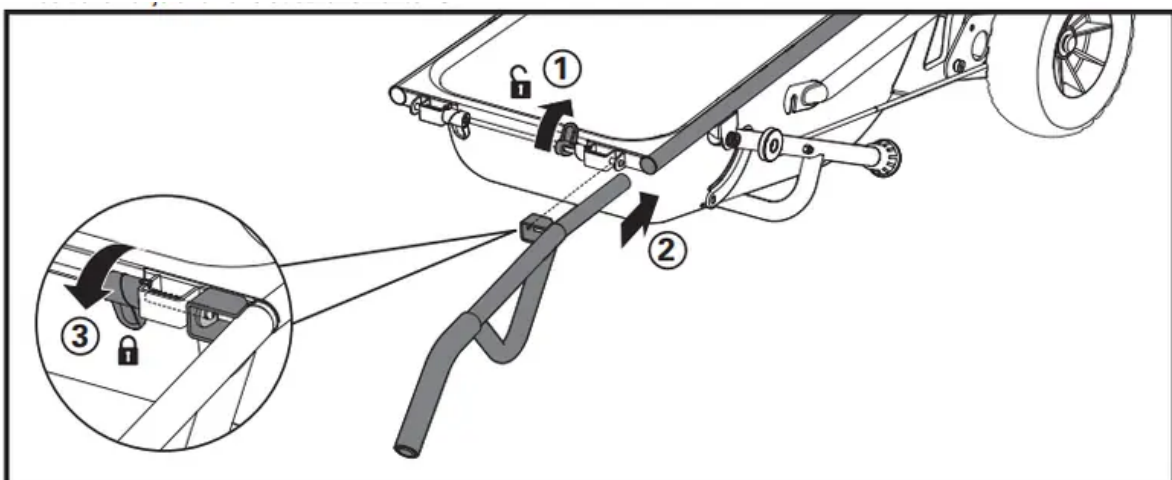

3. OPERATION

The Aerocart™ transforms from a dolly to a wheelbarrow and back with ease. Pull and release the Leg Lock Knob to move the legs and wheels into desired position. The wheelbarrow features two wheels for improved stability and comfort. The Aerocart™ also can be transformed into a wagon, using the Wagon Conversion Kit, which is sold separately. When you first take the product out of its packaging for Wheel and Handle assembly it will be in dolly mode, but with Dolly Flap Plate closed.

3.1 Change between Wheelbarrow and Dolly modes.

1. Place the Aerocart™ forward with weight on nose of cart.
2. Grasp the leg support and pull upward slightly.
3. Pull the Leg Lock Knob firmly.
4. Reposition legs either up or down as desired. Make sure the Leg Lock Knob “clicks” into locked position.

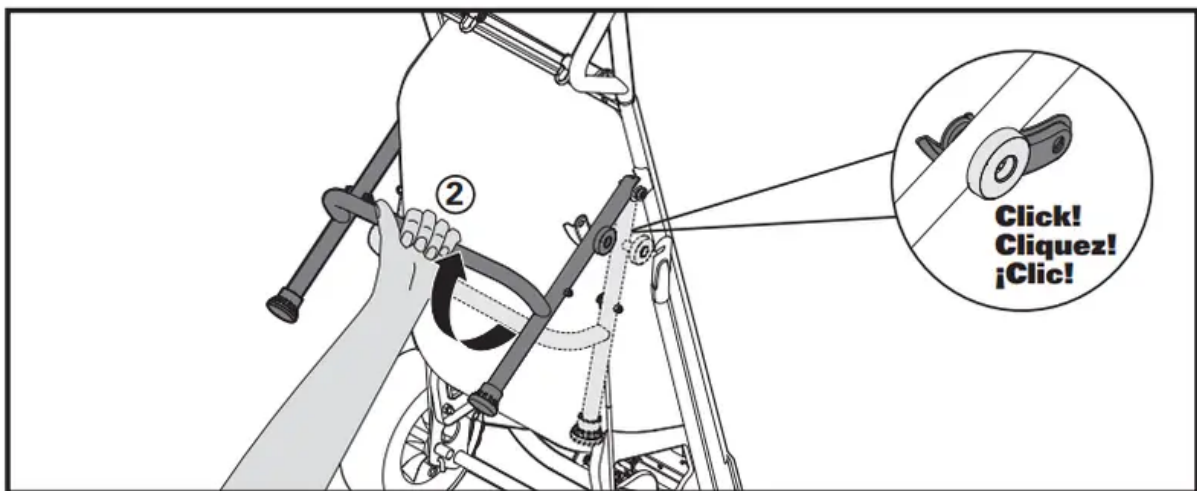
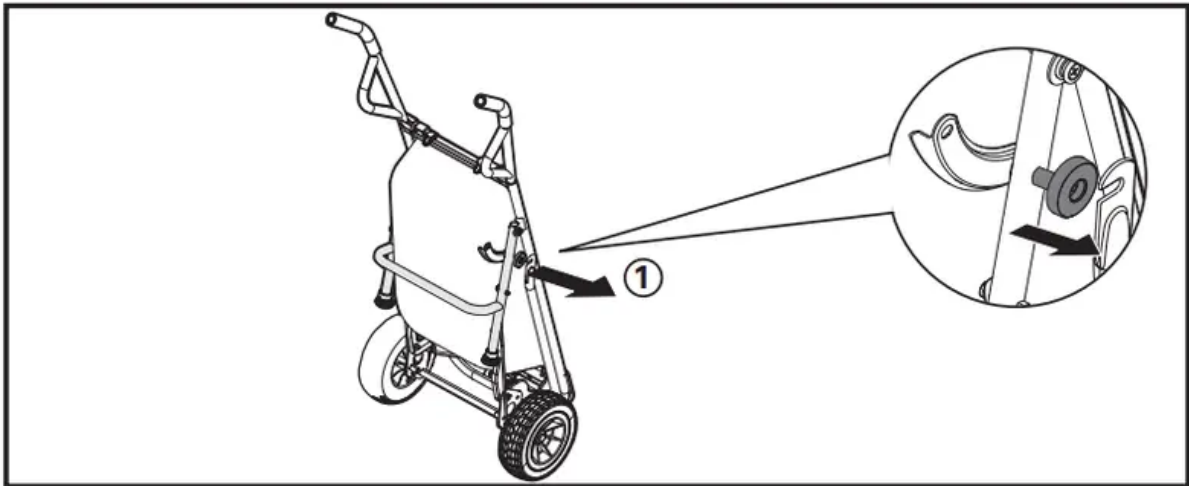

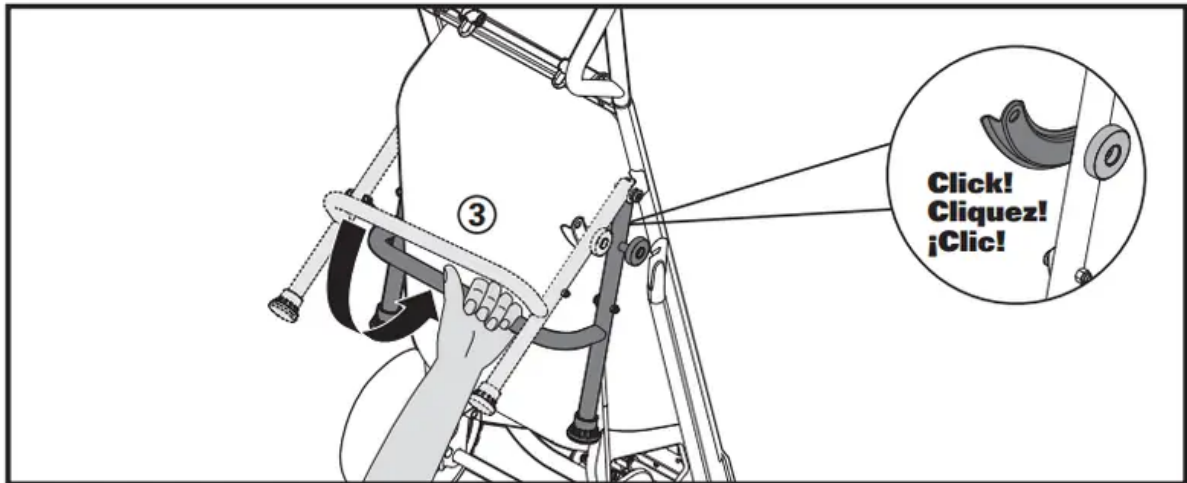

3.2 Open or Close the Dolly Flap Plate

1. Slide Dolly Flap Plate in direction of arrow.
2. Flip the Dolly Flap Plate up or down as needed. It will lock back into position automatically.

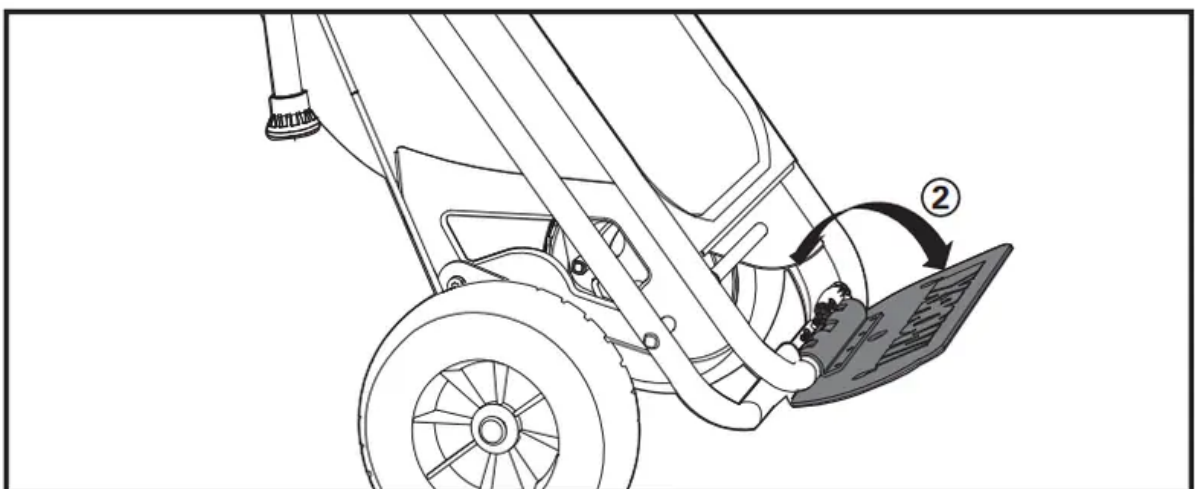
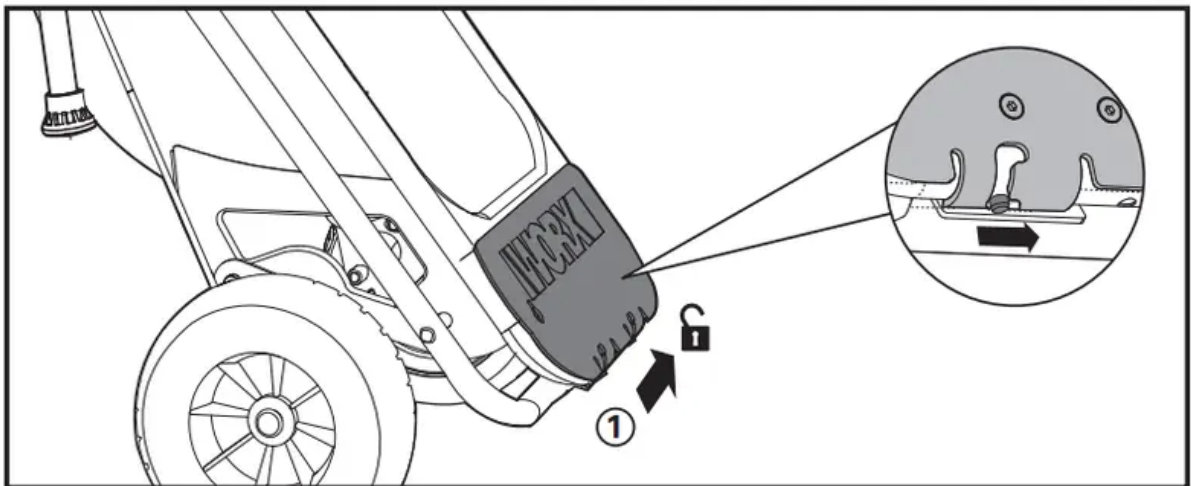

3.3 Attach Cylinder Holder

1. Insert the tabs on the ends of the Cylinder Holder in the slots on the rim of the tub.
2. Press down firmly to insure that the tabs are well seated in the slots.
3. Switch Aerocart™ to dolly mode, and slide Dolly Flap Plate in direction of arrow. Put cylinder on to Aerocart™ as shown.

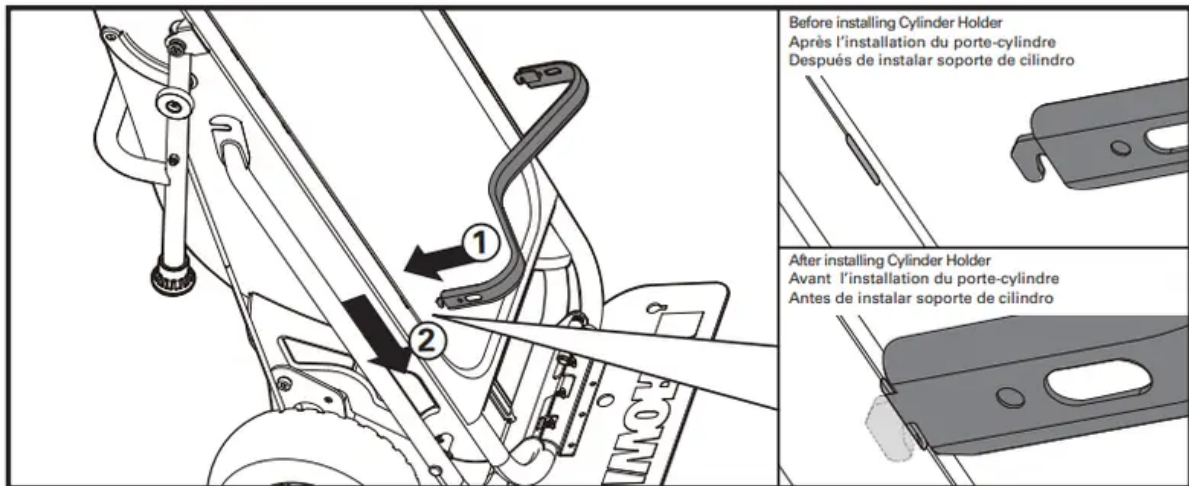

WARNING:

Safely secure all loads. Follow manufacturer's instructions for securing pressurized tanks or similar items.

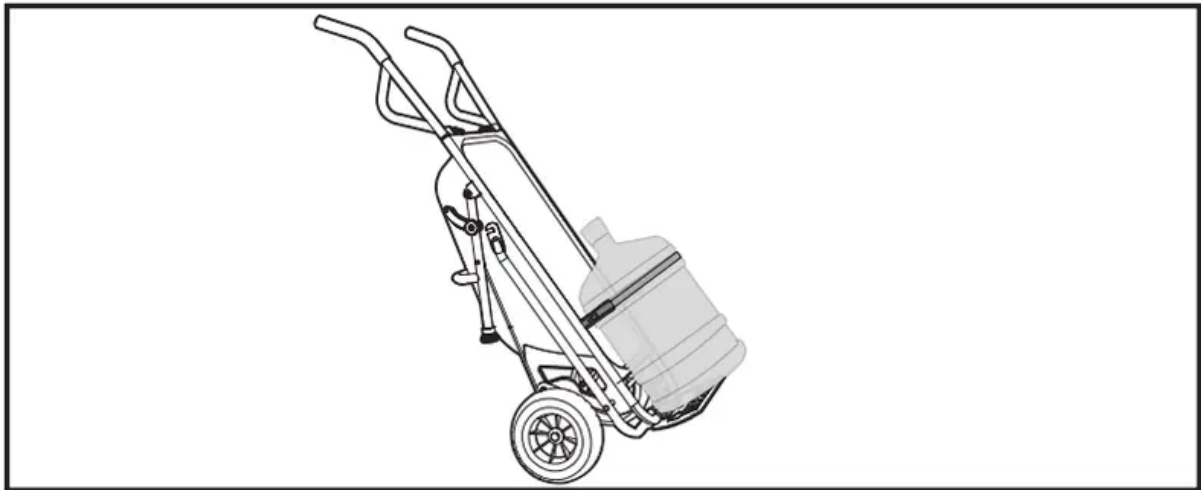

3.4 Open Extension Arms.

Grasp and position Arms into position desired.

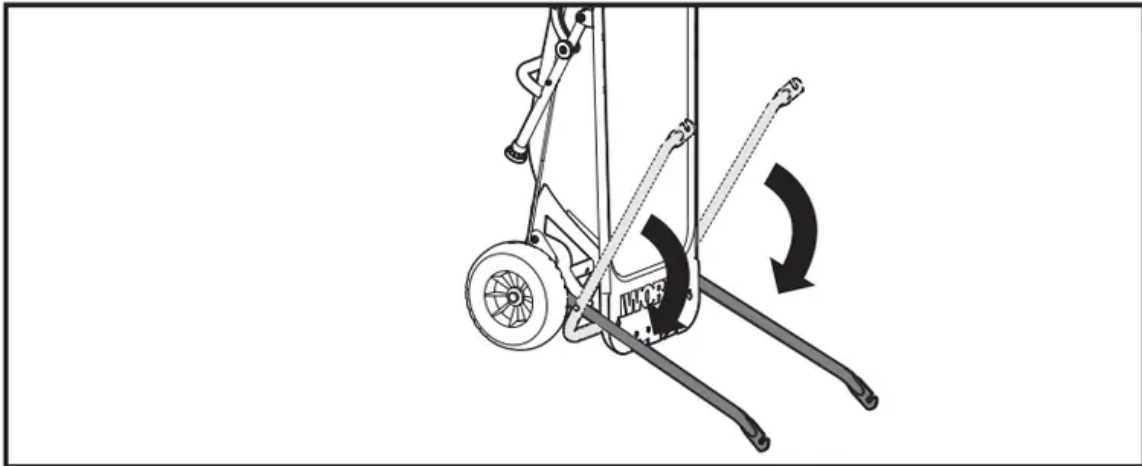

3.5 Attach Bag Holder

1. Insert the tabs on the Bag Holder in the slots on the rim of the tub.
2. Press down firmly to insure that the tabs are well seated in the slots.

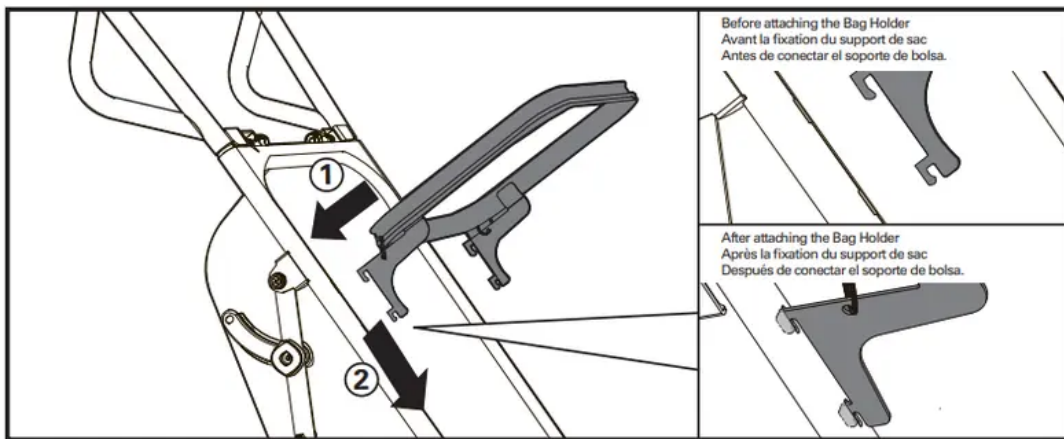

3. Tuck the bag under the elastic strap to keep it secure.

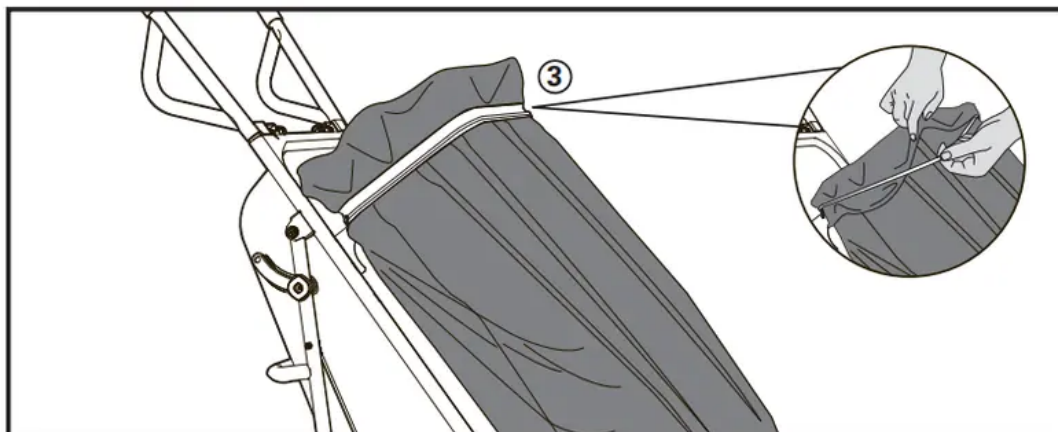

3.6 Attach Rock Mover Mesh

1. Position the rock or other heavy object onto the Mesh.

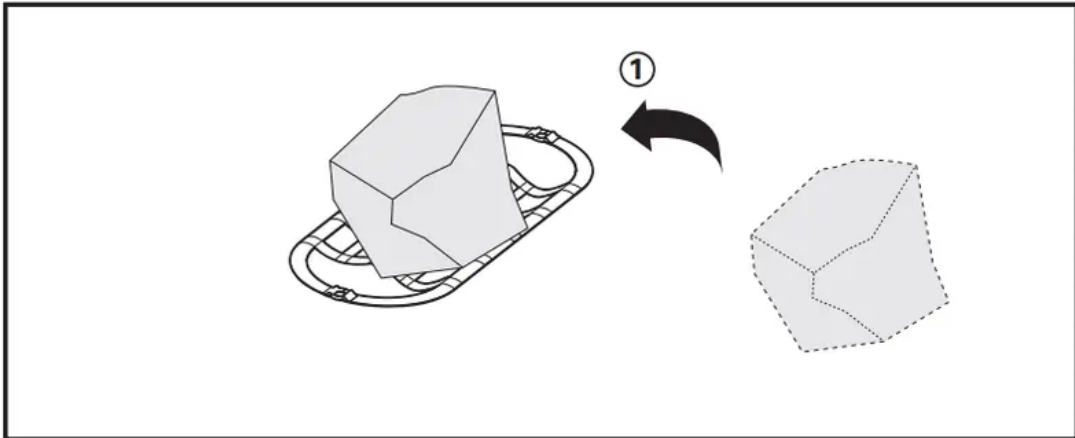

2. Connect the rings onto the Extension Arms.

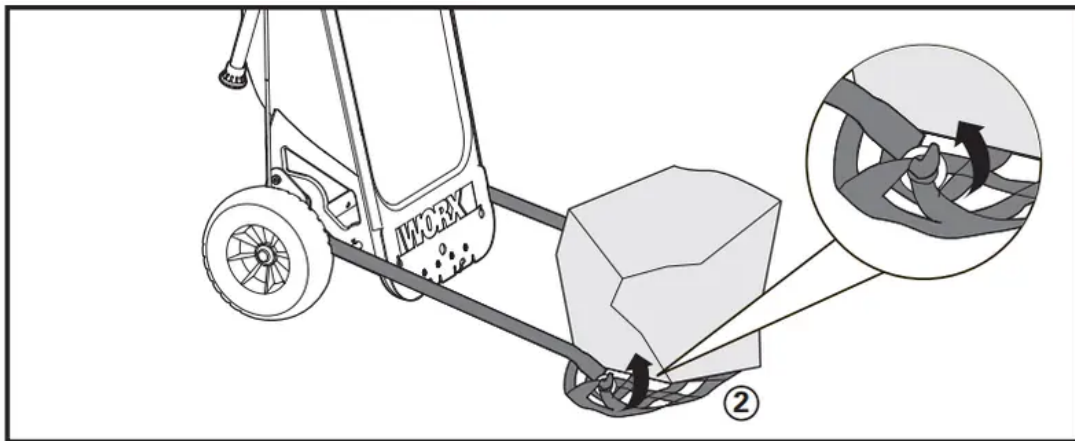

3.7 Attach Rock Mover Mesh – Alternate Method

1. Weave the straps of the Mesh directly onto the Extension Arms. *This method of attaching the Rock Mover Mesh is helpful for supporting a bag or other type of load that might tend to sag.

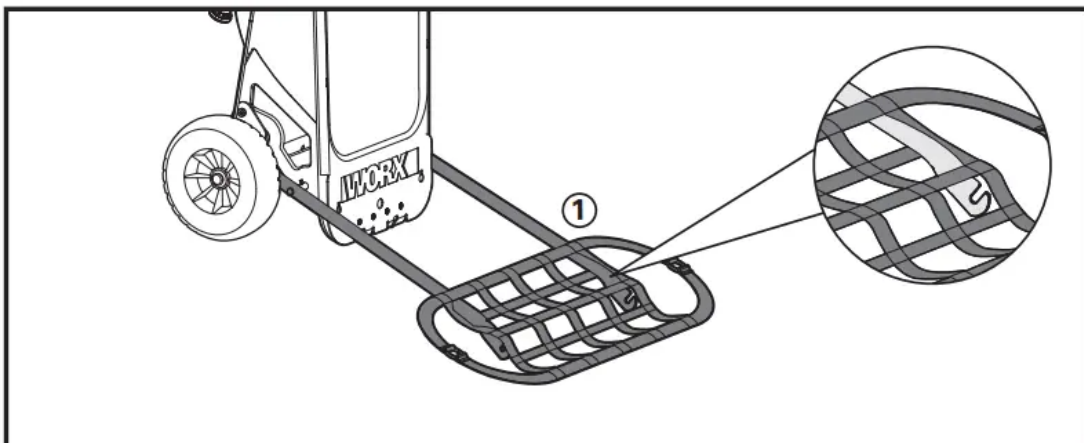

3.8 Attach Plant Mover Strap

1. Position the Strap around the pot or object. Make sure the metal rings are pointing upward.
2. Tighten the strap securely.
3. Make sure the metal rings are spaced an equal distance apart.

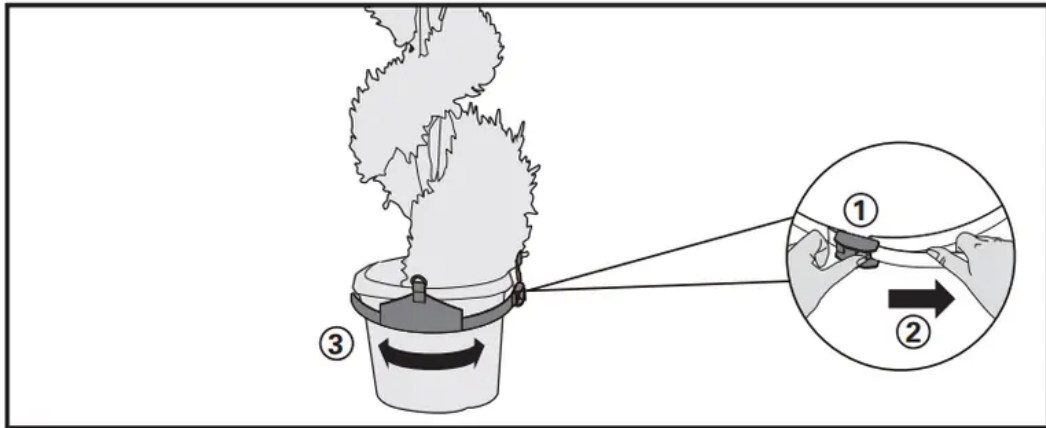

4. Connect the rings onto ends of the Extension Arms.

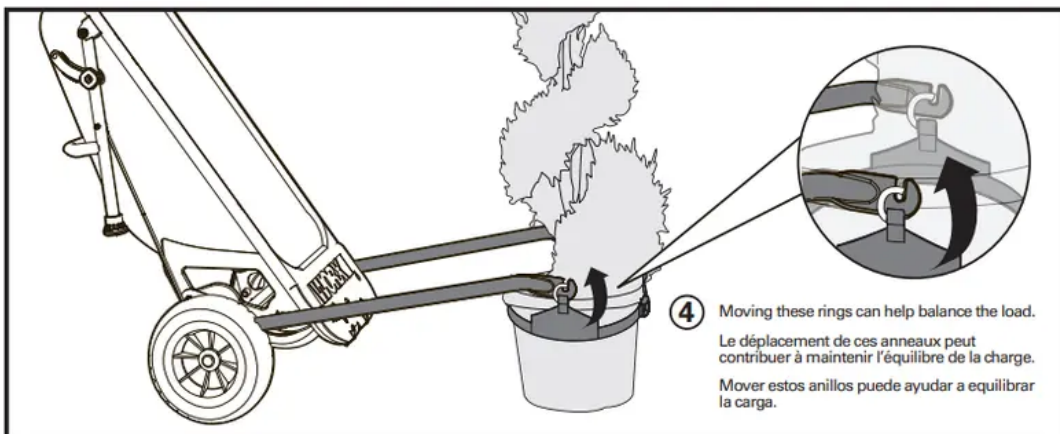

5. Lift the pot carefully by pushing down on the Aerocart™ handles. If the load is not balanced, reposition the rings on the strap.

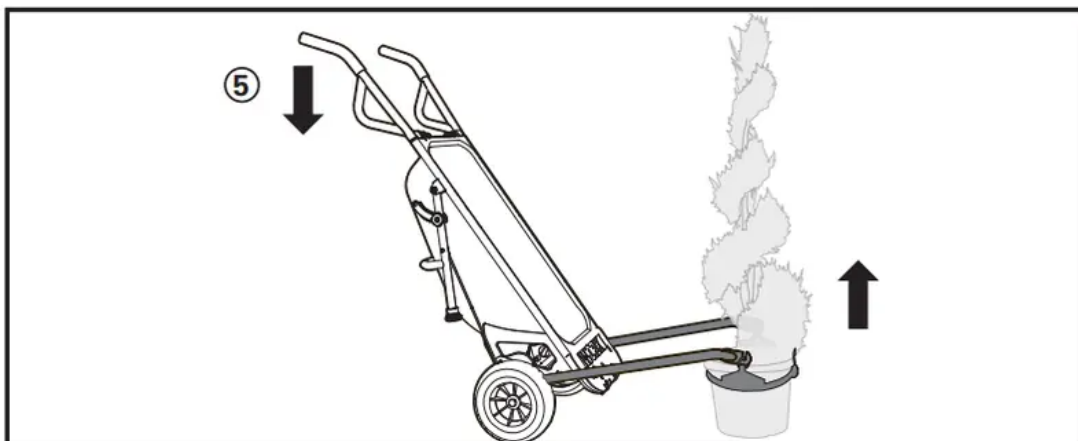

3.9. Trailer mover

1. Transform the Aerocart™ into the dolly position and open the Dolly Flap board Plate.
2. Locate the hole in the Dolly Flap and put trailer hitch ball in to the hole.
3. Screw on the trailer hitch ball(not included) and close the Dolly Flap Plate.
4. Position hitch ball under trailer hitch and push handles down to raise the hitch.

WARNING: DO NOT ATTEMPT TO MOVE A TRAILER ON A STEEP INCLINE

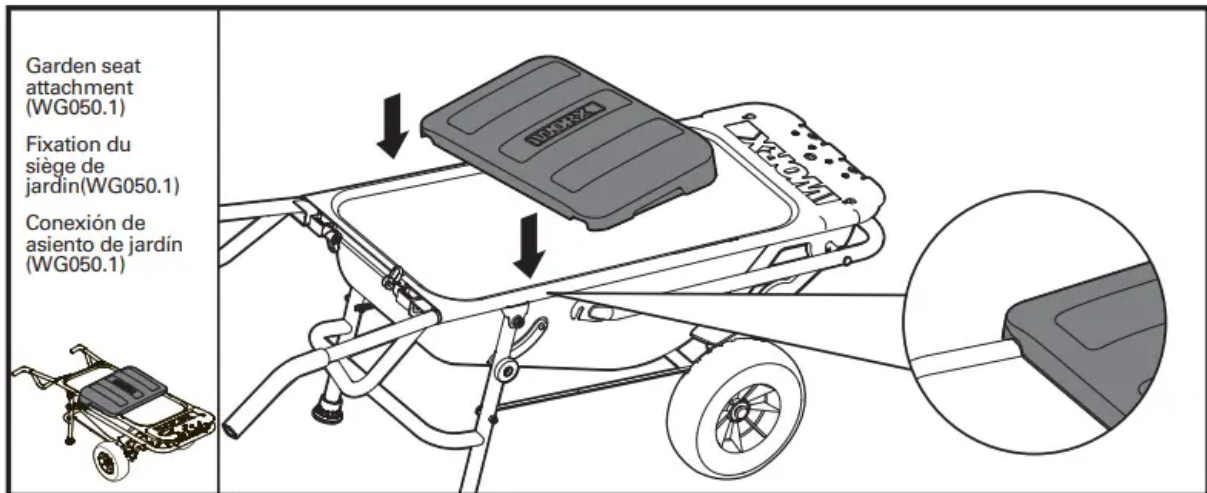

4. MAX WEIGHT LIMITS

1. Wheelbarrow weight maximum is 300 lbs (136kg)

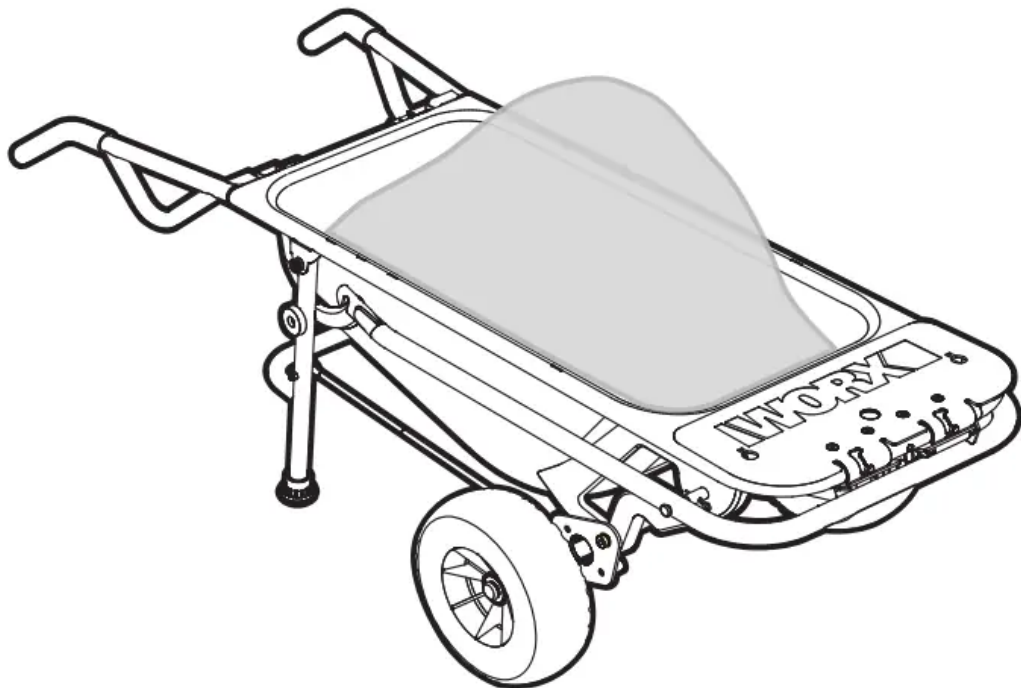

2. Dolly weight maximum is 300 lbs (136kg)

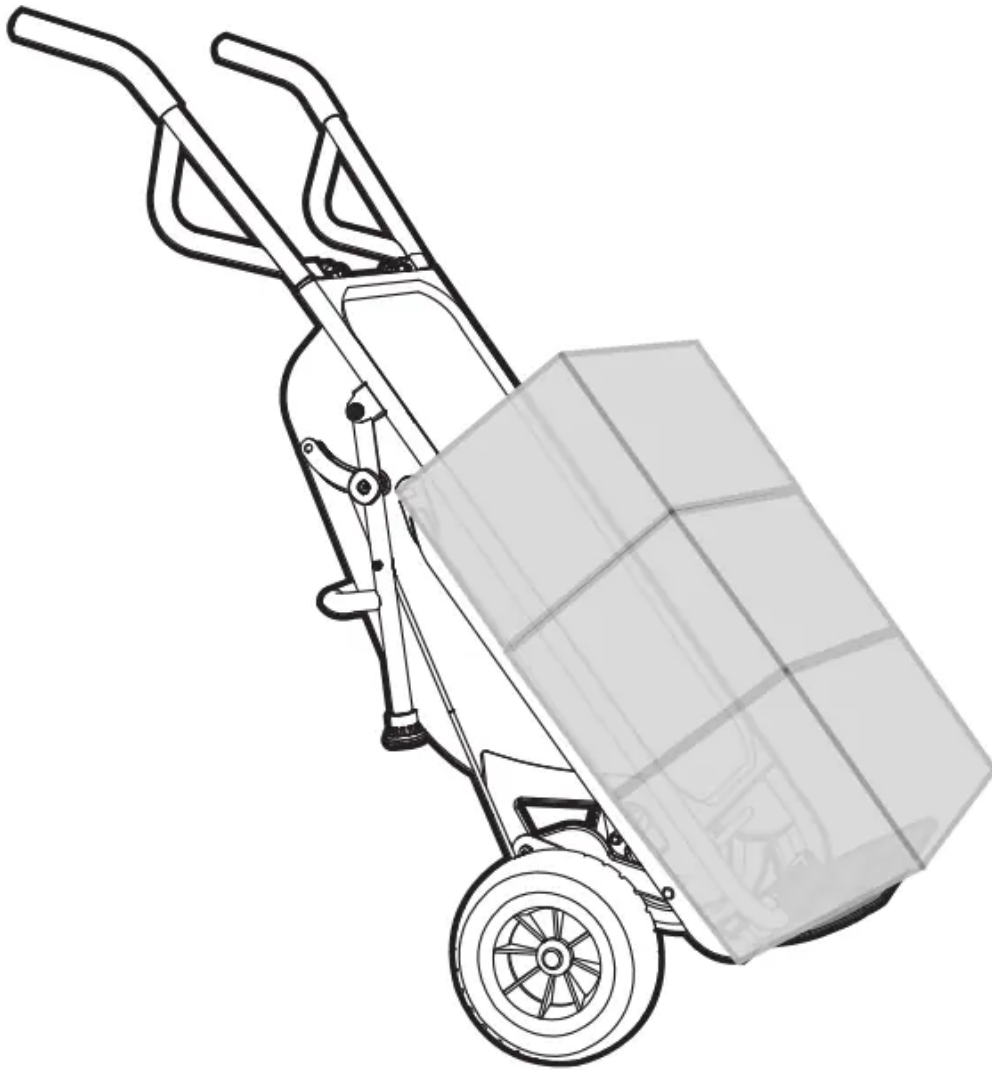

3. Cylinder Holder weight maximum is 80 lbs (36kg)

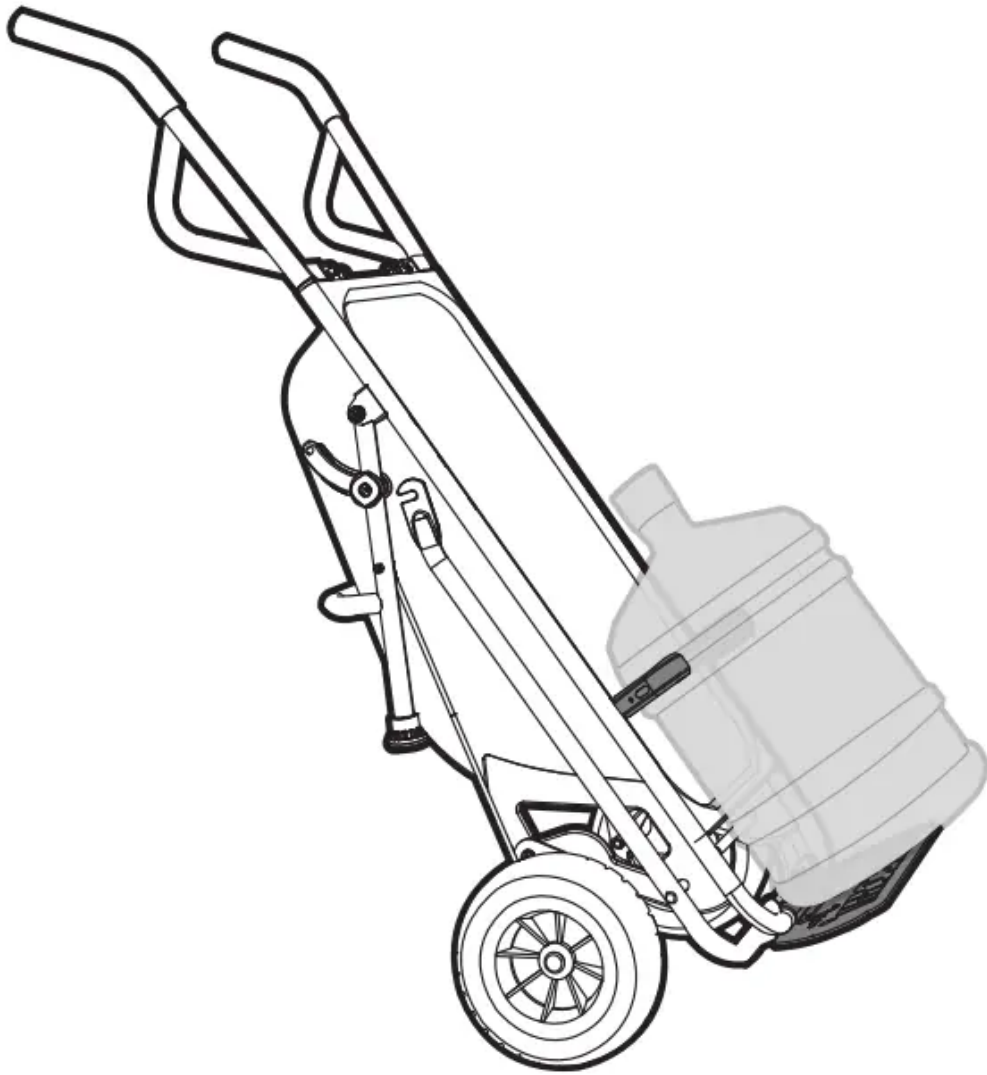

4. Extension arm weight maximum is 80 lbs (36kg)



5. Bag Holder weight maximum is 40 lbs (18kg)



6. Trailer mover tongue weight maximum is 100 lbs (45kg) Trailer mover trailer weight maximum is 1000 lbs (450kg)

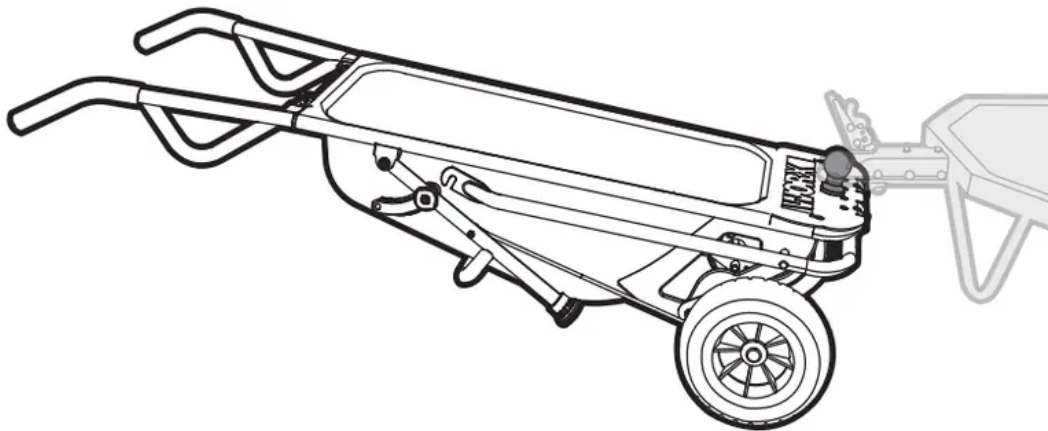

Warning

This content is compiled from multiple sources and is provided for reference purposes only. It may not be complete or fully applicable to all situations. If you are unable to resolve your issue, please contact the product manufacturer or an authorized service provider for official support.

