

What's in the Box?

Standard accessories may vary by model. To identify what should be included with your purchase, please refer to the "Carton Contents" list located on the carton top flap.

Vacuum Base

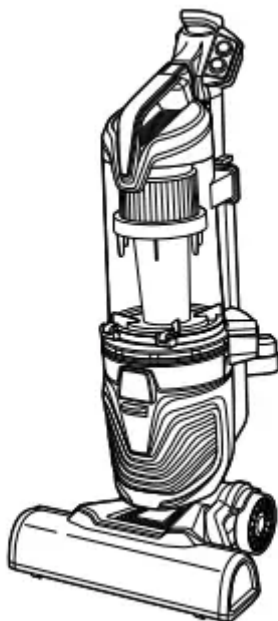

Upper Handle & Extension Wand



Stretch Hose

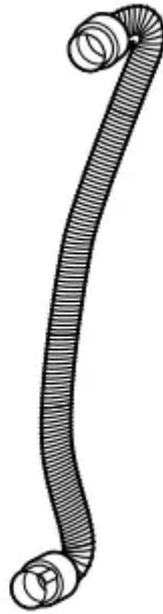

LED Lighted Crevice Tool



Pet TurboEraser® Tool



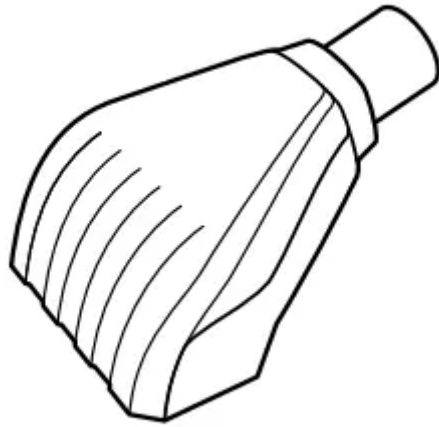

2-in-1 Pet Brush

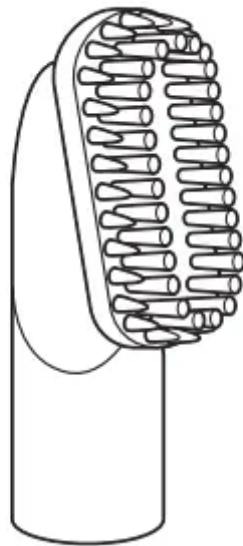

Optional Febreze Filter



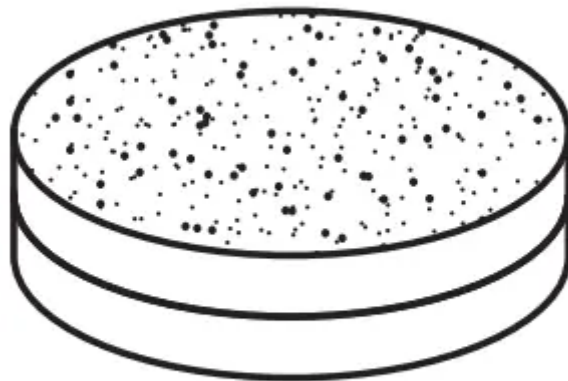

Certain trademarks used under license from The Procter & Gamble Company or its affiliates.

Product View

For additional support videos and information about your vacuum, visit support.BISSELL.com.

1. Suction Control
2. Hose
3. Quick Release Extension Wand
4. Dirt Tank Release Button
5. Power Switch
6. Brush Roll ON/OFF Switch
7. Pre-Motor Filter
8. Dirt Tank
9. Post-Motor Filter
10. Automatic Cord Rewind Button

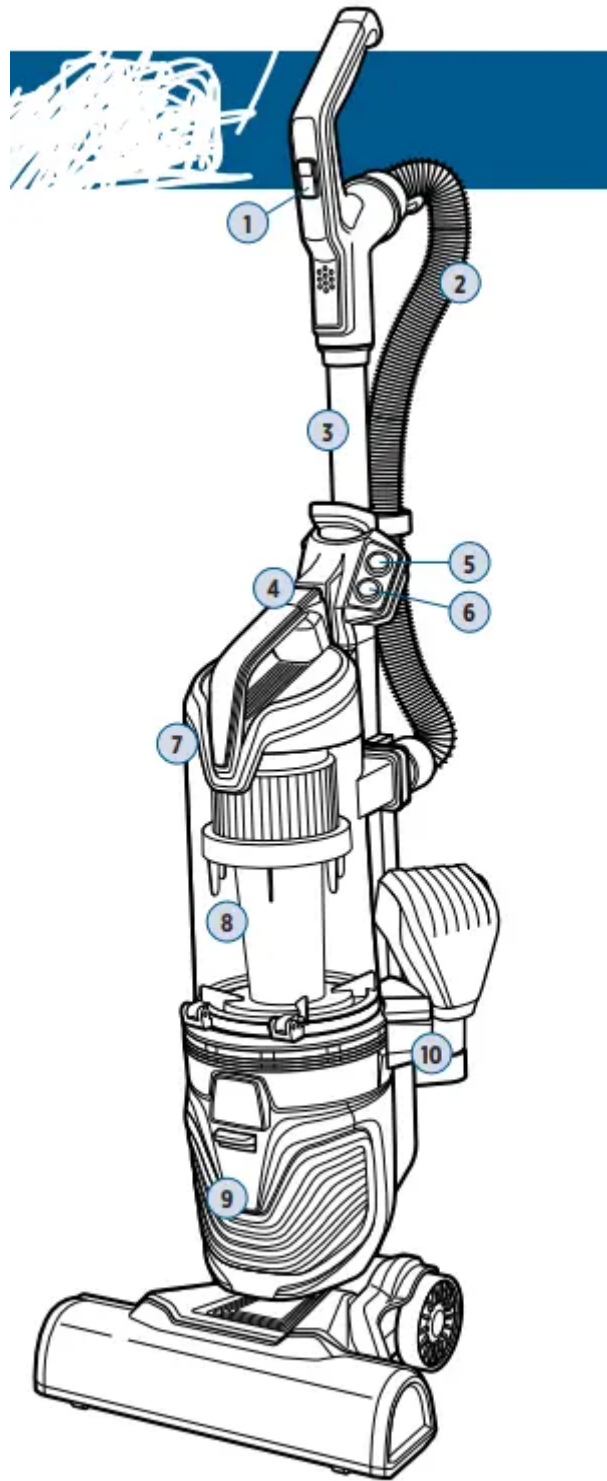



Assembly

1. Slide end of wand into top of base. It will “click” when inserted correctly.



2. Attach Stretch Hose by lining the tabs on the circular cuff with the notches on the back of the handle. Twist clockwise to lock hose into place.



3. Press the Dirt Tank Release Button and pull tank away from the vacuum to remove.

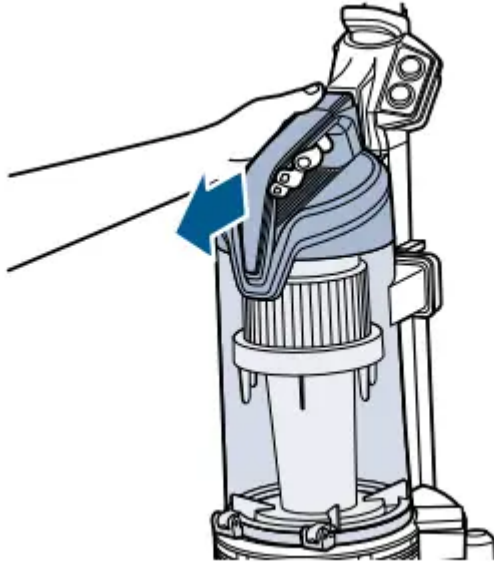

4. Attach end of hose to vacuum by sliding square cuff into the bracket below the Power Switch.

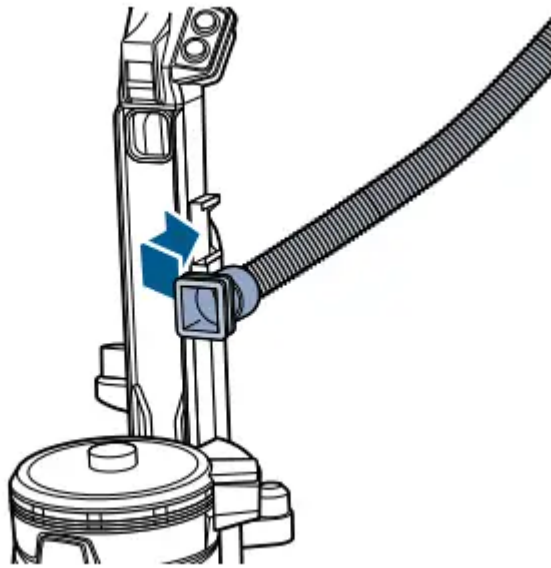

5. . Install optional Febreze filter by twisting tank cover to unlock position and pulling up on the handle. Remove the Pre-Motor Filter and replace with Febreze filter. Reinstall tank cover when done.

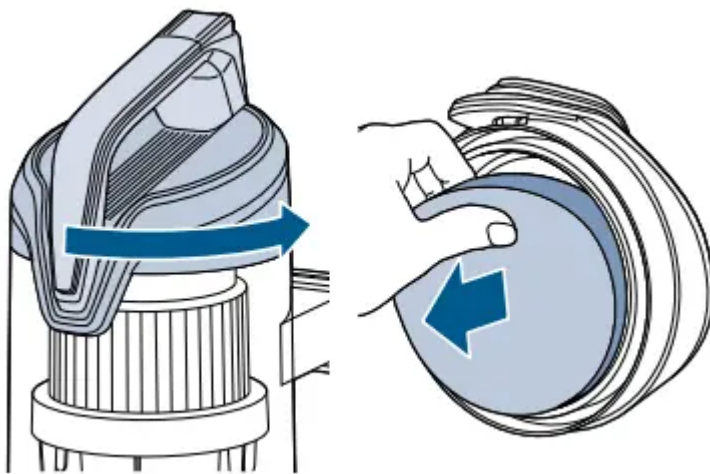

6. Place the Dirt Tank on the vacuum by securing the bottom in place first, then push back until you hear a “click”.



Using Your Vacuum

For additional ways to use your vacuum's features, check out [support.BISSELL.com](https://support.bissell.com).

1. Turn the Power Switch ON.

Optional: Turn the Brush Roll Switch ON to run the PowerBrush for carpet cleaning. Brush Roll is ON when light switch is illuminated. Turn the Brush Roll Switch OFF when vacuuming hard or delicate surfaces like hardwood, tile, small area rugs, or frieze carpets with long delicate fibers or threads.

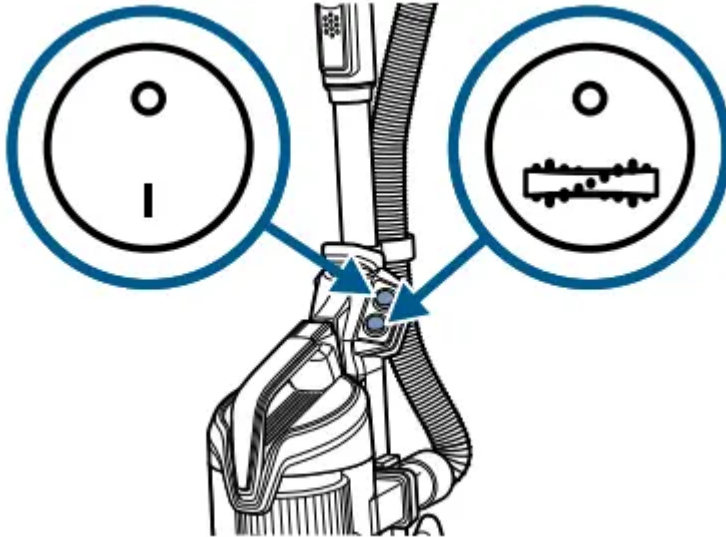

2. Step gently on base and pull the handle back to recline.

Note: The Brush Roll automatically shuts OFF when vacuum is locked in upright position. Recline to reactivate.



3. Use the Suction Control Switch to change settings between plush and low carpet for easy multi-surface cleaning.

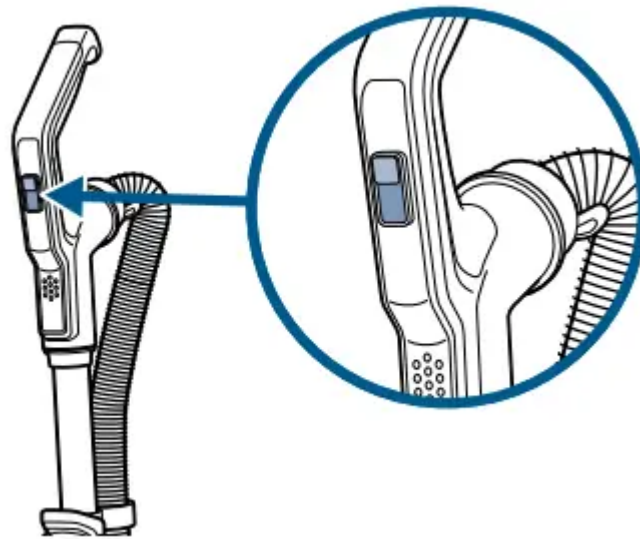

Warning: Do not plug in your vacuum until you are familiar with all instructions and operating procedures.



Automatic Cord Rewind

If you have trouble with this feature, see our troubleshooting videos on support.BISSELL.com.

1. To plug in your vacuum, gently pull the cord out, being careful not to pass the red mark on the cord. Plug the cord into an outlet.

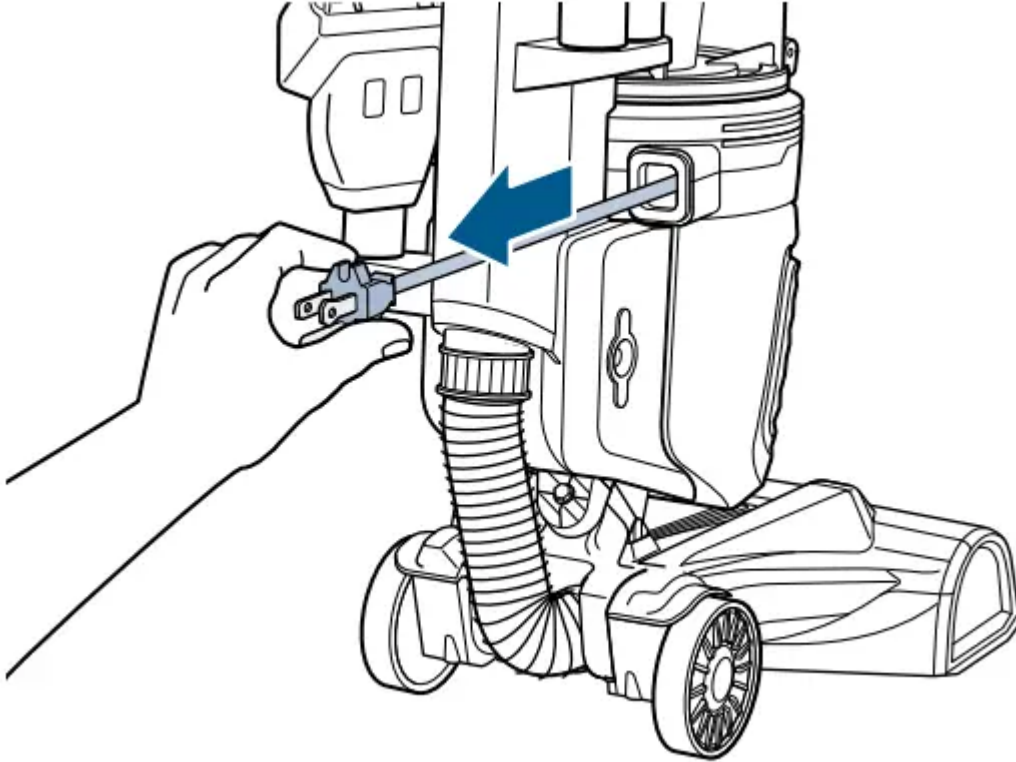

2. When you're done cleaning, unplug the vacuum. Hold the plug and press the Automatic Cord Rewind Button to slowly retract the cord.

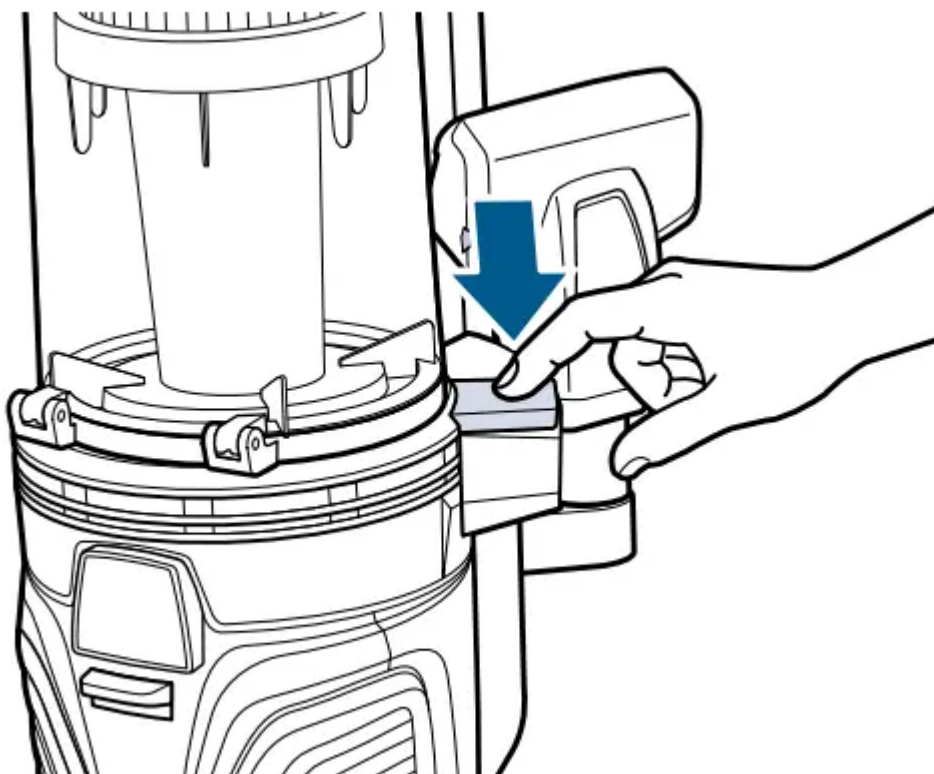

3. If it doesn't fully retract at first, pull some of the cord out and press the button again.

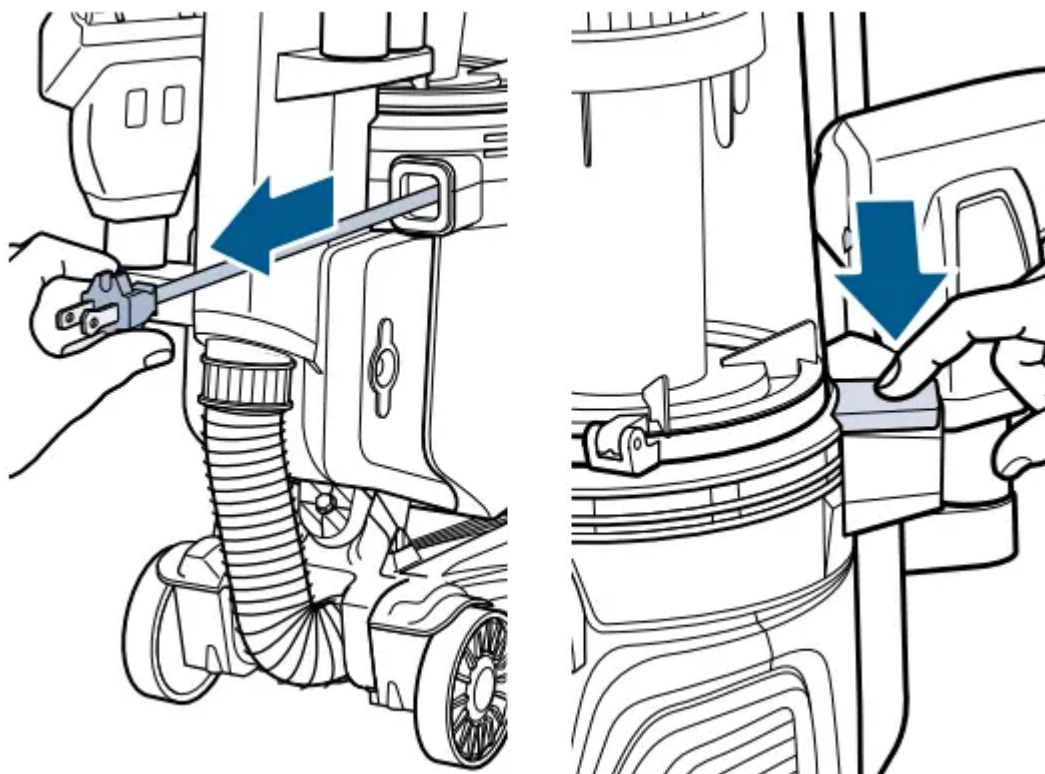

Warning: Hold plug when rewinding onto cord reel. Do not allow plug to whip when rewinding.



Above-Floor Cleaning

Visit support.BISSELL.com to see all the ways you can use your vacuum's tools.

1. Clean hard-to-reach spaces with the Quick Release Extension Wand. Push the release button to remove and attach desired tool.

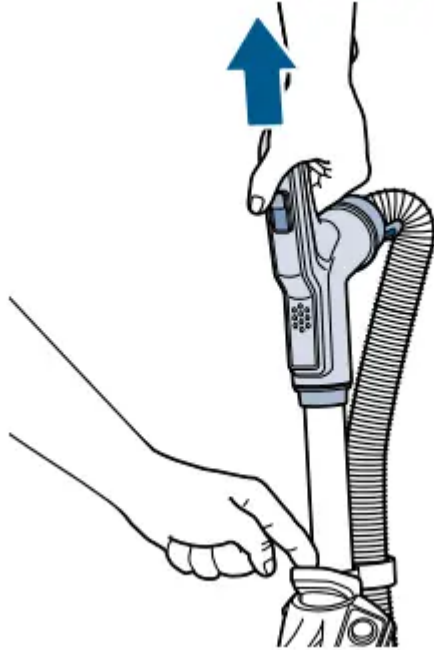

2. The Stretch Hose can be removed from the extension wand. To do so, twist circular hose cuff counter-clockwise and remove from handle.

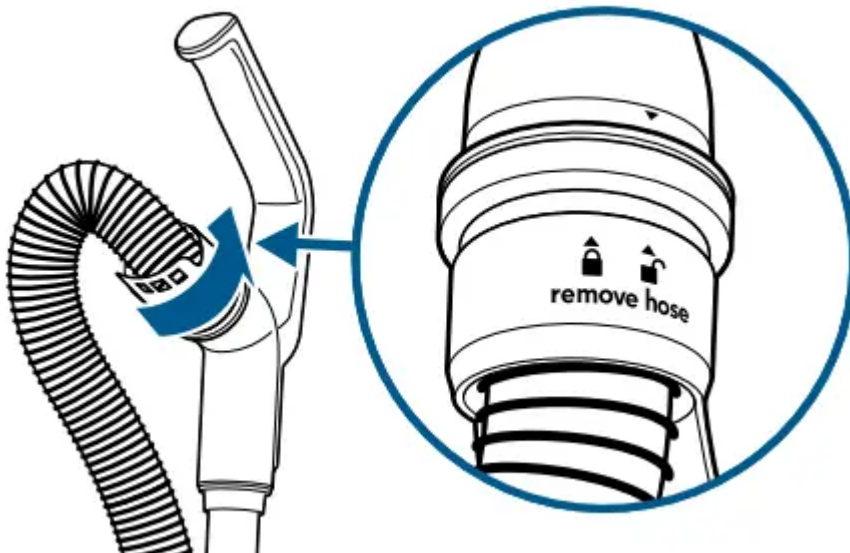

3. When finished, replace the wand back on the vacuum by sliding into place until you hear a “click” and reattach hose to handle if needed.



Emptying the Dirt Tank

For additional maintenance steps, visit support.BISSELL.com.

1. Press the Dirt Tank Release Button and grab the handle to pull the Dirt Tank away from vacuum.

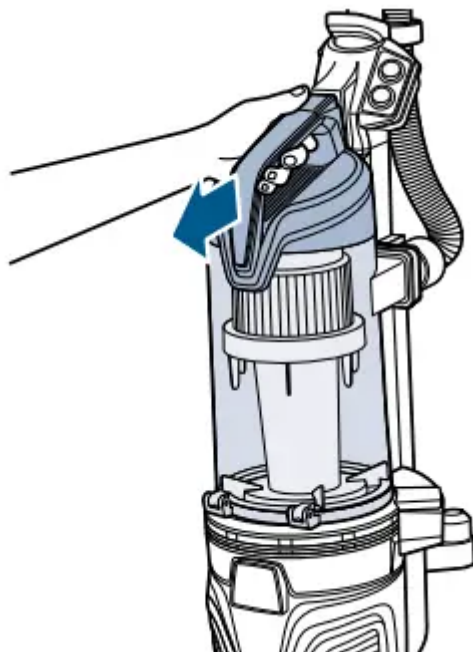

2. Hold the Dirt Tank over a trash bin and press the Empty Button. Once emptied, snap bottom back into place.

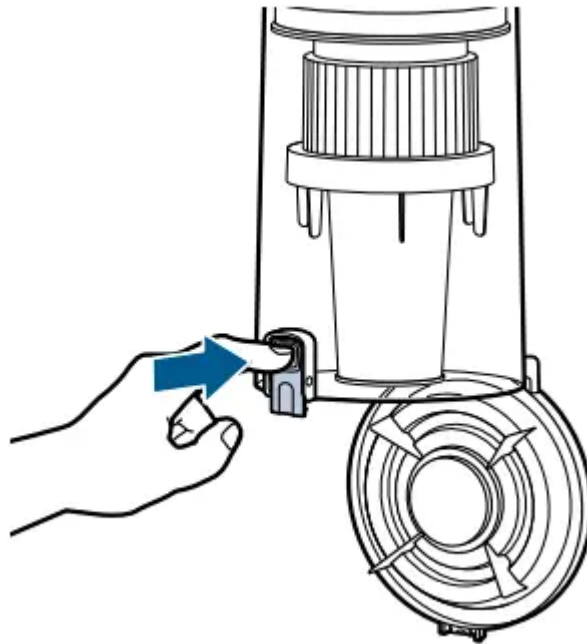

3. Return the Dirt Tank to the vacuum by securing the bottom in place first and then pushing back until you hear a “click”.

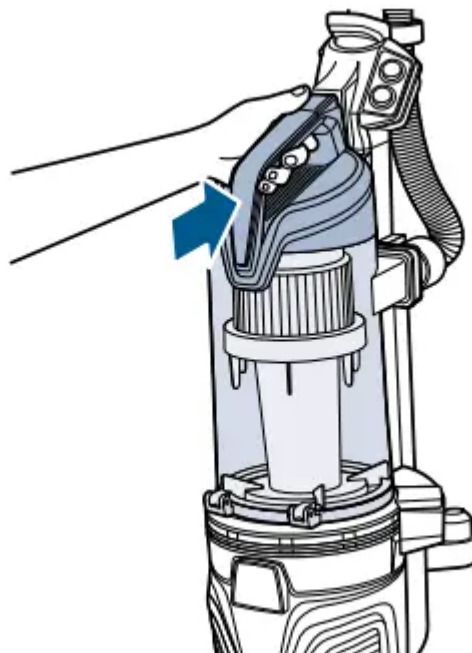

Cleaning the Inner Cyclone Separator

We have additional maintenance videos for your machine on support.BISSELL.com.

1. Hold the Dirt Tank over a trash container. Press the bottom release button to empty.

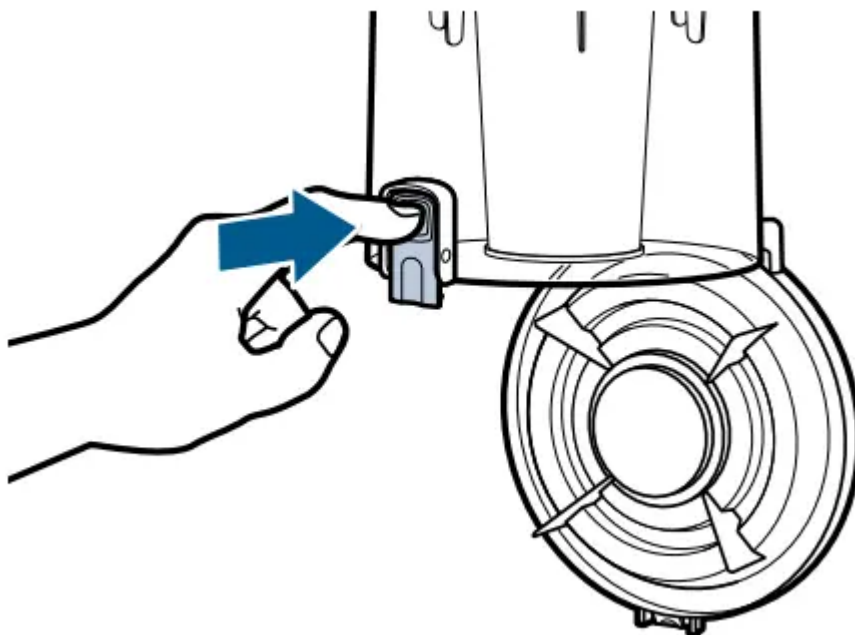

2. Twist Cyclone counter-clockwise and pull down to remove.

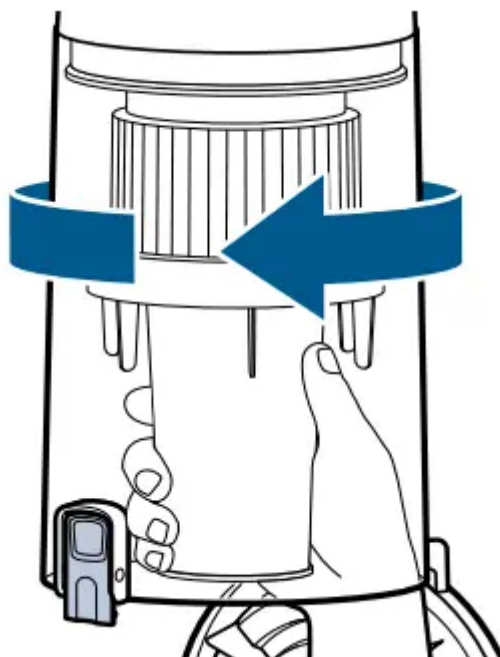

3. Tap separator against inside of trash container and rinse under warm water, if necessary. Be sure to let it dry completely before placing back in Dirt Tank.

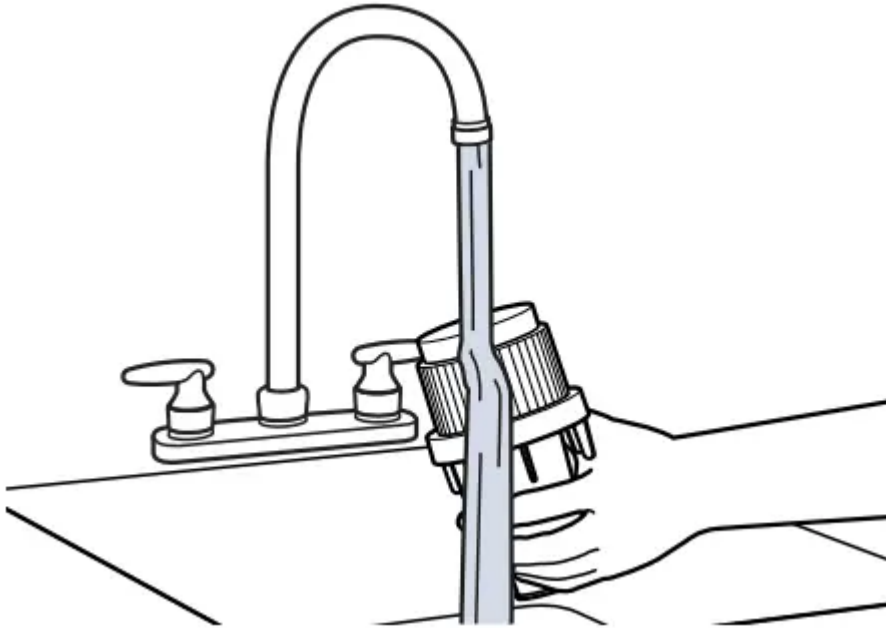

WARNING:

To reduce the risk of electrical shock:

- Turn Power Switch OFF and disconnect polarized plug from electrical outlet before performing maintenance or troubleshooting checks.
- Before using your vacuum, make sure that the Dirt Tank is in locked position and that all filters, both pre- and post-filters, are in place. DO NOT operate your vacuum without these filters.

Cleaning and Replacing the Filters

Visit **BISSELL.com** to find replacement filters.

Pre-Motor Filter

1. Press the Dirt Tank Release Button and pull away from vacuum.

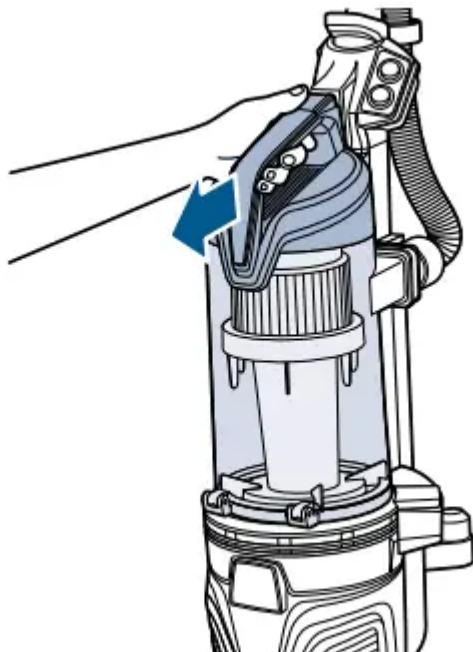

2. Twist tank cover to the unlock position then pull up on handle.

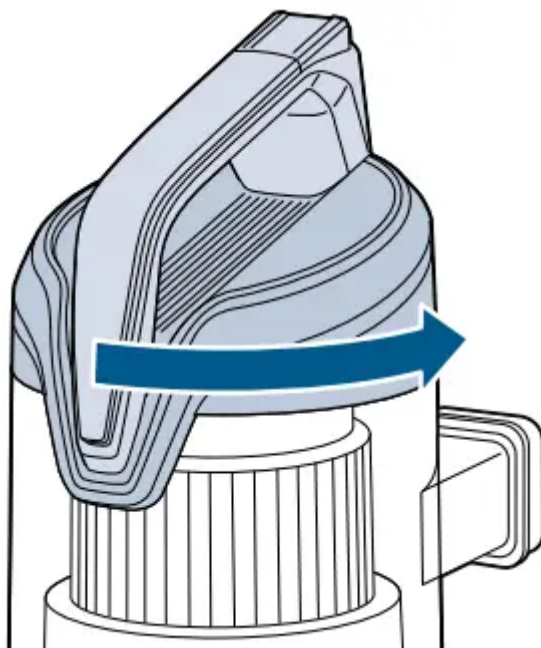

3. Remove Pre-Motor Filter from top of Dirt Tank lid by pulling out.

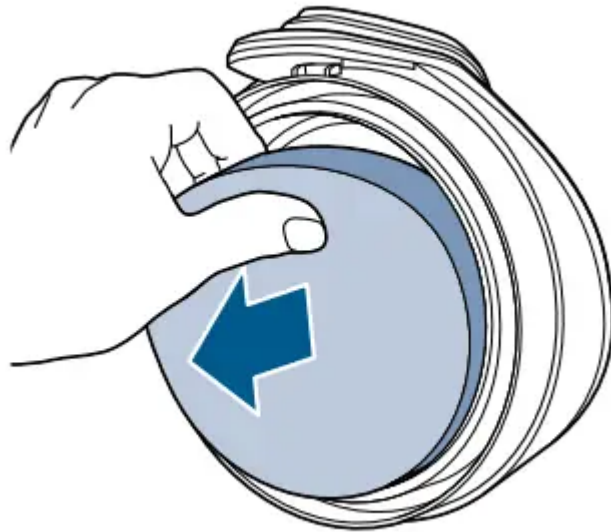

4. Clean with mild detergent, rinse and squeeze all excess water. Allow filters to dry completely before reinserting.



5. Return Pre-Motor Filters to the top of the Dirt Tank, placing the thick foam filter in last.

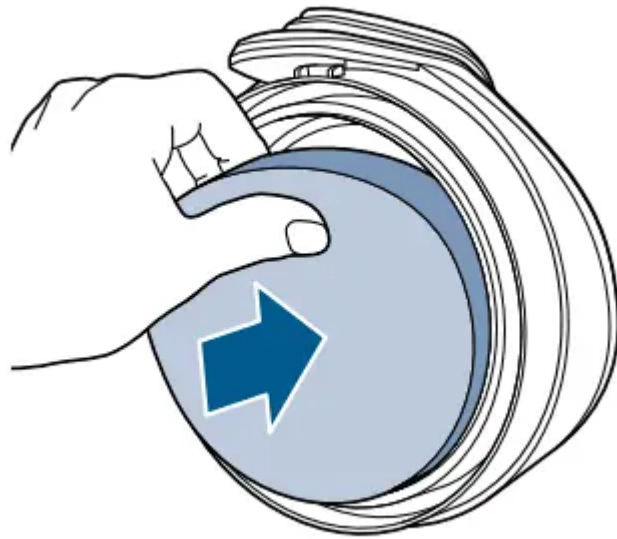

6. Put tank cover back on and twist to lock.

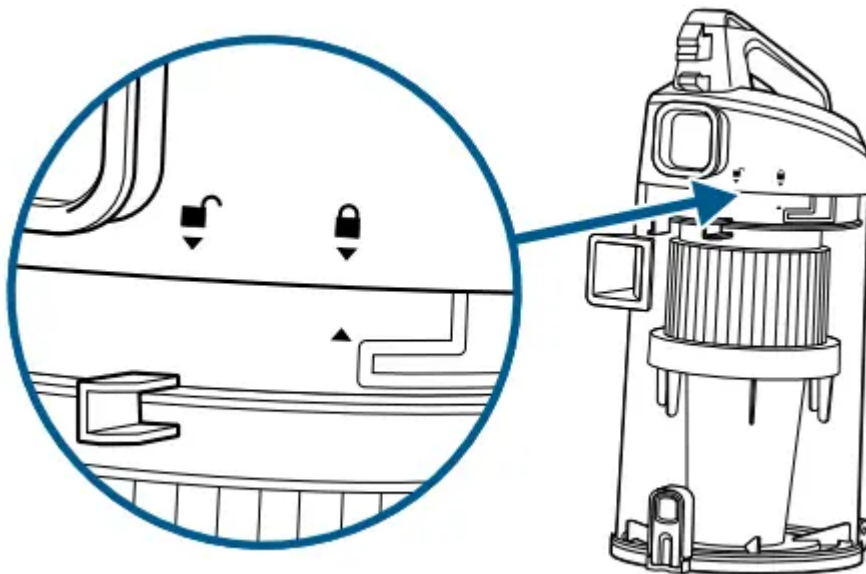

Post-Motor Filter

1. Press down on tab to remove Post-Motor Filter cover

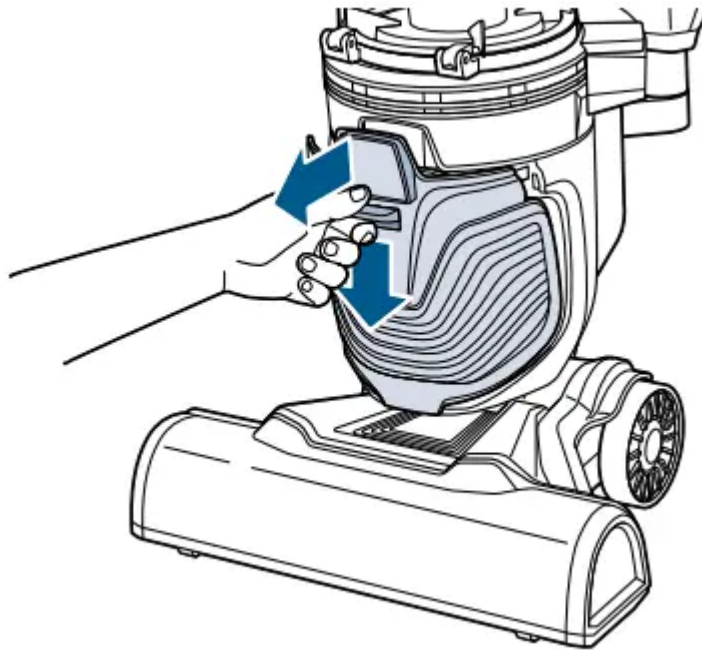

2. Twist filter counter-clockwise to unlock and remove from vacuum.

Remove debris from filter by tapping on the side of a trash container. This pleated filter may NOT be washed.

[IMAGE]

3. When re-assembling, be sure to lock the filter back into place. Reattach the filter cover.

[IMAGE]

WARNING:

To reduce the risk of electrical shock:

- Turn Power Switch OFF and disconnect polarized plug from electrical outlet before performing maintenance or troubleshooting checks.
- Do not operate vacuum with damp or wet filters. Allow components to dry before reassembling the Dirt Tank.

Protecting the Vacuum's Motor

For more assistance with your vacuum's motor protection, visit support.BISSELL.com.

There is an internal thermal protector in your vacuum that protects it from overheating. It controls the main vacuum motor only, not the brush motor. When it activates, the main motor will stop. The front lights and Brush Roll will stay on but there won't be any suction. If this happens, follow these steps:

1. Turn vacuum OFF and unplug from electrical outlet.

2. Check for the source of overheating problem (full Dirt Tank, dirty filters or a clog) and fix by following the steps in the “Vacuum won’t pick up dirt” troubleshooting section.
3. When the motor cools for approximately 30 minutes, the thermal protector automatically resets and cleaning may continue. If the vacuum will not turn ON or the thermal protector continues to activate contact Consumer Care.

Troubleshooting

Below are some of the issues you may run into. If you don’t see the issue you’re experiencing below, visit **support.BISSELL.com**.



Problem	Possible Cause	Remedies
Vacuum is hard to push or pull.	Suction needs adjustment.	Adjust using the Suction Control feature on the handle. See page 6.
Vacuum won't pick up dirt.	<p>There is a clog in the vacuum.</p> <hr/> <p>Filters are dirty.</p> <hr/> <p>Incorrect Suction Control settings.</p>	<p>Remove main hose, run broomstick through to clear.</p> <p>Remove bottom brush cover and clear debris from brush, belt and foot area.</p> <p>Remove lower hose and run broomstick through to clear any clogs.</p> <hr/> <p>Remove and rinse Pre-Motor Filters. Allow enough time for them to dry properly before reinserting. Remove and dust off Post-Motor Filter. See page 10.</p> <hr/> <p>Adjust using the Suction Control feature. See page 6.</p>
Brush Roll doesn't rotate.	<p>Brush Roll Switch is OFF.</p> <hr/> <p>Vacuum is locked in upright position.</p> <hr/> <p>Brush Roll has lodged debris or other entanglements, keeping the brush from rotating.</p>	<p>Make sure Brush Roll Switch is ON.</p> <hr/> <p>Recline vacuum and turn the Brush Roll Switch ON.</p> <hr/> <p>Remove bottom brush cover and clear debris from brush, belt and foot area. To reset brush motor, machine should be unplugged before turning ON.</p>
Loud noise.	Suction relief valve was activated.	Clear any clogs from the upper and lower hose and brush area. Also clean all filters.

WARNING:

To reduce the risk of electrical shock, turn Power Switch OFF and disconnect polarized plug from electrical outlet before performing maintenance or troubleshooting checks.

Warning



This content is compiled from multiple sources and is provided for reference purposes only. It may not be complete or fully applicable to all situations. If you are unable to resolve your issue, please contact the product manufacturer or an authorized service provider for official support.

Document generated by [ManualsFile](#)

