

## Before first use:

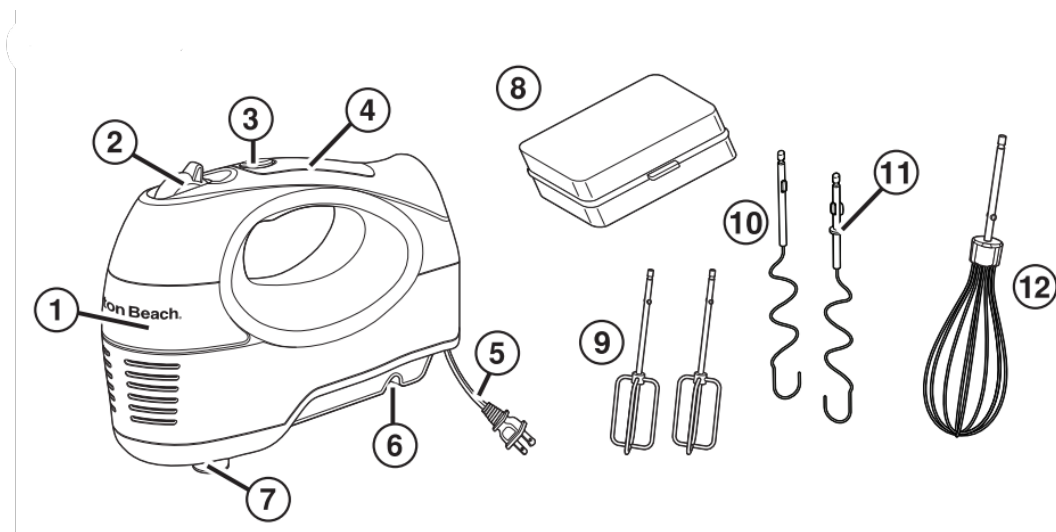



- Remove all packaging materials, labels, and/or stickers from your Hand Mixer.
- Check that all parts are enclosed and that the unit is not damaged.
- Clean the appliance and all accessories. See “Care and Cleaning” section.

## Parts and Features



1. Housing
2. Speed Control/Eject Button
3. BURST Button
4. Handle with Soft-Grip Material
5. Power Plug with Power Cord
6. Bowl Rest™
7. Openings for Attachments
8. Storage Case
9. Beater Attachments
10. Dough Hook Attachments
11. Collar Disc
12. Whisk Attachment

## How to Use Your Mixer

1. Make sure Mixer is unplugged and Speed Control is set to OFF (  ).
2. Insert Beaters or one Whisk into Opening(s) for Attachments. When using Dough Hooks, insert Dough Hook with Collar Disc into opening on right side. Push to click into place.  
**NOTE:** Attachments should be used as a set (2 Beaters, 2 Dough Hooks, or 1 Whisk). Do not mix different Attachments.
3. Plug into outlet. Place Beaters into bowl with ingredients.  
  
**NOTE:** Make sure to turn the Mixer to OFF (  ) before adding any ingredients.
4. Set Speed Control to desired speed, starting at 1 and increasing speed if necessary.
5. When finished mixing, move Speed Control to OFF (  ) and unplug Mixer.
6. To eject Attachments: Set Speed Control to OFF (  ), and unplug Mixer. Hold the Attachments at their stems and press the Eject Button to release the Attachments from the Mixer.

**NOTE:** Always unplug Mixer before attempting to remove Attachments.

### General Mixing Guide

#### SPEED -FUNCTION

 -OFF (Must be OFF  / to eject beaters)

1. LOW speed for folding or mixing in dry ingredients, muffins, or quick breads
2. To cream butter and sugar; most cookie dough
3. MEDIUM speed for most packaged cake mixes
4. Frosting and mashed potatoes; kneading dough
5. Beating egg whites; kneading dough
6. HIGH speed for whipping cream

### BURST Button

Press and hold down the BURST Button for additional power at any speed.

**NOTE:** Do not hold Burst Button down for more than 2 minutes at a time.

### Bowl Rest™

Use the Bowl Rest while adding ingredients or checking a recipe. To use, turn Mixer OFF (  ) and then set the Mixer on the edge of the bowl.

## NOTES:

- Never use Bowl Rest when Mixer is on.
- Do not use Bowl Rest on small or plastic mixing bowls.
- Do not lean Beaters against side of bowl.

## Care and Cleaning

1. Make sure Mixer is unplugged before cleaning.
2. Wash Attachments in hot, soapy water. Rinse and dry. Or, wash in dishwasher, top-rack only. DO NOT use the "SANI" setting when washing in the dishwasher. "SANI" cycle temperatures could damage your product.
3. Wipe Housing with a soft damp cloth or sponge and dry.

**WARNING Electrical Shock Hazard. Disconnect power before cleaning. Do not immerse mixer, cord, or plug in any liquid.**



## NOTES:

- Clean the Mixer after every use. This appliance contains no user-serviceable parts and requires little maintenance. Leave any servicing or repairs to qualified personnel.
- Clean and dry all parts before storing. Store the Mixer in its storage case or in a clean, dry place. Never wrap the power cord around the Mixer.
- Do not use abrasive cleaners or scouring pads.

## IMPORTANT SAFEGUARDS

When using electrical appliances, basic safety precautions should always be followed to reduce the risk of fire, electric shock, and/or injury to persons, including the following:

1. Read all instructions.
2. This appliance is not intended for use by persons with reduced physical, sensory, or mental capabilities, or lack of experience and knowledge, unless they are closely supervised and instructed concerning use of the appliance by a person responsible for their safety.
3. This appliance shall not be used by children. Keep the appliance and its cord out of reach of children.
4. Close supervision is necessary when any appliance is used near children. Children should be supervised to ensure that they do not play with the appliance.
5. To protect against risk of electrical shock, do not put cord, plug, or mixer body in water or other liquid.

6. Turn the appliance OFF (  ), then unplug from outlet when not in use, before putting on or taking off parts, and before cleaning. To unplug, grasp the plug and pull from the outlet. Never pull from the power cord.
7. Avoid contacting moving parts. Keep hands, hair, and clothing, as well as spatulas and other utensils, away from beaters during operation to reduce risk of injury to persons and/or damage to mixer.
8. Remove beaters from mixer before washing.
9. Do not let cord hang over edge of table or counter or touch hot surfaces, including the stove.
10. Do not operate any appliance with a damaged supply cord or plug, or after the appliance malfunctions or has been dropped or damaged in any manner. Supply cord replacement and repairs must be conducted by the manufacturer, its service agent, or similarly qualified persons in order to avoid a hazard. Call the provided customer service number for information on examination, repair, or adjustment.
11. The use of attachments not recommended or sold by the appliance manufacturer for use with this model may cause fire, electric shock, or injury.
12. Do not use outdoors.
13. Do not place on or near a hot gas or electric burner, or in a heated oven.
14. Check that the appliance is OFF (  ) before plugging cord into wall outlet. To disconnect, turn the control to OFF (  ); then remove plug from wall outlet. To unplug, grasp the plug and pull from the outlet. Never pull from the power cord.
15. Do not use appliance for other than intended purpose.
16. **CAUTION!** In order to avoid a hazard due to inadvertent resetting of the thermal cut-out, this appliance must not be supplied through an external switching device, such as a timer, or connected to a circuit that is regularly switched on and off by the utility.

## SAVE THESE INSTRUCTIONS

### Other Consumer Safety Information

**This appliance is intended for household use only.**

**WARNING Electrical Shock Hazard:** This product is provided with a polarized plug (one wide blade) to reduce the risk of electric shock. The plug fits only one way into a polarized outlet. Do not defeat the safety purpose of the plug by modifying the plug in any way or by using an adapter. If the plug does not fit fully into the outlet, reverse the plug. If it still does not fit, have an electrician replace the outlet.

The length of the cord used on this appliance was selected to reduce the hazards of becoming tangled in or tripping over a longer cord. If a longer cord is necessary, an approved extension cord may be used. The electrical rating of the extension cord must be equal to or greater than the rating of the appliance. Care must be taken to arrange the extension cord so that it will not drape over the countertop or tabletop where it can be pulled on by children or accidentally tripped over. w CAUTION Moving Parts Hazard: To reduce the risk of personal injury, always unplug mixer before inserting or removing beaters.

#### **WATTAGE/PEAK POWER INFORMATION**

The marked rating of the hand mixer is determined by Underwriters Laboratories as the maximum stabilized power consumption of the hand mixer at high speed under a loaded condition.

Peak power is an average of the maximum wattage a hand mixer may consume during initial operation at high speed.

#### **Warning**

This content is compiled from multiple sources and is provided for reference purposes only. It may not be complete or fully applicable to all situations. If you are unable to resolve your issue, please contact the product manufacturer or an authorized service provider for official support.