

Overview

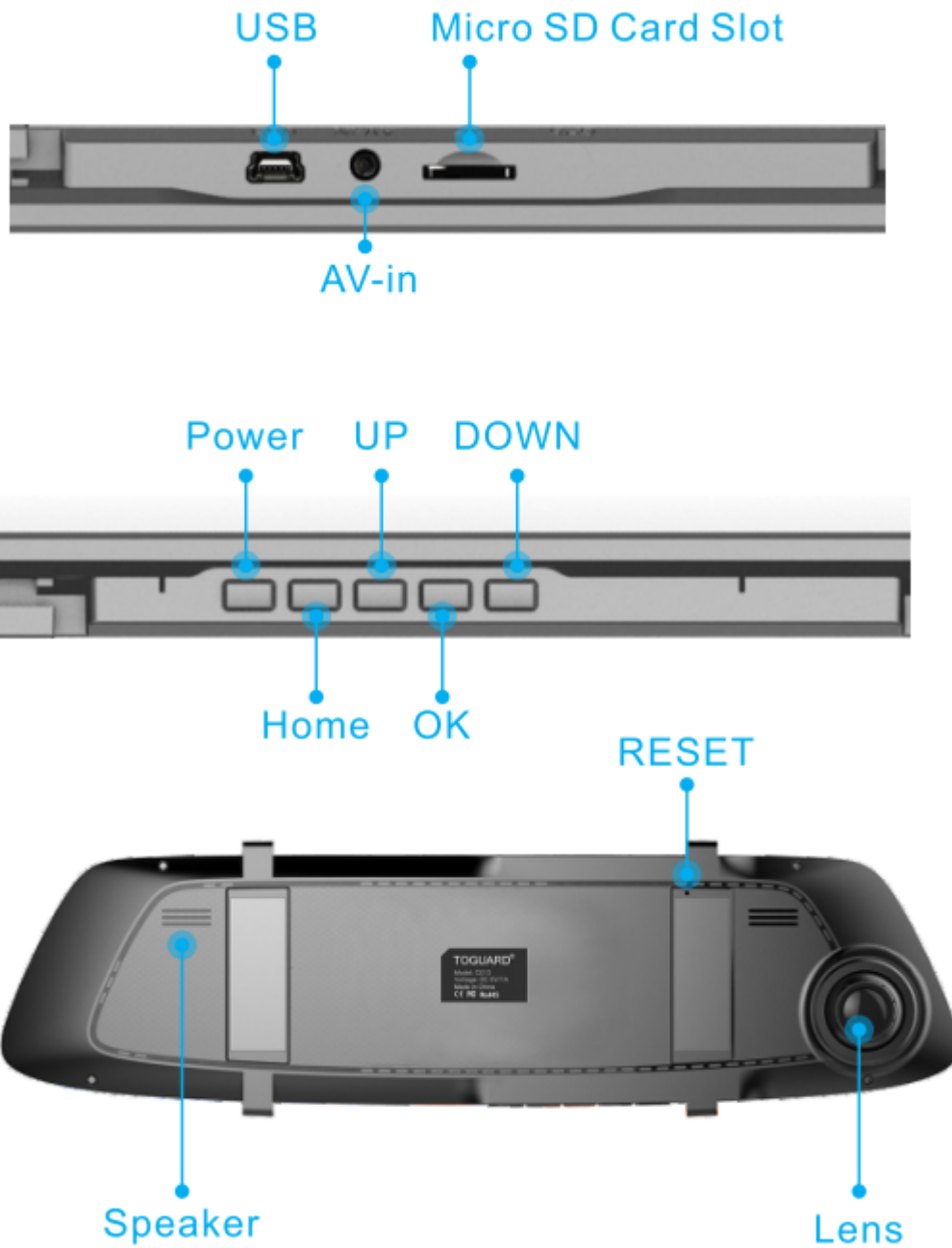

Main Interface and Touch Screen Function

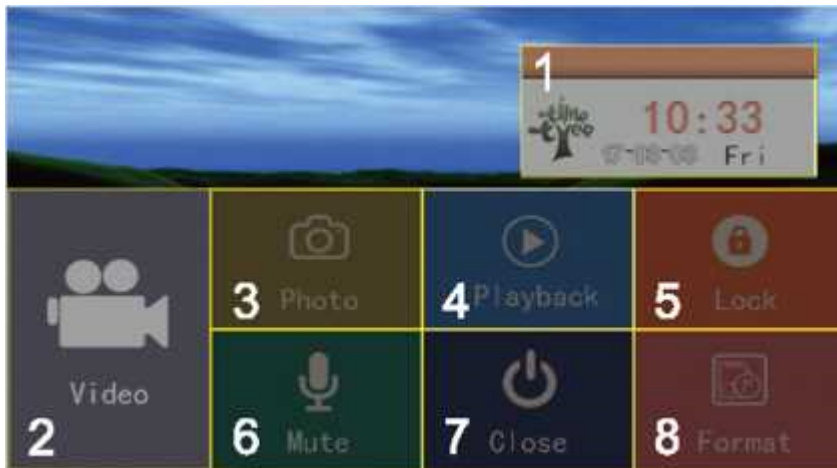

1. Clock/Time Setting
2. Video Recording Mode
3. Photo Mode
4. Playback
5. Manual Lock Current Video
6. Mute Audio Recording
7. Power OFF
8. Format memory card

Set up and Installation:

1. Before installation, please check the camera's normal function, and make sure you are using a high speed Micro SD card (speed Class 10 or above.), and format the card in the camera menu before recording.
2. Mount the camera over the original rearview mirror and use the included rubber rings to fix it, make sure the camera is in place and fasten.
3. Adjust the mirror angle according to your driving position, make sure the mirror is right in place and the view is clear.
4. Adjust the lens angle of the camera, make sure you get best coverage over the hood and the road ahead, so you can record what happens.
5. Connect the power to the camera and the cigarette lighter, hide the rest of the cable in the gap of the Interior trim board.
6. The rear camera should be installed above the number plate, screw pad upward, connect the red power cable to the reverse lamp wire positive lead.

7. Route the camera cable to the front of the car, and connect the rear camera to the main device. There are 2 pictures for reference.



Wiring Method A



Wiring Method B

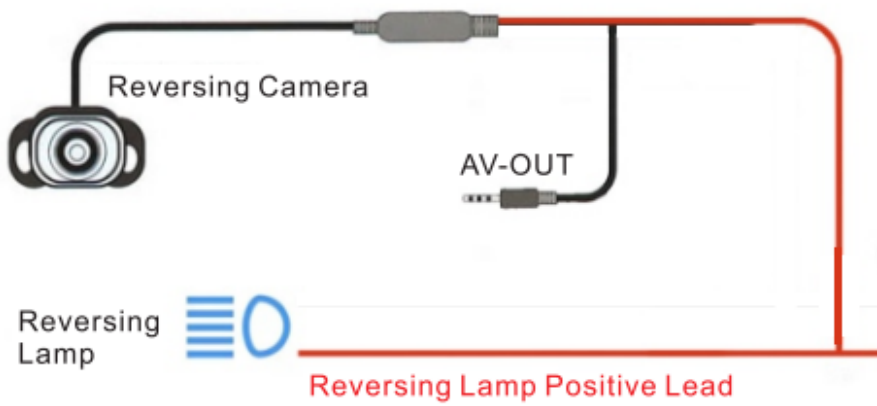

8. Start the engine and have a test run.

Setting Menu and Featured Functions

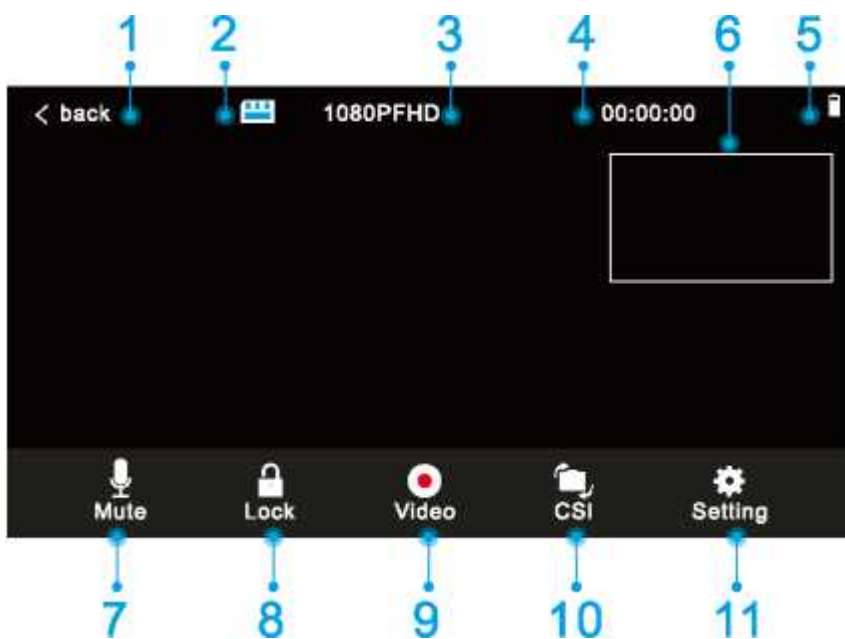

1. Return to Main Interface
2. Memory Card Status
3. Video Resolution
4. Recording Time
5. Power Status
6. Rearview Camera
7. Mute Audio Recording.
8. Manual Lock
9. Start/Stop Recording
10. Picture in Picture Mode Switch
11. Setting Menu

Video Recording Menu:



Resolution: Adjust recording video resolution, 1080P/ 720P/VGA available

Loop Recording: This function allows you to set video file length to 1/2/3minutes, Select a value to activate loop recording, so when storage fills up, it will automatically loop back to the earliest file and record over it.

Enhanced Night Vision: turn on to optimize video quality with wider light range and image details.

Exposure: Adjust exposure value to adjust the brightness of the video.



Date Stamp: Enable/Disable the date and time marks in video files.

Gravity Sensing: G-sensor will detect significant or sudden shock and movement then automatically locks current recording from loop recording, Low/medium/High sensitivity available.

Parking Monitor: It's used to protect your car after parking, with this function on, after you stop the car and the camera turns off, it stays standby, when camera detects shaking, it will automatically turn on and take a short video, then shut down automatically.

Auto Power Off: Set the time for the camera to automatically power to save energy, after the camera is idle for set time, it will power off.



Language : English/French/ Spanish/ German/ Italian/ Russia/Japanese available.

Frequency: Set light frequency to 50Hz or 60Hz, and press OK.

Format: Format the Micro SD card.

Screen Saver: Set the time to automatically turn off the LCD display after no operation.

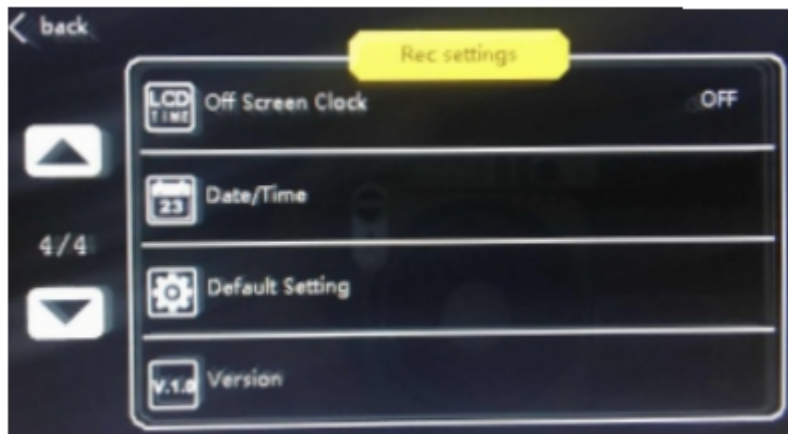

Off Screen Clock: Turn ON/OFF time display after screen saver is activated.

Date/Time: Change the time and date by using the UP and DOWN button, then press OK to confirm.

Default Setting: Reset all settings back to factory default.

Version: Check firmware version.

Photo Mode Interface and Setting Menu

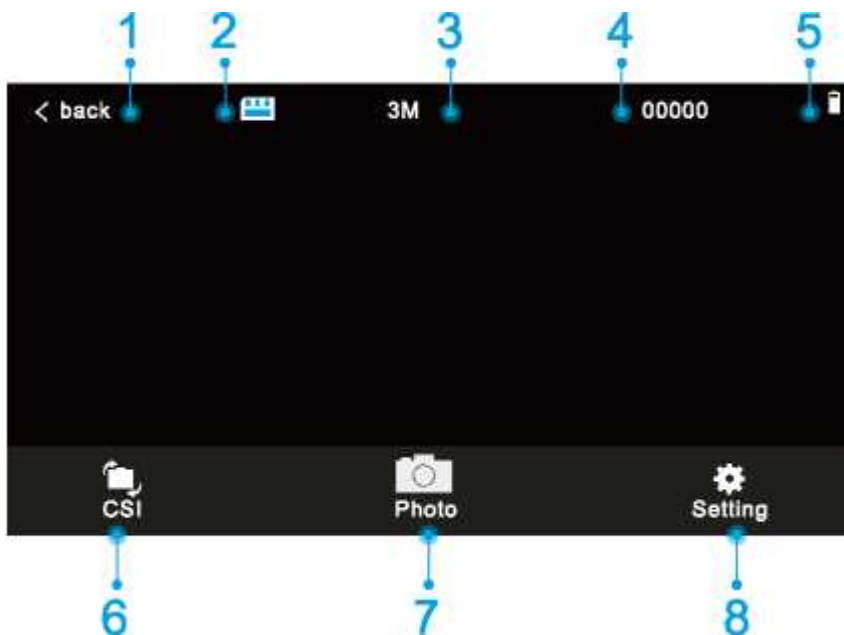

1. Return to Main Interface
2. Memory Card Status
3. Photo Resolution
4. Remaining Storage

5. Power Status
6. Rearview Camera Switch
7. Take Photo
8. Setting Menu



Resolution: Set the photo resolution, Up to 3 Mega Pixels available.

Quality: Defines the quality of image you capture, Fine / Normal / Economy available.

Anti-Shaking: Turn ON/OFF image stabilization function.

Date Stamp: Enable/Disable the date and time marks in image files.

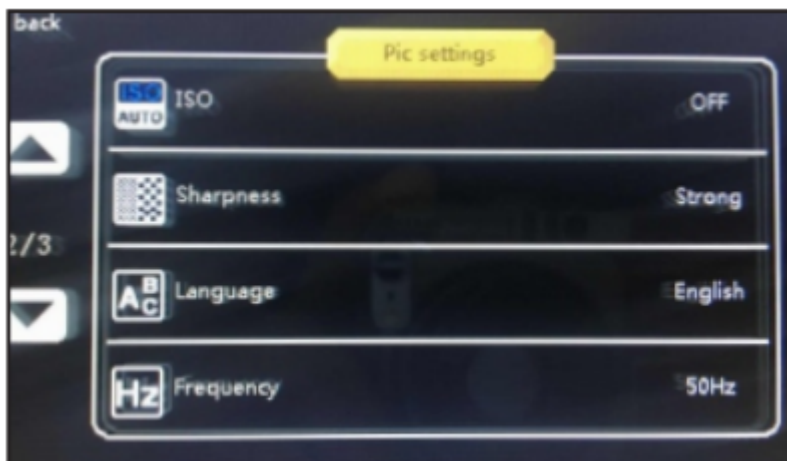

ISO: Adjust ISO value to adjust the brightness of the video.

Sharpness: Defines the clarity of details in the photos.

Language : English/French/ Spanish/ German/ Italian/ Russia/Japanese available.

Frequency: Set light frequency to 50Hz or 60Hz, and press OK.

Common Problems and Solutions:

1. The dash cam will stop automatically when recording. Solution:

- (1) Check whether the memory is full.
- (2) Check whether the loop recording function of the dash cam is working.
- (3) Check whether the Micro SD card is high-speed above C10
- (4) Check the memory card, there might be too many locked video that the loop recording won't work right.

2. If the video played on the computer is somehow not fluent or jammed. There might be some problem with the memory card.

Solution:

- (1) Format your Micro SD card in the camera.
- (2) Change one high quality card

3. There are stripes interference in the image. There should be wrong light frequency.

Solution:

According to the local main frequency, make the appropriate settings 50HZ or 60H

4. When the video play on your computer, the video will pause. Or the video mode is not compatible with the player.

Solution:

- (1) The Micro SD card does not suit for this dash camera, please try with another memory card.
- (2) Use some other media player.

5. Without external power supply, the camera only lasts very short time, or it just can't turn on.

Solution:

The built-in battery is very small for safety reasons, not designed to work alone, so please keep it connected to external power supply.

Specification



Model	Teguard CE13
Image Sensor	High Resolution CMOS Sensor
Screen	4.3 inch LCD Display
Lens	170° High Resolution Wide Angle Lens
Video Resolution(Front):	1920*1080P(Front Lens Only) 1280*720P(Dual Record) VGA
Video Resolution(Rear):	640*480
Video Format:	AVI
Video Mode:	Front Only/ Dual Lens Recording
Picture Format	JPEG
Photo Resolution	3MP/2MP/ 1MP
Loop Recording	OFF / 1mins/2mins/3mins/
Power ON Recording	Supported
G-Sensor Lock	Supported
Audio Recording	Built-in Mic ON/OFF Optional
Storage	Micro SD Card (Upto 32GB)

USB Interface	Mini USB
Internal Power	Built-in Li-ion Battery
External Power	DV 5V/1A
Language:	English/French/Spanish/German/Japanese/ Italian
Opearating Temperature	-10° C~60° C

Warning

This content is compiled from multiple sources and is provided for reference purposes only. It may not be complete or fully applicable to all situations. If you are unable to resolve your issue, please contact the product manufacturer or an authorized service provider for official support.