

Part 1 : Before using the cam

1. Please charge the camera first for about 2 hours with car charger or USB cable.
2. Insert the SD card when the camera is off.



3. The Micro SD card is not included in package. You are suggested to use a class 10, 32GB max SDHC card. Please format the card on computer to FAT32 and KB64 then format again on dash cam before using.

A: How to format on your PC?

- ① Please connect the SD card to the computer by a card reader, or your computer has slot.
- ② Please click the right mount button once and then click "Format".

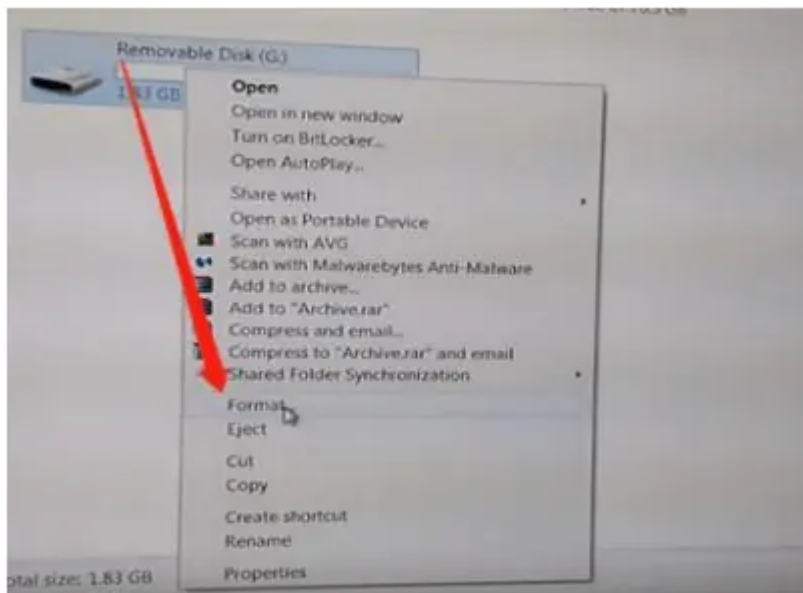

③ Please click “FAT32” and “64 kilobytes” to finish the format.

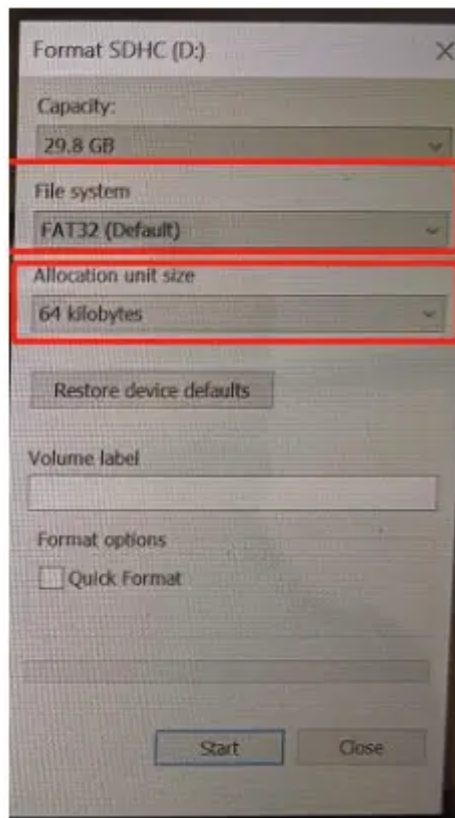

Note: It's better not to click Quick Format to format your Micro SD card.

B: How to format on the camera?

- ① Press and hold the power button for 5 seconds to turn on.
- ② Press “OK” button to stop recording video.

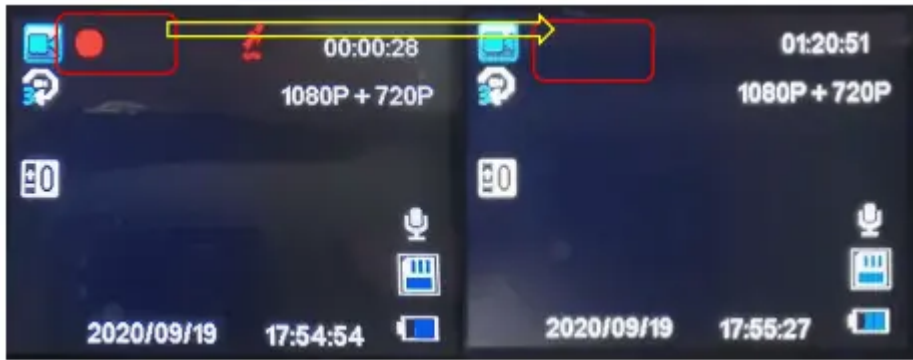

③ press the “M” button twice, and press the “DOWN” button to find the option of Format.



④ Click the “OK” button twice.

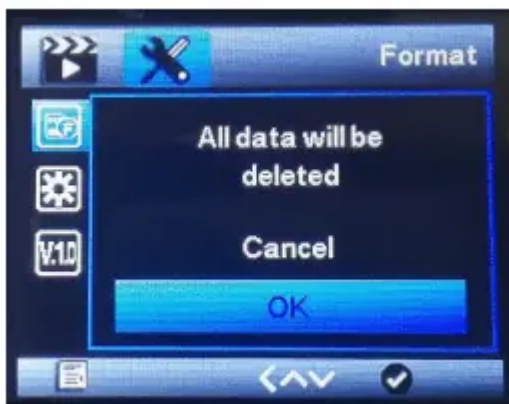

Part 2: Installation of CR750 Dash Cam

- Tear off the film first;
- Clean the windshield, choose a appropriate position to stickthesuction cup;
- Install the power cable;
- Use the crowbar to install the power cable;

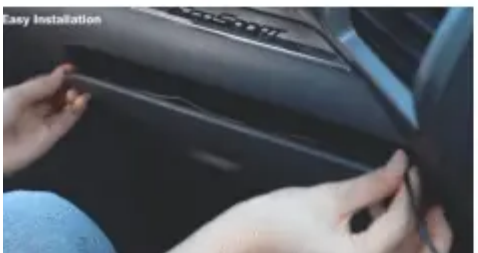
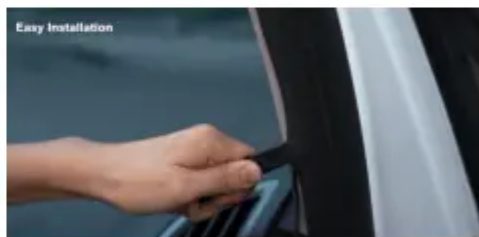
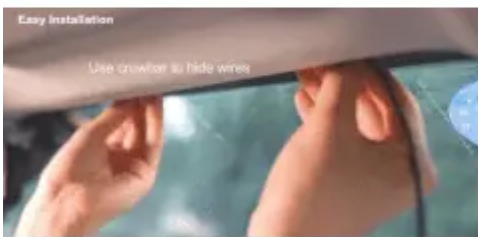

Part 3: Cam warm tips

1. The battery of the cam is only for emergency file back up. External power is required for operation. When recording, charging the dash cam all the time is necessary.
2. If you want the screen stay on all the time, simply turn off the screensaver function on the menu.
3. If you want to achieve long time parking function, hardwire kit is needed. Mini USB port, Voltage:12-24V, Output voltage and current:5V, 2A Warm tip: we suggest that you should choose the hard wire kit which will switch off when the battery volts drop below 11.6 volts, so the cam will not run out of the power in your car battery.
4. It's forbidden to take off SD card when recording, it may cause file corrupted.
5. Avoid exposing your device to excessive cold or heat. Extreme temperatures can damage the device and reduce the charging capacity and life of your device. Your device is recommended for use with in a temperature range of -10 °C to 60 °C (14°F to 140°F).

6. Red light on means the camera charging, blue light blinking means camera recording.

7. We do suggest to turn off Motion Detection features while driving, this function may make recording intermittent. If the video files can be playback normally on the dash cam, but it shows as blank or corrupted on PC, please change a card reader or video player.

8. The USB cable is used to transfer the file or use it worked as a PC camera. Therefore, when using the USB cable to connect it, it will show two options.

"Mass storage" is to transfer the file from camera to computer.

"PC camera" is to use this camera as a pc camera.

9. We provide camera Firmware, such as night vision firmware, image color firmware. Contact our email to get firmware for free.

Please note that we only recommend updating your firmware if you experience issues with your camera. Installing incorrect firmware can damage your device.

10. Crosstour provides FREE camera accessory-suction cup, car charger, 3M sticker. If you need it, please contact our official after-sales team and we'd like to send it to you.

Part 4: Frequent Cam Q&A

Why Dash Cam saying SD Card full? / Dash Cam turn off randomly?

When the dash cam saying " SD card FULL", the dash camera will turn off randomly, which is to remind you format card and need reset the dashcams. As the gravity sensor is sensitive (in order to protect you to save important videos), if you are driving on a relatively bumpy road, the camera may think there is an accident and lock some videos. These locked videos will not be deleted by the loop recording function.

Therefore we recommend:

1. Turn off G sensor, or set G-sensor: Low
2. Turn off motion detection and parking function when you are driving.
3. These two functions will cause the dash cam turn off and turn on when you driving.

Regularly format SD Card every 15 days.

SD card life-span is short. We recommend you can change a new card, which has large capacity

Unable to read storage and can't find the connection device.

1. Change to another USB cable and check whether there is something wrong with the cable.
2. Connect the camera to different computers because some computer systems will prevent the external devices.

How parking monitoring works? What should I do if I want to have permanently parking function? I know that the built-in battery has a low capacity.

1. If you turn on parking function, the camera will automatically turn on when detects unusual vibration and start recording 30 seconds then auto shut off.
2. If you want to achieve long time parking function, please use hardwire kit. A 12V hardwire kit can power your dash cam all the time, and will record when your car is parked.

The specification of hard wire kit needed:

Mini USB port, Voltage:12-24V,

Output voltage and current:5V, 2A

Can the camera work while the screen is closed?

The dash cam has a function "Screensaver", with this function, the dashcam works while the screen is closed in order to save the power of battery

Why I need to manually turn on and turn off my camera?

Your car may equip with long time power supply, the cigarette lighter powered your camera even your car is off, that's why the camera cannot turn on and off automatically. Hardwire kit can solve the issue.

Can the unit be set to display the GPS speed on the screen at all times while driving?

The driving speed cannot show on the machine's screen, but when you watch the video on our designed software, you can see the driving speed.

Can you turn off the speed monitoring?

With GPS function on, this cam will automatically record the speed, longitude and latitude. So if you'd like to turn off the speed monitoring, please turn off the GPS.

How to turn the GPS off:

- 1, turn on the cam;
- 2, press OK button to stop recording;
- 3, press Menu button twice to switch to system setting;
- 4, press Down button to scroll over until you find "GPS";
- 5, press OK button to choose "Off".

Is the GPS a navigation system that will tell me the route when traveling?

No, the GPS just used to exist where you are, and it can not be used as navigation system.

Is this GPS has built in battery?

Yes, there is a very little built-in battery in GPS.



Warning

This content is compiled from multiple sources and is provided for reference purposes only. It may not be complete or fully applicable to all situations. If you are unable to resolve your issue, please contact the product manufacturer or an authorized service provider for official support.

Document generated by [ManualsFile](#)

