

USER GUIDE Jump Starter

Model: Alpha 85S

STEPS TO JUMP START YOUR VEHICLE



1. Insert the jumper cable into the jump starter and connect the clamps to the car battery.
2. "READY" sign shows on the screen.
3. Start your car engine.

ABOUT THE FORCE START FUNCTION:

Why the screen shows nothing when you try to start your car ?

If the screen doesn't display anything when you have correctly connected the clamps to your car, you can use the Force Start Function to enter boost mode.



3 steps to fix your problem:

1. Check the clamps connection and the product's battery is above 20%.
2. Press the Power Button and Flashlight Button simultaneously for 2-3 seconds.
3. The screen will shows "READY", and go back to start engine ignition.

Warning: When using the Force Start Function, auto-detection and safety features will be disabled.

ABOUT THE ERROR CODE:

ERROR CODE	Reason	Solution
	“+”and “-” poles of battery clips reversed.	Reverse the clips and ensure the correct connection.
	The voltage of the car battery is between 2-8V.	Press the Power Button and Flashlight Button simultaneously for 2-3s to start force output. (Force Start Function)
	① The product's operating temperature is too high. (≥113°F) ② Charge the device at extremely low or high temperature.	①Please store it back to where the temperature is between : -40°F-113°F. ②Please charge the device at room temperature.
	Jump start the battery more than 5 times within 10 minutes, the product will automatically enter the safe mode.	The safe mode will be off automatically after 10 minutes waiting. (Please do not turn off the product during the process)

ABOUT USB-A OUTPUT PORT:

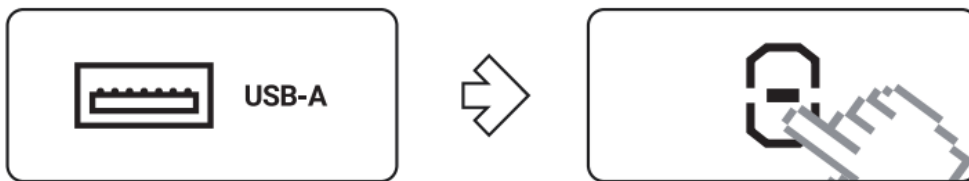

- 1.Plug the cable into the USB-A output port.
- 2.Press the Power Button.

ABOUT 12V DC OUTPUT PORT (MAX 15V/10A):

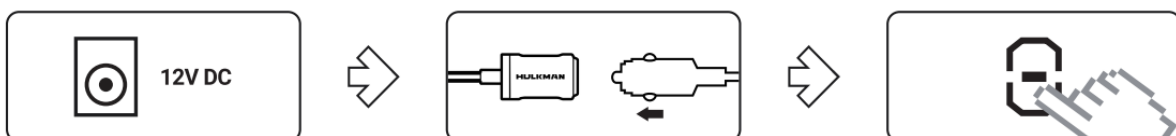

- 1.Plug the 12V cigarette lighter socket adapter into the 12V DC output port.

2.Connect your 12V DC appliances to the cigarette lighter adapter.

3.Press the Power Button.

ABOUT LED FLASHLIGHT:



1.Hold the Flashlight Button for 1-2s.

2.Press briefly to switch the light modes.

- 50% Lumen Light → 100% Lumen Light → White Strobe Light → White SOS Light
→ Red Strobe Light

ABOUT PRE-HEAT TECH:



1.Connect the clamps to the car battery correctly.

2.The Pre-Heat Function will operate automatically and the icon will be displayed on the screen when the detected temperature is below the ideal operating temperature.

3.The screen will show "READY" after preheating , then start your car engine.

Warning

This content is compiled from multiple sources and is provided for reference purposes only. It may not be complete or fully applicable to all situations. If you are unable to resolve your issue, please contact the product manufacturer or an authorized service provider for official support.