

# KEURIG K-Express Essentials ( model: K25 )Use & Care Guide

Get the most from your new Keurig' coffee maker

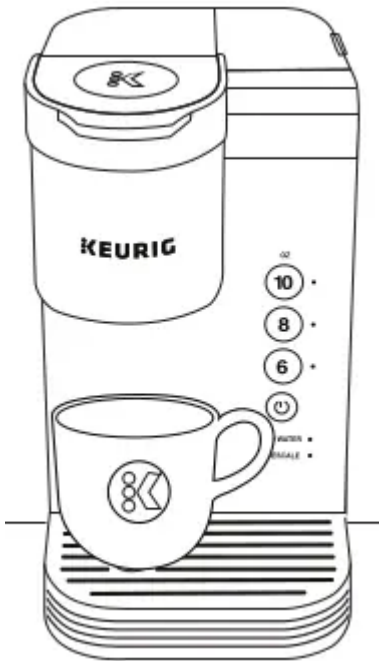

## Before You Brew

### 1. Plug & Place

Remove packing tape from coffee maker. Plug into an outlet.

Place a large mug (296 ml/10 oz minimum) on the drip tray.

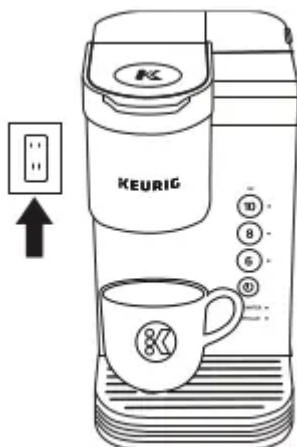

### 2. Rinse & Fill

Remove the water reservoir lid. then lift the reservoir straight up to remove it. If you have aKeurig Water Filter. install it now. Refer to your Water Filter Starter Kit for instructions.

Rinse reservoir with fresh water and fill to the MAX FILL line.

Replace water reservoir, making sure the tank is seated properly in the base. Replace lid

NOTE: Do not use distilled water.



### 3. Lift & Lower

Lift and lower the handle. Do not insert a recyclable\* K-Cup pod.

The coffee maker will power on automatically.

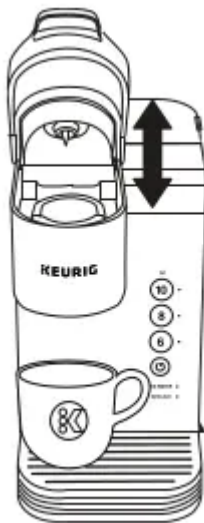

### 4. Cleansing Brew

The 3 cup sizes will blink. Press the 8 oz button to start a cleansing brew. Pour the hot water into the sink

Do not remove the water reservoir or lift the handle once the brew button has been pressed until the brew has completed.

The one-time setup process is now complete and you are ready to brew!

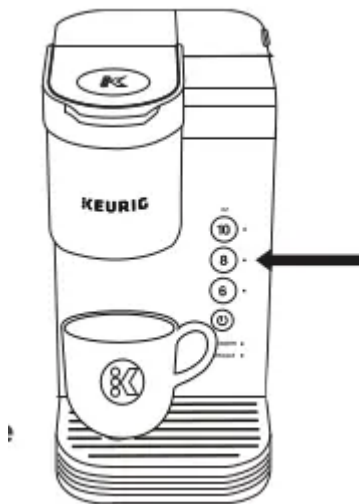

## Brew Your First Cup

### 5. Place Mug & Pod

Place a mug on the drip tray. If using a travel mug, remove the drip tray and place the mug on the drip tray base.

Lift the handle and place a recyclable\* K-Cup pod in the K-Cup pod holder. Lower the handle completely to close the lid

Do not remove the foil lid on the recyclable\* K-Cup pod.

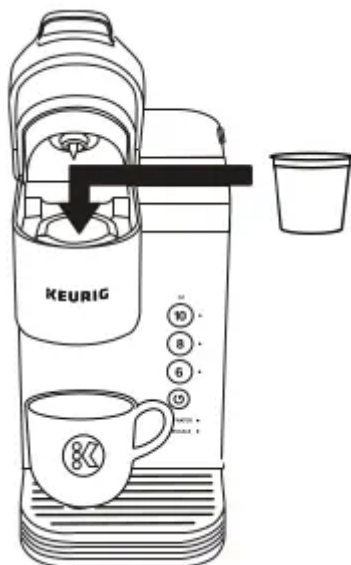

### 6. Brew & Enjoy!

The 3 brew sizes will blink. Select and press your brew size. The light will remain illuminated while brewing. Brewing is complete when the sizes are all illuminated. Lift the handle and recycle the recyclable\* K-Cup pod. (See instructions below.)

CAUTION: While brewing, there is extremely hot water in the K-Cup pod holder. To avoid injury, do not lift the handle during the brewing process.



\* Recyclable in select locations.

## Coffee Maker Features

**FAST & FRESH-BREWED:** Coffee made in minutes.

**BACK-TO-BACK BREWING:** Immediately brew a second cup. no need to wait for reheating.

**TRAVEL MUG FRIENDLY:** Accommodates travel mugs up to 17.8 cm (7") tall

**SIMPLE BUTTON CONTROLS:** Just insert any recyclable\* K-Cup pod and use the button controls to brew a delicious cup.

MAINTENANCE ALERT: Reminds you to descale after every 250 brews.

### **COMPATIBLE WITH THE MY K-CUP UNIVERSAL**

REUSABLE COFFEE FILTER: Brew your own ground coffee (sold separately).

Auto Off automatically turns your coffee maker off 5 minutes after the last brew for energy savings. but will be ready to brew as soon as it is powered on again.

High Altitude To ensure your coffee maker works properly at higher altitudes (1,000 metres/5,000 feet) please enable the High Altitude Brewing Mode on your coffee maker.

1. Begin with the coffee maker plugged in and powered off.
2. Press and hold the POWER button and 8 oz button for 3 seconds. The 10 oz button will illuminate to confirm that the High Altitude Brewing Mode has been enabled.
3. High Altitude Mode will remain enabled until steps 1-2 are repeated and the 10 oz light turns off and the 6 oz light turns on to confirm that the High Altitude Brewing mode is disabled.

HIGH ALTITUDE BREWING: While holding the coffee maker handle up, push down slowly on the recyclable\* K-Cup pod in the pod holder until the bottom of the recyclable\* K-Cup pod is punctured by the exit needle.

## **Caring For Your Coffee Maker**

Regular cleaning keeps your coffee maker running smoothly. Always be sure to turn off and unplug your coffee maker before cleaning

### **Coffee Maker Exterior**

Keep your Keurig coffee maker looking its best by cleaning the exterior from time to time. Just clean with a damp, soapy, lint-free, non-abrasive cloth.

Never immerse the coffee maker in water or other liquids.



### **Drip Tray**

The drip tray overflow should be emptied and cleaned occasionally. To remove, lift up off coffee maker base, keeping it level to avoid spilling. Rinse and clean with a damp, soapy, lint-free, non-abrasive cloth. Hand wash only.



### Water Reservoir

The water reservoir should be cleaned periodically by wiping the inside of the reservoir and underside of the lid with a damp, non-abrasive, lint free cloth. Do not dry the inside of the water reservoir with a cloth as lint may remain. Allow the reservoir to dry completely. Hand wash only.



## Regular Maintenance

For great-tasting coffee, keep your coffee maker running at peak performance by following the recommended maintenance schedule:

Frequency	Product	Benefit
Every 2 months	Keurig® Water Filters	Keeps your water fresh and helps remove impurities
Every 3 months or when the Descale notification turns on*	Keurig® Descaling Solution	Eliminates mineral buildup to preserve the long-term health of your coffee maker

\*To turn off Descale notification, follow the full descaling procedure as outlined in this guide. If the coffee maker has been in storage, or hasn't been used in days, run a cleansing brew before brewing your beverage.

Periodically hand-wash the water reservoir and lid and drip tray with warm soapy water and rinse clean.

CAUTION: Parts are not dishwasher safe.

NOTE: Do not dry the inside of the water reservoir with a cloth as lint may remain.

### **K-Cup Pod Holder Assembly**

To remove the K-Cup pod holder from the coffee maker, lift the handle and grasp the top of the K-Cup pod holder with one hand while pushing up on the bottom of the K-Cup pod holder from underneath with the other until it releases. After cleaning, align the K-Cup pod holder with the opening using the two front ribs as a guide and snap into place from the top.



CAUTION: There are sharp needles that puncture the recyclable K-Cup pad above the K-Cup pod holder and in the bottom of the K-Cup pod holder. To avoid risk of injury, do not put your fingers in the K-Cup pod holder.

NOTE: Always remove and recycle the used recyclable K-Cup pad after brewing.

### **Funnel**

Washing the funnel ensures a fresh beverage experience. The funnel should be washed regularly and can be removed from the K-Cup pod holder by pulling on it until it pops off. To replace it, orient the snaps to the indent and just snap it back onto the K-Cup pod holder.



### **Exit Needle**

Remove the pod holder assembly and detach the funnel. Locate the exit needle on the inside bottom of the K-Cup pod holder. Insert a straightened paper clip into the exit needle to loosen any coffee grounds.

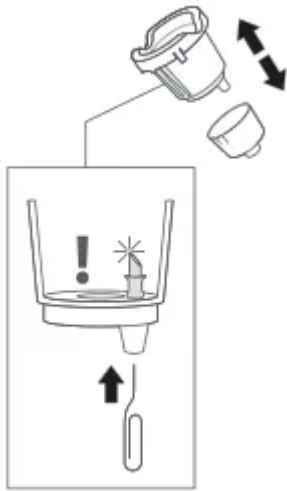

### Entrance Needle

Lift the coffee maker handle and locate the entrance needle on the underside of the lid. To clean the holes in the needle, hold the coffee maker handle in the upward position and with your other hand, carefully insert a straightened paper clip into all the holes. Gently move it around to loosen any coffee grounds. Lower the handle completely and run a cleansing brew two times. Do not insert a recyclable\* K-Cup pod.



## Descaling Procedure

Note: the full descaling procedure must be completed to turn off the Descale light.

You will need: a large ceramic mug (2% ml/10 oz minimum). fresh water. Keurig? Descaling Solution. and access to a sink

Do not use a paper cup. Ensure that there is no beverage pod in the K-Cup pod holder. The descaling procedure takes approximately 20 minutes.

### **STEP 1: Prepare the Coffee Maker**

Pour the entire bottle of Keurig Descaling Solution into an empty water reservoir.

Then. fill the empty bottle with water and pour into the water reservoir.

Then. fill the empty bottle with water and pour into the water reservoir.

Do not insert a recyclable\* K-Cup pod.

Place a large mug on the drip tray.

### **STEP 2: Descale the Coffee Maker**

To activate Descale Mode. begin with the coffee maker plugged in and powered off. then press and hold the 6 oz and 10 oz buttons together for 3 seconds.

When flashing. press the 8 oz button to start the descaling process.

Once the brew is complete. pour the hot liquid into the sink.

Continue to brew 8 oz until the ADD WATER light illuminates.

### **STEP 3: Fresh Water Rinse**

Empty the water reservoir and refill to the MAX fill line with fresh water.

When flashing. press the 8 oz button to start the rinsing process.

Once the brew is complete. pour the hot liquid into the sink.

Continue to brew 8 oz until the DESCALE notification turns off.

The coffee maker has now exited Descale Mode and will be ready for use!

NOTE: The cleaning action of Keurig Descaling Solution may result in a "foam" dispensed from the coffee maker. This is natural. as the solution is reacting with the scale inside. For @ coffee maker that is heavily scaled. the coffee maker may not fill properly after the descaler is added. If this occurs. you may see only a small or no output dispensed. followed by the sound of air blowing out. If this occurs:

+ Turn off and unplug the coffee maker.

+ If there is Keurig Descaling Solution in the water reservoir. discard the contents. rinse the water reservoir thoroughly and refill with water

+ Plug the coffee maker back in. power on. and repeat the Step 3 Fresh Water Rinse cycle.

The coffee maker should begin to function normally as the solution is rinsed out and the scale is removed. If problem persists. allow coffee maker to sit unplugged for at least. 30 minutes before continuing with the rinse.

## Troubleshooting

### Grounds in Your Coffee

Grounds may have gathered in the exit or entrance needles and can be cleaned using a straightened paper clip or similar tool.

- + Clean the exit needle of the K-Cup pod holder. Refer to the Exit Needle care instructions.
- + Clean the coffee maker entrance needle. Refer to the Entrance Needle care instructions.

For optimal enjoyment and to limit grounds in your cup during hot water brews or when transitioning from brewing a coffee pod to a non-coffee pod (i.e. tea or cocoa), clean the exit and entrance needles per the instructions provided and perform 2 cleansing brews

### Coffee Maker Will Not Brew

- + The water level must be at the minimum line to brew. Add an additional 2 oz of water to the reservoir to ensure the minimum fill level has been met. then press the size button. Repeat until the coffee maker begins to dispense.
- + Lift up and replace the reservoir to ensure a secure fit on the base.

### Brewing a Partial Cup

- + Power the coffee maker off. Press and hold the 10 oz button for 5 seconds until water starts dispensing. Then release and let the water purge. Discard the contents into the sink. Press the power button to restart.
- + The exit needle may be clogged. Refer to the Exit Needle care instructions.
- + Clean the K-Cup Pod Holder. see K-Cup Pod Holder care instructions.
- + The coffee maker may need to be descaled. If you have repeated the descale procedure on your coffee maker two times and it is still only brewing a partial cup. contact Customer Service.

### Coffee Maker Does Not Have Power or Shuts Off

- + Make sure that the power button has been turned on.
- + Plug the coffee maker into its own outlet. If the electric circuit is overloaded with other appliances. your coffee maker may not function properly. The coffee maker should be operated on its own circuit. separate from other appliances.
- + For energy savings. the coffee maker automatically turns off 5 minutes after the last brew. Press the power button to restart.
- + If the coffee maker still doesn't have power. contact Customer Service.

### Helpful Hints

Water quality varies greatly. If you notice an undesirable taste in your beverage (such as chlorine or mineral tastes), we recommend using bottled or filtered water. Do not use distilled water.

## Service

Beyond these recommended cleaning and maintenance procedures, this coffee maker is not user serviceable. For service, please refer to the Warranty section of this guide.

## Storage

Empty the water reservoir before storing or transporting and take care to ensure that you store your coffee maker in a safe and frost-free environment. When you prepare to use it after storage, we recommend rinsing the water reservoir with fresh water and descaling the coffee maker as detailed in the Descaling your Coffee Maker section.

If you plan to move your coffee maker to a different location, turn the coffee maker off, unplug it, and empty the water reservoir. If your coffee maker has been in an environment below freezing, please be sure to let it warm to room temperature for at least 2 hours before using.

## Contact Keurig

Website: [keurig.ca/support\\_1](http://keurig.ca/support_1)

Call: 1-800-361-5628

## K Express Essentials SINGLE SERVE COFFEE MAKER

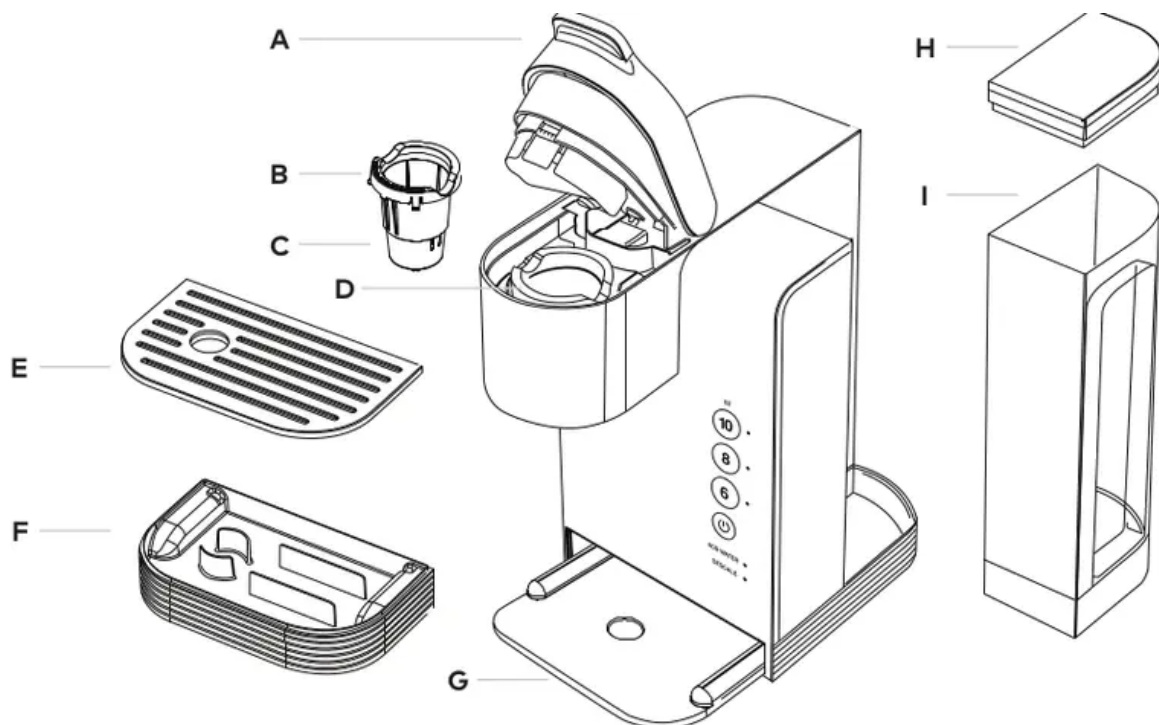

## K Express Essentials SINGLE SERVE COFFEE MAKER

- A. Handle
- B. K-Cup Pod Holder (Band C are the K-Cup Pod Holder Assembly)
- C. Funnel
- D. K-Cup Pod Assembly Housing
- E. Drip Tray Plate
- F. Drip Tray
- G. Drip Tray Base
- H. Water Reservoir Lid
- I. Water Reservoir

Document: DC0000008326 REV A

### **Warning**

This content is compiled from multiple sources and is provided for reference purposes only. It may not be complete or fully applicable to all situations. If you are unable to resolve your issue, please contact the product manufacturer or an authorized service provider for official support.

---

Document generated by [ManualsFile](#)