

PROGRAMMING

PROGRAM TO GARAGE DOOR OPENERS WITH A YELLOW LEARN BUTTON

If your remote was previously programmed to another type of opener, see PROGRAM TO COMPATIBLE GARAGE DOOR OPENERS AND OPERATORS fo reprogram to a yellow LEARN button.

1. Start withthe garage door closed.
2. Press andimmediately release the yellow LEARN button. The Learn LED glows steady for 30 seconds.

Within 30 seconds...

3. Press and hold the button on the remote control you wish to use.
4. Release the button when the garage door opener lights blink or two clicks are heard.
5. Test by pressing the button you just programmed. The opener activates.

To program the remote to Chamberlain accessories, refer to the manual provided with the accessory.

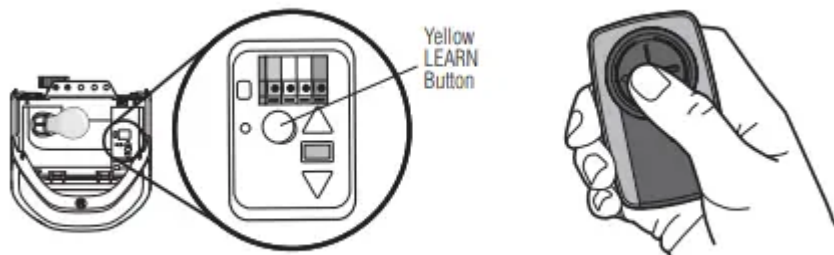

PROGRAM TO COMPATIBLE GARAGE DOOR OPENERS AND OPERATORS

1. Start with your garage door, gate, or commercial door closed.
2. Remove the remote control cover. Press and hold the program button until the LED turns on.
3. Press and release the SMART/LEARN button on your product or match the remote control DIP SWITCHES to the existing receiver or existing remote control.
4. Selecta button to program on the remote control. Press and release the button the specified number of times according to the following list. NOTE: Make sure the LED stops flashing between each press of the button. The garage door opener will respond by clicking, blinking or activating.

... 8 times Chamberlain®* Yellow Button 2011- Current

... 3 times Chamberlain®* Purple Button 2005- Current

... 2 times Chamberlain®* Orange Button 1997-2005

- ... 4 times Chamberlain®* Green Button 1993-1996
- .. 6 times Genie Overhead Door® Intellicode 1995-Current
- ... 5 times Genie Overhead Door®** Intellicode 2005-Current
- ...1time Linear® Mega- Code 1997-Current
- ... 7 times Stanely® Security Code 1998
- ... 9 times Wayne Dalton® Rolling Code 372.5 MHz 1999-Current
- ... 14 times Linear Multicode® 10 Position Dip Switch
- .. 16 times Stanley Multicode® 10 Position Dip Switch
- ... 18 times Linear® 8 Position Dip Switch
- .. 10 times Xtreme Garage®, Guardian® Black Button 2005- Current
- .. 11 times Sommer® Black Button 1998- Current

* LiftMaster, Do-It, Master Mechanic, Raynor, True Value and Sears Craftsman are compatible with Chamberlain technology.

** Find Genie intellicode II instructions at support.chamberlaingroup.com.

5. Press the program button on the remote control to save.

6. Test by pressing the button you just programmed. The opener activates.

To program the remote to Chamberlain accessories, refer to the manual provided with the accessory.



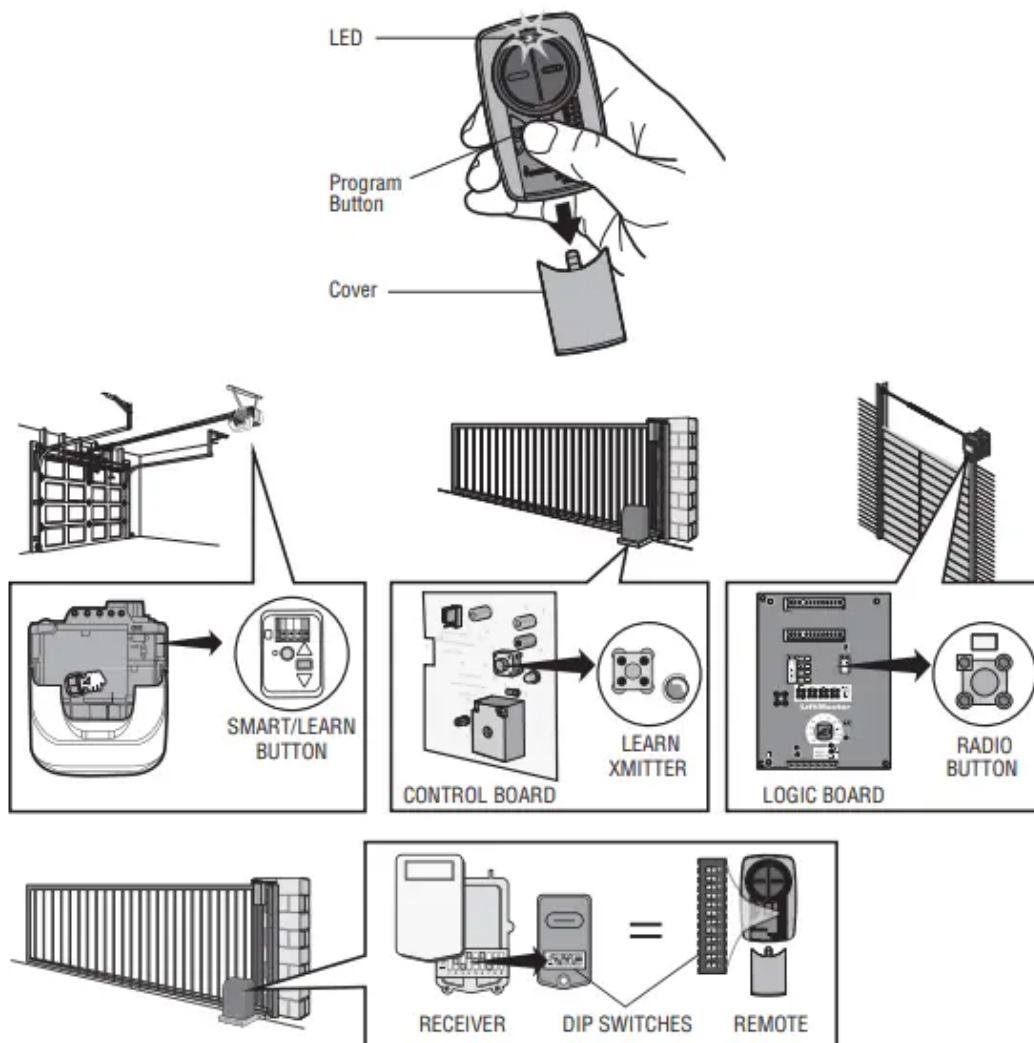

- The SMART/LEARN button or DIP SWITCHES are located either on the product or in an external receiver on or near the product. Consult your product owner's manual to locate the SMART/LEARN button or DIP SWITCHES.
- If you have a 2 position DIP SWITCH and programming fails, reverse DIP SWITCHES (OFF to ON and ON to OFF).

BATTERY

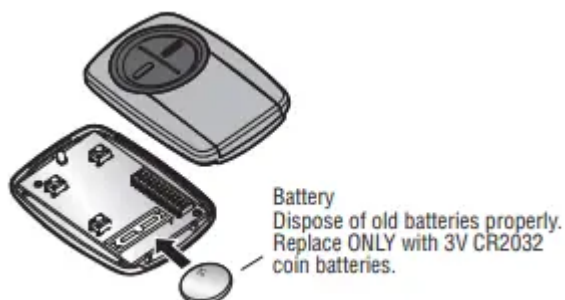

NOTICE: This device complies with part 15 of the FCC rules and Innovation, Science and Economic Development Canada license-exempt RSSs. Operation is subject to the following two conditions: (1) this device may not cause harmful interference, and (2) this device must accept any interference received, including interference that may cause undesired operation. Any changes or modifications not expressly approved by the party responsible for compliance could void the user's authority to operate the equipment.

This device has been tested and found to comply with the limits for a Class B digital device, pursuant to part 15 of the FCC rules and Industry Canada ICES standard. These limits are designed to provide reasonable protection against harmful interference in a residential installation. This equipment generates, uses and can radiate radio frequency energy and, if not installed and used in accordance with the instructions, may cause harmful interference to radio communications. However, there is no guarantee that interference will not occur in a particular installation. If this equipment does cause harmful interference to radio or television reception, which can be determined by turning the equipment off and on, the user is encouraged to try to correct the interference by one or more of the following measures:

- Reorient or relocate the receiving antenna.
- Increase the separation between the equipment and receiver.
- Connect the equipment into an outlet on a circuit different from that to which the receiver is connected.
- Consult the dealer or an experienced radio/TV technician for help.

Warning

This content is compiled from multiple sources and is provided for reference purposes only. It may not be complete or fully applicable to all situations. If you are unable to resolve your issue, please contact the product manufacturer or an authorized service provider for official support.