

## Before You Brew

### 1. Plug & Place

Remove packing tape from brewer and plug into a grounded outlet.

Place a large mug (12oz. minimum) on the drip tray plate.

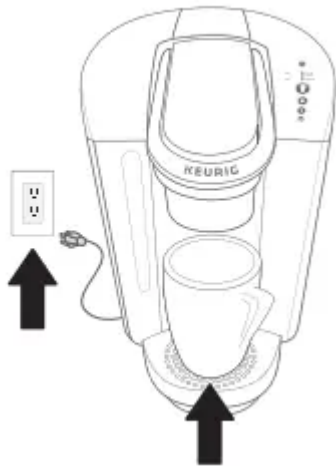

### 2. Rinse & Fill

Remove the water reservoir lid, then lift the reservoir straight up to remove it.

If you have a Keurig® Water Filter, install it now. Refer to your Water Filter Starter Kit for instructions. Rinse reservoir with fresh water and fill to the MAX fill line.

Replace water reservoir, making sure the lock tab engages with the brewer. Replace lid.

**NOTE: Do not use distilled water.**



### 3. Power On

Press power button — the green power light and Auto Off light will illuminate.

The brewer will automatically begin heating the water. This will take about 3 minutes. Once the heating sound stops, the brewer is ready.

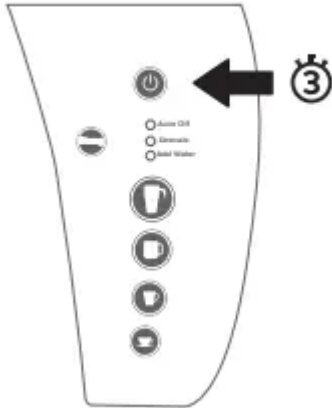

### 4. Lift & Lower

Lift and lower the handle. Do not insert a K-Cup® pod. The four brew buttons and the Strong button will blink.

Press the small cup button to start a cleansing brew. Pour the hot water into the sink.

The one-time setup process is now complete and you are ready to brew!



## Brew Your First Cup

### 5. Place Mug

Place a mug on the drip tray plate. If using a travel mug, remove the drip tray and place the mug on the drip tray base.

**NOTE:** Between brew cycles, the brewer may take about a minute to reheat.

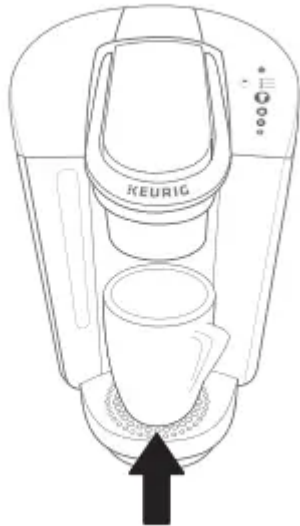

## 6. Lift & Insert

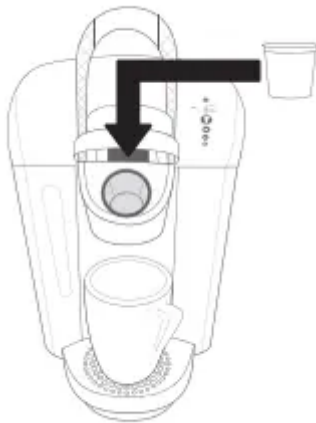

Lift the handle and place a K-Cup® pod in the K-Cup® pod holder. Lower the handle completely to close the lid.

**Do not remove the foil lid on the K-Cup® pod.**

## 7. Brew & Enjoy



Select your brew size – for bolder coffee, press the Strong button before selecting your brew size. The brew size and Strong button, if selected, will remain illuminated while brewing – about 1 minute.

The brewer will be ready to brew another cup in about a minute.

**NOTE:** After 60 seconds, the brew buttons will be disabled. To re-activate, lift and lower the handle completely.

**CAUTION:** While brewing, there is extremely hot water in the K-Cup® pod holder. To avoid injury, do not lift the handle during the brewing process.

## Brewer Features

Strong Brew kicks up your coffee's strength and intensity. For bolder coffee, press the Strong button before selecting your brew size.

Smart Start heats then brews in one simple process. No need to wait for the brewer to heat before selecting brew size. Power on your brewer, place mug, insert a K-Cup® pod, and lower the handle. Then, select your brew size. The brewer will heat, then automatically begin brewing.

Auto Off automatically turns your brewer off 2 hours after the last brew for energy savings.

To disable the Auto Off feature:

1. Power the brewer off while it is plugged in.
2. Press and hold the Strong and the 10oz. Large Mug buttons for 3 seconds – the green Auto Off light will turn off.
3. Power the brewer on – the green Auto Off light will no longer be illuminated.

To enable the Auto Off feature, repeat steps 1-3. The green Auto Off light will illuminate

High Altitude Brewing: To ensure your brewer works properly at higher altitudes (5,000 feet) please follow these brewing instructions and enable the High Altitude Brewing Mode on your brewer.

Brewing Instructions - While holding the brewer handle up, push down slowly on the K-Cup® pod in the pod holder until the bottom of the K-Cup® pod is punctured by the exit needle.

To enable High Altitude Brewing Mode:

1. Power the brewer off while it is plugged in.
2. Press and hold the Strong and 8oz. Small Mug buttons for 3 seconds- both lights will blink 3 times to confirm that the High Altitude Brewing Mode has been enabled.

To disable High Altitude Brewing Mode:

1. Power the brewer off while it is plugged in.
2. Press and hold the Strong and 8oz. Small Mug buttons until the lights are no longer illuminated.

## Caring for your Brewer

Regular cleaning keeps your brewer running smoothly. Always be sure to turn off and unplug your brewer before cleaning.

### Brewer Exterior

Keep your Keurig® brewer looking its best by cleaning the exterior from time to time. Just clean with a damp, soapy, lint-free, non-abrasive cloth. Never immerse the brewer in water or other liquids.

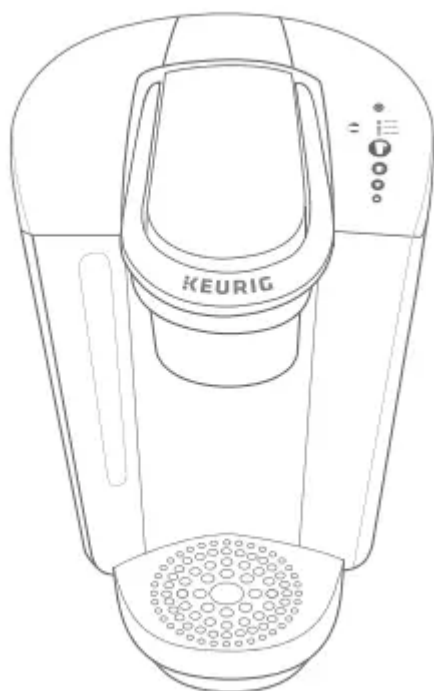

## Drip Tray

The drip tray can hold up to 8 ounces of overflow and should be emptied and cleaned occasionally. To remove, slide it toward you, keeping it level to avoid spilling. Clean in dishwasher (top rack only) or rinse and clean with a damp, soapy, lint-free, non-abrasive cloth.

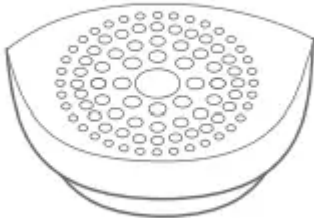

## Water Reservoir & Reservoir Lid

The water reservoir lid and water reservoir should be cleaned periodically. Clean in a dishwasher (top rack only) or hand wash. To hand wash, use a damp, soapy, nonabrasive cloth. Rinse the reservoir thoroughly after cleaning. This will ensure that no cleaning solutions remain in the area as they may contaminate the water supply. After rinsing, fill the reservoir with clean water and return it to the brewer. Do not dry the inside of the water reservoir with a cloth as lint may remain. If needed, repeat above procedures.

**NOTE: If you are using a water filter inside the water reservoir, remove it before cleaning.**

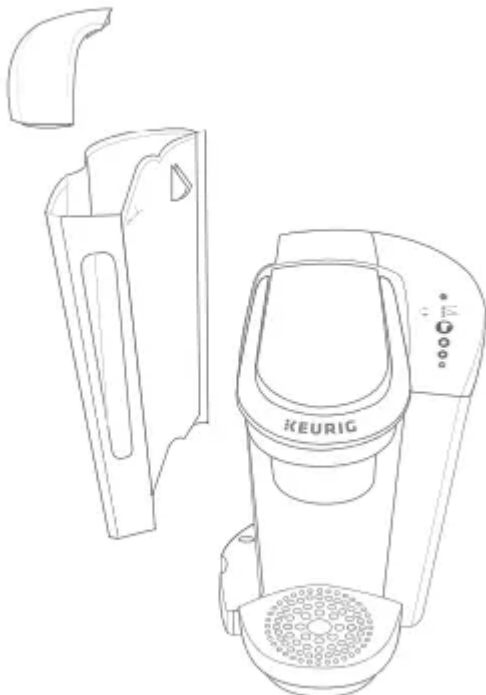

## K-Cup® Pod Holder

To remove the K-Cup® pod holder from the brewer, lift the handle and grasp the top of the K-Cup® pod holder with one hand while pushing up on the bottom of the K-Cup® pod holder from underneath with the other until it releases. After cleaning, align the K-Cup® pod holder with the opening using the two front ribs as a guide and snap into place from the top.

**CAUTION:** There are sharp needles that puncture the K-Cup® pod above the K-Cup® pod holder and in the bottom of the K-Cup® pod holder. To avoid risk of injury, do not put your fingers in the K-Cup® pod holder.

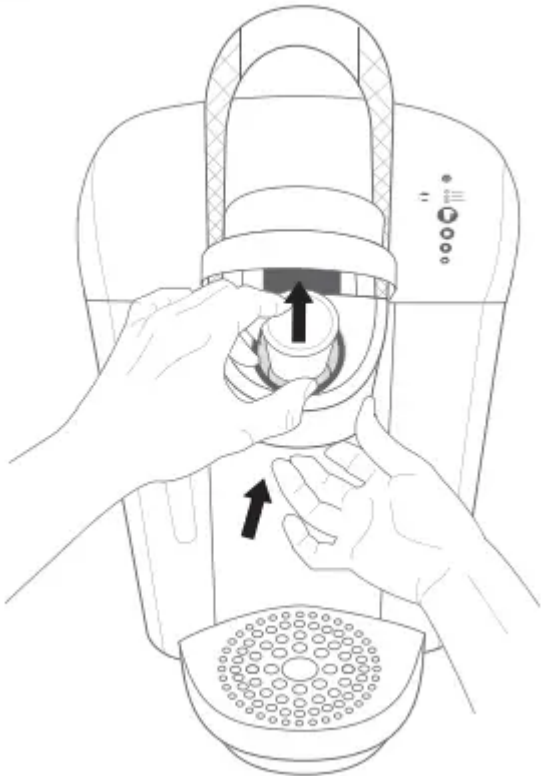

## Funnel

The funnel can be removed from the K-Cup® pod holder by pulling on it until it pops off. To replace it, just snap it back onto the K-Cup® pod holder.

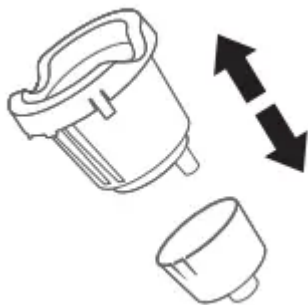

## Exit Needle

Remove the pod holder assembly and detach the funnel. Locate the exit needle on the inside bottom of the K-Cup® pod holder. Insert a straightened paper clip into the exit needle to loosen the clog and push it out.

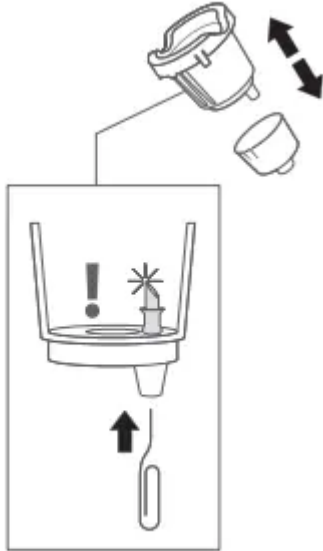

## Entrance Needle

Lift the brewer handle and locate the entrance needle on the underside of the lid. To clean both holes in the needle, hold the brewer handle in the upward position and with your other hand, carefully insert a straightened paper clip into both holes. Gently move it around to loosen any coffee grounds. Lower the handle completely and run two water-only brew cycles. Do not insert a K-Cup® pod.

**TIP:** Refer to [support.Keurig.com](http://support.Keurig.com) for video instructions on cleaning the entrance/exit needles.

## Descaling your Brewer

You should descale your brewer every 3-6 months. Properly follow the descaling procedure.

Depending on the mineral content of your water, calcium deposits or scale may build up in your brewer. Scale is nontoxic but if left unattended can hinder brewer performance. Regularly descaling your brewer every 3-6 months helps maintain the heating element, and other internal parts that come in contact with water. Calcium deposits may build up faster, making it necessary to descale more often.

## Descaling Procedure

Before you begin, you will need a large ceramic mug, fresh water, Keurig® Descaling Solution, and access to a sink. Do not use a paper cup. Ensure that there is no beverage pod in the K-Cup® pod holder. Please allow approximately 45 minutes for the descaling procedure.

Empty the water from the water reservoir. If using a Keurig® Water Filter, remove and set aside.

### STEP 1: Descaling Solution Rinse

Press the power button to power the brewer off. Pour the entire bottle of Keurig® Descaling Solution into an emptied water reservoir. Then fill the empty bottle with water and pour into the water reservoir. Press the power button to turn the brewer back on.

Place a large mug on the drip tray and run a rinsing brew by lifting and lowering the handle and selecting the largest brew size.

### STEP 2: Descaling Rinse & Repeat

Repeat the rinsing brew process until the add water light is illuminated. Do not use a K-Cup® pod. Let brewer stand for at least 30 minutes while still on.

After 30 minutes, discard any residual solution from the water reservoir and rinse thoroughly.

### STEP 3: Fresh Water Rinse

Fill the water reservoir with fresh water to and not beyond the MAX fill line.

Place a large mug on the drip tray plate and run a rinsing brew using the largest brew size. Do not use a K-Cup® pod. Pour the contents of the mug into the sink.

Repeat brew process until you have completed at least 12 rinsing brews using the largest brew size. You may need to refill the water reservoir at least one time during this process.

NOTE: The cleaning action of Keurig® Descaling Solution may result in a “foam” dispensed from the brewer. This is natural, as the solution is reacting with the scale inside. For a brewer that is heavily scaled, the brewer may not fill properly after the descaler is added. If this occurs, you may see only a small or no output dispensed, followed by the sound of air blowing out. If this occurs:

- Turn off and unplug the brewer.
- If there is Keurig® Descaling Solution in the water reservoir, discard the contents, rinse the water reservoir thoroughly and refill with water.
- Plug the brewer back in, power on, and repeat the Step 3 Fresh Water Rinse cycle. The brewer should begin to function normally as the solution is rinsed out and the scale is removed. If problem persists, allow brewer to sit unplugged for at least 30 minutes before continuing with the rinse.

## Troubleshooting

### Grounds in Your Coffee

Grounds may have gathered in the exit or entrance needles and can be cleaned using a straightened paper clip or similar tool.

- Clean the exit needle of the K-Cup® pod holder. Refer to the Exit Needle care instructions.
- Clean the brewer entrance needle. Refer to the Entrance Needle care instructions.

### Brewer Will Not Brew

- After placing the K-Cup® pod in the K-Cup® pod holder, make sure that the handle is pushed down securely and the brew buttons are flashing.
- If the add water light is illuminated, add water to water reservoir. Fill to and not beyond the MAX fill line. Make sure the water reservoir is seated properly in its base. If the add water light continues to be illuminated even after refilling, contact Customer Service.

### Brewing a Partial Cup

- The exit needle may be clogged. Refer to the Exit Needle care instructions.
- The water reservoir may have been removed during brewing. Replace the water reservoir and perform a rinsing brew without a K-Cup® pod.
- The brewer may need to be descaled. If you have repeated the descale procedure on your brewer two times and it is still only brewing a partial cup, contact Customer Service.

### Brewer Does Not Have Power or Shuts Off

- Make sure that the power button has been turned on.
- Plug brewer into its own grounded outlet. If the electric circuit is overloaded with other appliances, your brewer may not function properly. The brewer should be operated on its own circuit, separate from other appliances.
- Auto Off sets the brewer to turn off 2 hours after the last brew for energy savings. Refer to Brewer Features for instructions on enabling and disabling this feature.
- If the brewer still doesn't have power, contact Customer Service.

### *Helpful Hints*

Water quality varies greatly. If you notice an undesirable taste in your beverage (such as chlorine or mineral tastes), we recommend using bottled or filtered water. Do not use distilled water. You can also install a Keurig® Water Filter to help remove water impurities and improve beverage taste.

## Service

Beyond these recommended cleaning and maintenance procedures, this brewer is not user serviceable. For service, please refer to the Warranty section of this guide.

## Storage

Empty the water reservoir before storing or transporting and take care to ensure that you store your brewer in a safe and frost free environment. Please be sure to store your brewer in its upright position to avoid water leakage from the inner tank. If you store the brewer in a cold environment, you run the risk of water freezing inside the brewer and causing damage. When you prepare to use it after storage, we recommend rinsing the water reservoir with fresh water and running three rinsing brews without a K-Cup® pod.

If you plan to move your brewer to a different location, turn the brewer off, unplug it, and empty the water reservoir. If your brewer has been in an environment below freezing, please be sure to let it warm to room temperature for at least 2 hours before using.

## K-SELECT™ BREWER



For more information, please visit [www.Keurig.com](http://www.Keurig.com)

- A. Water Reservoir Lid
- B. MAX Fill Line
- C. Water Reservoir

D. Water Reservoir Lock Tab Slot

E. Power Cord F. Handle

G. Lid

H. K-Cup® Pod Holder (H and I are the K-Cup® Pod Holder Assembly)

I. Funnel J. K-Cup® Pod Assembly Housing

K. Drip Tray Plate

L. Drip Tray

M. Drip Tray Base

**Warning**

This content is compiled from multiple sources and is provided for reference purposes only. It may not be complete or fully applicable to all situations. If you are unable to resolve your issue, please contact the product manufacturer or an authorized service provider for official support.

