

## User manual Camera

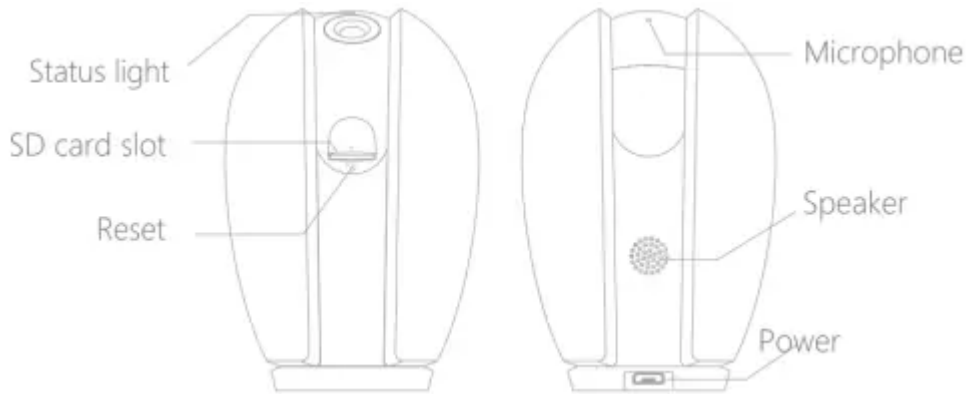

Power	DC 5V ± 10%
Status Light	<ul style="list-style-type: none"><li>• Red light solids on: the device or network is abnormal</li><li>• Blinking red light: awaiting WiFi connecting</li><li>• Blue light solids on: camera running correctly</li><li>• Blinking blue light: currently connecting</li></ul>
Microphone	Capture sound for your video
SD card slot	Support local SD Card storage (Max.128G)
Reset	Press and hold the 'RESET' for 5 seconds with pin to res the device(Camera will return to factory default settings)

## WHAT'S IN THE BOX

PLEASE CONSULT THIS CHECKLIST FOR ALL PARTS

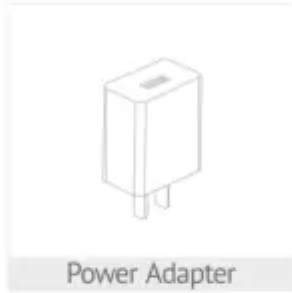

## APP SET UP

For step-by-step Mobile APP set up instruction, please read the Quick Start Guide included in the package or check out our Youtube tutorials.

### 1. DOWNLOAD AND INSTALL APP

- LaView App is available for both iOS and Android OS. Search the name 'LaView^' in App Store or Google Play.(The other LaView apps, such as LaView Connect, LaView ONE, LaView Life do NOT support R3 camera)



LaView



- Please download the LaView App from the App Store or Scan the QR Code below



### 2. MAKE SURE YOUR PHONE IS CONNECTED TO A 2.4GHZ WIFI NETWORK

### 3. COMPLETE THE APP REGISTRATION PROCESS

#### 4. FOLLOW THE IN-APP INSTRUCTION TO PAIR THE CAMERA

- Click on the '+' sign to add the camera. Continue to click "Video Surveillance" >> "Smart Camera"
- Connect the camera to power via included USB charge (If you are not setting up the camera for the very first time, press the Reset button instead for 5 seconds until you hear a 1 beep.)

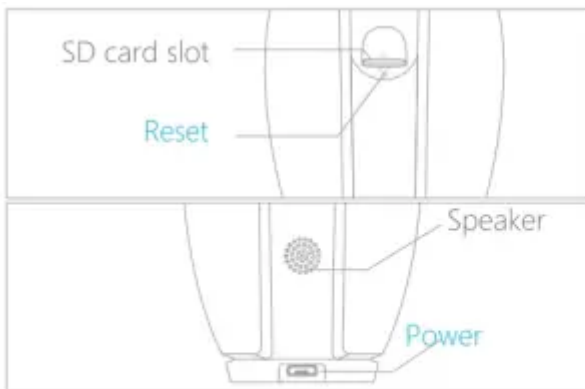

1



2

- Wait until the LED indicator is flashing rapidly, which means the camera is ready for pairing
- Enter the WiFi Password to generate a QR code that carries your WiFi information<sup>2</sup>
- Use the camera to scan the QR code on the phone ( keep the camera 6-8 inches away from the phone)

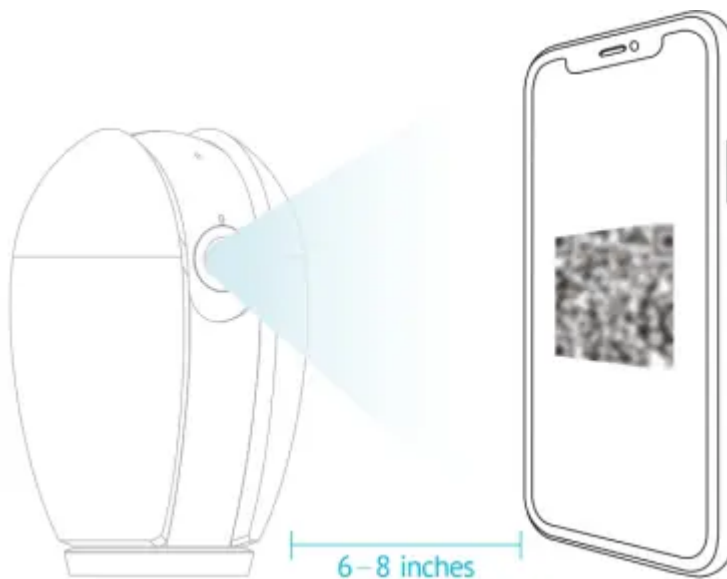

- Press 'I Heard a Prompt' after the camera receives the QR code and beeps. The camera will start pairing

- When connecting, you should make sure your router, mobile phone, and camera are as close as possible
- Wait until the camera is connected online
- Customize the camera name to differentiate cameras in different locations and finish and pairing process
- If the pairing is not successful, press the Reset button for 5 seconds until you hear a beep and start again. Or check the FAQ section for more troubleshooting steps

## INSTALLATION

### FIND A GOOD MOUNTING SPOT

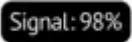
- Use the WiFi Signal Indicator  in the APP Live view screen to test the WiFi signal strength. Move the camera as close to the router as possible if the WiFi signal is poor

## TROUBLESHOOTING

### IF YOU CANNOT CONNECT THE CAMERA TO THE INTERNET, CHECK THE FOLLOWING STEPS

- Ensure you are connecting to a 2.4GHz WiFi not 5GHz



- Ensure WiFi password or SSID is correct
- Ensure the camera is placed as close to the router as possible
- Ensure camera is powered on and the indicator is blinking rapidly before scanning the QR code
- Ensure you are using the correct APP (LaView)
- Ensure the camera is scanning the QR code on the phone in the correct way
- If the above steps don't help, reset the camera and start pairing again

### WHAT CAN I DO IF THE CAMERA STOPPED WORKING?

- Close the APP and Restart the APP again
- Check if WiFi password or router is changed. If so please reset the camera

- Ensure router is powered on and online
- Ensure camera has power
- Ensure the phone has decent network bandwidth
- Check the app is on latest version

## **HUMAN AND MOTION DETECTION**

### **HOW TO TURN ON AND OFF MOTION DETECTION?**

- To turn on or off motion detection and Human detection setting, go to the camera menu and click on Detection Alarm Settings

### **WHAT CAN I DO IF I CANNOT RECEIVE NOTIFICATIONS?**

- LaView camera uses the advanced 3D AI Humanoid Analysis technology that only sends notifications when a human is detected
- Ensure your phone notification setting is enabled for LaView APP
- Ensure the phone has decent network bandwidth
- Ensure the camera is online

### **WHAT CAN I DO IF I RECEIVE TOO MANY NOTIFICATIONS?**

- Ensure the Human AI detection filter is enabled
- If the camera is placed at a location with large traffic, we recommend to relocate it to a place with less traffic to receive less alerts
- Objects with human body shape such as stuffed toys may be detected as human and trigger the alerts, remove those if they constantly show up in the camera

## **OTHERS**

### **WHAT CAN I DO IF THE IMAGE IS NOT CLEAR?**

- The camera is equipped with 1080p Full HD lens and sensor to produce superior image, however the image quality may be affected by the lighting condition
- Ensure the camera is NOT facing an environment with poor lighting condition or with extremely high contrast. Ensure it is NOT facing directly to bright lighting sources such as sunlight
- Ensure your phone and your router has enough bandwidth to stream HD video. A minimum of 2Mbps is required to stream each 1080p camera. If the network does not meet this requirement, the live view stream will be downgraded to SD automatically

## NIGHT VISION

- The camera is equipped with Infrared LED technology to capture black and white night vision image in detail at night. However, the night vision image quality may be affected by the following factor:
- There are high contrast light sources such as car headlight pointing to the camera



Daytime



Night

# PARAMETER



<b>Camera</b>	
Image sensor	1/2.9"Processive Scan CMOS
IR Distance	33ft
Lens	3.6" mm FOV105°
Day & night	IR Cut Filter with auto switch
Angle Adjustment	Tilt:-10°~75°; Pan: 0-355°
<b>System</b>	
Processor	High-Performance Embedded SOC Processor
Wireless	Built-in 2.4G Wi-Fi
<b>Audio</b>	
Input	Built-in Omni-direction microphone
Output	Built-in loudspeaker
<b>Video</b>	
Compression Standard	H.264
Max. Resolution	1920 x 1080
Frame Rate	1~25fps adaptive frame rate of network transmission
WDR	DWDR
<b>Interface</b>	
Cloud Storage	Laview Cloud Storage
<b>Interface</b>	
Local Storage	Micro SD Card ( Max. 128G )
<b>General</b>	
Operating conditions	-4°F - 131 °F (-20°C - 55°C ) humidity 90% or less (non-condensing)
Power Supply	5V DC.1A

Power Consumption	Max.4.5W
Dimensions	2.48" x 2.28"x 3.78"(63 x 58 x 96mm)
Weight	0.34 lbs (155g)

**Warning**

This content is compiled from multiple sources and is provided for reference purposes only. It may not be complete or fully applicable to all situations. If you are unable to resolve your issue, please contact the product manufacturer or an authorized service provider for official support.

