

About Your RoboVac

RoboVac Anatomy

Top & Side

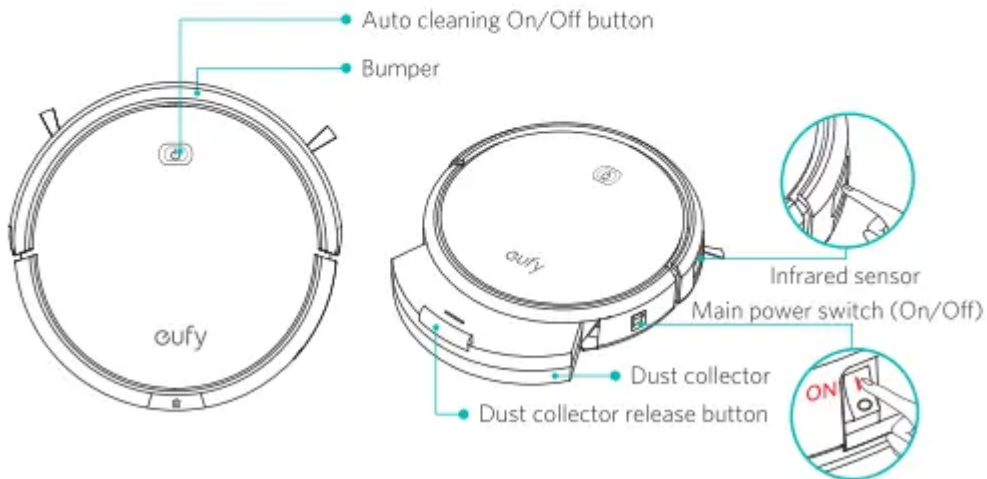

Bottom

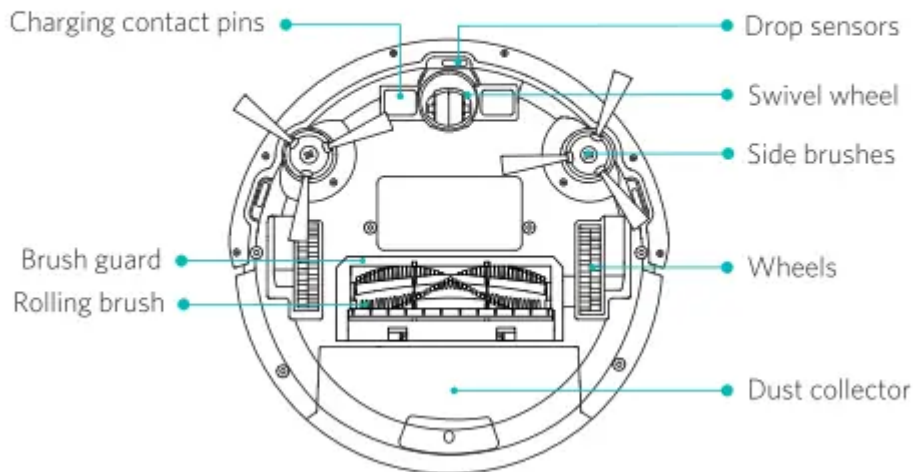

Dust Collector

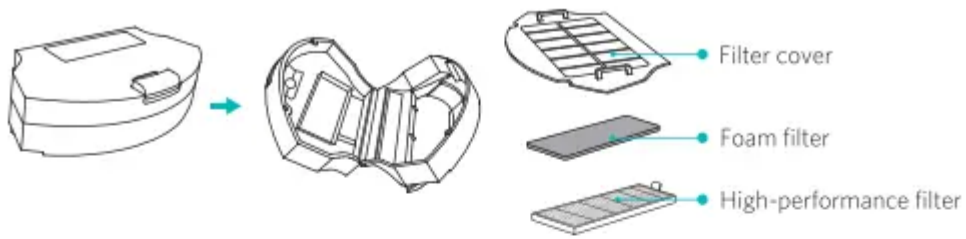

Suction Inlet

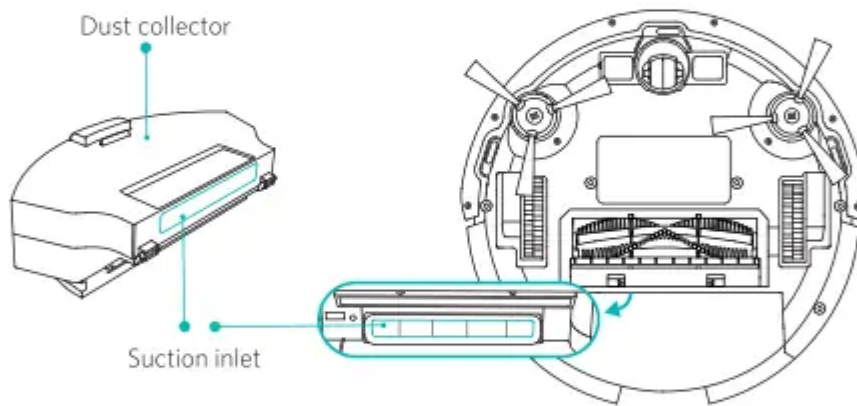

Charging Base

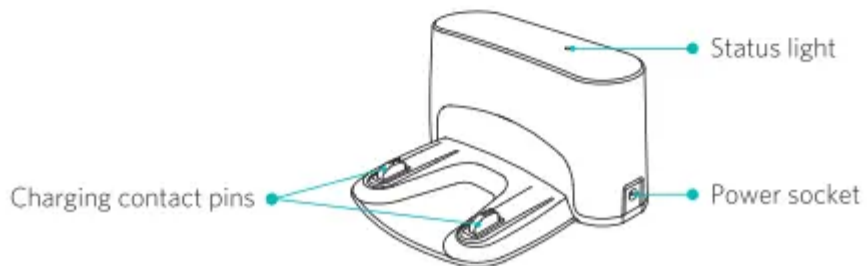

Remote Control

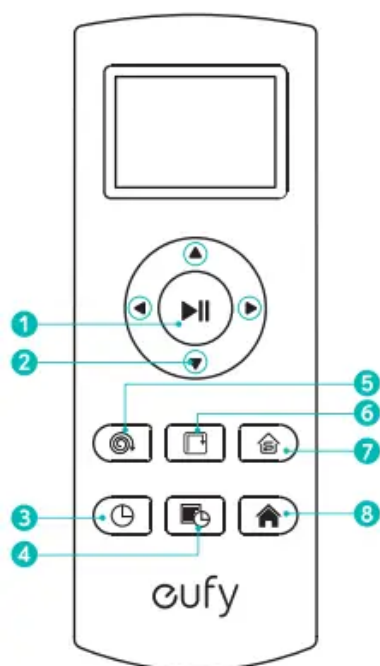

- 1 Start/Stop Auto cleaning
- 2 Control cleaning direction manually
Adjust the hour and minute
- 3 Set the current time
- 4 Schedule auto cleaning start time
- 5 Start Spot cleaning
- 6 Start Edge cleaning
- 7 Start Single Room cleaning
- 8 Return RoboVac to the Charging Base

Using Your RoboVac

Important Tips Before Use

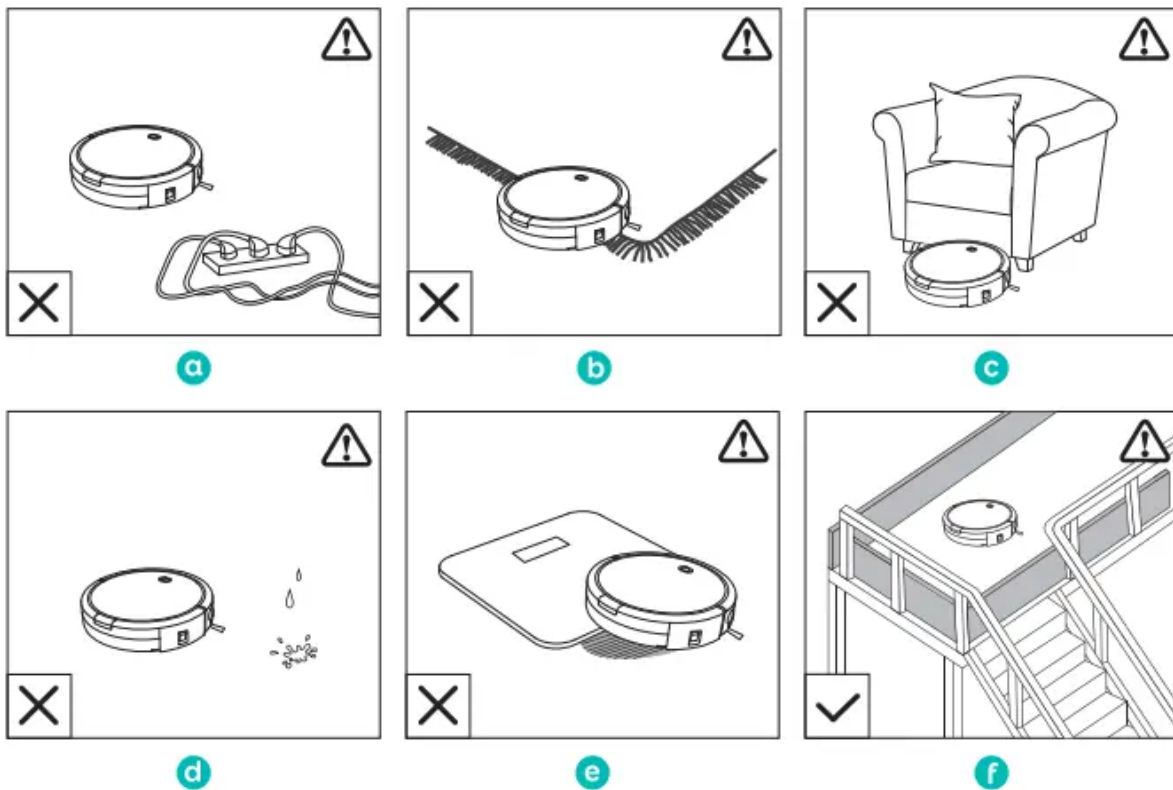

a. Remove power cords and small objects from the floor that may entangle RoboVac.

b. Remove rugs that are thicker than 0.87 in/22 mm as they may cause RoboVac to malfunction. Fold tasseled edges of area rugs underneath to prevent tangling RoboVac. Do not use RoboVac on long-pile carpeting.

c. Avoid cleaning spaces lower than 3.9 in/100 mm to prevent RoboVac from getting stuck

d. Keep RoboVac away from wet areas.

e. RoboVac may climb on top of objects less than 0.63 in/16 mm in height. Remove these objects if possible.

f. Anti-drop sensors prevent RoboVac from tumbling down stairs and steep drops. They may work less effectively if dirty or used on reflective/very dark-colored floors. It is recommended to place physical barriers to block off areas where RoboVac may fall.

Install the Charging Base

1. Place the Charging Base on a hard, level surface and against a wall.

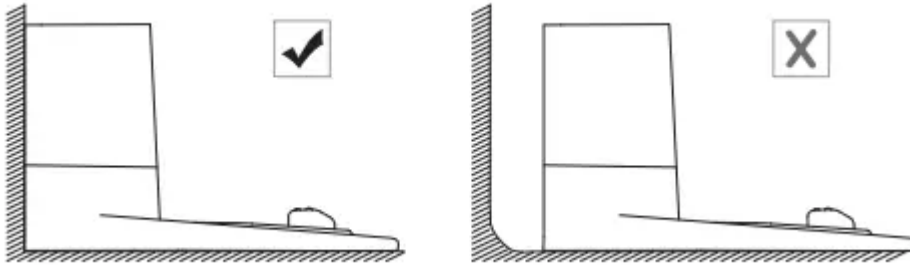

2. Remove objects within 3 ft/1 m of the left and right side and within 6 ft/2 m of the front of the charging base.

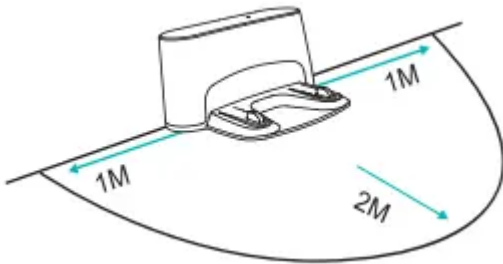

4. Connect the round connector of the adapter into the power socket on the Charging Base and the other end into a wall outlet.

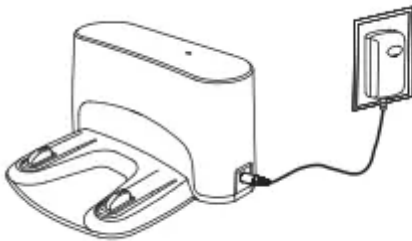



 - Install the Charging Base in a location that RoboVac can easily access.
 - Always keep the Charging Base plugged in, otherwise RoboVac will not automatically return to it.

Charge Your RoboVac

- RoboVac has a pre-installed rechargeable battery that has to be fully charged before use.
- RoboVac returns to the Charging Base at the end of a cleaning cycle or when its battery is running low.
- Make sure the main power switch on the side of RoboVac is turned on before charging.

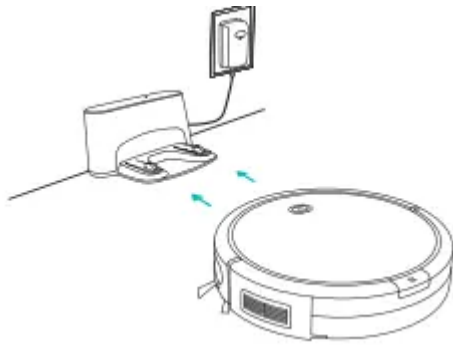
Method 1: Attach RoboVac to the Charging Base by aligning its charging pins with the charging pins on the base.



Method 2: Press  on the remote control to return RoboVac to the Charging Base.

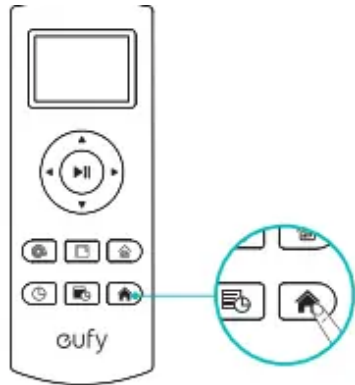

 (Status Light)	Status
Breathing blue	Charging
Solid blue	Standby / Cleaning / Returning to charging base
Solid purplish-red	Low power and returning to charging base
Flashing / Solid red + Beeping	RoboVac has an error
Off	<ul style="list-style-type: none"> • RoboVac powers off. • To save power, the light automatically turns off: <ul style="list-style-type: none"> ◦ When RoboVac is not docked to the charging base and has been inactive for 10 minutes; ◦ After RoboVac is docked to the charging base and has been fully charged for 10 minutes.

Start / Stop Cleaning

1. Turn on the main power supply

Press the main power switch on the side of RoboVac to turn on the main power supply.

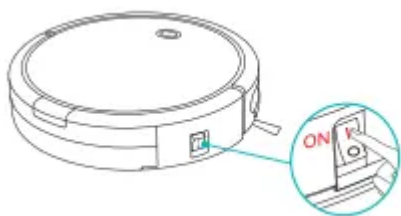

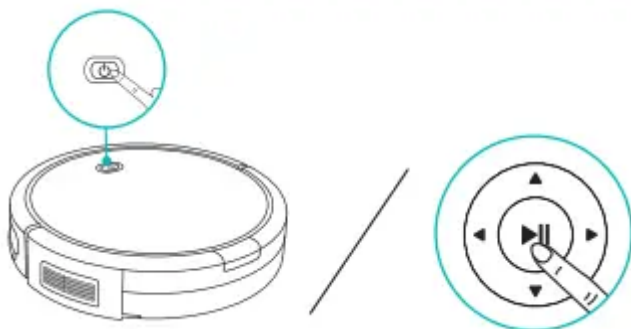

2. Start cleaning

Press  on RoboVac or  on the remote control to start cleaning in Auto mode.



3. Stop cleaning

Press  on RoboVac or  on the remote control to stop cleaning.

Select a Cleaning Mode

1. Auto cleaning

RoboVac automatically cleans in a back-and-forth, straight-line pattern. This is the most commonly used cleaning mode.

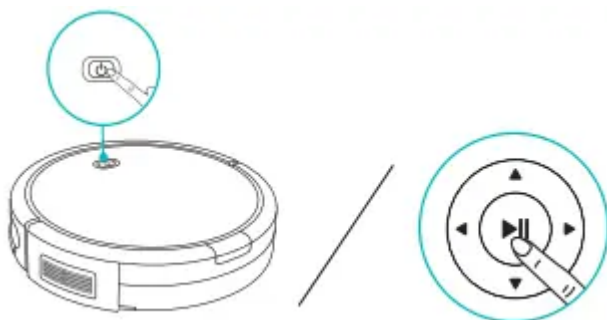

Press  on RoboVac or  on the remote control to start cleaning in Auto Mode.



Power Boost Feature (Model T2104 only)

When the Power Boost feature is enabled, RoboVac will automatically increase the suction power if it detects stronger power is needed to ensure the best clean. Power Boost is ideal for cleaning thicker carpets and hard-to-sweep messes, which will reduce the cleaning

time, but increase the noise level. If the vacuuming noise caused by Power Boost disturbs you, you can disable this feature. This feature only works in Auto cleaning mode.

To a the default suction power in Auto Cleaning Mode, simultaneously press and hold the  and  buttons for 2 seconds; you will hear a series of beeps that correspond to the suction power selected. Repeat to adjust the suction power level.

Sound	Power Boost	Suction Power Setting
One beep	Off	Standard
Two beeps	On	Automatically switches between Standard and Maximum (default)
Three beeps	Off	Maximum

2. Spot cleaning

RoboVac intensively cleans a specific area in a spiral, useful if there is a concentrated area of dust or debris. In Spot mode, RoboVac will stop cleaning after 2 minutes.

Press  on the remote control to start cleaning in Spot mode.

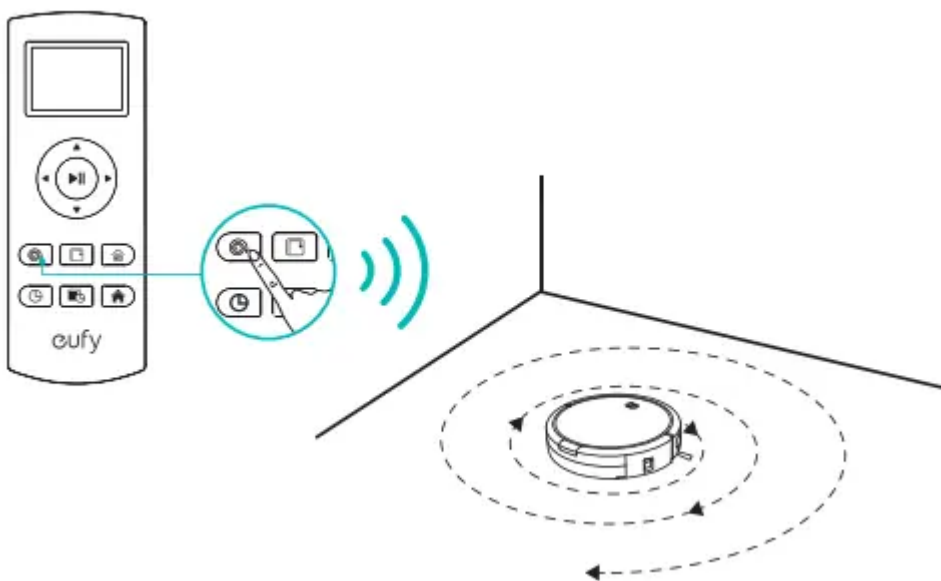

3. Edge cleaning

RoboVac reduces its speed when it detects a wall and then follows the wall to ensure the edge is cleaned thoroughly. In Edge mode, RoboVac will clean for 20 minutes and return to the Charging Base.

Press  on the remote control to start cleaning in Edge mode.

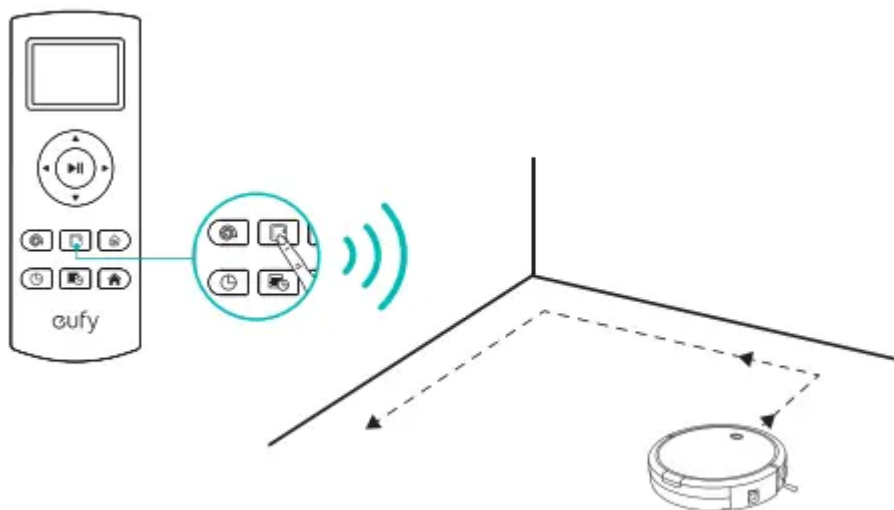

4. Single Room cleaning

RoboVac intensively cleans one single room and stops after 30 minutes. Select this mode only when one specific room needs to be cleaned. Make sure to confine RoboVac to the room by closing the door.

Press  on the remote control to start cleaning in Single Room Mode.

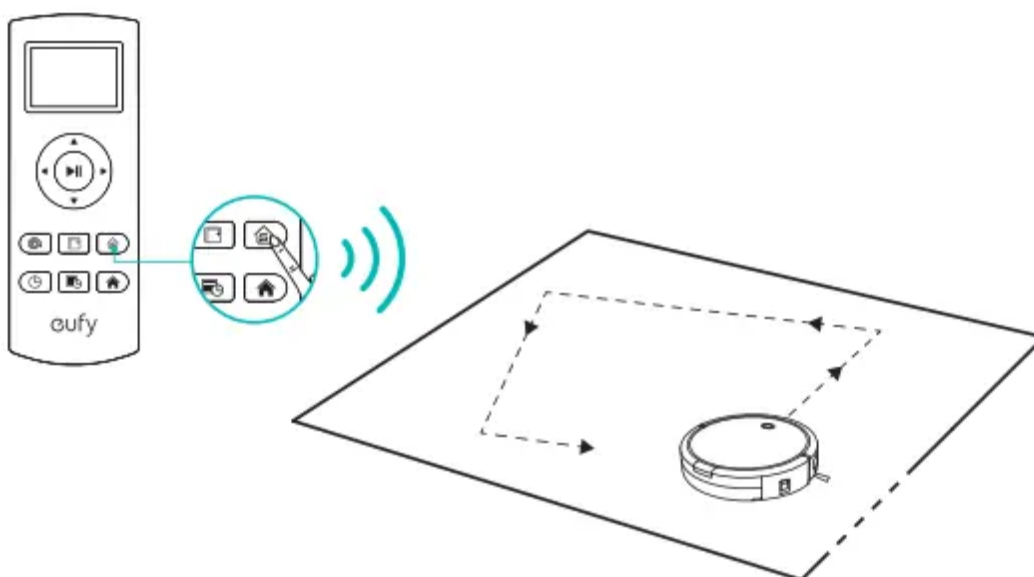

5. Manual cleaning

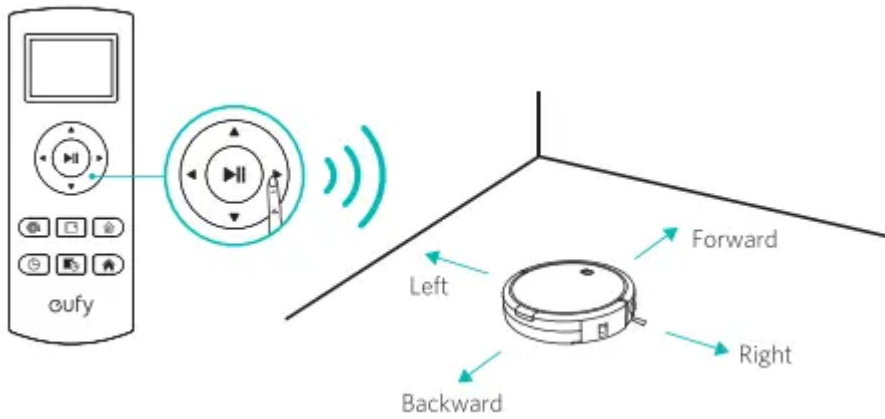

You can direct RoboVac to clean a particular area by using the directional buttons on the remote control.







Set Time and Scheduled Cleaning



1. Set Time

1 Make sure the main power switch on the bottom of RoboVac is turned on.

2 Press  on the remote control.  will blink on the display.



3 Press     to set the “hour” and “minute”.

Note: Make sure AM/PM is set correctly.

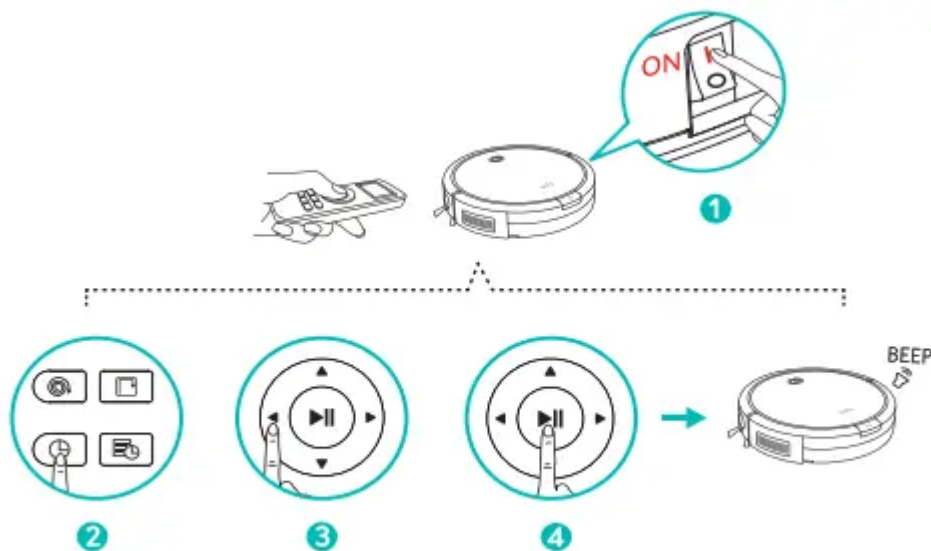
4 Press  or  to save the setting. RoboVac will BEEP ONCE to indicate the time has been set.





2. Schedule Cleaning



You can schedule RoboVac to start cleaning at a specified time. To cancel a previously scheduled cleaning, press and hold  for 3 seconds until RoboVac beeps twice and  disappears.

Note: Before setting a scheduled cleaning, make sure the time has been set correctly to your local time; refer to the previous section “Set Time” for how to set the time.

1 Make sure the main power switch on the bottom of RoboVac is turned on.

2 Press  on the remote control.  will blink on the display

3 Press  to set the “hour” and “minute”. Note: Make sure AM/PM is set correctly.

4 Press  or  to save the setting. RoboVac will BEEP ONCE to indicate the scheule has been set.

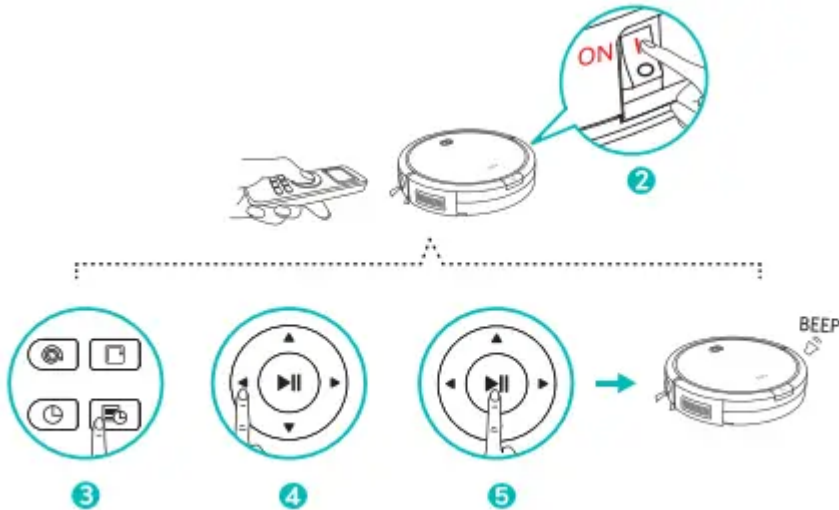

Cleaning and Maintenance

Clean the Dust Collector and Filters

1. Press the dust collector release button to pull the dust collector out.
2. Open and empty the dust collector.



3. Remove the pre-filter by pulling the hooks as shown.
4. Take out the foam filter and high-performance filter.

3

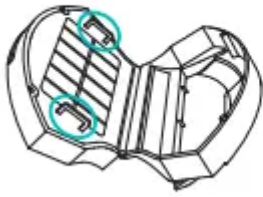

4

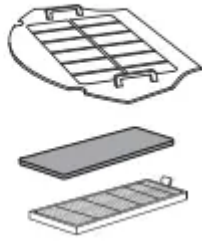

5. Clean the dust collector and filters with a vacuum cleaner or a cleaning brush.

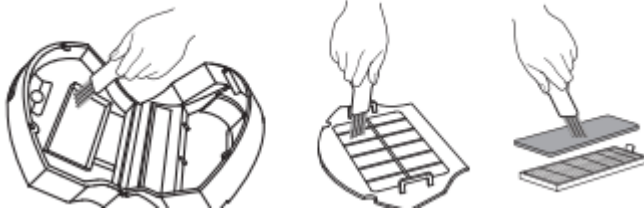

6. Put the filters and pre-filter back together in the dust collector

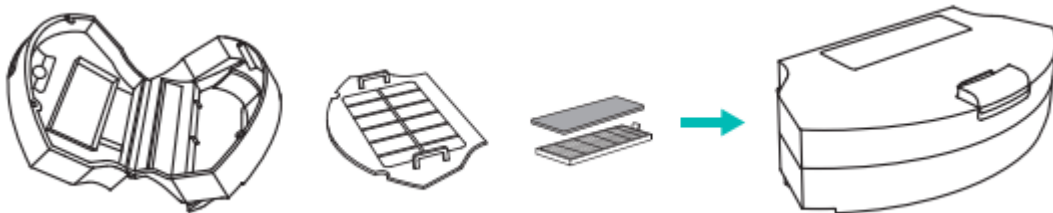

7 Push the dust collector back into the main unit.



Clean the Rolling Brush

1 Pull on the release tabs to unlock the brush guard as shown.

2 Lift the rolling brush to remove.

3 Clean the rolling brush with the provided cleaning tool or a vacuum cleaner.

4 Reinstall the rolling brush by inserting the fixed protruding end first and then clicking into place.

5 Press down to snap the brush guard into place.



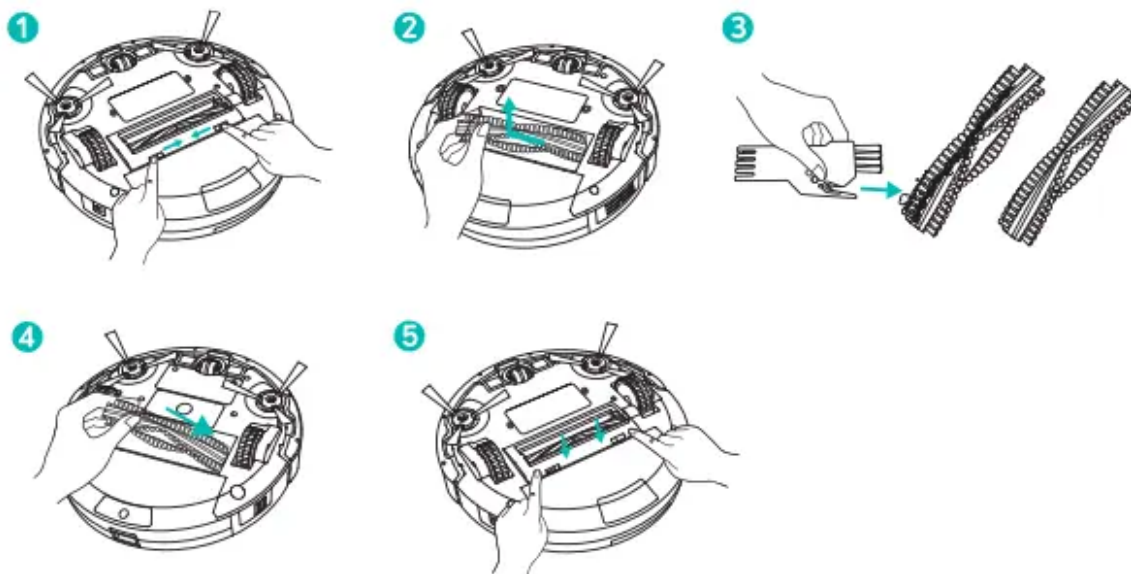

Clean the Sensors and Charging Pins

To maintain the best performance, clean the drop sensors and charging pins regularly.

- Dust off the drop sensors and charging contact pins using a cloth or cleaning brush.

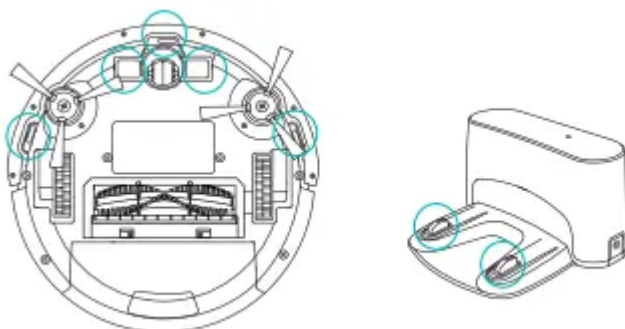

Clean the Side Brushes

Foreign substances, such as hair, can easily get tangled in the side brushes, and dirt may adhere to them. Be sure to clean them regularly.

1. Carefully unwind and pull off any hair or string that is wrapped between the main unit and the side brushes.
2. Use a cloth dampened with warm water to remove dust from the brushes or to gently reshape them.

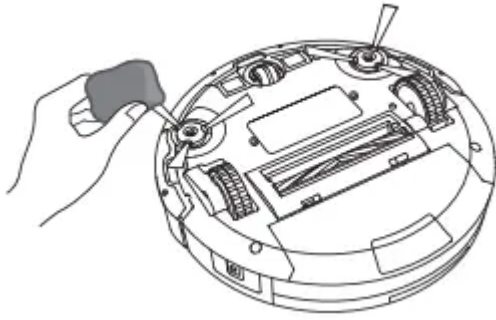

Replace the Side Brushes

The side brushes may become bent or damaged after being used for a period of time. Follow the instructions below to replace them. Pull off the old side brushes and snap the new ones into place.

1. Use a screwdriver to unscrew the screws on the side brushes.
2. Pull off the old side brushes and snap the new ones into place

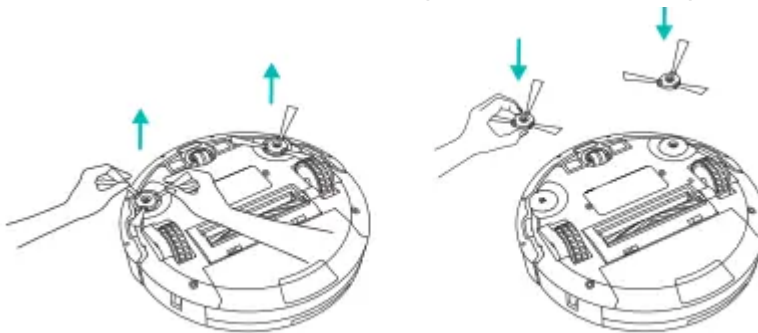

3. Screw down the screws to fasten the side brushes.

Troubleshooting

RoboVac cannot be activated.



- Make sure the main power switch is in the ON position.
- Make sure the battery is fully charged
- Replace the batteries (2 AAA) in the remote control.
- Make sure the remote control is within range (less than 6 ft/3 m from RoboVac).
- If you still have trouble, turn off the main power switch and then| turn it on.

The remote control does not work.

- Replace the batteries in the remote control.
- Make sure RoboVac is turned on and fully charged.

- If RoboVac and the remote control's display work properly, but RoboVac does not respond to the remote control's commands, it may be because the remote control has not been paired with RoboVac.

In this case, do not dock RoboVac to the Charging Base. Turn off the main power switch and then:

- (1) press and hold  on the remote control until the  icon blinks on the display;
- (2) turn on the main power switch.

You will hear three beeps after successful pairing.

RoboVac stops working suddenly

- Check if RoboVac is trapped or stuck on an obstacle.
- Check if the battery level is too low
- If you still have trouble, turn off the main power switch, wait for 2 seconds, and then turn it back on.

RoboVac does not start scheduled cleaning.

- Make sure the main power switch on the side of RoboVac is turned on.
- Make sure the time, time of day (AM/PM), and the scheduled time have been set correctly.
- Check if RoboVac's power is too low to start cleaning

Suction power is weak.

- Check if any obstructions are blocking the suction inlet
- Empty the dust collector.
- Check if the filter is wet due to water or other liquid on the floor. Air-dry the filter completely before use.

RoboVac cannot be charged

- Check if the indicator on the Charging Base lights up.
- Remove objects within 3 ft/1 m to the left and right side and within 6 ft/2 m of the front of the Charging Base
- Dust off the charging contact pins with a dry cloth.

RoboVac cannot return to the Charging Base

- Remove objects within 3 ft/1 m to the left and right side and within 6 ft/2 m of the front of the Charging Base
- When RoboVac is in the vicinity of the Charging Base, it will return more quickly. However, if the Charging Base is located far away, RoboVac will need more time to return. Please be patient as it works its way back

RoboVac's movements or travel paths are abnormal.

- Clean the sensors carefully with a dry cloth
- Restart RoboVac by turning the power switch off and on.

The rolling brush does not rotate.

- Clean the rolling brush.
- Check if the rolling brush and brush guard have been installed properly

Error Tones

When RoboVac is in trouble, it will emit a series of short or long beeps and the red indicator on RoboVac will be solid or flashing.

Flashing red indicator light

One beep

- RoboVac's drop sensors are dirty.
 - Clean the drop sensors gently with a dry cloth.

Two beeps

- RoboVac's power level is too low.
 - Charge RoboVac for at least 5 hours.

Three beeps

- RoboVac is hanging over a ledge or is trapped.
 - Turn off RoboVac and restart in a new location.

Four beeps

- RoboVac's suction fan is stuck.
 - Turn off RoboVac, then remove and empty the dust collector.
 - Make sure the suction inlet is not blocked by any hair or debris.

Five beeps

- RoboVac's infrared sensor on the bumper is dirty.
 - Clean the infrared sensor gently with a dry cloth

Solid red indicator light

One beep

- RoboVac's left/right wheel is stuck.
 - Turn off RoboVac and remove any hair or debris from the left/right wheel.

Two beeps

- RoboVac's side brush is stuck.
 - Turn off RoboVac and remove any hair or debris from the side brush.



Three beeps

- RoboVac's suction fan is stuck.
 - Turn off RoboVac, then remove and empty the dust collector.
 - Make sure the suction inlet is not blocked by any hair or debris.

Four beeps

- RoboVac's rolling brush is stuck.
 - Turn off RoboVac and remove any hair or debris from the rolling brush.

Specifications

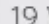
	Product Model	T2104	T2109
	Input	19 V  0.6 A	19 V  0.6 A
	Battery Voltage	DC 14.4 V	DC 14.6 V
	Power Consumption	28 W	25 W
	Battery Type	DC 14.4 V Li-ion 2500 mAh	DC 14.6 V Li-ion 2050 mAh
	Dust Collector Capacity	0.55 L	0.55 L
	Cleaning Time	Max. 100 mins	Max. 100 mins
	Charging Time	300 - 360 mins	300 - 360 mins

	Input	19 V  0.6 A
	Output	19 V  0.6 A

Warning

This content is compiled from multiple sources and is provided for reference purposes only. It may not be complete or fully applicable to all situations. If you are unable to resolve your issue, please contact the product manufacturer or an authorized service provider for official support.