

Owner's Guide Washer & Dryer



Programmes



Detergent drawer
with compartments I, II, ☼

Washing machine door

Control panel

Washing machine
door handle

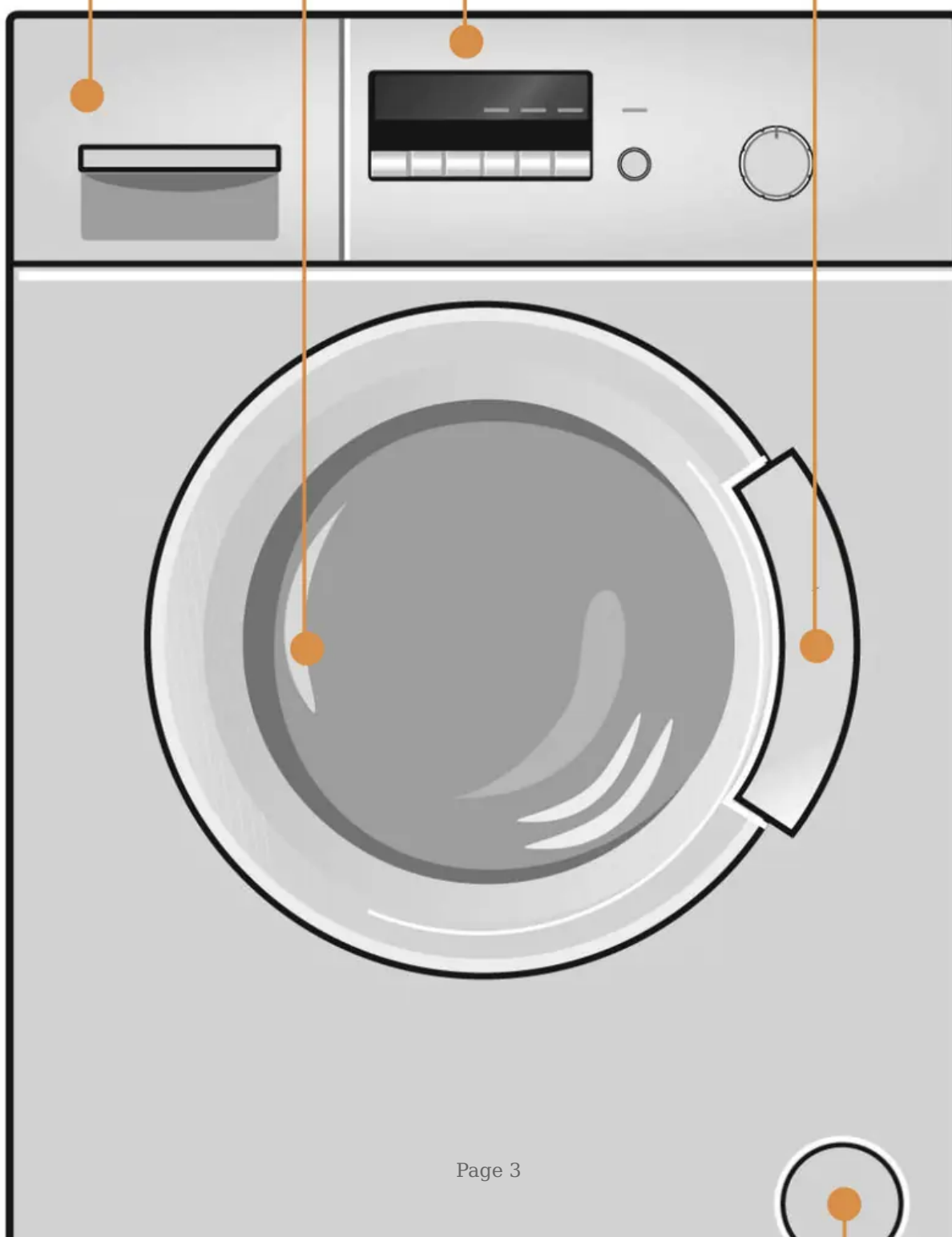

Programmes Detailed programme overview.

Temperature and spin speed can be selected individually, depending on the selected programme and programme progress.



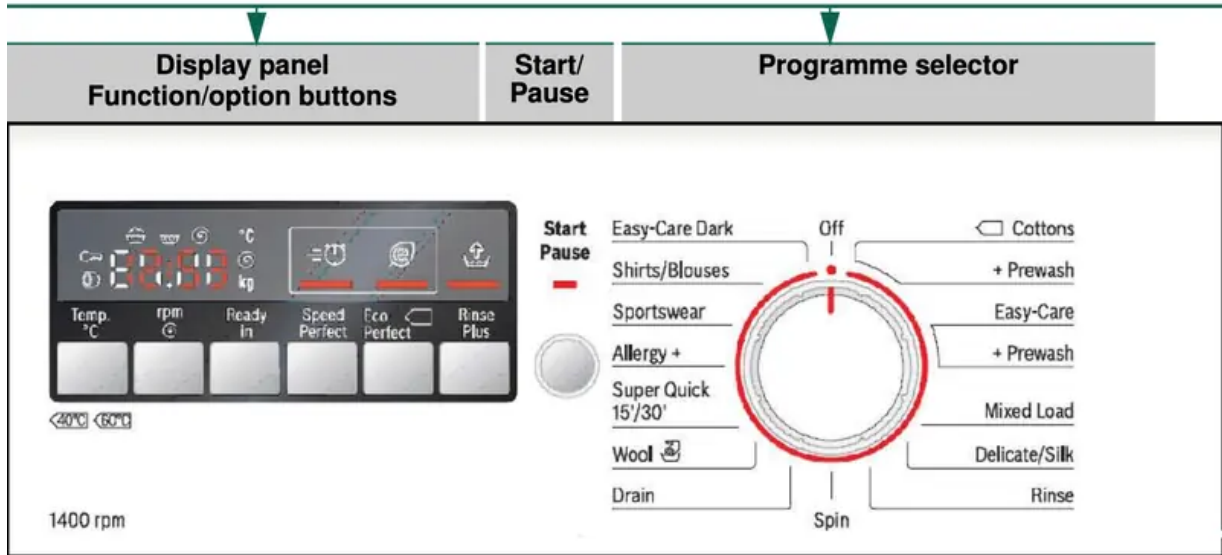



Setting** and adjusting programmes

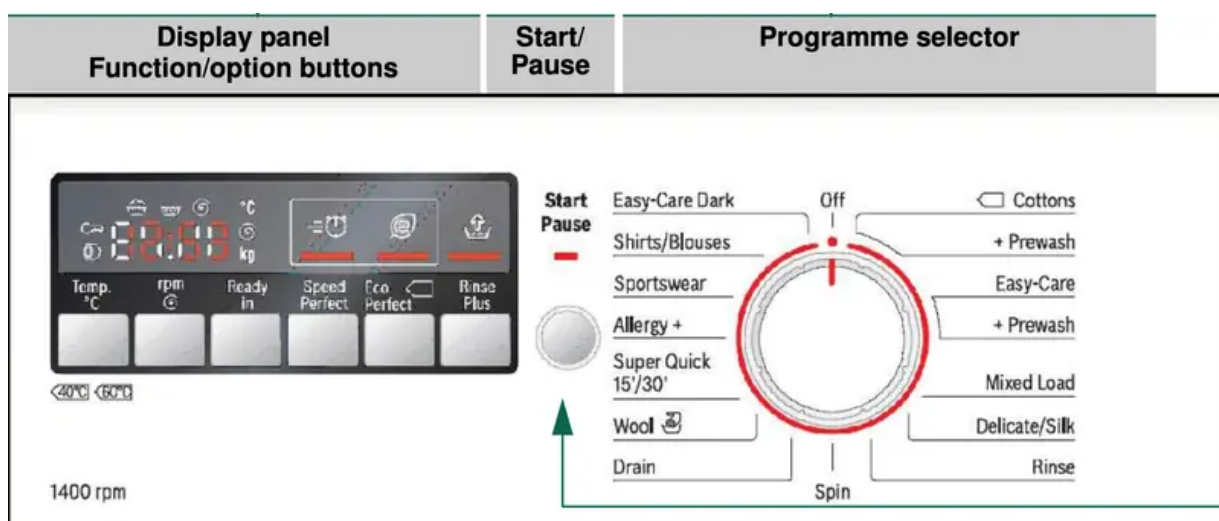

Cottons	Hard-wearing fabrics
+ Prewash	Hard-wearing fabrics, prewash at 30 °C
Easy-Care	Easy-care fabrics
+ Prewash	Easy-care fabrics, prewash at 30 °C
Mixed Load	Different types of laundry
Delicate/Silk	Delicate washable fabrics
 Wool	Hand/machine-washable wool
Rinse	Extra rinse with spin
pin	Extra spin with selectable speed
Drain	rinsing water for ---- (Rinse stop = no final spin); for this, set ⌚ (spin speed) to ----
Super Quick 15'/30'	Short programmes
Allergy +	Hard-wearing fabrics
Sportswear	Fabrics made from microfibre
Shirts/Blouses	Non-iron shirts
Easy-Care Dark	Dark-coloured fabrics

Select Start/Pause



<i>cold</i> - 90	Temp. °C  	Select the temperature (<i>cold</i> = cold)
---- - 1400*	rpm 	Select the spin speed (* depending on the model) or ---- (Rinse stop (Spülstop) = no final spin, laundry soaks in the last rinsing water, display panel ----)
<i>1h - 24h</i>	Ready in	Programme end after
Status indicators		Programme status indicators:
   <i>End</i>		Wash, rinse, spin, programme duration or end
		Childproof lock — page 5

**If the  (symbol flashes on the display panel, the childproof lock is active --> Deactivating, page 5.

Function and option buttons b Individual settings, page 5.

Caution: Programme selector for switching the machine on and off and for selecting the programme. Can be turned in either direction.

Caution: If the function buttons are held for longer, the appliance automatically runs through the display options.

End of programme when...

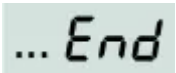
 appears on the display panel.

Interrupting the programme

Programmes at high temperatures:

- To cool the laundry: Select **Rinse**.
- Press **Start/Pause**.

Programmes at lower temperatures:

- Select **Spin** or **Drain** (if only emptying: set  (spin speed) to ----).
- Press **Start/Pause**.

Changing the programme, if...

... a wrong programme has been selected by mistake:

- Reselect the programme.
- Press Start/Pause. The new programme starts from the beginning.

Pausing/continuing the programme...

... e.g. for soaking b page 9.

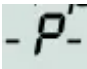
Press Start/Pause.  appears on the display panel; washing machine door cannot be opened. To continue the programme, press Start/Pause.

Individual settings

Function buttons

The spin speed and temperature can be changed before and during the selected programme. The effects depend on the programme progress.

Temp.°C

You can change the display washing temperature. The maximum washing temperature that can be selected depends on the programme that has been set.

rpm (spin speed // - - - - (Rinse stop = no final spin))



You can change the spin speed shown or select - - - - (Rinse stop (Spülstop) = no final spin, laundry remains in the water after the last rinse, display panel - - - -). The maximum selectable spin speed depends on the model and on which programme is currently selected.

Ready in

When you select the programme, the relevant programme duration is displayed. You can delay the start of the programme before it begins. The "Finished in" time can be set in increments of one hour up to a maximum of 24 hours. Press the Ready in button repeatedly until the required number of hours is displayed (h = hour).

Press Start/Pause.

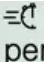
Option buttons

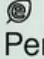
 Speed perfect	For washing in a shorter time with a washing result comparable to that of the standard programme. Maximum load —: Programme overview, <i>page 7</i> .
 Rinse Plus	Additional rinse cycle. For areas with very soft water or for further enhancing the spin result.
 Eco Perfect <	For saving energy with a comparable washing effect to the standard programme.

Childproof lock

 on the display panel

You can lock the washing machine to prevent the functions you have set from being changed inadvertently.

ON/OFF: after the start/end of the programme, press and hold the Start/Pause button for approx. 5 seconds.

Note: The childproof lock can remain activated until you wish to start the next programme, even after switching off the machine.

Then you can deactivate the childproof lock before starting the programme and activate it again as necessary once the programme has started.

Start/ Pause

To start, pause and continue the programme and to active/deactivate the chilproof lock.

Signal

1. Activate the setting mode for the signal volume

To activate the setting mode

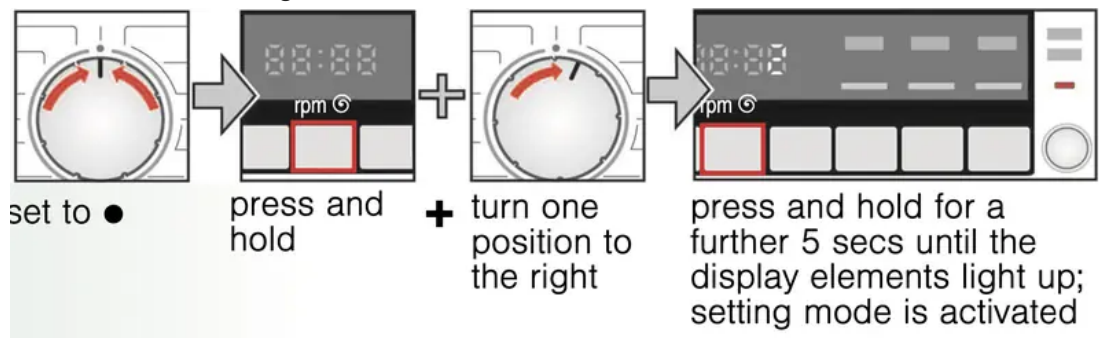

2. Set the volume for button signals (depending on model)

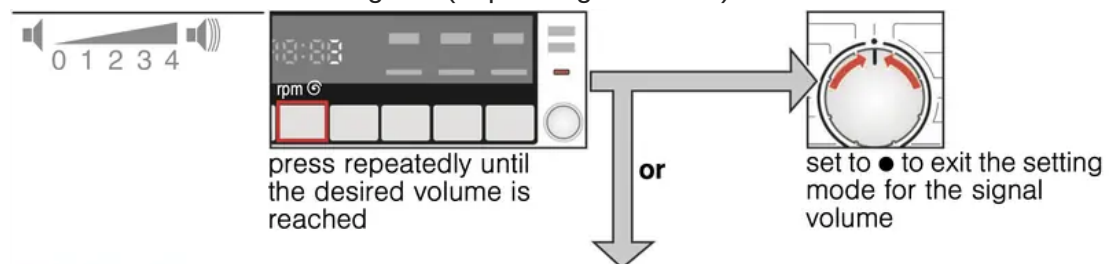

Set the volume for information signals

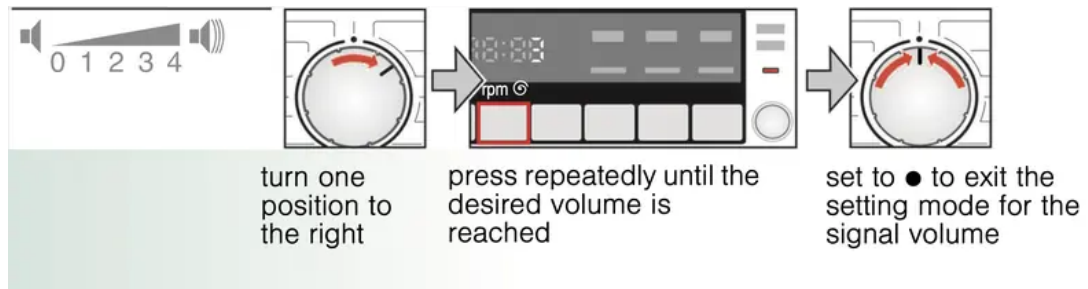

Information on the display panel depending on model

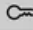
E: 17	Turn the (cold water) tap on fully; supply hose kinked/trapped; water pressure too low; service, clean the filter —: <i>page 10</i> ,
E: 18	Detergent solution pump blocked; service, clean the detergent solution pump —: <i>page 10</i> . Drainage hose/waste pipe blocked; service, clean the drainage hose at the siphon —: <i>page 10</i> .
E: 23	Water in the base tub, appliance leaking. Turn off the tap. Call the after-sales service.
	Childproof lock active; Deactivating —: <i>page 5</i> .
Other displays	Switch off the appliance, wait for 5 seconds and switch it back on again. If the display appears again, call the after-sales service.

Cleaning and care

Cleaning the contains detergent drawer...

...if it detergent or fabric softener residues.

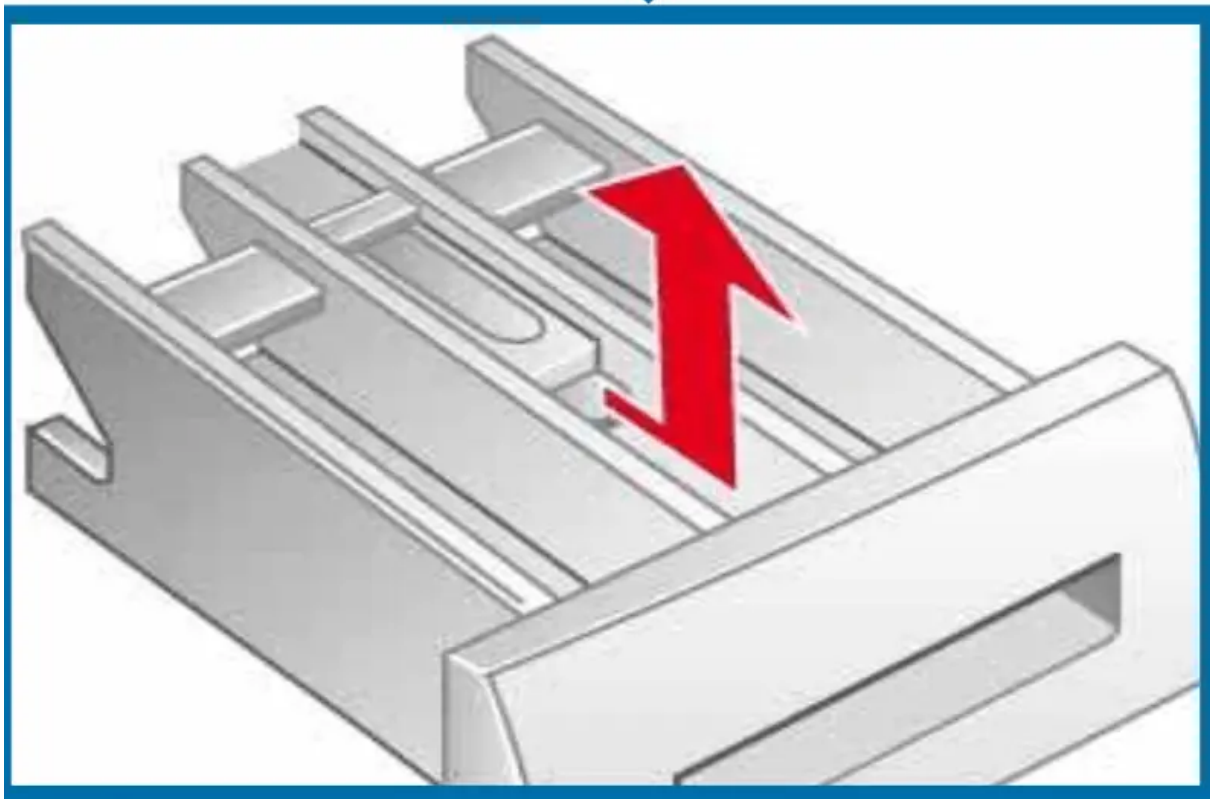
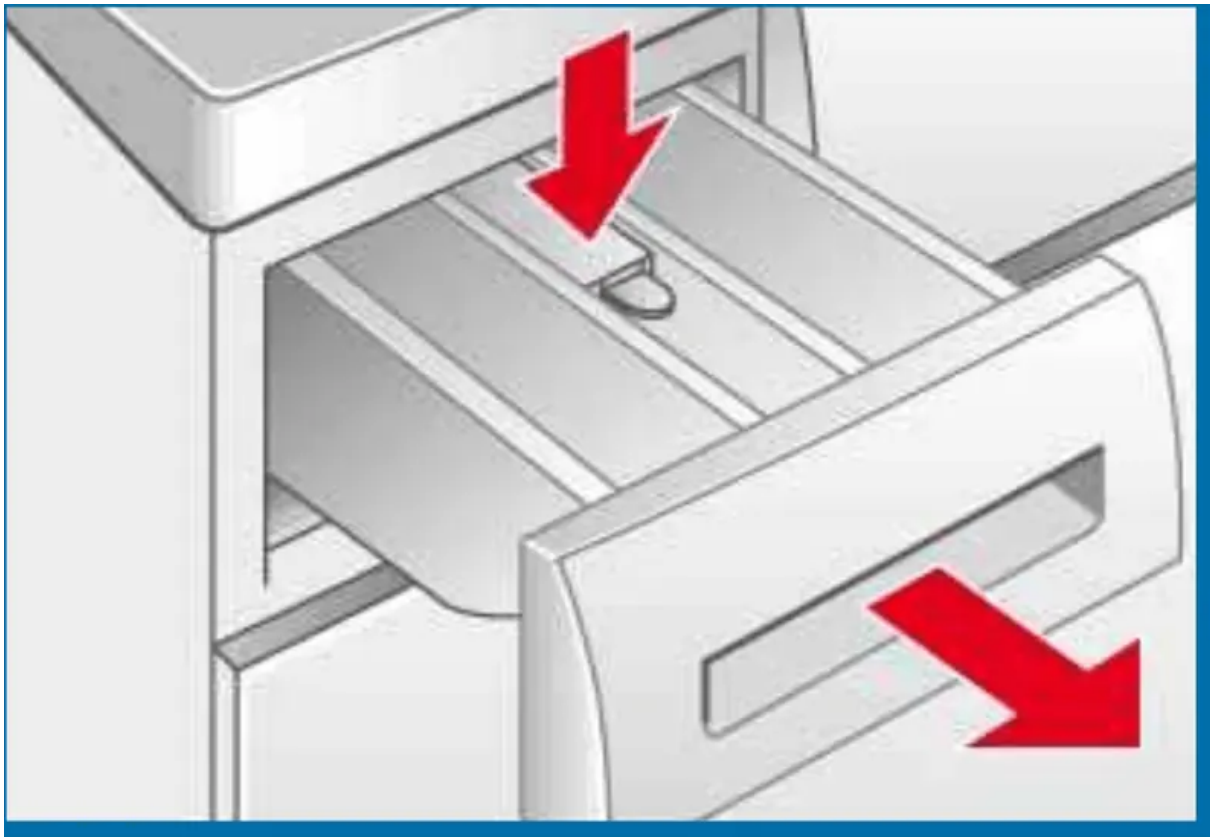

1. Pull out, press insert down, remove drawer completely.
2. To remove the insert: press the insert upwards from below with your finger.
3. Clean the detergent dispenser tray and insert with water and a brush and dry it.

4. Attach the insert and engage (connect the cylinder to the guide pin).
5. Push in the detergent drawer.

Leave the detergent drawer open so that any residual water can evaporate.

Drum

Leave the washing machine door open so that the drum can dry out.

Rust stains - use chlorine-free cleaning agent, not steel wool.

Descaling

Make sure that there is no laundry in the machine.

This should not be necessary if the correct detergent dosage has been used. If it is necessary, however, proceed according to the descaling agent manufacturer's instructions. Suitable descalers can be obtained via our website or from our after-sales service (page 1).

Maintenance

Warning - Risk of scalding

- Allow the detergent solution to cool down.
- Turn off the tap.

Detergent solution pump

Turn the programme selector to Off and disconnect the mains plug.

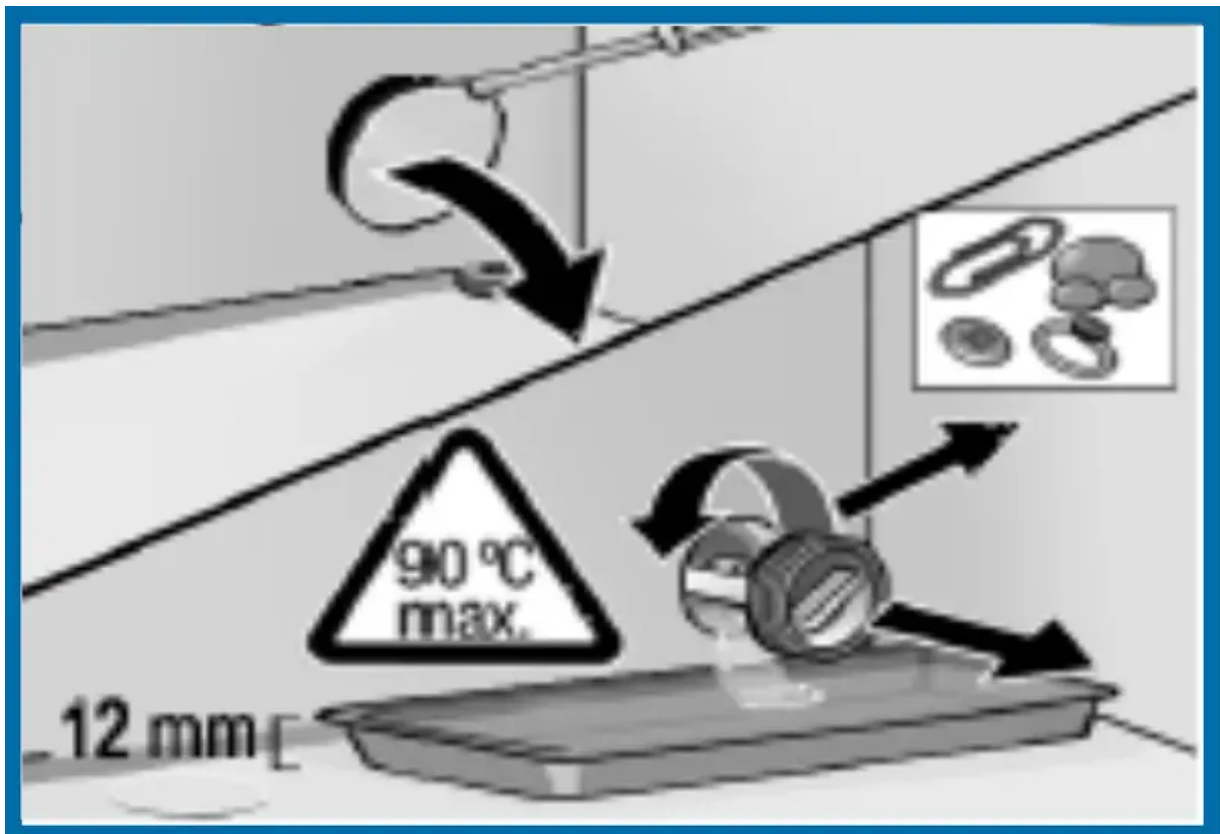

1. Open the service flap
2. Carefully unscrew the pump cover (residual water).
3. Clean the interior, pump cover thread and pump housing (the impeller in the detergent solution pump must rotate).
4. Replace the pump cover and screw it on tightly.
5. Replace the service flap.

To prevent unused detergent from flowing straight into the drain during the next wash: Pour 1 litre of water into compartment II and start the Drain programme.

Drainage hose at the siphon is blocked

Turn the programme selector to Off and disconnect the mains plug.

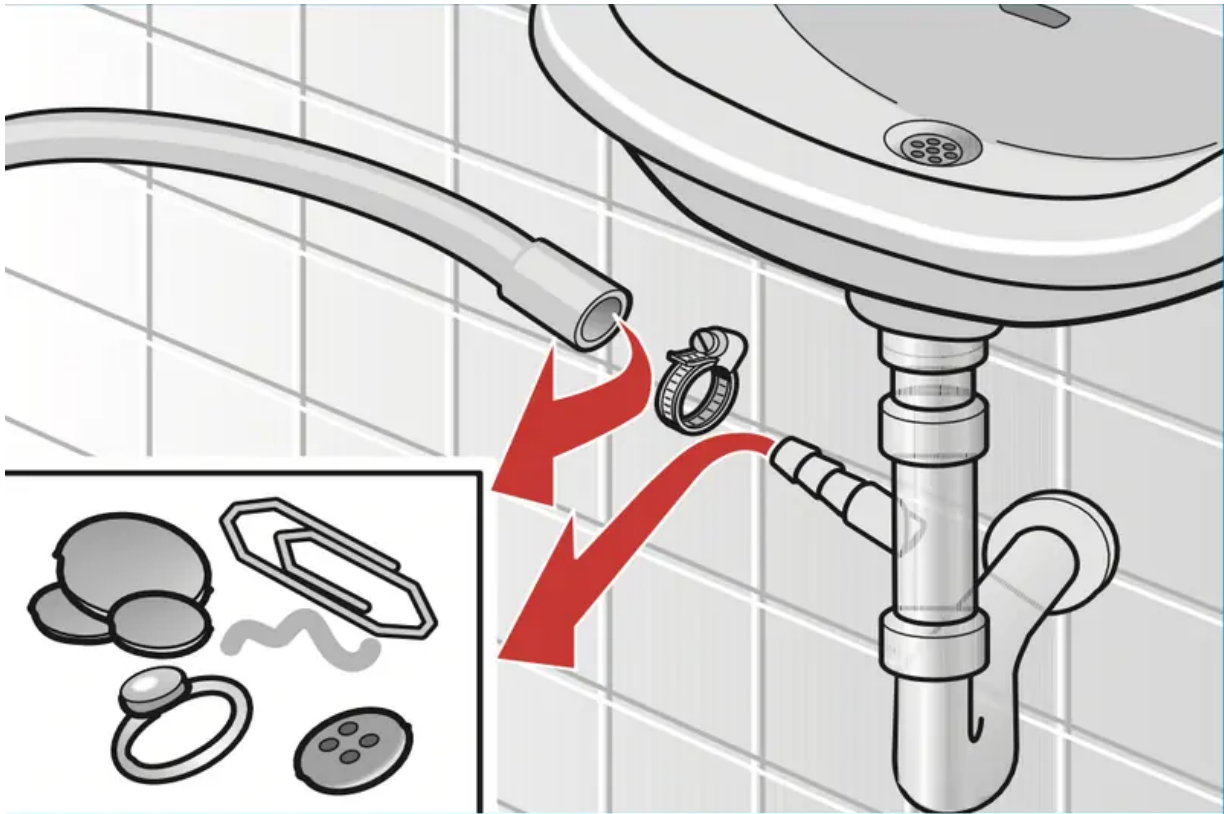

1. Loosen the hose clamp and carefully remove the drainage hose (caution: residual water).
2. Clean the drainage hose and siphon connecting piece.
3. Reattach the drainage hose and secure the connection with the hose clamp.

Filter in the water inlet is blocked

Risk of electric shock! Do not immerse the Aqua-Stop safety device in water (it contains an electric valve).

Reduce the water pressure in the supply hose:

1. Turn off the tap.
2. Select any programme (except for Spind/ Drain).
3. Press Start/Pause. Let the programme run for approximately 40 seconds. Turn the programme selector to Off.
4. Disconnect the mains plug.

Clean the filter:

5. Disconnect the hose from the tap.
Clean the filter with a small brush.

and/or

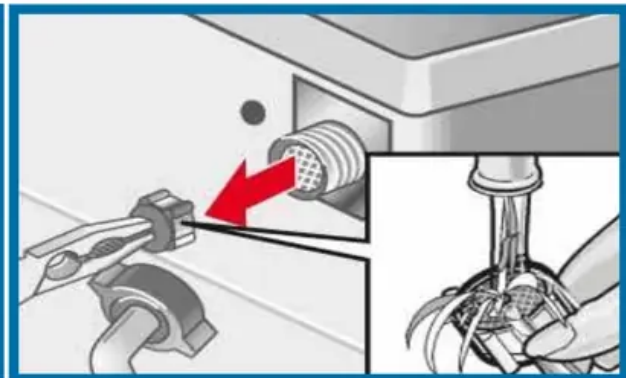
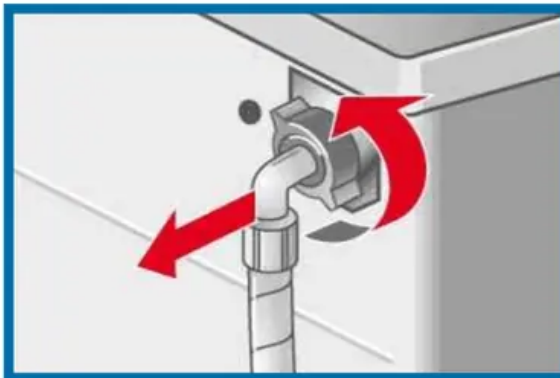

on standard and Aqua-Secure models: Remove the hose from the rear of the appliance.
Take out the filter with a pair of pliers and clean it.

6. Connect the hose and check for leaks.



What to do if...

<p>Water is leaking out.</p>	<ul style="list-style-type: none"> • Attach/replace the drainage hose correctly. • Tighten the screw connection of the supply hose.
<p>No water supply. Detergent not dispensed.</p>	<ul style="list-style-type: none"> • Start/Pause not selected? • Tap not turned on? • Filter blocked? Clean the filter, page 11. • Supply hose kinked or trapped?
<p>Washing machine door cannot be opened.</p>	<ul style="list-style-type: none"> • Safety function active. Programme stopped?, page 4. • - - - - (Rinse stop = no final spin) selected?. page 3,4.
<p>Programme does not start.</p>	<ul style="list-style-type: none"> • Start/Pause or Ready in time selected? • Washing machine door closed? • Childproof lock active? Deactivating, page 5.
<p>Detergent solution is not drained.</p>	<ul style="list-style-type: none"> • - - - - (Rinse stop = no final spin) selected?, page 3, 4. • Clean the detergent solution pump, page 11. • Clean the waste pipe and/or drainage hose.
<p>Water not visible in the drum</p>	<ul style="list-style-type: none"> • Not a fault - water below the visible area.
<p>Spin result not satisfactory. Laundry wet/too damp.</p>	<ul style="list-style-type: none"> • Not a fault - the imbalance monitoring system has interrupted the spin because the laundry is unevenly distributed. • Distribute large and small items of laundry evenly in the drum. Speed selected too low?, page 5.
<p>The programme duration changes during the wash cycle.</p>	<ul style="list-style-type: none"> • Not a fault - the programme cycle is optimised for the particular washing process. This can cause changes in the programme duration on the display panel.
<p>Spin cycle performed several times.</p>	<ul style="list-style-type: none"> • Not a fault - unbalanced-load detection system is adjusting the imbalance

<p>Residual water in the  compartment for care products.</p>	<ul style="list-style-type: none"> • Not a fault - the action of the care product is not affected. • Clean the insert if necessary, page 10.
<p>Odour formation in the washing machine.</p>	<ul style="list-style-type: none"> • Run programme Cottons 90 °C without laundry. Use standard detergent.
<p>Status display  flashing. Appliance has detected a detergent overload.</p>	<ul style="list-style-type: none"> • Too much detergent used? • Mix one tablespoonful of fabric softener with ½ litre water and pour into compartment II (Not for outdoor fabrics, sportswear fabrics or those made with down.) • Reduce the detergent dosage for the next wash cycle.
<p>Loud noises, vibrations and “wandering” during the spin cycle.</p>	<ul style="list-style-type: none"> • Are the appliance feet fixed? Secure appliance feet --> Installation instructions. • Transportation safety devices removed? Remove transportation safety devices --> Installation instructions.
<p>Display panel/indicator lamps do not function during operation.</p>	<ul style="list-style-type: none"> • Power cut? • Circuit breakers tripped? Switch the circuit breakers back on or replace. • If the fault occurs repeatedly, call the after-sales service.
<p>Programme sequence longer than usual.</p>	<ul style="list-style-type: none"> • Not a fault - unbalanced-load detection system is adjusting the imbalance by repeatedly redistributing the laundry. • Not a fault - foam detection system active - adds an additional rinse cycle.
<p>There are detergent residues on the laundry.</p>	<ul style="list-style-type: none"> • Occasionally, phosphate-free detergents contain water-insoluble residues. • Select Rinse or brush down the laundry after washing.

If you cannot correct a fault yourself (switching on/off) or a repair is required:

- Turn the programme selector to Off and remove the mains plug from the socket.

- Turn off the water supply and call the after-sales service --> Installation instructions.

Warning

This content is compiled from multiple sources and is provided for reference purposes only. It may not be complete or fully applicable to all situations. If you are unable to resolve your issue, please contact the product manufacturer or an authorized service provider for official support.

Document generated by [ManualsFile](#)