

TECHNICAL DATA

- Voltage: 110-120 V AC 60 Hz
- Rated power: 68 W
- Noise level: <66 dB(A)
- Unit dimensions: 22"H x 9.9"W x 10.9"D
- Unit weight: 15.5 lbs.

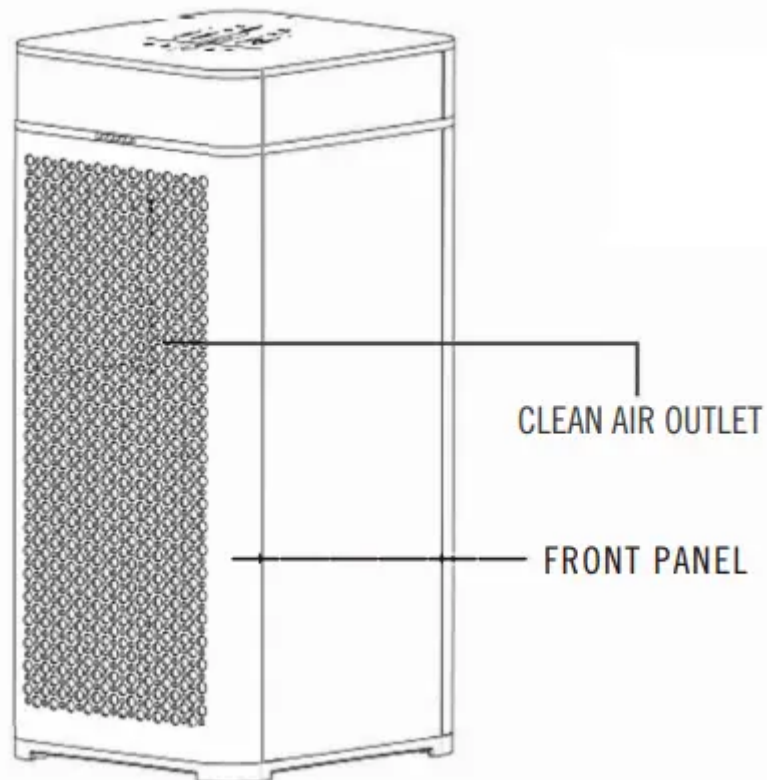

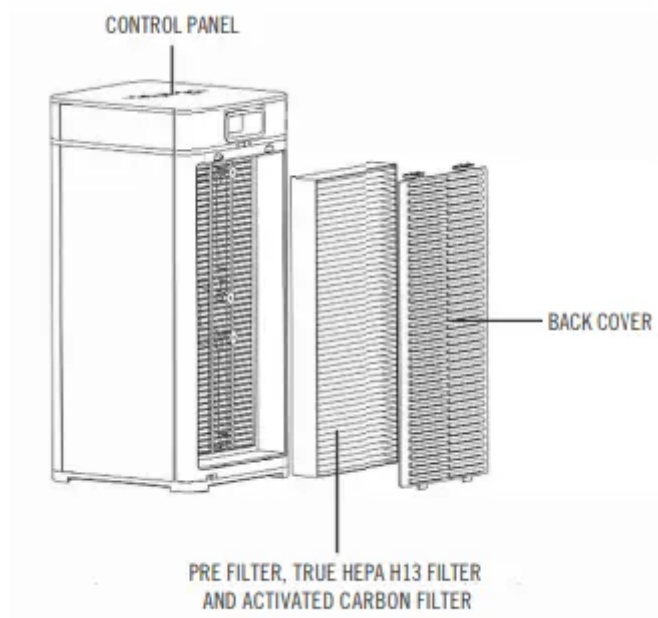
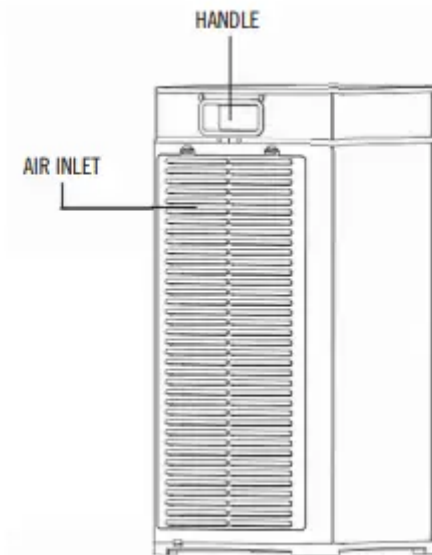

BEFORE USE

OPENING AND REPLACING THE BACK COVER

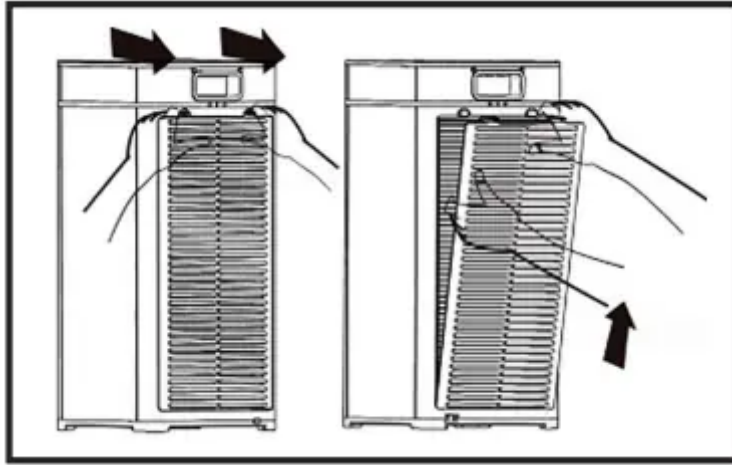

1. Press the tabs on the back cover and pull on the cover. Then lift the back cover and pull out slightly.

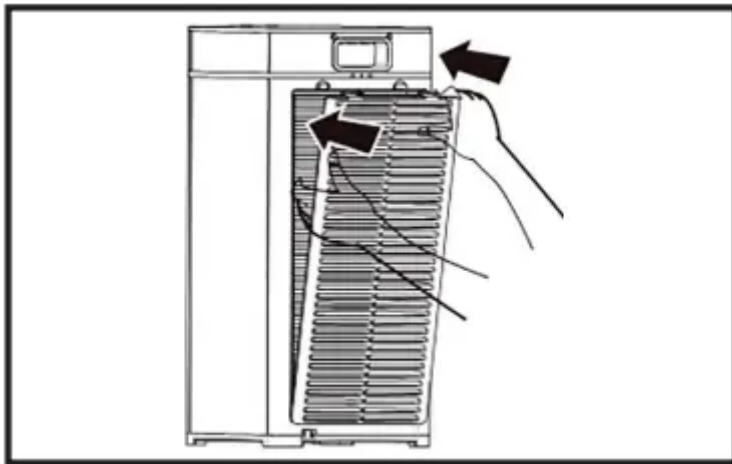

2. To reinstall the side covers, align the fixed slots and insert the covers into the slots. The covers will automatically snap back into place.

INSTALLING THE AIR PURIFIER

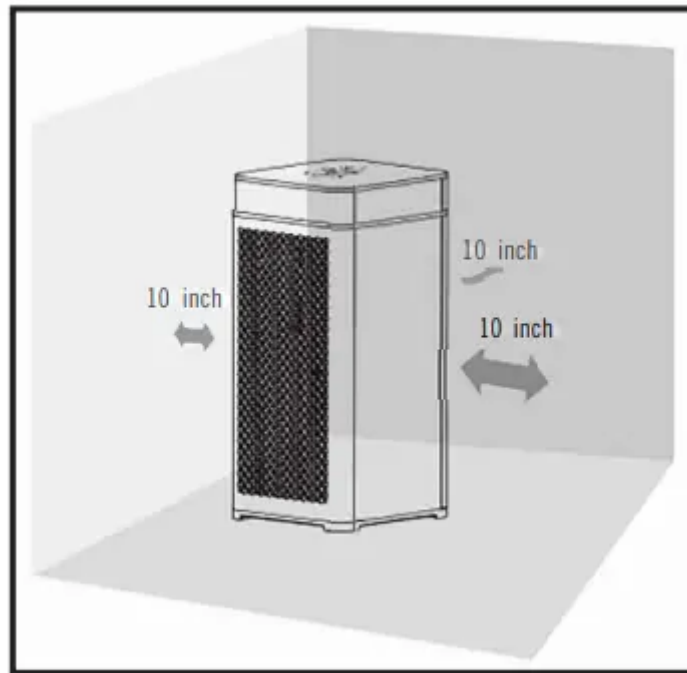

Do not obstruct the air intake or the clean air outlet. To ensure proper air circulation, leave at least 10" space between the back air intake and the wall or the furniture.

INSTALLING THE FILTER

The 3 stage Medify filter is a one-piece filter for higher performance. Remove the old filter by pulling on the small tab at top. When reinstalling the new filter, make sure to push it back in and make sure it is in snug for maximum performance.



1. Place the machine in a dry location and on a smooth and flat surface.

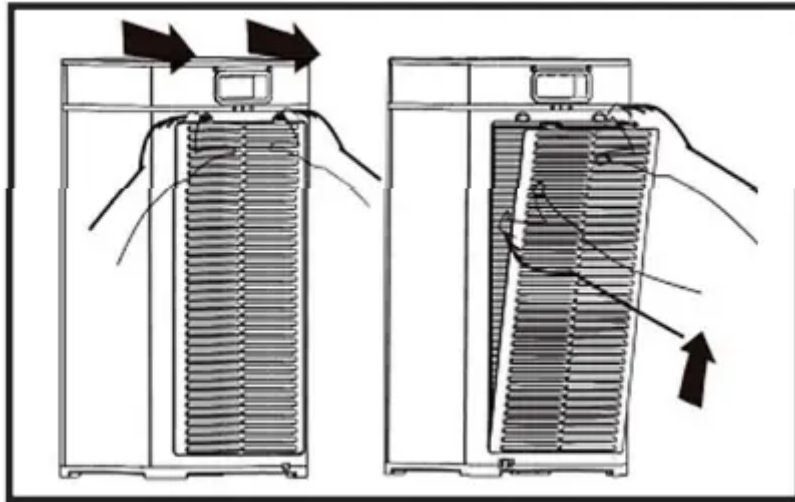

2. Press the top buttons in the back cover and pull the cover. Lift the back cover and pull out slightly.

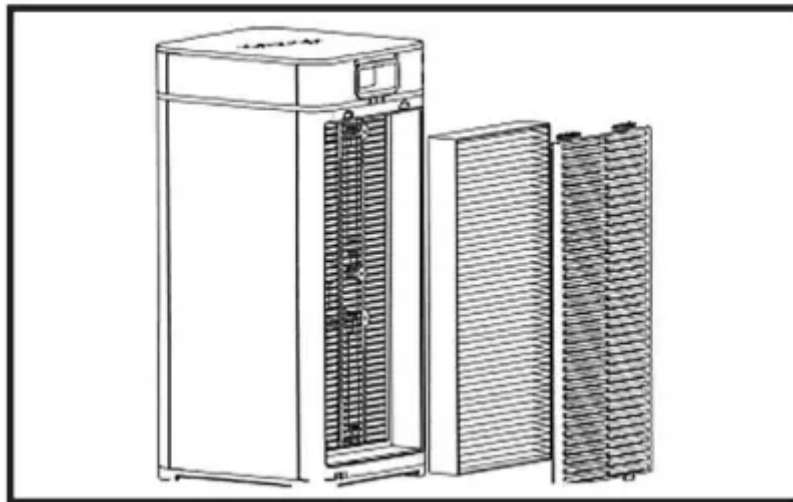

3. Remove the filter by pulling on the small tab at the top of filter.

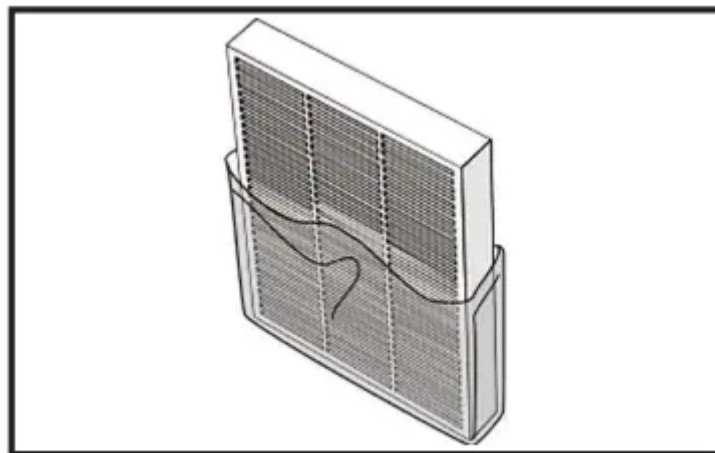

4. Remove any plastic packaging from the new filter before installing it in the air purifier.

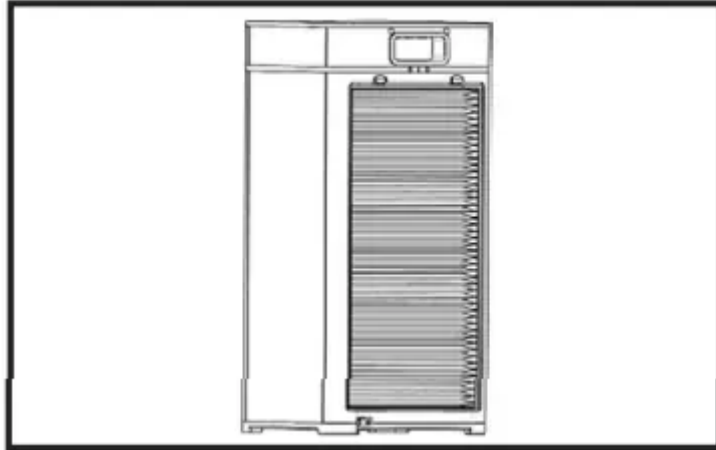

5. Place the new filter in the air purifier with the white side facing out to you. The tab at the top of the filter should be facing you.

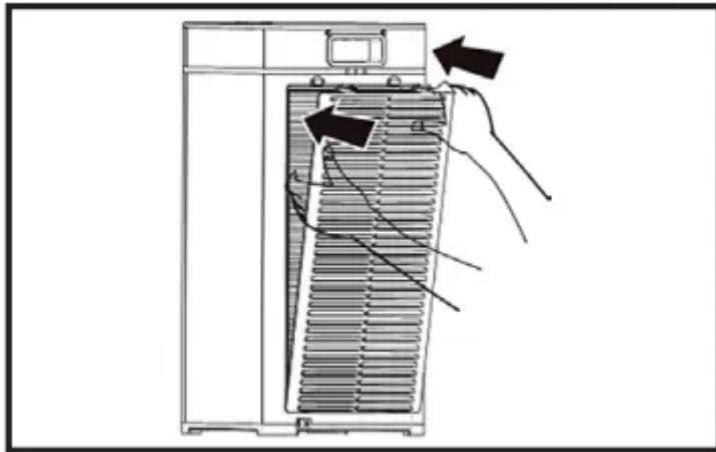

6. Replace the back cover.

ATTENTION

Remove all plastic packaging from the filter before installing. it. DO NOT run the air purifier if there is no filter installed.



CONTROL PANEL

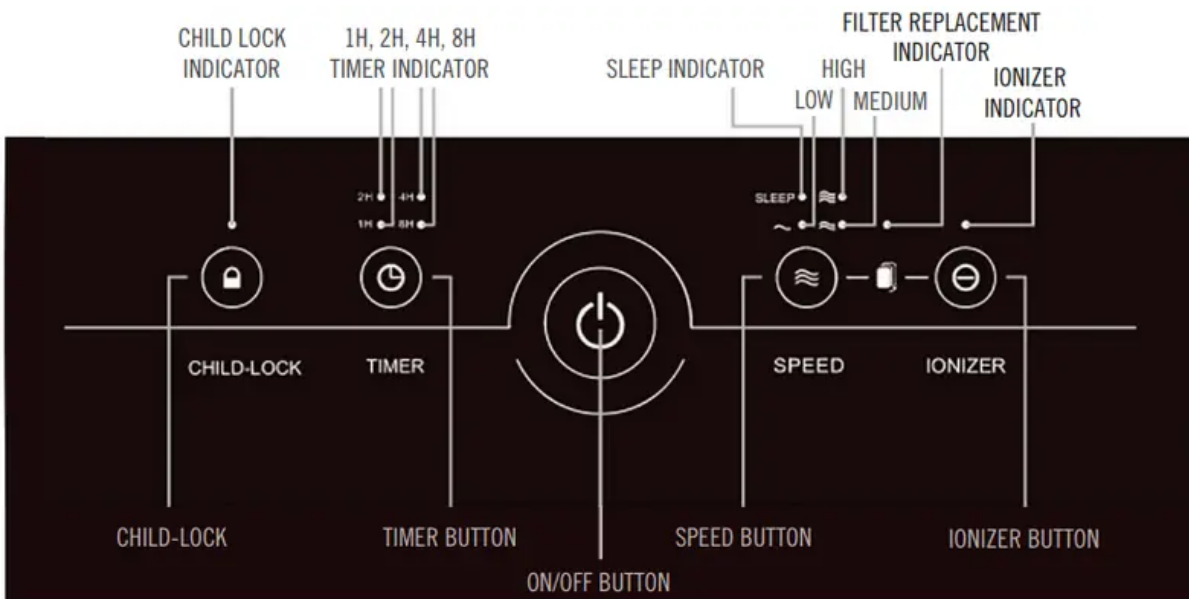



HOW TO USE

BEFORE TURNING THE UNIT ON

- Take the air purifier out of the box and remove the clear protective plastic bag.
- Place the air purifier on a firm, leveled surface.
- Plug the power cord into a standard AC outlet. After plugging it in, the air purifier will beep. All the indicator lights will flash 1 time, including the power light indicator. Then, the unit will enter standby mode.

POWER BUTTON AND FAN SPEED SETTINGS

- To turn the air purifier on, press the power  button.
- The unit will start working in low speed. Press the  button again so the machine stops and enters standby mode.
- This air purifier has 3 fan speed settings: low, medium, high and sleep mode. The higher the fan speed setting, the faster the air will be purified. To select or change fan speed, press the fan speed button until the desired setting is reached.

TIMER

Press the timer button and choose your preferred hour option: 1, 2, 4, 8 or no timer.

IONIZER MODE

Ionizer is an On/Off function. You can choose to leave it on or off at your discretion. When Ionizer is on, the indicator light will be lit.

CHILD-LOCK BUTTON

In this mode, none of the function keys can be used or changed (except the child lock function). To turn on the child lock, hold the button down for 3 to 5 seconds. To turn off the child lock function, hold the button down for 30 to 45 seconds.

CLEANING AND MAINTENANCE

Unplug the air purifier before cleaning it. Do not use too much water to clean the unit. Use a soft and wet cloth to clean the unit. Do not ever use any cleaners or chemicals on the air purifier.

CLEANING THE AIR PURIFIER

From time to time, if you see too much dust accumulated on the unit, wipe it with a clean dry cloth. Also make sure that both air intake and vents are free from dust. DO NOT vacuum or try to wash the filter as it will clog it.

FILTER REPLACEMENT

LIGHT INDICATOR TO REPLACE THE FILTER

It reminds the user when the filter needs to be replaced. The indicator icon will become lit when the filter needs to be replaced.

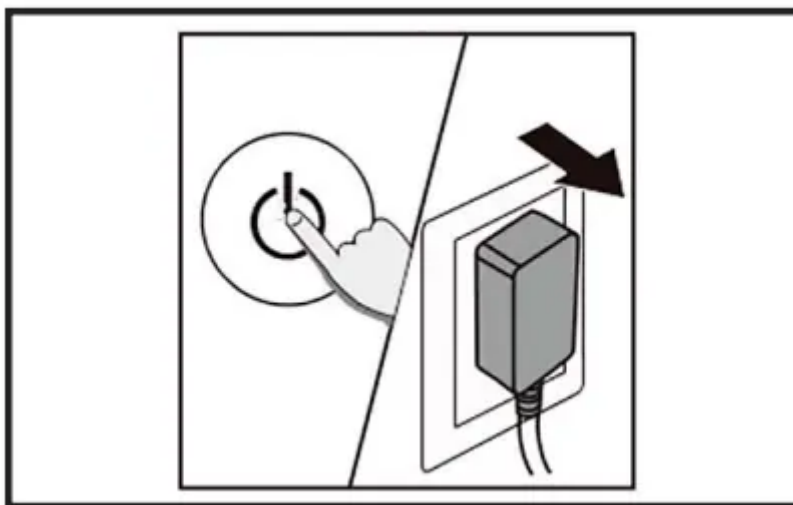

1. Indicator Lights will show the user if the filters need to be replaced. Make sure to unplug the unit before changing the filter.

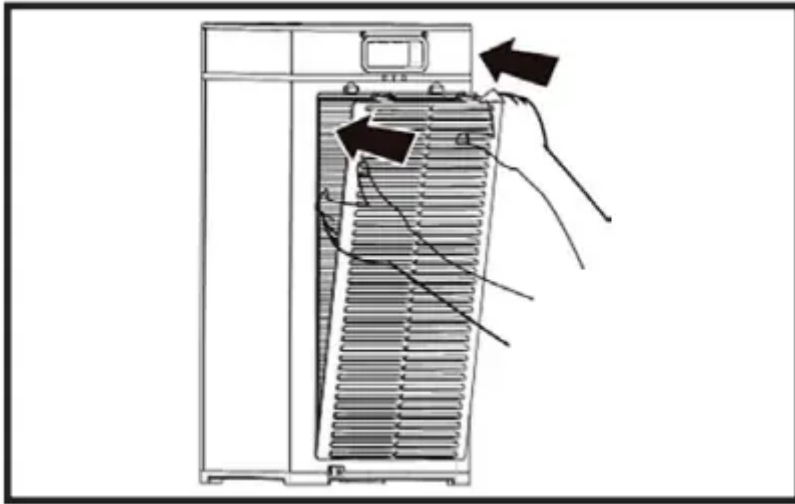

2. Press the top buttons on the back cover and pull the cover. Lift the back cover and pull out slightly.

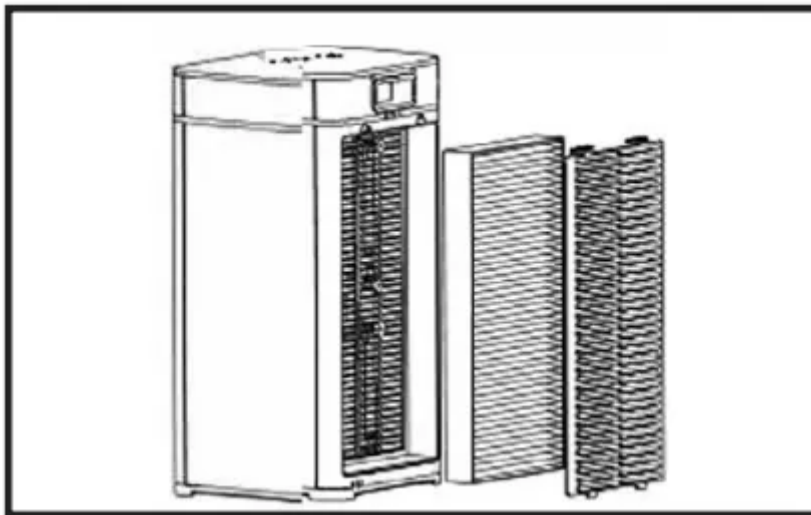

3. Remove the old filter from the unit by pulling on the tab at the top.

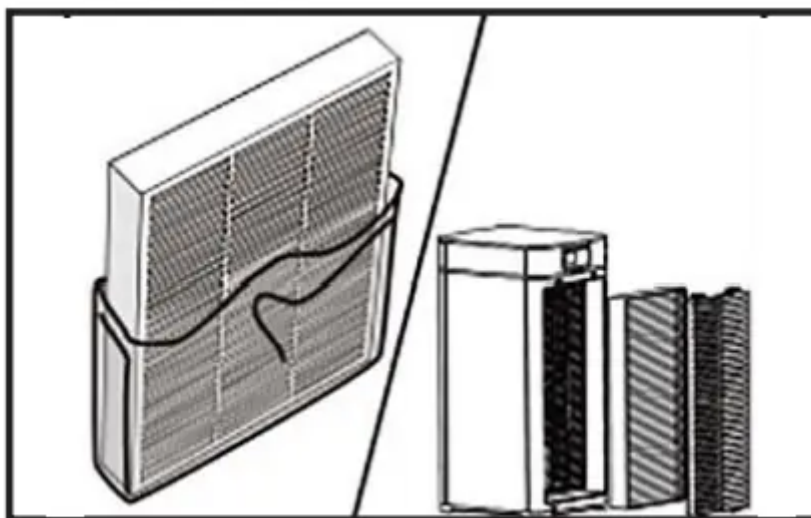

4. Remove any plastic packaging from the new filter before installing it in the air purifier. Place the new filter in the air purifier with the white side facing to you.

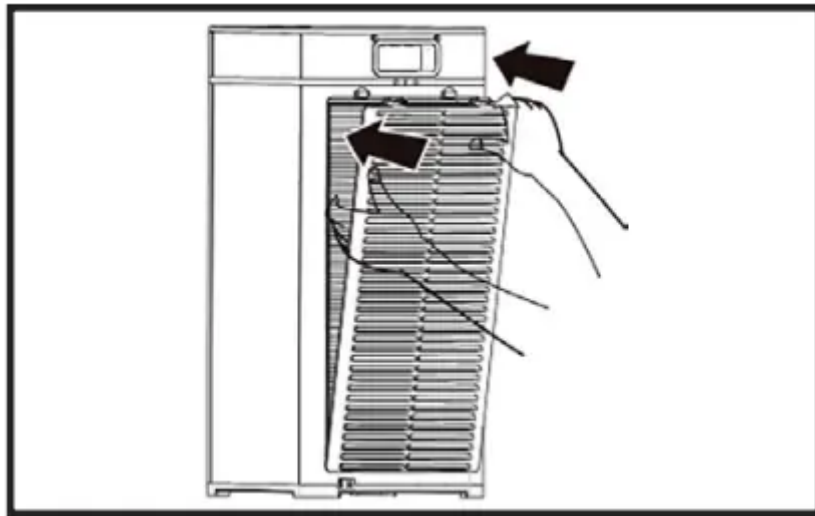

5. Replace the back cover.

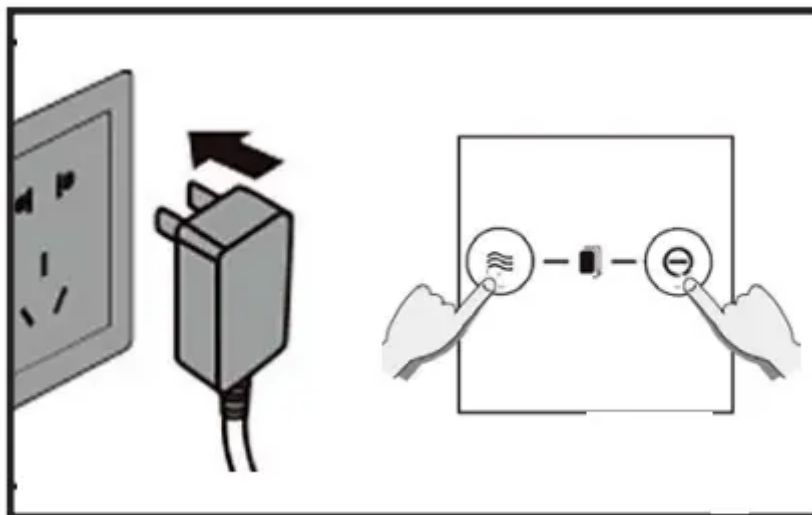

6. Resetting the Filter indicator Light: Once the new filter has been installed and the unit is turned back on: Hold down the FAN SPEED button and the IONIZER button at the same time for 3-5 seconds. Then, the indicator light will go off and the timer will be reset for 3000 hours.

Warning

This content is compiled from multiple sources and is provided for reference purposes only. It may not be complete or fully applicable to all situations. If you are unable to resolve your issue, please contact the product manufacturer or an authorized service provider for official support.