

## Safety instructions

- Disconnecting the Device from the Main Power
- The power plug is the disconnecting device. In case of an emergency, the power plug must remain readily accessible.
- Do not let your children climb or cling onto the TV. Otherwise, the TV may fall over, which may cause serious injury.

### Outdoor Antenna Grounding (Can differ by country):

- If an outdoor antenna is installed, follow the precautions below. An outdoor antenna system should not be located in the vicinity of overhead power lines or other electric light or power circuits, or where it can come in contact with such power lines or circuits as death or serious injury can occur.

### Grounding (Except for devices which are not grounded.)

- TV with a three-prong grounded AC plug must be connected to a three-prong grounded AC outlet. Ensure that you connect the earth ground wire to prevent possible electric shock.
- Never touch this apparatus or antenna during a lightning storm. You may be electrocuted.
- Make sure the power cord is connected securely to the TV and wall socket if not secured damage to the Plug and socket may occur and in extreme cases a fire may break out.
- Do not insert metallic or inflammable objects into the product. If a foreign object is dropped into the product, unplug the power cord and contact the customer service.
- Do not touch the end of the power cord while it is plugged in.

### You may be electrocuted.

1. If any of the following occur, unplug the product immediately and contact your local customer service.
2. The product has been damaged.
3. If water or another substance enters the product (like an AC adapter, power cord, or TV).
4. If you smell smoke or other odors coming from the TV
5. When lightning storms or when unused for long periods of time.
6. Even the TV is turned off by remote control or button, AC power source is connected to the unit if not unplugged in.
7. Do not use high voltage electrical equipment near the TV e.g., a bug zapper). This may result in product malfunction.

8. Do not attempt to modify this product in any way without written authorization from LG Electronics. Accidental fire or electric shock can occur. Contact your local customer service for service or repair. Unauthorized modification could void the user's authority to operate this product.

## **Moving**

1. When moving, make sure the product is turned off, unplugged, and all cables have been removed. It may take or more people to carry larger TVs.
2. Do not press or put stress on the front panel of the TV. Otherwise, this may result in product damage, fire hazard or injury.
3. Keep the packing anti-moisture material or vinyl packing out of the reach of children.
4. Do not allow an impact shock, any objects to fall into the product, and do not drop anything onto the screen.
5. Do not press strongly upon the panel with a hand or a sharp object such as a nail, pencil, or pen, or make a scratch on it. It may causedamage to screen.

## **Cleaning**

1. When cleaning, unplug the power cord and wipe gently with a soft/dry cloth. Do not spray water or other liquids directly on the TV.
2. Do not clean your TV with chemicals including glass cleaner, any type of air freshener, insecticide, lubricants, wax (car, industrial), abrasive, thinner, benzene, alcohol etc., which can damage the product and/or its panel. Otherwise, this may result in electric shock or product damage.

## **Preparing**

### **Securing TV to the Wall**

1. Insert and tighten the eye-bolts, or TV brackets and bolts on the back of the TV.
2. If there are bolts inserted at the eye-bolts position, remove the bolts first.
3. Mount the wall brackets with the bolts to the wall. Match the location of the wall bracket and the eye-bolts on the rear of the TV.
4. Connect the eye-bolts and wall brackets tightly with a sturdy rope. Make sure to keep the rope horizontal with the flat surface.
5. Use a platform or cabinet that is strong and large enough to support the TV securely.
6. Brackets, bolts and ropes are not provided. You can obtain additional accessories from your local dealer.

## Mounting to the Wall

- Attach an optional wall mount bracket at the rear of the TV carefully and install the wall mount bracket on a solid wall perpendicular to the floor.
- When you attach the TV to other building materials, please contact qualified personnel. LG recommends that wall mounting be performed by a qualified professional installer. We recommend the use of LG's wall mount bracket.
- LG's wall mount bracket is easy to move with cables connected.
- When you do not use LG's wall mount bracket, please use a wall mount bracket where the device is adequately secured to the wall with enough space to allow connectivity to external devices. It is advised to connect all the cables before installing fixed wall mounts.

## Wall Mounting Bracket Depending on model)

- Make sure to use screws and wall mount bracket that meet the VESA standard. Standard dimensions for the wall mount kits are described in the following table.

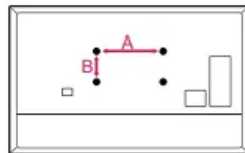

|                           |                 |
|---------------------------|-----------------|
| <b>Model</b>              | OLED55/65/77G1* |
| <b>VESA (A x B) (mm)</b>  | 300 x 300       |
| <b>Standard screw</b>     | M6              |
| <b>Number of screws</b>   | 4               |
| <b>Wall mount bracket</b> | OLW480B         |

## Before Installation

1. Do not use the product for any purpose other than installing the TV on a wall.
2. Avoid product damage and safety accidents caused by careless installing or use of improper or unauthorized wall mount.
3. Follow the instructions in the installation manual for a convenient installation of the wall mount.
4. Immediately discontinue installation and contact the service centre if you cannot fully understand the installation process.
5. Use a professional installer if any installation issues remain after the inquiry.
6. Installation of this product on a concrete wall or wood stud is recommended. Installation of this product on other surfaces (Dry wall, plywood, bricks, etc.) is not recommended. Improper installation may result in the product falling.

7. Install the product only on a vertical wall.
8. Do not install on a tilted wall that exceeds building standards or on the heavily tilted wall or ceiling.
9. LG is not responsible for problems caused by improper installation of the product, e.g., heavily tilted walls and ceilings.

### **How to fix anchors and screws**

1. Please make sure that:
2. Check that the material and thickness of the wall and finishing material comply with the installation manual. Before beginning the mounting process, you must be sure the wall is able to support the weight of the TV.
3. Should use the enclosed anchors and screws on crack-free concrete walls.
4. Never install the product on a plasterboard or wall made of paper or medium-density fiberboard (MDF). When it is necessary to install the product on such wall, anchor screws must be fastened to retaining walls (concrete) or wood Stud inside the finishing material.
5. The wall mount should be attached to a stud. This usually will not be a problem, but depending on individual circumstances, there may be cases when the ability to mount into a stud is not possible. In this case, there are a variety of drywall anchors, such as toggle bolts, which may provide a solution.
6. If using drywall anchors, please be sure the anchors and the wall have the ability to support the weight of your TV. Please note that the supplied anchors may not be the correct ones for your individual situation, so you should check with a local professional.
7. Other unspecified walls must be capable of supporting pullout loads of over 70kgf (686 N) and shear loads of over 100kgf (980 N) per fastener.
8. Use an Ø 8 mm drill bit for concrete and a hammer (impact) drill or Ø 4 mm drill bit for wood stud to drill holes.

### **For installation on concrete wall**

- Drill holes in anchor locations with a drill bit of Ø 8 mm to a depth of 80 mm to 100 mm.

### **Clean the drilled holes.**

- Insert the enclosed anchors for fixing the wall mount into the holes. (Use a hammer when inserting anchors.)

### **Wall mounting anchor**

- Push the wall mount support closely toward the wall to match the hole locations.
- Tighten screws for fixing the wall mount to the holes. At this time, tighten the screws to a torque of between 45kgf/cm to 60kgf/cm.

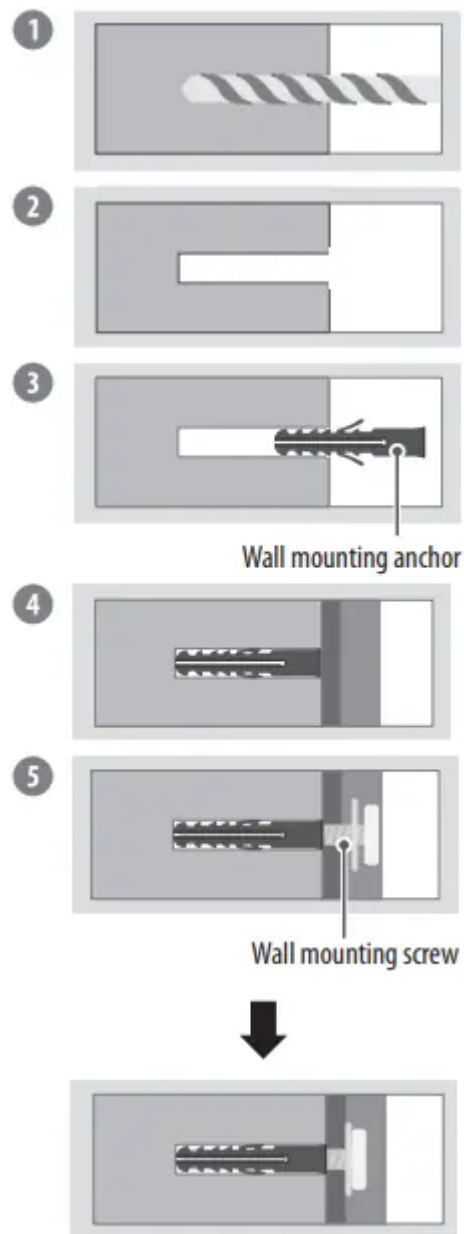

### Antenna/Cable

1. Connect the TV to a wall antenna socket with an RF cable (75 Ω).
2. Use a signal splitter to use more than 2 TVs.
3. If the image quality is poor, install a signal amplifier properly to improve the image quality.
4. If the image quality is poor with an antenna connected, try to realign the antenna in the correct direction.
5. An antenna cable and converter are not supplied.
6. For a location that is not supported with Ultra HD broadcasting, this TV cannot receive Ultra HD broadcasts directly.

# Starting TV

## Adjusting the menu

- When the TV is turned on, press the button one time. You can adjust the Menu items using the button.
- Turns the power off. Changes the input source.
- Adjusts the volume level. Scrolls through the saved programmes.
- Note • Your TV's OSD (On Screen Display) may differ slightly from that shown in this manual.
- The available menus and options may differ from the input source or product model that you are using.
- New features may be added to this TV in the future.
- The device must be easily accessed to a location outlet near the access. Some devices are not made by turning on / off button, turning off the device and unplugging the power cord.

## Inserting the battery

- When the message [Magic Remote battery is low. Please change the battery.] is displayed, replace the battery.
- To replace batteries, open the battery cover, replace batteries (1.5 V AA) matching the and ends to the label inside the compartment, and close the battery cover.
- Do not mix new batteries with old batteries. This may cause the batteries to overheat and leak.
- Failure to match the correct polarities of the battery may cause the battery to burst or leak, resulting in fire, personal injury, or ambient pollution.
- This apparatus uses batteries. In your community there might be regulations that require you to dispose of these batteries properly due to environmental considerations. Please contact your local authorities for disposal or recycling information.
- Batteries inside or inside the product shall not be exposed to excessive heat such as sunshine, fire or the like.

## How to register the Magic Remote Control

1. To use the Magic Remote, first pair it with your TV.
2. Put batteries into the Magic Remote and turn the TV on.
3. Point the Magic Remote at your TV and press the Wheel (OK) on the remote control.
4. If the TV fails to register the Magic Remote, try again after turning the TV off and back on.
5. How to deregister the Magic Remote Control

6. Press the (Back) and (Home) buttons at the same time, for five seconds, to unpair the Magic Remote with your TV.
7. Press and hold the (Home) and (Q. Settings) buttons for more than 5 seconds to disconnect and re-register the Magic Remote at the same time.
8. It is recommended that an Access Point (AP) be located more than 0.2 m away from the TV. If the AP is installed closer than 0.2 m, the
9. Magic remote control may not perform as expected due to frequency interference.

### Using the NFC Feature

1. NFC is technology that uses Near Field Communication, allowing you to conveniently send and receive information without separate settings.
2. By bringing a smart device near the NFC-enabled remote control, you can install the LG ThinQ app and connect the device to the TV.
3. Turn on NFC in the smart device's settings. To use NFC with Android devices, set the NFC option to enable 'read/write tags' in the smart device's settings. The NFC settings may vary depending on the device.
4. Bring the smart device near the (NFC) on the remote control. The required distance for NFC tagging is about 1 cm.
5. Follow the instructions to install the LG ThinQ app on your smart device.
6. Retagging the smart device to the remote control allows you to conveniently access various features on the connected TV through the LG ThinQ app.

## Connections

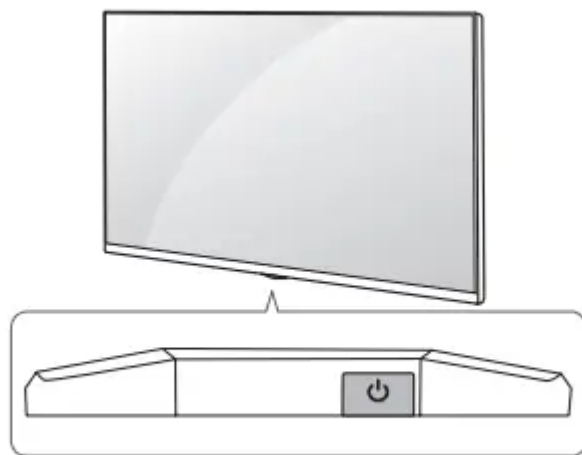

### External Devices

- The external device connection may differ from the model.

- Connect external devices to the TV regardless of the order of the TV port.
- If you record a TV programme on a Blu-ray/DVD recorder or VCR, make sure to connect the TV signal input cable to the TV through a DVD recorder or VCR.
- For more information of recording, refer to the manual provided with the connected device.
- Refer to the external equipment's manual for operating instructions.
- If you connect a gaming device to the TV, use the cable supplied with the gaming device.
- In PC mode, there may be noise associated with the resolution, vertical pattern, contrast or brightness. If noise is present, change the PC output to another resolution, change the refresh rate to another rate or adjust the brightness and contrast on the [Picture] menu until the picture is clear.
- In PC mode, some resolution settings may not work properly depending on the graphics card.
- If Ultra HD content is played on your PC, video or audio may become disrupted intermittently depending on your PC's performance. (Depending on model)
- When connecting via a wired LAN, it is recommended to use a CAT 7 cable. (Only when port is provided.)

## Troubleshooting

### Cannot control the TV with the remote control.

- Check the remote control sensor on the product and try again.
- Check if there is any obstacle between the product and the remote control.
- Check if the batteries are still working and properly installed ( to , to ).

### No image display and no sound is produced.

- Check if the product is turned on.
- Check if the power cord is connected to a wall outlet.
- Check if there is a problem in the wall outlet by connecting other products.

### The TV turns off suddenly.

1. Check the power control settings. The power supply may be interrupted.
2. Check if the auto-off function is activated on the settings related time.
3. If there is no signal while the TV is on, the TV will turn off automatically after 15 minutes of inactivity.

### When connecting to the PC (HDMI), no signal is detected.

- Turn the TV off/on using the remote control.

- Reconnect the HDMI cable.
- Restart the PC with the TV on.

### **Abnormal Display**

- If the product feels cold to the touch, there may be a small “flicker” when it is turned on. This is normal, there is nothing wrong with product.
- This panel is an advanced product that contains millions of pixels. You may see tiny black dots and/or brightly coloured dots (white, red, blue or green) at a size of 1 ppm on the panel.
- This does not indicate a malfunction and does not affect the performance and reliability of the product. This phenomenon also occurs in third-party products and is not subject to exchange or refund.
- You may find different brightness and colour of the panel depending on your viewing position(left/right/ top/down).
- This phenomenon occurs due to the characteristic of the panel.
- It is not related with the product performance, and it is not malfunction.

### **Generated Sound**

1. “Cracking” noise: A cracking noise that occurs when watching or turning off the TV is generated by plastic thermal contraction due to temperature and humidity. This noise is common for products where thermal deformation is required.
2. Electrical circuit humming/panel buzzing:
3. A low level noise is generated from a high-speed switching circuit, which supplies a large amount of current to operate a product. It varies depending on the product.
4. This generated sound does not affect the performance and reliability of the product.

### **Specifications**

## HDMI

- When connecting the HDMI cable, the product and external devices should be turned off and unplugged.



- Supported HDMI Audio format (Depending on model):  
True HD (48 kHz),  
Dolby Digital / Dolby Digital Plus (32 kHz, 44.1 kHz, 48 kHz),  
PCM (32 kHz, 44.1 kHz, 48 kHz, 96 kHz, 192 kHz)

### ✔ Note

If the device connected to Input Port also supports HDMI Deep Colour, your picture may be clearer. However, if the device doesn't support it, it may not work properly. In that case, change the TV's [HDMI Deep Colour] setting to off.

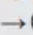
-  →  → [General] → [Devices] → [HDMI Settings] → [HDMI Deep Colour]
  - On: Support 4K @ 50/60 Hz (4:4:4, 4:2:2, 4:2:0), 4K @ 100/120 Hz (4:4:4, 4:2:2, 4:2:0)
  - Off: Support 4K @ 50/60 Hz (4:2:0)
- Use a certified cable with the HDMI logo attached.
- If you do not use a certified HDMI cable, the screen may not display or a connection error may occur.
- Recommended HDMI Cable Types
  - Ultra High Speed HDMI<sup>®</sup>/™ cable (3 m or less)

## USB

Some USB Hubs may not work. If a USB device connected using a USB Hub is not detected, connect it to the USB port on the TV directly.



### ✔ Note

- For an optimal connection, HDMI cables and USB devices should have bezels less than 10 mm thick, 18 mm width and 8 mm a wire diameter. Use an extension cable that supports USB 2.0 or higher if the USB cable or USB memory stick does not fit into your TV's USB port.

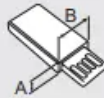
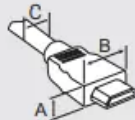

\* A ≤ 10 mm

\* B ≤ 18 mm

\* C ≤ 8 mm

## Warning

This content is compiled from multiple sources and is provided for reference purposes only. It may not be complete or fully applicable to all situations. If you are unable to resolve your issue, please contact the product manufacturer or an authorized service provider for official support.