

# Features

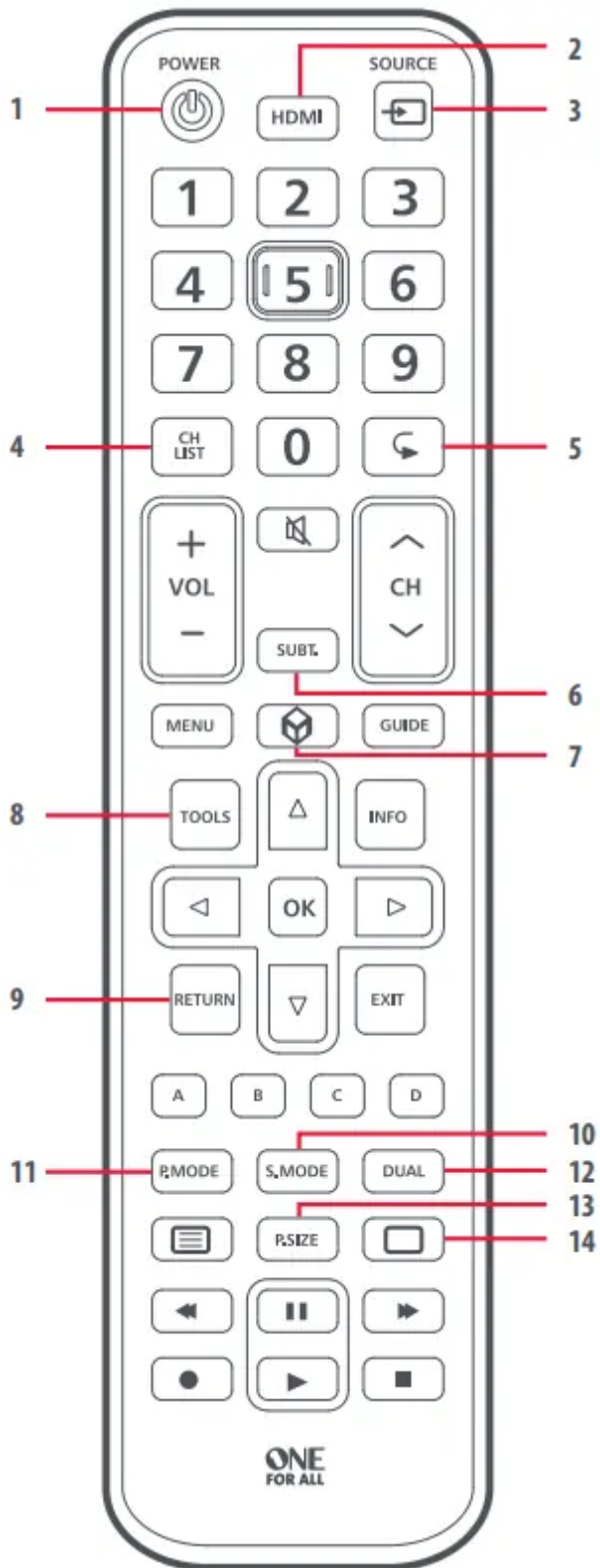

## 1. POWER

Power Key

## 2. HDMI



Direct access to your attached HDMI Devices

### **3. SOURCE**

AV Input

### **4. CH LIST**

Channel List

### **5. LAST**

Previous Channel

### **6. CC**

Closed Captions / Subtitles

### **7. SMART HUB**

Smart Hub / Centre intelligent

### **8. TOOLS**

Tools, Options

### **9. RETURN**

Return, Back

### **10. S. MODE**

Sound Mode

### **11. P. MODE**

Picture Mode

### **12. DUAL**

I-II

### **13. P. SIZE**

Picture Size

### **14. ANT**

Antenna / TV

## Batteries

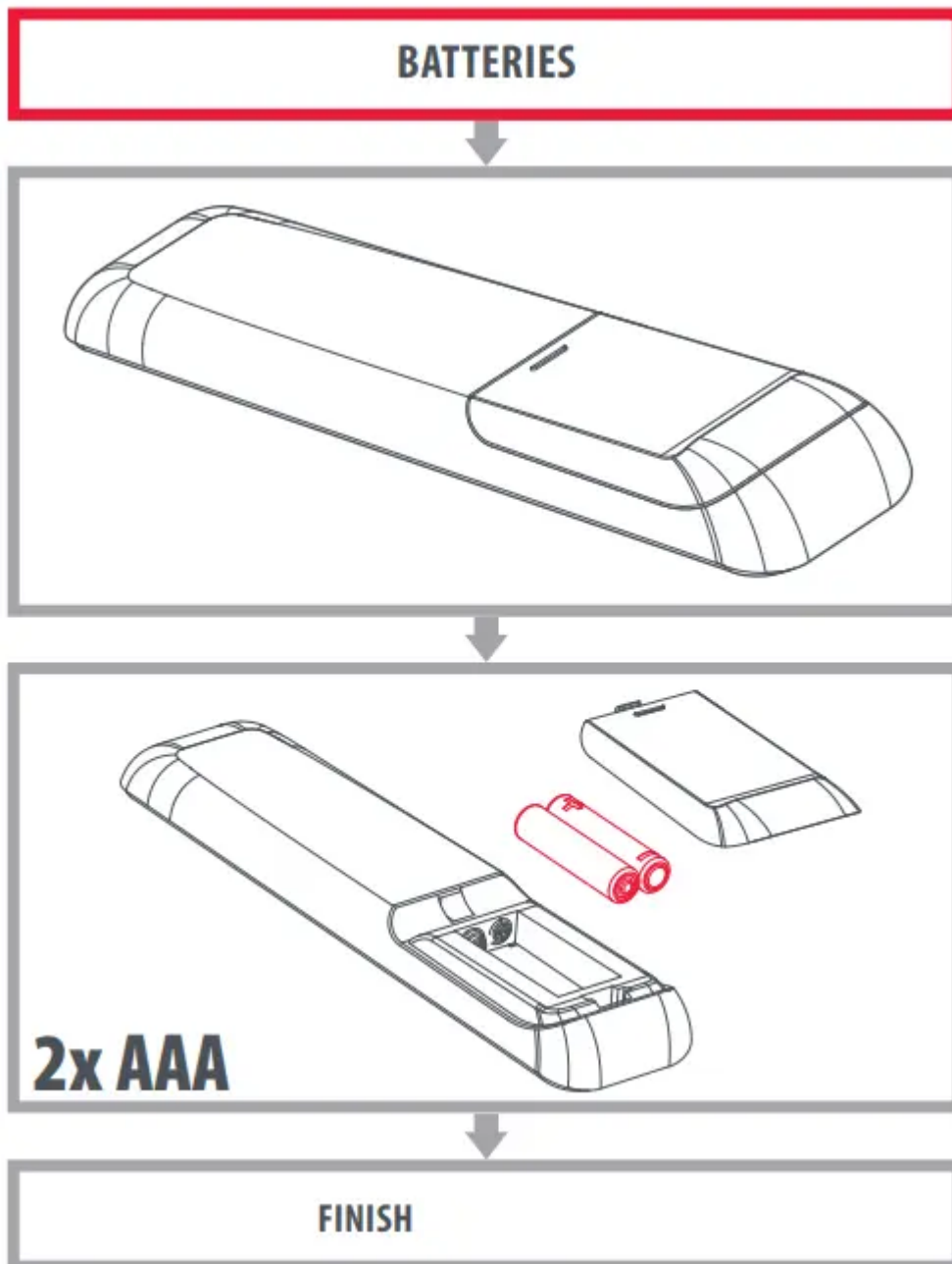

## Using Remote Control

### Step 1: Set up your television

THE MAJORITY OF NEWER SAMSUNGS TVS SHOULD WORK DIRECTLY.

After putting batteries in, just test some of the keys, and if they work, your remote is ready. If not, follow the next steps:

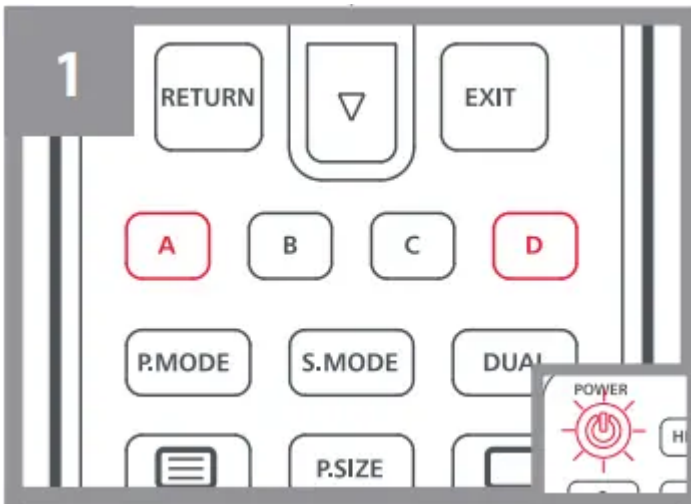

Make sure your TV is on (not on standby).

Hold down RED + BLUE until the LED behind the Power Key blinks twice



Point towards the TV and hold down the POWER KEY until the TV turns off .

The remote will send a different Power signal every 3 seconds As soon as the TV turns off , let go of the POWER KEY.

The LED will blink twice. Now test the rest of the keys on the remote, if they work as your original did, your remote is ready to use.

=> FINISH

If you find some keys still do not work as expected (or at all), proceed to the next step.

**Step 2: If step 1 does not work as expected**

ARE SOME KEYS NOT WORKING AS EXPECTED?

If you find some keys do not work as expected (or at all), proceed to the next step.



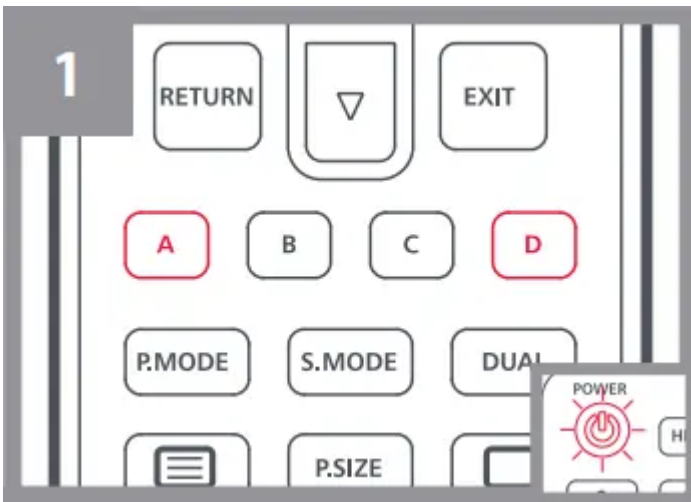

Make sure your TV is on (not on standby).

Hold down RED + BLUE until the LED behind the Power Key blinks twice



Point towards the TV and hold one of the keys that is not working correctly (for example MENU).

The remote will send a signal every 3 seconds. When the correct function is shown on the screen (in this case the MENU), let go of the key.

The LED will blink twice - your remote is ready to use

=> FINISH

## LEARNING

START: LEARN A NEW FUNCTION TO YOUR REMOTE

Your One For All remote can learn any function from your original (working) remote.

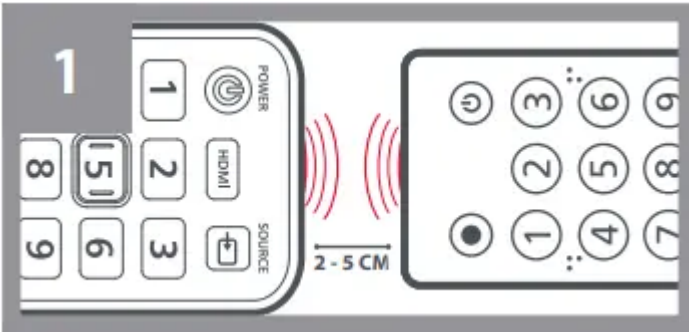

Place the original remote facing the One For All remote on a flat surface.

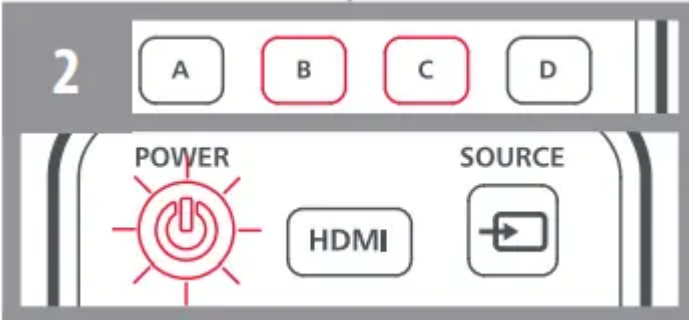

To learn:

Hold down GREEN + YELLOW until the LED blinks twice



Press 975

The LED will blink twice.

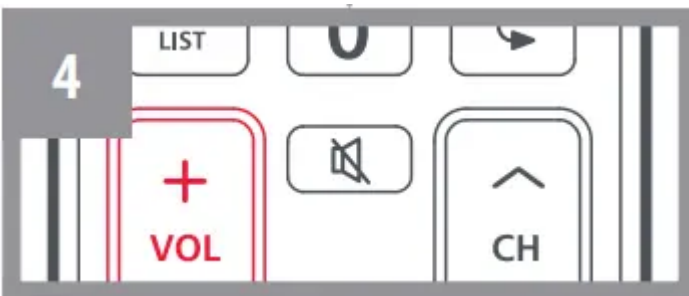

Press the key on the One For All remote you want to learn on, for Example: the VOL + key

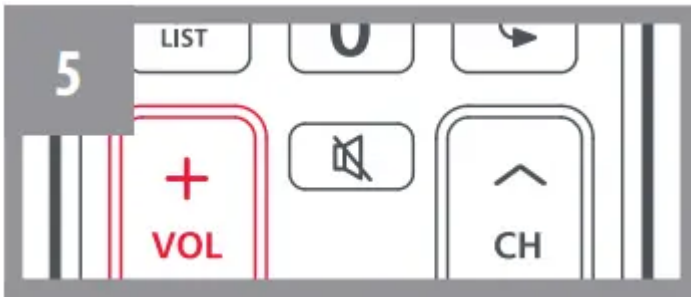

Press the key on the Original remote you want to learn, for Example: the VOL + key of your AUDIO Device

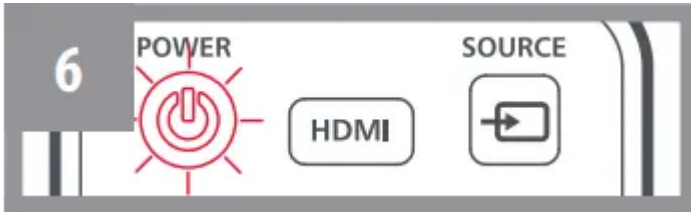

Two blinks: ok. Repeat from step 4 for any more keys to learn.

Long blink: try again from step 4.

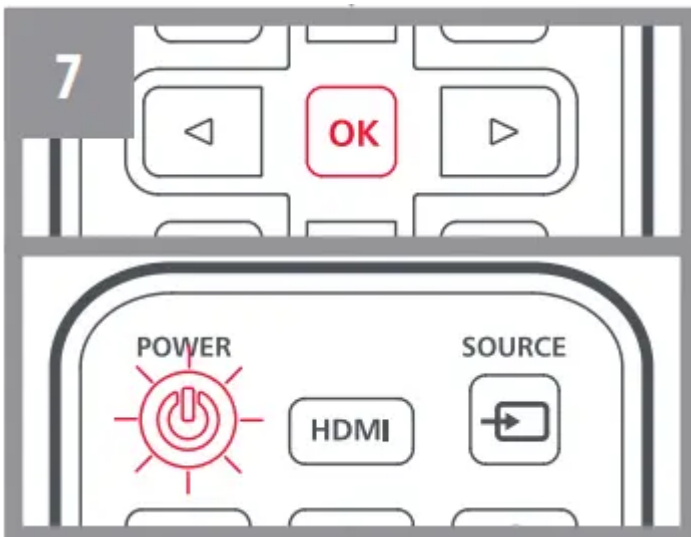

When you have learned all the keys you need, press and hold the OK KEY for 3 seconds. The LED will blink twice

=> FINISH

#### HOW TO DELETE A LEARNED FUNCTION

1. Hold down GREEN + YELLOW until the LED blinks twice.
2. PRESS 976.
3. Press the key to reset twice.

The LED flashes twice and the key will get back the original function

**Warning**

This content is compiled from multiple sources and is provided for reference purposes only. It may not be complete or fully applicable to all situations. If you are unable to resolve your issue, please contact the product manufacturer or an authorized service provider for official support.

---

Document generated by [ManualsFile](#)