

## FEATURES

### GET TO KNOW YOUR AIR CLEANER

Your true HEPA air cleaner removes up to 99.97% of airborne allergens as small as 0.3 microns, including ragweed pollen, grass pollen, tree pollen, household dust, dust mite debris, mold spores, pet dander and smoke from the air passing through the filter.

### IONIZER

This appliance has an optional ionizer feature which, when turned on, releases negative ions into outgoing filtered air to help the air purification process.

#### **What Are Ions?**

Ions are tiny particles that carry a positive or negative charge. They exist naturally around us: in the air, water, and ground. Both positive and negative ions are colorless, odorless, and completely harmless.

#### **How Does The Ionizer Work?**

Negative ions help air purification by attaching themselves to very small airborne particles in the room. These particles take on a negative charge and may join with positively charged particles such as dust, pollen, smoke, and pet dander to form larger particles. These larger particles are then more easily captured by the filter system.

#### **Important Notes:**

Your ionizer may produce an occasional popping or cracking sound. This is normal and occurs when a small buildup of ions is discharged.

After extended use, you may notice dust around the grills or front panel. This is caused by negative ions exiting the air outlet, evidence of the ionizer's air cleaning effectiveness. You can remove the dust with a soft brush or clean, damp cloth. Larger particles may be attracted to positively charged surfaces throughout the home, like walls or floors.

- This may occur more frequently when the filter is nearing the end of its useful product life and unable to capture as many charged particles.
- Excessive amounts of pet dander, dust, or smoke may decrease the life expectancy of the filter and interfere with the ionization process.

To help prevent particles from attracting to surfaces throughout your home:

- You may want to run the ionizer less often.
- Check the condition of the filter more frequently

## TRUE HEPA FILTER HEPA

(High-Efficiency Particulate Air) filters are designed to remove up to 99.97% of airborne pollutants at 0.3 microns or larger, from the air that passes through them. These include tobacco smoke, household dust, pet dander and pollen.

## HIGH, MEDIUM, AND LOW-SPEED SETTINGS

For optimum air filtration, operate your Holmes® air cleaner continuously on the HI setting. Its rugged motor has been designed to give many years of use. For quieter operation (such as in a bedroom), select LOW setting.

## BEFORE USE

1. Carefully unpack your air cleaner.
2. Select a firm, level surface with no obstructions to the air inlets or outlets.
3. If the filter is covered by a bag when shipped, remove plastic bag before use and place filters into unit.



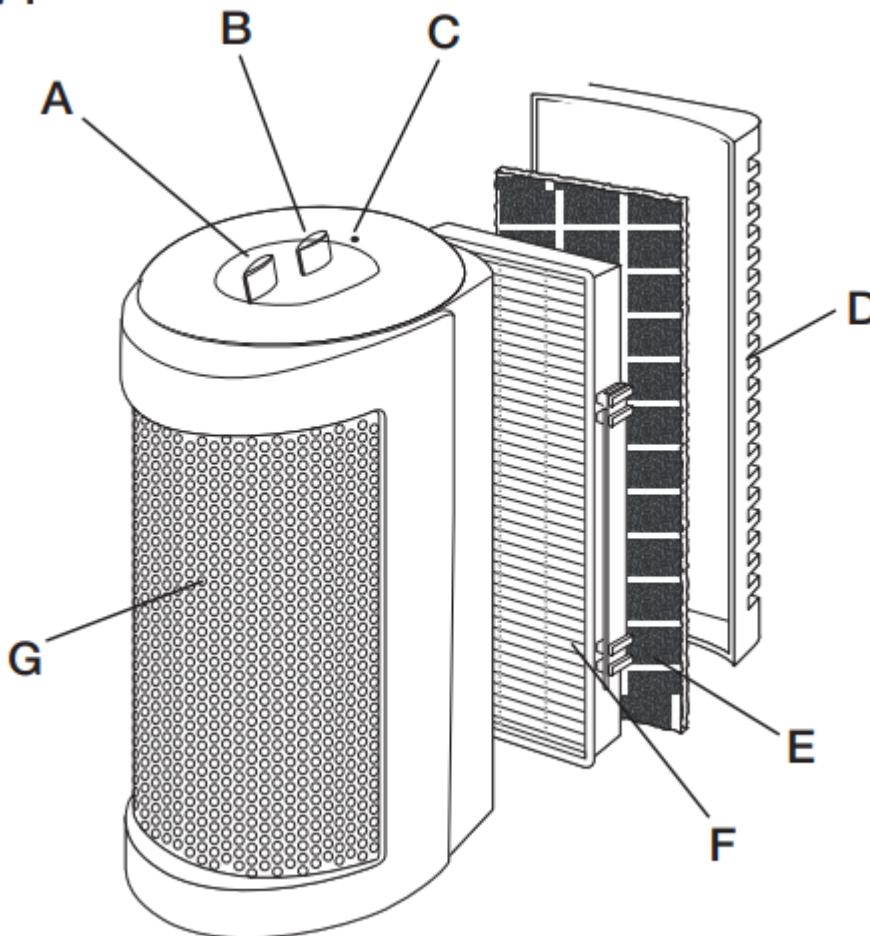

## OPERATING INSTRUCTIONS

Fig. 1



- A. SpeedControl Knob
- B. IonizerControl Knob
- C. Ionizer Indicator Light
- D. Air Inlet Grill
- E. Washable Foam Pre-Filter
- F. True HEPA Filter
- G. Filtered Air Outlet

**To operate your air cleaner:**

1. Plug into a 120V AC electrical outlet.
2. Select the operating speed of HIGH (  ), MEDIUM (  ) or LOW (  ) by turning the speed control knob to the appropriate setting.
3. To release negative ions into the filtered air, turn the Ionizer (  ) Control Knob to ON and the light will illuminate.
4. The ionizer will not work unless air cleaner is running.
5. For optimum air filtration, it is recommended to operate the air cleaner continuously. Its rugged motor has been designed to give many years of use.

## **CLEANING / MAINTENANCE**

### **REPLACING THE FILTER**

To replace your filter:

1. Turn off and unplug the air cleaner.
2. Open the air inlet grill and examine the foam prefilter. Remove any dust or lint, and wash in warm soapy water. Rinse, drip dry, and place back into grill inlet.
3. Remove HEPA filter from the unit by pulling it gently towards you and discarding it. DO NOT attempt to clean the old HEPA filter.
4. Install the new HAPF300 HEPA filter into the unit. This model utilizes a hang tab and filter clips to ensure that the filter is properly in place. Before replacing the filter, make sure that the hang tab is securely in place. The clip can only be attached to the tabs on the filter one way. The filter clip should easily slide onto the filter hang tab with only a small amount of pressure. DO NOT use force while attaching the clip to the filter. (Fig. 2)

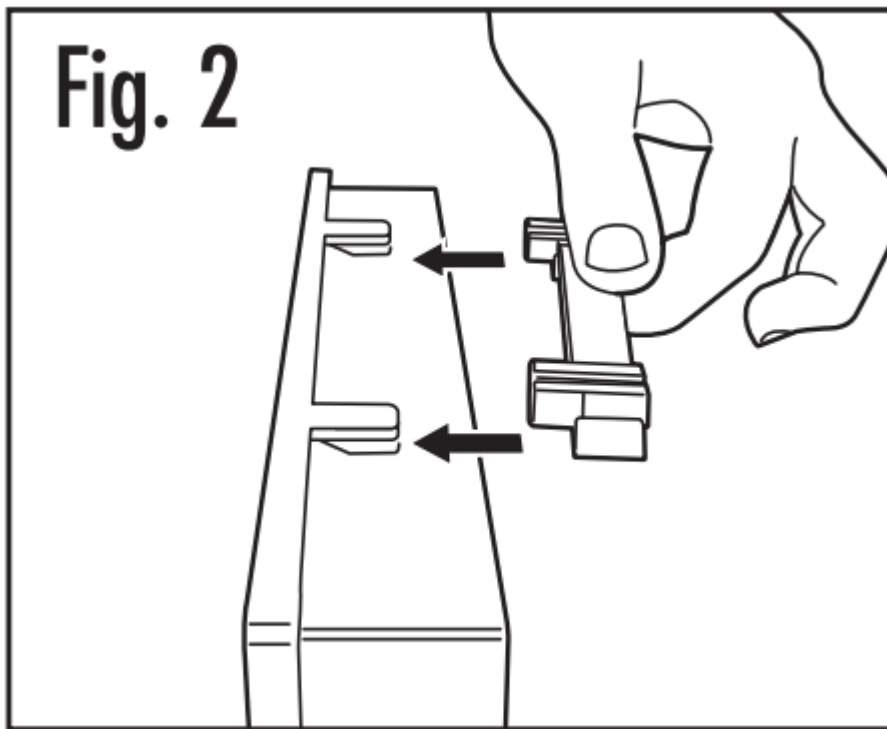

5. Align the clip on the top of true HEPA filter with rails on the inside of the cleaner unit. Gently slide the filter onto the rail. (Fig. 3)

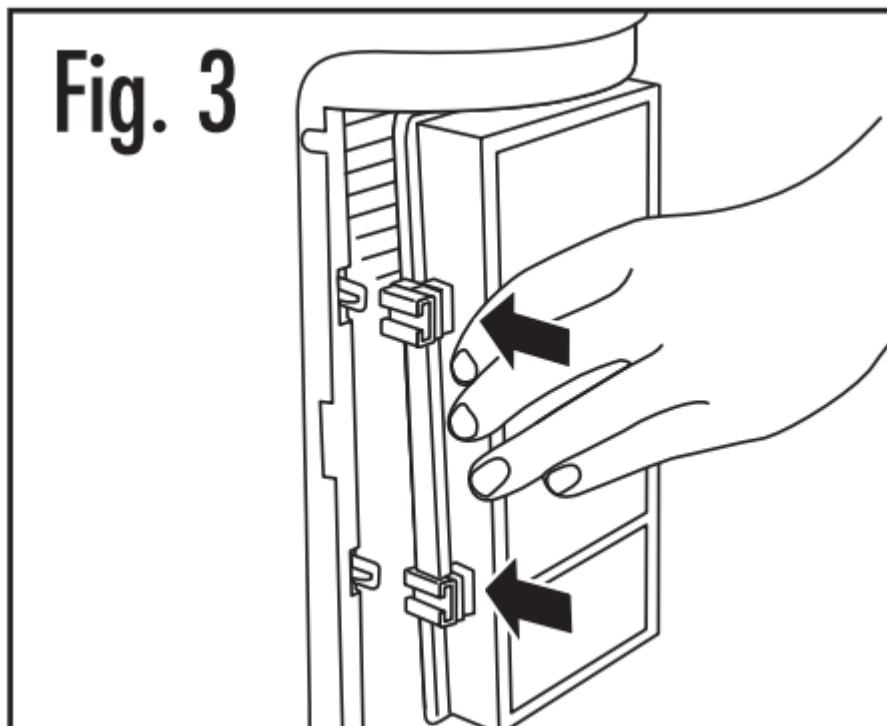

6. Replace air inlet grill.

## TIPS AND TROUBLESHOOTING

ISSUE	SOLUTION
UNIT WILL NOT OPERATE	<ul style="list-style-type: none"><li>• Make sure unit is properly plugged in and outlet is energized.</li><li>• Make sure unit turned ON.</li></ul>
DECREASED AIRFLOW	<ul style="list-style-type: none"><li>• Make sure nothing is blocking air inlet and filtered air outlets.</li><li>• Check condition of the filter and clean/replace if necessary.</li></ul>
EXCESSIVE NOISE	<ul style="list-style-type: none"><li>• Make sure parts are firmly positioned in place.</li></ul>

### Warning

This content is compiled from multiple sources and is provided for reference purposes only. It may not be complete or fully applicable to all situations. If you are unable to resolve your issue, please contact the product manufacturer or an authorized service provider for official support.