

## Parts identification

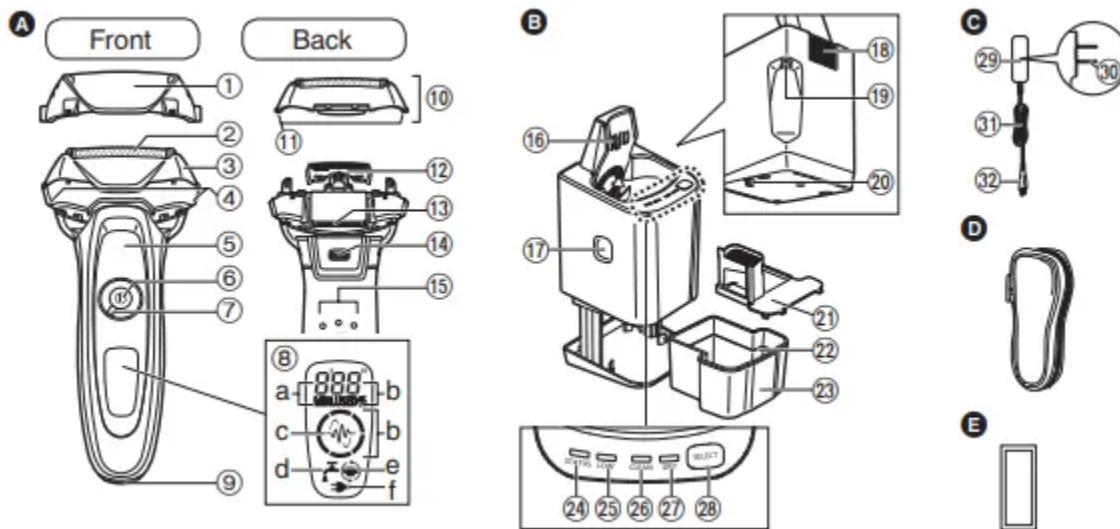

### A Main body

1 Protective cap

2 System outer foil

3 Foil frame

4 Foil frame release buttons

5 Finger rest

6 Power switch

7 Lock ring

8 Lamp display

a. Used time lamp

b. Battery capacity lamp

c. Shaving sensor lamp 

d. Clean lamp

e. Foil/blade check lamp

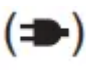
f. Charge status lamp 

9 Appliance socket

10 Outer foil section

11 System outer foil release buttons

12 Inner blades

13 Trimmer

14 Trimmer handle

15 Main body rear terminals

### **B Self-cleaning recharger**

16 Charging terminals

17 Cleaning liquid unit removal button

18 Intake port

19 Self-cleaning recharger socket

20 Lock release lever

21 Cleaning liquid filter

22 Water maximum line

23 Cleaning liquid unit

24 STATUS lamp

25 LOW lamp

26 CLEAN lamp

27 DRY lamp

28 SELECT button

### **C AC adaptor (RE7-59)**

29 Adaptor

30 Power plug

31 Cord

32 Appliance plug Accessories

### **D Travel case**

### **E Special detergent (Detergent)**

#### **Using the lock ring**

Use the lock ring to lock or unlock the power switch. Rotate the lock ring until it clicks.



Rotate the lock ring to “ O ” to unlock the power switch:

Used when shaving, washing the shaver, lubricating the shaver.



Rotate the lock ring to “ L ” to lock the power switch:

Used when carrying the shaver

## Charge

### Charging using the self-cleaning recharger

Thoroughly wipe off any drops of water on or around the selfcleaning recharger so that it is dry before charging the shaver.

- 1. Insert the appliance plug into the self-cleaning recharger.**
- 2. Remove the protective cap and then attach the shaver.**
  - Turn the shaver off before attaching.
  - Wipe off any water droplets on the main body rear terminals.
  - Check that the outer foil is not deformed or damaged when you are attaching

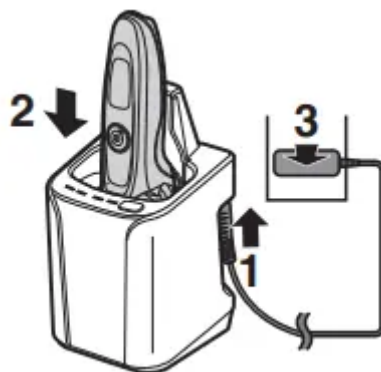

the shaver.

- 3. Plug in the adaptor into a household outlet.**

- The “Charge” mode starts when attaching the shaver.
- Check that the charge status lamp (  ) glows.
- Charging is completed after approx. 1 hour. The charging time may decrease depending on the charging capacity.

- If the shape of the plug does not fit the power outlet, use an attachment plug adaptor of the proper configuration.

### **While charging**



The charge status lamp  glows. The number of the battery capacity lamp will increase as charging progresses

### **After charging is completed**

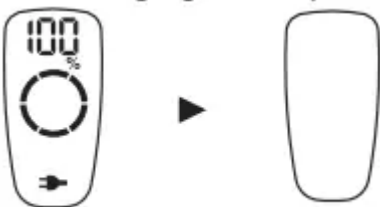

The battery capacity lamp and the charge status lamp will light up and then turn off after 5 seconds.

### **Abnormal charging**



The charge status lamp  will blink twice every second.

- After charging is completed, turning the power switch ON with the shaver plugged in will cause the battery capacity lamp and the charge status lamp to light up and then turn off after 5 seconds. This shows that the shaver is fully charged.
- Recommended ambient temperature for charging is 10 – 35 °C (50 – 95 °F). It may take longer to charge or the battery may fail to charge properly in extremely high or low temperatures. Charge the shaver within the recommended ambient temperature range.
- When charging the shaver for the first time or when it has not been in use for more than 6 months, the charge status lamp ( ) may not glow. It will eventually glow if kept connected.

#### 4 Disconnect the adaptor after charging is completed.

- You can charge even with the STATUS lamp of the self-cleaning recharger glowing.
- The appliance can be charged even with the cleaning liquid unit removed.

#### Charging without the self-cleaning recharger

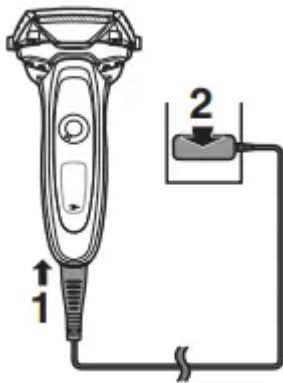

You can also charge without the self-cleaning recharger.

1. Insert the appliance plug into the shaver.
  - Turn the shaver off before inserting.
2. Plug in the adaptor into a household outlet.
  - Wipe off any water droplets on the appliance socket.
3. Disconnect the adaptor after charging is completed

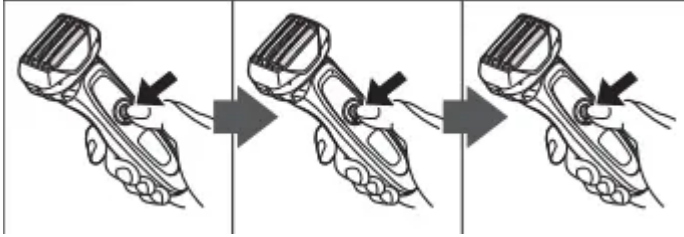

#### Using the shaver

1. Rotate the lock ring to unlock the power switch. (See page 11.)
2. Press the power switch to select the desired shaving mode.
  - Each time you press the power switch, the shaving mode changes from “Shaving sensor mode” “Normal mode” “OFF”.

Shaving mode	Shaving sensor mode	Normal mode	OFF
Description	Beard thickness is automatically sensed and the power is automatically adjusted when shaving.	The power level is constantly maintained while shaving.	-
Operation			
Shaving sensor lamp	 The shaving sensor lamp blinks.	— The shaving sensor lamp turns off.	— The shaving sensor lamp turns off.

- The shaving sensor may not respond depending on the thickness of the beard or the type of the shaving gel and shaving foam, but this is normal.
- The shaving sensor may not respond when the remaining battery capacity is low. If this happens, recharge the shaver.

3.

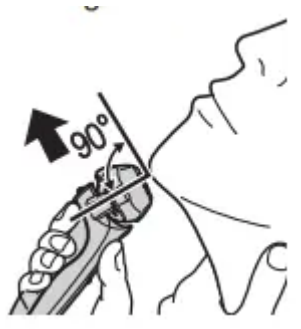

Hold the shaver as illustrated and shave.

- Start shaving by applying gentle pressure to your face. Stretch your skin with your free hand and move the shaver back and forth in the direction of your beard. You may gently increase the amount of pressure as your skin becomes accustomed to this shaver. Applying excessive pressure does not provide a closer shave.

## Switching the shaver head

You can change the pivot action.

### FREE

You can move the shaver head.

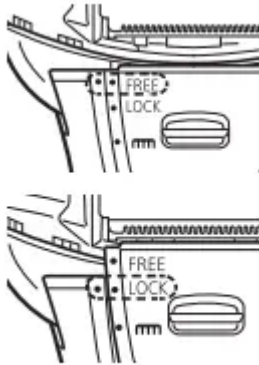

### LOCK

You can lock the shaver head.

## Using the trimmer

Slide the trimmer handle up to the “mm” position so that the trimmer stands upright.



Press and hold the lock release button (a) and slide the trimmer handle down to lower the trimmer.

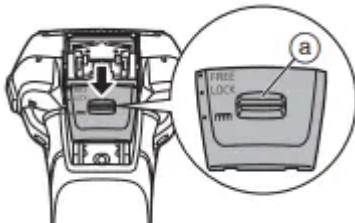

## Trimming sideburns

Slide the trimmer handle up. Turn the shaver on and place at a right angle to your skin and move



downwards to trim your sideburns.

### Pre-shave

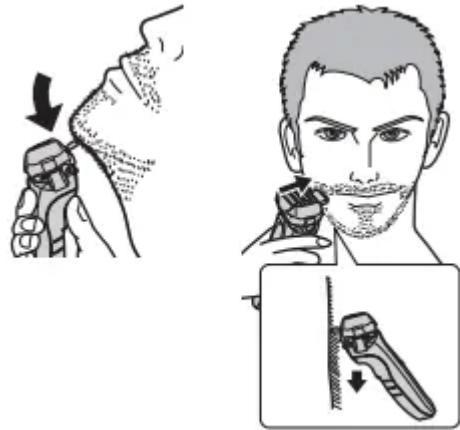

The trimmer can be used for a pre-shave of long beards.

## Clean

### Cleaning using the self-cleaning recharger

#### Preparing the self-cleaning recharger

Remove the shaver and the appliance plug from the self-cleaning recharger.

1. Place the self-cleaning recharger on a hard, flat surface.
  - When the self-cleaning recharger is lifted, or on the soft surface such as carpets, the lock release lever will not fit in the recharger properly. In that case, the cleaning liquid unit cannot be removed.
2. Press the cleaning liquid unit removal button and remove the cleaning liquid unit.

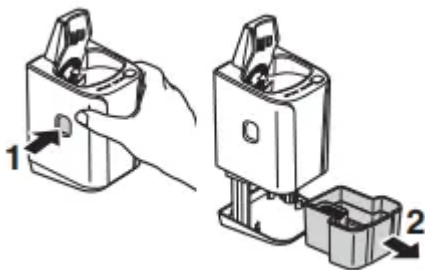

3. Wash away the old cleaning liquid and beard trimmings and then rinse the cleaning liquid unit.

- After washing, be sure to attach the cleaning liquid filter.

4. Pour tap water and detergent into the cleaning liquid unit.

- Do not let the water rise above the maximum water line. This may cause the

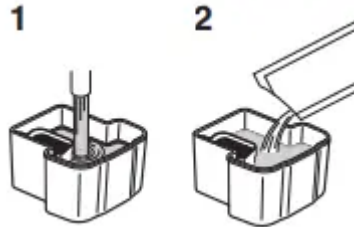

cleaning liquid to spill.

5. Attach the cleaning liquid unit.

- Immediately wipe up any cleaning liquid that has been spilled. Be careful not to drop cleaning liquid onto leather products or wooden floors as it may cause

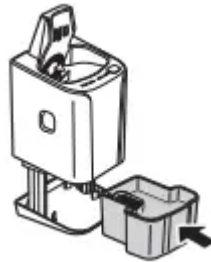

discoloration.

6. Press the top of the selfcleaning recharger down and securely attach until it clicks.



## Notes

- The water and detergent will mix after cleaning begins, making cleaning liquid.
- When the cleaning liquid level has dropped, the LOW lamp will glow to indicate the cleaning liquid should be replaced.
- After the LOW lamp glows, you can clean the shaver with the self-cleaning recharger for approximately 7 days.
- Replace the cleaning liquid when the STATUS lamp glows.
- When replaced, the cleaning liquid will last for approximately 30 days if used once per day. (This will differ depending on beard thickness and the ambient temperature.)

- Use the detergent within approximately 6 months after opening the package. When 6 months have passed, discard the cleaning liquid, and then pour new water and detergent into the cleaning liquid unit.
- Replace the water and detergent at the same time. Otherwise the cleaning function may deteriorate.
- Only use self-cleaning recharger detergent for Panasonic shavers

## Cleaning the shaver





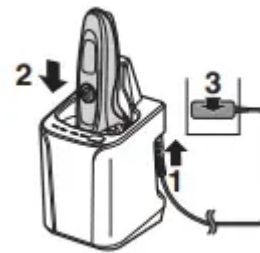





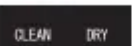







Remove any soap or water on the shaver if it has been washed with hand soap or any other detergent.

1. Insert the appliance plug into the self-cleaning recharger.
- 2.



Remove the protective cap and then attach the shaver.

3. Plug in the adaptor into a household outlet.
  - Turn the shaver off before attaching.
  - Wipe off any water droplets on the main body rear terminals.
  - Check that the outer foil is not deformed or damaged when you are attaching the shaver.
4. Press the SELECT button to select the mode.
  - The “Charge” mode starts when attaching the shaver.
  - Each time you press the SELECT button, the mode changes from “Clean/Dry/Charge” “Dry/Charge” “Charge”.
  - The modes start approximately 6 seconds after they are selected.
  - The mode will be aborted if the power is cut off. In this case, perform the mode again from the beginning.
  - Do not press the cleaning liquid unit removal button as the cleaning liquid may spill causing a malfunction.

Mode	Time required (guide)						
<b>① Charge</b> 	<b>Charge</b> 0 to 60 min 						
<b>② Clean/Dry/Charge</b> 	<table style="width: 100%; text-align: center;"> <tr> <td><b>Clean</b> 10 min</td> <td><b>Dry</b> 80 min (170 min*)</td> <td><b>Charge</b> 0 to 60 min</td> </tr> <tr> <td></td> <td>▶ </td> <td>▶ </td> </tr> </table> <ul style="list-style-type: none"> <li>It is not possible to change the mode after the "Clean/Dry/Charge" mode has started.</li> </ul>	<b>Clean</b> 10 min	<b>Dry</b> 80 min (170 min*)	<b>Charge</b> 0 to 60 min		▶ 	▶ 
<b>Clean</b> 10 min	<b>Dry</b> 80 min (170 min*)	<b>Charge</b> 0 to 60 min					
	▶ 	▶ 					
<b>③ Dry/Charge</b> 	<table style="width: 100%; text-align: center;"> <tr> <td><b>Dry</b> 180 min</td> <td><b>Charge</b> 0 to 60 min</td> </tr> <tr> <td></td> <td>▶ </td> </tr> </table> <ul style="list-style-type: none"> <li>It is possible to change to the "Clean/Dry/Charge" mode even after the "Dry/Charge" mode has started.</li> </ul>	<b>Dry</b> 180 min	<b>Charge</b> 0 to 60 min		▶ 		
<b>Dry</b> 180 min	<b>Charge</b> 0 to 60 min						
	▶ 						

\* When the ambient temperature of the self-cleaning recharger is low (approx. 15 °C (59 °F) or lower), the time it takes to dry the shaver increases.

- Use the self-cleaning recharger in temperatures between 15 °C (59 °F) and 35 °C (95 °F).
- The Clean or Dry function may stop under extreme low temperatures (approx. 0 °C (32 °F) or lower). In such a case, the STATUS lamp will glow for approximately 5 seconds and the mode will switch to the "Charge" mode without allowing you to select the "Clean/Dry/Charge" mode or the "Dry/Charge" mode.

### Cleaning the shaver without the self-cleaning recharger

We recommend that you clean your shaver with the self-cleaning recharger or the sonic vibration cleaning mode when the faucet symbol  appears on the lamp display.

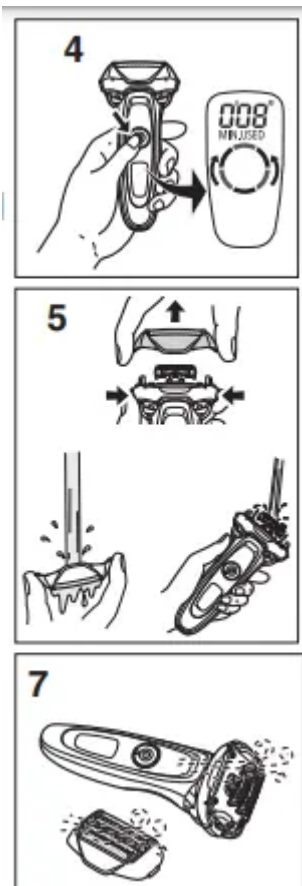

1. Disconnect the cord from the shaver.
2. Apply some hand soap and some water to the system outer foil.
3. Rotate the lock ring to unlock the power switch.
4. Press the power switch for more than 2 seconds to activate the sonic vibration cleaning mode.
5. The battery capacity lamps blink in order.
6. After about 20 seconds, it will be automatically turned off, or you can turn it off by pressing the power switch.
7. Remove the outer foil section and press the power switch for more than 2 seconds to activate the sonic vibration cleaning mode and clean it with running water.
8. Wipe off any drops of water with a dry cloth.

**Dry the outer foil section and the shaver completely.**

1. Attach the outer foil section to the shaver.
2. Dry the shaver with self-cleaning recharger using “Dry/Charge” mode.

## Cleaning the self-cleaning recharger

Beard trimmings may become attached to the cleaning tray of the self-cleaning recharger. Follow the steps below to remove them. We recommend doing this each time you change the cleaning liquid.

1. Be sure to remove the cleaning liquid unit and the appliance plug from the self-cleaning recharger.

- Be careful not to spill the cleaning liquid.
- Some cleaning liquid components and skin oil may separate and adhere to the cleaning liquid unit and cleaning liquid filter. This does not indicate a problem.

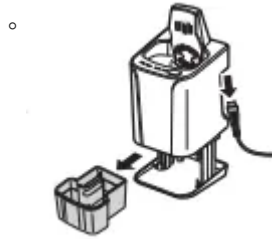

2. Pour water as illustrated while tilting the cleaning liquid unit and shaking it gently.

- You can clean with the cleaning liquid filter removed.
- After washing, be sure to attach the cleaning liquid filter.

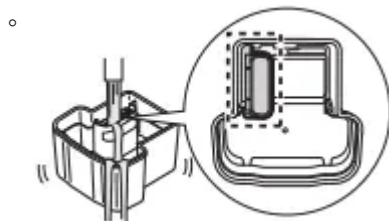

3. Gently wipe off any beard trimmings attached to the inside of the cleaning tray with a cloth or tissue paper dampened with water.

- Clean the corners and uneven parts of the cleaning tray with a cotton swab dampened with water.

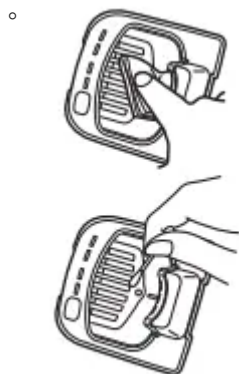

## When the water does not drain from the cleaning tray

Beard trimmings may clog the drain at the bottom of the cleaning tray. In this case, you cannot clean or dry the shaver. Push the beard trimmings down through the drain with a toothpick etc.

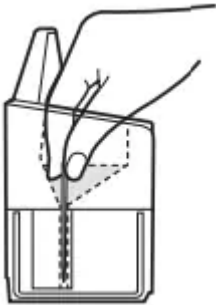

## Troubleshooting

### ► Self-cleaning recharger

#### The blade has not been thoroughly washed.

- If the shaver is not cleaned for more than 2 weeks, first clean to remove beard trimmings.
- Do not add detergent and water except when replacing the cleaning liquid. Doing so may deteriorate the cleaning function. (See page 15.)
- After cleaning, oil-like droplets may remain on the outside of the foil frame. This is the lubricating component of the cleaning liquid and does not indicate a problem. You may wipe it off with a soft cloth.

#### The STATUS lamp glows.

- See page 21.

#### The mode does not start.

- Check that the AC adaptor is connected to the self-cleaning recharger, and that the recharger is plugged in to a household outlet. (See page 11.)
- Confirm that the shaver is properly attached to the selfcleaning recharger. (See page 11.)
- The Clean or Dry operation may not function under extreme low temperatures (approx. 0 °C (32 °F) or lower).
- Check if the STATUS lamp glows. (See page 21.)

#### Cleaning liquid has accumulated in the cleaning tray.

- Remove any waste, etc. that has accumulated in the drain at the bottom of the cleaning tray. (See page 18.)

- If you use the self-cleaning recharger when the shaver is wet or when soap or shaving gel is on the shaver, cleaning liquid may accumulate in the cleaning tray.

**The cleaning liquid unit cannot be removed.**

- Place the self-cleaning recharger on a hard, flat surface. When the self-cleaning recharger is lifted, or on the soft surface such as carpets, the lock release lever will not fit in the recharger properly. In that case, the cleaning liquid unit cannot be removed.

**Makes a loud sound.**

*During cleaning:*

The self-cleaning recharger makes a loud sound due to the cleaning of the blades.

*After cleaning:*

The self-cleaning recharger makes a loud sound due to the removal of water droplets in order to speed drying.

- The sound after cleaning is different from the sound during cleaning. The water level has dropped and it is removing water droplets from the blades after cleaning. This does not indicate a problem.

**The shaver cannot be charged.**

- Gently wipe the main body rear terminals and the charging terminals of the self-cleaning recharger with a cloth or tissue dampened with water.

**The blades are not dry or are sticky.**

- The blades may not dry quickly due to temperature conditions. Run the “Dry/Charge” mode again or wipe with a soft cloth before shaving.

**The blades crack or deform during cleaning.**

- Do not insert any foreign objects into the recharger.
- Replace the system outer foil and/ or inner blades. (See page 17.)

**The cleaning liquid has foamed.**

- If you mix soapy water or hand soap with the detergent or use another detergent, the cleaning liquid will foam. Use the selfcleaning recharger after thoroughly washing and drying the shaver.
- Replace the cleaning liquid.

**Cleaning liquid leaked from the cleaning liquid unit.**

- Do not press the cleaning liquid unit removal button during the mode.
- Place the self-cleaning recharger horizontally.
- If you use the self-cleaning recharger when the shaver is wet or when soap or shaving gel is on the shaver, cleaning liquid may leak.

## ► Shaver

### **Trimmed hairs fly all over.**

- This can be improved by cleaning every time after shaving.
- Clean the inner blades.

### **System outer foil gets hot.**

- Replace the system outer foil if it is damaged or deformed. (See page 17.)

### **The power switch cannot be pressed.**

- Unlock the power switch.

### **Operating time is short even after charging.**

- When the number of operations per charge starts to decrease, the battery is nearing the end of its life.

### **Makes a loud sound.**

- Confirm that the blades are properly attached.
- The shaver makes a high-pitched sound due to the linear motor drive. This does not indicate a problem.
- Clean the system outer foil.

### **The odor is getting stronger.**

- This can be improved by cleaning every time after shaving.

### **You do not get as close a shave as before.**

- This can be improved by cleaning every time after shaving.
- Replace the system outer foil and/ or inner blades.
- Expected life of system outer foil and inner blades:
- System outer foil:
  - Approximately 1 year
- Inner blades:
  - Approximately 2 years

### **The shaving sensor does not respond.**

- The shaving sensor may not respond when the remaining battery capacity is low. If this happens, recharge the shaver.
- Depending on the beard thickness, the shaving sensor may not react and the driving sound may not change. This is not abnormal.

- The shaving sensor may not respond depending on the thickness of the beard or the type of the shaving gel and shaving foam, but this is normal.

**The shaving sensor responds even though the shaver is not in contact with the skin.**

- Clean the beard trimmings from the shaver. When the shaver is extremely dirty, remove the foil frame and wash with water. (See page 16.)
- Replace the system outer foil and/ or inner blades. Expected life of system outer foil and inner blades:
  - System outer foil:
    - Approximately 1 year
  - Inner blades:
    - Approximately 2 years

**The shaver cannot be charged with the selfcleaning recharger.**

- Gently wipe the main body rear terminals and the charging terminals of the self-cleaning recharger with a cloth or tissue dampened with water.

**Shaver stopped functioning.**

- Recommended ambient temperature for operation is 5 – 35 °C (41 – 95 °F). The shaver may stop functioning when out of recommended ambient temperature range.
- The battery has reached the end of its life.

**The driving sound changes while shaving.**

- While the shaving sensor lamp glows, the shaving sensor is operating. The sound changes depending on the beard thickness.

**The power will not switch to OFF.**

- Press the power switch twice while using in the shaving sensor mode.

**► When the STATUS lamp glows**

**It is time to replace the cleaning liquid.**

- Pour new water and detergent into the cleaning liquid unit.

**The cleaning liquid unit is not properly attached.**

- Properly attach the cleaning liquid unit.

**The self-cleaning recharger is tilted.**

- Place the self-cleaning recharger on a horizontal surface.

**Use the self-cleaning recharger outside the range of the recommended usage temperature.**

- Use within the recommended temperature range of 15 – 35 °C (59 – 95 °F).

## ► When all self-cleaning recharger's lamps blink

### Device failure

- Contact an authorized service center.

#### **Warning**

This content is compiled from multiple sources and is provided for reference purposes only. It may not be complete or fully applicable to all situations. If you are unable to resolve your issue, please contact the product manufacturer or an authorized service provider for official support.