

## STEPS TO JUMP START YOUR VEHICLE



1. Insert the jumper cable into the jump starter and connect the clamps to the car battery.
2. "READY" sign shows on the screen.
3. Start your car engine.

## ABOUT THE FORCE START FUNCTION:

### Why the screen shows nothing when you try to start your car ?

If the screen doesn't display anything when you have correctly connected the clamps to your car, you can use the Force Start Function to enter boost mode.



### 3 steps to fix your problem:

1. Check the clamps connection and the product's battery is above 20%.
2. Press the Power Button and Flashlight Button simultaneously for 2-3 seconds.
3. The screen will shows "READY", and go back to start engine ignition.

**Warning:** When using the Force Start Function, auto-detection and safety features will be disabled.

## ABOUT THE ERROR CODE:

### Error Code --- Reason ---- Solution



--- "+" and "-" poles of battery clips reversed.

- Reverse the clips and ensure the correct connection



--- The voltage of the car battery is between 2-8V.

- Press the Power Button and Flashlight Button simultaneously for 2-3s to start force output. (Force Start Function)



① The product's operating temperature is too high. ( $\geq 113^{\circ}\text{F}$ )

- Please store it back to where the temperature is between :  $5^{\circ}\text{F}$ - $113^{\circ}\text{F}$ .

② Charge the device at extremely low or high temperature.

- Please charge the device at room temperature.



-- Jump start the battery more than 5 times within 10 minutes, the product will automatically enter the safe mode.

- The safe mode will be off automatically after 10 minutes waiting. (Please do not turn off the product during the process)

### ABOUT USB-A OUTPUT PORT:

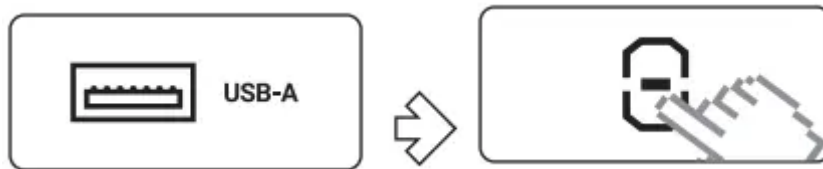

1.Plug the cable into the USB-A output port.

2.Press the Power Button.

### ABOUT 12V DC OUTPUT PORT (MAX 15V/10A):

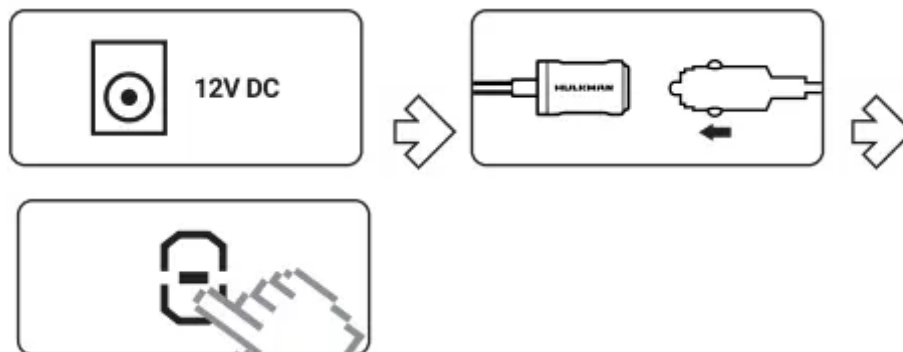

1.Plug the 12V cigarette lighter socket adapter into the 12V DC output port.

2.Connect your 12V DC appliances to the cigarette lighter adapter.

3.Press the Power Button.

## ABOUT LED FLASHLIGHT:



1. Hold the Flashlight Button for 1-2s.

2. Press briefly to switch the light modes.

• 50% Lumen Light → 100% Lumen Light → White Strobe Light → White SOS Light → Red Strobe Light

- [START COMPLETELY DEAD BATTERIES]: Powerful and safe to start your completely dead car battery. 2000 Amps peak cranking amp, especially for vehicles up to 8.5L Gas/ 6.0L Diesel engines. Up to 60 jump starts on a single charge.
- [COMPREHENSIVE INDICATOR PANEL]: A user-friendly 3.3-inch smart screen provides you with all the information about operational status, battery level and possible errors. You can start your car.
- [MULTI-PROTECTION]: With its integrated design of the battery protection scheme and built-in intelligent clamps, the HULKMAN jump starter is safe and fully insulated. Its 10 types of protection include spark-proof, mistake-proof and reverse-polarity protection to free you from malfunction concerns like a short-circuit or sparks. Use it to jump start your car confidently!
- [0% to 80% in JUST 1 HOUR]: With our unmatched 65W Speed Charge Tech., it only takes an hour to charge the Alpha 85 Jump Starter from 0% to 80%, and can be fully-charged in 90 minutes. When fully charged, this device can hold the electricity up to 18 months. A 5-min charge can provide a single jump-start!
- [MOST ADVANCED DESIGN]: This car battery starter has been developed with the concept of sturdiness and reliability. The IP65 rating shell material prevents rainwater, dust and external impacts from causing damage to the inner structure, adapting itself to many kinds of complex work scenarios.
- [MORE THAN JUMP-STARTS]: With the 12V/10A DC, USB-A/QC3.0 and Type-C/ PD18W output, this car starter can readily charge tire pumps, car refrigerators, and a wide variety of electronic products like smartphones. The 5 modes of LED flashlights will also play an important role in an emergency.
- [IN THE BOX]: In the box you will find the Alpha 85 Jump Starter Car Battery Charger, an SC 65W Wall Charger, Rubber Wrapped Booster Clamps, a Type-C USB Cable (Out), and a DC 12V Cigarette Lighter Socket Adapter. Our customer support department will always be there for any consultation.

**Note:** Products with electrical plugs are designed for use in the US. Outlets and voltage differ internationally and this product may require an adapter or converter for use in your destination. Please check compatibility before purchasing.

### **Start your car in 5 mins**

- Start the vehicles up to 8.5L Gas/6.0L Diesel engines.
- 3.3-inch Smart Screen shows percentage of power,error code and product status, which helps you see clearly and operates effortlessly.
- 65W Speed Charge(4x faster) optimizes the charging experience.
- 20000mAh Capacity features a USB-A output port, aType-C output port and a 12V DC output port.

#### **Warning**

This content is compiled from multiple sources and is provided for reference purposes only. It may not be complete or fully applicable to all situations. If you are unable to resolve your issue, please contact the product manufacturer or an authorized service provider for official support.