

## Package Contents

### Package Contents



Robot



Charging Dock + Power Adapter



Side Brushes



Remote Control with  
Batteries



Multi-Function Cleaning  
Tool



Instruction Manual

**Note:** Figures and illustrations are for reference only and may differ from actual product appearance. Product design and specifications are subject to changes without notice.

# Product Diagram

## Robot



## Bottom View

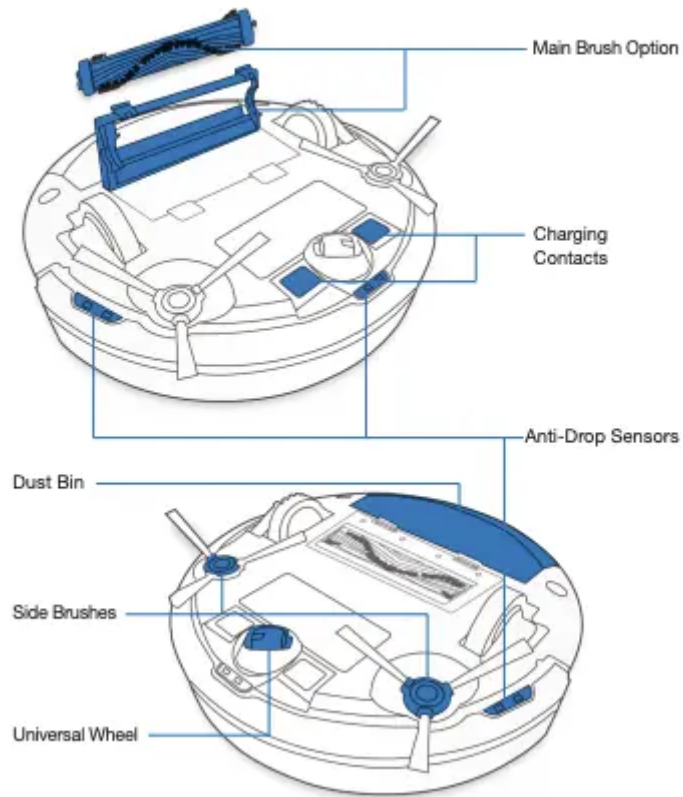

## Charging Dock

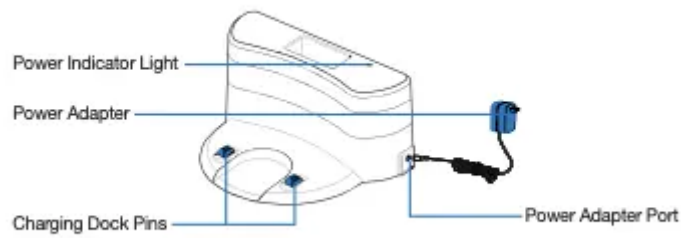

## Remote Control

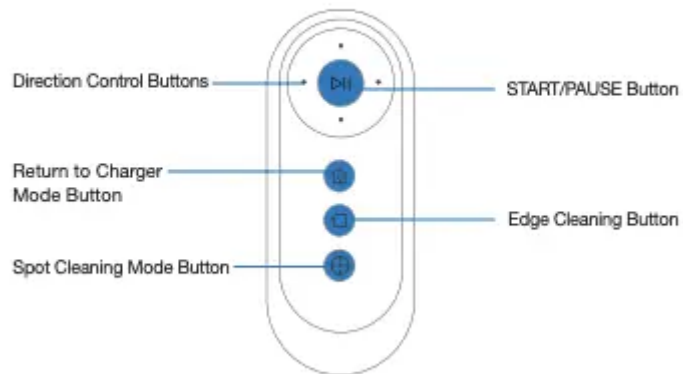

## Operating and Programming

### Notes Before Cleaning

**WARNING:** Do not use the robot on wet surfaces or surfaces with standing water.



Before using the product on a rug with tasseled edges, please fold the rug edges under.

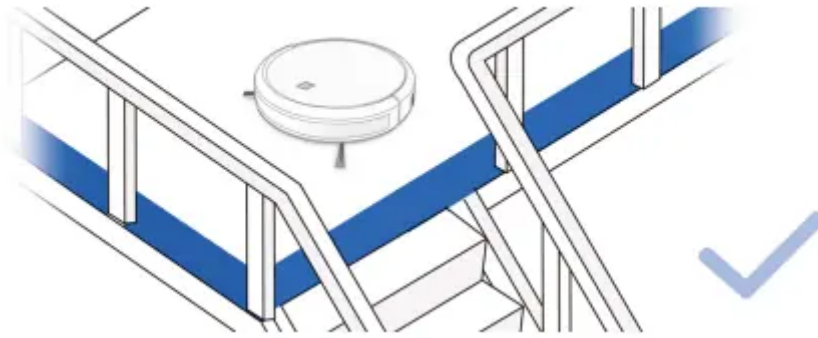

It may be necessary to place a physical barrier at the edge of a drop to stop the unit from falling over the edge.



Tidy up the area to be cleaned by putting furniture, such as chairs, in their proper place.

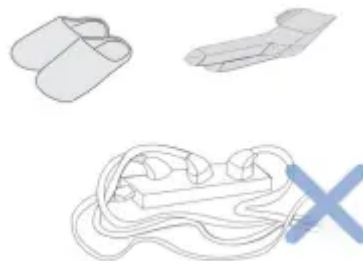

Remove power cords and small objects from the floor that the robot could be obstructed by.

## Preparation

### 1 Plug in Adapter

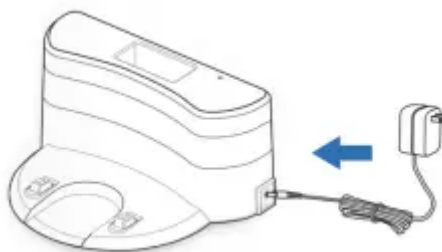

## 2 Charging Dock Placement

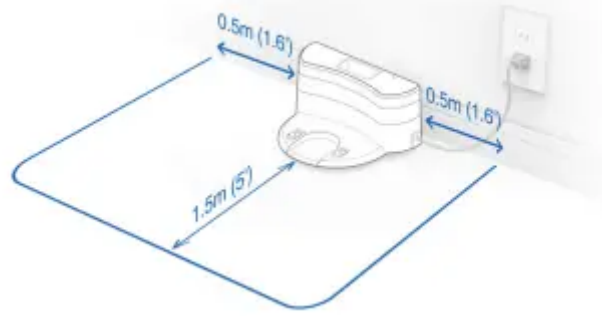

## 3 Install Side Brushes

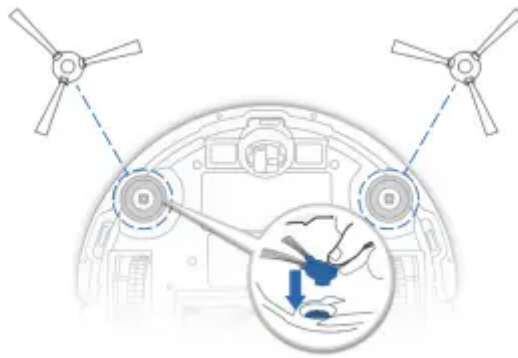

## 4 Power ON

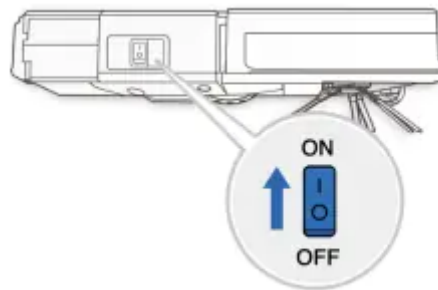

## 5 Charge the robot

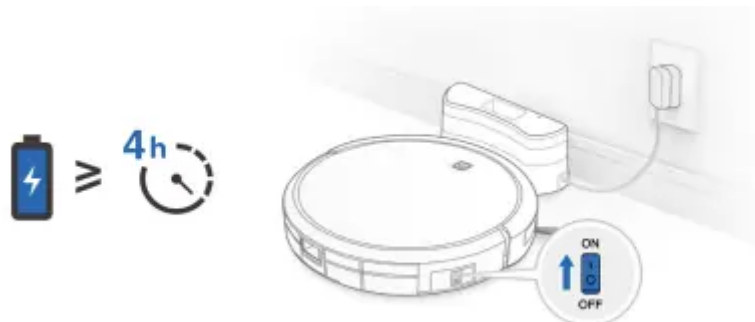

**Note:** When the robot completes the cleaning cycle or when battery power gets low, the robot automatically returns to the Charging Dock to recharge itself.

## Selecting Cleaning Mode

### 1 AUTO Cleaning Mode

A Random Cleaning Pattern (optimized for carpets) will be selected by default.

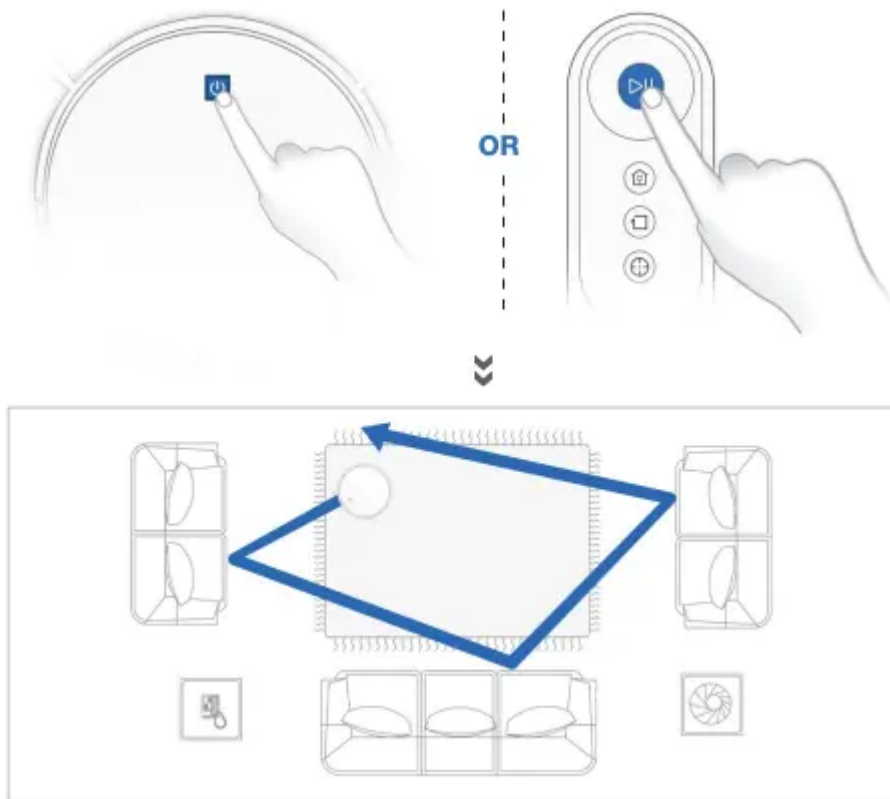

### 2 Return to Docking Station

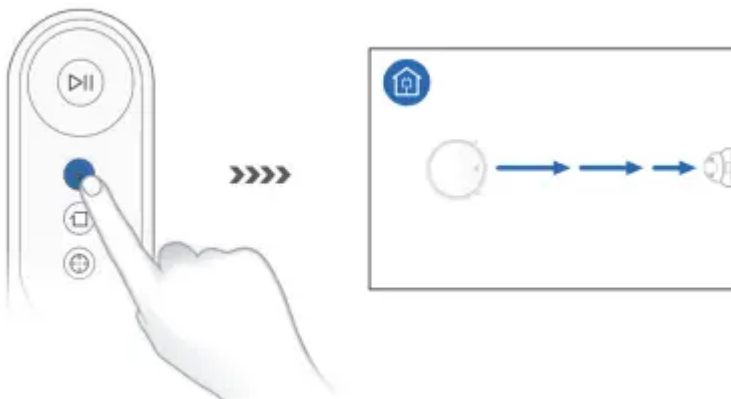

### 3 Edge Cleaning Mode

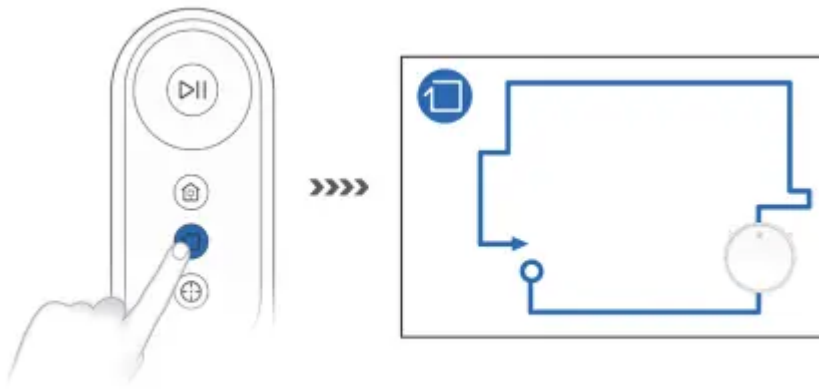

### 4 Spot Cleaning Mode

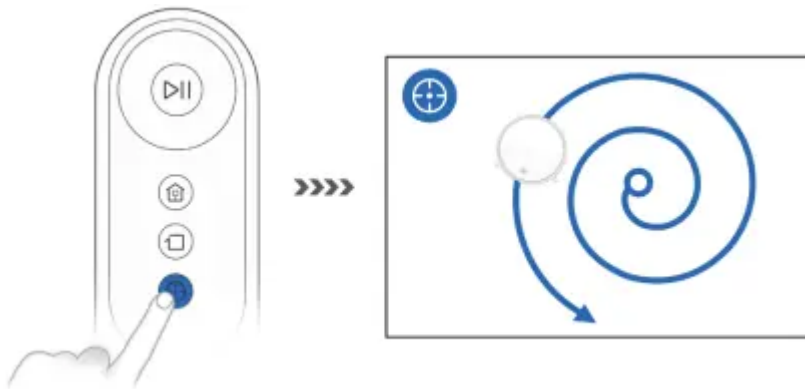

### Switch vacuum power



### Pause, Wake Up, Power Off

#### 1 Pause





**Note:** the robot's Control Panel stops glowing after the robot is paused for a few minutes. Press the AUTO Mode Button on the robot to wake up the robot.

## 2 Wake Up



**Press the AUTO button on the robot to wake it up**



## 3 Power OFF

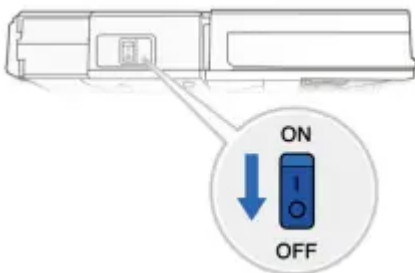

**Note:** When the robot is not working, it is recommended to keep it switched ON and charging.

## Dust Bin and Filters

### Dust Bin

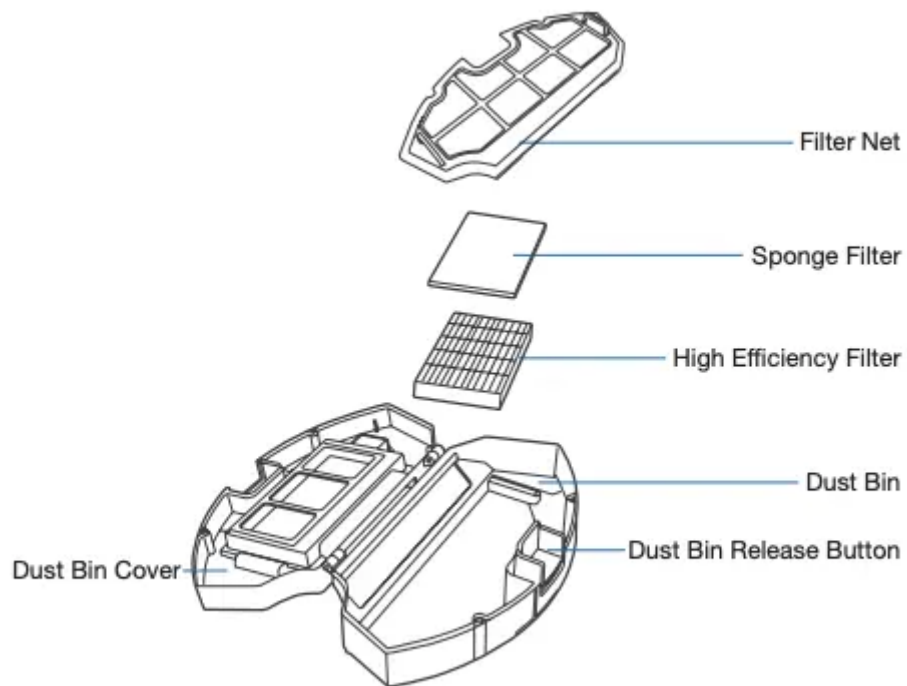

## Maintenance

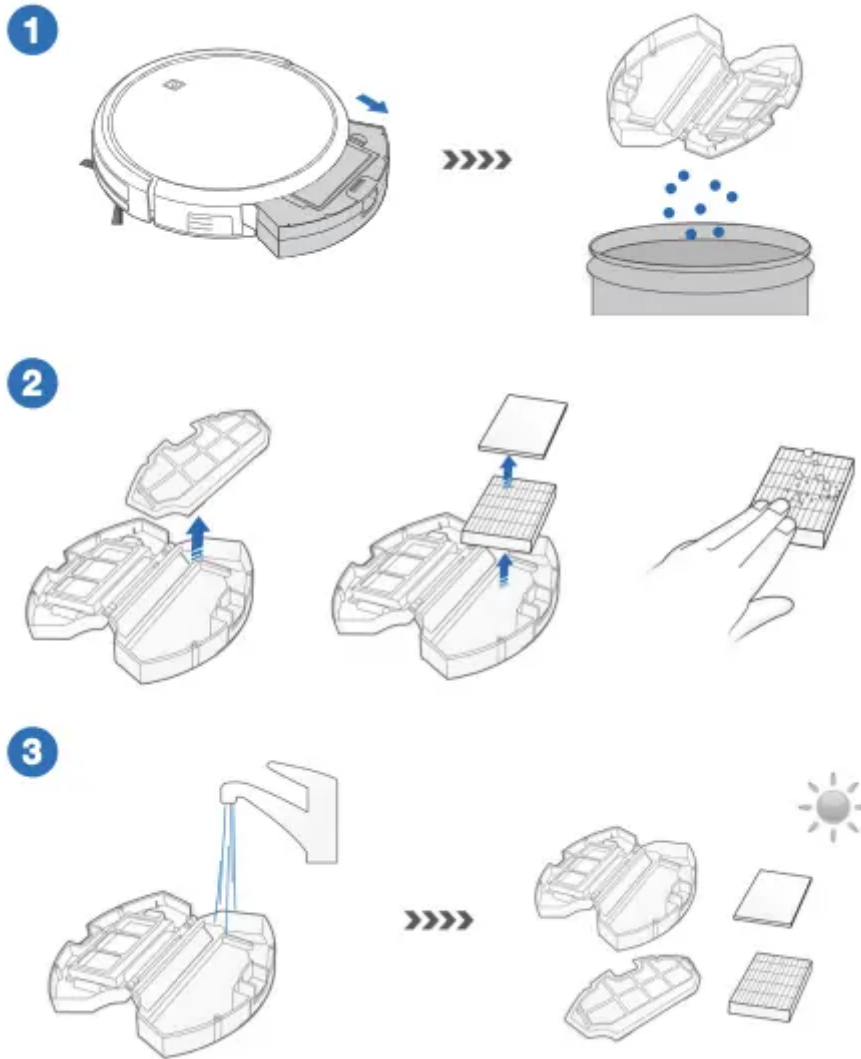

### Main Brush and Side Brushes

**Note:** A Multi-Function Cleaning Tool is provided for easy maintenance. Handle with care, this cleaning tool has sharp edges

#### Main Brush

1

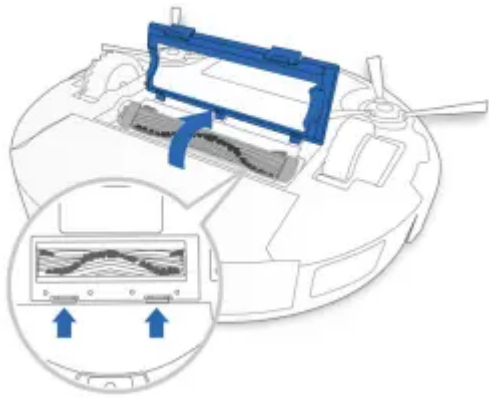

2

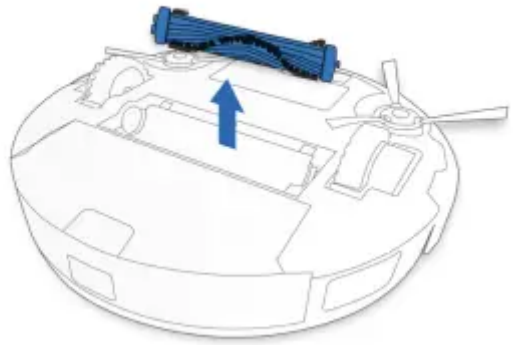

3

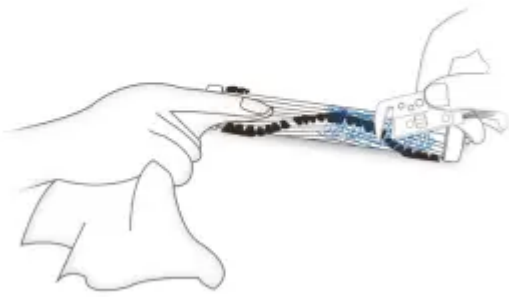

4

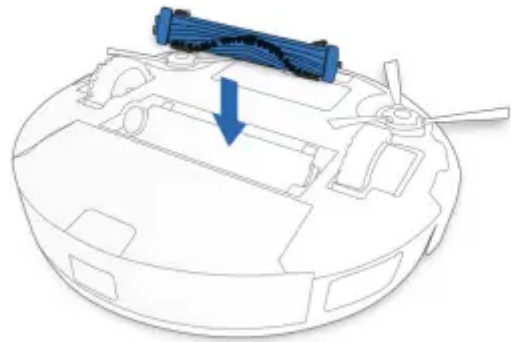

5

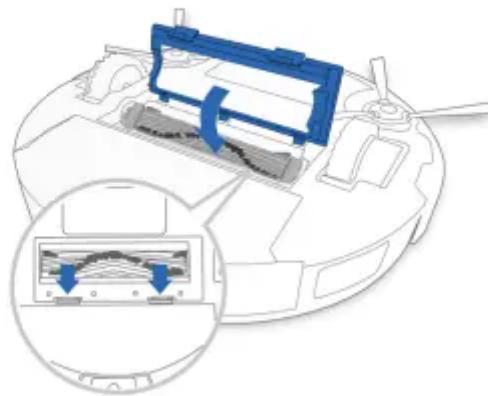

## Side Brushes



1

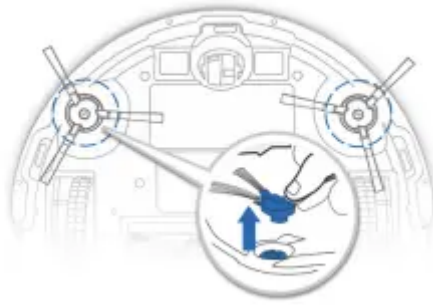

2

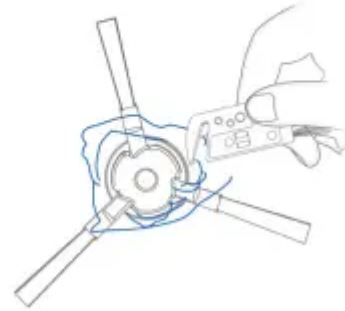

3

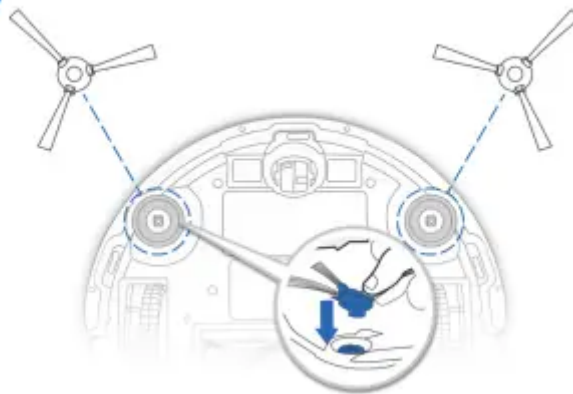

### Other Components

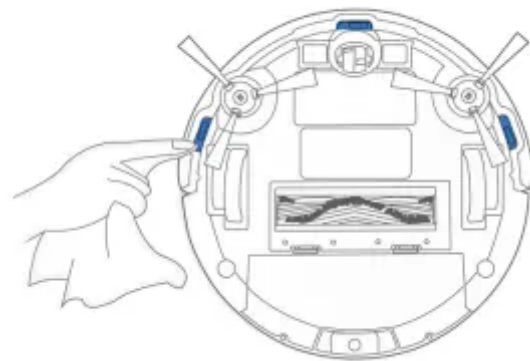
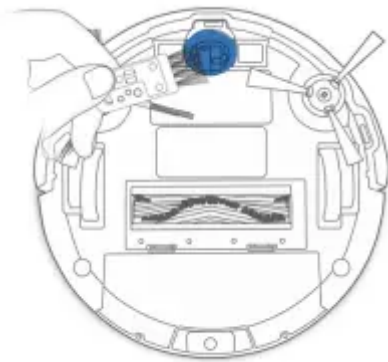



**Note:** Before cleaning the robot's Charging Contacts and Charging Dock Pins, turn the robot OFF and unplug the Charging Dock.

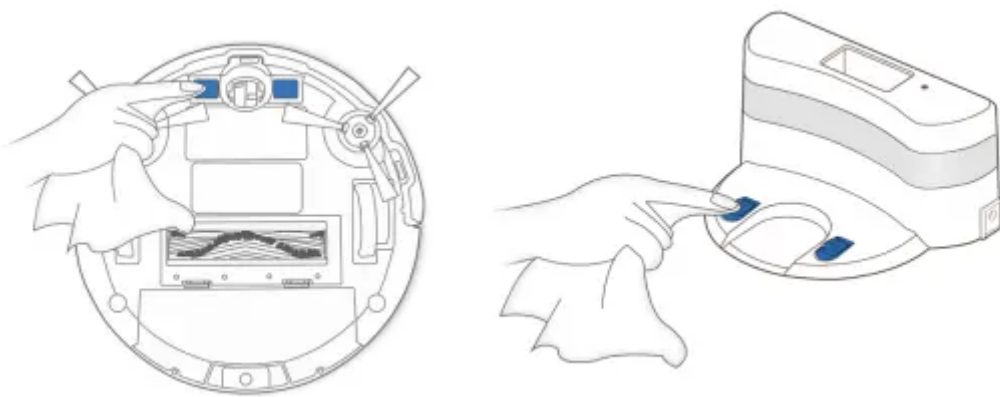

## Regular Maintenance

To keep the robot running at peak performance, perform maintenance tasks and replace parts with the following frequencies:

Robot Part	Maintenance Frequency	Replacement Frequency
Side Brush	Once every 2 weeks	Every 3-6 months
Main Brush	Once per week	Every 6-12 months
Sponge Filter/ High Efficiency Filter	Once per week	Every 3-6 months
Universal Wheel Anti-Drop Sensors Bumper Charging Contacts Charging Dock Pins	Once per week	/

A Multi-Function Cleaning Tool is provided for easy maintenance. Handle with care, this cleaning tool has sharp edges.

**Note:** YEEDI manufactures various replacement parts and fittings. Please contact Customer Service for more information on replacement parts.

## Indicator Light and Alarm Sounds

### Indicator Light

Status	AUTO Mode Button
The robot is charging.	Flashes BLUE
The robot has a problem.	Flashes RED or glows a continuous RED
The robot has low battery.	Glows a continuous RED
The robot is cleaning.	Glows a continuous BLUE

### Alarm Sounds

If the robot detects a problem, it emits alarm beeps and the AUTO Mode Button flashes RED or glows RED.

#### Flashing RED:

Alarm Sound	Problems	Solution
Two Beeps	Anti-Collision Bumper Malfunction	Check the Anti-Collision Bumper for debris and remove the debris.
Three Beeps	Anti-Drop Sensors Malfunction	Clean Anti-Drop Sensors as described in section 4 Maintenance.
Four Beeps	Low Battery	Manually place the robot on the Charging Dock to charge.

#### Glowing a continuous RED:

Alarm Sound	Problems	Solution
One Beep	Driving Wheel malfunction	Check Driving Wheel for tangled hair or debris and clean as described in section 4 Maintenance.
Two Beeps	Side Brush malfunction	Check Side Brushes for tangled hair or debris and clean as described in section 4 Maintenance.
Four Beeps	Main Brush malfunction	Check Main Brush for tangled hair or debris and clean as described in section 4 Maintenance.

## Troubleshooting

### The robot is not charging

The robot is not switched ON. Switch ON the robot.

- The robot has not connected to the Charging Dock.

Be sure that the robot's

- Charging Contacts have connected to the Charging Dock Pins.

The battery is completely discharged.

- Re-activate the battery. Switch ON the robot. Place the robot on the Charging Dock by hand, remove after charging for 3 minutes, repeat 3 times; then charge normally

**The robot cannot return to the Charging Dock.**

The Charging Dock is not correctly placed.

- Refer to section 3.2 to correctly place the Charging Dock

**The robot gets stuck while working and stops.**

The robot is tangled with something on the floor (electrical wires, curtains, carpet fringing, etc.).

- The robot will try various ways to free itself. If it is unsuccessful, manually remove the obstacles and restart.

**The robot returns to the Charging Dock before it has finished cleaning.**

When the battery gets low, the robot automatically switches to Return to Charger Mode and returns to the Charging Dock to recharge itself.

- This is normal. No solution necessary.

Working time varies according to floor surface, room complexity and the Cleaning Mode selected.

- This is normal. No solution necessary.

**The robot does not clean the whole area.**

The cleaning area is not tidy.

- Remove small objects from the floor and tidy up the cleaning area before the robot starts cleaning.

**Warning**

This content is compiled from multiple sources and is provided for reference purposes only. It may not be complete or fully applicable to all situations. If you are unable to resolve your issue, please contact the product manufacturer or an authorized service provider for official support.

