

Product Diagram

Front

1. Speaker
2. LED Indicator

Rear Panel

3. Power Port
4. AUX Input
5. Mount Holes*

*Note: The mounting screws are not provided.

Side

6. Volume -
7. Mode Button

8. Volume +
9. Power Button
10. Play / Pause

Package Contents

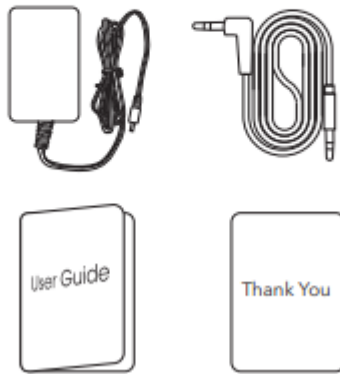

- 1 x TaoTronics Sound Bar (Model: TT-SK025)
- 1 x Power Adapter*
- 1 x AUX Cable
- 1 x User Guide
- 1 x Thank You Card

*Note: Power adapter types varied by regions.

Button Control

Function	Operation
Power On / Off	Press and hold the Power Button until a beep is heard.
Volume +	Press the Volume + button
Next Track	Press and hold the Volume + button under the Bluetooth mode
Volume -	Press the Volume - button
Previous Track	Press and hold the Volume - button under the Bluetooth mode
Switch to Bluetooth / AUX Mode	Press the Mode Button to switch between the Bluetooth and AUX mode.
Play / Pause	Press the Play / Pause button
Mute (only under AUX mode)	Press the Play / Pause button to mute / unmute

LED Indication

Operations		LED Status
Power on		Light up blue / green.
Bluetooth Connection	Pairing	Flashes blue fast
	Connected	Stays solid blue during playing; Blinks blue slowly when no audio input
AUX Connection		Stays solid green during playing; Blinks green slowly when no audio input

How to Use

Bluetooth Connection

1. Plug the sound bar to power, press and hold the Power Button until a beep is heard. The device is in the Bluetooth mode initially.
2. When the indicator starts to flash fast, activate the Bluetooth function on your device and search for devices nearby.
3. Find "TaoTronics TT-SK025" in the search results and tap to connect.
4. A beep will be heard and the indicator will turn solid blue upon a successful connection.

Notes:

1. When it's power on, the sound bar will automatically connect to the device last paired if any. Otherwise, it'll enter the pairing mode with the LED indicator blinking fast.
2. To change the connection, press and hold the Play / Pause button to enter the pairing mode and connect another device.

AUX Cable Connection



1. Press the Mode Button to switch to AUX mode.
2. Plug in the AUX cable into the AUX Input port at the back.
3. Connect to an AUX device via the cable.

Note: Buttons on the sound bar do not work under the AUX mode, except that pressing the Play / Pause button can mute / unmute.



The **Bluetooth**® word mark and logos are registered trademarks owned by the Bluetooth SIG, Inc. and any use of such marks by Sunvalleytek International Inc. is under license. Other trademarks and trade names are those of their respective owners.

NOTE: This equipment has been tested and found to comply with the limits for a Class B digital device, pursuant to part 15 of the FCC Rules. These limits are designed to provide reasonable protection against harmful interference in a residential installation. This equipment generates uses and can radiate radio frequency energy and, if not installed and used in accordance with the instructions, may cause harmful interference to radio communications. However, there is no guarantee that interference will not occur in a particular installation. If this equipment does cause harmful interference to radio or television reception, which can be determined by turning the equipment off and on, the user is encouraged to try to correct the interference by one or more of the following measures:

- Reorient or relocate the receiving antenna.
- Increase the separation between the equipment and receiver.
- Connect the equipment into an outlet on a circuit different from that to which the receiver is connected.
- Consult the dealer or an experienced radio/TV technician for help

Changes or modifications not expressly approved by the party responsible for compliance could void the user's authority to operate the equipment. This device complies with Part 15 of the FCC Rules. Operation is subject to the following two conditions:

1. this device may not cause harmful interference, and
2. this device must accept any interference received, including interference that may cause undesired operation.



■ WEEE Compliance

Correct Disposal of This Product (Waste Electrical & Electronic Equipment) (Applicable in countries with separate collection systems)

This marking on the product, accessories or literature indicates that the product and its electronic accessories should not be disposed of with other household waste at the end of their working life. To prevent possible harm to the environment or human health from uncontrolled waste disposal, please separate these items from other types of waste and recycle them responsibly to promote the sustainable reuse of material resources. Household users should contact either the retailer where they purchased this product, or their local government office, for details of where and how they can take these items for environmentally safe recycling. Business users should contact their supplier and check the terms and conditions of the purchase contract. This product and its electronic accessories should not be mixed with other commercial wastes for disposal.

Warning

This content is compiled from multiple sources and is provided for reference purposes only. It may not be complete or fully applicable to all situations. If you are unable to resolve your issue, please contact the product manufacturer or an authorized service provider for official support.