

GETTING STARTED

ASSEMBLY

1. Fully assemble product prior to use. Insert the Upper Handle into Upper Handle Pole and insert Upper Handle Pole into the base. You will hear a “CLICK” when each end locks into place.	
2. Slide the Clean Water Tank into place. Push down firmly.	

NOTE: To avoid damage to wood floors underneath area rugs or carpet, place waterproof material (ex: plastic) underneath them before cleaning.

OPERATION

FILL THE CLEAN WATER TANK

1. Lift up to remove the Clean Water Tank, then remove the cap and add warm water to the fill line. Add Hoover Solution to the solution fill line. Secure cap.	
2. Align the tank and firmly press it into place.	

NOTE: Cap must be locked in place for proper performance and to prevent leaking.

NOTE: Read the directions on the Hoover® Carpet Cleaning fluid prior to use.

CLEANING FLUID: SEE THE HOOVER SOLUTION GUIDE insert or visit [Hoover.com/cleaning-solutions](https://www.hoover.com/cleaning-solutions).

CAUTION: Not to be used for grooming a pet.

BEFORE YOU BEGIN CLEANING

1. Vacuum carpet and upholstery thoroughly with a Hoover vacuum before use. Don't use the carpet cleaner as a traditional vacuum cleaner.





2. Use your Hoover carpet cleaner only if upholstery fabric is marked with a “W” (for wet” clean) or “S/W” (for “solvent/dry” or wet” clean). Don’t clean fabric marked “S” solvent/dry” clean only).

3. Test for colorfastness in a small, hidden area. Gently rub surface with a dampened white cloth. Wait ten minutes and check for color removal or bleed with a white paper towel.

CAUTION: Do not use this EXTRACTOR on hard floors. Using this PRODUCT on hard floors may scratch or damage your floor.

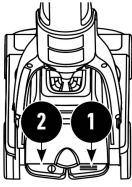
HOW TO CLEAN CARPETS

<p>1. Step on the Handle Release Pedal to recline the cleaner for cleaning position.</p>	
<p>2. Step on the Power Pedal to turn ON.</p> <p>IMPORTANT: Empty Dirty Water Tank when you hear an audible change. Ensure the tank is secured before cleaning.</p>	
<p>3. Squeeze trigger for a slow forward and backward wet stroke.</p>	
<p>4. Release trigger for a slow forward and backward dry stroke. To Rinse: Fill with warm water and omit adding solution to the Clean Water Tank.</p>	

WARNING: Risk of personal injury – Brush roll may suddenly restart – unplug before cleaning or servicing.

HOW TO CLEAN THE DIRTY WATER TANK

To Dry System: Run system for ten seconds before shutting off without engaging trigger

1. Turn power OFF and unplug the power cord.	
2. Open the Quick Pour Spout to empty the tank. Rinse, and allow to air dry.	
3. Prior to replacing tank, check and clean filter as needed.	
4. Replace Dirty Water Tank by tilting back then rocking it forward to snap into place.	

MAINTENANCE

HOW TO REMOVE & CLEAN THE BRUSH ROLL AND REMOVE THE BELT

CAUTION: To reduce the risk of injury from moving parts, unplug before servicing.

1. Remove the nozzle cover by pulling up and forward on the latch. Rinse nozzle cover and allow to air dry.	
2. Lay the product down to access the underside. Use a Philips screwdriver to remove 6 screws. Arrows show location of screws on the underside of your cleaner.	
3. Remove underside belt cover then pull brush roll out. Belt will still be attached to cleaner.	
4. Rinse brush roll and allow to air dry.	
5. Slide belt off shaft and remove. If replacing belt, install the new belt.	



REPLACING THE BELT

1. Place new belt on motor shaft.	1
2. Slip brush roll through belt.	2
3. Position non-belt side end cap of brush roll into pockets.	3
4. Carefully stretch belt to position the other end cap into the pocket.	4
5. Replace belt cover and secure by replacing all 6 screws.	5

NOTE: Rotate brush rolls manually to make sure belt is not twisted or pinched.

LUBRICATION:

The motor is equipped with bearings which contain sufficient lubrication for their lifetime. The addition of lubricant could cause damage. Do not add lubricant to motor bearings.

STORAGE:

Wrap the power cord around the cord hooks for convenient storage. Attach the plug end to the cord. Allow brushes and underside of carpet cleaner to air dry thoroughly before storing carpet cleaner on a carpeted or wood surface.

TROUBLESHOOTING

WARNING: Risk of personal injury – Brush roll may suddenly restart – unplug before cleaning or servicing.

PROBLEM	POSSIBLE CAUSE	POSSIBLE SOLUTION
Cleaner won't run	<ol style="list-style-type: none"> 1. Not firmly plugged in 2. No voltage in wall plug 3. Blown fuse or tripped breaker 4. Fuse in cleaner blown 	<ol style="list-style-type: none"> 1. Plug unit in firmly 2. Check fuse or breaker in home 3. Replace fuse or reset breaker in home 4. Take to service center
Low suction	<ol style="list-style-type: none"> 1. Dirty Water Tank full/automatic shut off engaged 2. Dirty Water Cap or Plug not on correctly 3. Dirty Water Tank Debris Filter Clogged 4. Blockage in nozzle 5. Dirty Water Tank not properly secured 6. Clogged Filter 	<ol style="list-style-type: none"> 1. Remove and empty Dirty Water Tank. 2. Tighten 3. See "How to Clean Dirty Water Tank" 4. See "Maintenance" 5. Replace Dirty Water Tank securely 6. Clean it
Clean water won't dispense	<ol style="list-style-type: none"> 1. Clean Water Tank not firmly in place 2. Clean Water Tank or solution container empty 	<ol style="list-style-type: none"> 1. Make sure tank is securely locked in position 2. Refill container according to cleaning instructions 3. Ensure trigger is being pulled
Brushes won't rotate during floor cleaning	<ol style="list-style-type: none"> 1. Check for jams and/or broken belt 	<ol style="list-style-type: none"> 1. Turn the cleaner off and unplug from electrical outlet. Remove any obstructive debris or replace the belt.



IMPORTANT SAFETY INSTRUCTIONS

WARNING: When using an electrical product, basic precautions should always be followed to avoid electric shock, fire, and/or serious injury, including the following:

- Fully assemble or install product prior to use.
- Do not leave product when plugged in. Unplug from outlet when not in use and before servicing.
- Do not allow to be used as a toy. Not intended for use by children age 12 and under. Close supervision is necessary when used by or near children. To avoid injury or damage, keep children away from product, and do not allow children to place fingers or other objects into any openings.
- Use only as described in this user's manual. Use only Hoover recommended attachments.
- To Reduce the Risk of Fire and Electric Shock due to internal component damage, use only Hoover Cleaning Fluids intended for use with this appliance.
- Do not use product with damaged cord or plug. If product is not working as it should, has been dropped, damaged, left outdoors, or dropped into water, call customer service at 1 (800) 944-9200.
- Do not pull or carry by cord, use cord as a handle, close a door on cord, or pull cord around sharp edges or corners.
- Do not run appliance over cord. Keep cord away from heated surfaces.
- Do not unplug by pulling on cord. To unplug charger, grasp the plug, not the cord.
- Do not handle plug or appliance with wet hands.
- Do not put any object into openings. Do not use with any opening blocked; keep free of dust, lint, hair, and anything that may reduce air flow.
- Keep hair, loose clothing, fingers, and all parts of body away from openings and moving parts.
- Turn off all controls before unplugging.
- Use extra care when cleaning on stairs. To avoid personal injury or damage, and to prevent the products from falling, always place product at bottom of stairs or on floor. Do not place product on stairs or furniture.
- Do not use to pick up flammable or combustible liquids, such as gasoline, or fine wood sandings, or use in areas where they may be present.
- Connect to a properly grounded outlet only. See Grounding Instructions.

CAUTION: TO REDUCE THE RISK OF DAMAGE:

- Avoid picking up hard, sharp objects with this product, as they may cause damage.

- Store appropriately indoors in a dry place. Do not expose machine to freezing temperatures.
- To assist in reducing drying time, be certain the area is well ventilated when using detergents and other cleaners with this machine.
- To help prevent matting and resoiling, avoid contact with carpets until they are dry. Keep children and pets away from carpets until they are completely dry.
- Do not store extractor with solution in tanks.
- With brushes on, do not allow cleaner to sit in one location for an extended period of time, as damage to floor can result.
- Do not use this extractor on hard floors. Using this product on hard floors may scratch or damage your floor.
- Water will drip from the brushes and underside of the product after use and may puddle. To avoid damage to wood and laminate flooring and to avoid potential slip hazard, after use (a) do not leave the product on wood and laminate surfaces and remove to a hard surface and (b) place unit on absorbent material (such as a towel) to soak up drips.

GROUNDING INSTRUCTIONS

This appliance must be grounded. If it should malfunction or breakdown, grounding provides a path of least resistance for electric current to reduce the risk of electric shock. This appliance is equipped with a cord having an equipment-grounding conductor (C) and grounding plug (A). The plug must be inserted into an appropriate outlet (B) that is properly installed and grounded in accordance with all local codes and ordinances.

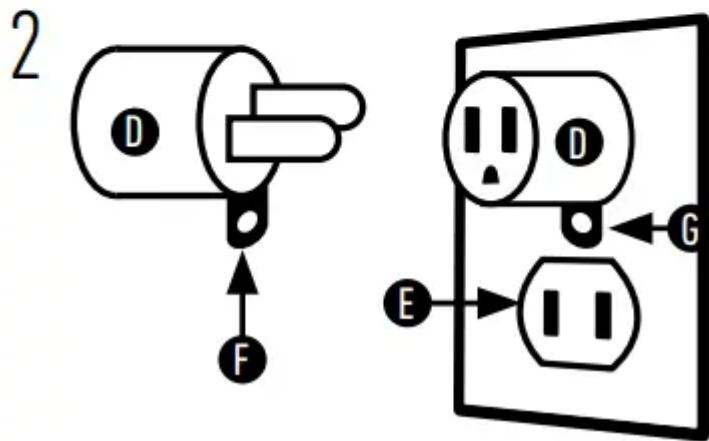
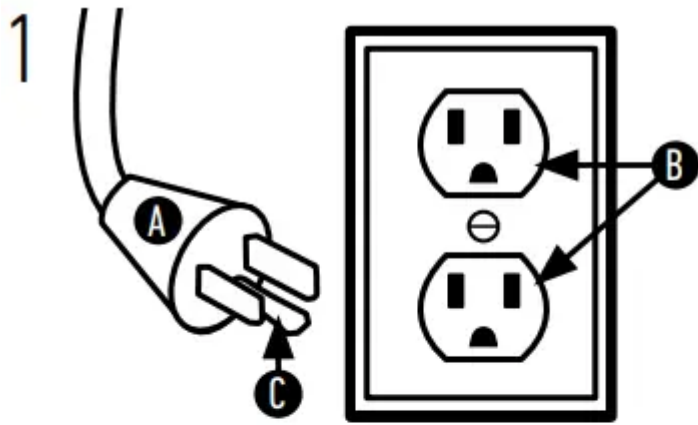

WARNING: Improper connection of the equipment-grounding conductor can result in the risk of electric shock. Check with a qualified electrician or service person if you are in doubt as to whether the outlet is properly grounded. Do not modify the plug provided with the appliance - if it will not fit the outlet, have a proper outlet installed by a qualified electrician.

This appliance is for use on a nominal 120-volt circuit and has a grounding plug that looks like the plug (A) illustrated in Fig. 1.

A temporary adapter (D) may be used to connect this plug to a 2-pole receptacle (E) if a properly grounded outlet is not available (Fig. 2). The temporary adapter should be used only until a properly grounded outlet (B) can be installed by a qualified electrician (Fig. 1). The green colored rigid ear, lug, or the like (F) extending from the adapter must be connected to a permanent ground (G) such as a properly grounded outlet box cover (Fig. 2). Whenever the adapter is used, it must be held in place by a metal screw.

NOTE: In Canada, the use of a temporary adapter is not permitted by the Canadian Electrical Code.

Warning



This content is compiled from multiple sources and is provided for reference purposes only. It may not be complete or fully applicable to all situations. If you are unable to resolve your issue, please contact the product manufacturer or an authorized service provider for official support.

Document generated by [ManualsFile](#)

