

## CHECKING THE COMPONENTS

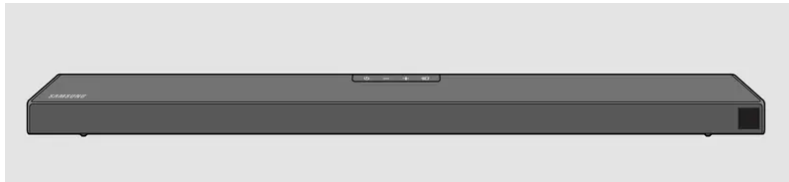

**Soundbar Main Unit**

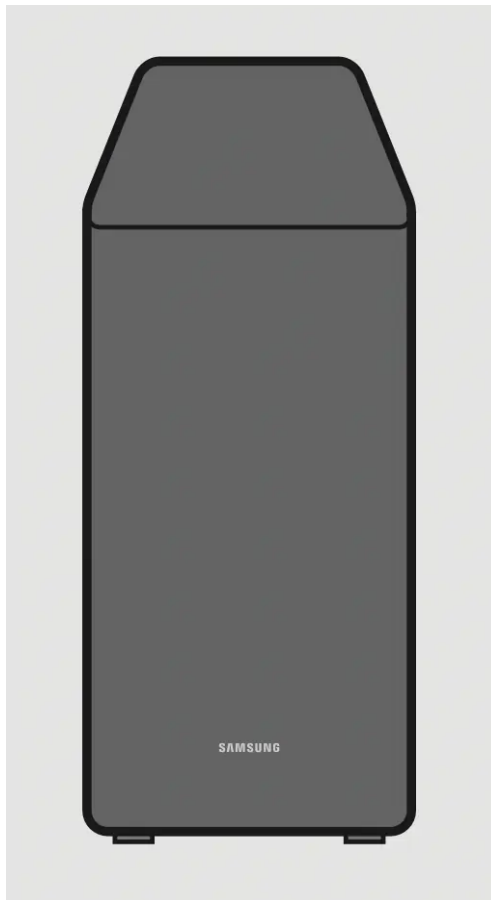

**Subwoofer**



**Remote Control (AH81-09784A) / Batteries**

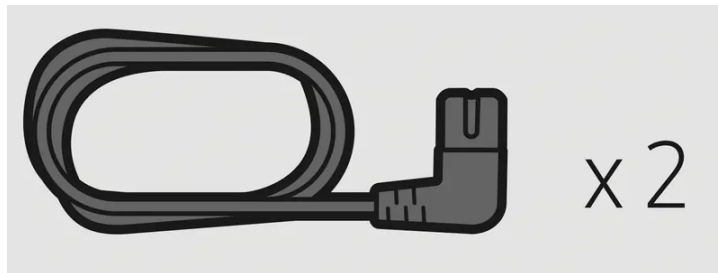

**Power Cord (Subwoofer, Soundbar) (AH81-09826A)**

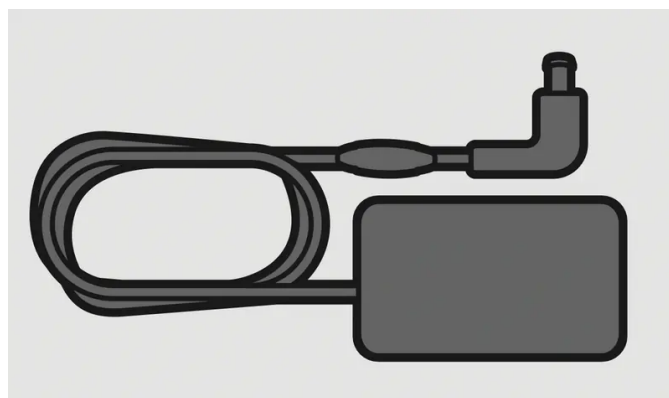

**AC/DC Adapter (Soundbar) (AH81-09783A)**

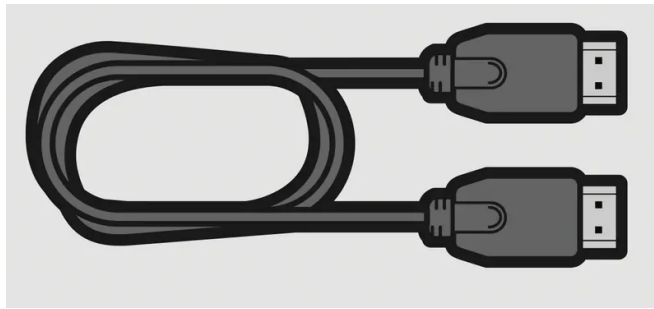

**HDMI Cable (AH81-11233A)**

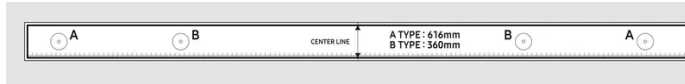

**Wall Mount Guide (AH81-09822A)**

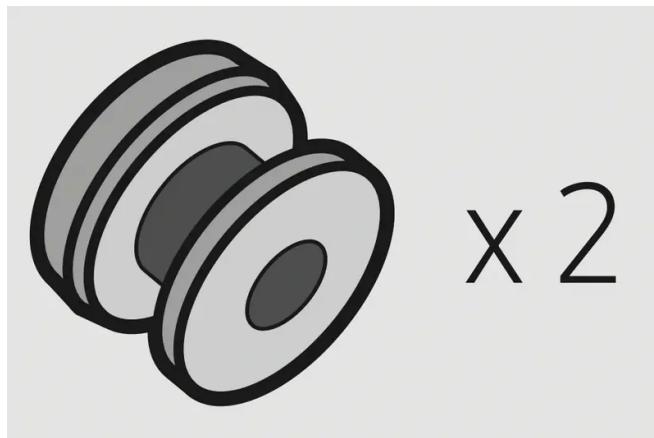

**Holder-Screw (AH81-09824A)**

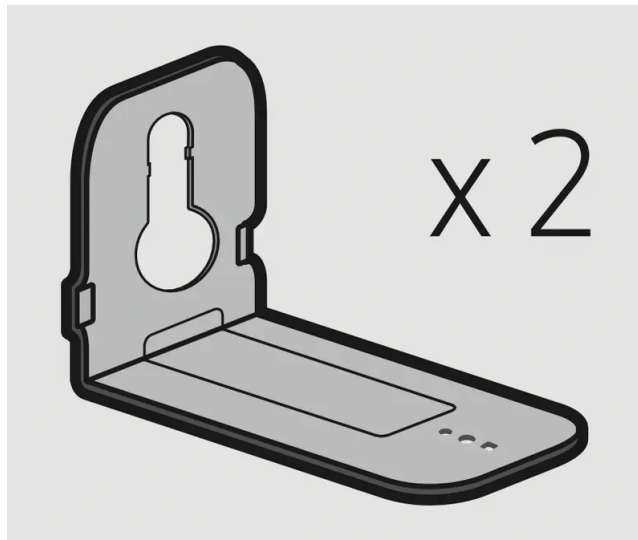

**Bracket-Wall Mount (AH81-09823A)**



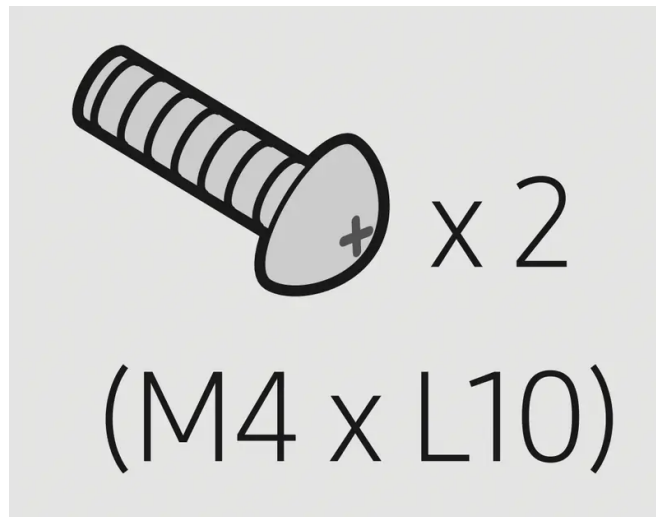

**Screw (AH81-09825A)**

- For more information about the power supply and power consumption, refer to the label attached to the product. (Label: Bottom of the Soundbar Main Unit)
- To purchase additional components or optional cables, contact a Samsung Service Center or Samsung Customer Care.
- The appearance of the accessories may differ slightly from the illustrations above.

## PRODUCT OVERVIEW

### Front Panel / Top Panel of the Soundbar

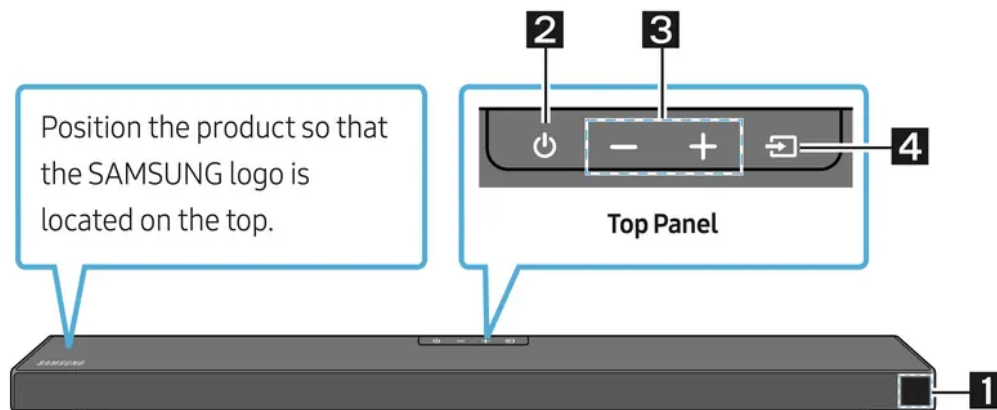

<b>1</b>	<b>Display</b> Displays the product's status and current mode.												
<b>2</b>	<b>⏻ (Power) Button</b> Turns the power on and off. <ul style="list-style-type: none"> <li>• <b>Auto Power Down Function</b>              The unit turns off automatically in the following situations:             <ul style="list-style-type: none"> <li>– In <b>D.IN / HDMI / BT / USB</b> Mode : If there is no audio signal for 20 minutes.</li> </ul> </li> </ul>												
<b>3</b>	<b>⏮ + (Volume) Button</b> Adjusts the volume. <ul style="list-style-type: none"> <li>• When adjusted, the volume level appears on the Soundbar's front display.</li> </ul>												
<b>4</b>	<b>📶 (Source) Button</b> Selects the source input mode. <table border="1" style="width: 100%; margin-top: 10px;"> <thead> <tr> <th style="text-align: center;">Input mode</th> <th style="text-align: center;">Display</th> </tr> </thead> <tbody> <tr> <td style="text-align: center;">Optical Digital input</td> <td style="text-align: center;">D.IN</td> </tr> <tr> <td style="text-align: center;">ARC (HDMI OUT) input</td> <td style="text-align: center;">D.IN → TV ARC (Auto conversion)</td> </tr> <tr> <td style="text-align: center;">HDMI input</td> <td style="text-align: center;">HDMI</td> </tr> <tr> <td style="text-align: center;">BLUETOOTH mode</td> <td style="text-align: center;">BT</td> </tr> <tr> <td style="text-align: center;">USB mode</td> <td style="text-align: center;">USB</td> </tr> </tbody> </table> <ul style="list-style-type: none"> <li>• To turn on "<b>BT PAIRING</b>" mode, change the source to "<b>BT</b>" mode, and then press and hold the <b>📶 (Source)</b> button for more than 5 seconds.</li> </ul>	Input mode	Display	Optical Digital input	D.IN	ARC (HDMI OUT) input	D.IN → TV ARC (Auto conversion)	HDMI input	HDMI	BLUETOOTH mode	BT	USB mode	USB
Input mode	Display												
Optical Digital input	D.IN												
ARC (HDMI OUT) input	D.IN → TV ARC (Auto conversion)												
HDMI input	HDMI												
BLUETOOTH mode	BT												
USB mode	USB												

- When you plug in the AC cord, the power button will begin working in 4 to 6 seconds.
- When you turn on this unit, there will be a 4 to 5 second delay before it produces sound.
- If you want to enjoy sound only from the Soundbar, you must turn off the TV's speakers in the Audio Setup menu of your TV. Refer to the owner's manual supplied with your TV.

## Bottom Panel of the Soundbar

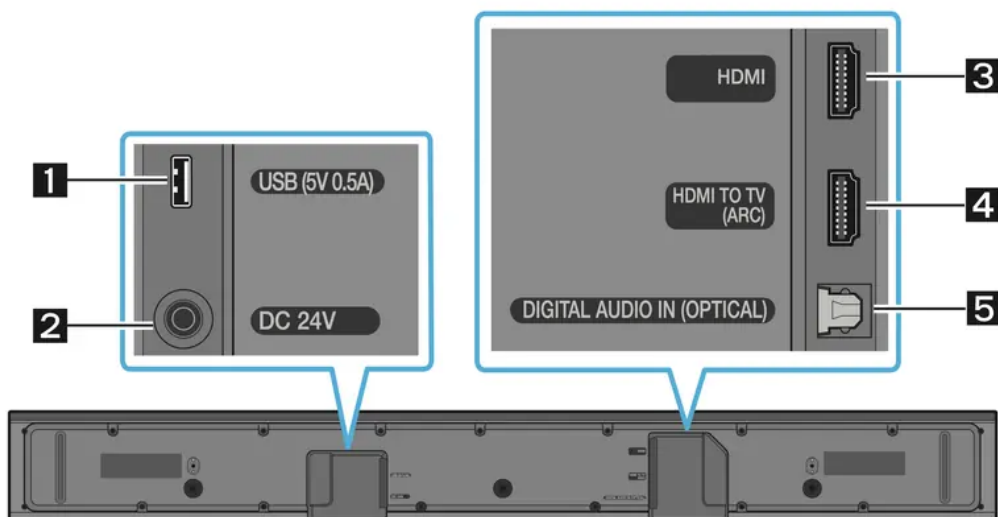

<b>1</b>	<b>USB (5V 0.5A)</b> Connect a USB device here to play music files stored on the USB device through the Soundbar.
<b>2</b>	<b>DC 24V (Power Supply In)</b> Connect the AC/DC power adapter.
<b>3</b>	<b>HDMI</b> Inputs digital video and audio signals simultaneously using an HDMI cable. Connect to the HDMI output of an external device.
<b>4</b>	<b>HDMI TO TV (ARC)</b> Connect to the HDMI (ARC) port on a TV.
<b>5</b>	<b>DIGITAL AUDIO IN (OPTICAL)</b> Connect to the digital (optical) output of an external device.

- When disconnecting the power cable of the AC/DC power adapter from a wall outlet, pull the plug.  
Do not pull the cable.
- Do not connect this unit or other components to an AC outlet until all connections between components are complete.

## CONNECTING THE SOUNDBAR

### Connecting Electrical Power

Use the power components to connect the Subwoofer and Soundbar to an electrical outlet in the following order:

1. Connect the power cord to the Subwoofer.
2. Connect the power output cable to the power adapter, and then to the Soundbar.
3. Connect the power cord to a wall socket.

See the illustrations below.

- For more information about the required electrical power and power consumption, refer to the label attached to the product. (Label: Bottom of the Soundbar Main Unit)

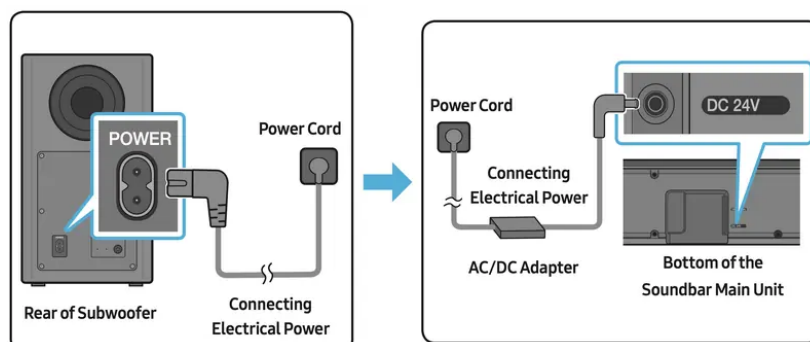

Make sure to rest the AC/DC Adapter flat on a table or the floor. If you place the AC/DC Adapter so that it is hanging with the AC cord input facing upwards, water or other foreign substances could enter the Adapter and cause the Adapter to malfunction.

## Connecting the Soundbar to the Subwoofer

When the subwoofer is connected, you can enjoy rich bass sound.

### **Automatic connection between the Subwoofer and the Soundbar**

When you turn the power on after connecting the power cables to the Soundbar and subwoofer, the subwoofer is automatically connected to the Soundbar.

- When auto pairing is complete, the blue indicator at the rear of the subwoofer turn on.

### **LED Indicator Lights on the Rear of Subwoofer**

LED	Status	Description	Resolution
Blue	On	Successfully connected (normal operation)	-
	Blinking	Recovering the connection	Check if the power cable attached to the main Soundbar unit is connected properly or wait about 5 minutes. If blinking persists, try manually connecting the subwoofer. See page 7.
Red	On	Standby (with the Soundbar main unit turned off)	Check if the power cable attached to the main Soundbar unit is connected properly.
		Connection failed	Connect again. See the instructions for manual connection on page 7.
Red and blue	Blinking	Malfunction	See the contact information for the Samsung Service Center in this manual.

### **Manually connecting the Subwoofer if automatic connection fails**

**Before performing the manual connection procedure below:**

- Check whether the power cables for the Soundbar and subwoofer are connected properly.

- Make sure that the Soundbar is turned on.

1. Press and hold ID SET on the rear of the subwoofer for at least 5 seconds.

The red indicator on the rear of the subwoofer turns off and the blue indicator blinks.

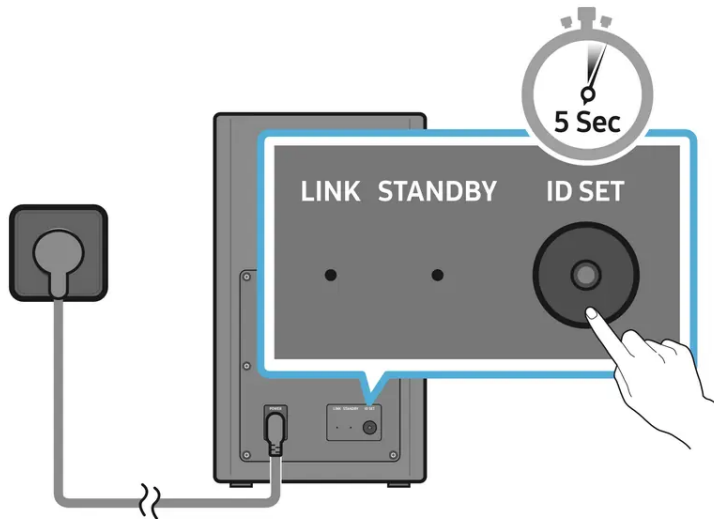

**Rear of Subwoofer**

2. Press and hold the Up button on the remote control for at least 5 seconds.

The ID SET message appears on the display of the Soundbar for a moment, and then it disappears.

The Soundbar will automatically power on when ID SET is complete.

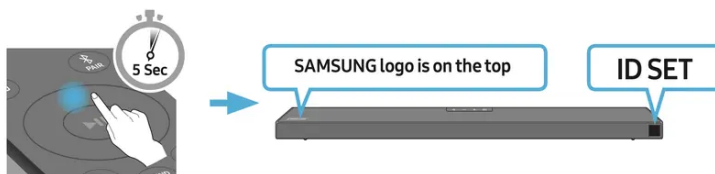

3. Check if the LINK LED is solid blue (connection complete).

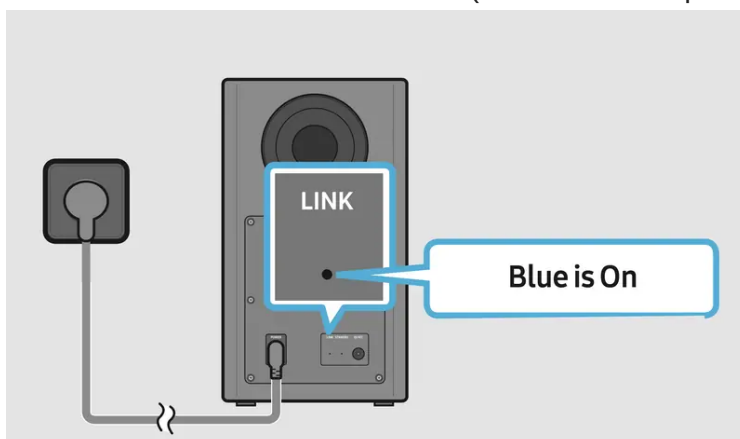

The LINK LED indicator stops blinking and glows a solid blue when a connection is established between the Soundbar and the Wireless Subwoofer.

## NOTES

- Do not connect the power cord of this product or your TV to a wall outlet until all connections between components are complete.
- Before moving or installing this product, be sure to turn off the power and disconnect the power cord.
- If the main unit is powered off, the wireless subwoofer will go into stand-by mode and the STANDBY LED on the rear of the sub-woofer will turn red after blinking blue several times.
- If you use a device that uses the same frequency (5.8GHz) as the Soundbar near the Soundbar, interference may cause some sound interruption.
- The maximum transmission distance of the main unit's wireless signal is about 32.8 ft (10 m), but may vary depending on your operating environment. If a steel-concrete or metallic wall is between the main unit and the wireless subwoofer, the system may not operate at all because the wireless signal cannot penetrate metal.

## PRECAUTIONS

- Wireless receiving antennas are built into the wireless subwoofer. Keep the unit away from water and moisture.
- For optimal listening performance, make sure that the area around the wireless subwoofer and the Wireless Receiver Module (sold separately) is clear of any obstructions.

## Connecting an SWA-8500S (Sold Separately) to your Soundbar

Expand to true wireless surround sound by connecting the Samsung Wireless Rear Speaker Kit (SWA-8500S, sold separately) to your Soundbar.

1. Connect the Wireless Receiver Module to 2 Surround Speakers.

When connecting the speaker cable, connect the core wire to the speaker.

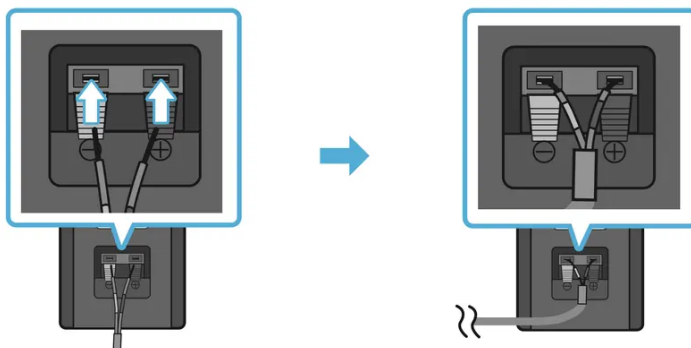

The speaker cables are color coded.

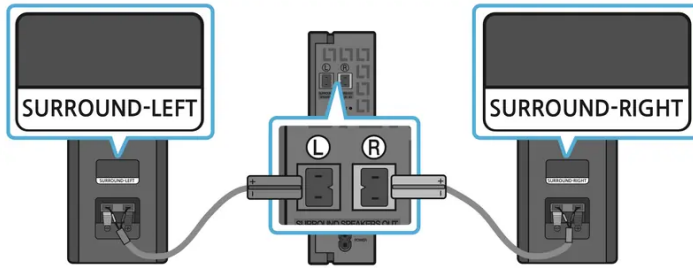

2. Check the standby status of the Wireless Receiver Module after plugging it into an electrical outlet.

The LINK LED indicator (blue LED) on the Wireless Receiver Module blinks. If the LED does not blink, press the ID SET button on the back of the Wireless Receiver Module with a pen tip for 5~6 seconds until the LINK LED indicator blinks (in Blue). For more about the LED, please refer to the SWA-8500S user manual.

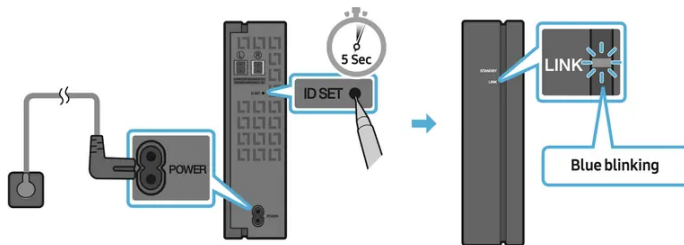

3. Press and hold the Up button on the remote control for at least 5 seconds.

The ID SET message appears on the display of the Soundbar for a moment, and then it disappears.

The Soundbar will automatically power on when ID SET is complete.

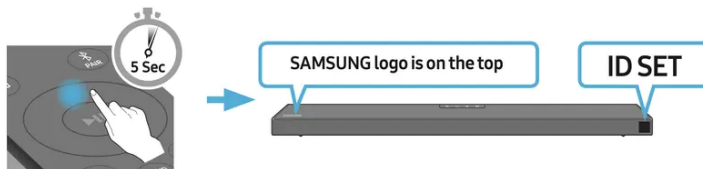

**CAUTION:** If your Soundbar was playing music when it connects to the SWA-8500S, you may hear some stuttering from the woofer as the connection finalizes.

4. Check if the LINK LED is solid blue (connection complete).

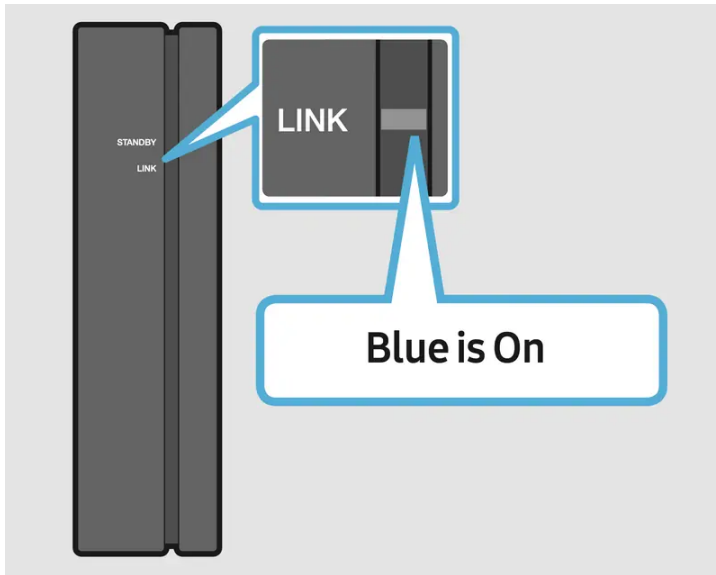

The LINK LED indicator stops blinking and glows a solid blue when a connection is established between the Soundbar and the Wireless Receiver Module.

5. If the SWA-8500S is not connected, repeat the procedure from Step 2.

## CONNECTING TO YOUR TV

Hear TV sound from your Soundbar through wired or wireless connections.

- When the Soundbar is connected to selected Samsung TVs, the Soundbar can be controlled using the TV's remote control.
  - This feature is supported by 2017 and later Samsung Smart TVs that support Bluetooth when you connect the Soundbar to the TV using an optical cable.
  - This function also allows you to use the TV menu to adjust the sound field and various settings as well as the volume and mute.

### Method 1. Connecting with a Cable

#### Connecting a TV using an HDMI Cable

##### CAUTION

- When both the HDMI cable and optical cable are connected, the HDMI signal is received first.
- To connect the HDMI cable between the TV and Soundbar, be sure to connect the terminals marked ARC. Otherwise, the TV sound may not be output.
- The recommended cable is High Speed HDMI Cable with Ethernet.

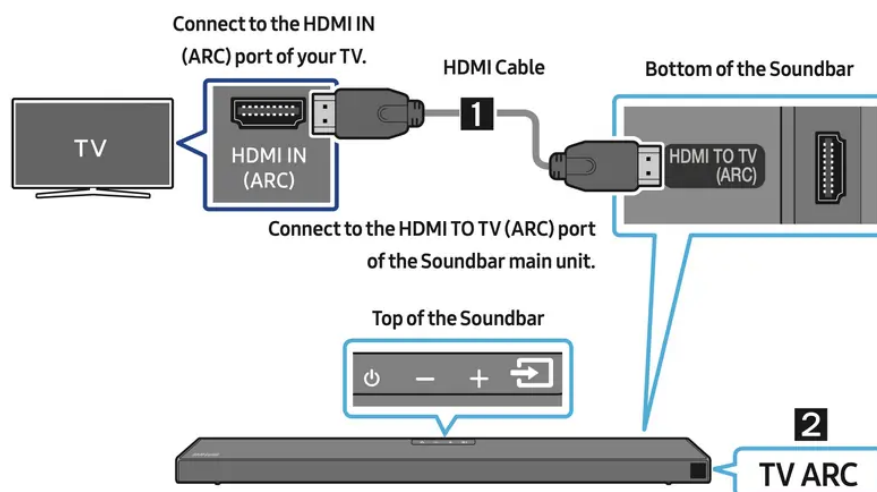

1. With the Soundbar and TV turned on, connect the HDMI cable as shown in the figure.
2. “TV ARC” appears in the display window of the Soundbar main unit and the Soundbar plays TV sound.
  - If TV sound is inaudible, press the  (**Source**) button on the remote control or on the top of the Soundbar to switch to “D.IN” mode. The screen displays “D.IN” and “TV ARC” in sequence, and TV sound is played.
  - If “TV ARC” does not appear in the display window of the Soundbar main unit, confirm that the HDMI cable is connected to the correct port.
  - Use the volume buttons on the TV’s remote control to change the volume on the Soundbar.

## NOTES

- HDMI is an interface that enables the digital transmission of video and audio data with just a single connector.
- If the TV provides an ARC port, connect the HDMI cable to the HDMI IN (ARC) port.
- We recommend you use a coreless HDMI cable if possible. If you use a cored HDMI cable, use one whose diameter is less than 0.55 inches (14 mm).
- This function is not available if the HDMI cable does not support ARC.
- When the audio in a broadcast is encoded in Dolby Digital and the “Digital Output Audio Format” on your TV is set to PCM, we recommend that you change the setting to Dolby Digital. When the setting on the TV is changed, you will experience better sound quality. (The TV menu may use different words for Dolby Digital and PCM depending on the TV manufacturer.)

## Connecting using an Optical Cable

## Pre-connection Checklist

- When both the HDMI cable and optical cable are connected, the HDMI signal is received first.
- When you use an optical cable and the terminals have covers, be sure to remove the covers.

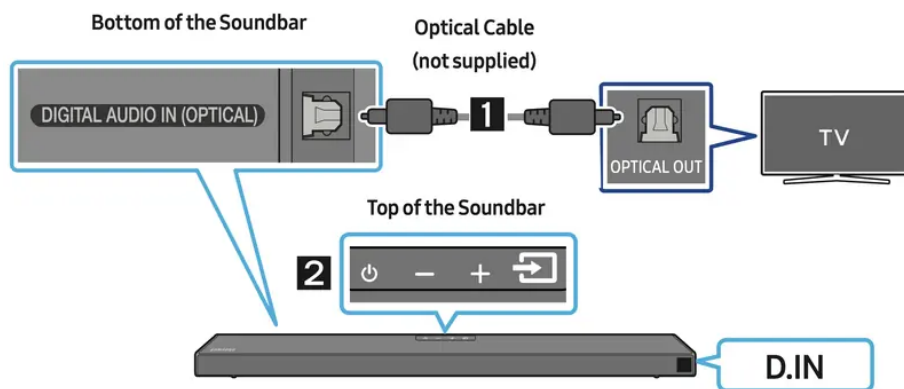

1. Connect the DIGITAL AUDIO IN (OPTICAL) port on the Soundbar to the OPTICAL OUT port of the TV with a digital Optical Cable (not supplied).
2. Press the  (**Source**) button on the top panel or remote control, and then select the “D.IN” mode.

## Using the Q-Symphony Function

For Q-Symphony, the Soundbar syncs with a Samsung TV to output sound through two devices for optimum surround effect. When the Soundbar is connected, the option, “TV+Soundbar” appears under the Sound Output menu of the TV. Select the corresponding menu.

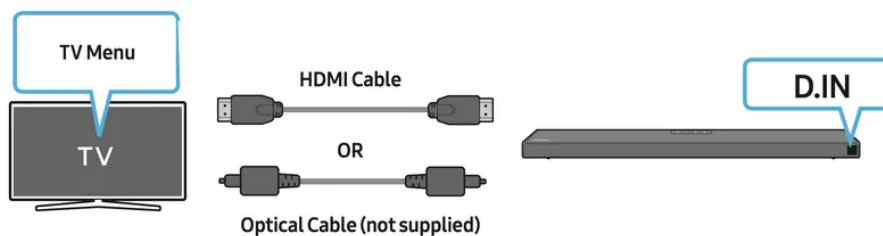

- TV menu example: TV + [AV] Soundbar series name [HDMI]

## NOTES

- It can operate according to the Codec supported by TV.

- This function is supported only when the HDMI Cable or Optical Cable (not supplied) is connected.
- This function is available in Samsung TVs released in or after 2020 and some Soundbar models.

## Method 2. Connecting Wirelessly

### Connecting a TV via Bluetooth

When a TV is connected using Bluetooth, you can hear stereo sound without the hassle of cabling.

- Only one TV can be connected at a time.

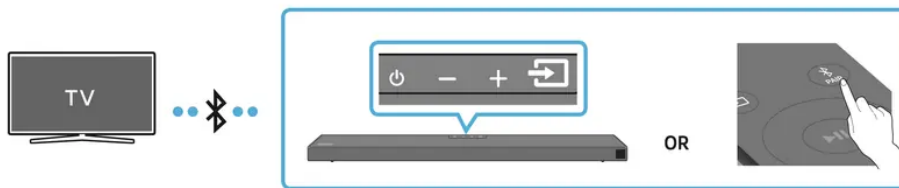

### The initial connection

1. Press the **PAIR** button on the remote control to enter the **“BT PAIRING”** mode.  
**(OR)**
  - a. Press the **(Source)** button on the top panel and then select **“BT”**.  
**“BT”** changes to **“BT PAIRING”** in a few seconds automatically or changes to **“BT READY”** if there is a connect record.
  - b. When **“BT READY”** appears, press and hold the **(Source)** button on the top panel of the Soundbar for more than 5 seconds to display **“BT PAIRING”**.
2. Select Bluetooth mode on the TV. (For more information, see the TV’s manual.)
3. Select **“[AV] Samsung Soundbar Q6T-Series”** from the list on TV’s screen.  
An available Soundbar is indicated with **“Need Pairing”** or **“Paired”** on the TV’s Bluetooth device list. To connect the TV to the Soundbar, select the message, and then establish a connection.  
When the TV is connected, **[TV Name]** → **“BT”** appears on the Soundbar’s front display.
4. You can now hear TV sound from the Soundbar.

### If the device fails to connect

- If a previously connected Soundbar listing (e.g. **“[AV] Samsung Soundbar Q6T-Series”**) appears in the list, delete it.
- Then repeat steps 1 through 3.



**NOTE:** After you have connected the Soundbar to your TV the first time, use the **“BT READY”** mode to reconnect.

### Disconnecting the Soundbar from the TV

Press the  (**Source**) button on the top panel or on the remote control and switch to any mode but “BT”.

- Disconnecting takes time because the TV must receive a response from the Soundbar. (The time required may differ, depending on the TV model.)
- To cancel the automatic Bluetooth connection between the Soundbar and TV, press the Left button on the remote control for 5 seconds with the Soundbar in “**BT READY**” status. (Toggle On → Off)

#### **What is the difference between BT READY and BT PAIRING?**

- **BT READY** : In this mode, you can search for previously connected TVs or connect a previously connected mobile device to the Soundbar.
- **BT PAIRING** : In this mode, you can connect a new device to the Soundbar. (Press the  **PAIR** button on the remote control or press and hold the  (**Source**) button on the top of the Soundbar for more than 5 seconds while the Soundbar is in “**BT**” mode.)

#### **NOTES**

- If asked for a PIN code when connecting a Bluetooth device, enter <0000>.
- In Bluetooth connection mode, the Bluetooth connection will be lost if the distance between the Soundbar and the Bluetooth device exceeds 32.8 ft (10 meters).
- The Soundbar automatically turns off after 20 minutes in the Ready state.
- The Soundbar may not perform Bluetooth search or connection correctly under the following circumstances:
  - If there is a strong electrical field around the Soundbar.
  - If two or more Bluetooth devices are simultaneously paired with the Soundbar.
  - If the Bluetooth device is turned off, not in place, or malfunctions.
- Electronic devices may cause radio interference. Devices that generate electromagnetic waves must be kept away from the Soundbar main unit - e.g., microwaves, wireless LAN devices, etc.

## **CONNECTING AN EXTERNAL DEVICE**

Connect to an external device via a wired connection or Bluetooth connection to play the external device's sound through the Soundbar.

## Connecting using an HDMI Cable

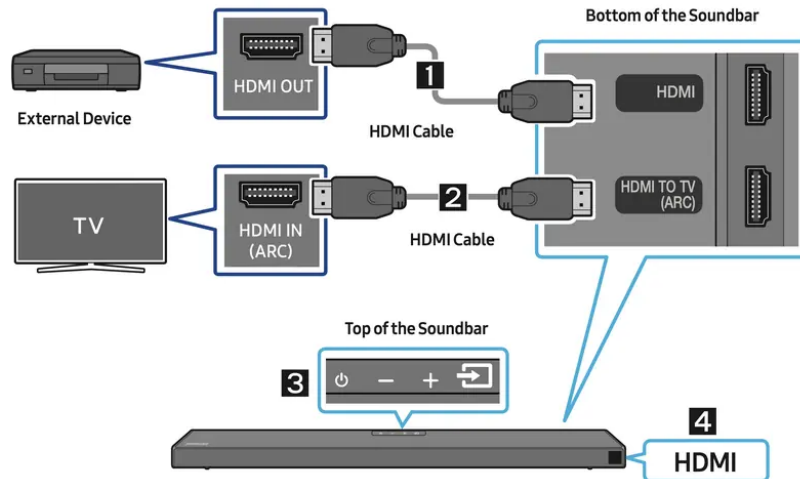

1. Connect an HDMI cable from the HDMI port on the back of the product to the HDMI OUT port on your digital device.
2. Connect an HDMI cable from the HDMI TO TV (ARC) port on the back of the product to the HDMI IN port on your TV.
3. Press the  (**Source**) button on the top panel or on the remote control, and then select "HDMI".
4. "HDMI" mode is displayed on the Soundbar display panel and sound plays.

### Supported UHD Signals Specification (3840 x 2160p)

Frame rate (fps)	Color depth	RGB 4:4:4	YCbCr 4:4:4	YCbCr 4:2:2	YCbCr 4:2:0
< 60	8 bit	○	○	○	○
	10 bit	-	-	-	○
	12 bit	-	-	-	○
120	8 bit	-	-	-	-
	10 bit	-	-	-	-

- Supported specification may vary depending on the connected external device or usage conditions.

## Connecting using an Optical Cable

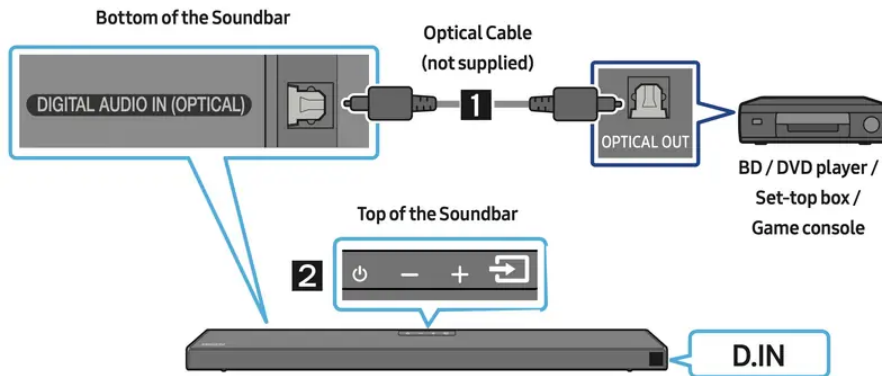

1. Connect **DIGITAL AUDIO IN (OPTICAL)** on the main unit to the OPTICAL OUT port of the Source Device using a digital Optical Cable (not supplied).
2. Select “D.IN” mode by pressing the  (**Source**) button on the top panel or on the remote control.

## CONNECTING A USB STORAGE DEVICE

You can play music files located on USB storage devices through the Soundbar.

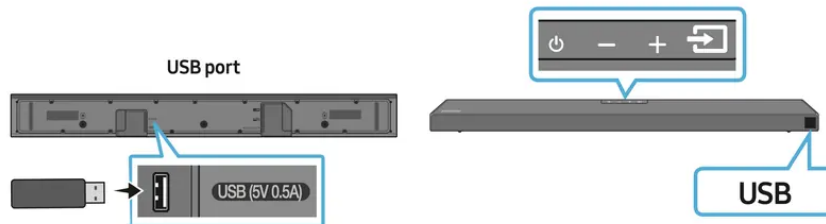

1. Connect the USB device to the USB port on the bottom of the product.
2. Press the  (**Source**) button on the top panel or on the remote control, and then select “USB”.
3. “USB” appears in the display screen.
4. Play music files from the USB storage device through the Soundbar.
  - The Soundbar automatically turns off (Auto Power Down) if no USB device has been connected for more than 20 minutes.

## File Format Type Compatibility list

Extension	Codec	Sampling Rate	Bitrate
*.mp3	MPEG1 Layer2	32kHz ~ 48kHz	32kbps ~ 320kbps
	MPEG1 Layer3	32kHz ~ 48kHz	32kbps ~ 320kbps
	MPEG2 Layer3	16kHz ~ 24kHz	8kbps ~ 160kbps
	MPEG2.5 Layer3	8kHz ~ 12kHz	8kbps ~ 160kbps
*.wma	WMA7/8/9 (Audio Only)	32kHz ~ 48kHz	32kbps ~ 320kbps
*.ogg	Vorbis	32kHz ~ 48kHz	45kbps ~ 500kbps
*.aac *.m4a *.mp4	AAC-LC (MPEG2/MPEG4 Audio Only)	32kHz ~ 48kHz	32kbps ~ 320kbps
*.wav	LPCM	32kHz ~ 192kHz	1,024kbps ~ 9,216kbps
*.flac	FLAC	32kHz ~ 192kHz	162kbps ~ 8,100kbps
*.aiff	AIFF	32kHz ~ 192kHz	1,024kbps ~ 9,216kbps

- If there are too many folders (about 200) and files (about 2000) stored on the USB device, it may take the Soundbar some time to access and play files.

## CONNECTING A MOBILE DEVICE

### Connecting via Bluetooth

When a mobile device is connected using Bluetooth, you can hear stereo sound without the hassle of cabling.

- The connection is limited to one TV or two Bluetooth devices at the same time.

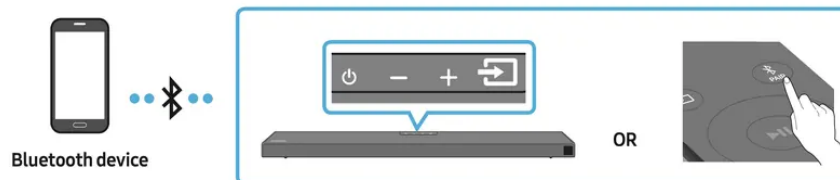

1. Press the **PAIR** button on the remote control to enter the **"BT PAIRING"** mode.  
**(OR)**
  - a. Press the **(Source)** button on the top panel and then select **"BT"**.  
**"BT"** changes to **"BT PAIRING"** in a few seconds automatically or changes to **"BT READY"** if there is a connect record.
  - b. When **"BT READY"** appears, press and hold the **(Source)** button on the top panel of the Soundbar for more than 5 seconds to display **"BT PAIRING"**.
2. On your device, select "[AV] Samsung Soundbar Q6T-Series" from the list that appears.  
When the Soundbar is connected to the Bluetooth device, **[Bluetooth Device Name]** → **"BT"** appears in the front display.
3. Play music files from the device connected via Bluetooth through the Soundbar.

### **If the device fails to connect**

- If a previously connected Soundbar listing (e.g. “[AV] Samsung Soundbar Q6T-Series”) appears in the list, delete it.
- Then repeat steps 1 and 2.

**NOTE:** After you have connected the Soundbar to your mobile device the first time, use the “BT READY” mode to reconnect.

### **What is the difference between BT READY and BT PAIRING?**

- **BT READY** : In this mode, you can search for previously connected TVs or connect a previously connected mobile device to the Soundbar.
- **BT PAIRING** : In this mode, you can connect a new device to the Soundbar. (Press the **PAIR** button on the remote control or press and hold the **(Source)** button on the top of the Soundbar for more than 5 seconds while the Soundbar is in “BT” mode.)

### **NOTES**

- If asked for a PIN code when connecting a Bluetooth device, enter <0000>.
- In Bluetooth connection mode, the Bluetooth connection will be lost if the distance between the Soundbar and the Bluetooth device exceeds 32.8 ft (10 m).
- The Soundbar automatically turns off after 20 minutes in the Ready state.
- The Soundbar may not perform Bluetooth search or connection correctly under the following circumstances:
  - If there is a strong electrical field around the Soundbar.
  - If several Bluetooth devices are simultaneously paired with the Soundbar.
  - If the Bluetooth device is turned off, not in place, or malfunctions.
- Electronic devices may cause radio interference. Devices that generate electromagnetic waves must be kept away from the Soundbar main unit - e.g., microwaves, wireless LAN devices, etc.
- The Soundbar supports SBC data (44.1kHz, 48kHz).
- Connect only to a Bluetooth device that supports the A2DP (AV) function.
- You cannot connect the Soundbar to a Bluetooth device that supports only the HF (Hands Free) function.
- Once you have paired the Soundbar to a Bluetooth device, selecting “[AV] Samsung Soundbar Q6T-Series” from the device’s scanned devices list will automatically change the Soundbar to “BT” mode.
  - Available only if the Soundbar is listed among the Bluetooth device’s paired devices.

(The Bluetooth device and the Soundbar must have been previously paired at least once.)

- The Soundbar will appear in the Bluetooth device's searched devices list only when the Soundbar is displaying "BT READY".

## **Bluetooth Power On (SOUND MODE)**

If a previously paired Bluetooth device tries to pair with the Soundbar when the Bluetooth Power On function is on and the Soundbar is turned off, the Soundbar turns on automatically.

1. Press and hold the SOUND MODE button for more than 5 seconds on the remote while the Soundbar is turned on.
2. "ON-BLUETOOTH POWER" appears on the Soundbar's display.

## **Disconnecting the Bluetooth device from a Soundbar**

You can disconnect a Bluetooth device from the Soundbar. For instructions, see the Bluetooth device's user manual.

- The Soundbar will be disconnected.
- When the Soundbar is disconnected from the Bluetooth device, the Soundbar will display "BT DISCONNECTED" on the front display.

## **Disconnecting the Soundbar from the Bluetooth device**

Press the  (**Source**) button on the top panel or on the remote control, and then change to any mode except "BT".

- Disconnecting takes time because the Bluetooth device must receive a response from the Soundbar. (Disconnection time may differ, depending on the Bluetooth device)
- When the Soundbar is disconnected from the Bluetooth device, the Soundbar will display "BT DISCONNECTED" on the front display.

## **NOTES**

- In Bluetooth connection mode, the Bluetooth connection will be lost if the distance between the Soundbar and the Bluetooth device exceeds 32.8 ft (10 m).
- The Soundbar automatically turns off after 20 minutes in the Ready state.

## **More About Bluetooth**

Bluetooth is a technology that enables Bluetooth-compliant devices to interconnect easily with each other using a short wireless connection.

- A Bluetooth device may cause noise or malfunction, depending on usage, if:
  - A part of your body is in contact with the receiving/transmitting system of the Bluetooth device or the Soundbar.

- It is subject to electrical variation from obstructions caused by a wall, corner, or office partition.
- It is exposed to electrical interference from same frequency-band devices including medical equipment, microwave ovens, and wireless LANs.
- Pair the Soundbar with the Bluetooth device while they are close together.
- The further the distance between the Soundbar and Bluetooth device, the worse the quality is.  
If the distance exceeds the Bluetooth operational range, the connection is lost.
- In poor reception areas, the Bluetooth connection may not work properly.
- The Bluetooth connection only works when it is close to the unit. The connection will be automatically cut off if the Bluetooth device is out of range. Even within range, the sound quality may be degraded by obstacles such as walls or doors.
- This wireless device may cause electric interference during its operation.

### **Bluetooth Multi connection**

The Soundbar can be connected to 2 Bluetooth devices at the same time.



1. Connect the Soundbar to up to two Bluetooth devices. (See page 20)
2. Play music from one of the connected Bluetooth devices while two devices are connected.
3. To play music from the Bluetooth device “B” while playing from the device “A”, pause or stop playback on the device “A” and then start playing on the device “B”.  
The device won’t switch if playing music from the device “B” without pausing or stopping the device “A” first.
4. In versions prior to AVRCP V1.4, the switching time of the device playing music may be delayed.





### **NOTES**

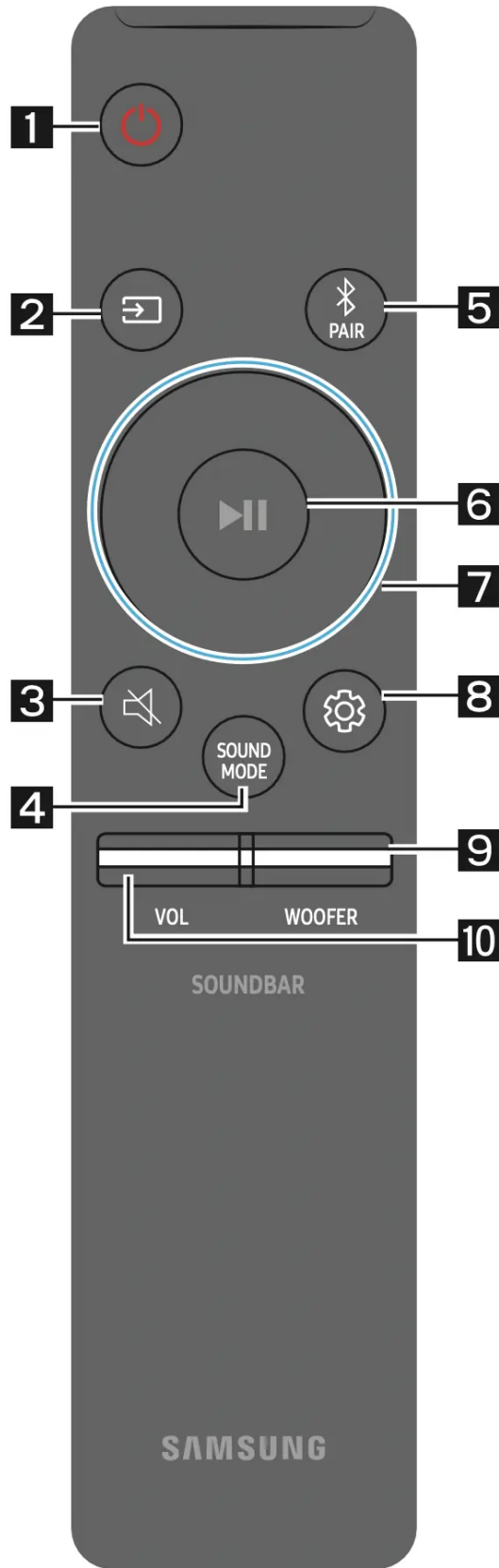

- If you attempt to connect a 3rd Bluetooth device, the A or B devices will disconnect. (A device that is not currently playing will be disconnected.)
- Only one Samsung TV, or 2 Bluetooth devices can be connected at the same time.
- The Soundbar will be disconnected from Bluetooth devices when it receives a connection request from a Samsung TV.







# USING THE REMOTE CONTROL

## How to Use the Remote Control

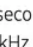
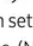

1	 <b>Power</b>	Turns the Soundbar on and off.
2	 <b>Source</b>	Press to select a source connected to the Soundbar.
3	 <b>Mute</b>	Press the  ( <b>Mute</b> ) button to mute the sound. Press it again to unmute the sound.
4	 <b>SOUND MODE</b>	<p>Press to cycle through the available sound modes: <b>STANDARD</b>, <b>SURROUND SOUND</b>, <b>GAME PRO</b>, or <b>DTS VIRTUAL:X</b>.</p> <ul style="list-style-type: none"> <li>- <b>STANDARD</b> Outputs the original sound.</li> <li>- <b>SURROUND SOUND</b> Provides a wider sound field than standard.</li> <li>- <b>GAME PRO</b> Provides stereoscopic sound to immerse you in the action while gaming.</li> <li>- <b>DTS VIRTUAL:X</b> Immersive 3D sound from any content.</li> </ul> <ul style="list-style-type: none"> <li>• <b>DRC (Dynamic Range Control)</b> Lets you apply dynamic range control to Dolby Digital tracks. Press and hold the <b>SOUND MODE</b> button for more than 5 seconds while the Soundbar is powered off to turn DRC (Dynamic Range Control) on or off. With the DRC turned on, loud sound is reduced. (The sound may be distorted.)</li> </ul>

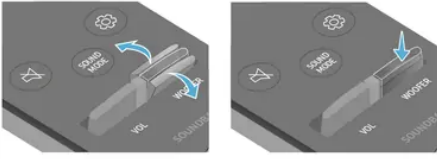
	<ul style="list-style-type: none"> <li>• <b>Bluetooth Power</b> This feature automatically turns the Soundbar on when it receives a connection request from a previously connected TV or Bluetooth device. The setting is On by default. <ul style="list-style-type: none"> <li>– Press and hold the <b>SOUND MODE</b> button for more than 5 seconds to turn off the Bluetooth Power function.</li> </ul> </li> </ul>
<p><b>5</b></p>  <p><b>Bluetooth PAIR</b></p>	<p>Press the <b>PAIR</b> button. "<b>BT PAIRING</b>" appears in the Soundbar's display. You can connect the Soundbar to a new Bluetooth device in this mode by selecting the Soundbar from the Bluetooth device's search list.</p>
<p><b>6</b></p>  <p><b>Play / Pause</b></p>	<p>Press the <b>▶  </b> button to pause a music file temporarily. When you press the button again, the music file plays.</p>
<p><b>7</b></p>  <p><b>Up/Down/Left/Right</b></p>	 <p><b>Press the indicated areas to select Up/Down/Left/Right.</b></p> <p>Press Up/Down/Left/Right on the button to select or set functions.</p> <ul style="list-style-type: none"> <li>• <b>Repeat</b> To use the Repeat function in "<b>USB</b>" mode, press the <b>Up</b> button.</li> <li>• <b>Music Skip</b> Press the <b>Right</b> button to select the next music file. Press the <b>Left</b> button to select the previous music file.</li> <li>• <b>ID SET</b> Press and hold the <b>Up</b> button for 5 seconds to complete <b>ID SET</b> (when connecting to a wireless subwoofer or wireless rear speakers).</li> <li>• <b>Volume Restriction function</b> To protect your hearing, the Volume Restriction function restricts the volume to 20 if you turn on the Soundbar when the volume is set higher than 20. <ul style="list-style-type: none"> <li>– The default value for the Volume Restriction function is Off. You must turn it on to activate it.</li> <li>– When turned on, the Volume Restriction function stays on even when the power is turned off.</li> <li>– To turn Volume Restriction on or off, press and hold the <b>Down</b> button on the remote control for 5 seconds. With Volume Restriction off, "<b>V FREE</b>" appears on the front display. With the function on, "<b>V LOCK</b>" appears.</li> </ul> </li> </ul>

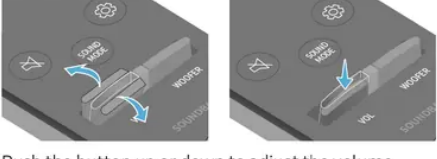
8	 <b>Sound Control</b>	<p>When pressed, the settings <b>TREBLE</b>, <b>BASS</b>, or <b>AUDIO SYNC</b> are displayed in sequence. The desired settings can be adjusted using the <b>Up/Down</b> buttons.</p> <ul style="list-style-type: none"> <li>To control the volume of the treble or bass sound, press the  (<b>Sound Control</b>) button to select <b>TREBLE</b> or <b>BASS</b> and then adjust the volume between -6~+6 by using the <b>Up/Down</b> buttons.</li> <li>Press and hold the  (<b>Sound Control</b>) button for about 5 seconds to adjust the sound for each frequency band. 150Hz, 300Hz, 600Hz, 1.2kHz, 2.5kHz, 5kHz, and 10kHz are selectable using the <b>Left/Right</b> buttons and each can be adjusted to a setting between -6 to +6 using the <b>Up/Down</b> buttons.</li> <li>If the video on the TV and audio from the Soundbar are not synchronized, press the  (<b>Sound Control</b>) button to select <b>AUDIO SYNC</b> and then set the audio delay between 0~300 milliseconds by using the <b>Up/Down</b> buttons. (Not available in "USB" or "BT" mode.)</li> <li>If Surround Speakers (sold separately) are connected, the Rear Speaker function can be turned <b>ON/OFF</b> by using the <b>Up/Down</b> buttons to adjust the volume within a -6 to +6 range.</li> <li><b>AUDIO SYNC</b> is only supported for some functions.</li> </ul>
9	 <b>WOOFER (BASS) LEVEL</b>	 <p>Push the button up or down to adjust the level of the woofer (bass) to -12 or between -6 to +6. To set the woofer (bass) volume level to 0 (Default), press the button.</p>
10	 <b>VOL (Volume)</b>	 <p>Push the button up or down to adjust the volume.</p> <ul style="list-style-type: none"> <li><b>Mute</b> Press the <b>VOL</b> button in to mute the sound. Press it in again to unmute the sound.</li> </ul>

## Adjusting the Soundbar volume with a TV remote control

If you have a Samsung TV, you can adjust the Soundbar's volume using the IR remote control that came with your Samsung TV.

First use the TV menu to set the TV audio on your Samsung TV to external speakers, then use your Samsung remote to control the Soundbar's volume. For more information, see the TV's user manual. The default mode for this function is control by a Samsung TV remote. If your TV is not a Samsung TV, follow the directions below to change the settings of this function.

1. Turn Off the Soundbar.

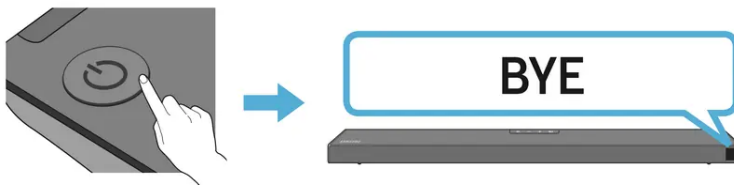

2. If you do not want to use this function, push up and hold the WOOFER button for 5 seconds repeatedly until “OFF-TV REMOTE” appears in the display.

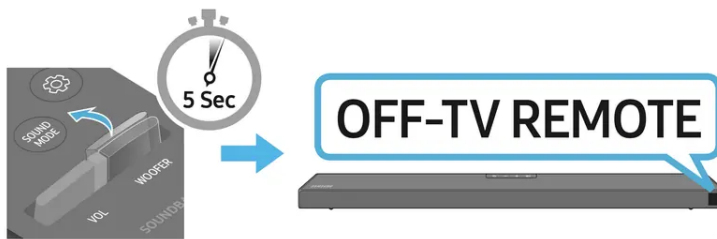

3. If you want to control the Soundbar with your TV's remote, push up and hold the WOOFER button for 5 seconds repeatedly until “ALL-TV REMOTE” appears in the display. Then, use your TV's menu to select external speakers.

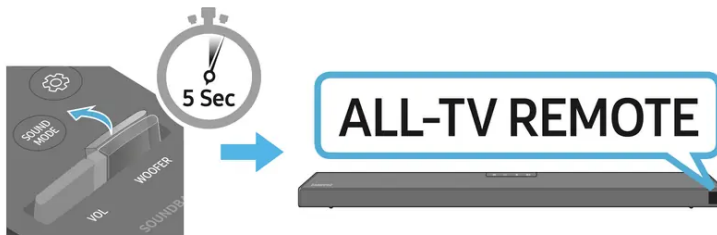

4. If you want to return the Soundbar to the default mode (control by a Samsung TV remote), push up and hold the WOOFER button for 5 seconds repeatedly until “SAMSUNG-TV REMOTE” appears in the display.

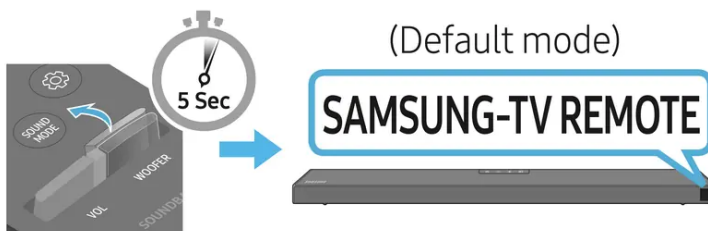

- Each time you push the WOOFER button up and hold it for 5 seconds, the mode switches in the following order: “SAMSUNG-TV REMOTE” (Default mode) → “OFF-TV REMOTE” → “ALL-TV REMOTE”.
- This function may not be available, depending on the remote control.
- Manufacturers supporting this function: VIZIO, LG, Sony, Sharp, PHILIPS, PANASONIC, TOSHIBA, Hisense, RCA

## Using the Hidden Buttons (Buttons with more than one function)

Hidden Button		Reference page
Remote Control Button	Function	
WOOFER (Up)	TV remote control On/Off (Standby)	page 28
▶   (Play / Pause)	Initialize (Standby)	page 33
Left	TV Auto connect On/Off (BT Ready)	page 16
Up	ID SET (Standby)	page 26
Down	Volume Restriction On/Off (Standby)	page 26
 (Sound Control)	7 Band EQ	page 27
SOUND MODE	DRC ON/OFF (Standby)	page 25
	Bluetooth Power	page 26

## Output specifications for the different sound effect modes

Effect	Input	Output	
		Without Wireless Rear Speaker Kit	With Wireless Rear Speaker Kit
 <b>SOUND MODE</b>	STANDARD	2.0 ch	2.1 ch
		5.1 ch	3.1 ch
	SURROUND SOUND	2.0 ch	4.1 ch
		5.1 ch	5.1 ch
	GAME PRO	2.0 ch	4.1 ch
		5.1 ch	5.1 ch
	DTS VIRTUAL:X	2.0 ch	3.1 ch
		5.1 ch	3.1 ch

- The Samsung Wireless Rear Speaker Kit can be purchased separately. To purchase a Kit, contact the vendor you purchased the Soundbar from.

## TROUBLESHOOTING

Refer to the table below if this product does not function properly. If the problem you are experiencing is not listed below or if the instructions below do not help, turn off the product, disconnect the power cord, and contact Samsung Electronics at 1-800-SAMSUNG (1-800-726-7864).

Problems	Causes	Solution
The unit will not turn on.	Is the power cord firmly plugged into the wall outlet and power adapter?	Unplug and reconnect the power cord to the wall outlet and the power adapter to make sure the connection is secure.
	Is the power adapter firmly connected to the main unit?	Disconnect the power adapter from the Soundbar, and reconnect to make sure the connection is firm and secure.
A function does not work when the button is pressed.	Is there static electricity in the air?	Disconnect the power plug and connect it again.
Sound dropouts occur in BT mode.		See the Bluetooth connection sections on pages 15 and 20.
Sound is not produced.	Is the Mute function on?	Press the  (Mute) button to cancel the mute function.
	Is the volume set to minimum?	Adjust the Volume.
The remote control does not work.	Are the batteries drained?	Replace with new batteries.
	Is the distance between the remote control and Soundbar main unit too far?	Move the remote control closer to the Soundbar main unit.
The red LED on the subwoofer blinks and the subwoofer is not producing sound.	This issue can occur if the subwoofer is not connected to the Soundbar main unit.	Try to connect your subwoofer again. (See page 6.)
The subwoofer drones and vibrates noticeably.	Try to adjust the vibration of your subwoofer.	Push the <b>WOOFER</b> button up or down to adjust the level of the woofer (bass) to -12 or between -6 to +6.

**Warning**

This content is compiled from multiple sources and is provided for reference purposes only. It may not be complete or fully applicable to all situations. If you are unable to resolve your issue, please contact the product manufacturer or an authorized service provider for official support.

---

Document generated by [ManualsFile](#)