

Getting started

Features

- **DTV / Analog TV / CATV**

You can use your remote control to select channels which are broadcast in digital format and conventional analog format. Also, cable and satellite subscribers can access their TV channels.

- **Information display**

You can display on the TV screen the title, contents (DTV only) and other information on the current program.

- **Autoprogram**

This unit automatically scans and memorizes channels available in your area, eliminating difficult setup procedures.

- **Net TV**

This unit lets you enjoy internet services. Use the remote control to browse the Net TV pages. You can play movies and much more, all from your TV screen.

- **Child lock**

This feature allows you to block children's access to inappropriate programs.

- **Closed caption decoder**

Built-in closed caption decoder displays text for closed caption supported programs.

- **MTS / SAP tuner**

Audio can be selected from the remote control.

- **Auto standby**

If there is no input signal and no operation for 15 minutes, the unit will go into standby mode automatically.

- **Sleep timer**

You can set the unit to go into standby mode after a specific amount of time.

- **Choices for on-screen language**

Select your on-screen language: English, Spanish or French.

- **Stereo sound function**

- **PLL frequency synthesized tuning**

Provides free and easy channel selection and lets you tune directly to any channel using the number and decimal point “•” keys on the remote control.

- **Various adjustments for picture and sound**

Customizes picture quality suitable for your room and sets your sound preference.

- **EasyLink via HDMI link EasyLink**

allows your other HDMI link devices to be controlled by the HDMI cable connected to your TV.

- **HDMI input**

- **HDMI-DVI input**

If your video device has a DVI output jack, use an HDMI-DVI conversion cable to connect the unit.

- **Component video input**

- **AV input**

Audio and video input from an external device.

- **USB terminal**

The picture, music and video files stored on a USB memory stick can be played back on this unit.

- **Digital audio output**

- **Headphone audio output**

Headphone 3.5mm stereo jack for personal listening

Included accessories

User manual



Quick start guide



Caution sheet



TV base and Screws

65"

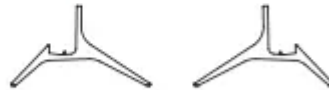

55" / 50" / 43"



Remote control
and Batteries
(AAA, 1.5V x 2)



Screws packed with this unit

Model	Quantity	Size
65PFL5602	4	M4 x 0.709"(18mm)
55PFL5602 50PFL5602	4	M4 x 0.984"(25mm)
43PFL5602	4	M4 x 0.551"(14mm)

Symbols used in this User manual

The following is the description for the symbols used in this User manual. Description refers to:

Digital TV operation

Cable / NTSC (Analog) TV operation

- If neither symbol appears, the operation is applicable to both

Unpacking

It is recommended that two or more people remove the TV set from the box. Be careful not to injure your fingers and keep children away during assembly.

(65PFL5602)

1. Open the top flaps of the box

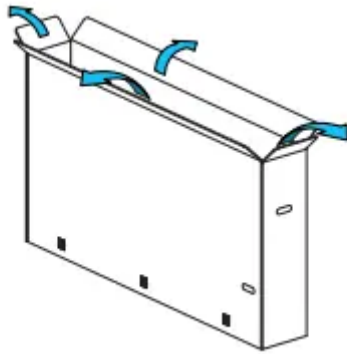

2. Remove all accessories.

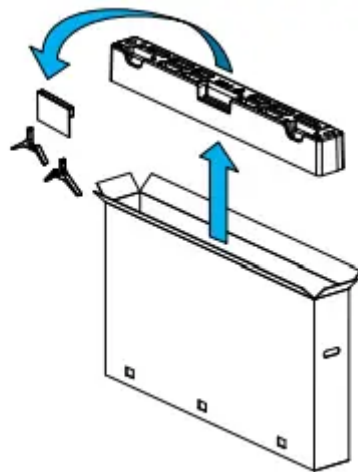

3. Remove the packing joints from the box

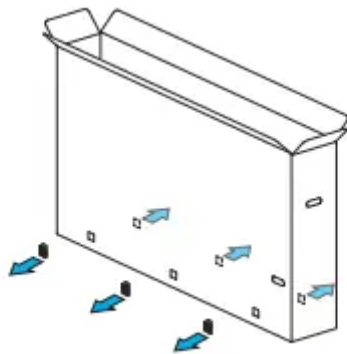

4. Remove the outer slipbox with care



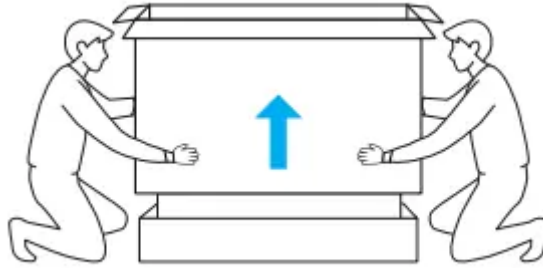

5. Support the top of the TV set with a hand to prevent the TV from falling.

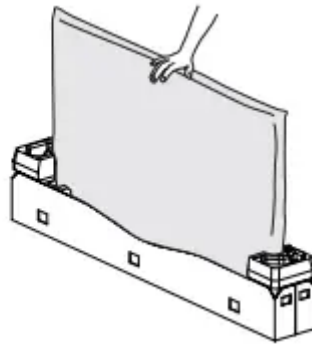

6. Unhinge the retaining tabs and unfold the left and right side of the bottom packaging

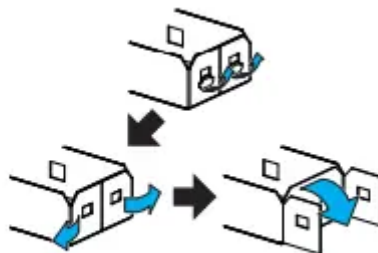

(55PFL5602, 50PFL5602)

1. Open the top flaps of the box

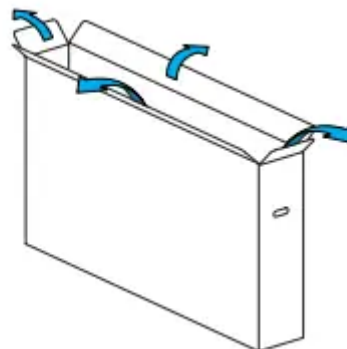

2. Remove all accessories

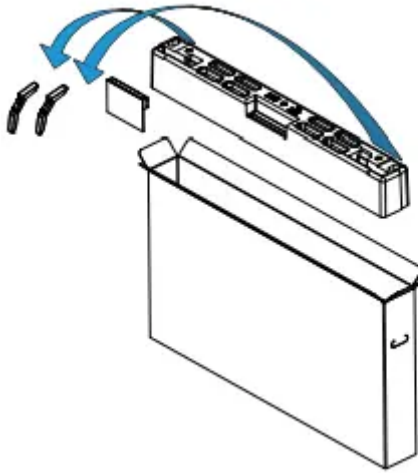

3. Prepare a table and cover the top of it with a table cloth, blanket or such to avoid damage to the TV set. Support both sides of the TV set and, move it onto the table.

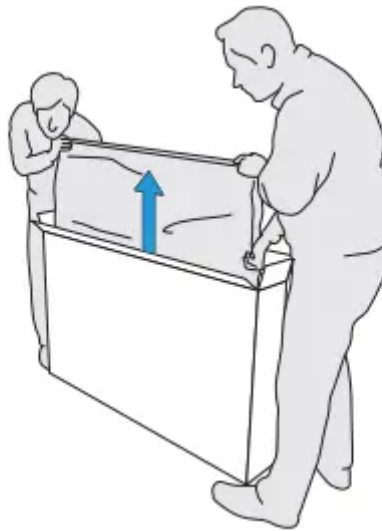

4. Carefully lay the TV set, with the screen side down, on the table so as not to deform or damage Decoration plate of the bottom of the unit.



Installing the stands

(65PFL5602)

1. Remove both of the bottom polystyrene foam bases. Carefully tear the plastic bag until the bottom corner of the TV is exposed.

- Support the top of the TV set at all times to prevent the TV from falling

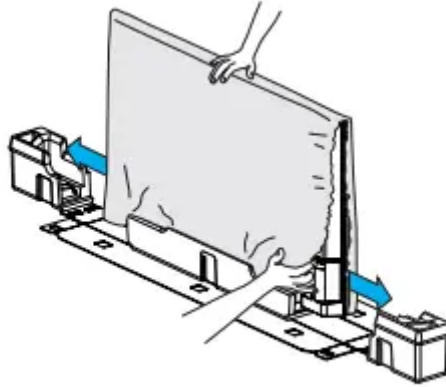

2. Lift up one side of the TV approx. 1 inch (2.5 cm) and insert the matching stand upward until it fits the main unit.

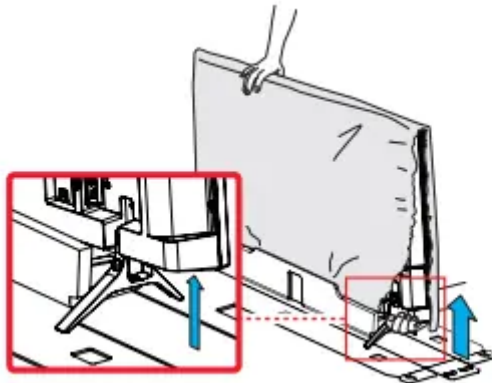

3. Fasten the matching stand to the TV with 2 screws (included).

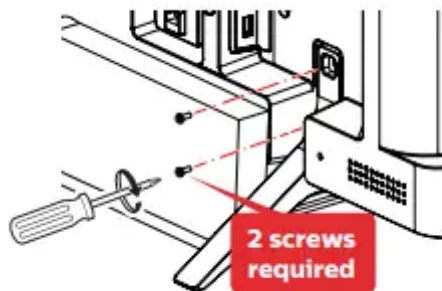

4. In the same manner as step 2, install the other stand

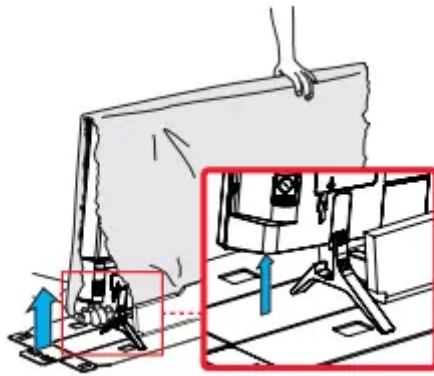

5. Fasten the other stand to the TV with 2 screws (included)

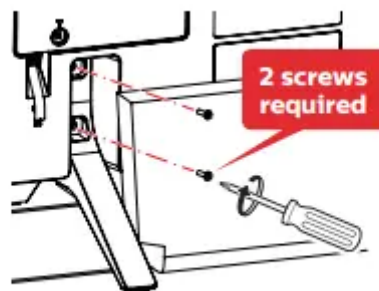

6. Both stands should now be securely fastened.

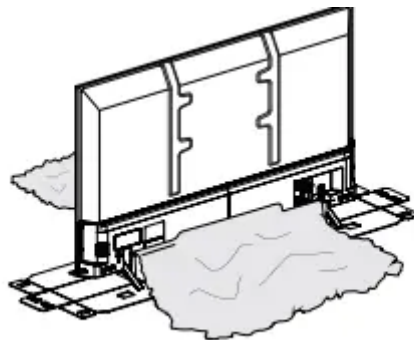

(55PFL5602, 50PFL5602)

1. Remove the tape on the bottom of the TV set and the plastic bag

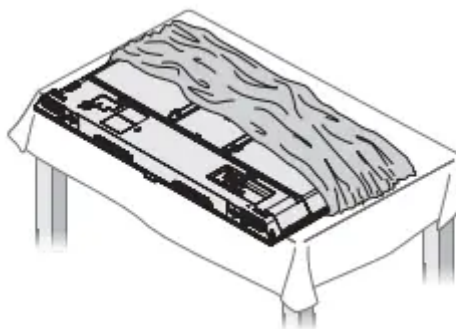

2. Fasten the matching stand to the TV with 2 screws (included). While fastening the screws, hold the stand to prevent it from falling.

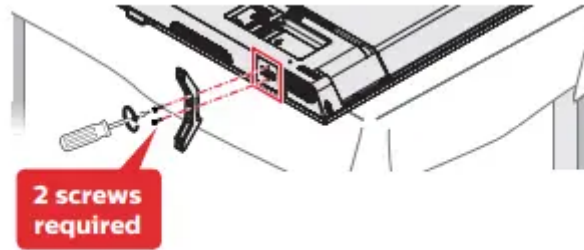

3. Fasten the other stand to the TV with 2 screws (included). While fastening the screws, hold the stand to prevent it from falling.

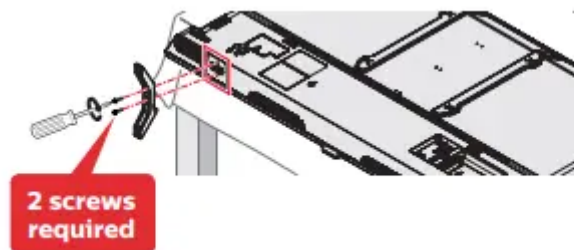

4. Both stands should now be securely fastened.

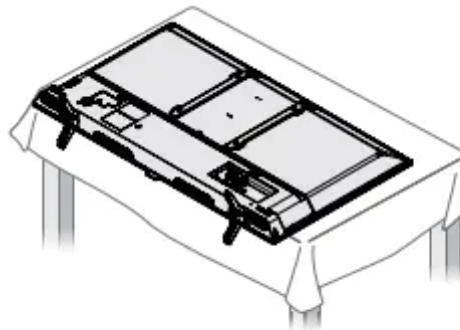

(43PFL5602)

1



2

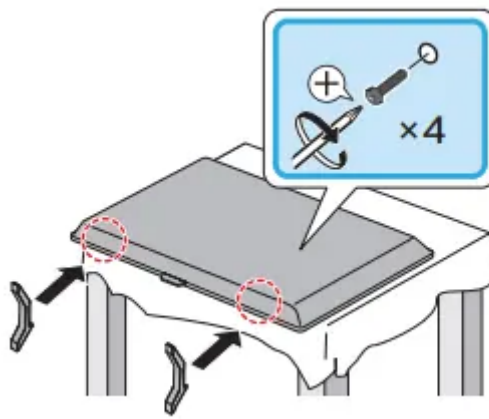

3

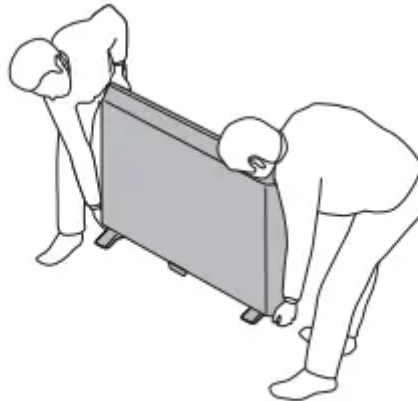

Lifting the TV set

Carefully lift the TV set as shown in the illustration and place it onto a stable, level surface.

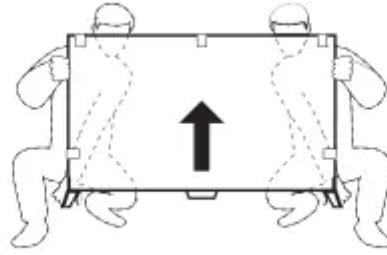

Removing cardboard

Remove the cardboard attached to the screen. You are now ready to set up and enjoy your Philips TV.



Installing the remote control batteries

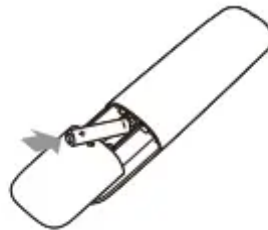

1. Slide the battery cover off the back of the remote control.
2. Insert the two included batteries (AAA, 1.5V). Be sure the + and – ends of the batteries line up with the markings inside the case.
3. Slide the cover back into position

Remote control



1. (POWER)

Turns the TV on from standby or off to standby

2. VUDU

Access directly to VUDU

3. EasyLink buttons

 : Searches backward or forward through the disc

 : Starts, pauses or resumes playback

 : Stops the disc playback

4. YouTube

Access directly to YouTube.

5. SAP

Selects audio mode (MONO / STEREO / SAP) / audio language.

6. (Home)

Displays the main menu

7.  **INFO**

Displays information about the current program.

8. **OK**

Press to decide the command of setting when the Home menu is displayed.

9.  **(NAVIGATION buttons)**

Moves the cursor, selects the on-screen menu items.

10.  **OPTIONS**

Displays a list of menu items applicable to the highlighted object or screen

11.  **SOURCE**

Selects connected devices.

12. **CH + / -**

13. **COLOR buttons**

Works as direct access to user specified net apps.

14. **0 - 9 (NUMBER buttons)**

Used to enter a channel / program number.

• **(DOT)** : Use with 0-9 to select digital channels. For example, to enter 2.1,



press

PREV.CH : Returns to the previously viewed channel.

15.  **(MUTE)**

Turns the sound on and off.

16. **VOL + / -**

Adjusts the volume.

17.  **BACK**

Returns to the previous menu operation. ,

18.  **FORMAT**

Adjusts the picture size on the TV screen.

19. **CC**

Selects closed caption settings (Off, On, CC w/mute).

20. NETTV

Access to Net TV menu directly.

21. NETFLIX

Access directly to Netflix.

Control panel

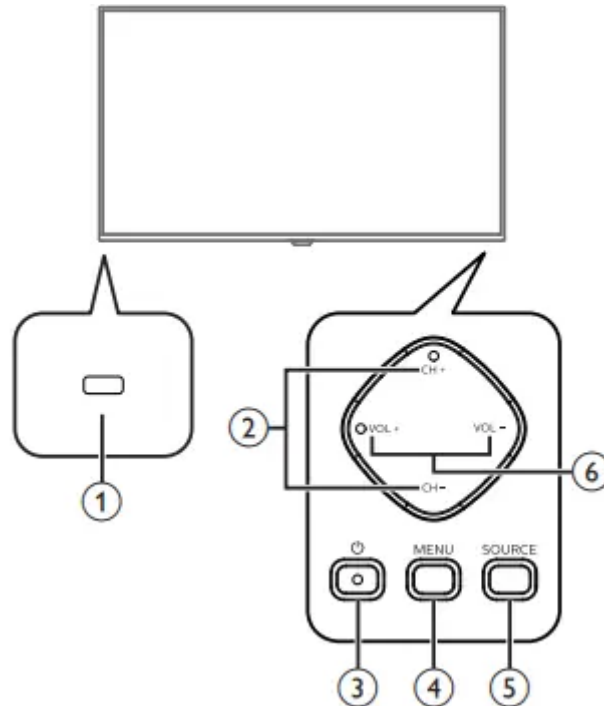

1. Remote control sensor

Receives IR signal from remote control.

2. CH + / -

Selects a channel. In the menu screen, moves the cursor up (+) / down (-).

3. (POWER)

Turns the TV on or switches the TV into standby mode.

4. MENU

Opens the main on-screen menu.

5. SOURCE

Selects connected devices.

6. VOL + / -

Adjusts the volume. In the menu screen, moves the cursor left (+) / right (-).

VOL + : Volume up

VOL – : Volume down

Terminals

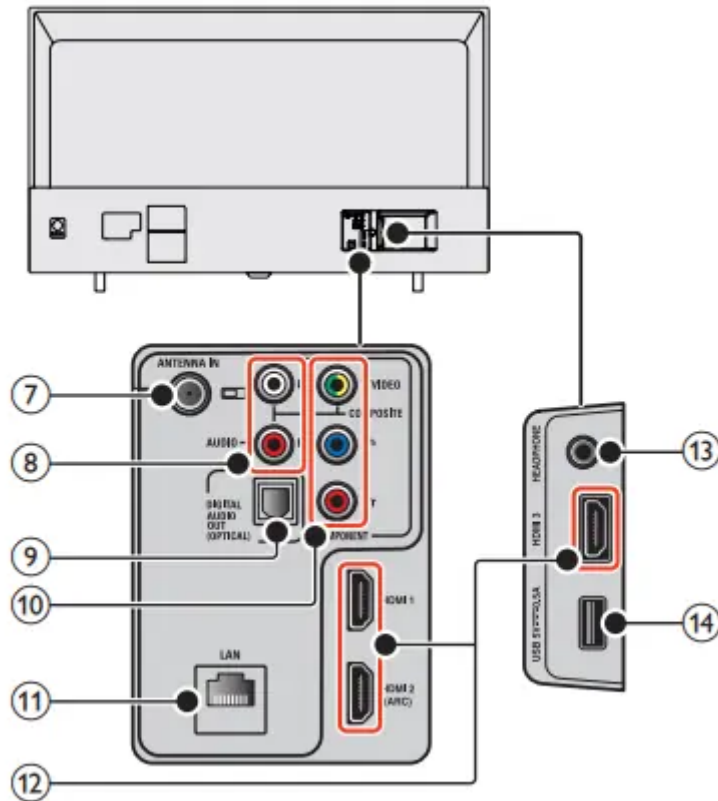

7. 75 ohm Cable / Antenna connection

Signal input from an antenna or cable / satellite set-top boxes.

8. Analog audio (L/R) input jacks

Connect analog audio signals from;

- HDMI-DVI / Analog audio (L/R) jacks signal
- Component video / Analog audio (L/R) jacks signal
- Composite video / Analog audio (L/R) jacks signal
- PC connection / Analog audio (L/R) jacks signal with stereo mini 3.5mm plug audio cable on PC

9. Digital audio output jack

Digital audio (S/PDIF) output to home theaters and other digital audio systems.

10. Component (Y/Pb/Pr) / Composite video (VIDEO) input jack(s) for VIDEO

Composite video input (VIDEO) jack is a shared jack with component video input (Y) jack. Green / Yellow color orientation depends on model.

11. Ethernet port

For internet connection using an Ethernet cable with an RJ-45 connector.

12. HDMI input jack(s)

Digital audio and video input from high definition digital devices such as DVD / Blu-ray Disc™ players, cable / satellite set-top boxes, PC's, etc.

- For HDMI 2 only In addition to normal HDMI and HDMI-DVI functionality, it outputs TV audio to an HDMI-ARC-compliant device, such as a home theater system. '

13. Headphone audio output jack

Headphone 3.5mm stereo jack for personal listening.

14. USB terminal

Data input from USB memory stick only. Do not connect any device to this terminal such as digital camera, keyboard, mouse, etc.

Connecting Antenna or cable / satellite / IPTV set-top box

Be sure your antenna or another device is connected properly before plugging in the AC power cord.

If connecting to an antenna through an RF cable

Any DTV programs that are broadcast in your area can be received for free through an antenna connection.

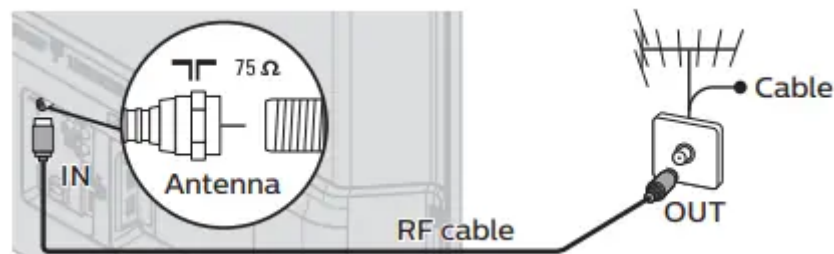

If connecting cable / satellite / IPTV set-top box using an RF cable

If the TV is connected to a cable or set-top box via a coaxial connection, set the TV to channel 3/4 or the channel specified by the service provider

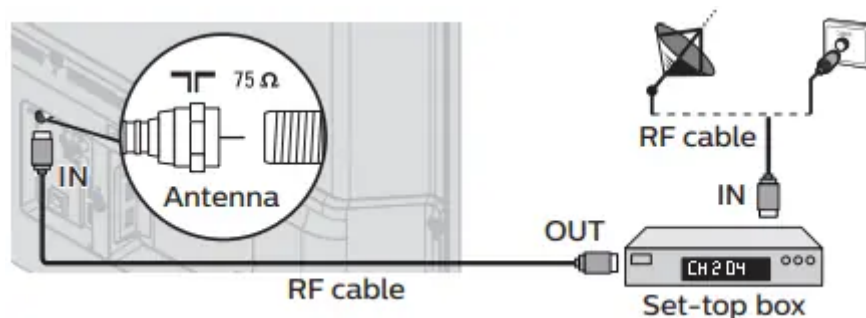

If connecting cable / satellite / IPTV set-top box using an HDMI cable

If the TV is connected to a cable / satellite set-top box via an HDMI cable, make sure you select the correct source by using  SOURCE.

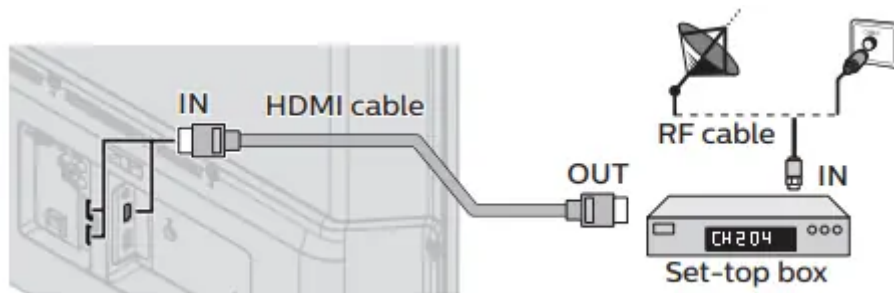

If connecting cable / satellite / IPTV set-top box using component video input

If the TV is connected to a cable / satellite set-top box via component video input, make sure you select the correct component video source by using  SOURCE

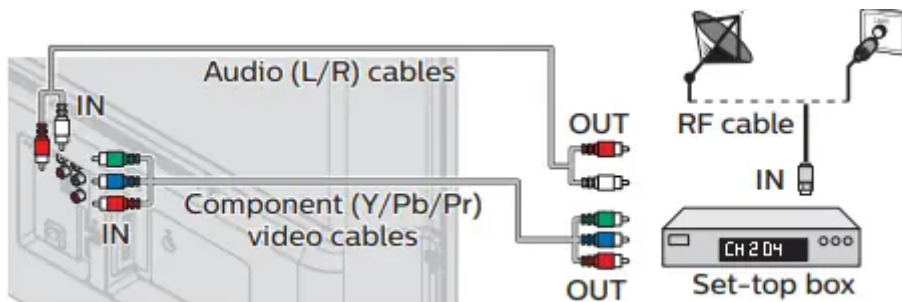

Connecting a cable / satellite / IPTV set-top box, Blu-ray Disc™ / DVD recorder via composite connectors and analog audio

Do not place your recorder too close to the screen because some recorders can be susceptible to harmful interference from the TV.

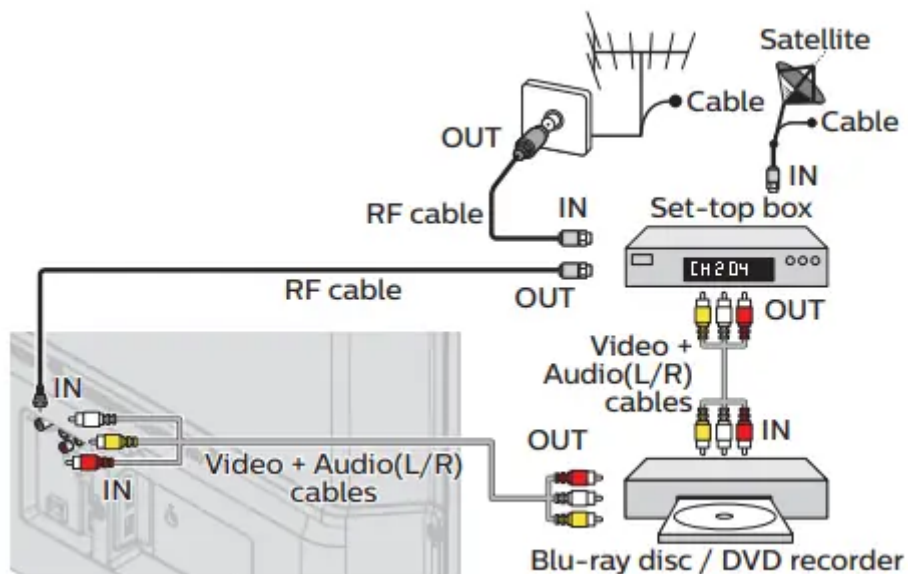

Plugging in the AC power cord

Make sure that the AC power cord must be plugged to an AC outlet after all the necessary connections are made

Before you connect the AC power cord:

Be sure other devices are connected properly before plugging in the AC power cord.

Selecting your connection quality

HDMI - Highest quality

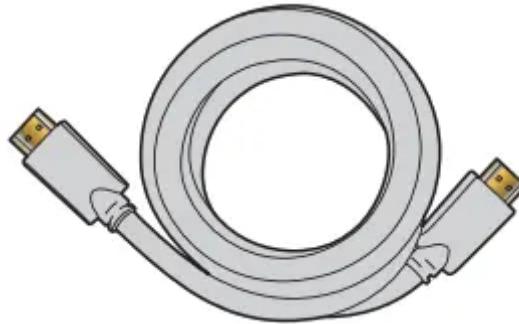

Supports high-definition digital signals and gives highest picture and sound quality. Video and audio signals are combined in one cable. You must use HDMI for full high-definition video and to enable EasyLink(HDMI CEC).

Component (Y Pb Pr) - High quality

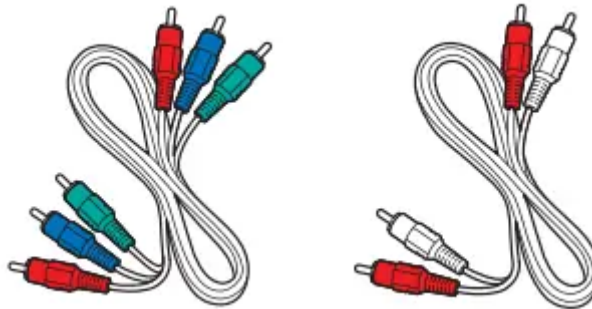

Supports high-definition analog signals but gives lower picture quality than HDMI. Component (Y/Pb/Pr) video cables combine red / green / blue video cables with red / white audio (L/R) cables. Match the cable colors when you connect to the TV.

Composite - Basic quality

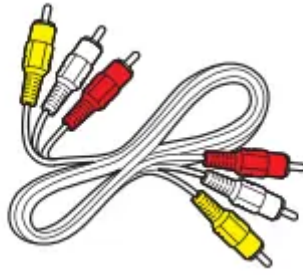

For analog connections. Composite video / Audio analog cable usually combine a yellow video cable with red / white audio (L/R) cables. With this unit, yellow cable must be connected to Y (green) jack on the component video input jacks.

Connecting your devices

HDMI digital connection

HDMI connection offers the highest picture quality. HDMI (High-Definition Multimedia Interface) transports high-definition digital video and multi-channel digital audio through a single cable.

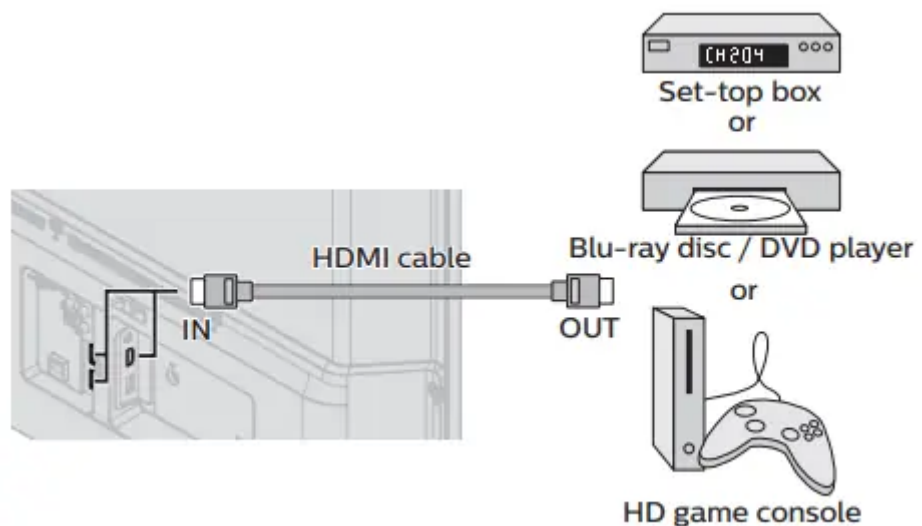

HDMI-DVI connection

This unit can be connected to a device that has a DVI terminal. Use an HDMI-DVI conversion cable for this connection and it requires audio cable for analog audio signal as well

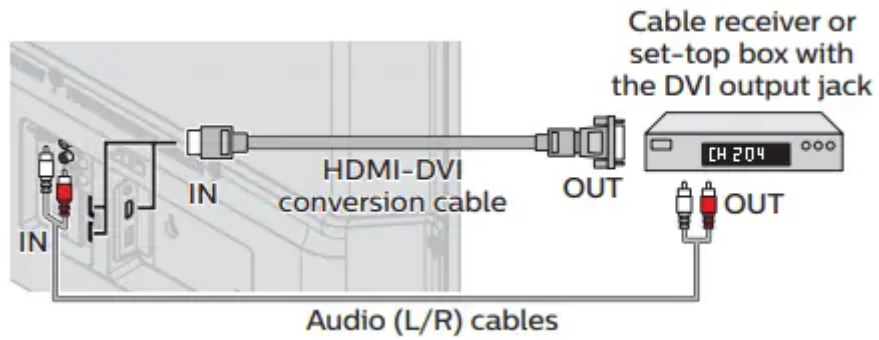

HDMI-ARC connection

HDMI-ARC allows you to use EasyLink to output TV audio directly to a connected audio device, without the need for an additional digital audio cable

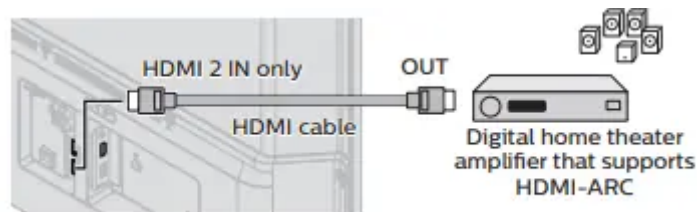

Component analog video connection

Component analog video connection offers better picture quality for video devices connected to the unit. If you connect to the unit's component video (Y/Pb/Pr) input jacks, connect analog audio cables to the analog audio (L/R) input jacks.

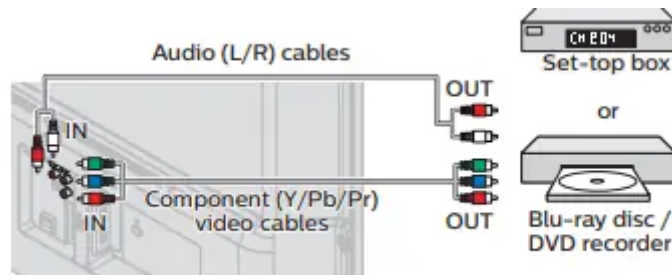

Composite analog video connection

Composite analog video connection offers standard picture quality for video devices connected to the unit.

If you connect to the unit's component / composite video (Y/VIDEO) input jack (green), connect audio cables to the audio (L/R) input jacks. When the audio is monaural, then only connect to the audio L input jack.

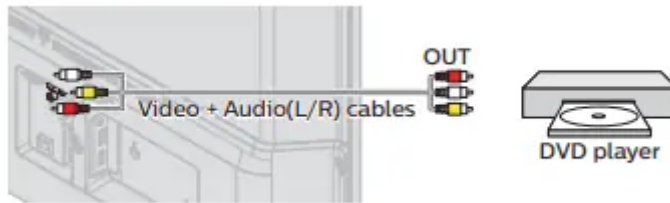

Connecting the TV to the internet using an Ethernet cable

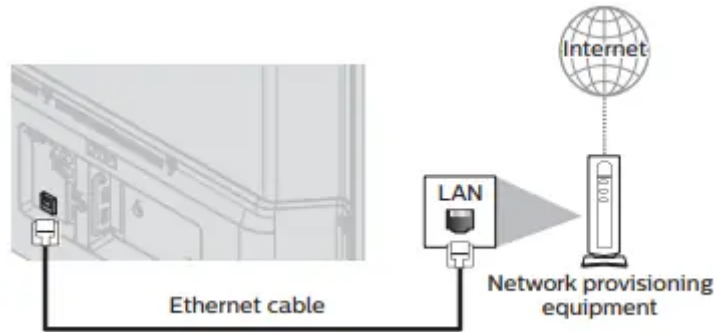

Connecting the TV to the internet using a wireless LAN

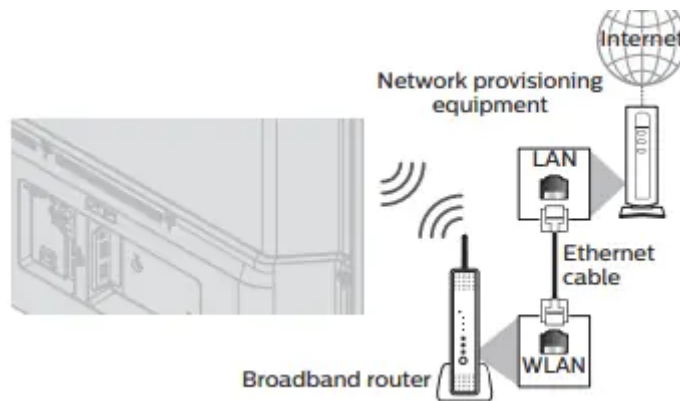

Digital audio output connection

If you connect this unit to an external digital audio device, you can enjoy multi-channel audio like 5.1ch digital broadcasting sound. Use a digital audio optical cable to connect the unit to external digital audio devices.

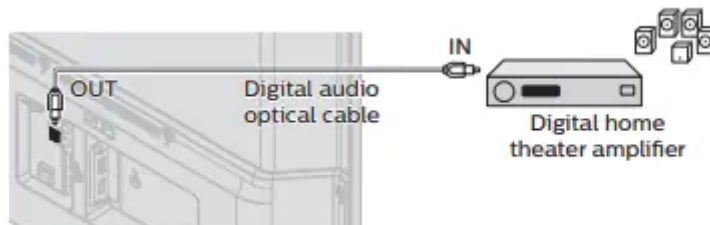

PC connection

HDMI connection



This unit can be connected to your PC that has an HDMI terminal. Use an HDMI cable for this digital connection

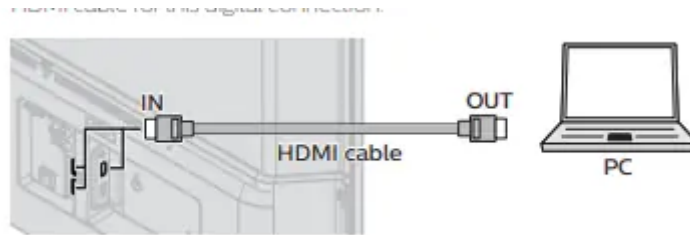

HDMI-DVI connection

This unit can be connected to your PC that has a DVI terminal. Use an HDMI-DVI conversion cable for this video digital connection and it requires stereo mini 3.5mm plug audio cable for analog audio signal as well.

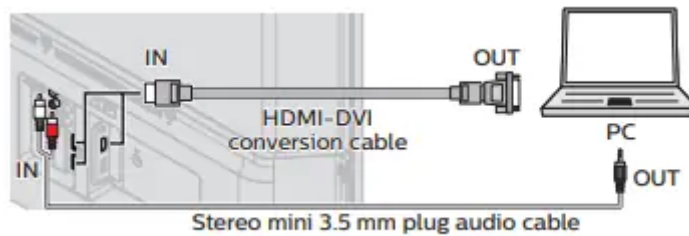

The following PC-input video signals can be displayed

Format	Resolution	Refresh rate
VGA	640 x 480	60Hz
SVGA	800 x 600	
WXGA	1,024 x 768	
	1,360 x 768	
FHD	1,920 x 1,080	24/30/60Hz
UHD	3,840 x 2,160	
	4,096 x 2,160	

USB memory stick

This unit offers easy playback of picture, music and video files. Insert the USB memory stick into the USB terminal shown below. For a complete list of file formats and specifications supported, refer to USB Section → p. 27

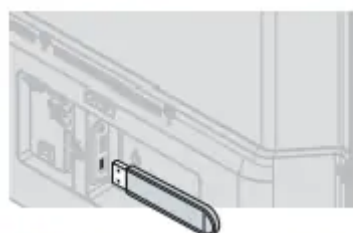





Note(s)

- The unit recognizes only a USB memory stick
- Do not use a USB hub or an extension cable to connect an external hard disk drive to the unit. (Not supported.)
- Always insert a USB memory stick directly to this unit.
- A USB memory stick is not included with this unit.
- We do not guarantee that all USB memory sticks can be supported by this unit.
- Be sure to keep a backup copy of the original files on your USB device before you play them back on this unit. We have no responsibilities for damage or loss of your USB stored data.
- To protect your USB memory stick files from being erased place the write protect sliding tab in the protect position (if available).
- When you are ready to remove a USB memory stick, set the unit to go into standby mode to avoid any damage to your data and the unit.
- A USB memory stick that requires its own driver or the device with a special system such as fingerprint recognition are not supported
- This unit is not allowed to use the USB memory stick which requires an external power supply (500mA or more).

Initial setup

This section will guide you through the unit's Initial setting which includes selecting a language for your on-screen menu, country, location and Autoprogram, which automatically scans and memorizes viewable channels. You can also set the network connection in this setting.



Before you begin: Make sure the unit is connected to an antenna or cable.

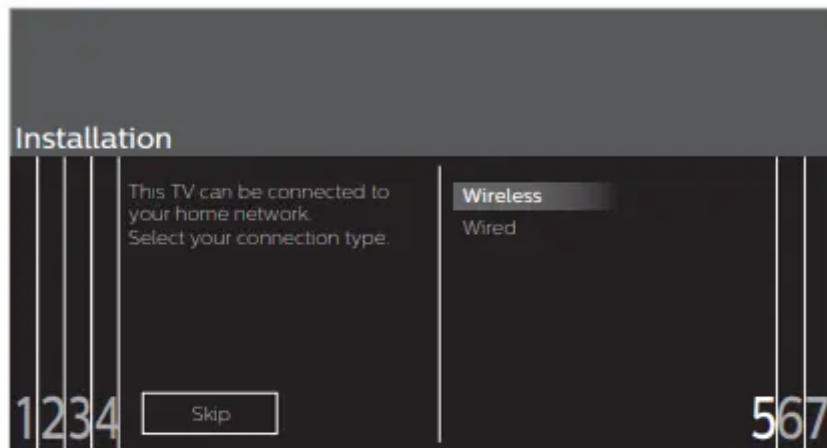

1. After making all the necessary connections, press  to turn on the unit.
 - It may take a few moments to turn on the unit for the first time.
 - Initial setup menu appears automatically after the unit is turned on.
2. Use   to select the on-screen language, Voice guide, country, TV placement and location in the middle of the TV screen, then press OK.
 - You must set Home in location setting. Otherwise, Picture and Sound settings you adjusted will not be memorized after the unit goes into standby mode.
3. Use   to select Skip or Next on network setup screen.

4. Use   to select Wireless or Wired, then press OK.





Wireless	If you have a wireless router, select Wireless to connect to the internet.
Wired	If you connect with an Ethernet cable, select Wired to connect to the internet.

- If you have a router with easy connect function, select Wireless and use   to select Easy Connect, then press OK.
- When you select On in the selection screen for Software update notification, A message will appear later if there is the latest software on the network server.

5. Use   to select the signal type.

- If the TV is connected to a cable or satellite set-top box, select the 2nd one and skip to step 7



6. Use   to select Antenna for TV channels or Cable for CATV channels, then press OK.

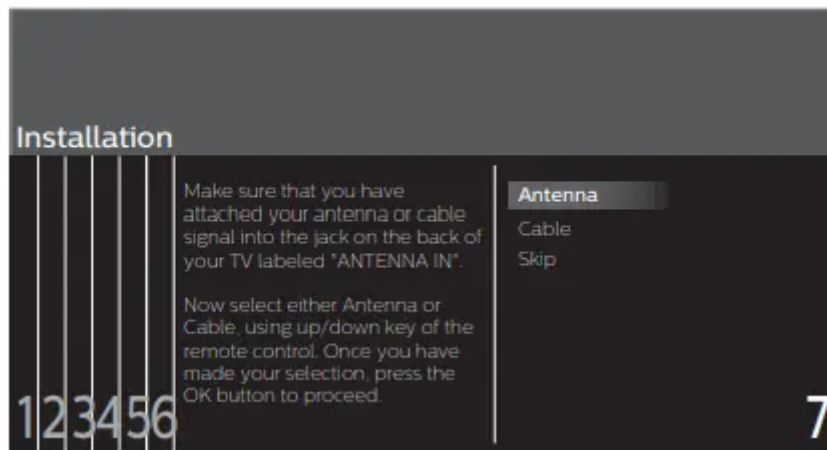

–When Antenna is selected, the TV detects antenna signals. It searches for DTV and analog TV channels available in your area.

–When Cable is selected, the TV detects signals supplied by cable. It searches for DTV, analog TV and cable channels available in your area.

- Auto programming will begin

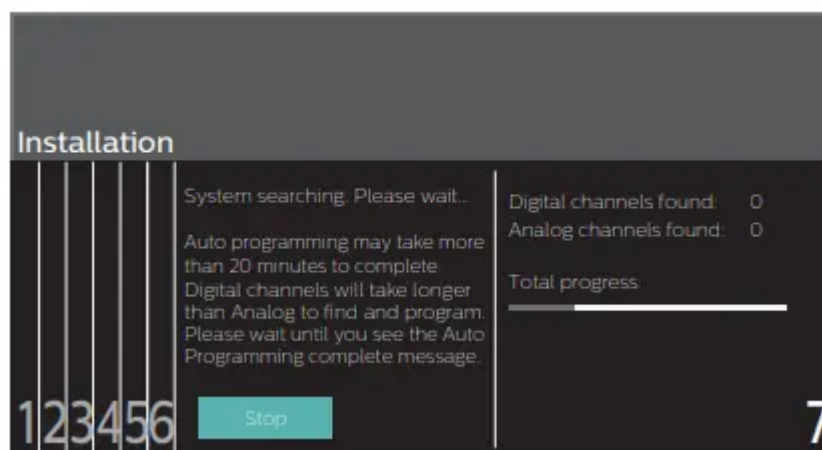

7. Use **▲▼** to select your preferred picture setting, then press OK

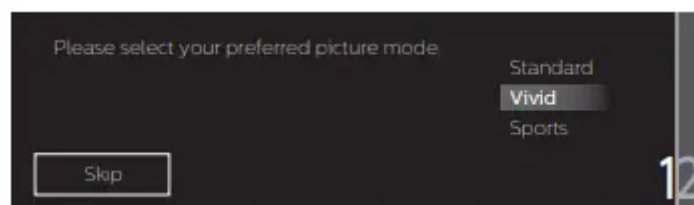

8. Use **▲▼** to select your preferred sound setting, then press OK

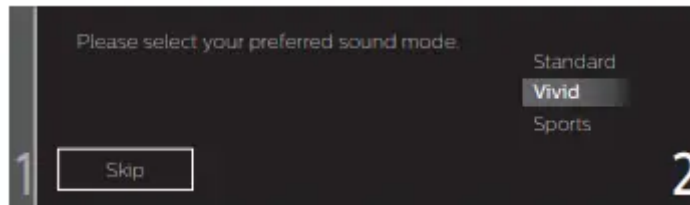

9. After Picture and sound setup is completed, a message will appear if there is the latest software on the network server

After an initial setup is completed...

- If you want to scan the channels automatically again. Search for channels → p. 38
- If you want to change to another language. Language → p. 34
- If you want to change the country setting. Country → p. 51
- If you want to change the location setting. Location → p. 35
- If you want to change the network setting. Connect to network → p. 41
- If you want to restore the picture and sound setting. Picture and sound setup → p. 31

Use your TV

Switching on your TV and putting it in standby mode



Remote control



To turn the TV on from standby or off to standby

- Press  on the TV or the remote control.

Adjusting volume



Remote control



To decrease or increase volume

- Press VOL + / – on the TV or the remote control.

VOL + : Volume up

VOL – : Volume down

To mute or unmute sound

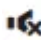
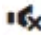
- Press  on the remote control to mute the sound.
- Press  again or VOL + / – to recover the original sound.

Switching channels



Remote control



To select channels by using CH + / -

- Press CH + / - on the TV or the remote control.

To select channels by using the NUMBER buttons

Digital TV operation

- For digital channels, press a number followed by a dot “.” and the corresponding sub channel number.
- When selecting digital channel 1 1. 1 Be sure to press
- before entering the subchannel number.



Cable / NTSC (Analog) TV operation

- When selecting cable or analog channel 1 1





Press PREV.CH to return to the previously viewed channel

Watching channels from an external device

Switching each input mode can easily switch with the remote control between TV and external devices when they are connected to the unit

1. Turn on the set-top box or the connected device.



- Press  SOURCE and use  to select the set-top box or the connected device and wait a few seconds till the picture appears

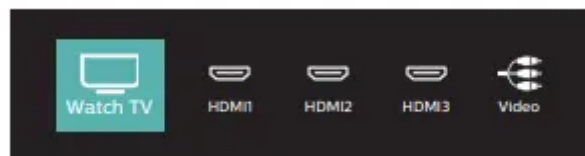

- Use the remote control of the set-top box or the connected device to select channels

Access the Home menu

1. Press 





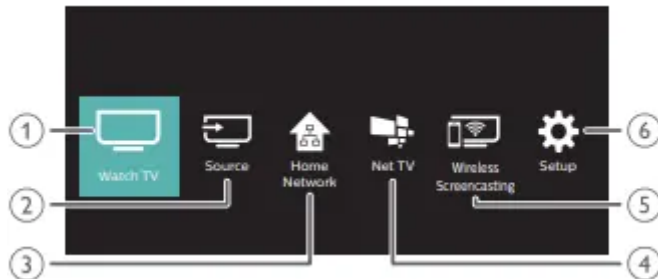

Guide to Home menu



1. **Watch TV** : Switches back to the TV source if another source is selected.
2. **Source** : To select connected devices.
3. **Home Network** : Accesses Home network menus.
4. **Net TV** : Accesses Net TV menus.
5. **Wireless Screencasting** : Accesses Wireless Screencasting menus.
6. **Setup** : Accesses menus that allow you to change picture, sound and other TV settings.



Lock or unlock your device from the Home menu

This section describes how to lock or unlock specified device.

- 1 Press  SOURCE on the remote control.
- 2 Use  to select a device to lock or unlock.
- 3 Press  OPTIONS on the remote control.
- 4 Use  to select Lock or Unlock, then press OK. • If device lock is unlocked, Lock will be displayed. If device lock is locked, Unlock will be displayed at the top right of the device icons.
- 5 Enter your PIN. Change PIN → p. 40

Changing device type

You can change device icons displayed in the source list.

- 1 Press  SOURCE on the remote control.
- 2 Use  to select the desired device.

3 Press red button on the remote control.

4 Use  to select the desired type, then press OK.

To reset the type

- Press  OPTIONS on the remote control at step 3, then select Original icon.

Scan connections

You can rescan TV connections and update the source list.

Before you begin:

You must set On in Master EasyLink. → p. 36

1 Press  SOURCE on the remote control.

2 Use  to move the cursor to any device.

3 Press  OPTIONS on the remote control.

4 Use  to select Scan connections, then press OK.

Create a list of favorite channels

You can create lists of your preferred TV channels so that you can find those channels easily.

1 Press OK while viewing a TV program.

2 Use  to select the desired channel, then press yellow button.

3 Use  to select the desired favorite list (Favorites 1 - Favorites 4), then press OK to add or remove on the list of favorite channels.

- indicates that the channel is added.
- indicates that the channel is removed.
- The channel will be marked with  icon.

Display the list of favorite channels

1 Press OK while viewing a TV program.

2 Use  to select Favorites.

To change the favorite list

1 Press blue button.

2 Use  to select the desired favorite list (Favorites 1 - Favorites 4).

To remove a channel from the favorite list

1 Select the desired channel, then press yellow button.

2 Use  to select Yes, then press OK.

Changing Picture format

Display modes can be selected when your TV receives a 16:9 or 4:3 video signal.

Three types of display modes can be selected for a PC input signal.

Press  FORMAT repeatedly to switch the TV aspect ratio.



For 16:9 video signal (4096 x 2160p)

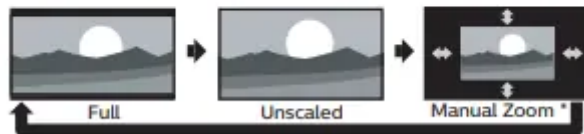

For 16:9 video signal (3840 x 2160p)

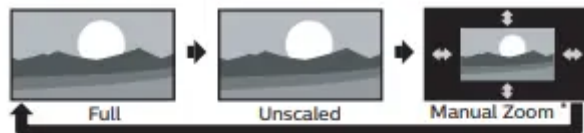

For 16:9 video signal (not 2160p)

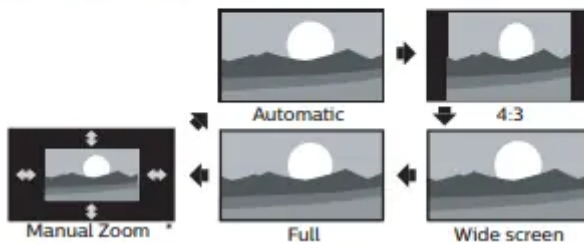

Automatic	Other than DTV and HDMI connected devices, enlarges the picture to best fit the screen. DTV and HDMI connected devices display the picture at its original size. The subtitles may remain visible.
4:3	Displays a 16:9 picture at a 4:3 size; the picture is shortened horizontally. Sidebars appear on both edges of the screen.
Wide screen	Displays a 16:9 picture that is stretched horizontally and vertically.
Unscaled	Displays a 16:9 picture at its original size.
Full	Displays a scaled 16:9 picture. Bars appear on both the upper and lower portions of the screen depending on the type of video signal.
Manual Zoom	Allows step by step vertical and horizontal stretching of the picture size to suit your viewing preferences. Manual zoom can distort the aspect ratio of the image, to switch back to a normal mode select Automatic / Normal.

- Manual Zoom setting is not available on the following models:
 - 65PFL5602/F7
 - 65PFL5602/F7 D
 - 55PFL5602/F7
 - 50PFL5602/F7

Your model number can be confirmed on the rating label applied on the rear cabinet.

for 43 video signal

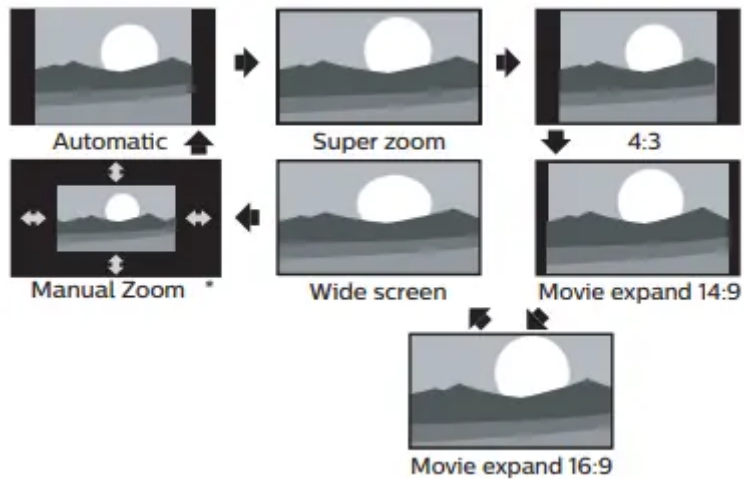

Automatic	Other than DTV and HDMI connected devices, enlarges the picture to best fit the screen. DTV and HDMI connected devices display the picture at its original size. The subtitles may remain visible.
Super zoom	Displays a 4:3 picture at a 16:9 size; the picture is stretched horizontally and vertically and its left and right edges are enlarged. This crops out some of the top and bottom of the picture.
4:3	Displays a 4:3 picture at its original size. Sidebars appear on both edges of the screen.
Movie expand 14:9	Displays a 4:3 picture at a 14:9 size; the picture is stretched horizontally and vertically. This crops out some of the top and bottom of the picture. Sidebars appear on both edges of the screen.
Movie expand 16:9	Displays a 4:3 picture at a 16:9 size; the picture is stretched horizontally and vertically. This crops out some of the top and bottom of the picture.
Wide screen	Displays a picture that is stretched out of proportion to fill the screen.
Manual Zoom	Allows step by step vertical and horizontal stretching of the picture size to suit your viewing preferences. Manual zoom can distort the aspect ratio of the image, to switch back to a normal mode select Automatic / Normal.

- Manual Zoom setting is not available on the following models:
 - 65PFL5602/F7
 - 65PFL5602/F7 D
 - 55PFL5602/F7
 - 50PFL5602/F7

Your model number can be confirmed on the rating label applied on the rear cabinet

For PC input signal

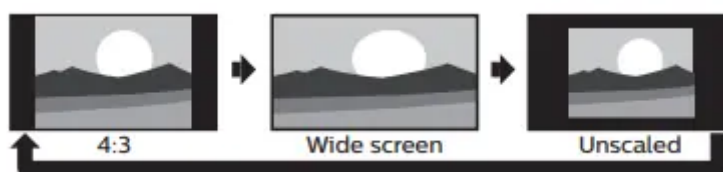

- This unit can also be connected to your PC that has a DVI terminal. Use an HDMI-DVI conversion cable for this video connection and it requires stereo mini 3.5mm plug audio cable for analog audio signal as well.
- Refer to 16:9 video signal on this page if the PC has HDMI output

4:3	Displays a proportionately stretched picture. Sidebars appear on both edges of the screen.
Wide screen	Displays a picture that is stretched out of proportion to fill the screen.
Unscaled	Displays a picture in its original size.

If the signal source has side or top-bottom bars inserted into the picture, the Picture format function will not eliminate them.

TV screen information

You can display the currently selected channel or other information such as the aspect ratio on the TV screen. In the digital mode, the detailed broadcasting information for the current off-the-air channel such as program title and program guides are displayed.

1 Press  INFO.

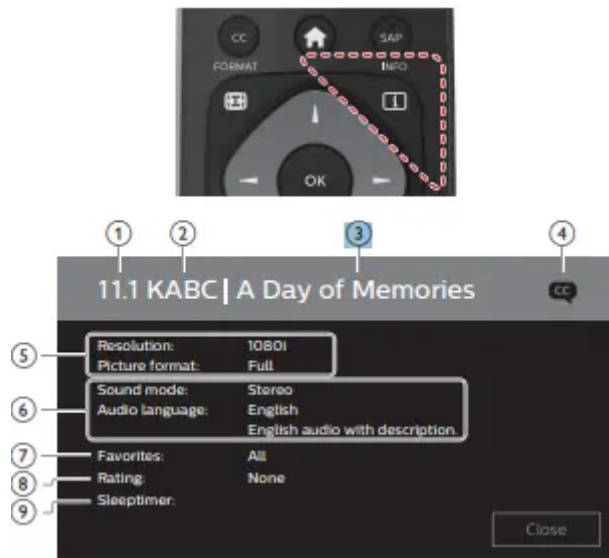

1. Channel number / Input mode

Switching channels → p. 22

Watching channels from an external device → p. 23

2. Broadcast station

3. Program title (for DTV only)

4. CC (not available if Closed caption is set to Off)

Caption settings → p. 37

5. Program's image aspect ratio

Changing Picture format → p. 24 Audio language (DTV)

6. Audio mode (Analog TV)

Sound → p. 33

7. Favorites

Create a list of favorite channels → p. 24

8. Child lock rating

Child lock → p. 39

9. Remaining time on sleep timer

Sleeptimer → p. 34

2 Press  INFO to hide the information

Using options menu

You can access to some TV settings directly by using  OPTIONS.

1 Press  OPTIONS to display options menu, then press OK

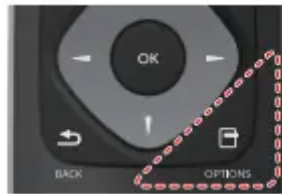

2 Use  to select a desired setting, then press OK.



1.Options

Following settings can be configured.

Voice guide toggle	To set Voice guide on or off. Voice guide toggle → p. 36
Closed captions	To choose the Closed captions display setting. Closed captions → p. 37
Digital audio language	To Select the language according to your preference. (It differs depending on the program.) Digital audio language → p. 40
Mono/Stereo	To Select an audio format. Mono/Stereo → p. 40

2.Controls

If you have our brand products such as Blu-ray Disc™ player or DVD recorder that are compatible with EasyLink functions, connect them to this unit via an HDMI cable so you can simply operate various items from this unit's remote control.

Before you begin:

select a device connected to an HDMI connection. → p. 23 You must set On in Master EasyLink. → p. 36 Otherwise, LINK does not work even if you connected our brand devices to this unit

1 Press  OPTIONS to display options menu.

2 Use  to select Controls then press OK.

3 Use  to select the desired item, then press OK

Device-menu	Controls the menu of your connected EasyLink device.
Device-contents	Controls the top menu of your DVD or Blu-ray Disc™.
Device-favorite	Controls the pop-up menu of your Blu-ray Disc™.



3. Picture and sound

Following settings can be configured

Auto picture	To set predefined picture mode. Picture → p. 31
Auto sound	To set predefined sound mode. Sound → p. 33
Headphone volume	To adjust headphone volume. Sound → p. 33
TV speakers	To Select the audio output from the unit's speakers or not. Sound → p. 33
Picture format	To switch the TV aspect ratio. Changing Picture format → p. 24
Setup	To display setup menu.

4. ECO settings





Following settings can be configured.

Switch off timer	<p>You can turn off the unit automatically when there is no operation for specified time. In spite of this setting, the unit goes into standby mode automatically if there is no signal input and no user operation for 15 minutes.</p> <p>Press  repeatedly to change the amount of time (Increases the time by 30 minutes up to 240 minutes).</p> <p>Each press of  will decrease the time by 30 minutes.</p> <p>To cancel the timer, press  repeatedly until "0" is displayed.</p>
------------------	--

USB

Your TV is fitted with a USB connection that enables you to view photos, listen to music or watch video files stored on a USB memory stick.

1 Press  SOURCE and use  to select USB, then press OK.



2 Use     to select the desired file, then press OK.



- These recorded files must meet specifications shown below:

Picture (JPEG / Progressive JPEG)						
JPEG	Upper limit	4000x4000 pixels				
Progressive JPEG	Upper limit	1024x768 pixels				
Music (MP3 / WAV / AAC)						
MP3	Sampling frequency	16 kHz - 48 kHz				
	Constant bit rate	8 kbps - 320 kbps				
WAV	Sampling frequency	8 kHz - 48 kHz				
	Constant bit rate	64 kbps - 1.5 Mbps				
AAC	Sampling frequency	8 kHz - 48 kHz				
	Constant bit rate	-				
Video (MPEG / VOB / AVI / MP4)						
Maximum video	H.264, H.265/HEVC 3840x2160@30fps, MPEG 1920x1080@60fps					
Extension	.avi	.mpg, mpeg	.ts, .trp, tp	.vob	.mp4	.mkv
Video codec	MPEG1, MPEG2, MPEG4, H.264	MPEG1, MPEG2, MPEG4	MPEG1, MPEG2, H.264, H.265/HEVC	MPEG1, MPEG2	MPEG1, MPEG2, MPEG4, H.264, H.265/HEVC	MPEG1, MPEG2, MPEG4, H.264, H.265/HEVC
Audio codec						
Dolby Digital	YES	YES	YES	YES	YES	YES
MPEG1/2 audio layer1/2/3	YES	YES	YES	YES	NO	YES
LPCM	YES	YES	YES	YES	YES	YES
AAC-LC	YES	YES	YES	YES	YES	YES

Getting more from your TV

This section describes the overview of the Setup menu displayed when you press  and use   to Select Setup. The Setup menu consists of the function setting items below.

1 Press  to display the Home menu



2 Use  to select Setup, then press OK.

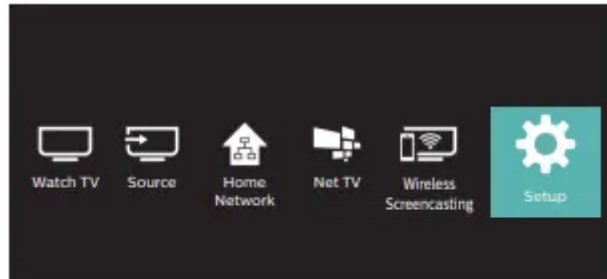

3 Use  to select the desired menu and an item, then press OK.

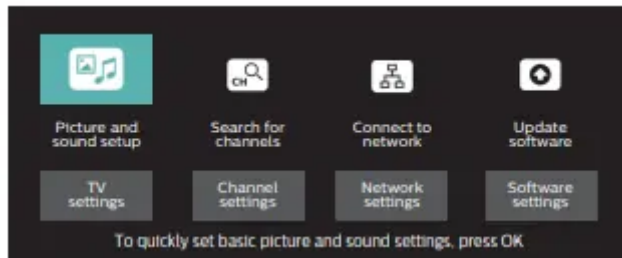



Picture and sound setup	→ p. 31
<small>Guides you to get the best picture and sound settings.</small>	
TV settings	→ p. 31
<small>Accesses menus that allow you to change picture, sound and TV usage settings.</small>	
Search for channels	→ p. 38
<small>Guides you through channel installation.</small>	
Channel settings	→ p. 38
<small>Accesses menus that allow you to change channel settings.</small>	
Connect to network	→ p. 41
<small>Guides you through network installation.</small>	
Network settings	→ p. 42
<small>Accesses menus that allow you to network settings.</small>	
Update software	→ p. 46
<small>Guides you through an update of the TV software.</small>	
Software settings	→ p. 47
<small>Accesses menus that allow you to change software settings.</small>	



Picture and sound setup

Before you begin:

You must set Home in Location. → p. 35

Otherwise, personalized picture and sound settings will not be memorized after the unit goes into standby mode.

1 Press  and use  to select Setup then press OK.

2 Use   to select Picture and sound setup, then press OK.

3 Follow steps 7 to 8 in Initial setup → p. 21

TV settings

Picture

Before you begin:

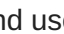

You must set Home in Location. → p. 35 Otherwise, personalized picture and sound settings will not be memorized after the unit goes into standby mode.

1 Press  and use  to select Setup then press OK.

2 Use   to select TV settings, then press OK.

3 Use  to select Picture, then press OK.



4 Use   to select the item you want to adjust, then press OK. The following picture settings can be configured. Depending on the format of the picture source, some picture settings are not available.

Auto picture	To set your TV to a predefined picture setting	
	Personal	The customized settings you defined using the Picture menu.
	Standard	For normal TV viewing.
	Natural	Ideal picture mode for viewing high quality content without any picture enhancements.
	Vivid	Enhanced picture contrast and sharpness for viewing in a well-lit room.
	Sports	Brilliant picture settings for high action.
	Movie	Deep picture settings for a cinematic experience.
	Game	Optimized for PCs and game consoles.
	Energy saving	Eco TV settings for low power consumption.
	Internet video	Optimized for low bit-rate internet video.

When you adjust the following settings, Personal picture will be set automatically		
	Cursor ▼	Cursor ▲
Backlight	To reduce power consumption and brightness	To increase power consumption and brightness
Contrast	To decrease contrast	To increase contrast
Brightness	To decrease brightness	To increase brightness
Color	To decrease color intensity	To increase color intensity
Tint	To adjust color hues, especially to make skin tones appear more natural.	
Sharpness	To soften	To sharpen
Pixel Plus Ultra HD	Enters sub-menus to adjust the following settings: (Dynamic contrast, Color enhancement, Black stretch, 120 PMR, 4K UHD Upscaling, Macro Dimming, Noise reduction and MPEG artifact reduction)	
Advanced settings	Enters sub-menus to adjust the following settings: (Color alignment, Custom color management, HDR mode*, Gamma, Blue stretch and Film mode)	
Picture format	Automatic	Changing Picture format → p. 24
	Super zoom	
	4:3	
	Movie expand 14:9	
	Movie expand 16:9	
	Wide screen	
	Full	
	Manual Zoom ±	
Unscaled		
Mode selection	PC	To turn off image enhancement features which makes the TV to act purely as a monitor
	HDTV	To enable image enhancement features to improve picture quality
	Cursor ▼	Cursor ▲
Horizontal position	To move PC screen left	To move PC screen right
Vertical position	To move PC screen down	To move PC screen up

*1 HDR mode settings are only available on the following models:

- 65PFL5602/F7
- 65PFL5602/F7 D

- 55PFL5602/F7
- 50PFL5602/F7

Other models, such as 65PFL5602/F7 C, automatically switch to the decided picture settings upon receiving HDR signals.

*2 Manual Zoom setting is not available on the following models:

- 65PFL5602/F7
- 65PFL5602/F7 D
- 55PFL5602/F7
- 50PFL5602/F7

Your model number can be confirmed on the rating label applied on the rear cabinet

You may adjust picture quality and enhancement settings using Pixel Plus Ultra HD and Advanced settings sub menus.

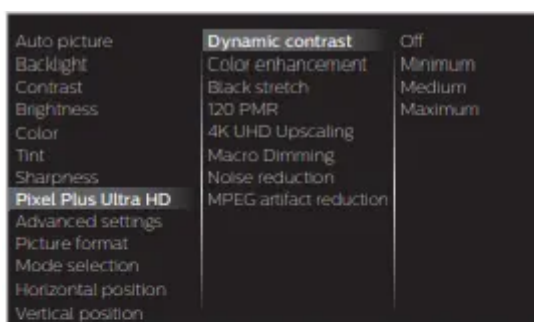

Dynamic contrast	To select the desired setting, then press OK (Off , Minimum , Medium and Maximum)	
Color enhancement	Off	To set color enhancement to off
	On	To make colors more vivid and bright
Black stretch	To select the desired setting, then press OK (Off , Minimum , Medium and Maximum)	
120 PMR	Off	To set 120 PMR to Off
	On	To make the video appear smoother
4K UHD Upscaling	To select the desired setting, then press OK (Off , Minimum , Medium and Maximum)	
Macro Dimming	To select the desired setting, then press OK (Off , Minimum , Medium and Maximum)	
Noise reduction	To select the desired setting, then press OK (Off , Minimum , Medium and Maximum)	
MPEG artifact reduction	To select the desired setting, then press OK (Off , Minimum , Medium and Maximum)	



Color alignment	Mode	To set the color temperature to Personal , Cool , Normal and Warm . When you adjust the following settings, Personal will be set automatically.	
		Cursor ▼	Cursor ▲
	Red gain	To decrease red contrast	To increase red contrast
	Green gain	To decrease green contrast	To increase green contrast
	Blue gain	To decrease blue contrast	To increase blue contrast
	Red offset	To decrease red brightness	To increase red brightness
	Green offset	To decrease green brightness	To increase green brightness
	Blue offset	To decrease blue brightness	To increase blue brightness

Custom color management	To select the desired setting, then press OK (Red , Yellow , Green , Cyan , Blue and Magenta)		
		Cursor ▼	Cursor ▲
	Tint	To adjust color hues, especially to make skin tones appear more natural.	
	Saturation	To decrease color with only selected color	To increase color with only selected color
HDR mode	Off	To set HDR mode to off	
	Auto	Automatically switches to a dedicated picture quality setting when receiving HDR signal.	
Gamma	To select the desired setting, then press OK (Very Dark Room , Dark Room , Normal , Bright Room and Very Bright Room)		
Blue stretch	To select the desired setting, then press OK (Off , Minimum , Medium and Maximum)		
Film mode	Off	To set film mode to off	
	Auto	To optimize the picture recorded by the original film	

*HDR mode settings are only available on the following models:

- 65PFL5602/F7
- 65PFL5602/F7 D
- 55PFL5602/F7
- 50PFL5602/F7

Other models, such as 65PFL5602/F7 C, automatically switch to the decided picture settings upon receiving HDR signals. Your model number can be confirmed on the rating label applied on the rear cabinet.

Sound

You must set Home in Location. → p. 35 Otherwise, personalized picture and sound settings will not be memorized after the unit goes into standby mode.

1 Press and use to select Setup then press OK.

2 Use to select TV settings, then press OK.

3 Use to select Sound, then press OK.

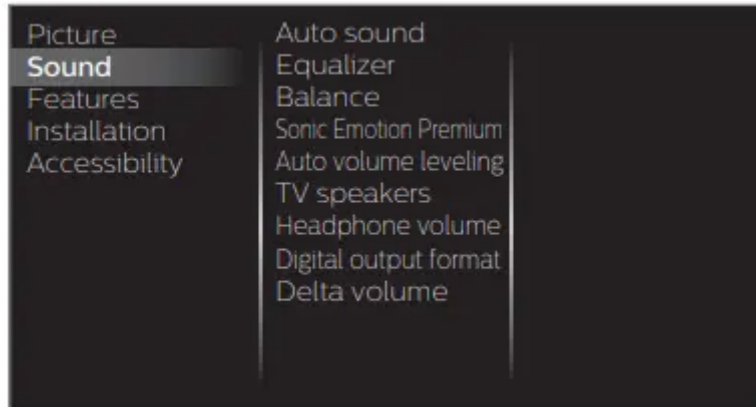

4 Use to select the item you want to adjust, then press OK. The following sound settings can be configured. Depending on the format of the broadcasting, some sound settings are not available

Auto sound	To set your TV to a predefined sound setting. When you adjust the following settings (Equalizer , Sonic Emotion Premium and Auto volume leveling), Personal sound will be set automatically.	
	Personal	The customized settings you defined using the Sound menu.
	Standard	For normal TV viewing.
	Vivid	Enhanced sound.
	Sports	Clear sound for high action.
	Movie	Powerful sound settings for a cinematic experience.
	Music	Optimized for music playback.
	News	Set the anchor's voice at a comfortable volume.

Adjust

the tonal quality for each frequency

Equalizer	Cursor ▲	Cursor ▼
	To adjust each level of tonal quality Press BACK to go back to the previous menu.	

Adjust the speakers to suit your listening preference

Balance	Cursor ▲	Cursor ▼
	To adjust the balance of the right and left speakers	

This selects sound modes for more spatial or surround sound reproduction

Sonic Emotion Premium	Sonic Emotion	Off	To set Sonic Emotion to off
		On	To set Sonic Emotion to on
	Dialog Enhancement	Off	To set Dialog Enhancement to off
		On	To set Dialog Enhancement to on
	Bass Enhancement	Off	To set Bass Enhancement to off
		On	To set Bass Enhancement to on
Absolute 3D Sound	Off	To set Absolute 3D Sound to off	
	On	To set Absolute 3D Sound to on	

This function keeps a constant Loudness differential between the TV commercials and the programs

Auto volume leveling	Off	To remove the Auto volume leveling
	On	To reduce volume differences between the TV commercials and the programs

You

can select the audio output from the unit's speakers or not. If your amplifier is HDMI link function compatible and connected by an HDMI cable to this unit, some sound operations such as volume up can be changed by using this unit's remote control. Make sure Master EasyLink is set to On. → p. 36

TV speakers	Off	No output sound from the unit's speakers
	On	To output sound from the unit's speakers
	Speakers EasyLink	To control audio output from your connected EasyLink compliant devices with VOL + / - by using this unit's remote control.

Adjust headphone volume

Headphone volume	Cursor ▲	Cursor ▼
	To decrease or increase volume	

You

can set the digital audio output format from SPDIF/ARC

Digital output format	PCM	To output PCM format
	Bitstream	To output audio in its native format as Bitstream to connected audio receiver

If a

channel or input device is too loud or too soft, navigate to that channel or input device

	Cursor ▲	Cursor ▼
Delta volume	Provides the ability to set a custom volume level for the current channel or input source. If the source volume is too loud, set a negative value (-1 to -12) If the source volume is too soft, set a positive value (+1 to +12)	

Features

1 Press  and use  to select Setup then press OK.

2 Use   to select TV settings, then press OK.

3 Use  to select Features, then press OK.





4 Adjust the following items.



Sleeptimer

Sleep timer can set the unit to go into standby mode after an incremental period of time.









1 Use  to select Sleeptimer, then press OK.

2 Use  repeatedly to change the amount of time (increases the time by 5 minutes up to 180 minutes).

- Each press of  will decrease the time by 5 minutes.

- Press  INFO once to call up the display for checking the remaining time.
- To cancel the sleep timer, press   repeatedly until “0” is displayed.

Installation

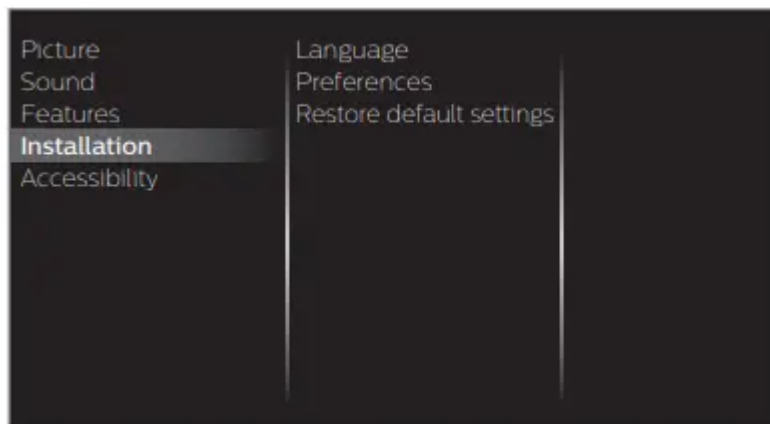

- 1 Press  and use   to select Setup then press OK.
- 2 Use     to select TV settings, then press OK.
- 3 Use   to select Installation, then press OK.



- 4 Adjust the following items.

Language

You can set the language for the on-screen display.

- 1 Use   to select Language, then press OK.

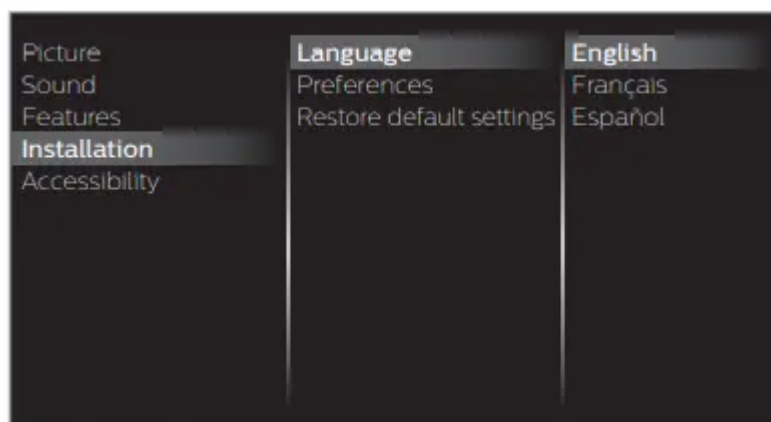



- 2 Use   to select English, Español or Français, then press OK.



Preferences

You can set the unit to reduce the power consumption or adjust the backlight brightness in Location setting. EasyLink allows you to operate your connected EasyLink device.



Setting your location to home

Choosing Home gives you full flexibility to change predefined settings for picture and sound.

1 Use   to select Preferences, then press OK.

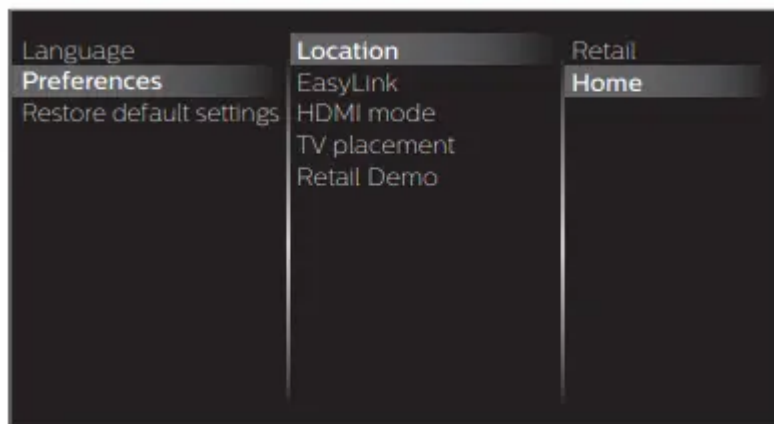
2 Use   to select Location, then press OK.





3 Use   to select Home, then press OK.

Retail	The unit will be set up with predefined settings for retail displays. In this setting, you can set the backlight brighter.
Home	The unit is set to maximize the energy efficiency for home setting and it can be adjusted through a choice of picture and sound quality selections according to your preference.



HDMI mode

If there are issues with picture/color and/or sound when connecting an external device using the HDMI port, please try switching the HDMI mode following the instructions below

1 Press  and use   to select Setup, then press OK.



2 Use     to select TV settings, then press OK.

3 Use   to select Installation, then press OK.

4 Use   to select Preferences, then press OK.

5 Use   to select HDMI mode, then press OK.



6 Use   to select HDMI1, HDMI2 or HDMI3, then press OK.

7 Use   to select Max 4K@60Hz + HDR, Max 4K@60Hz or Max 4K@30Hz (Compatibility) depending on the output capabilities of the external device, then press OK.



- When switching the HDMI configuration, the screen will black out for a moment, then come back on

TV placement

To apply the best settings for your TV, select wall mount or stand mount.



1 Use   to select Preferences, then press OK.

2 Use   to select TV placement, then press OK.

3 Use   to select Wall mounted or On a TV stand, then press OK.

Retail Demo

When you set Location to Retail, E-sticker (Electronic Sticker) is displayed. E-sticker can be turned off using procedure below.

1 Use   to select Preferences, then press OK.

2 Use   to select Retail Demo, then press OK.

3 Use   to select Off, then press OK.

Use Philips EasyLink

Your TV supports Philips EasyLink, which enables one-touch play and one-touch standby between EasyLink-compliant devices. Compliant devices must be connected via an HDMI connector.

One-touch play

When you connect your TV to devices that support one-touch play, you can control your TV and the devices with one remote control. For

example, when you press  (Play) on your DVD remote control, your TV automatically switches to the correct channel to show the DVD content.

One-touch standby

When you connect your TV to devices that support standby, you can use your TV remote control to put your TV and all connected HDMI devices in standby mode. You can perform one-touch standby using the remote control from any of the connected HDMI devices.

System audio control

When you connect your TV to HDMI CEC compliant devices, your TV can switch automatically to play audio from the connected device. To use one-touch audio, you must map the audio input from the connected device to your TV. You can use the remote control from the connected device to adjust the volume.

Remote control (RC) key forwarding

RC key forwarding allows you to control EasyLink-compliant devices using your TV remote control.

HDMI-ARC (Audio Return Channel) (HDMI 2 only)

HDMI-ARC allows you to use Philips EasyLink to output TV audio directly to a connected audio device, without the need for an additional digital audio cable. Be sure that the device is HDMI CEC and ARC compliant, and that the TV is connected to the device using an HDMI cable attached to both HDMI-ARC connectors.

EasyLink (HDMI CEC)

This function allows you to operate the linked functions between our brand devices with a EasyLink feature and this unit connecting through an HDMI cable. You must connect this unit to our brand EasyLink devices and be sure its EasyLink (HDMI CEC) setting is also set to on

1 Use  to select Preferences, then press OK.

2 Use  to select EasyLink, then press OK.

3 Use  to select the item you want to adjust, then press OK.



Set the Master EasyLink to On or Off. The following additional settings will be grayed out when you set them to Off.

Master EasyLink	Off	Disables all EasyLink.
	On	Selects if you have connected an external device that is compatible with the EasyLink function.

This unit will turn on when the power on signal is sent from your connected EasyLink device.

Auto TV On	Off	This unit stays in Standby mode even if you turn on your connected EasyLink device.
	On	This unit turns on automatically when you turn on your connected EasyLink device.

You can operate some functions such as disc playback or call up the menu of the connected devices, by using this unit's remote control.

RC key forwarding	Off	Disable RC key forwarding.
	On	PLAY, PAUSE ▶ / STOP ■ / FWD ▶▶ / REV ◀◀ / VOL + / - / 🔊 (MUTE) / ⏏ OPTIONS / ▲▼◀▶ / OK / ↵ BACK / the NUMBER buttons can be used to control your connected EasyLink devices by this unit's remote control.

HDMI-ARC allows you to use Philips EasyLink to output TV audio directly to a connected audio device, without the need for an additional digital audio cable

HDMI-ARC (HDMI 2 only)	Off	Disable HDMI-ARC.
	On	You can output TV audio through the HDMI cable solely, provided both the TV and device are HDMI-ARC compliant.

Return your settings to default values



You can return settings to their default values.

1 Use  to select Restore default settings, then press OK.

2 Use  to select Reset AV settings or Reset all settings, then press OK.

Reset AV settings	Return picture and sound settings to their default values. The channel installation settings are not affected.
Reset all settings	Return all the settings to their default values.

Accessibility

1 Press  and use  to select Setup then press OK.

2 Use  to select TV settings, then press OK.

3 Use  to select Accessibility, then press OK.

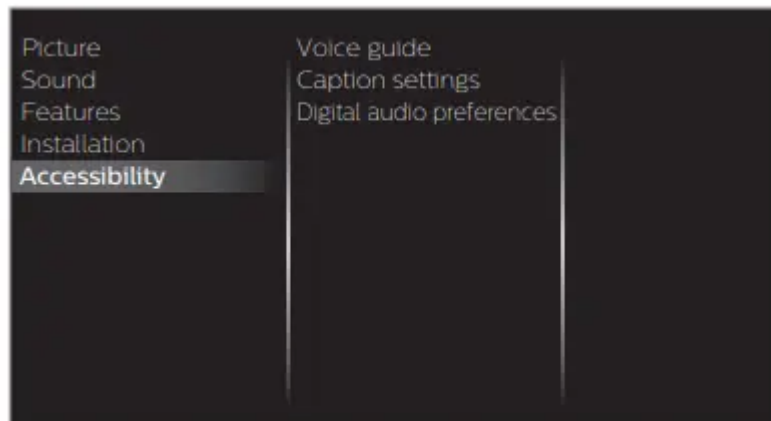

4 Adjust the following items

Voice guide

Lets you configure Voice guide and its settings.

1 Use  to select Voice guide, then press OK

Voice guide toggle	Off	To set Voice guide off
	On	To set Voice guide on
Speed	Fast	Set voice guide speed based on your preference
	Normal	
	Slow	
Pitch	High	Set voice guide pitch based on your preference
	Normal	
	Low	
Verbosity	Verbose	Set voice guide explanation verbosity based on your preference
	Succinct	
Volume level	Loud	Set voice guide volume based on your preference
	Normal	
	Soft	

Caption

settings

Closed captions displays the audio portion of the program as superimposed text over the video.

1 Use  to select Caption settings, then press OK.

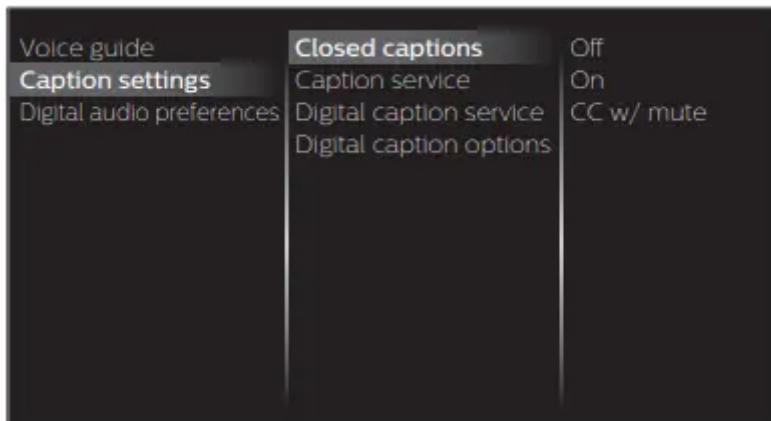

Closed captions	Off	Closed caption is not displayed.
	On	Closed caption is always displayed.
	CC w/mute	Closed caption is displayed when the sound is off.

Digital TV operation

In addition to the basic closed caption, DTV has its own closed caption called digital caption service. Use this menu to change the settings for digital caption service.

Digital caption service	CS-1 to CS-6	Select one of these before changing any other item in Caption settings menu. Choose CS-1 under normal conditions.
--------------------------------	---------------------	---

You can choose the size, font, color, background and other characteristics of the caption text

Digital caption options	Reset to default	You can reset the status of digital caption options.
		You can change closed captioning font style, size, color and transparency. (Font style , Font size , Font color and Font opacity)
		You can change background color and transparency of the displayed caption. (Background color and Background opacity)
		You can change edge color and type of the displayed caption text. (Edge color and Edge type)

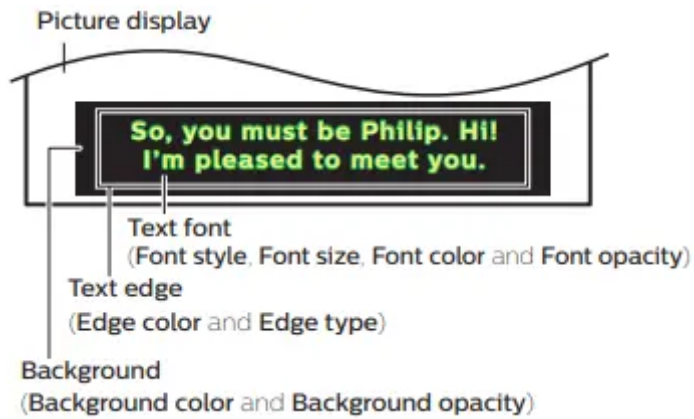

Cable / NTSC (Analog) TV operation

Caption service	CC-1 and T-1	The primary closed captions and text services. The closed captions or text is displayed in the same language as the program's dialog (up to 4 lines of script on the TV screen).
	CC-3 and T-3	Serve as the preferred data channels. The closed captions or text is often a secondary language.
	CC-2, CC-4, T-2 and T-4	Rarely available and broadcasters use them only in special conditions, such as when CC-1 and CC-3 or T-1 and T-3 are not available.

• There

are 3 display modes according to programs:

Paint-on	Displays characters on the TV screen immediately.
Pop-on	Once characters are stored in memory, they are displayed all at once.
Roll-up	Displays the characters continuously by scrolling (max. 4 lines).

Digital

audio preferences

You can set the interpretive broadcasting by an audio explanation.



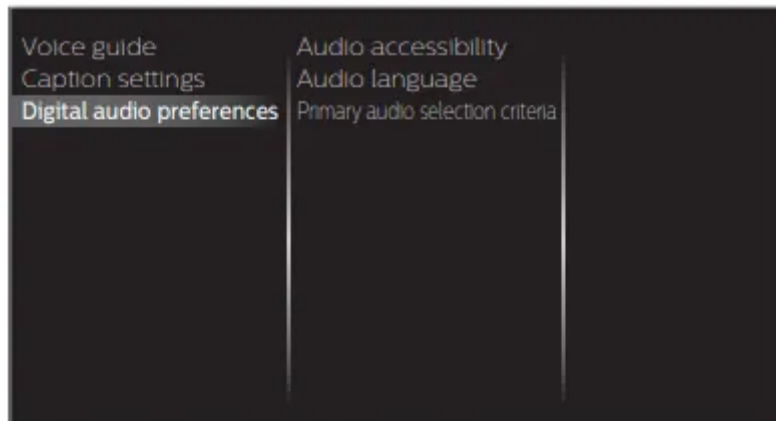

1 Use  to select Digital audio preferences, then press OK



Audio accessibility	To prioritize VI-Visually Impaired streaming or HI-Hearing Impaired streaming. The setting for handicapped users (Main audio, Visually Impaired or Hearing Impaired).
Audio language	To set your preferred language in the audio streaming (English, Spanish or French).
Primary audio selection criteria	To set TV priority based on either of the above settings: (Audio accessibility or Audio language).

Search for channels

Be sure the RF cable is correctly connected to this unit and you are registered with your cable TV provider when you install cable channels.

1 Press  and use  to select Setup then press OK.

2 Use  to select Search for channels,, then press OK.

3 Use  to select Start, then press OK.

Install channels

You can search and store all channels. If you move the unit to a different area after the initial setting, it is recommended to perform Autoprogramming.

4 Use  to select Antenna or Cable, then press OK.

5 Press OK on Start.

- When the scanning and memorizing of available channels is completed, the lowest memorized channel will be displayed.

6 Follow the on-screen instructions to complete the installation.

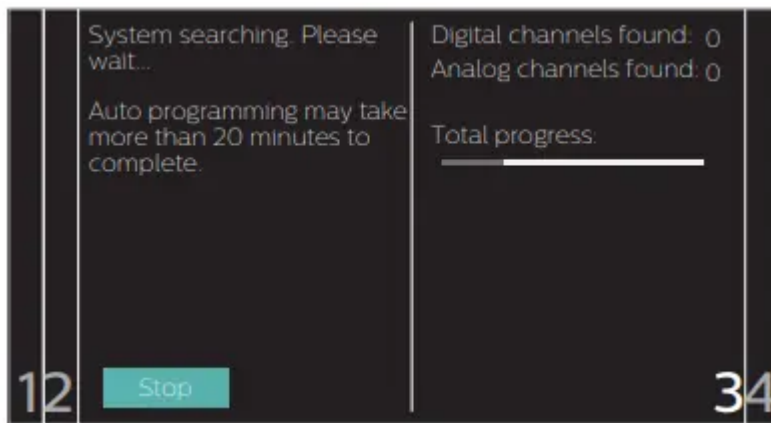

Channel settings

- 1 Press and use to select Setup then press OK.
- 2 Use to select Channel settings, then press OK.
- 3 Adjust the following items.

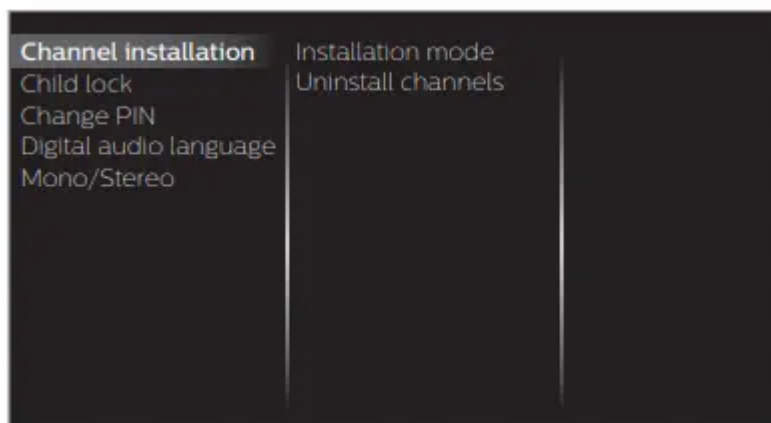

Channel installation

Be sure the RF cable is correctly connected to this unit and you are registered with your cable TV provider when you install cable channels.

Installation mode

- 1 Use to select Channel installation, then press OK.
- 2 Use to select Installation mode, then press OK.
- 3 Use to select Antenna or Cable, then press OK.

- When Antenna is selected, the TV detects antenna signals. It searches for DTV and analog TV channels available in your area.

- When Cable is selected, the TV detects signals supplied by cable. It searches for DTV, analog TV and cable channels available in your area.

Uninstall channels

The channels selected here can be skipped when selecting the channels using CH + / -.

Those channels can still be selected with the NUMBER buttons.

1 Use **▲▼** to select Channel installation, then press OK.

2 Use **▲▼** to select Uninstall channels, then press OK.

3 Use **▲▼** to select the channel you want to remove, then press OK.

- The removed channels are not displayed on the list of favorite channels.

- To reactivate a removed channel, use **▲▼** then press OK.

Child lock

You can prevent your children from watching certain programs or certain channels by locking the TV controls and by using ratings.

1 Use **▲▼** to select Child lock, then press OK.



2 Use the NUMBER buttons to enter the 4-digit numbers for your PIN code.

- When you have not set up your PIN code, enter 0, 0, 0, 0.
- When the PIN code is correct, Child lock menu is displayed.

See the following description for setting each item





Setting TV and movie ratings

Movie ratings lock is the rating system created by MPAA. TV ratings lock has controlled access to individual programs based on their age ratings and content rating.

3 Use **▲▼** to select TV ratings lock or Movie ratings lock, then press OK.

4 Use **▲▼** to select the desired rating, then press OK repeatedly to switch between block and view.

- indicates that the rating is locked (Blocked).
- indicates that the sub rating is locked (Blocked).
- indicates that the rating is not locked (Viewable).

TV ratings lock

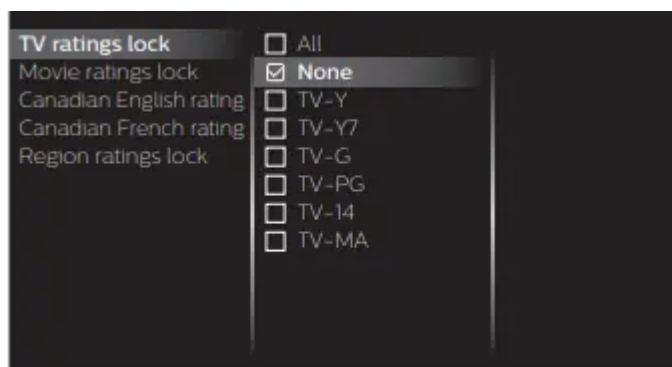

Movie ratings lock



US movie ratings	US TV ratings	Description
All		All ratings locked including no rating
NR	None	No rating
-	TV-Y	Appropriate for all children
-	TV-Y7	Appropriate for all children 7 and older
G	TV-G	General audience
PG	TV-PG	Parental guidance suggested
PG-13	-	Unsuitable for children under 13
-	TV-14	Unsuitable for children under 14
R	-	Restricted under 17 requires accompanying parent or adult guardian
NC-17	-	No one under 17 admitted
X	TV-MA	Mature audience only

To set the sub ratings (displayed in the right column)

For TV ratings lock, you can further set the sub ratings to block specific elements of programming. To set the sub ratings, follow the step below.

Use **▲▼◀▶** to select the desired rating, then press OK repeatedly to switch between , .

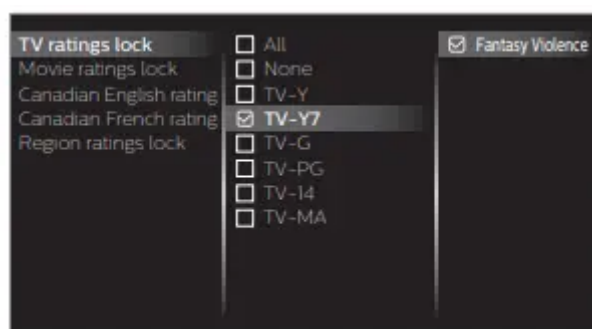

US TV ratings	Sub rating
TV-Y7	Fantasy Violence
TV-PG	Violence
TV-14	Sex Language Dialog
TV-MA	Violence Sex Language

Change PIN

Although the default PIN code (0000) is supplied with the unit, you can set your own PIN code.

- 1 Use ▲▼ to select Change PIN, then press OK.
- 2 Press the NUMBER buttons to enter the current 4-digit PIN code.
- 3 Press the NUMBER buttons to enter the new 4-digit PIN code.
 - Enter PIN code again to confirm.

Digital audio language

You can select the audio language while your TV is receiving the digital broadcasting.

- 1 Use ▲▼ to select Digital audio language, then press OK.

Digital audio language	To select the language according to your preference. (It differs depending on the program.)
------------------------	--

Mono/Stereo

Cable / NTSC (Analog) TV operation

You can select an audio format while your TV is receiving the analog broadcasting.

- 1 Use ▲▼ to select Mono/Stereo, then press OK.
- 2 Use ▲▼ to select Mono, Stereo or SAP (Second Audio Program), then press OK.



Connect to network

Setup network connection settings in order to use Net TV or network upgrade functions.

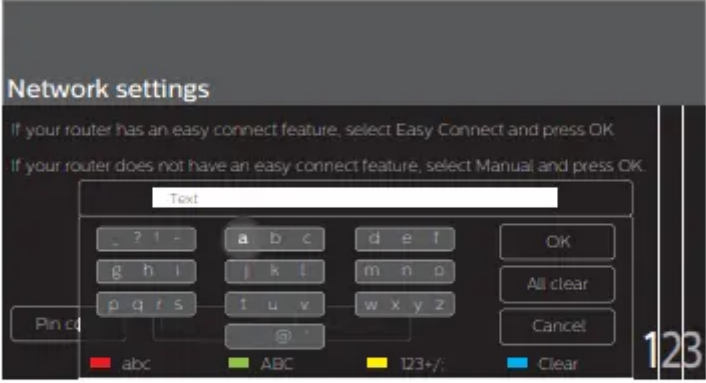
- The meanings of abbreviations are defined as below.
AP : Wireless LAN access point
SSID : Wireless network name
- The key entry screen will appear when you select SSID, WEP / others or proxy address.



- Enter the key of the selected wireless network using ▲▼◀▶, then press **OK**.
Clear : Clear the entered number or word.
All clear : Clear all the entered numbers or words.
abc : Switch to the small letter mode.
ABC : Switch to the capital letter mode.
123+; : Switch to the numeral and symbol mode.
Cancel : Shows the cancellation display.
OK : Set the entered number or word.

1 Press  and use  to select Setup then press OK.

2 Use  to select Connect to network, then press OK.



Wireless setting

Select to use a wireless LAN to connect to the internet by a wireless connection.

1 Use  to select Wireless, then press OK.

2 Use  to select the desired setting, then press OK, and follow the on-screen instructions.

Easy Connect	Select this setting if your router has an easy connect button. Start scanning for wireless networks on the TV after pressing the easy connect button on your router. If connection test fails, refer to the router's manual for more details.
Scan	Search for wireless networks automatically and select the wireless network name (SSID) from the list.
Manual entry	Set up the connection to the wireless LAN Access Point (AP) (e.g. wireless router) manually by entering the wireless network name (SSID).

* Easy Connect cannot be used when the security protocol is set to WEP. Change the Access Point's security mode from WEP to others (recommended).



Wired setting

Select to use an Ethernet cable to connect to the internet by a wired connection. Please purchase shielded Ethernet cables at your local store and use it when you connect to network equipment.

1 Use   to select Wired, then press OK

. • Connection test will start automatically. → p. 44

Network settings

1 Press  and use   to select Setup then press OK.

2 Use     to select Network settings, then press OK.



3 Adjust the following items.

Manual network settings

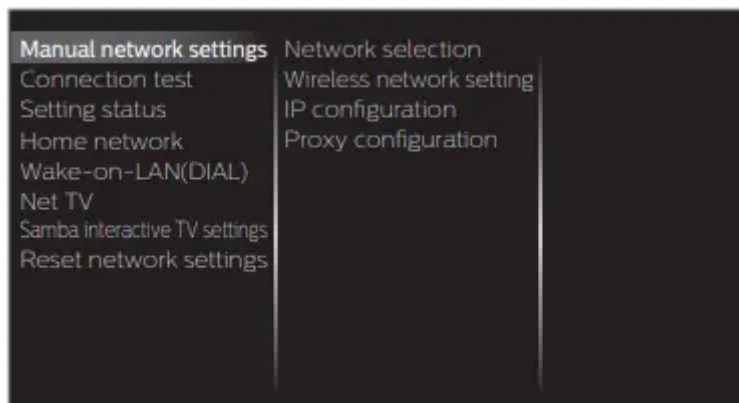
1 Use   to select Manual network settings, then press OK.



Network selection



2 Use   to select Network selection, then press OK.

3 Use   to select the desired setting, then press OK

Wired	If you connect to an Ethernet cable, select Wired to connect to the internet.
Wireless	If you have a router with easy connect function, select Wireless to connect to the internet.



Wireless network setting

This menu is displayed only when you set Wireless in Network selection. In order to use a wireless network, you must set up a connection to the AP (e.g. wireless router).









2 Use   to select Wireless network setting, then press OK.

Auto Search for wireless networks automatically and select the SSID from the list.

3 Use   to select Auto, then press OK.

4 The list of wireless networks will be displayed. Use   to select the appropriate the SSID, then press OK.



- If you select the SSID with  WEP*2 / others Key entry screen will appear. Enter the WEP*2 / others key of the selected wireless network using    , then press OK.
- If you select the SSID has an easy connect, the easy connect setting screen will appear. Use     to select a setting, then press OK.

Easy Connect	Select this setting if your router has an easy connect button. Start scanning for wireless networks on the TV after pressing the easy connect button on your router. If connection test fails, try Easy Connect again.*1 If it fails then refer to the router's manual for more details.
Pin code	Select this setting if your router has an easy connect feature but does not have an easy connect button. Enter the 8-digit PIN code shown on your TV in the Router settings menu via PC before Connect is selected.
Manual	If your wireless network with authentication setting (WEP*2, others), WEP*2 / others Key entry screen will appear. Enter the WEP*2 / others key of the selected wireless network using ▲▼◀▶, then press OK .

*1 Easy Connect cannot be used when the security protocol is set to WEP. Change the Access Point's security mode from WEP to others (recommended).

*2 WEP is not recommended to be used due to its major security flaws. Change the security protocol on the wireless router to others (recommended) mode.

Confirmation message will appear. Select OK to complete the settings.

Troubleshooting tips

No power

- Make sure the AC power cord is plugged in.
- Make sure that the AC outlet supplies the proper voltage, plug another electrical appliance into the AC outlet to ensure that the AC outlet operates normally.
- If a power failure

Control buttons do not work.

- Do NOT press more than one button at the same time.
- Ensure that no buttons on the remote control are depressed and move freely.

Universal remote control does not work properly.

- Refer to the User manual of the universal remote control for the Philips code.

Power is on but no screen image.

- Check whether the connection for the antenna, cable or set-top box is connected correctly.
- Check whether all the cables to the unit are connected to the correct output jack on your separate device like Blu-ray Disc™ / DVD recorder.
- Make sure that the selected input mode is connected to the working input jack.
- Check if your computer is NOT in sleep mode when the input mode on this unit is in PC mode. Tap any key on the computer keyboard to wake it up.

- Check if the correct input mode is selected by pressing  SOURCE.

No color

- View other TV channels. The problem might be limited to the broadcasting station.
- Adjust Color in Picture settings. → p. 31

Picture poor

- Adjust Contrast and Brightness in Picture settings. → p. 31
- For the best picture quality, watch “High Definition” wide screen programs. If the HD content is not available, watch “Standard Definition” programs instead.

You see pixelation on the screen.

- When the capabilities of the unit exceed the capabilities of the digital broadcasting, the signal will be increased to match the capabilities of the display on the unit. This may cause pixelation, noise or trash.

Unusual picture appears and the TV does not operate.

- Press the power button first. If it does not solve, follow the procedure below.
- Press the buttons on the remote control in the order shown below 
- Unplug the AC power cord, then wait for 1 minute, and then plug it in again

No sound is heard when using the HDMI digital connection.

- Some HDMI cables and devices may not be compatible with the TV due to different HDMI specifications.

No sound, distorted sound or incorrect audio sound is heard when using the HDMI-DVI connections.

- Make sure that the analog audio signals from the HDMI-DVI device are connected to the analog audio input L/R jacks.
- When using Component analog video or Composite analog video, make sure that the analog audio (L/R) connectors are mounted into the audio (L/R) input jacks.

Sound intermittent or no sound.

- Check if the audio cable is connected into the unit correctly.



You switch to a different input and the volume changes.

- This unit will memorize the volume level from the last time you adjusted it.
- If the volume of the sound from another device is higher or lower, then the loudness will change.
- Make sure Auto volume leveling is set to On. → p. 33

No sound with distorted picture occurs when using the HDMI digital connection.

- Some HDMI cables and devices may not be compatible with the TV due to different HDMI specifications.

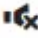
No picture or sound

- Check if the power is on.
- Check whether all the cables to the unit are connected to the correct output jack on your separate device like Blu-ray Disc™ / DVD recorder.
- View other TV channels. The problem might be limited to the broadcasting station or weak signal strength.
- Unplug the AC power cord and wait for about 1 minute, then plug the AC power cord and turn on the unit again
- Check whether the connection of the antenna or cable / satellite set-top box is connected correctly.
- Make sure that the selected input mode is connected to the working input jack.
- Check if your computer is NOT in sleep mode when the input mode of this unit is in PC mode. Tap any key on the keyboard to wake up your computer.
- Make sure that the sound is not muted. Press  so that the volume bar and current volume level will appear on the TV screen.
- Make sure that the volume is NOT set to 0 or . If so, use VOL + / – to adjust to the desired volume.
- Make sure that the headphone is NOT connected to the headphone audio output jack.
- Make sure that the TV speakers is NOT set to Off.
- If there are issues with picture/color and/or sound when connecting an external device using the HDMI port, please try switching the HDMI mode. (Refer to HDMI mode → p. 35)

Adjusted Picture or Sound settings are not effective every time the unit is turned on.

- You must set Home in Location. → p. 35 (Otherwise, the settings you adjusted will not be memorized after the unit goes into standby mode.)

You see a distorted picture or hear an unusual sound. (Analog TV - NTSC signal)

- You may be getting NTSC (Analog) TV signal (not HDTV signal) interference from electrical appliances, automobiles, motorcycles or fluorescent lights.
- Try moving the unit to another location to see if this is the cause of the problem.

Ghosts, lines or streaks in picture.

- Electrical interference from nearby appliances may affect picture quality.

- View other TV channels. The problem might be limited to the broadcasting station or weak signal strength.

Picture poor, sound intermittent or no sound

- View other TV channels. The problem might be limited to the broadcasting station or weak signal strength.

Forgotten PIN code.

- Enter “07 1 1” to clear your password.

You switch to a different input and the screen size changes.

- This unit will memorize the viewing mode from the last time you used the particular input modes.

The display image does not cover the entire screen.

- If you are using the unit as a PC monitor, make sure that Horizontal position and Vertical position in Picture are set correctly. → p. 31
- If you are watching TV or using the composite video, component video or HDMI with 480i input, press  FORMAT repeatedly to switch to various screen modes.

Different color marks on the TV screen

- View other TV channels. The problem might be limited to the broadcasting station, missing data or pixelation due to weak signal strength.

Closed captions are displayed as a white box. No closed captions are displayed in the closed captions-supported program.

- Interference from buildings or weather conditions may cause closed captions to be incomplete if watching analog TV signals.
- Broadcasting station may shorten the program to insert advertisements. The closed caption decoder cannot read the information of the shortened program

Black box is displayed on the TV screen.

- The text mode is selected for caption. Select CC-1, CC-2, CC-3 or CC-4.

A message appears on the screen prompting for software update again.

- When you start up the TV or a net service after executing the software update, a message may appear on the screen prompting for software update again. In this case, please select Update to start USB update or network update. → p. 46

Cannot connect to the network.

- Check if the Ethernet cable connection is properly made. Turn on the broadband router and/or modem.

- Check the network settings.
- Check if the broadband router and/or modem is correctly connected

Sometimes video quality is poor when using the wireless LAN.

- The wireless network connection quality varies depending on the distance or obstacles (e.g. wall, basement, 2nd floor) between the TV wireless LAN adapter and the wireless router (access point), from other wireless networks, and brand and type of the wireless router (access point). When using the wireless LAN of the TV, it is suggested to place the wireless router as close as possible to the television.

Wireless LAN connection fails or wireless connection is poor.

- Check the installation location of the TV and wireless router (access point). Signal quality may be affected for the following reasons.
 - Interference of other wireless devices, microwaves, fluorescent lights, etc., are placed nearby.
 - There are floors or walls between the wireless router and TV.
 - If the problems continue even after checking the above, try making a wired LAN connection.

Cannot use the wireless connection.

- Check if the wireless LAN Access Point (AP) (e.g. wireless router) is oriented properly or not placed too close between them.
- Once you have activated the wireless connection please wait 30 seconds for the connection to be established after turning on the unit, before trying to access network features such as Net TV.

Even though the speed of the internet connection improves during playback, the picture quality of Netflix streaming movie does not improve.

- The picture quality does not change during playback. It differs depending on the speed of internet connection at the time of loading.

Cannot use VUDU feature.

- VUDU is available only in the United States and Mexico.
- Check if the network connection is properly made

The picture quality of streaming movie (Netflix, VUDU or CinemaNow) is poor.

- Check the speed of your internet connection. You need speeds of at least 8 Mbps to this player for high quality uninterrupted playback.

Streaming movie (Netflix, VUDU or CinemaNow) often stops or starts buffering during playback.

- Contact your internet service provider to troubleshoot your internet connection for speed and line quality. Consistent line quality and speed are very important for internet video playback.

Cannot connect to the network while my PC is connected to the network.

- Check the content of your internet service contract to see if your internet service provider prevents multiple terminals connecting at the same time.

Cannot use Easy Connect to connect to the access point.

- Connect the unit to the access point using scan or manual entry mode. If the access point's security mode is set to WEP*, change the setting to others (recommended), then try Easy connect again. (For access point configuration, please consult its user manual or manufacturer.)

* WEP is not recommended to be used due to its major security flaws. Change the security protocol on the wireless router to others (recommended) mode.

Folder or files stored on home network media server are not displayed in the file list or cannot be played back.

- Check the setting on your home media server. (Refer to the user manual of the home media server.)
- Check the network connection and settings.

Cannot use Pandora feature.

- Check if the network connection is properly made.
- Pandora is available only in the United States.
- You must create a Pandora account and activate this unit.

Activating Pandora → p. 52 Wireless Screencasting

- Connectivity with all Wireless Screencasting compatible devices is not guaranteed.
- Devices that do not comply with Wireless Screencasting standards may have compatibility issues.

Maintenance

Cleaning

- Clean the front panel and other exterior surfaces of the unit with a soft microfiber cloth or lens brush. Before cleaning the panel, disconnect the AC power cord.

- Never use a solvent or alcohol. Do not spray insecticide liquid near the unit. Such chemicals may cause damage and discoloration to the exposed surfaces.
- Do not spray any liquids on the screen or other exterior surfaces of this unit. If liquids enter the unit, they could cause shorts, electric shocks or fire damage.



Servicing

Should your unit become inoperative, do not try to correct the problem yourself. There are no user serviceable parts inside. Call our toll free customer support line found on the cover of this User manual to locate an authorized service center.

IR signal check

If the remote control is not working properly, you can use a digital or cell phone camera to see if it is sending out an infrared signal. e.g.) With a digital camera: Point the digital camera towards the remote control infrared diode at the front of the remote control. Press and hold any key on the remote control and look at the camera display. If an infrared pulsating light appears on the display, the remote control is sending out an IR signal.

Note: Some cameras may have an IR filter or dual camera cell phones may have an IR filter in one of the camera's and both will not display the IR signal.



Specifications

Model #	65PFL5602	55PFL5602	50PFL5602	43PFL5602
Picture				
Type	UHD (Ultra HD) (3840 x 2160 pixels 60Hz)			
Diagonal screen size / Aspect ratio	65" / 16:9	54.6" / 16:9	49.5" / 16:9	43" / 16:9
Viewing angles	178° (V) by 178° (H)			
Built-in digital / analog tuner	ATSC (digital) / NTSC (analog)			
Sound				
Mono / Stereo	Mono, Stereo, Sonic Emotion Premium			
Power output (RMS watts)	10W x 2			8W x 2
Equalizer	5 Band			
Ease of use				
Picture format	SD (4:3 source)	Automatic / Super zoom / 4:3 / Movie expand 14:9 / Movie expand 16:9 / Wide screen / Manual Zoom		
	HD (16:9 source)	Automatic / 4:3 / Wide screen / Full / Unscaled / Manual Zoom		
	UHD	Full / Unscaled / Manual Zoom		
Photo slide show	JPEG, Progressive JPEG			
Music playback	MP3, WAV, AAC			
Video playback	MPEG1, MPEG2, H.264, MPEG4, H.265/HEVC			
Channel				
Channel coverage	Over-the-Air DTV : VHF: 2-13 (ATSC) UHF: 14-69 (Each channel may have e.g. 2.1-2.9, 3.1-3.9, etc) Over-the-Air Analog : VHF: 2-13 (NTSC) UHF: 14-69			
CATV (Analog NTSC)	2-13, A-W W+1-W+94 (Analog W+1-W+84), A-5-A-1, 5A			
Tuning system	Channel frequency synthesized tuning system			
Channel access	Direct access number keyboard, Programmable scan, Channel +(up) / -(down) and PREV. CH (Previous channel)			
Connectivity				
Component video input (Y/Pb/Pr)	1 Supporting video signals : 480i/p, 720p, 1080i/p @60Hz			
Composite video input (Shared Y green terminal with component video)	1			
HDMI input	3 (selectable HDMI modes) Supporting HDMI video signals : 480i/p, 720p, 1080i @60Hz, 1080p, 2160p @24/30/60Hz Supporting HDMI digital audio signals : LPCM, AC3, DD+ Supporting PC-Input video signal up to 4096 x 2160			
Analog audio L/R input	1 (L audio / R audio)			
PC input	Via HDMI and HDMI-DVI + Analog audio L/R			
USB	1			
Wireless LAN	Supporting wireless standards : IEEE 802.11a/b/g/n/ac (2.4GHz/5GHz)			
Ethernet port	1			
Digital audio output	1 Supporting Dolby Audio (Dolby Digital and Dolby Digital Plus)			
Headphone output	1 1/8 Inch (3.5mm)			
Power				
Power requirements	120V- +/- 10%, 60Hz +/- 0.5%			
Temperature				
Operating temperature	41°F (5 °C) to 104°F (40 °C)			

Warning

This content is compiled from multiple sources and is provided for reference purposes only. It may not be complete or fully applicable to all situations. If you are unable to resolve your issue, please contact the product manufacturer or an authorized service provider for official support.

