

COMPONENTS

Parts' Name

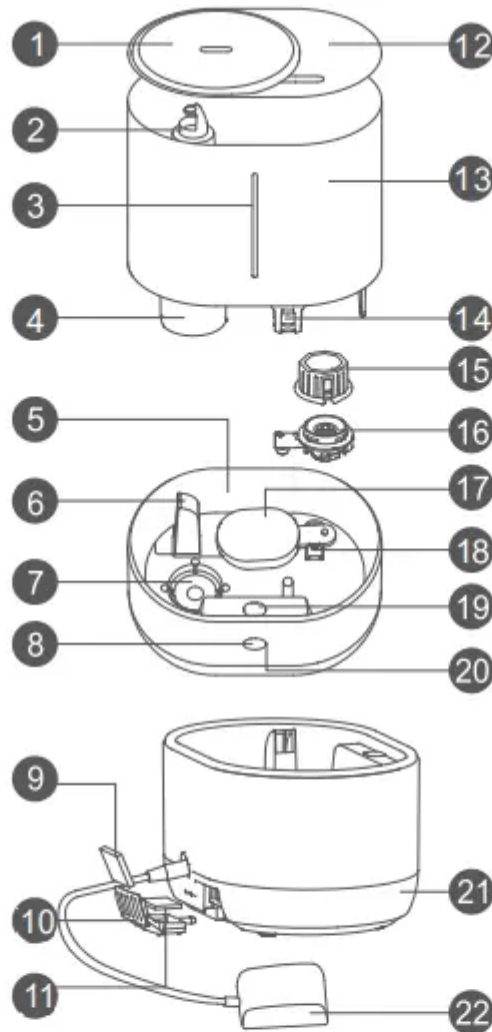

- | | | |
|-----------------------|-----------------------------|----------------------|
| 1. Mist Outlet Cover | 9. Carbon Filter | 17. Float Plate |
| 2. Mist Outlet | 10. Fragrance Box | 18. Supporter |
| 3. Water Gauge | 11. Fragrance Sponge | 19. Water Tank Light |
| 4. Mist Reinforcement | 12. Top Cover | 20. Light Ring |
| 5. Water Channel | 13. Water Tank | 21. Bottom Cover |
| 6. Air Outlet | 14. Float | 22. Power Adapter |
| 7. Atomizer | 15. Filter | |
| 8. Button | 16. Water Cover Subassembly | |

SETTING UP YOUR HUMIDIFIER

Unpack the Humidifier. Keep this instruction manual for reference

1. Remove the accessories from the box.
2. Remove the mist outlet cover (figure 1); add water directly into the water tank and then put cover back on the unit.



Figure 1

3. Insert the power adapter into the humidifier and connect it to a power outlet. When power is connected, the humidifier will enter standby mode.
4. In standby mode, press the button to start up the humidifier. The unit will turn on and should begin misting.
5. For more information about the button and light ring, please refer to the section “Operation method” on “Using Your Humidifier” page.
6. If you want to use the fragrance function; press and then release the fragrance tray to remove it (figure 2). Add 10 drops of fragrance into the fragrance sponge, and replace the tray back to its compartment.



Figure 2

NOTE:

- Never add fragrance directly into the water tank or water channel.
- Do not let aromatherapy oil come into contact with any other parts except the aromatherapy container to prevent damage. If aromatherapy oil has contacted other parts, clean and wipe them with a dry cloth immediately.
- To use the humidifier at night, it is recommended that you add water above 3/4 of the water tank to avoid water leaks.

USING YOUR HUMIDIFIER

Notice before operation

Suitable working environment for humidifier: 40°F - 104°F (5°C - 40°C);

Relative humidity: less than 80% RH;

Use clean water below 104°F (40°C);

When the humidifier hasn't been used for a long time, the water channel and the water tank should be cleaned before use;

This product includes a fragrance function. If it has not been used for a long time, please clean the fragrance duct before adding additional fragrance oil.

Operation method

Plug in the power adapter

- Standby status

Short press the button

- 1st Press - Smart Mode

- 2nd Press - Low Mist
- 3rd Press - Medium Mist
- 4th Press - High Mist 5th Press - Turn OFF

Hold the button for 3 seconds

- To turn the water tank light on/off (water tank light defaults to light-up).

Light ring is red

- Standby status

Light ring is white

- Working status
- In Smart mode, light ring is blinking
- In Low Mist, Medium Mist And High Mist modes, the light ring will be displayed in different brightnesses; the brighter the light ring, the greater the mist output.

Light ring is red and blinking

- If it blinks twice, this indicates the level of water in the tank is too low. Make sure the water tank is filled with water and installed in the base. Then restart the humidifier.
- If it blinks 3 times, it means water shortage protection has occurred. Unplug the humidifier, add water into the water tank and then reconnect the power.
- If it blinks 4 times, it means the product can humidify the air but cannot control the humidification output. Please contact our customer service center.

Light ring goes off The color of water tank light

- Light ring will go off if there is no operation in 40 seconds. Any kind of operation can wake it up.

Water tank light

- The water tank light will change its color according to ambient humidity. In case of lower humidity the tank light will illuminate orange. In medium humidity the tank will illuminate purple. In high humidity the tank will illuminate blue.

Hard Water and White Dust

High mineral content in your water, also known as hard water, may cause a white mineral residue to accumulate on surfaces in the room near the humidifier. This mineral residue is commonly referred to as white dust. The higher the mineral content (hardness) of your water, the greater the potential that an ultrasonic humidifier may produce white dust. White dust is not a result of a defect or flaw in the humidifier. It is a result of the amount of minerals suspended in the water you are using

CLEANING YOUR HUMIDIFIER

To keep your humidifier running efficiently, clean it regularly. Weekly cleaning is recommended. All maintenance should be done in the kitchen or bathroom on a water resistant surface near a faucet.

In some areas, water quality is harder and richer in calcium and magnesium. After using the humidifier over time, calcium and magnesium ions will be deposited on the evaporating filter core, causing it to become scaly. This decreases humidifying efficiency. In addition, the active carbon filter attached at the air inlet will accumulate a large quantity of dust over time, which also decreases humidifying efficiency.

The cleaning and maintenance method for the humidifier is listed below:

1. Clean atomizer, water tank and water channel every week.
2. Replace water in water tank frequently.
3. If you don't plan to use the humidifier for a long time, please remove the power adapter, clean and dry all components, and then store the product in a cool place.

Cleaning method for atomizer:

1. Inject 0.34 fl. oz. (10 ml) acetum on the surface of the atomizer (add or reduce acetum according to the severity of scaling) and immerse the atomizer for 2-5 mins.
2. Gently scrub the surface of the atomizer with the cleaning brush until the scale is removed.
3. Wash the surface of the atomizer with a wet towel.

Cleaning method for water tank:

1. Remove all excess water from both the humidifier tank and the base.
2. Remove the mist outlet cover; at the bottom side push on the fastener to separate the cap. You can now clean it properly.
3. Disconnect the filter in the water tank by pressing the two tabs on the filter and pulling up on it.
4. Lift up the water tank and remove the water cover subassembly by turning it counterclockwise (figure 3).
5. Wipe disassembled components with a warm wet towel. To prevent damage to the humidifier, never rinse the humidifier base directly under water. After cleaning, reassemble the components in reverse order. Be sure that the water cover subassembly is installed in its correct position.
6. Add a small amount of vinegar of 5-10 drops of cleaning solution into the water tank. Then fill 1/4 of the water tank with water. Leave it for 5-10 min and then use a brush to clean the water tank.

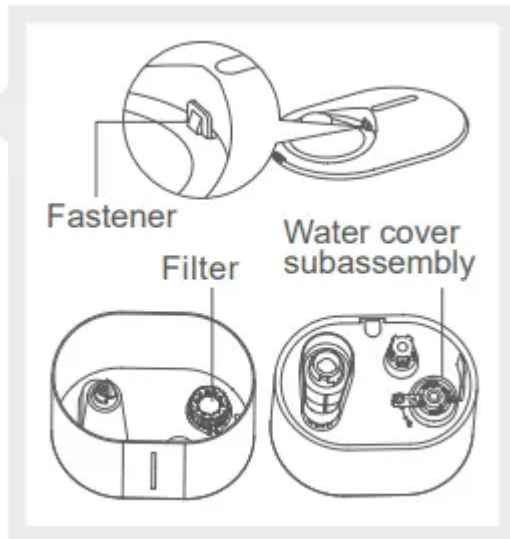

Figure 3

Cleaning method for water channel:

1. To clean the float plate, remove the plate by sliding it toward the back of the humidifier base. Reinstall it once it is cleaned.
2. If the water channel has any water deposits, wipe it with a soft cloth dampened with water.

Cleaning the fragrance box:

1. Clean the fragrance box with water and then leave it to dry.
2. Put the dry fragrance sponge back into the box then replace it with a fragrance box.

End of Season Cleaning and Storage

Follow the cleaning instructions when the humidifier will not be used for at least one week, or at the end of the season. At the end of the season, remove any accessories and discard. Allow the humidifier and all components to dry completely before storing.

DO NOT store humidifier with water inside the Reservoir or Water Tank. Pack unit safely and store in cool, dry location.

TROUBLESHOOTING

The humidifier does not operate.

- The power adapter is not well inserted.
 - Insert the power adapter in place.
- Low water level in the water channel.
 - Fill the water tank with water.

- The water tank is not installed correctly.
 - Install the water tank correctly.

There is a strange smell in the air.

- Water is dirty or hasn't been changed for a long time.
 - Clean the water tank and water channel. Use clean water for humidification.

Mist output is weak.

- The carbon filter at the air inlet is blocked by dust.
 - Clean the carbon filter at the air inlet.

There is an abnormal sound.

- The device is not placed on a flat surface.
 - Put it on a flat and solid place or on the floor and keep it stable.

There is water around the humidifier.

- The humidifier is used in a place that is not well ventilated or with high humidity. The mist does not evaporate and turns into water around the humidifier.
 - Turn down the humidification output (especially at night in sleep). Or you may use an air conditioner or a fan to speed up the air ventilation and improve the humidifying effect.

There is water in the water tank but the humidifier will not work.

- The humidifier is tilted, resulting in low water level in the water channel. The device has switched itself off due to low water level protection.
 - Place the humidifier on a flat and solid place and keep it stable.

Water overflows from the water channel or the water level is too high, resulting in small humidification output and dripping noise.

- The float plate, sealing part and water cover subassembly are not fixed in place; the water cover subassembly is blocked.
 - Fix the float plate, sealing part and water cover subassembly in place; remove the blockage

SPECIFICATIONS

Model	G-1011-4LW, G-1012-4LB
Working Voltage	24V DC
Rated Power Input	20W
Tank Capacity	4.0L
Humidifying Volume	4.5L/24h
Noise	$\leq 38\text{dB(A)}$
Product Dimension	230×162×295(mm)
Accessories	Power Adapter, Owner's Manual
Power Adapter: Rated Input 100-240V~ 50/60Hz 1.0A, Output 24V DC 1.5A	

Warning

This content is compiled from multiple sources and is provided for reference purposes only. It may not be complete or fully applicable to all situations. If you are unable to resolve your issue, please contact the product manufacturer or an authorized service provider for official support.