

Package Contents

Package Contents

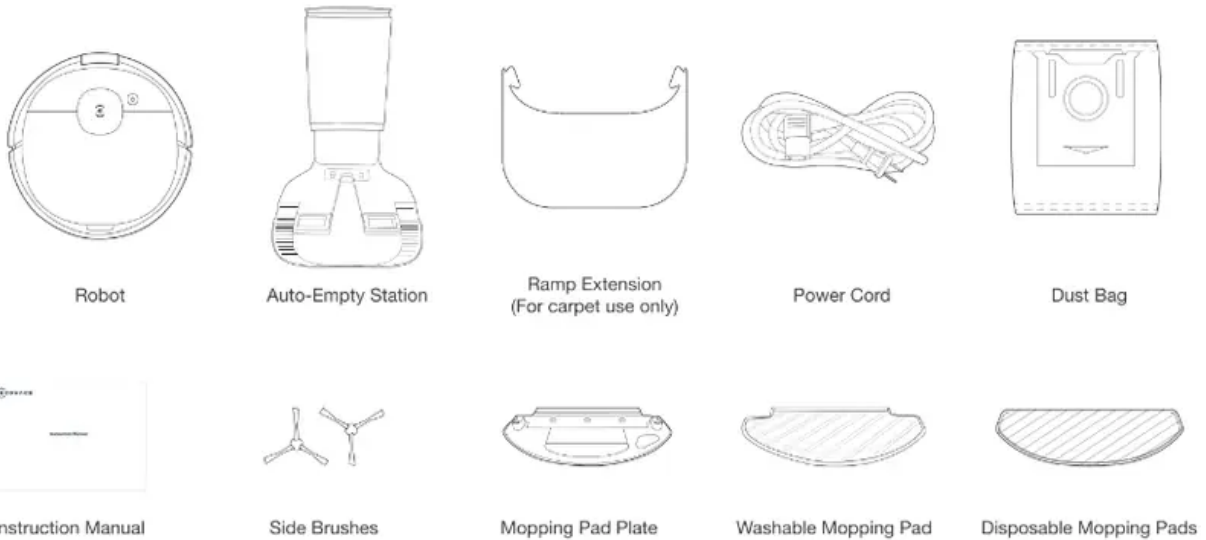

Note: Figures and illustrations are for reference only and may differ from the actual product appearance.

Product design and specifications are subject to changes without notice.

Product Diagram

Robot

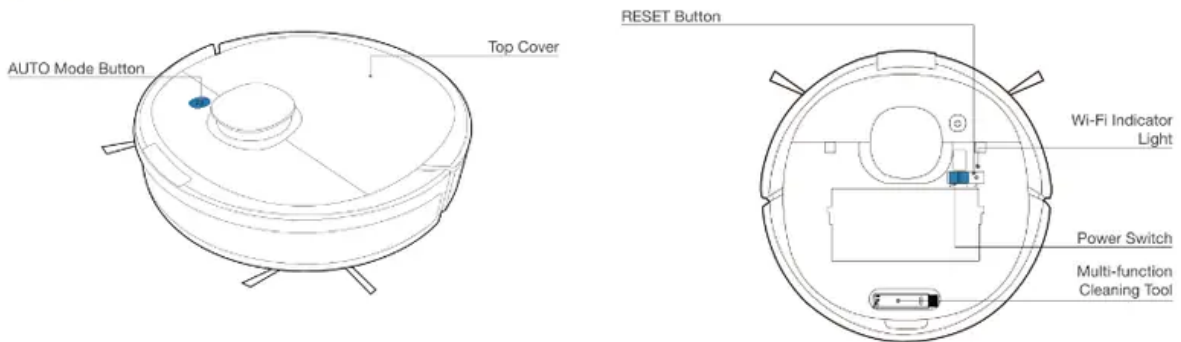

Auto-Empty Dust Bin

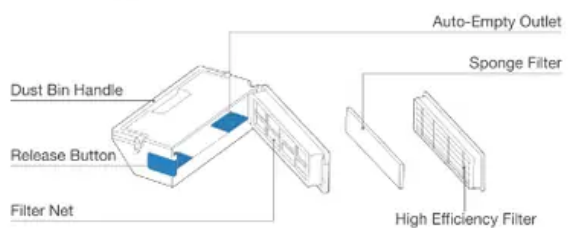

Bottom View

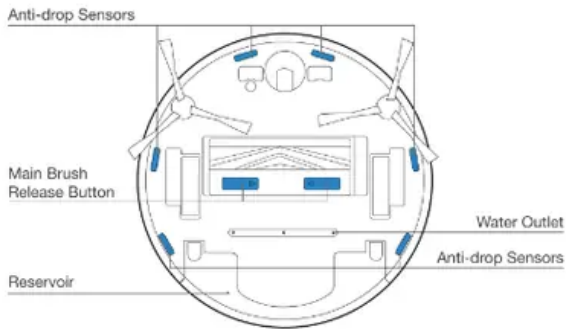
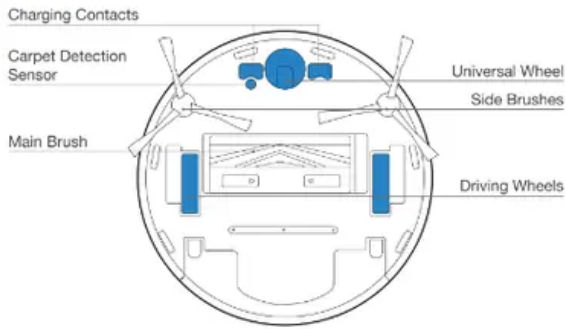

Auto-Empty Station

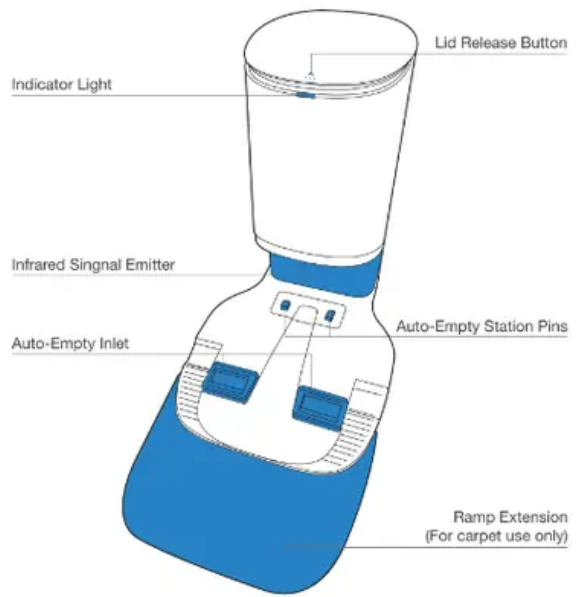

Auto-Empty Station (Back)

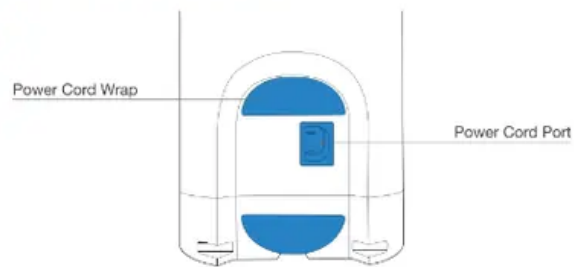

Auto-Empty Station (Top)

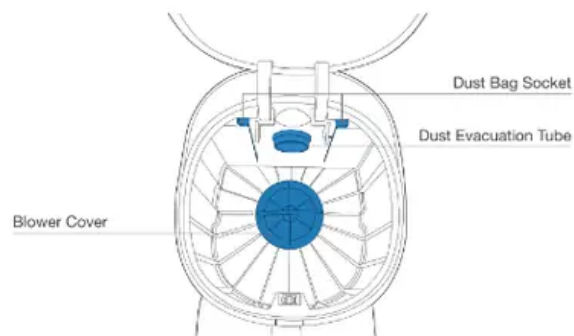

Auto-Empty Station (Bottom)

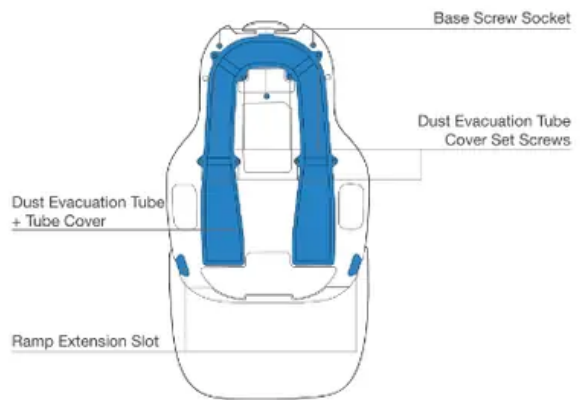

Power Cord

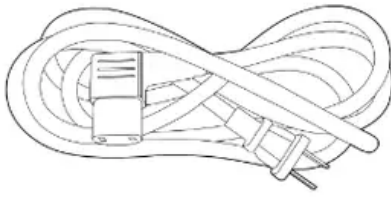

Reservoir

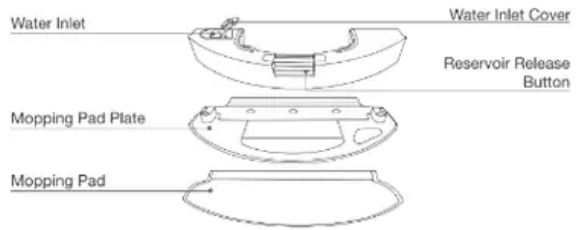

Operating and Programming

Notes Before Cleaning

Tidy up the area to be cleaned by putting furniture, such as chairs, in their proper place.



During the first use, make sure each room door is open to help DEEBOT fully explore your house.



It may be necessary to place a physical barrier at the edge of a drop to stop the unit from falling over the edge.

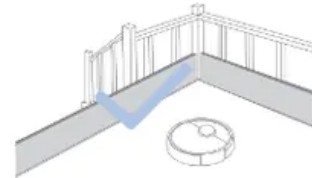

Put away objects including cables, cloths and slippers, etc. on the floor to improve the cleaning efficiency.



Before using the product on a rug with tasseled edges, please fold the rug edges under.



Please do not stand in narrow spaces, such as hallways, and make sure not to block the Detection Sensor.

Quick Start

1. Remove Protective Materials

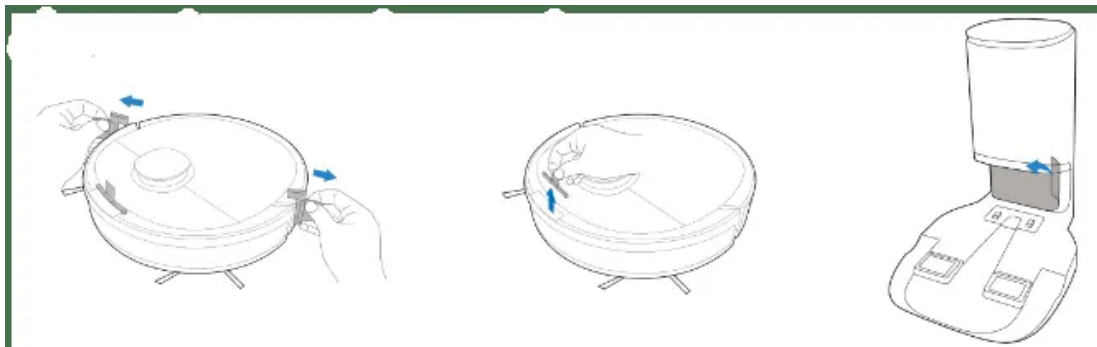

2. Assemble Auto-Empty Station

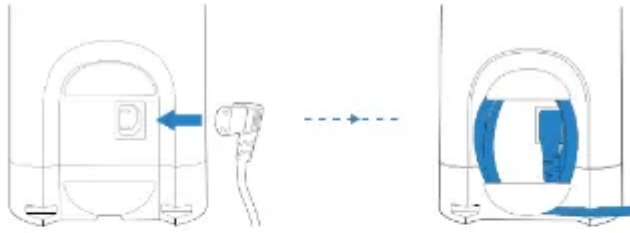

* For carpet use only

When Auto-Empty Station is placed on a carpet, install the Ramp Extension to the station for DEEBOT to return to charge successfully.

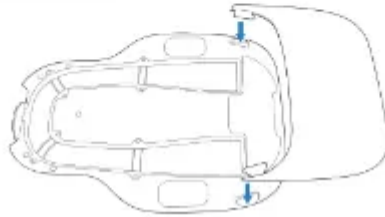

3.

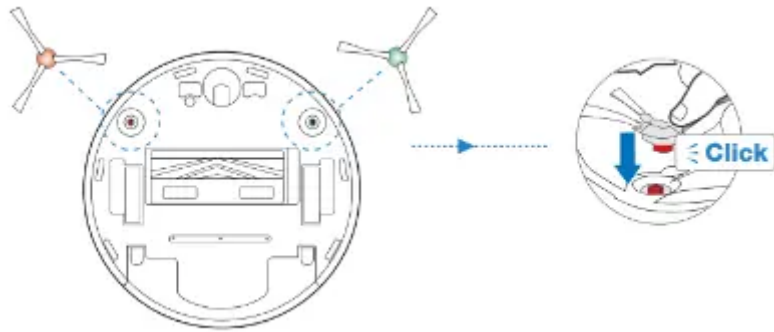

Install Side Brushes

Charging DEEBOT

1. Auto-Empty Station Placement

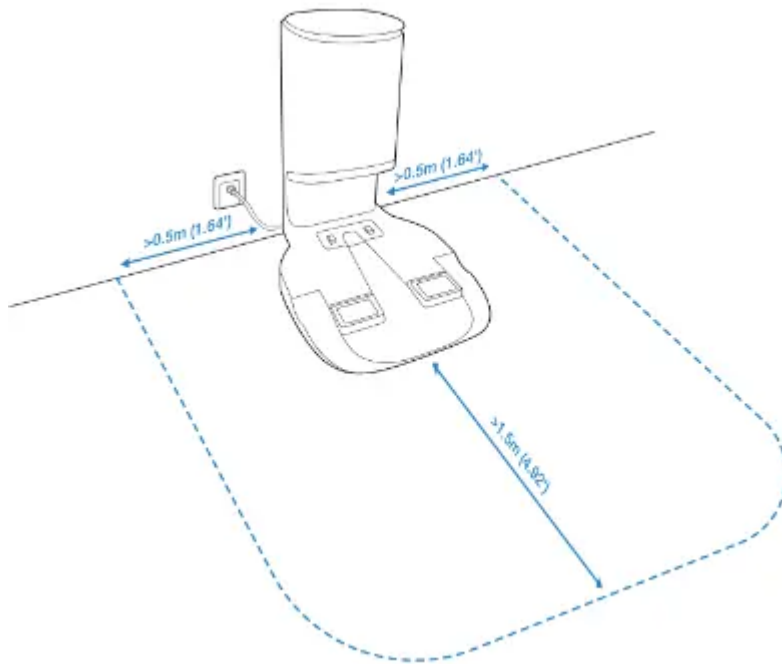

2.

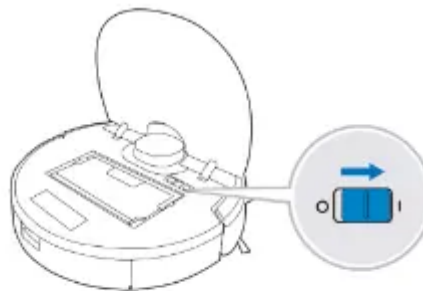



Note: **I** = ON, **O** = OFF.

Power ON  DEEBOT cannot be charged when being powered OFF.

3.

Empty remaining water from the Reservoir and remove the Reservoir and the mopping pad plate before charging DEEBOT.

 flashes when DEEBOT is charging.  goes out when DEEBOT is fully charged.

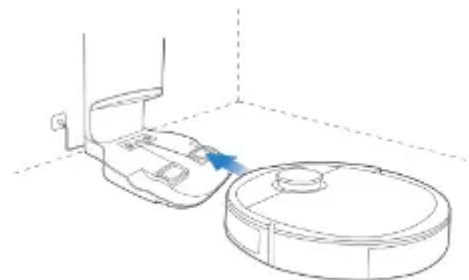
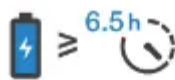

Charge DEEBOT

ECOVAS HOME App

To enjoy all available features, it is recommended to control your DEEBOT via the ECOVACS HOME app.

Before you start, make sure that:

- Your mobile phone is connected to a Wi-Fi network.
- The 2.4GHz band wireless signal is enabled on your router.
- The WiFi indicator light on DEEBOT is slowly flashing.

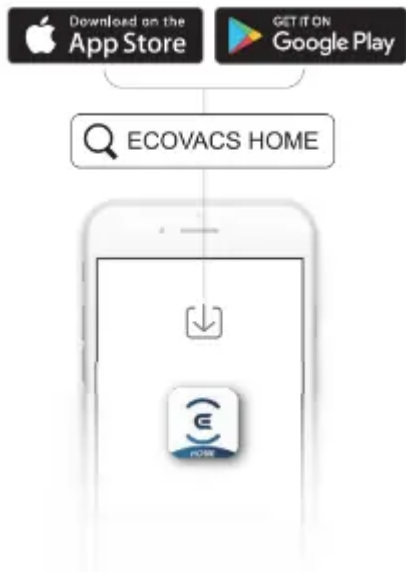

Wi-Fi Indicator Light

	Slowly flashing	Disconnected to Wi-Fi or waiting for Wi-Fi connection
	Rapidly flashing	Connecting to Wi-Fi
	Solid	Connected to Wi-Fi

Tips: If you have any problems during the Wi-Fi setup process, refer to the Troubleshooting > Wi-Fi Connection section in this manual.

Operating DEEBOT

During the first cleaning, please supervise DEEBOT and assist it should there be a problem.

1. Start

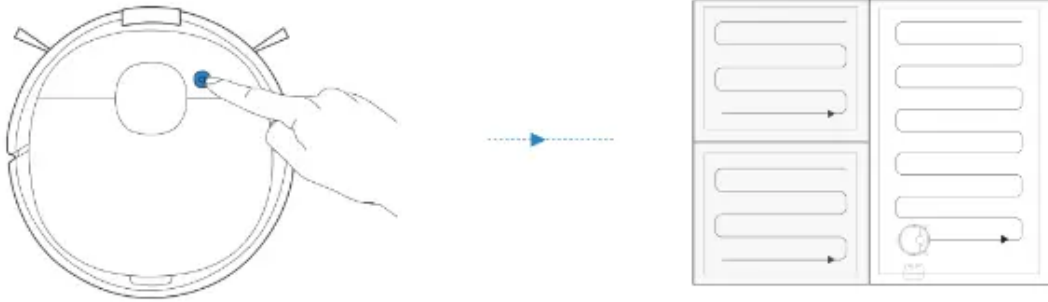

2.

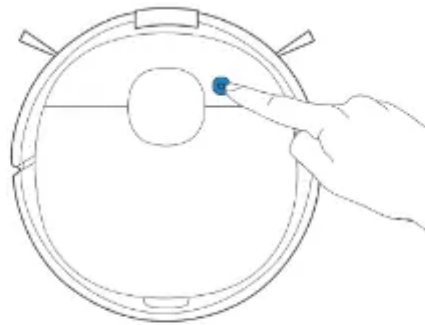

Note: The robot's Control Panel stops glowing after the robot is paused for a few minutes. Press the AUTO Mode Button on DEEBOT to wake up the robot.

Pause

3.

Pressing  for 3 seconds to send DEEBOT back to the Auto-Empty Station.

* When Auto-Empty Station is connected to power, DEEBOT automatically returns to the station to charge and empty the Dust Bin as it needs.

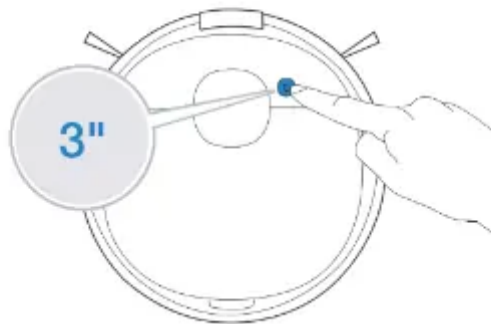

Return to Charge

OZMO Mopping System

1. **Note:** To prolong the servos of the reservoir it is recommended to use purified water or

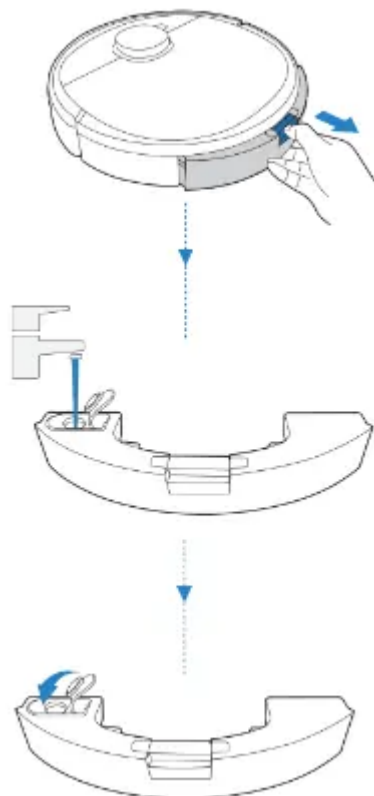

softened water for the OZMO mopping system.

2. **Note:** When DEEBOT is mopping, DEEBOT automatically detects the carpet and keeps away from it. If you need to clean the carpet, please uninstall the mopping pad plate first.

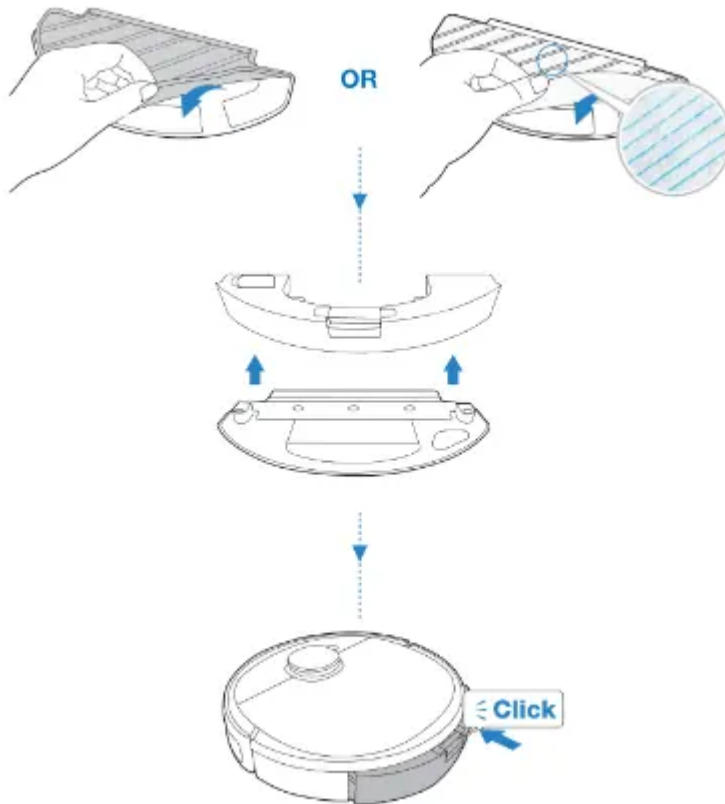

Maintenance

Regular Maintenance

To keep DEEBOT running at peak performance, perform maintenance tasks and replace parts with the following frequencies:

Robot Part	Maintenance Frequency	Replacement Frequency
Disposable Mopping Pad	/	Replace after each use
Washable Mopping Pad	After each use	Every 50 washes
Dust Bag	/	Dust Bags should be replaced when prompted by the Indicator Light/ECOVACS HOME App.
Reservoir/Mopping Pad Plate	After each use	/
Side Brush	Once every 2 weeks	Every 3-6 months
Main Brush	Once per week	Every 6-12 months
Sponge Filter/ High Efficiency Filter	Once per week	Every 3-6 months
Universal Wheel Anti-Drop Sensors Bumper Charging Contacts Auto-Empty Station Pins	Once per week	/

Before performing cleaning and maintenance tasks on DEEBOT, turn the robot OFF and unplug the Auto-Empty Station.

A multi-function Cleaning Tool is provided for easy maintenance. Handle with care. this cleaning tool has sharp edges.

Note: ECOVACS manufactures various replacement parts and fittings. Please contact Customer Service for more information on replacement parts.

OZMO Mopping System

1

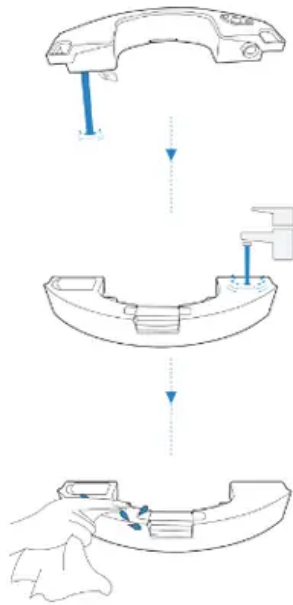

2 Washable Mopping Pad

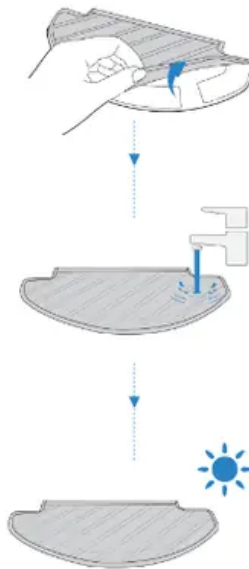

Disposable Mopping Pad

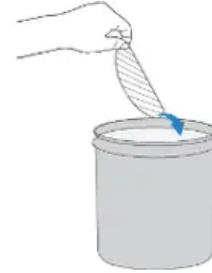

! Clean the water inlet filter on the bottom of the Reservoir if it is clogged.

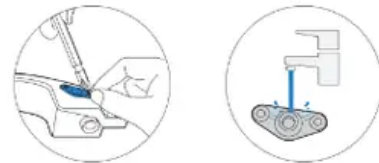

Auto-Empty Dust Bin and Filters

Dust Bin

1

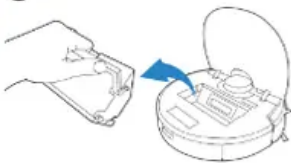

2

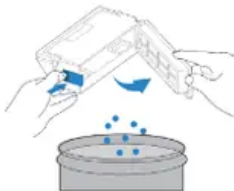

3

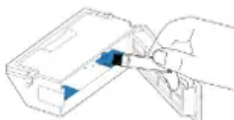

Filter

1



2

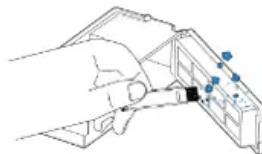

3



4



5

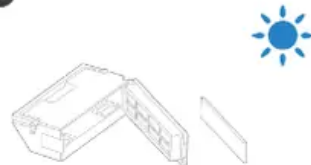

Main Brush and Side Brushes

Main Brush

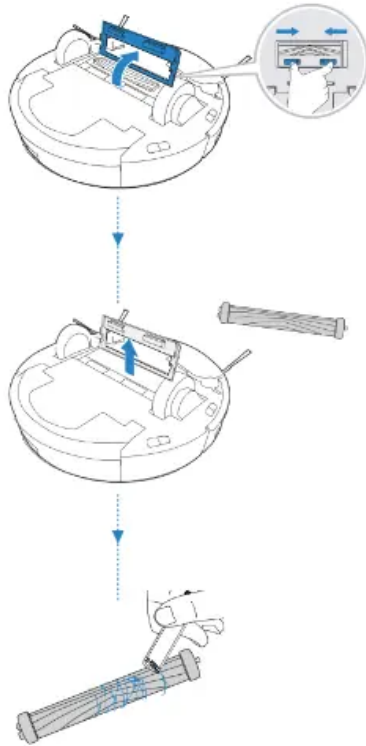

Side Brushes

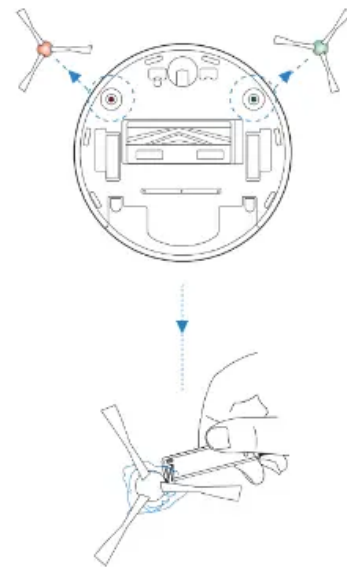

Auto-Empty Station

Note: Before performing cleaning and maintenance on Auto-Empty Station, unplug it first.

* For proper maintenance, wipe with a clean dry cloth, and avoid using any detergent or cleaning spray.

Auto-Empty Station Pins

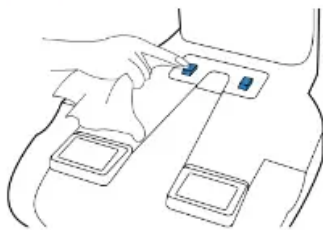

Infrared Signal Emitter



Dust Bag

1 Dispose the Dust Bag

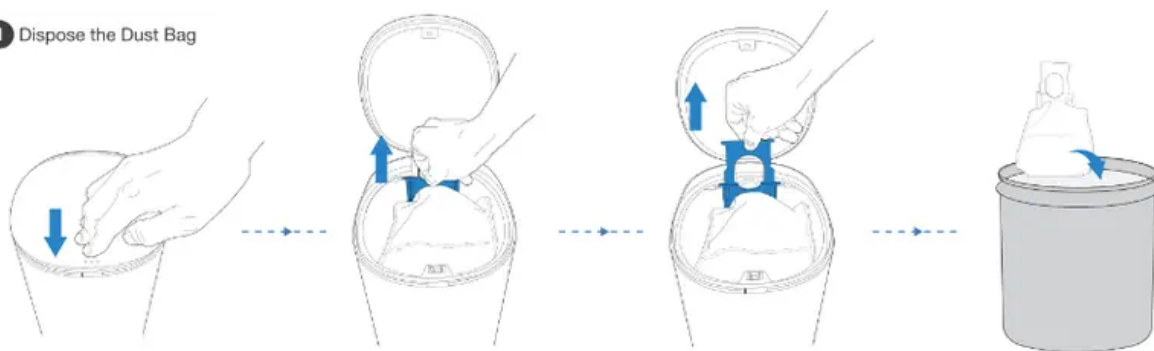

* The Dust Bag will be sealed by the handle so the dust will not leak.

2 Clean the Blower Cover

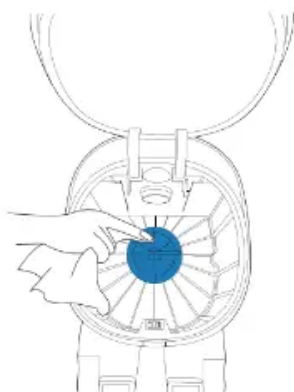

4 Close the Dust Container Lid



3 Install the Dust Bag

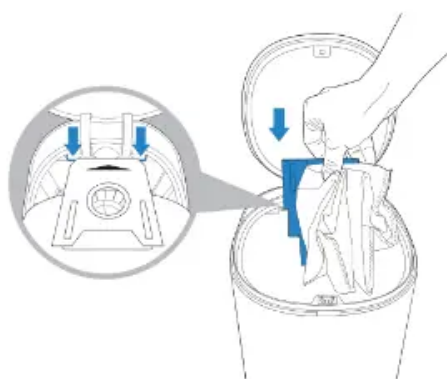

Dust Evacuation Tube

Unscrew the Dust Evacuation Tube Cover

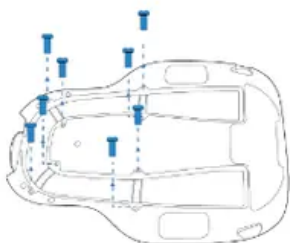

Uninstall the Dust Evacuation Tube Cover

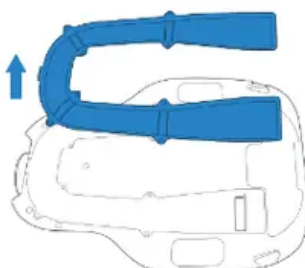

Clean the Dust Evacuation Tube



Other Components

Note: Before cleaning the robot's Charging Contacts and Auto-Empty Station Pins, turn the robot OFF and unplug the Auto-Empty Station.

1

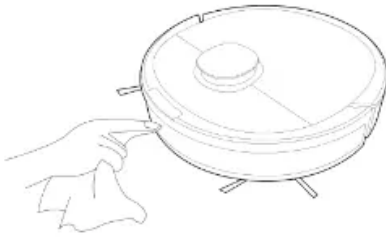

2

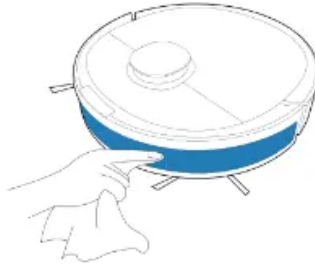

3

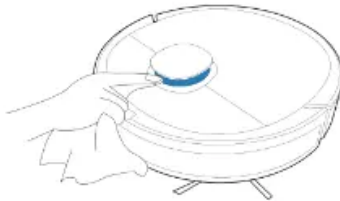

6

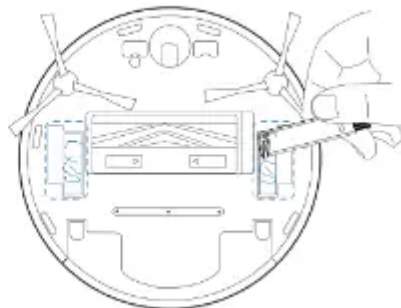

7

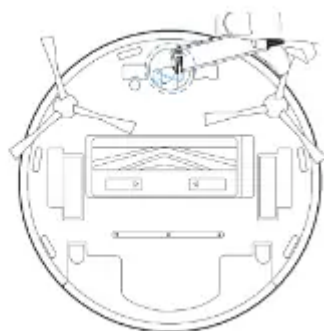

4

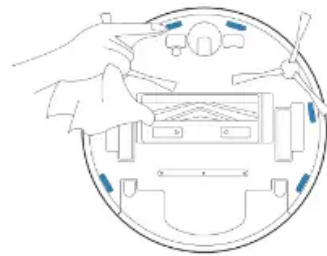

5

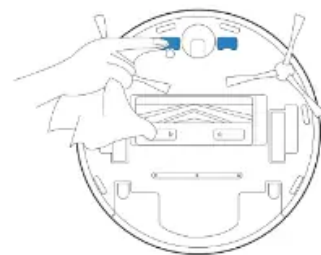

Storage

If DEEBOT will not be used for a while, fully charge DEEBOT and power OFF before storage. Charge DEEBOT every 1.5 months to prevent battery drain

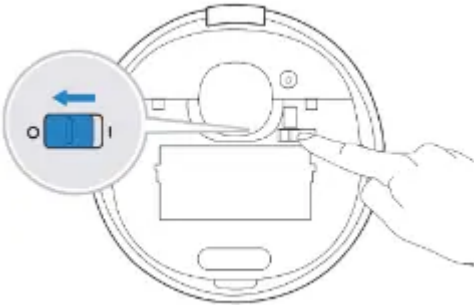

Note: When DEEBOT is not cleaning, it is recommended to keep DEEBOT powered ON and charging.

Troubleshooting

Troubleshooting

DEEBOT is not charging.

- DEEBOT is not switched ON.
 - Switch ON DEEBOT.
- DEEBOT has not connected to the Auto-Empty Station.
 - Be sure that the robot's Charging Contacts have connected to the Auto Empty Station Pins.
- The Power Cord is not connected to the Auto-Empty Station.
 - Make sure the Power Cord is firmly connected to the Auto-Empty Station.
- The Auto-Empty Station is not connected to the power supply.
 - Make sure the Auto-Empty Station is connected to the power supply.
- The battery is completely discharged.
 - Please contact Customer Care for help.

DEEBOT cannot return to the Auto-Empty Station.

- The Auto-Empty Station is not correctly placed.
 - Refer to section 3.2 to correctly place the Auto-Empty Station.
- The Auto-Empty Station is not correctly connected.
 - Make sure the Auto-Empty Station is correctly connected.

- The Auto-Empty Station is manually moved during the cleaning.
 - It is suggested not to move the Auto-Empty Station during the cleaning.
- DEEBOT is paused for more than 90 minutes.
 - It is suggested not to pause DEEBOT for more than 90 minutes.
- DEEBOT did not start cleaning from the Auto-Empty Station.
 - Make sure DEEBOT starts cleaning from the Auto-Empty Station.

DEEBOT gets stuck while working and stops.

- DEEBOT is tangled with something on the floor (electrical wires, curtains, carpet fringing, etc).
 - DEEBOT will try various ways to free itself. If it is unsuccessful, manually remove the obstacles and restart.
- DEEBOT might be stuck under furniture with an entrance of similar height.
 - Please set a physical barrier, or set a Virtual Boundary in the ECOVACS HOME App.

DEEBOT returns to the Auto-Empty Station before it has finished cleaning.

- Working time varies according to the floor surface, room complexity and the Cleaning Mode selected. When the battery gets low, DEEBOT automatically switches to Recharge Mode and returns to the Auto-Empty Station to recharge itself.
 - Turn on the Continuous Cleaning function in ECOVACS HOME App. DEEBOT will automatically resume the uncompleted cleaning cycle when Continuous Cleaning is enabled.
- DEEBOT is unable to reach certain areas blocked by furniture or barriers.
 - Tidy up the area to be cleaned by putting furniture and small objects in their proper place.
- The Auto-Empty Station is too distant from the center of the house.
 - Please place the Auto-Empty Station against the wall of a central room of the house.

DEEBOT does not clean automatically at the scheduled time.

- The time Scheduling function is canceled.
 - Program DEEBOT to clean at specific times using the ECOVACS HOME App.
- DEEBOT is switched OFF.
 - Switch ON DEEBOT.

- The robot's battery is low.
 - Keep DEEBOT switched ON and connected to the Auto-Empty Station to make sure it has a full battery to work at any time.

The water is not coming out of the Reservoir when DEEBOT is mopping.

- The water inlet filter on the bottom of the Reservoir is clogged.
 - Unscrew the water inlet on the bottom of the Reservoir and clean the filter as described in Section 4.1
- The Reservoir runs out of water.
 - Add water into the reservoir.
- The water outlets on the bottom of DEEBOT are clogged.
 - Check the water outlets on the bottom and clean them.

DEEBOT misses cleaning spots to be cleaned. or repeats cleaning the area cleaned.

- The cleaning cycle is interfered with by small objects or barriers on the floor.
 - Remove power cords and small objects from the floor to ensure cleaning efficiency. DEEBOT will automatically clean the area missed. please avoid moving DEEBOT manually or blocking the path during the cleaning cycle.
- DEEBOT is working on slippery polished floors.
 - Make sure the floor wax is dried before DEEBOT starts cleaning.
- DEEBOT is unable to reach certain areas blocked by furniture or barriers.
 - Tidy up the area to be cleaned by putting furniture and small objects in their proper place.
- The TrueMapping Distance Sensor is blocked.
 - Remove the objects that are blocking the TrueMapping Distance Sensor.

DEEBOT is making too much noise when cleaning.

- DEEBOT is tangled or blocked with debris.
 - Clean DEEBOT as described in section 4 Maintenance and restart. If the trouble persists. please contact Customer Care.

DEEBOT is not able to connect to the home Wi-Fi network.

- Incorrect home Wi-Fi username or password entered.
 - Enter the correct home Wi-Fi username and password.
- Incorrect App installed.
 - Please download and install ECOVACS HOME App.



- DEEBOT is not within range of your home WiFi signal.
 - Make sure DEEBOT is within range of your home Wi-Fi signal.
- The network setup started before DEEBOT was ready.
 - Turn ON Power Switch. Press the RESET Button DEEBOT is ready for network setup when its Wi-Fi Indicator light flashes slowly.
- DEEBOT does not support 5 GHz Wi-Fi.
 - Make sure the robot has been connected to a 2.4 GHz Wi-Fi network.
- Your smartphone's operating system needs to be updated.
 - Update your smartphone's operating system.

DEEBOT does not clean the whole area.

- The cleaning area is not tidy.
 - Remove small objects from the floor and tidy up the cleaning area before DEEBOT starts cleaning.

DEEBOT reservoir drops out of place during use.

- The reservoir is not correctly installed
 - Make sure the DEEBOT reservoir clicks into place when installing.

DEEBOT Side Brushes drop out of place during use.

- The Side Brushes are not correctly installed.
 - Make sure the Side Brushes click into place when installing.

DEEBOT does not start auto-emptying after returning to the Auto-Empty Station.

- The Dust Container Lid is not closed.
 - Close the Dust Container Lid.
- The Dust Bag is not installed in the Auto-Empty Station.
 - Install the Dust Bag and close the Dust Container Lid.
- Manually moving DEEBOT to the Auto-Empty Station will not trigger Auto-Emptying.
 - In order to make sure DEEBOT starts auto-emptying successfully. avoid picking up and moving the Auto-Empty Station during the cleaning.
- DEEBOT returns to the Auto-Emptying Station running Video Manager in the App.
 - This is normal.



- Do Not Disturb mode is enabled in ECOVACS HOME App.
 - This is normal. Disable Do Not Disturb mode in the App. or start auto-emptying manually.
- The Dust Bag is full.
 - Replace the Dust Bag and close the Dust Container Lid.
- If the possible causes are excluded. it might be a component malfunction.
 - Please contact customer service.

DEEBOT fails to auto-empty the Dust Bin.

- The Auto-Empty Dust Bin is not installed.
 - Please install the Auto-Empty Dust Bin with two Auto-Empty Outlets on the bottom.
- The Dust Bag is full.
 - Replace the Dust Bag and close the Dust Container Lid.
- The Auto-Empty Outlets on the Auto-Empty Dust Bin are stuck by debris.
 - Uninstall the Auto-Empty Dust Bin and clean the debris. on the Auto-Empty Outlets.
- The dust Evacuation Tube is blocked.
 - Clean the Dust Evacuation Tube.

There is debris in the Dust Container.

- Fine particles are absorbed inside the Dust Container through the Dust Bag.
 - Clean the Dust Container Lid and inner wall.
- The Dust Bag is damaged.
 - Check the Dust Bag and replace it.

DEEBOT leaks dust or debris while cleaning.

- The Auto-Empty Outlets are stuck by debris.
 - Uninstall the Auto-Empty Dust Bin and clear the debris.

The Base is dirty.

- Main Brush has debris on it and requires cleaning.
 - Clean the Main Brush.

Wi-Fi Connection

Before Wi-Fi setup, make sure DEEBOT, mobile phone, and Wi-Fi networks meet the following requirements.

DEEBOT and Mobile Phone Requirements

- DEEBOT is fully charged and the power switch of DEEBOT is turned on.
- The Wi-Fi status light slowly flashes.
- Turn off the mobile phone's cellular data (you can turn it back on after setup).

Wi-Fi Network Requirements

- You are using a 2.4GHz or 2.4/5 GHz mixed network.
- Your router supports 802.11b/g/n and IPv4 protocol.
- Do not use a VPN (Virtual Private Network) or Proxy Server.
- Do not use a hidden network.
- WPA and WPA2 using TKIP, PSK, AES/CCMP encryption.
- WEP EAP (Enterprise Authentication Protocol) is not supported.
- Use Wi-Fi channels 1-11 in North America and channels 1-13 outside North America (refer to local regulatory agency).
- If you are using a network extender/repeater, the network name (SSID) and password are the same as your primary network.

Technical Specifications

Model	DLN26			
Rated Input	20V === 1A			
Docking Station Model	CH1918		CH1822 (Sold Separately)	
Rated Input	120V~ 50-60Hz 8A	Rated Input	100-240V~ 50-60Hz 0.5A	
Rated Output (Charging)	20V === 1A	Rated Output	20V === 1A	

The output power of the Wi-Fi module is less than 100mW.

Note: Technical and design specifications may be changed for continuous product improvement.

Warning

This content is compiled from multiple sources and is provided for reference purposes only. It may not be complete or fully applicable to all situations. If you are unable to resolve your issue, please contact the product manufacturer or an authorized service provider for official support.

