

Components

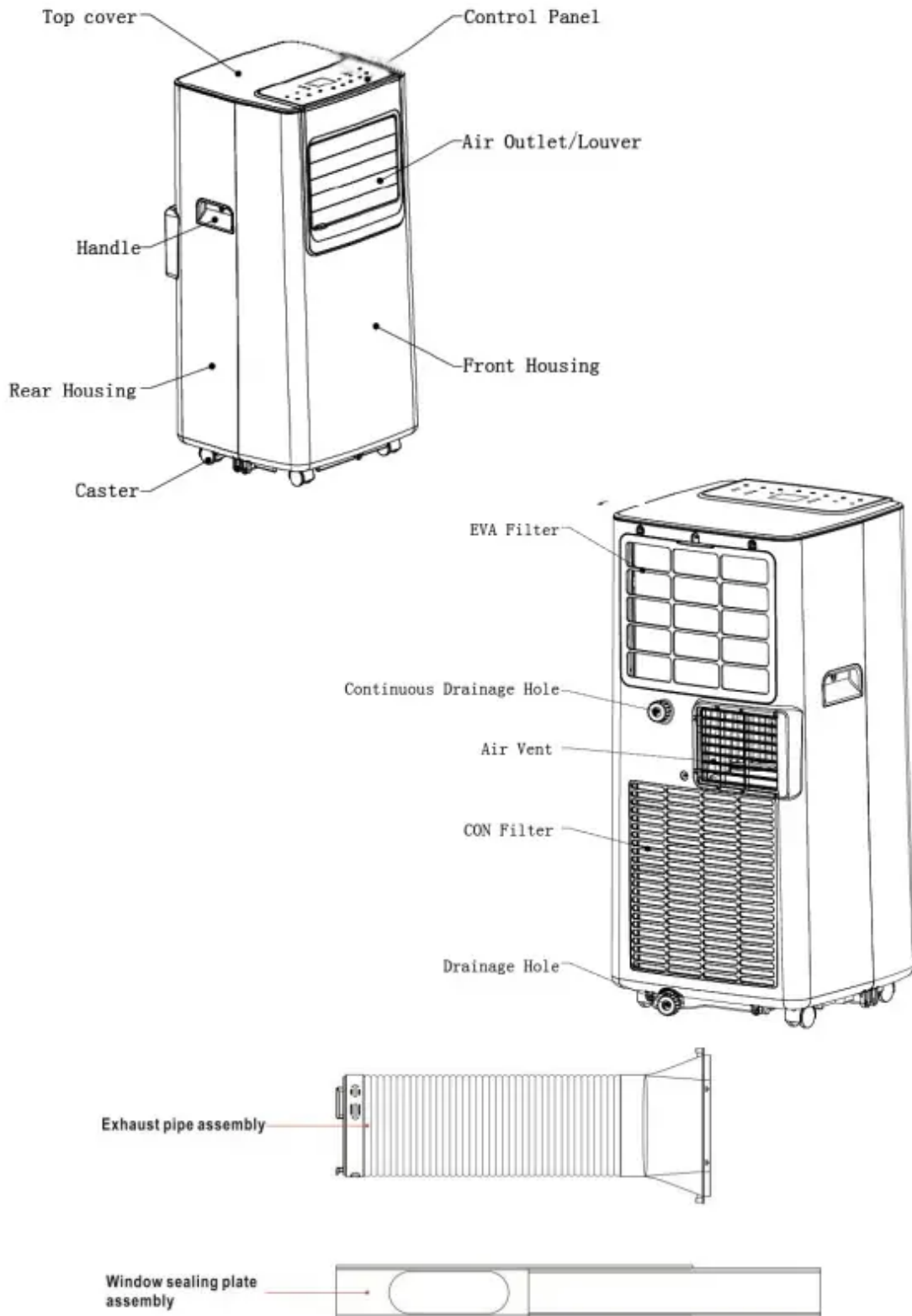

Installation

NOTE: The air-conditioner should be installed on a flat surface with at least 300mm clearance all around, including from the top of the unit as it is important that the air outlet is not blocked. Power supply must be nearby.

WARNING: THIS APPLIANCE MUST BE INSTALLED, OPERATED AND STORED IN A ROOM WITH A FLOOR AREA LARGER THAN 7m²

Do not install and use the appliance in the bathroom or other humid environments.

Install the heat pipe assembly (as shown in Figure 1).

Screw the heat pipe assembly (exhaust fitting end) into the exhaust port on the rear panel (counterclockwise).

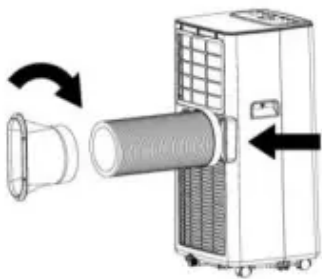

Figure 1

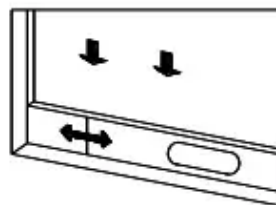

Figure 2

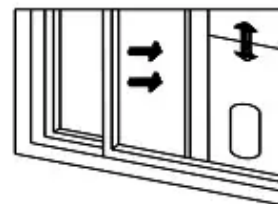

Figure 3

Install the window sealing plate assembly

Half open the window, and mount the window sealing plate assembly to the window (as shown in Figure 2 and Figure 3); the assembly can be placed in horizontal and vertical direction. Pull various components of the window sealing plate assembly open, adjust their opening distance to bring both ends of the assembly into contact with the window frame, and fix various components of the assembly.

You may require a glazier to cut a hole in your window pane to fit the exhaust hose fixing clip.

Important Notice: The length of the exhaust hose shall be 280~1,500mm, and this length is based on the specifications of the air conditioner. Do not use extension tubes or replace it with other different hoses, or this may cause a malfunction. Exhaust must be unobstructed; otherwise it may cause overheating.

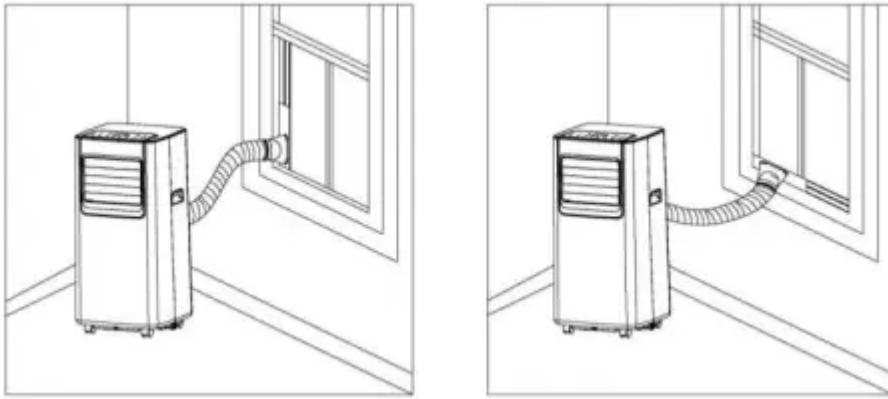

Control Panel and Remote Control

- This Portable Air Conditioner is designed to be operated in cooling mode, fan mode or dehumidifying mode. When switching between these functions keep an interval of at least 3 minutes between each ON/OFF.
- Allow the refrigerant to settle by leaving the appliance to stand for two hours after transport or after the unit has been on its side.
- Ensure the unit is in the OFF setting before connecting it to the mains supply. When the appliance is powered on for the first time, it will beep, and then the unit will be in standby.

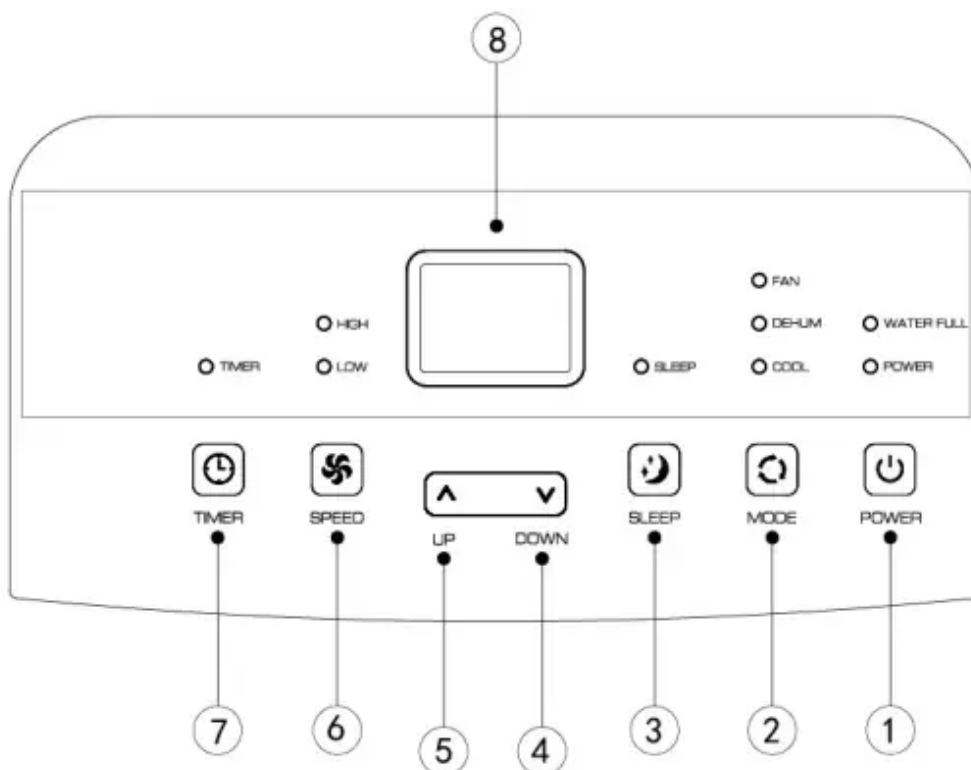

1. Power Button

- Press the button to turn the unit ON and OFF.

2. Mode Button

- Press the button to switch between Cooling → Dehumidification → Fan modes.

3. Sleep Button

- In the Cooling Mode, Press the UP and Fan buttons together to turn on the sleep mode. The unit will work in Energy-Saving and quiet mode.

Note: You cannot not use sleep mode in the Dehumidifying or Fan modes.

4 & 5. Temperature Setting Buttons

- To set the desired temperature, press UP or DOWN button. The range is 16-31oC.
- This function is not available in fan or dehumidification mode.
- Simultaneously press both buttons to switch between Celsius (°C) and Fahrenheit (°F)

6. Fan Speed Button

- In cooling or fan mode press the button to select between high or low fan speed operation. In dehumidification mode the fan will automatically be set to low speed operation. This cannot be changed.

7. Timer Setting Button

- The timer can be set to turn the unit ON or OFF from 1-24 hours.
- To set the timer to turn the unit OFF, press the TIMER button while the unit is operating and set the desired number of hours before the unit turns off.
- To set the timer to turn the unit ON, press the TIMER button while the unit is in standby and set the desired number of hours before the unit turns on.

Remote Control

The remote control has the same functions as the unit control panel.

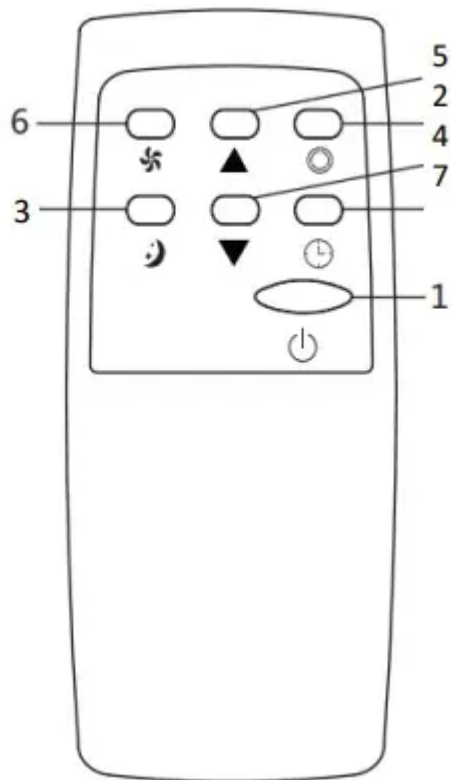

Care and Maintenance

Manual Drainage

- The unit will stop once it has filled with water. Turn off the unit and unplug the power plug.
- Move the unit carefully, so as not to spill the water in the water pan at the bottom of the body.
- Find a place to drain the water or place a bucket below the water outlet on the back of the unit.
- Unscrew the drainage cover and unplug the water plug, the water will automatically flow into the water container. During drainage, the body can be tilted slightly backwards.
- When the water is discharged, replace the water plug, and retighten the drainage cover.
- Allow unit to sit for at least 5 minutes before turning back on.
- Do not use this Air Conditioner with a programmer, remote-control system, separate timer or any other device that switches the Air Conditioner on automatically.

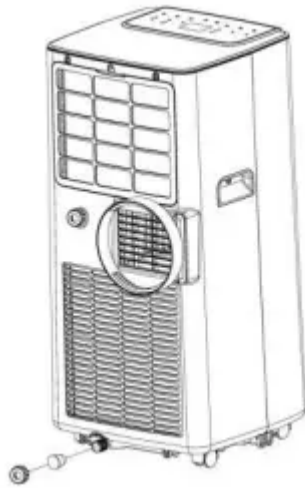

CARE AND CLEANING

Clean the upper filter screen frame

- Unscrew screw fixing the EVA filter screen and the rear housing to remove the EVA filter screen (as shown in the below figure)
- Put the EVA filter screen into warm water with neutral detergent (about 40 °C / 104 °F) and dry it in the shade after rinsing clean.

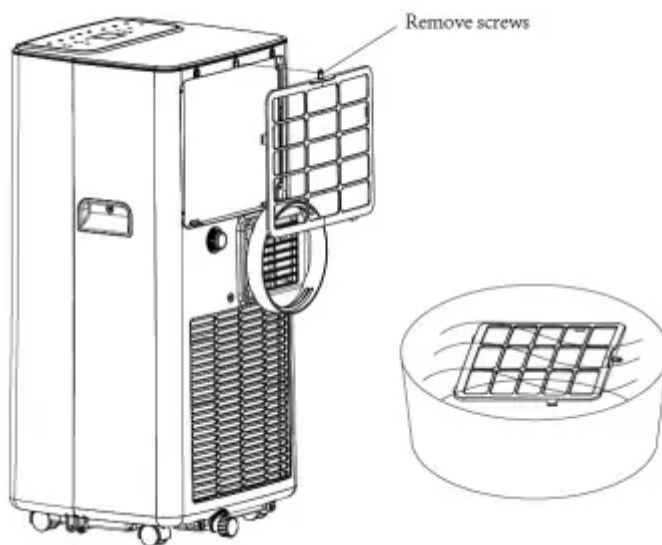

NEVER USE UNIT WITHOUT THE AIR FILTER.

- The exterior may be cleaned with a soft, dry cloth. If the device is extremely dirty wipe the device with a slightly damp (not wet) cloth. Never spray the device with water. DO NOT immerse the unit in water and never allow water to enter the motor housing. DO NOT use harsh chemicals to clean the unit.
- Do not attempt to dismantle the Air Conditioner. There are no user serviceable parts. For service or repair, contact an authorised electrical service technician.

STORAGE

- To store the unit, remove the plug from the socket. Remove the rubber plug from the drainage hole at the bottom of unit, and connect a drain hose to the lower fixing clip. All the water in the water tank will drain out. Allow the Container and the Air Conditioner to dry completely. Clean the air filter. Refit the rubber plug. Store the device in a dust-free location, preferably covered with a sheet of plastic.

Troubleshooting

The air conditioner does not work.

- There is no electricity.
 - Turn it on after connecting it to a socket with electricity.
- The water-full indicator will flash.
 - Discharge the water inside.
- The ambient temperature is too low or too high
 - Recommend to use the machine in at the temperature of 7-35 °C (44-95 °F).

The air conditioner does not work.

- In cooling mode, the room temperature is lower than the set temperature; in heating mode, the room temperature is higher than the set temperature.
 - Change the set temperature.
- In dehumidification mode, the ambient temperature is low.
 - The machine is placed in a room with an ambient temperature of greater than 17 °C (62 °F).

The cooling or heating effect is not good

- There is direct sunlight. Pull the Curtain.
 - Pull the Curtain.
- Doors or windows are open; there are a lot of people; or in cooling mode, there are other sources of heat.
 - Close doors and windows.
- The filter screen is dirty.
 - Clean or replace the filter screen.
- The air inlet or outlet is blocked.
 - Clear obstructions.

Loud Noise

- The air conditioner is not placed on a flat surface.
 - Put the air conditioner on a flat and hard place (to reduce noise).

Compressor does not work.

- Frost production starts.
 - Wait for 3 minutes until the temperature is lowered, and then restart the machine.
- Overheat protection starts.
 - Wait for 3 minutes until the temperature is lowered, and then restart the machine.

The remote control does not work.

- The distance between the machine and the remote control is too far.
 - Move the remote control closer to the air conditioner, and make sure that the remote control directly faces to the direction of the remote control receiver.
- The remote control is not aligned with the direction of the remote control receiver.
 - Move the remote control closer to the air conditioner, and make sure that the remote control directly faces to the direction of the remote control receiver.
- Batteries are dead.
 - Replace batteries.

Displays 'E1'.

- The room temperature sensor is abnormal.
 - Check the room temperature sensor and related circuitry.

Displays 'E2'

- The pipe temperature sensor is abnormal.
 - Check the pipe temperature sensor and related circuitry.

General Care and Safety Guide

Thank you for choosing this Goldair product. This Goldair appliance has been designed and manufactured to high standards of engineering and with proper use and care, as described in this leaflet, will give you years of useful service. Please read these instructions carefully and keep them for future reference.

1. This appliance is not intended for use by persons (including children) with reduced physical, sensory or mental capabilities, or lack of experience and knowledge, unless

they have been given supervision or instruction concerning use of the appliance by a person responsible for their safety.

2. Children should be supervised to ensure that they do not play with the appliance.
3. If the supply cord is damaged, it must be replaced by the manufacturer, its service agent or similarly qualified persons in order to avoid a hazard.
4. Ensure that the fan is switched off from the supply mains before removing the guard.
5. Use only the voltage specified on the rating plate of the appliance.
6. Keep all objects at least 1 Metre from the front, sides and rear of the appliance
7. This appliance is intended for household use only and not for commercial or industrial use.
8. Use this appliance only as described in this manual. Any other use is not recommended by the manufacturer and may cause fire, electric shock or injury.
9. The common cause of overheating is deposits of dust or fluff in the appliance. Ensure these deposits are removed regularly by unplugging the appliance and vacuum cleaning the air vents and grills.
10. Always unplug appliance when not in use.
11. When the appliance has been unpacked, check it for transport damage and ensure all parts have been delivered. If parts are missing or the appliance has been damaged, contact the Goldair Customer Services Team.
12. If your appliance does not work, or is not working properly, contact the place of purchase. Repair work on the appliance by unqualified persons can cause serious risk to the user.
13. Ensure hands are dry before handling the plug or the main unit.
14. Carry out regular checks of the supply cord to ensure no damage is evident.
15. Ensure that the cord is fully extended (not coiled) while in use.
16. Avoid contact with the moving parts. Keep hands, hair, clothing, away from blade of the fan during operation to reduce the risk of injury to person and/or damage to the unit.
17. Switch off and use handles provided when moving.
18. It is recommended that this fan is plugged directly into the wall socket.
19. A correctly specified, undamaged extension cord may be used with this fan provided it is used in a safe manner.
20. Never place appliance close to radiant heat source.
21. Never operate in areas where petrol, paint or other flammable liquids are used or stored.
22. Never use the appliance to dry clothes.
23. Never insert or allow foreign objects to enter any ventilation or exhaust opening, as this may cause an electric shock, fire or damage to the appliance.

24. Never use abrasive cleaning products on this appliance. Clean with a damp cloth (not wet) rinsed in hot soapy water only. Always remove plug from the mains supply before cleaning.
25. Never connect the appliance to mains supply until completely assembled and adjusted.
26. Never remove plug from power socket until the appliance has been switched off.
27. Never remove plug from power socket by pulling cord – always grip plug.
28. Never twist, kink or wrap the cord around the appliance, as this may cause the insulation to weaken and split. Always ensure that all cord has been removed from any cord storage area and is unrolled before use.
29. Never use this appliance in the immediate surrounds of a bath, a shower, or a swimming pool or other liquids. The appliance must not be immersed in any liquids.
30. Due to the risk of injury, never use this appliance for any purpose other than its intended use. This appliance is intended for use in household and similar applications such as staff kitchen areas in shops, offices and other working environments; farm houses, by clients in hotels, motels, bed and breakfast type environments and other residential type environments
31. Never use this appliance outdoors.
32. Never operate the appliance with a damaged cord or plug, after it malfunctions, or if it has been damaged in any manner. Have the appliance checked and repaired by a qualified electrician if repair is necessary.
33. Never place the unit in wardrobes or other enclosed spaces as this may cause fire hazards.

Warning

This content is compiled from multiple sources and is provided for reference purposes only. It may not be complete or fully applicable to all situations. If you are unable to resolve your issue, please contact the product manufacturer or an authorized service provider for official support.