

Installation Instruction 433MHz Receiver Logic Board Antenna Extension Kit

WARNING: To prevent possible SERIOUS INJURY or DEATH from electrocution, disconnect power to opener BEFORE proceeding.

The Antenna Extension Kit model 41A3504-1 was designed to work with the 433MHz Receiver Logic Boards

This kit contains an antenna, coaxial cable, adapter and an antenna bracket.

After replacing your receiver panel, follow the instructions below to access the logic board connector and install the antenna extension.

Installation

1. Screw the threaded end of the adapter into either end of the coaxial cable.
2. Plug the smooth end of the adapter into the connector on the logic board. The connector is located under the "Learn" button on the rear panel of the opener.
3. The antenna bracket can be mounted inside on the header, or for maximum range, outside the structure. Route the coaxial cable accordingly.
4. Attach the antenna and coaxial cable to the antenna bracket as illustrated.
5. Mount antenna bracket so the antenna is unobstructed and away from any metal or steel.

NOTE: Do NOT modify or remove the existing antenna.

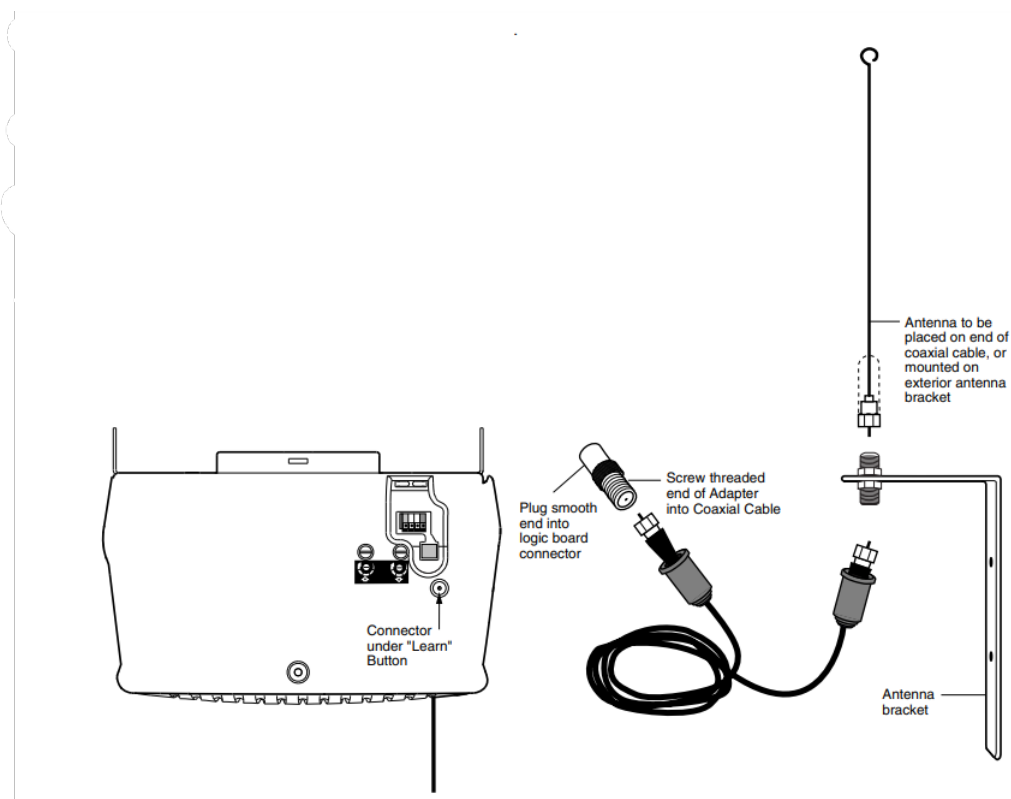

Warning

This content is compiled from multiple sources and is provided for reference purposes only. It may not be complete or fully applicable to all situations. If you are unable to resolve your issue, please contact the product manufacturer or an authorized service provider for official support.

Document generated by [ManualsFile](#)