

User manual Headphone

JBL Tour One Noise Cancelling Wireless Over Ear Headphone featured

What's In the Box



App



Power On & Connect

POWER ON & CONNECT

L R

OTHERS ANDROID™ 6.0+

Settings Bluetooth

Bluetooth ON

DEVICES

JBL TOUR ONE Connected

Now Discoverable

Fast Pair now JBL TOUR ONE Tap to pair. Device will be tied to Your Google Account

Fast Pair

* TO ENTER PAIRING MODE AGAIN, SLIDE TO THE BOTTOM AND HOLD FOR 2 SECONDS. CHOOSE "JBL TOUR ONE" TO CONNECT

Button Command

BUTTON COMMAND

- TAP/PRESS x 1
- TAP/PRESS x 2
- TAP x 3
- HOLD (2s)

ANC* AMBIENT AWARE* OFF

TALKTHRU*

VOICE ASSISTANTS* (Ok Google, alexa built-in)

L R

BIXBY/SIRI®/OTHERS

* ENABLE ADVANCE CONTROLS BY CONNECTING YOUR JBL TOUR ONE TO JBL HEADPHONES APP



Auto-play/pause

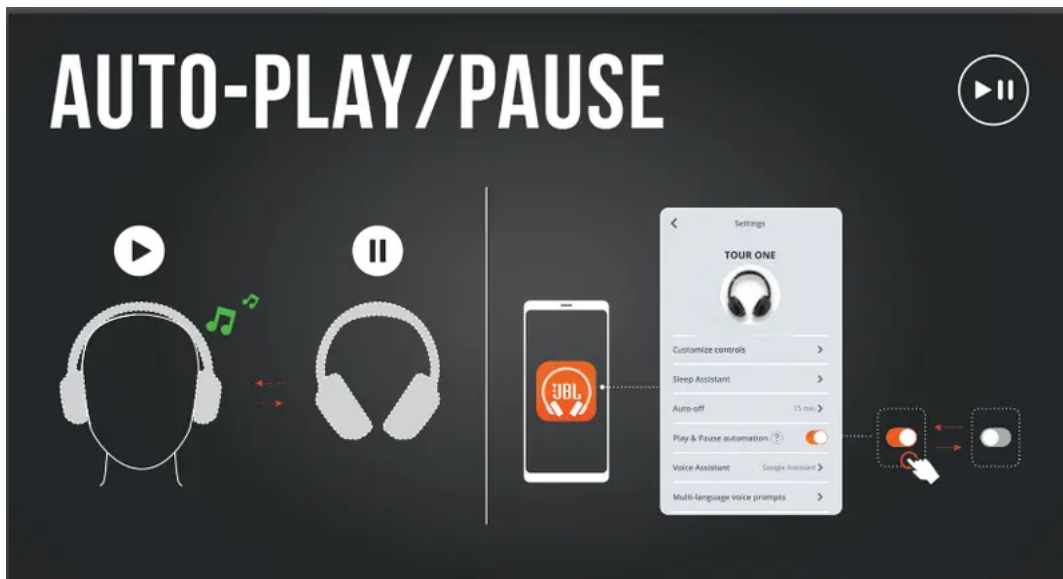

Multi-point connection

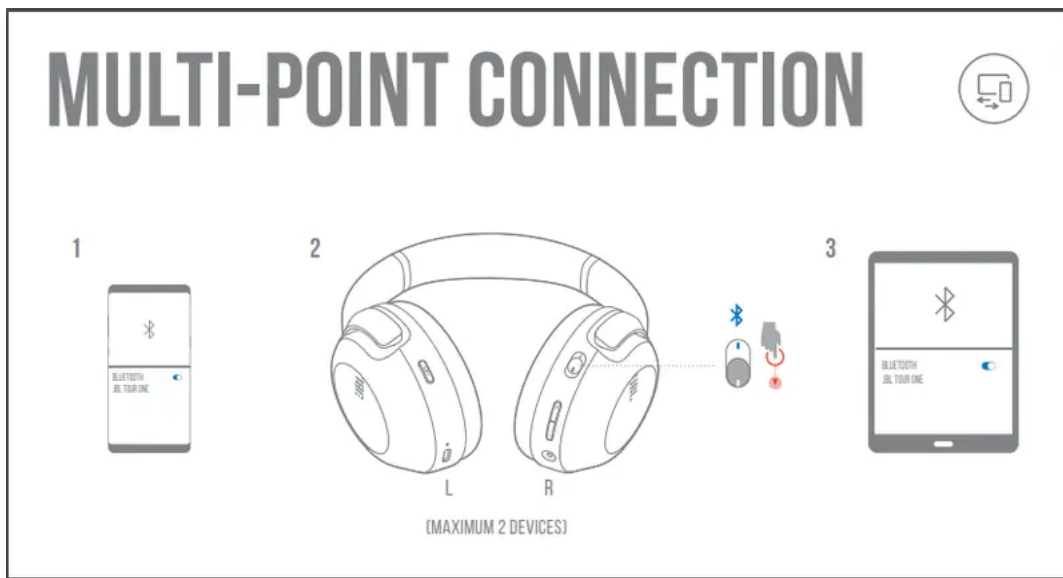

Wired listening

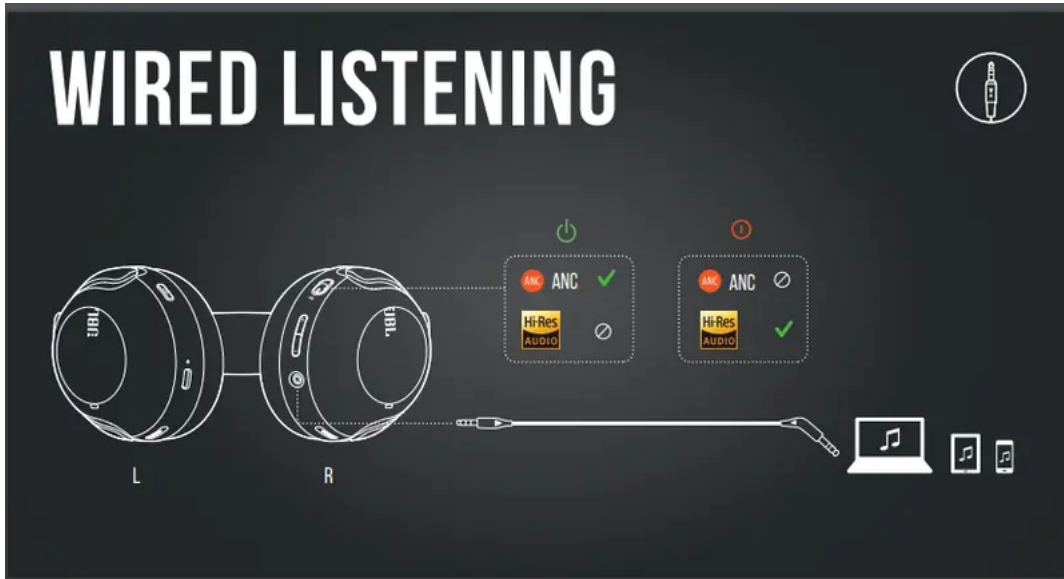

SILENT NOW

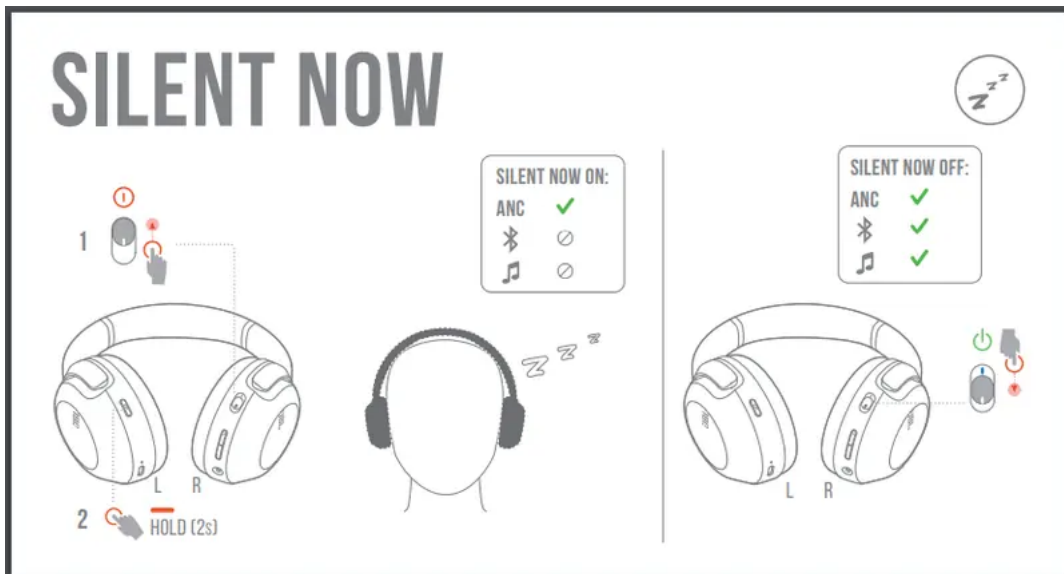

DO MORE WITH THE APP

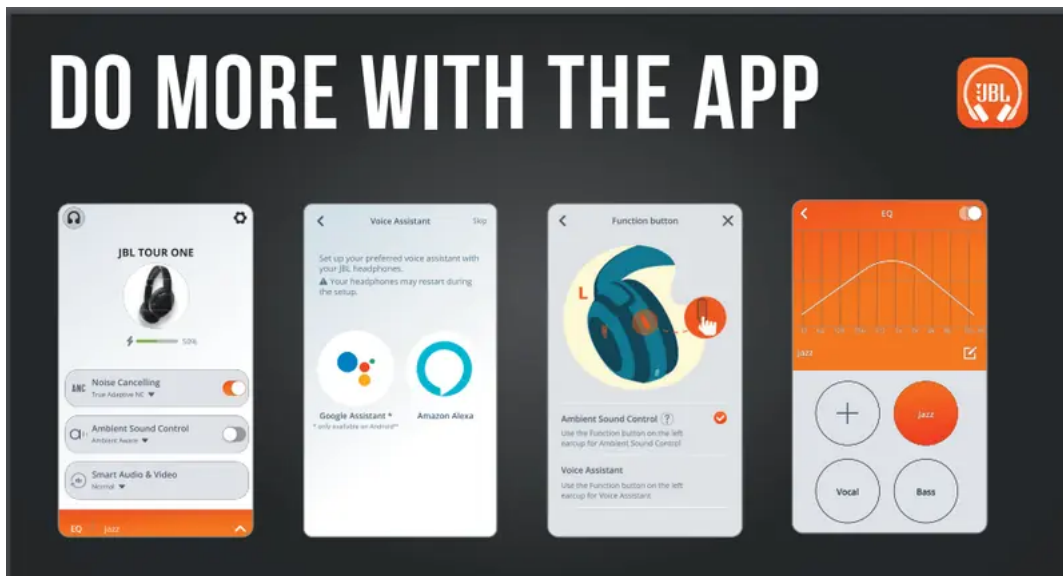

HANDS-FREE VOICE CONTROL

Get more done on the go. Say "Ok Google" to get started.

"Play my Workout playlist"

"Turn up the volume"

"Send a message"

"What's my schedule today?"

"Set an alarm for 7 AM"



Note: Only available on Android™

HANDS-FREE VOICE CONTROL



"Alexa"

"What's the weather?"

"Play today's hits"

"Turn on the lights"

⋮



Charging

CHARGING

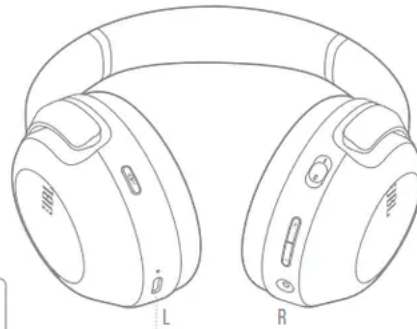

FACTORY RESET

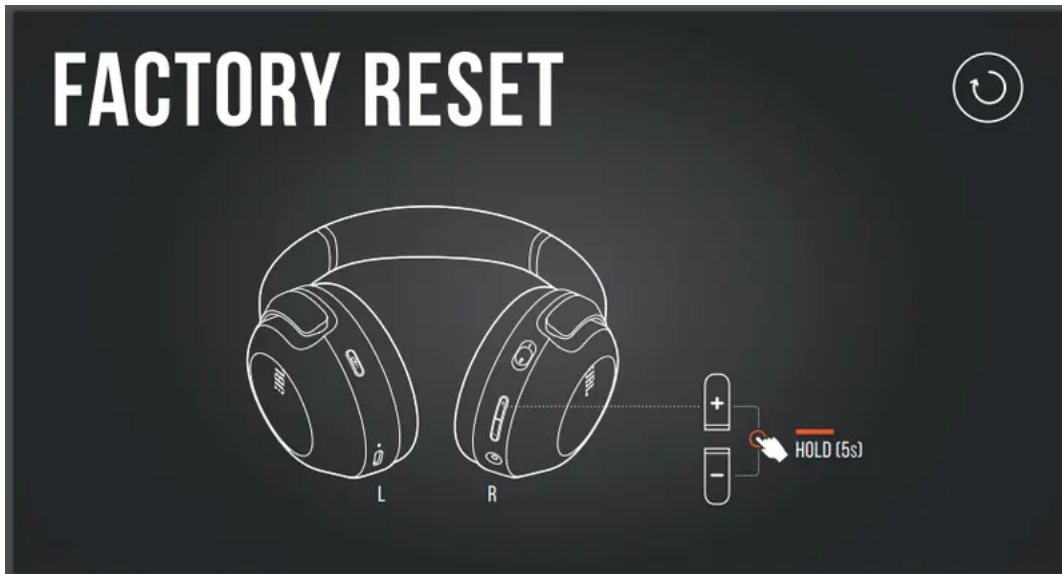

Led behaviors

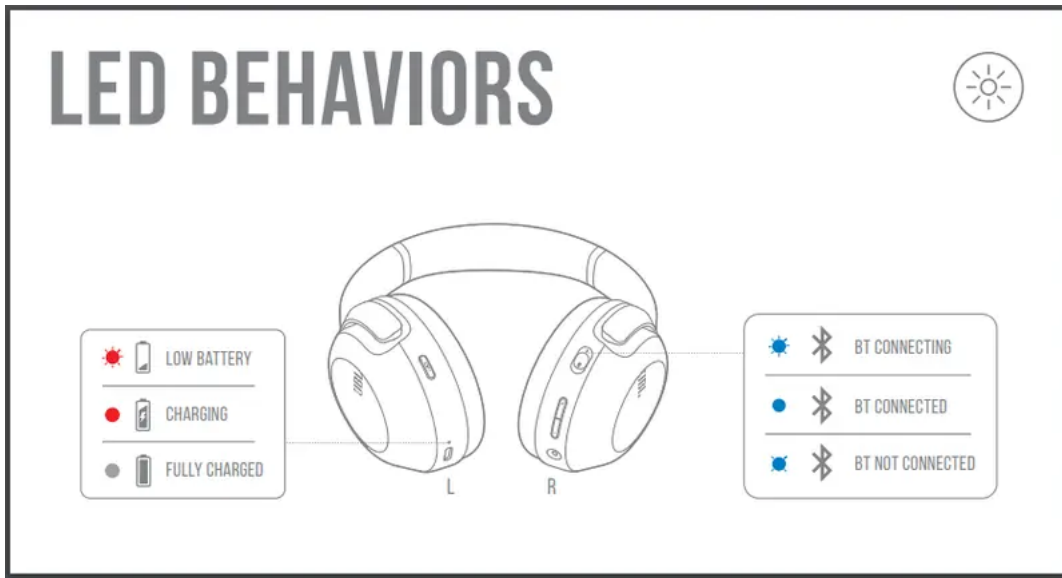

TECH SPEC

Model: TOUR ONE

Driver Size: 40 mm / 1.57" Dynamic Driver

Power supply: 5 V 1 A

Weight: 268 g / 0.59 lbs

Battery Type: Li-ion battery (920 mAh / 3.7 V)

Charging time (USB-C): 2 hrs

Music playtime with BT on and ANC off: 50 hrs

Music playtime with BT on and ANC on: 25 hrs

Frequency Response (Passive): 10 Hz – 40 kHz

Frequency Response (Active): 10 Hz ~ 22 kHz

Impedance: 32 ohm

Sensitivity: 95 dBSPL @1kHz

Maximum SPL: 95 dB

Microphone sensitivity: -35 dBV/Pa @1kHz

Bluetooth version: 5.0

Bluetooth profile version: HFP V1.7, A2DP V1.3, AVRCP V1.6

Bluetooth transmitter frequency range: 2.4 – 2.4835 GHz

Bluetooth transmitter power: <8 dBm EIRP

Bluetooth transmitter modulation: GFSK, $\pi/4$ DQPSK, 8DPSK

Maximum operation temperature: 45 °C

NOTE

TO PROLONG BATTERY LIFESPAN, FULLY CHARGE AT LEAST ONCE EVERY 3 MONTHS.
BATTERY LIFE VARIES BY USE AND SETTING.

The Bluetooth® word mark and logos are registered trademarks owned by Bluetooth SIG, Inc. and any use of such marks by HARMAN International Industries, Incorporated is under license. Other trademarks and trade names are those of their respective owners.

Warning

This content is compiled from multiple sources and is provided for reference purposes only. It may not be complete or fully applicable to all situations. If you are unable to resolve your issue, please contact the product manufacturer or an authorized service provider for official support.