

# How To Use

## Control Panel

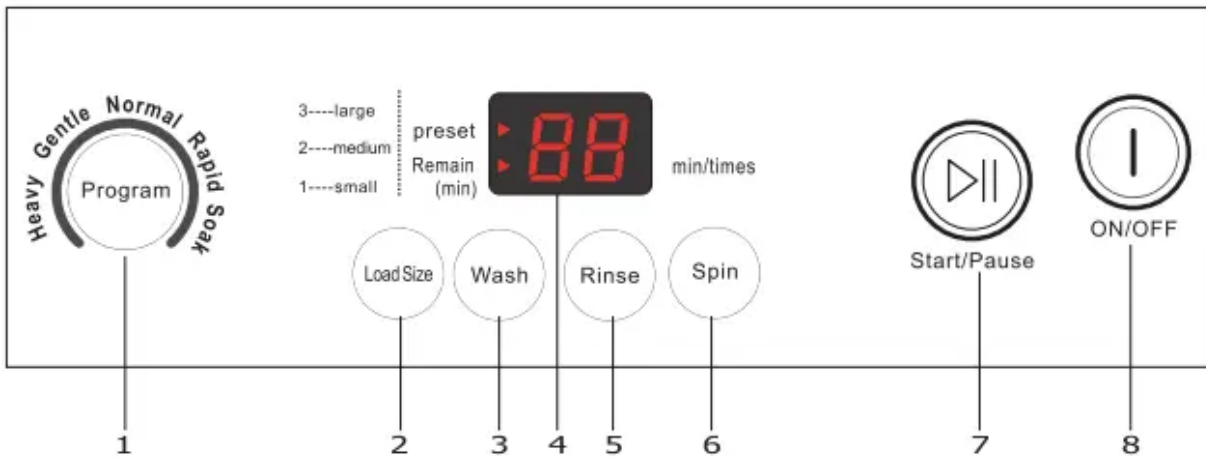

### 1- Program

Press this button to select your desired washing program.

- Heavy (light)
- Rapid (light)
- Gentle (light)
- Soak (light)
- Normal (light)

### 2 - Load Size

Press this button to set your washing load size. Your setting will decide the water level throughout all steps in the cycle.

### 3- Wash

Press the button to select the washing time

### 4 - Digital display

The digital display will show and count down the estimated minutes for the wash cycle selected.

### 5 - Rinse

Press the button to select the times of rinse

### 6- Spin

Press the button to select the time of spin

### 7 - START/ PAUSE

Press the START/ PAUSE button once to the start the wash cycle.

Press the button during operation to pause the cycle. Press again to continue the cycle.

## 8- ON/OFF

Press the ON/OFF button once to turn ON the power of the washer. Press again to turn OFF the unit.

### Washing a load of laundry

- **Step 1: Power on your washer**



ON/OFF

Press the ON/OFF button to power your wash on.

- **Step 2: Load your washer**



WARNING

Before loading your laundry, be sure to take out coins, keys and other hard objects, and close all zippers to prevent the clothes from damage.



Sort laundry by fabric type, soil level, color and load size as needed. Refer to the Fabric Care Chart in the APPENDIX. You can fill the tub with dry, unfolded clothes. **DO NOT OVERLOAD** the tub. Load the tub no more than 3/4 full.

To ensure good cleaning results do not overload the tub, especially when washing heavily soiled loads. Never load the tub more than 3/4 full.



WARNING

Overloading may reduce washing efficiency, cause excess wear, and possibly cause creasing or wrinkling of items in the load.

**Note:** To add a forgotten item:

1. Press the START/ PAUSE button to pause the washer.
2. Wait for the tub to stop turning, then open the door.

3. Add the item. close the door. and then press the START/ PAUSE button. The cycle will resume.

• **Step 3: Add detergent**

This washer is designed for high efficiency (HE) powder detergent only. Add the recommended amount of detergent directly into the basket before starting your washer. The normal amount of detergent to use is 1/4 to 1/2 of the maximum amount recommended by the detergent manufacturer. Always reduce the amount of detergent if the load is small or lightly soiled. or if your water is very soft. Never use more than the maximum amount recommended by the detergent manufacturer.

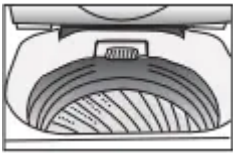

WARNING

Never pour any liquid bleach directly onto the load. It can cause fabric damage. such as weakening of cloth fibers or color loss.

• **Step 4: Select your desired cycle and options**



First, select your desired washing program.

- Heavy (light)
- Rapid (light)
- Gentle (light)
- Soak (light)
- Normal (light)



Second, select the water level based on a High, Medium or Low load size.

Press the Load Size button to change the water level setting.

- 3--large
- 2--medium
- 1--small



Third, user can freely select any combination among WASH, RINSE and SPIN modes according to the dirty degree of clothes. Detail operation methods are following:  
Continuously pressing the washing button to select washing time. (1~20 minutes, or no wash process)



Continuously pressing the rinse button to select rinse times. (1~3 times, or no rinse process)



Continuously pressing the spin button to select the spin time. (3~9 minutes or no spin process)

• **Step 5: Start the cycle**



Start/Pause

Press the START/ PAUSE button to start the washing cycle. When the washing cycle begins, the Estimated Time in minutes for the cycle to complete will show and count down in the digital display.



**WARNING** When the washer is running, you should pause the program and wait for the basket stopped completely before you open the door.

## Cycle Guide

Program	Load Size		soak time (about)	Wash Time (about)	Rinse Times	Final Spin Time	Total Time
	Default	Scope					
Normal	Large	Sm	—	12 min	1	5min	31min
		Med	—	12 min	1	5min	31min
		Lg	—	12 min	1	15min	41min
Heavy	Large	Sm, Med, Lg	—	12 min	2	5min	41min
Gentle	Large	Sm, Med, Lg	—	15 min	3	3min	52min
Rapid	Large	Sm, Med, Lg	—	3 min	1	2min	19min
Soak	Large	Sm, Med, Lg	13 min	4 min	2	2min	39min

### Energy efficiency test program :

"Normal" program is the most suitable program to wash normally soiled cotton or linen clothes and is the most efficient program in terms of combined energy and water consumption for washing that type of laundry.

## Care And Cleaning

### Regular Cleaning and Maintenance

- **Cleaning the exterior**

Turn off the water faucets after finishing the day's washing.

This will shut off the water supply to your washer and prevent the unlikely possibility of damage from escaping water.

Leave the lid open to allow the inside of your washer to dry out.

Use a soft cloth to wipe up all detergent, bleach or other pills as they occur.

Clean the following as recommended:

Control Panel - Clean with a soft, damp cloth. Do not use abrasive powders or cleaning pads. Do not spray cleaners directly onto the panel.

- **Cleaning the interior**

Clean the interior of your washer periodically to remove any dirt, soil, odor, mold, mildew, or bacterial residue that may remain in your washer as a result of washing clothes.

Failure to follow these instructions may result in unpleasant conditions, including odors and/or permanent stains on your washer or laundry. Hard water deposits may be removed, if needed. Use cleaners labeled "Washer safe".

- **Tub clean**

Run a Rapid cycle with some bleach every month to clean the tub. This will also help to remove mold which may occur inside the washer.

- **Lint filter clean**

There is a built-in lint filter in your washer. It can help to collect lint during washing cycle.

It is suggested to clean the lint filter every 10 cycles.

Take it out and clean the filter with water. Then place it back into the washer.

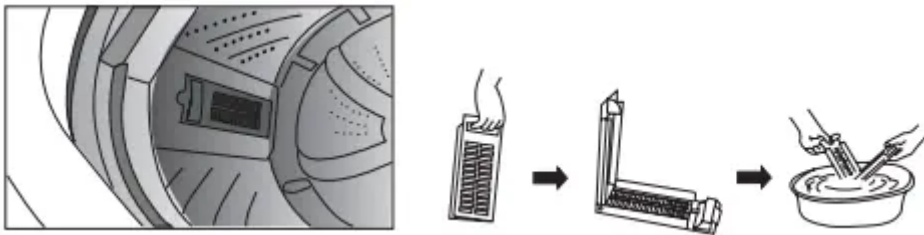

- **Pump filter clean**

There is a built-in Pump filter in your washer. It can help to protect the pump during washing cycle.

It is suggested to clean the lint filter every once every month.

It is suggested to clean the pump filter once every month.

Take the filter out and clean it with water. Then place it back into the washer.

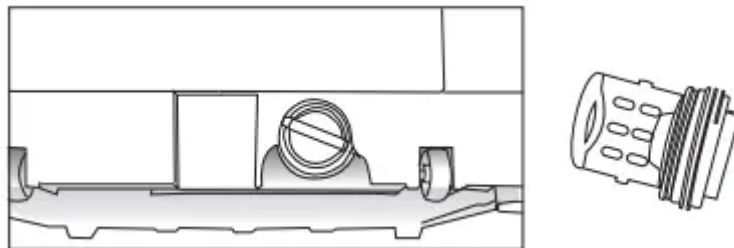

## Troubleshooting

### Before calling for service

Your washing machine is equipped with an automatic error-monitoring system to detect and diagnose problems at an early stage. If your washer does not function properly or does not function at all, check the following before you call for service:

#### Thumping sound

Heavy wash loads may produce a thumping sound.

- This is normal. If sound continues, washer is probably out of balance.

Washer load may be out of balance.

- Stop and redistribute wash load. Pause the cycle and redistribute the load.

### **Vibrating noise**

Packaging materials were not removed.

- See the UNPACKING AND REMOVING SHIPPING MATERIAL section in the installation instructions.

Wash load may be unevenly distributed in the tub.

- Pause the cycle and redistribute the load.

Not all leveling feet are resting firmly and evenly on the floor.

- See Leveling the Washer in the Installation Instructions.

Floor not rigid enough.

- Make sure that the floor is solid and does not flex. See Flooring in the Installation Requirements.

### **Excessive sudsing**

Too much detergent or incorrect detergent.

- HE detergents are formulated specifically for High-Efficiency washers and contain suds reducing agents. Only use detergent with the High-Efficiency (HE) logo.

### **Water leaking**

Inlet hose connection is loose at faucet or washer.

House drain pipes are clogged.

Drain hose has come out of drain or is not inserted far enough.

A large item such as a pillow or blanket is above the top of the tub.

- Check hoses for leaks, cracks and splits.
- Check and tighten hose connections.
- The washer pumps out water very rapidly.
- Check for water backing up out of the drain pipe during drain. If water is seen coming out of the drain, check for proper drain hose installation and check for restrictions in the drain. Contact a plumber to repair drain pipe.
- Tie drain hose to inlet hose or standpipe to prevent it from coming out during drain]

- For smaller drain pipes. insert the drain] hose into the pipe as far as the drain hose| flange. For larger drain pipes. insert the drain hose into the pipe 1-2 in. past the flange.
- Stop the washer and check the load.
- Make sure the load does not crest above the top edge of the tub.

### **Rattling and clanking noise**

Foreign objects, such as keys, coins, or safety pins, may be in tub or pump.

- Stop washer, check tub and drain filter for foreign objects. If noise continues after washer is restarted, call for service.

### **Wrinkling**

Washer not unloaded promptly.

- Always remove items from the washer as soon as the cycle is complete.

Washer overloaded.

- The washer can be fully loaded, but the tub should not be tightly packed with items. The lid of the washer should close easily.

Hot and cold water inlet hoses are reversed.

- Hot water rinse can set wrinkles in garments. Check the inlet hose connections.

### **Staining**

Washer was not unloaded promptly.

Clothes were not properly sorted.

- Always remove items from the washer as soon as possible after the cycle is complete. Always wash dark colors separately from light colors and whites to prevent discoloration. Never wash heavily soiled items washed with lightly soiled items.

### **Wash cycle time is longer than usual**

The washer automatically adjusts the wash time for the amount of laundry, water pressure and other operating conditions.

This is normal. The washer adjusts cycle time automatically to provide optimal results for the selected cycle.

- The time remaining shown in the display is only an estimate. Actual time may vary.

### **Musty or mildewy odor in washer**

Incorrect or too much detergent has been used .Inside of tub was not cleaned properly.

- Use only High-Efficiency (HE) detergent in accordance with the manufacturer's instructions. Run an Express cycle with bleach once a month to clean tub and remove any mold from inside washer.

### **Washer will not turn ON**

**NOTE:** If the washer stopped during acycle duetoa loss of power, the washer will resume the cycle where it stopped when the power is restored.

Power cord is not properly plugged in.

- Make sure that the plug is plugged securely into a grounded, 3-prong, 120-VAC, 60-Hz outlet.

House fuse is blown. circuit breaker has tripped. or power outage has occurred.

- Reset circuit breaker or replace fuse. Do not increase fuse capacity. If the problem is a circuit overload, have it corrected by a qualified electrician.

House fuse is blown, circuit breaker has tripped, due to multiple appliances on one outlet.

- Reset circuit breaker or replace fuse. If more than one appliance is connected to the outlet, call an electrician to have an additional circuit installed.

### **Water leaks**

Over sudsing of detergent.

- Over sudsing may create leaks. and may be caused by the type and amount of detergent used. High-Efficiency detergent is the only detergent recommended. Make sure that detergent and any additives are put into the correct dispenser compartments. The normal amount of detergent to use is 1/4 to 1/2 of the maximum amount recommended by the detergent manufacturer. Always reduce the amount of detergent if the load is small or lightly soiled. or if your water bis very soft. Never use more than the maximum amount recommended by the detergent manufacturer.

### **Poor stain removal**

Previously set stains

- Articles that have previously been washed may have stains that have been set. These stains may be difficult to remove and may require hand washing or pre-treating to aid in stain removal.

### **Washer will not drain water**

Kinked drain hose. Drain located higher than 48 in. above the floor.

- Ensure that the drain hose is not kinked. Make sure that the drain hose is no higher than 4 ft. above the bottom of the washer and is no more than 5 ft. away from the washer.

### **Washer will not operate**

Water supply is turned off .Control panel has powered off due to inactivity.

- This is normal. Press the POWER button to turn the washer on.

Washer is unplugged.

- Make sure cord is plugged securely into a working outlet.

Controls are not set properly.

- Turn both hot and cold faucets fully on.
- Make sure the cycle was set correctly. Close the lid and press the START/PAUSE button.

Lid is open.

- The washer will not operate if the lid is open. Close the lid and make sure that nothing is caught under the lid preventing it from closing completely.

Circuit breaker/fuse is tripped/blown.

- Check house circuit breakers/fuses. Replace fuses or reset breaker. The washer should be on a dedicated branch circuit. The washer will resume the cycle where it stopped once power is restored.

Control needs to be reset.

- Press the POWER button. Then re-select the desired cycle and press the START/PAUSE button.

START/PAUSE was not pressed after a cycle was Set.

- Press the POWER button then re-select the desired cycle and press the START/PAUSE button. The washer will shut off if the START/PAUSE button is not pressed within ten minutes.

Extremely low water pressure.

- Check another faucet in the house to make sure that household water pressure is adequate.

Washer is too cold.

- If the washer has been exposed to temperatures below freezing for an extended period of time. Allow it to warm up before pressing the POWER button. Otherwise, the display will not come on.

Washer is running under Delay start program.

- It's normal if the unit doesn't operate under Delay start function. It will start automatically after the delay time is out.

# Installation Manual

## Unpacking and Removing Shipping Material

Remove the packing box and lift the washer up and away from the foam base cushion. Open the lid of washer to take out all accessories including protection foam.

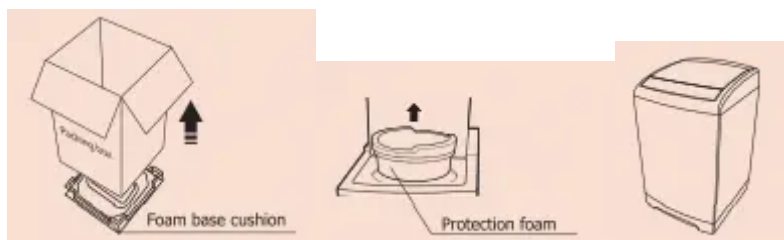

**WARNING** Packaging materials can be dangerous to children; Keep all packaging material (plastic bags, polystyrene, etc.) well out of children's reach. Do not operate this appliance on the foam base cushion. Failing to do so will result in serious vibration.

**After the machine is turned on, some water may remain inside. This is because each machine will be tested for performance on the production line. Before use, please try to clean up the residual water.**

## Installation of cold and hot water inlet pipes

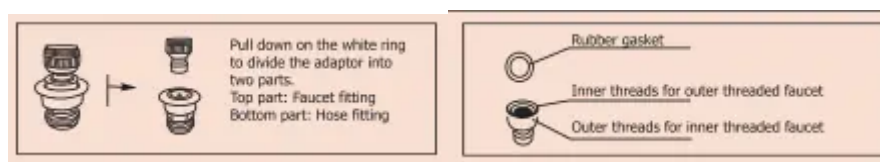

**NOTE:** When connected to a single faucet that can dispense either hot or cold water, both hot and cold water can be run through the cold water line for washing use. However, it is recommended) to only run cold water washes when the adaptor is connected to such a faucet.

Connect the ends of the water supply hoses to the HOT and COLD faucets. For convenience, use the Quick Connection Adaptor for connection to the cold water faucet.

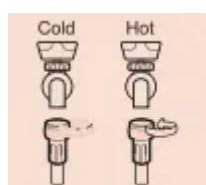

## Position the other end of the drain hose

A. Over the edge of a wash basin.



### B. Ina standpipe

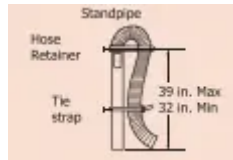

### C. Ina laundry tub.

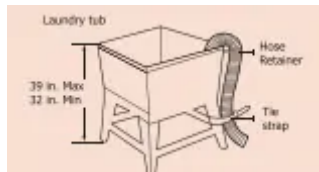

## Pump filter clean

There is a built-in Pump filter in your washer. It can help to protect the pump during washing cycle.

It is suggested to clean the lint filter once every month.

It is suggested to clean the pump filter once every month. Take the filter out and clean it with water.

Then place it back into the washer.

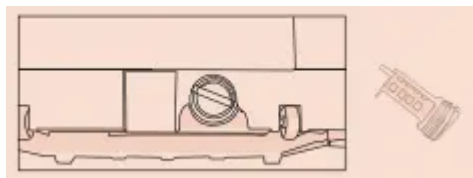

## Tighten the fittings

Tighten the fittings by hand until they are snug. and then tighten them an additional two-thirds of a turn with a wrench.



Confirm that the water supply hoses are not twisted or bent. If the hoses are twisted or bent, the hoses can leak and cause electric shock due to the water leakage. To ensure the correct water usage, connect both the HOT and COLD water faucets. If either or both are not connected, an error code can occur.

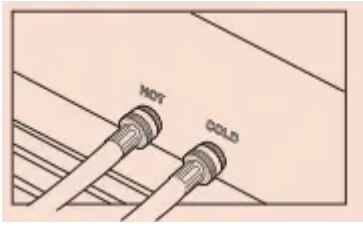

If you do not want to use the H<sup>O</sup>T water supply hose, install the water intake cap into the H<sup>O</sup>T water supply intake hole. In this case, you must select Cold water as the wash temperature choice. See Wash Temp in Control Panel section on page 23.

## Leveling your washer

See if the washer is level by checking the position of the tub or using a leveling gauge.

1. Slide the washer into position.
2. Open the lid of the washer, and pour the water into the tub to just below the pulsator level.
3. If the washer is level, the pulsator is positioned at the center of the washer as shown in the figure above right. If not, level your washer by turning the front leveling feet clockwise or counterclockwise as necessary.

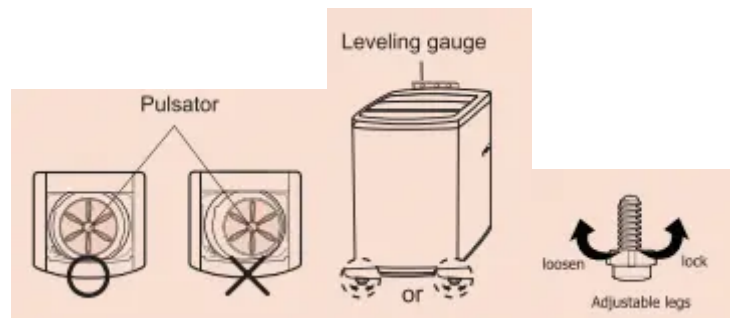

## Error Codes

### **E1**

It takes over 30 minutes to fill water but cannot achieve its preset water level.

- Check for Washer not filling properly and Water leakage.

### **E2**

It takes over 10 minutes to drain water but can not drain the washer empty.

- Check for Washer will not drain water.

### **E3**

The top lid is open.

- Close the lid and Press the START / PAUSE button.

### **E4**

The washer runs out of balance for three times.

- Redistribute the load.

**XX**

Others

- Please try again first, call up service line if there are still troubles.

**Warning**

This content is compiled from multiple sources and is provided for reference purposes only. It may not be complete or fully applicable to all situations. If you are unable to resolve your issue, please contact the product manufacturer or an authorized service provider for official support.

---

Document generated by [ManualsFile](#)

