

Operation Guide

Parts Location

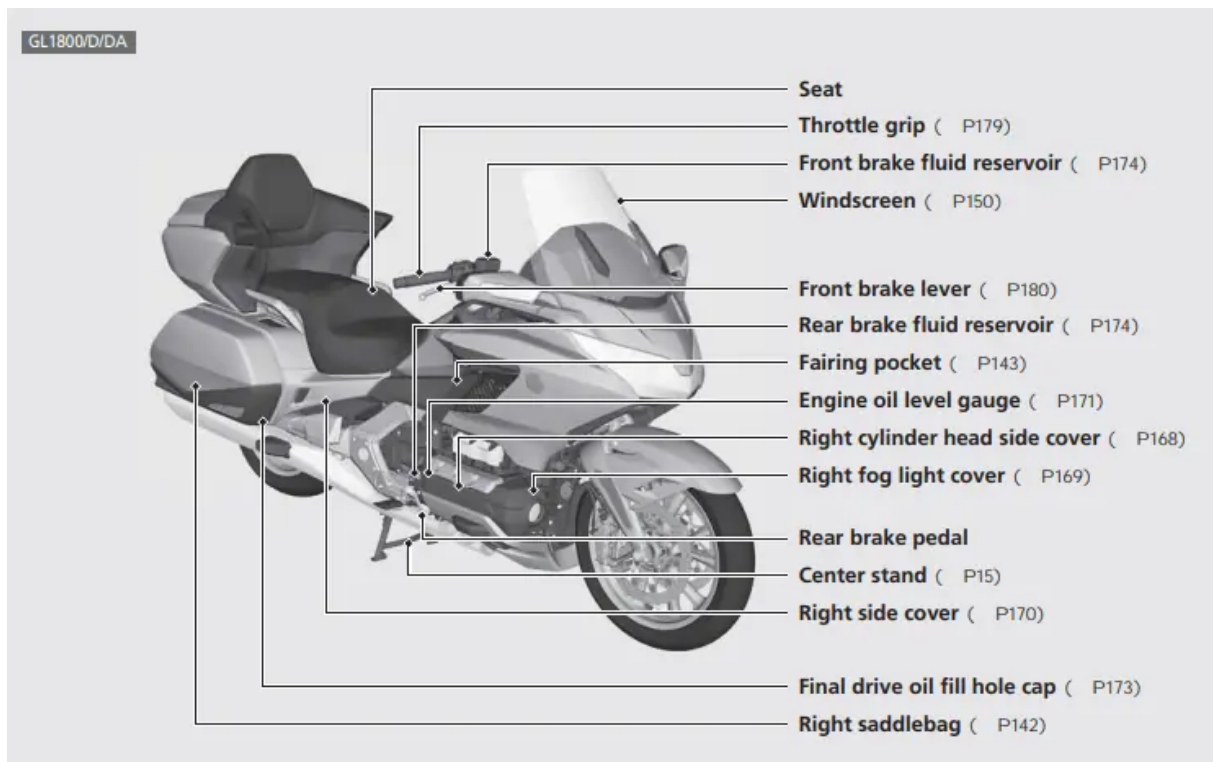

GL1800D/DA

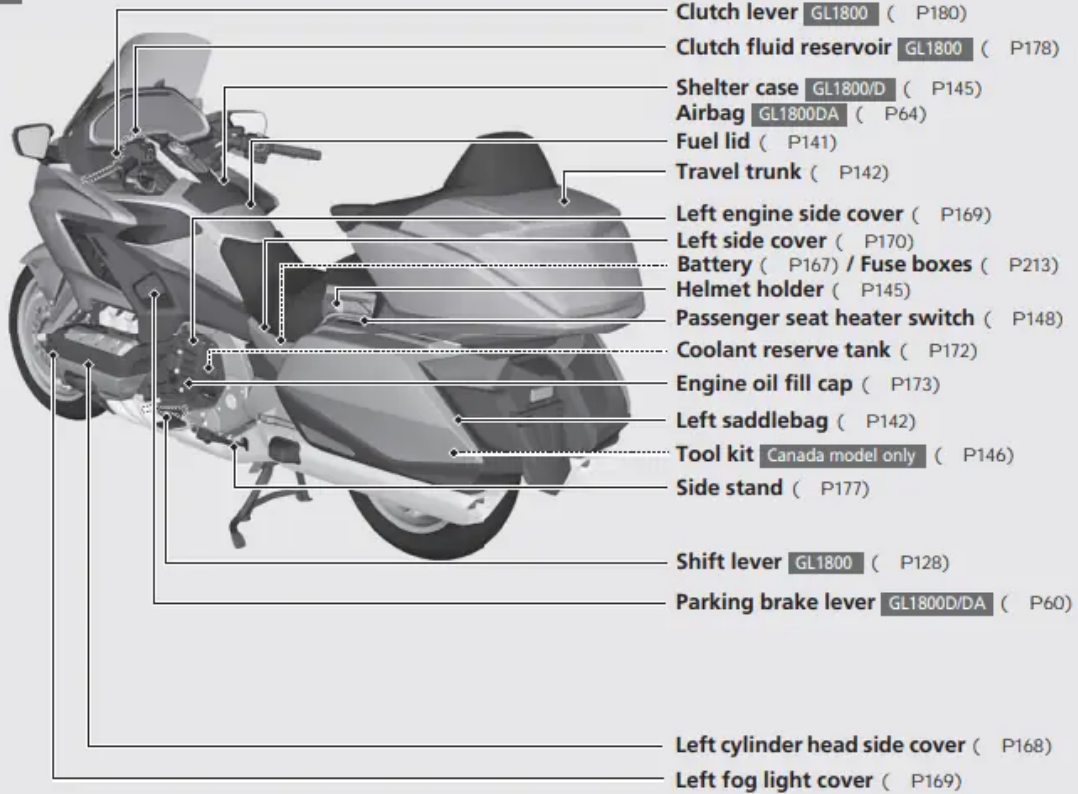

GL1800B/BD

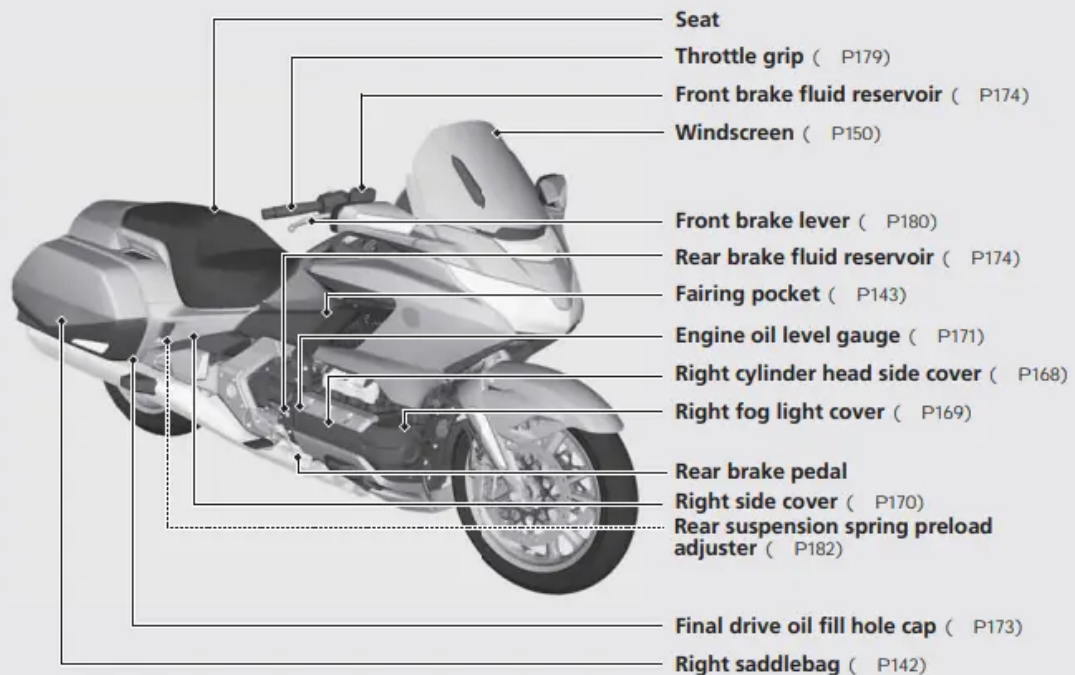

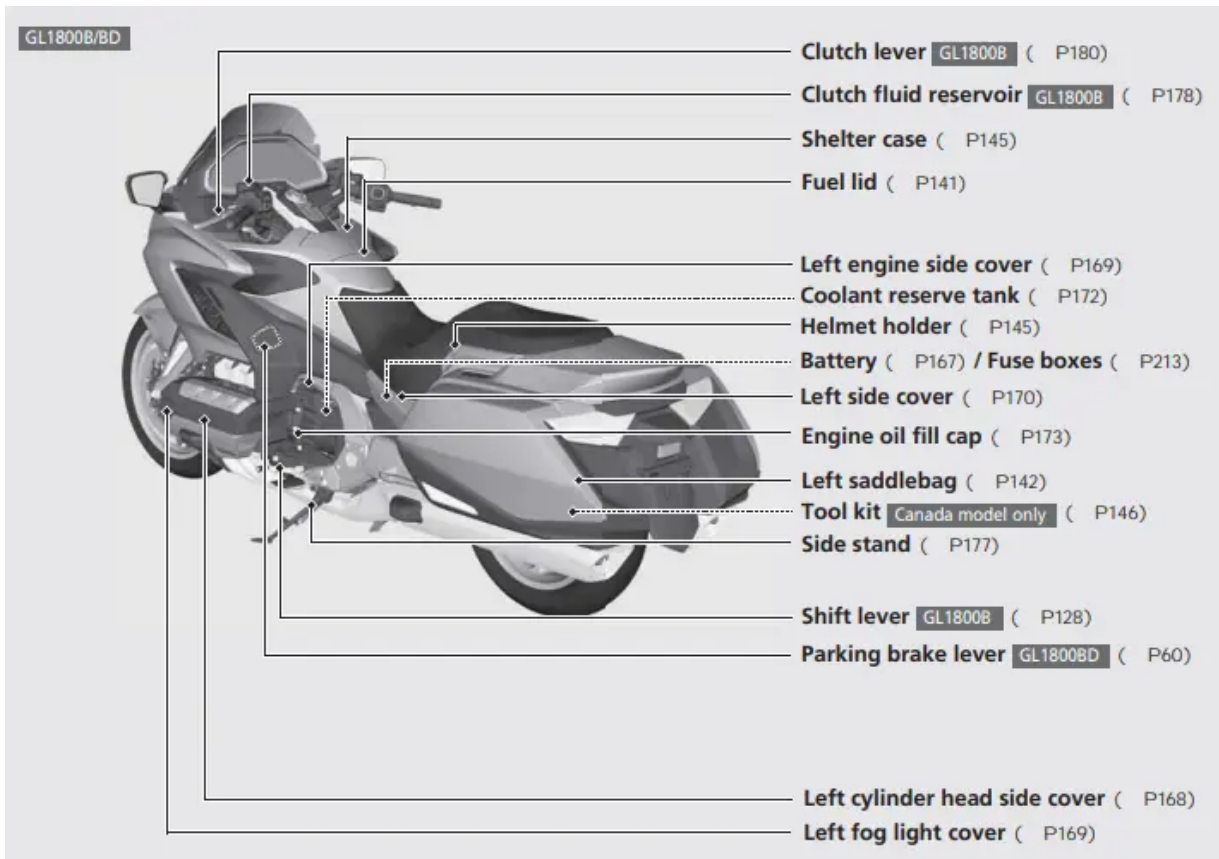

Instruments

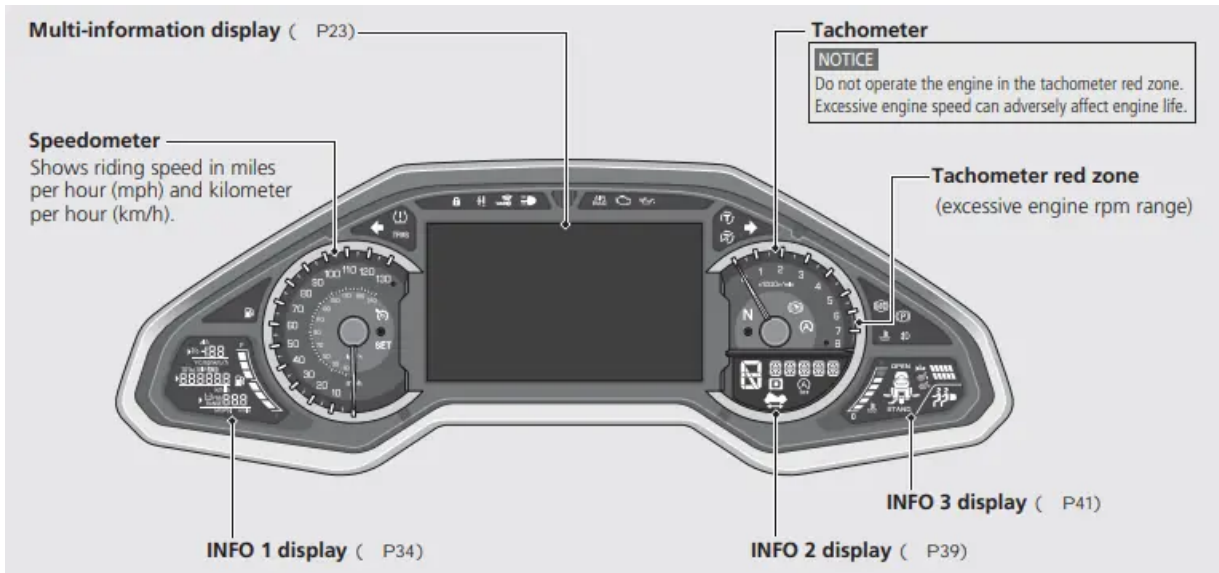

Display

Check When the ignition switch is turned ON, all of the modes and digital segments will show on the INFO 1, INFO 2 and INFO 3 displays, and the opening symbol will show on the multi-information display. If the displays do not show when they should, have your dealer check for problems.

Multi-information Display

Your vehicle is equipped with a multiinformation display that presents various functions and settings.

- Certain manual functions and settings are disabled or inoperable while the vehicle is in motion. You cannot select a grayed-out menu until the vehicle is stopped.

When the ignition switch is turned ON or ACC, the Notice message appears on the screen for a few second.

Read the Notice message.

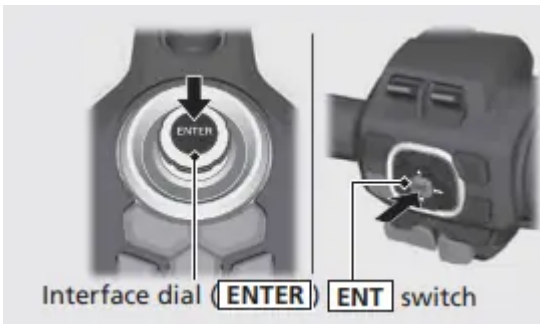
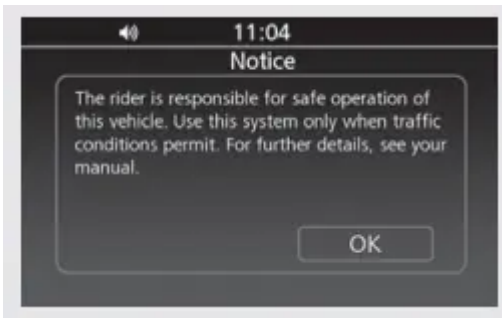

Home Screen

From this screen, you can go to various functions and setup options.

When the ignition switch is turned ON or ACC, you will see the screen you used last.

To return to the Home screen:

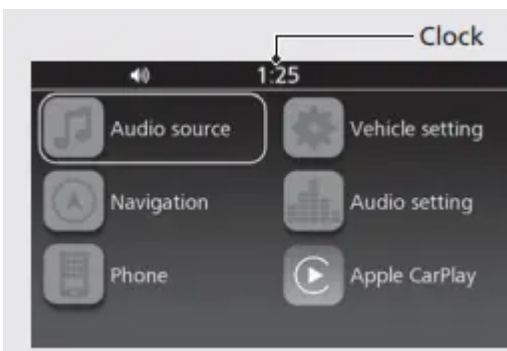

| Clock (12-hour display)

To set the clock: (P79)

| Audio Source

Enters the current audio mode. (P71)

| Vehicle Setting

Enters the vehicle setting menu screen. (P28)

| Navigation

Displays the navigation screen. (Refer to the Navigation System manual.)

| Audio Setting

Enters the audio setting menu screen. (P73)

| Phone

Enters the phone screen. (P118)

| Apple CarPlay™

Appears the menu icon when Apple CarPlay is available. (P111)

| Android Auto™

Appears the menu icon when Android Auto is available. (P114)

Indicators

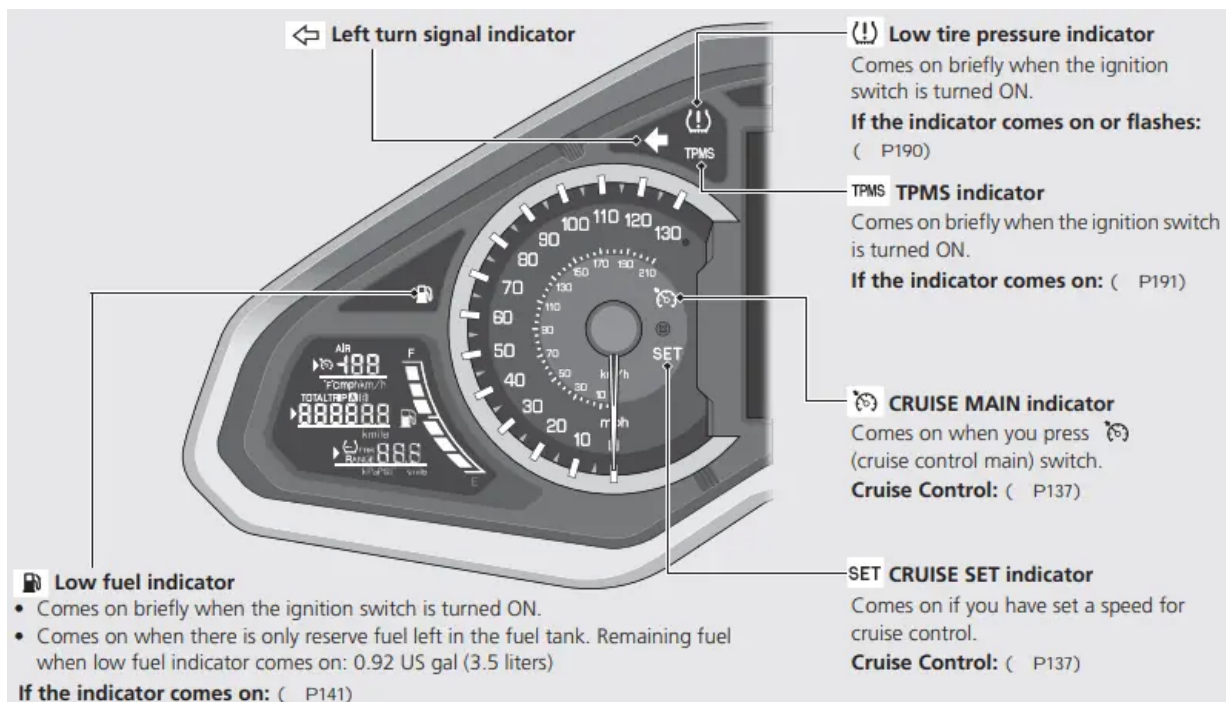

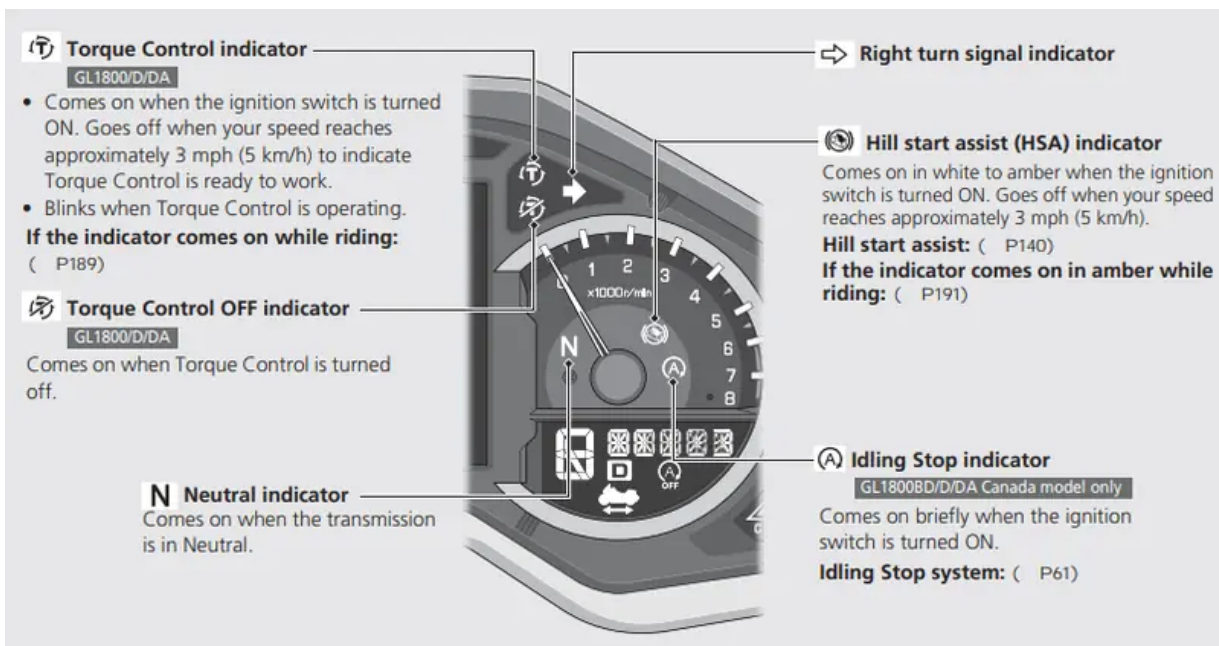
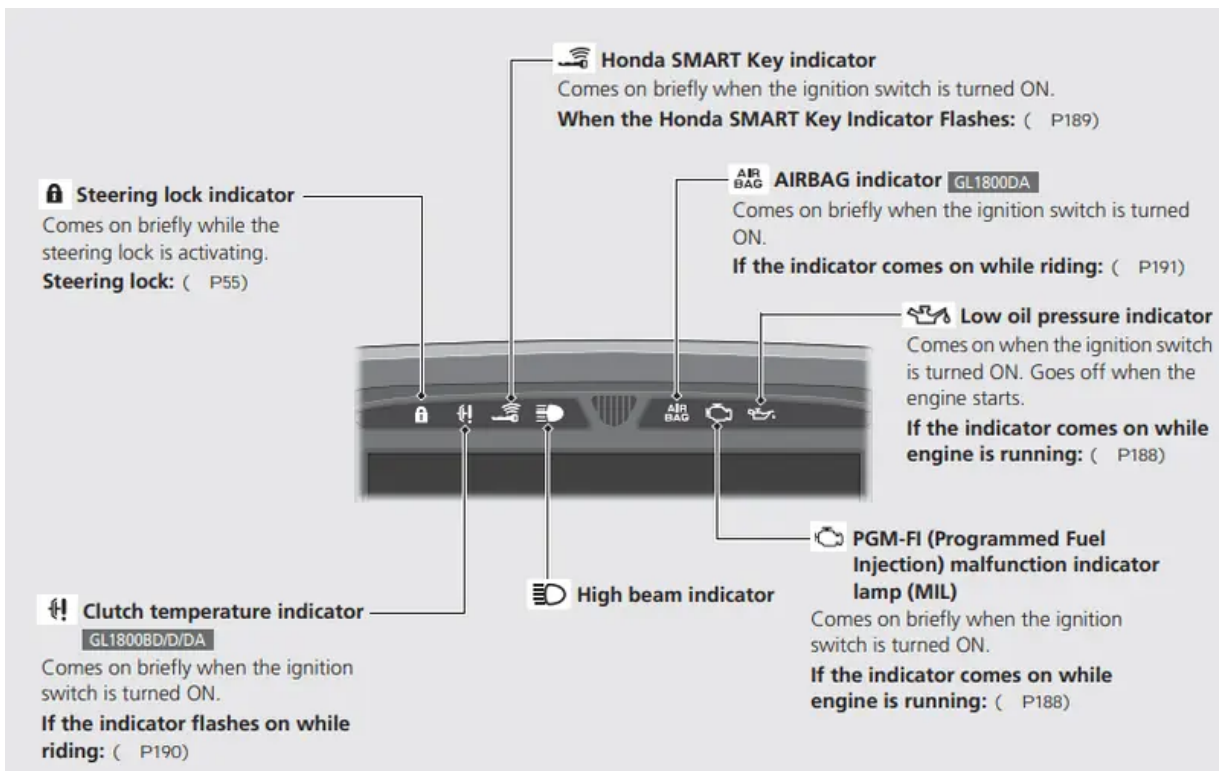

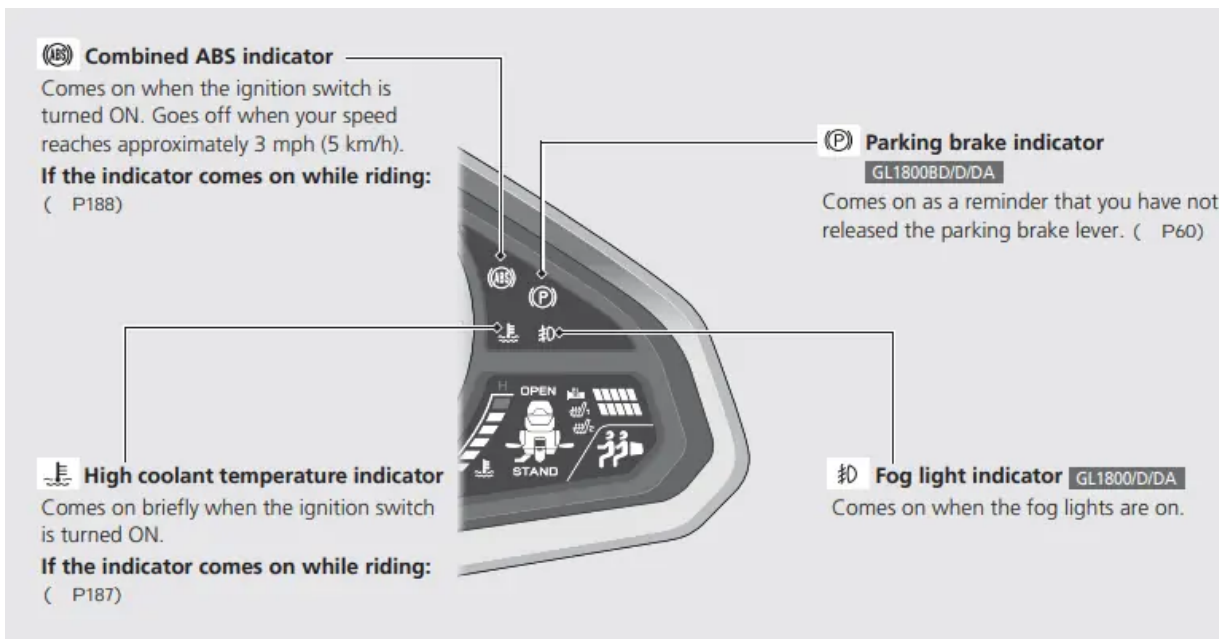

Switches

Center Panel

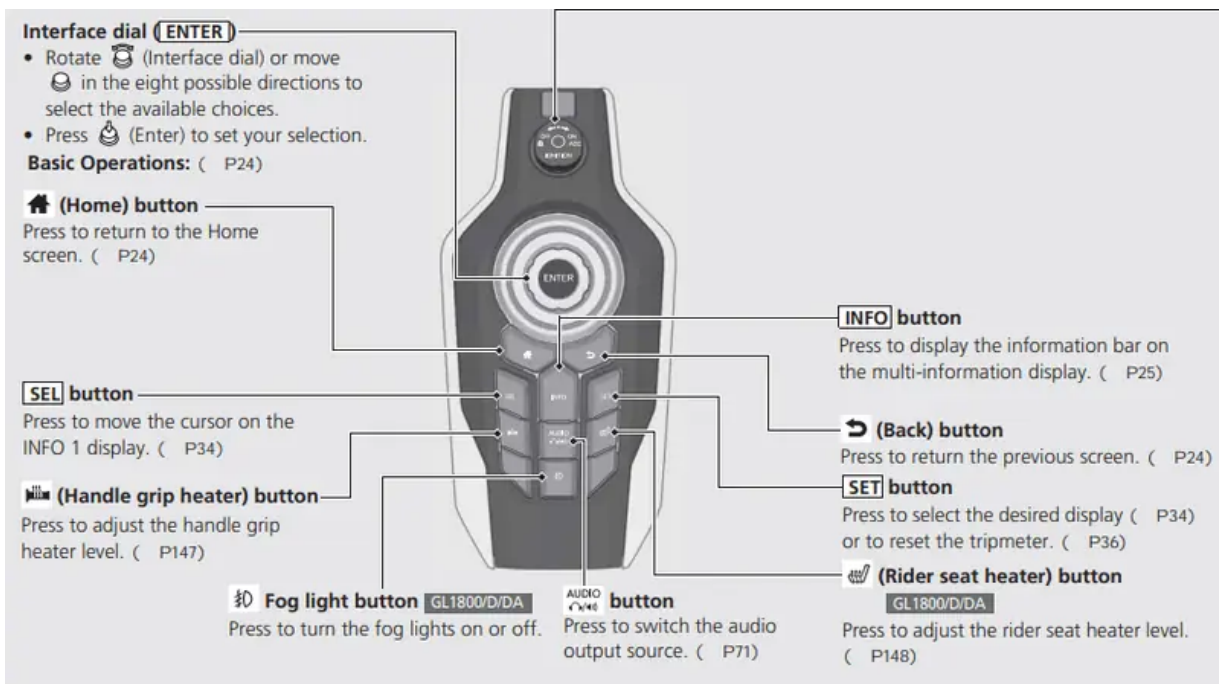

Ignition switch

Switches the electrical system on/off, locks the steering.

Make sure that the Honda SMART Key is activated (P56) and enter the operating range. (P57)



(Lock)



Locks steering. (P55)

OFF



Turns engine off.

ON



Turns electrical system on for starting/riding.

ACC



Turns electrical system on for the audio system and other accessories.

: Turning the ignition switch clockwise.

: Turning the ignition switch counterclockwise.

Left handlebar

GL1800BD/D/DA

Headlight dimmer switch

- ▲☐ : High beam
- ▼☐ : Low beam
- ☐PASS : Flashes the high beam headlight.

VOL lever

Push up or down to adjust the audio system volume. (P71)

(Voice control) switch

- Press to receive, reject or end a call. (P118)
- Starts Siri® or Google Assistant™ if Apple CarPlay or Android Auto are available. (P113)

Horn button

Turn signal switch

- The turn signal will automatically stop when you complete the turn.
- When used for a lane change, the turn signal automatically stops after 7.5 seconds or after riding 153 yards (140 m).
- You can manually cancel the turn signal by pressing the switch in.
- In some cases, the timing at which the turn signal stops is changed.
- Always use the recommended tires to ensure correct automatic cancellation operation.

To enable or disable the turn signal automatic cancellation: (P28)

4-way key/ENT switch

- Press the 4-way key switch in the ▲ / ▼ / ◀ / ▶ directions to select the available choices.
- Press ENT switch to set your selection. (P24)

Windscreen adjusting lever

Push up or down to adjust the windscreen height. (P150)

(Home) switch

Press to return to the Home screen. (P24)

(Back) switch

Press to return to the previous screen. (P24)

(Source/Private Mode) switch

- Press to change the audio mode. (P71)
- Press and hold to enable/disable the private mode. (P92)

Walking Speed mode switch

Press to enter the Walking Speed mode. (P131)

Shift up switch (+)

- Pull to shift up a gear. (P130)
- Pull to move the vehicle forward during the Walking Speed mode. (P131)

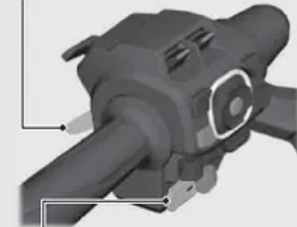

Shift down switch (-)

- Press to shift down a gear. (P130)
- Press to move the vehicle backward during the Walking Speed mode. (P131)

GL1800/B

Headlight dimmer switch

- ▲/D : High beam
- ▼/D : Low beam
- #/D PASS : Flashes the high beam headlight.

VOL lever
Push up or down to adjust the audio system volume. (P71)

(Voice control) switch

- Press to receive, reject or end a call. (P118)
- Starts Siri or Google Assistant if Apple CarPlay or Android Auto are available. (P113)

Horn button

4-way key/ENT switch

- Press the 4-way key switch in the ▲ / ▼ / ◀ / ▶ directions to select the available choices.
- Press ENT switch to set your selection. (P24)

Windscreen adjusting lever
Push up or down to adjust the windscreen height. (P150)

(Home) switch
Press to return to the Home screen. (P24)

(Back) switch
Press to return to the previous screen. (P24)

(Source/Private Mode) switch

- Press to change the audio mode. (P71)
- Press and hold to enable/disable the private mode. (P92)

R Reverse mode switch **GL1800 and GL1800B Canada model**
Press to enter the reverse mode. (P133)

Reverse button **GL1800 and GL1800B Canada model**
While pressing the switch, your vehicle will back up in the reverse mode. (P133)

Turn signal switch

- While pressing the switch, your vehicle will back up in the reverse mode. (P133)
- The turn signal will automatically stop when you complete the turn.
- When used for a lane change, the turn signal automatically stops after 7.5 seconds or after riding 153 yards (140 m).
- You can manually cancel the turn signal by pressing the switch in.
- In some cases, the timing at which the turn signal stops is changed.
- Always use the recommended tires to ensure correct automatic cancellation operation.

To enable or disable the turn signal automatic cancellation: (P28)

Right handlebar

GL1800B/D/DA

A/M switch
Shifts between AT MODE and MT MODE. (P130)

Hazard switch
Switchable when the ignition switch is ON. Can be turned to off regardless of the ignition switch position.
The signals continue flashing with the ignition switch in OFF or (Lock) after the hazard switch is on.

MODE button
Changes the riding mode. (P134)

Engine stop switch/ Start button
Should normally remain in the (Run) position.
In an emergency, switch to the (Stop) position to stop the engine.
Press the start button to start the engine. (P126)

(A) Idling stop button **Canada model only**
Press to switch the Idling Stop system on or off while engine is running. (P61)

N-D switch
To shift between Neutral and AT MODE. (P130)

Cruise control lever
Push up or down to set the speed or adjust the set speed. (P137)

Cruise control main switch
Press to activate the cruise control system. (P137)

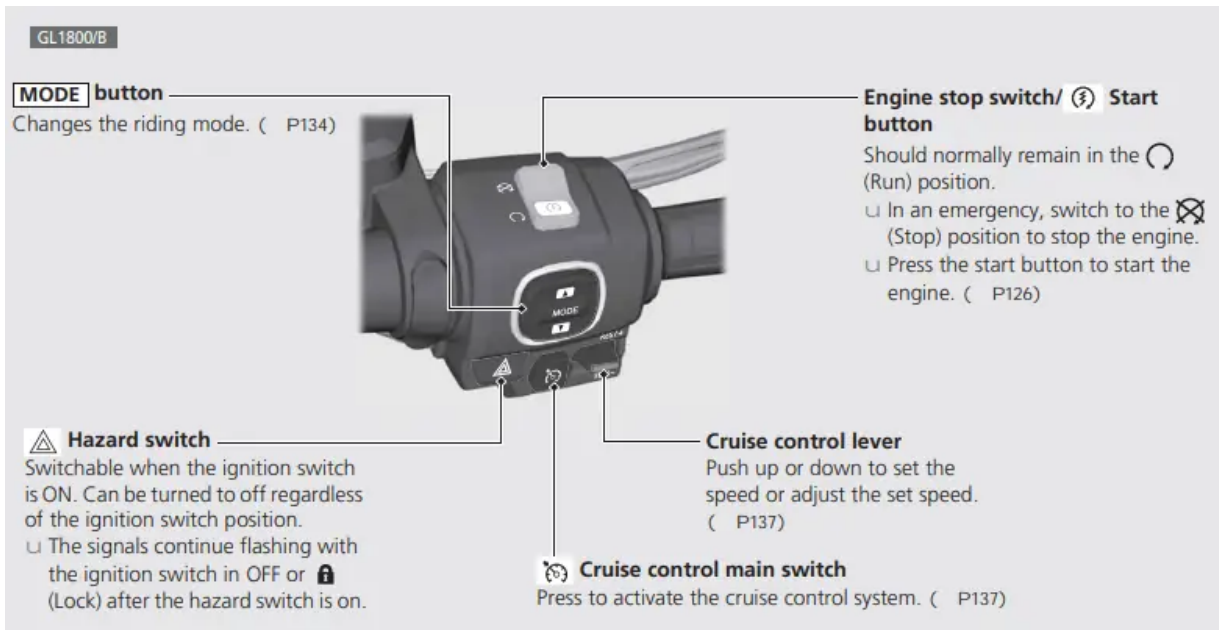

Passenger seat



Honda SMART Key



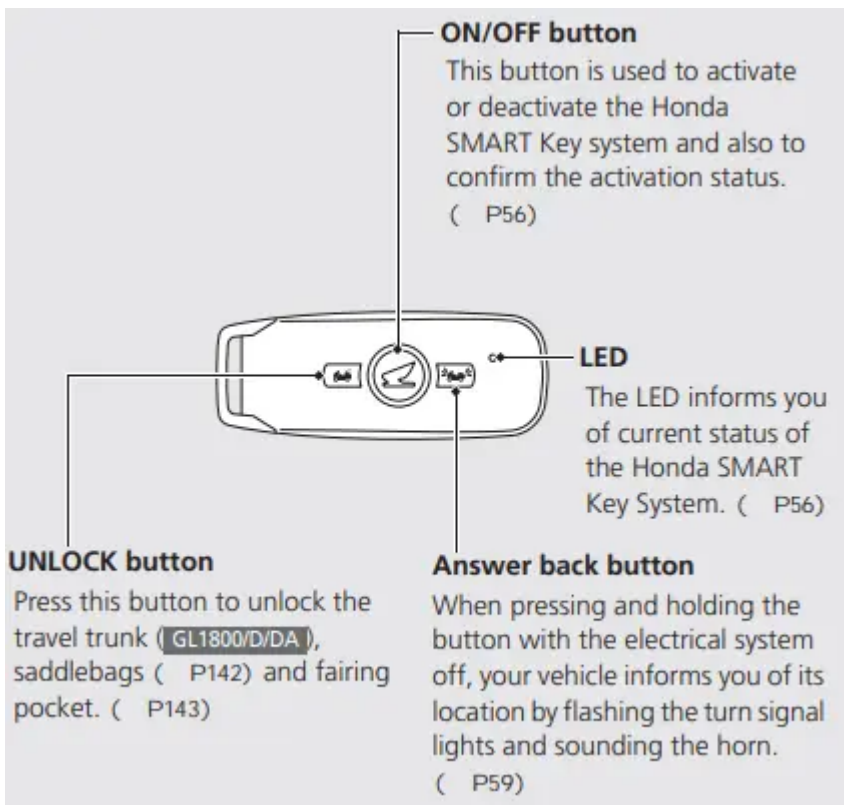

Steering Lock

Lock the steering when parked to help prevent theft. A U-shaped wheel lock or similar device is also recommended.

ⓘ When using a U-shaped wheel lock or similar device, be careful not to damage the wheels

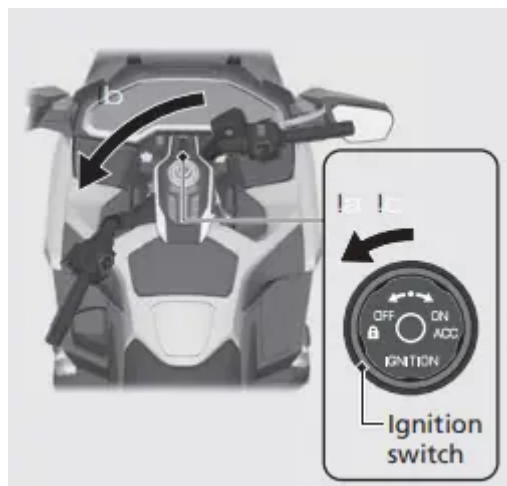

| Locking

a Turn the ignition switch to OFF. (P49)

b Turn the handlebars all the way to the left or right.

c Turn the ignition switch counterclockwise.

ⓘ The steering lock indicator comes on briefly and the steering is automatically locked.

UIf the steering lock indicator blinks and the alarm sounds, the steering has not been locked completely because the steering was not positioned all the way to the left or right.

If this occurs, reposition the handlebars all the way to the left or right, then turn the ignition switch counterclockwise (The steering can also be locked by positioning it all the way to the left or right while the alarm is sounding).

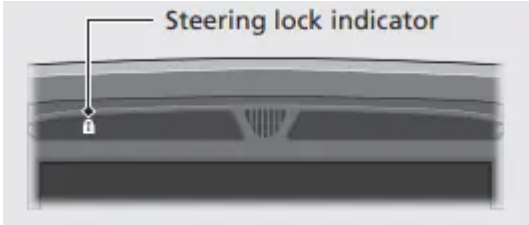

| Unlocking

a Make sure that the Honda SMART Key is activated (P56) and enter the operating range. (P57)

b Turn the ignition switch clockwise.

UThe steering is unlocked automatically.

Audio System

About Your Audio System

The audio system features AM/FM/SiriusXM[®] radio.

It can also play USB flash drives and iPod[®], iPhone[®], Android[™] phone and Bluetooth[®] devices.

You can operate the audio system from the switches on the left handlebar and buttons on the center panel. However, you cannot operate some functions by the center panel switches/Interface dial while the vehicle is in motion.

- State or local laws may prohibit the operation of handheld electronic devices while operating a vehicle.
- Only operate audio buttons and switches when safe to do so.
- Set the volume at a level that still allows horns and emergency vehicles to be heard.
- Some audio devices, USB flash drives and Bluetooth[®] audio devices may not be compatible.
- Use any audio devices, USB flash drives and Bluetooth[®] audio devices at your own risk.
- In no event shall Honda be liable for any damages or troubles that occur in the use of audio devices and USB flash drives. iPhone, iPad, iPad Air, iPad Mini, iPod, iPod touch, iPod classic, iPod shuffle and iPod nano are trademarks of Apple Inc.
- Google[™], Android, Google Maps[™], Google Play[™], Google assistant and Android Auto are trademarks of Google LLC.

- The Bluetooth word mark and logos are registered trademarks owned by Bluetooth SIG, Inc., and any use of such marks by Honda Motors Co., Ltd., is under license.
- Other trademarks and trade names are those of their respective owners.
- To prevent any potential issues, be sure to use an Apple MFi Certified Lightning Connector for Apple CarPlay, and for Android Auto, the USB cables should be certified by USB-IF to be compliant with USB 2.0 Standard.

Audio System Component Locations

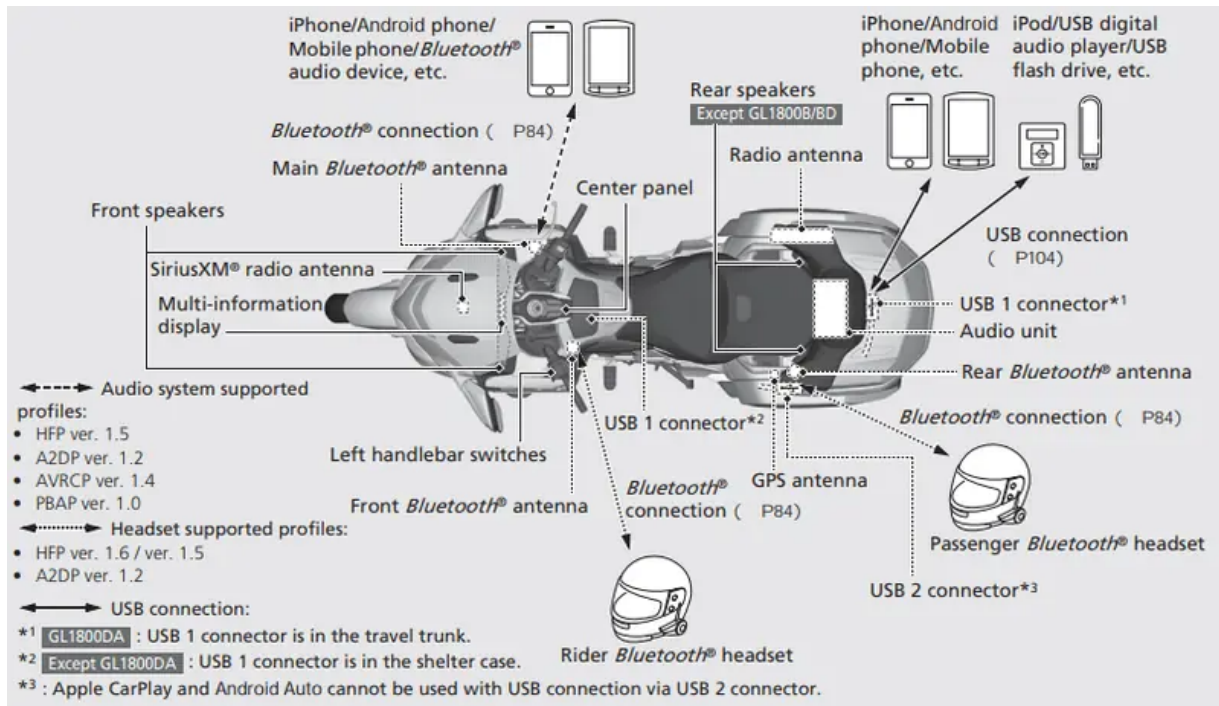

Basic Operations

You can operate and set the various functions of the audio system using the interface dial and buttons on the center panel and/or switches on the left handlebar. However, you cannot operate some functions by the center panel switches/Interface dial while the vehicle is in motion.

Center Panel

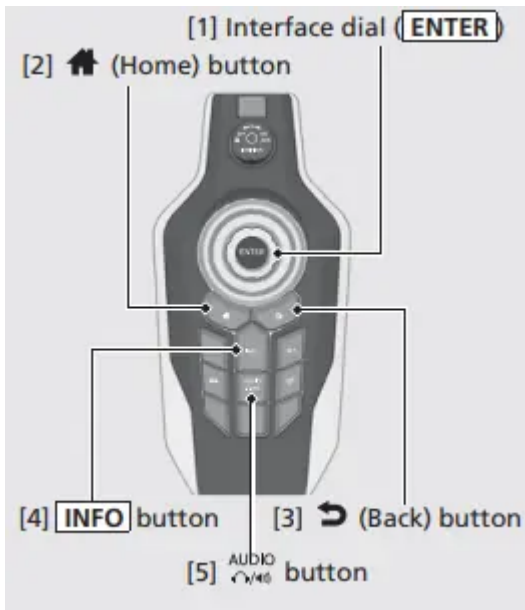

[1] (Interface dial): Rotate or move in the eight possible directions to select the available choices. Press to set your selection.

- When listening to the radio

Rotate or move : Switches to a higher-frequency

Rotate or move : Switches to a lower-frequency

Move and hold: Selects the next station with strong reception.

Move and hold: Selects the previous station with strong reception.

Move : Selects the next preset radio station.

Move : Selects the previous preset radio station.

- When listening to an iPod, USB flash drive or Bluetooth® audio

Move : Skips to the next song.

Move : Goes back to the beginning of the current or previous song.

- While the vehicle is in motion

Rotate : Adjusts a volume of the current audio mode and navigation mode.

[2] (Home) button: Select to go to the home screen.

[3] (Back) button: Press to go return the previous screen.

[4] button: Press to switch the information displayed on the information bar.

[5] button: Press to switch the audio output between the paired Bluetooth® headsets and the speakers.

Left Handlebar

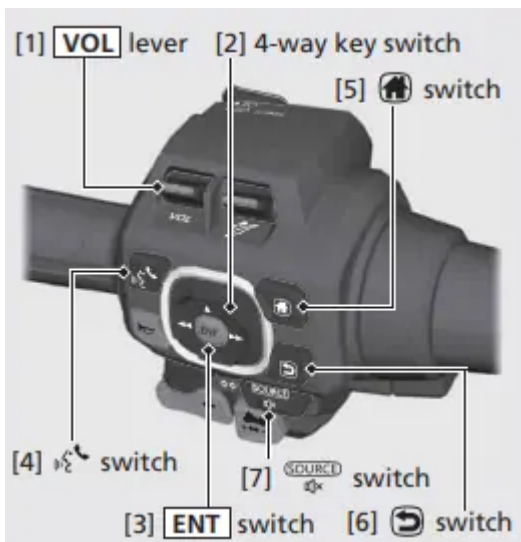

[1] **VOL** (volume control) lever: Push the lever up to increase the volume.

- To increase the volume: Push the lever up.
- To decrease the volume: Push the lever down.
- To increase the volume rapidly: Push up and hold the lever.
- To decrease the volume rapidly: Push down and hold the lever.

[2] 4-way key switch: Press right, left, up or down to select a menu item.

- When listening to the radio

Press ▲: Switches to a higher-frequency.

Press ▼: Switches to a lower-frequency.

Press and hold ▲: Selects the next station with strong reception.

Press and hold ▼: Selects the previous station with strong reception.

Press ►►: Selects the next preset radio station.

Press ◀◀: Selects the previous preset radio station

- When listening to an iPod, USB flash drive or Bluetooth® audio

Press ►►: Skips to the next song.

Press ◀◀: Goes back to the beginning of the current or previous song.

[3] **ENT** switch: Press to set your selection.

[4] (Voice control) switch: Press to receive, reject or end a call. Starts Siri or Google Assistant if Apple CarPlay or Android Auto are available.

[5] (Home) switch: Select to go to the home screen.

[6] (Back) switch: Press to return to the previous screen.

[7] (Source/Private Mode) switch:

Press to change the audio mode. Cycles through the audio modes as follows: [FM] -> [AM] -> [SXM] -> [USB] -> [iPod] -> [Bluetooth] -> [AUX] (option)

- When playing an audio

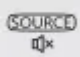
Press and hold  switch to mute the volume and to pause a track

- When receiving a call

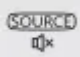
Press and hold  switch to enable/disable the private mode.

Display Message

Check Tuner

1. In SXM main screen: Channel, Artist, Category and Song meta data shall be blank. Channel meta data shall be displayed as “Check Tuner”.
2. In Travel Link screen: Popup shall be displayed. Popup screen remains on screen until tuner fixed.
3. If not in SXM main screen but SXM audio source: Channel meta data on the information bar shall be displayed as “Check Tuner”.

Loading

1. In SXM main screen: Channel, Artist, Category and Song meta data shall be blank. Channel meta data shall be displayed as “Loading”.
2. In Travel Link screen: Popup shall be displayed. Popup screen remains on screen until loading finished.
3. If not in SXM main screen but SXM audio source: Channel meta data on the information bar shall be displayed as “Loading”.

Check Antenna

Antenna Disconnected or Antenna Shorted

1. In SXM main screen: Channel, Artist, Category and Song meta data shall be displayed as blank. Channel meta data shall be displayed as “Check Antenna”. Show Artist meta data as “Antenna Disconnected” or “Antenna Shorted”.
2. In Travel Link screen: Popup shall be displayed. Popup screen remains on screen until error fixed.
3. If not in SXM main screen but SXM audio source: Channel meta data on the information bar shall be displayed as “Check Antenna”.

No Signal

1. In SXM main screen: Channel, Artist, Category and Song meta data shall be displayed as blank. Channel meta data shall be displayed as “No Signal”.

2. In Travel Link screen: Popup shall be displayed. Popup screen remains on screen until error fixed.
3. If not in SXM main screen but SXM audio source: Channel meta data on the information bar shall be displayed as “No Signal”.

Subscription Updated

1. In SXM main screen: Popup shall be displayed. Popup screen remains on screen until user select [OK] button.
2. In Travel Link screen: Popup shall be displayed. Popup screen remains on screen until user select [OK] button.
3. If not in SXM main screen but SXM audio source: Popup shall be displayed. Popup screen remains on screen until user select [OK] button.

Replay Memory Almost Full

1. In SXM main screen: Popup shall be displayed. Popup screen remains on screen until user select [OK] button.
2. If not in SXM main screen but SXM audio source: Popup shall be displayed. Popup screen remains on screen until user select [NO] or [YES] button.

Starting the Engine

Start your engine using the following procedure, regardless of whether the engine is cold or warm.

This vehicle is equipped with a Honda SMART Key system. Always keep Honda SMART Key on you when you ride the vehicle.

GL1800/B

!a Make sure the engine stop switch is in the  (Run) position.

!b Unlock the steering. (P55)

!c Turn the ignition switch to ON. (P49)

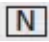
!d Shift the transmission to Neutral ( indicator comes on). Alternatively, pull in the clutch lever to start your vehicle with the transmission in gear so long as the side stand is raised.

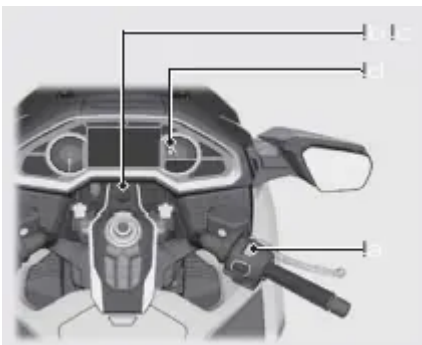

!e Press the start button with the throttle completely closed.



GL1800BD/D/DA

!aCheck the parking brake (P parking brake indicator comes on).

!bMake sure the engine stop switch is in the (Run) position.

!cUnlock the steering. (P55)

!dTurn the ignition switch to ON. (P49)

!eMake sure the (N) indicator comes on. If the (N) indicator does not come on.

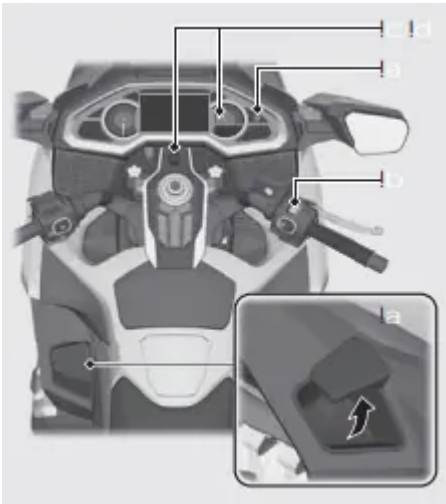

!ePress the start button with the throttle completely closed.

!fMake sure the parking brake lever is released before riding.

If the engine does not start:

!aOpen the throttle fully and press the start button once.

!bRepeat the normal starting procedure.

!cIf the engine starts, open the throttle slightly if idling is unstable.

!dIf the engine does not start, wait 10 seconds before trying steps !a & !b again.

Quick Engine Starting

You can also start the engine by the following procedure.

!aMake sure the status of the Honda SMART Key is active (P56) and enter the operating range. (P57)

!bWhile applying the brake lever or pedal firmly, press and hold the start button until engine starts.

- ☐ The steering lock is automatically unlocked at the same time.
- ☐ The quick engine starting will not operate if the transmission is in gear. The process will stop with the ignition switch ON. Start the engine with normal starting procedure. (P126)
- ☐ The engine will not start unless you perform the quick starting with correct conditions such as applying the brake. The process will stop with the ignition switch ON. Start the engine with normal starting procedure

Maintenance

Maintenance Schedule

The maintenance schedule specifies the maintenance requirements necessary to ensure safe, dependable performance, and proper emission control.

Maintenance work should be performed in accordance with Honda's standards and specifications by properly trained and equipped technicians. Your dealer meets all of these requirements. All scheduled maintenance is considered a normal owner operating cost and will be charged to you by your dealer. Keeping an accurate maintenance record will help ensure your vehicle is properly maintained. 2 P. 156

Make sure whoever performs the scheduled maintenance completes the maintenance record. Retain all service documents. If you sell your vehicle, these service documents should be transferred with the vehicle to the new owner.

Items	Frequency*1								Regular Replace	Refer to page
	x 1,000 mi x 1,000 km	0.6 1.0	4 6.4	8 12.8	12 19.2	16 25.6	20 32.0	24 38.4		
Fuel Line				I		I		I		-
Throttle Operation				I		I		I		179
Air Cleaner*2						R				-
Crankcase Breather*3			C	C	C	C	C	C		-
Spark Plug						R				-
Valve Clearance								I		-
Engine Oil			R		R		R		1 Year	171
Engine Oil Filter			R				R			-
Clutch Oil Filter (GL1800BD/D/DA)			R				R			-
Engine Idle Speed				I		I		I		-
Radiator Coolant*5				I		I		I	3 Years	172
Cooling System				I		I		I		-
Secondary Air Supply System						I				-
Evaporative Emission Control System*4						I				-
Final Drive Oil									3 Years	173
Brake Fluid*5			I	I	I	I	I	I	2 Years	174
Brake Pads Wear			I	I	I	I	I	I		175
Brake System				I		I		I		157
Brake Light Switch				I		I		I		176
Brake Lock Operation (GL1800BD/D/DA)			I	I	I	I	I	I		176
Headlight Aim				I		I		I		-
Clutch System (GL1800/B)				I		I		I		180
Clutch Fluid*1 (GL1800/B)			I	I	I	I	I	I	2 Years	178
Reverse Operation (GL1800/B)				I		I		I		-
Side Stand				I		I		I		177
Suspension				I		I		I		-
Nuts, Bolts, Fasteners				I		I		I		-
Wheels/Tires				I		I		I		-
Steering Head Bearings				I		I		I		-

Maintenance Level

 Intermediate. We recommend service by your dealer, unless you have the necessary tools and are mechanically skilled. Procedures are provided in an official Honda Service Manual. (2 P. 237)

 Technical. In the interest of safety, have your vehicle serviced by your dealer.

Maintenance Legend

 I : Inspect (clean, adjust, lubricate, or replace, if necessary)

 C : Clean

 R : Replace

Notes:

*1 : At higher odometer reading, repeat at the frequency interval established here.

*2 : Service more frequently when riding in unusually wet or dusty areas.

*3 : Service more frequently when riding in rain or at full throttle.

*4 : 50 STATE (meets California)

*5 : Replacement requires mechanical skill.

Maintenance Fundamentals

Pre-ride Inspection

To ensure safety, it is your responsibility to perform a pre-ride inspection and make sure that any problem you find is corrected. A pre-ride inspection is a must, not only for safety, but because having a breakdown, or even a flat tire, can be a major inconvenience.

Check the following items before you get on your vehicle:

- Tire tread wear and air pressures are within limits.
- Lights, horn, and turn signals operate normally.

Check the following items if you are carrying a passenger or cargo:

- Combined weight is within load limits.
- Cargo is secured properly.
- Suspension is adjusted to suit load.

Check the following items after you get on your vehicle:

- Throttle action moves smoothly without binding.
- Brake lever and pedal operate normally.
- Check the fuel level and refuel when needed.
- Engine stop switch functions properly.

Check the following items at regular intervals:

- Oil level is between the upper and lower level marks.
- Brake fluid level is

Front: above the LWR mark.

Rear: above the LWR mark.

- **GL1800/B** Clutch fluid level is above the LWR mark.
- Engine coolant level is between the UPPER and LOWER level marks.
- Side stand functions properly.
- **GL1800BD/D/DA** Parking brake works properly.

Periodic Checks

You should also perform other periodic maintenance checks at least once a month regardless of how often you ride, or more often if you ride frequently. Also, check the odometer reading against the Maintenance Schedule and perform all maintenance that is due

Tires and wheels

- Check the air pressure , examine tread for wear and damage , and check the wheels for damage.

Fluid levels

- Check the engine oil level , engine coolant level, clutch fluid level () (2 P. 178), final drive oil level and brake fluid level.

Lights

- Check that the headlight, brake lights, taillights, turn signals and license plate light are working properly.

Controls

- Check the freeplay of the throttle grip (2 P. 179). Check the clutch lever () (2 P. 180), front brake lever (2 P. 180), rear brake pedal, and parking brake () (2 P. 176) operate properly.

Fuses

- Check that you have a full supply of spare fuses.

Nuts & bolts

- Check the major nuts and bolts, and tighten as needed.

Replacing Parts

Always use Honda Genuine Parts or their equivalents to ensure reliability and safety. When ordering colored components, specify the model name, color and code mentioned on the color label. The color label is attached on the reverse side of the fuel lid.

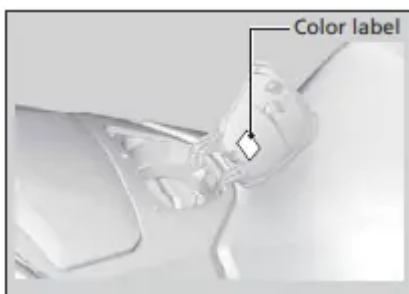

Battery

Your vehicle has a maintenance-free type battery. You do not have to check the battery electrolyte level or add distilled water. Clean the battery terminals if they become dirty or corroded. Do not remove the battery cap seals. There is no need to remove the cap when charging.

What to do in an emergency

If any of the following occur, immediately see your doctor.

- Electrolyte splashes into your eyes:
 - ↳ Wash your eyes repeatedly with cool water for at least 15 minutes. Using water under pressure can damage your eyes.
- Electrolyte splashes onto your skin:
 - ↳ Remove affected clothing and wash your skin thoroughly using water.
- Electrolyte splashes into your mouth:
 - ↳ Rinse mouth thoroughly with water, and do not swallow.

Cleaning the Battery Terminals

1. Remove the battery.
2. If the terminals are starting to corrode and are coated with a white substance, wash with warm water and wipe clean.
3. If the terminals are heavily corroded, clean and polish the terminals with a wire brush or sandpaper. Wear safety glasses.
4. After cleaning, reinstall the battery.

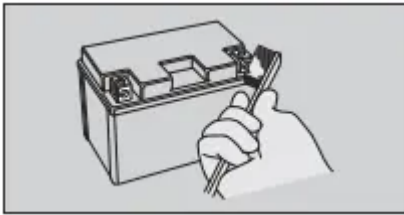

The battery has a limited life span. Consult your dealer about when you should replace the battery. Always replace the battery with another maintenance-free battery of the same type.

Charging

If you use electrical accessories that drain the battery or you do not ride frequently, we recommend that you charge the battery every 30 days using a charger designed specifically for your Honda, which can be purchased from your dealer. Read the information that came with your battery charger and follow the instructions on the battery. Avoid using an automobile-type battery charger, as these can overheat a vehicle battery and cause permanent damage.

Make sure the ignition switch is turned to OFF before charging the battery.

Fuses

Fuses protect the electrical circuits on your vehicle. If something electrical on your vehicle stops working, check for and replace any blown fuses.

Inspecting and Replacing Fuses

Turn the ignition switch OFF to remove and inspect fuses. If a fuse is blown, replace with a fuse of the same rating. For fuse ratings, see “Specifications.”

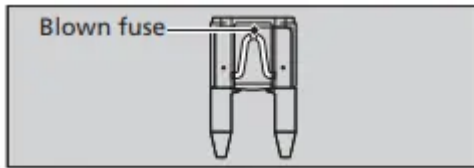

If a fuse fails repeatedly, you likely have an electrical fault. Have your vehicle inspected by your dealer.

Engine Oil

Engine oil consumption varies and oil quality deteriorates according to riding conditions and time elapsed. Check the engine oil level regularly, and add the recommended engine oil if necessary. Dirty oil or old oil should be changed as soon as possible.

Brake Fluid (Clutch Fluid)

Do not add or replace brake fluid, except in an emergency. Use only fresh brake fluid from a sealed container. If you do add fluid, have the brake and clutch system serviced by your dealer as soon as possible.

Recommended Coolant

Pro Honda HP Coolant is a pre-mixed solution of antifreeze and distilled water. A concentration of antifreeze below 40% will not provide proper corrosion and cold temperature protection. A concentration of up to 60% will provide better protection in colder climates

Crankcase Breather

Service more frequently when riding in rain, at full throttle, or after the vehicle is washed or overturned. Service if the deposit level can be seen in the transparent section of the drain tube. If the drain tube overflows, the air filter may become contaminated with engine oil causing poor engine performance.

Tires (Inspecting/Replacing)

Checking the Air Pressure

Even though your vehicle is equipped with tire pressure monitoring system (TPMS), visually inspect your tires and use an air pressure gauge to measure the air pressure at least once a month or any time you think the tires look low. Always check air pressure when your tires are cold.

GL1800/D/DA

Do not adjust tire pressure using the values indicated on the tire pressure gauge of the INFO 1 display.

The tire pressure values indicated on the tire pressure gauge of the INFO 1 display may not match actual values, because the tire pressure gauge indication is not updated instantly and is updated only at a certain period.

Even if the direction of the valve stem is changed, do not return it to the original position. Have your vehicle inspected by your dealer.

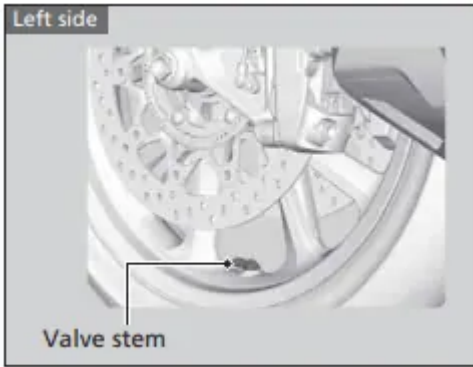

Inspecting for Damage



Inspect the tires for cuts, slits, or cracks that exposes fabric or cords, or nails or other foreign objects embedded in the side of the tire or the tread. Also inspect for any unusual bumps or bulges in the side walls of the tires.

Inspecting for Abnormal Wear

Inspect the tires for signs of abnormal wear on the contact surface.

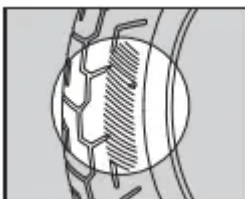

Inspecting Tread Depth

Inspect the tread wear indicators. If they become visible, replace the tires immediately.

For safe riding, you should replace the tires when the minimum tread depth is reached.

Have your tires replaced by your dealer.

For recommended tires, air pressure and minimum tread depth, see “Specifications.” Follow these guidelines whenever you replace tires.

- Use the recommended tires or equivalents of the same size, construction, speed rating, and load range.
- Have the wheel balanced with Honda Genuine balance weights or equivalent after the tire is installed.
- Do not install a tube inside a tubeless tire on this vehicle. Excessive heat build-up can cause the tube to burst.
- Use only tubeless tires on this vehicle. The rims are designed for tubeless tires, and during hard acceleration or braking, a tube-type tire could slip on the rim and cause the tire to rapidly deflate.
- Each wheel is equipped with a tire pressure sensor mounted inside the tire behind the valve stem. You must use TPMS specific wheels. Not using TPMS specific wheels can cause an air leak, a tire pressure monitoring system failure, or both.

Tire Service Life

The service life of your tires is dependent on many factors, including, but not limited to, riding habits, road conditions, vehicle loading, tire air pressure, maintenance history, speed, and environmental conditions (even when the tires are not in use). In addition to your regular inspections and maintenance, it is recommended that you have annual inspections performed once the tires reach 5 years old. It is also recommended that all tires be removed from service after 10 years from the date of manufacture, regardless of their condition or state of wear. The last four digits of the TIN (tire identification number) indicate the date of manufacture.

Removing & Installing Body Components

Battery

| Removal

Make sure the ignition switch is turned to OFF.

After turning the ignition switch OFF, wait more than 60 seconds and then remove the negative cable of the battery. Because the electrical system may not function correctly.

1. Remove the left side cover.
2. Disconnect the negative - terminal from the battery.
3. Disconnect the positive + terminal from the battery.

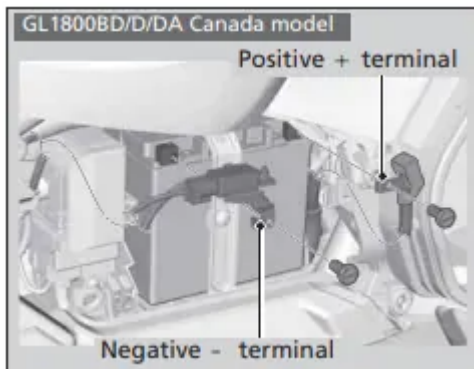
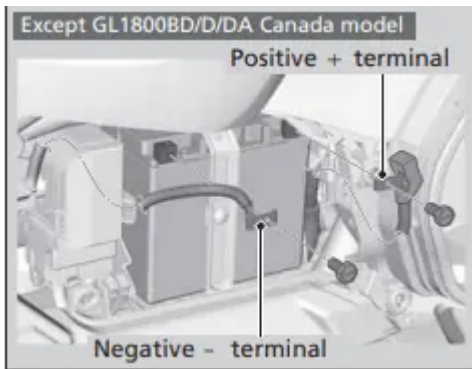

4. Remove the battery holder bolt.
5. Swing the battery holder as shown to avoid interference against the seat.

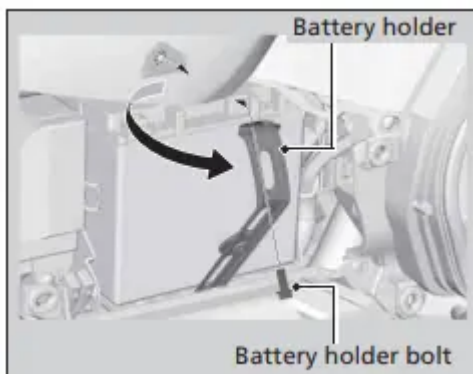

6. Remove the battery holder from the hook.
7. Remove the battery taking care not to drop the terminal nuts.

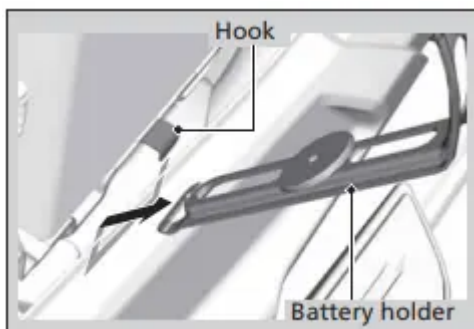

Cylinder Head Side Cover

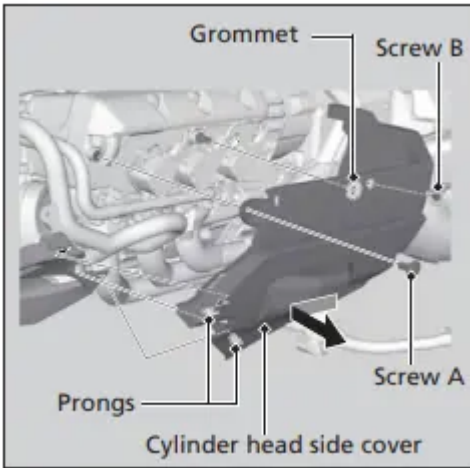

The right and left cylinder head side cover can be removed in the same way.

| Removal

1. Remove the fog light cover.
2. Remove the screw A and B.
3. Remove the prongs from the lower cover.
4. Pull the grommet from the boss on the cylinder head and slide the cylinder head side cover forward, then remove it.

| Installation

Install the parts in the reverse order of removal.

Fog Light Cover

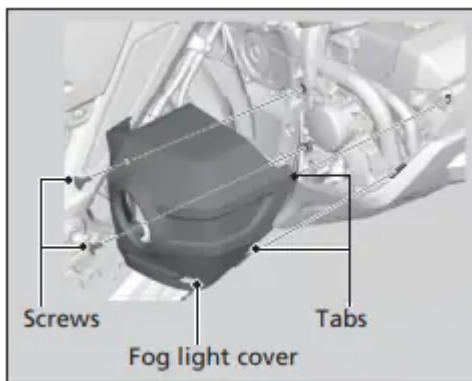

The right and left fog light cover can be removed in the same way.

| Removal

1. Remove the screws.
2. Release the tabs from the cylinder head side cover.
3. Remove the fog light cover.

| Installation

Install the parts in the reverse order of removal.

Left Engine Side Cover



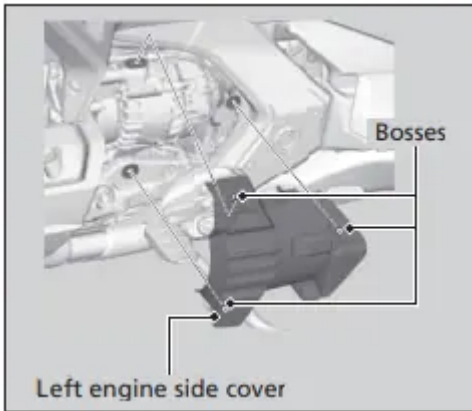

| Removal

1. Release the bosses from the grommets.
2. Remove the left engine side cover.

Side Cover

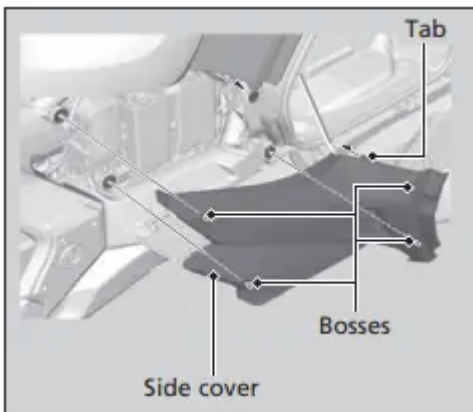

The right and left side cover can be removed in the same way.

| Removal

1. Open the saddlebag. 2 P. 142
2. Remove the bosses.
3. Release the tab from the saddlebag cover.
4. Remove the side cover.

Engine Oil

Engine Oil

Checking the Engine Oil

Check the engine oil with the Idling Stop system disabled.

1. If the engine is cold, idle the engine for 3 to 5 minutes.
2. Turn the ignition switch OFF and wait for 2 to 3 minutes.
3. Place your vehicle in an upright position on a firm, level surface.
4. Remove the dipstick and wipe it clean.
5. Insert the dipstick until it seats, but don't screw it in.

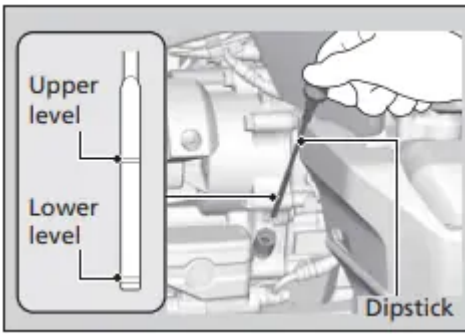

6. Check that the oil level is between the upper level and lower level marks on the dipstick.

7. Securely install the dipstick.

Adding Engine Oil

If the engine oil is below or near the lower level mark, add the recommended engine oil.

1. Remove the oil fill cap. Add the recommended oil until it reaches the upper level mark.

- ▣ Place your vehicle in an upright position on a firm, level surface when checking the oil level.
- ▣ Do not overfill above the upper level mark.
- ▣ Make sure no foreign objects enter the oil filler opening.
- ▣ Wipe up any spills immediately.

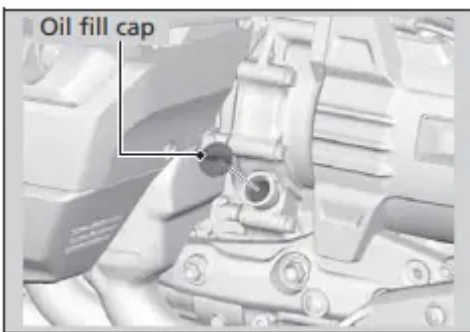

2. Securely reinstall the oil fill cap

Coolant

Checking the Coolant

Check the coolant level in the reserve tank while the engine is cold.

1. Place your vehicle on a firm, level surface.
2. Remove the left engine side cover.
3. Hold your vehicle in an upright position.
4. Check that the coolant level is between the UPPER level and LOWER level marks in the reserve tank.

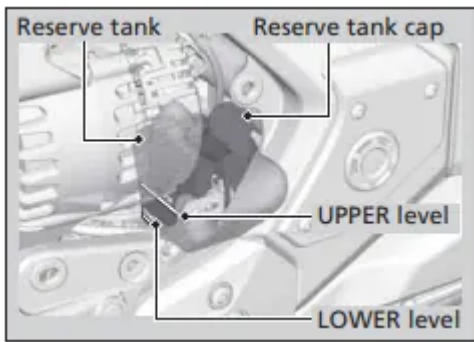

If the coolant level is dropping noticeably or the reserve tank is empty, you likely have a serious leak. Have your vehicle inspected by your dealer.

Adding Coolant

If the coolant level is below the LOWER level mark, add the recommended coolant until the level reaches the UPPER level mark.

Add fluid only from the reserve tank cap and do not remove radiator cap.

1. Remove the left engine side cover.
2. Remove the reserve tank cap and add fluid while monitoring the coolant level.
 - ▢ Do not overfill above the UPPER level mark.
 - ▢ Make sure no foreign objects enter the reserve tank opening.
3. Securely reinstall the reserve tank cap.
4. Install the left engine side cover.

Troubleshooting

Engine Will Not Start

Starter Operates But Engine Does Not Start

Check the following items:

- Check the correct engine starting sequence
- Check that there is gasoline in the fuel tank
- Check if the PGM-FI (Programmed Fuel Injection) Malfunction Indicator Lamp (MIL) is on
 - ▢ If the indicator lamp is on, contact your dealer as soon as possible.

Starter Does Not Operate

Check the following items:

- Check the correct engine starting sequence 2 P. 126
- Check for a blown fuse 2 P. 213
- Check for a loose battery connection or battery terminal corrosion
- Check the condition of the battery

If the problem continues, have your vehicle inspected by your dealer.

Overheating (High coolant temperature indicator is on

The engine is overheating when the following occurs:

- High coolant temperature indicator comes on.
- The 6th (H) segment flashes in the coolant temperature gauge.
- Acceleration becomes sluggish.

If this occurs, pull safely to the side of the road and perform the following procedure.

Extended fast idling may cause the high coolant temperature indicator to come on.

Also the 6th (H) segment will flash.

1. Stop the engine, and then turn the ignition switch to ON.
2. Check that the radiator fan is operating, and then turn the ignition switch to OFF.

If the fan is not operating:

Suspect a fault. Do not start the engine.

Transport your vehicle to your dealer.

If the fan is operating:

Allow the engine to cool with the ignition switch turned OFF.

3. After the engine has cooled, inspect the radiator hose and check if there is a leak.

If there is a leak:

Do not start the engine. Transport your vehicle to your dealer.

4. Check the coolant level in the reserve tank.

☐ Add coolant as necessary.

5. If 1 - 4 check normal, you may continue riding, but closely monitor the coolant temperature gauge.

Warning Indicators On or Flashing

Low Oil Pressure Indicator

If the low oil pressure indicator comes on, pull safely to the side of the road and stop the engine.

1. Check the engine oil level, and add oil as necessary.
2. Start the engine.

☐ Only continue riding if the low oil pressure indicator goes off.

Rapid acceleration may momentarily cause the low oil pressure indicator to come on, especially if the oil is at or near the low level.

If the low oil pressure indicator stays on when the oil level is at the proper level, stop the engine and contact your dealer.

If the engine oil level goes down rapidly, your vehicle may have a leak or another serious problem. Have your vehicle inspected by your dealer.

PGM-FI (Programmed Fuel Injection) Malfunction Indicator Lamp (MIL)

If the indicator comes on while riding, you may have a serious problem with the PGMFI system. Reduce speed and have your vehicle inspected by your dealer as soon as possible.

Combined ABS Indicator

If the Combined ABS indicator operates in one of the following ways, your brakes will continue to work as a conventional system, but without the Combined ABS function. Reduce your speed and have your vehicle inspected by your dealer as soon as possible.

- Indicator does not come on when the ignition switch is turned ON
- Indicator does not go off at speeds above 3 mph (5 km/h)
- Indicator comes on or starts flashing while riding

The combined ABS indicator may flash if:

- The front wheel leaves the ground for 1 second or more
- You turn the rear wheel while your vehicle is lifted off the ground.

This is normal but the Combined ABS is not in operation. To activate the system again, turn the ignition switch to OFF, and then to ON again.

Torque Control Indicator

If the indicator operates in one of the following ways, you may have a serious problem with the Torque Control. Reduce your speed and have your vehicle inspected by your dealer as soon as possible.

- Indicator comes on while riding.
- Indicator does not come on when the ignition switch is turned on.
- Indicator does not go off at speeds above 3 mph (5 km/h).

Even when the Torque Control indicator is on, your vehicle will have normal riding ability without Torque Control function.

ⓘ When the indicator comes on while the Torque Control is in operation, you will have to completely close the throttle to regain normal riding ability.

The Torque Control indicator may come on if you rotate the rear wheel while your vehicle is lifted off the ground. In this case, turn the ignition switch to OFF and then ON again. The Torque Control indicator will go off after your speed reaches 3 mph (5 km/h).

Honda SMART Key Indicator

| If the Honda SMART Key Indicator Flashes 5 times When the Ignition Switch is Turned ON

Replacing the Honda SMART Key Battery

| When the Honda SMART Key Indicator is Flashing While the Electrical System is On

The Honda SMART Key indicator flashes when communication between your vehicle and Honda SMART Key stops after turning on the ignition switch.

It is probably caused by the following:

- Strong radio waves or noise are affecting the system
- You lost the Honda SMART Key while riding

However, this does not affect the operation of your vehicle until the ignition switch turned OFF.

You may not be able to turn off the electrical system when losing the Honda SMART Key while riding, or if the battery is low, or because the system is affected by strong radio waves or noise. If this occurs, turn the ignition switch counterclockwise and hold it until the electrical system shut off.

If you do not have the Honda SMART Key, the electrical system can be activated by means of emergency procedures.

Clutch Temperature Indicator

GL1800BD/D/DA

The clutch temperature indicator flashes if the clutch temperature becomes unusually high.

If the indicator flashes, pull safely to the side of the road and shift the transmission to neutral, then idle the engine.

When the indicator goes off, riding can be restarted.

If this occurs frequently, contact your dealer.

Low Tire Pressure Indicator

If the low tire pressure indicator flashes, check your tires as soon as possible. If the low tire pressure indicator lights constantly, one or more of your tires is significantly underinflated. You should stop and check your tires as soon as possible.

For more information on temporary repair, refer to “Emergency Repair Using a Tire Repair Kit.”

Check the air pressure when the tires are cold. (This means the vehicle has been parked for at least 3 hours.) Adjust to the recommended tire pressures if necessary.

When the low tire pressure indicator flashes or comes on, but you continue to ride, the low tire pressure indicator will go off in some cases. It is still necessary to check the air pressures of both tires after the tires cool because air in the tires is expanded with heat.

If the low tire pressure indicator does not go off after inflating the tires to the specified values, have your dealer to check the system as soon as possible.

Riding on an underinflated tire causes the tire to overheat and can lead to tire failure.

Under-inflation also reduces fuel efficiency and tire tread life, and may affect the vehicle's handling and stopping ability.

Because tire pressure varies by temperature and other conditions, the low tire pressure indicator may turn on unexpectedly.

Please note that the TPMS is not a substitute for proper tire maintenance, and it is the rider's responsibility to maintain correct tire pressure, even if under-inflation has not reached the level of turning on the low tire pressure indicator.

For example, if you check and fill your tires in a warm area, then ride in extremely cold weather, the tire pressure will be lower than measured and could be underinflated and cause the low tire pressure indicator to turn on. Or, if you check and adjust your tire pressure in cooler conditions, and ride into extremely hot conditions, the tire may become overinflated. However, the low tire pressure indicator will not turn on if the tires are overinflated.

TPMS Indicator

The TPMS indicator comes on if there is a problem with the tire pressure monitoring system.

If this occurs, the system will shut off and no longer monitor tire pressure.

Have the system checked by your dealer as soon as possible.

Also the TPMS indicator may light for the following reasons:

- Interference of other electronic devices by using the same radio frequency.
- Using replacement wheels not equipped with tire pressure sensors.

AIRBAG Indicator

GL1800DA

The AIRBAG indicator comes on if there is a problem with the airbag system.

If the indicator does not come on, or comes and stays on when the ignition switch is turned on, or comes on while you are riding, have your vehicle inspected by your dealer as soon as possible as the airbag may not deploy when it could help save your life.

Hill Start Assist (HSA) Indicator

If the Hill start assist (HSA) indicator comes on in amber in one of the following ways, you may have a serious problem with the HSA system.

Reduce speed and have your vehicle inspected by your dealer as soon as possible.

- Indicator comes on in amber while riding.
- Indicator does not come on when the ignition switch is turned to ON.
- Indicator does not go off at speeds above 3 mph (5 km/h).
- Even when the Hill start assist (HSA) indicator comes on in amber, your vehicle will have normal riding ability without HSA function.

If the Hill start assist (HSA) indicator comes on in white while stopping the vehicle, this is normal and the HSA is working properly

Other Warning Indications

Fuel Gauge Failure Indication

If the fuel system has an error, the fuel gauge segments will be displayed as shown in the illustration. If this occurs, see your dealer as soon as possible.

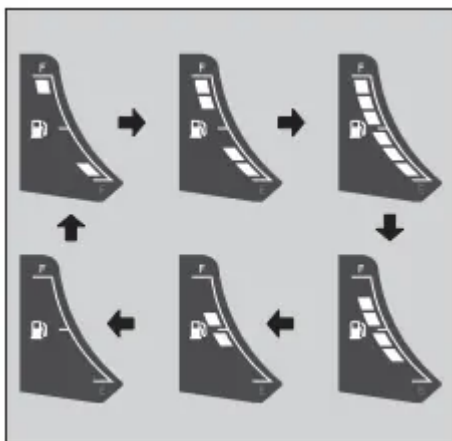
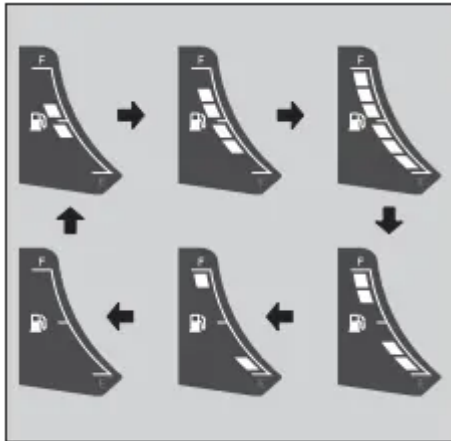

Handle Grip Heater Failure Indication

GL1800/D/DA

If the handle grip heater system has an error, the handle grip heater indicator will blink. If this occurs, see your dealer as soon as possible

Seat Heaters Failure Indication

If the seat heater system has an error, the seat heater indicator will blink.

If this occurs, see your dealer as soon as possible.

Coolant Temperature Gauge Failure Indication

If the cooling system has an error, all segments will blink as shown in the illustration.

If this occurs, see your dealer as soon as possible.

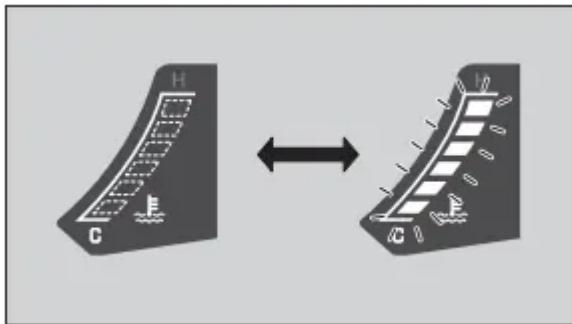

If the “-” is Blinking in the Gear Position Indicator While Riding (GL1800BD/D/DA)

If the “-” is blinking in the gear position indicator while riding, you may have a serious problem with the Dual Clutch Transmission system.

Park your vehicle in a safe place and have your vehicle inspected by dealer immediately.

It may be possible to ride your vehicle by following the steps below.

1. Turn the ignition switch to OFF.
2. Turn the ignition switch to ON and start the engine.

If you cannot start the engine:

Turn the ignition switch to OFF and move the vehicle back and forth slightly (to disengage the gears).

Turn the ignition switch to ON again and start the engine.

If you still cannot start the engine:

Start the engine while applying the brake lever or pressing the brake pedal.

If you can shift from N to D range:

When a gear position is shown in the gear position indicator, you can ride in that gear.

Take your vehicle to your dealer riding at a safe speed.

If you can't shift from N to D range and the “-” is blinking:

Possible damage to the DCT is preventing you from riding.

Have your vehicle inspected by your dealer immediately.

When the Idling Stop System Does Not Operate Properly (GL1800BD/D/DA Canada model)

Idling Stop Indicator Does Not Come On

When the Idling Stop indicator does not come on, perform the followings.

- If the Idling Stop system is off:
 - Press the start/Idling Stop button or set the Idling Stop system at the multi-information display.
- If the engine is cold:
 - Warm up the engine.
 - The Idling Stop system does not operate when the engine is cold.
- If you did not ride the vehicle after engine starts:
 - Ride the vehicle at speeds of over 6 mph (10 km/h). The Idling Stop system does not operate until you ride once.
- If PGM-FI malfunction indicator lamp (MIL) lights:
 - When the PGM-FI malfunction indicator lamp (MIL) lights, the Idling Stop system does not operate for protection of the engine. See your dealer.
- If the battery voltage is low:
 - Ride the vehicle for a while, then stop the engine and then restart the engine, referring to the correct engine starting procedure (2 P. 126). The Idling Stop system may not operate if the battery voltage is low.
 - If this occurs frequently, contact your dealer.
- If the temperature of the battery is cold:
 - Ride the vehicle for a while.
 - The Idling Stop system does not operate when the battery is cold.

Engine is Not Stopped by the Idling Stop System While the Idling Stop Indicator is On

When the engine is not stopped by Idling Stop system while the Idling Stop indicator is on, perform the following.

- If the vehicle does not stop completely:
 - Stop the vehicle completely. The Idling Stop system operates if the speed is only at 0 mph (0 km/h).
- If the throttle is not closed completely:
 - Close the throttle completely.
- If the Hill start assist (HSA) is operated:
 - The Idling Stop system does not stop the engine while the HSA is operated.
- When the transmission is shifted in Neutral:
 - The Idling Stop system does not stop the engine when the transmission is shifted in Neutral (N side of the N-D switch is pressed).

Engine Does Not Start Even If the Throttle is Opened

Engine does not start even if the throttle is opened, perform the followings.

- If the side stand is down
 - While the engine is stopped by the Idling Stop system, if you operate the side stand, the flashing Idling Stop indicator changes flashing to off, and the Idling Stop system is cancelled. Restart the engine with the start/Idling Stop button, referring to the starting procedure for standard engine starting.
- If the rider does not sit astride the vehicle
 - When the rider has not been sitting astride the vehicle for approx. 3 minutes, the Idling Stop indicator changes from flashing to off and you cannot restart the engine, even if you open the throttle.
 - Restart the engine with the start/Idling Stop button, referring to the starting procedure for standard engine starting.
- If the start/Idling Stop button is operated:
 - While the engine is stopping by the Idling Stop system, if you press the start/Idling Stop button, the Idling Stop system will be cancelled.
 - Restart the engine with the start/Idling Stop button, referring to the starting procedure for standard engine starting.
 - If the Idling Stop indicator flashes, but engine does not start even if the throttle is opened, perform the followings.
- Battery lead is loose:
 - Check the battery terminals.

When the Honda SMART Key System Does Not Operate Properly

When the Honda SMART Key system does not work properly, perform the following.

- Check that the Honda SMART Key system is activated.

Lightly press the ON/OFF button on the Honda SMART Key.

If the Honda SMART Key LED does not blink 3 times, activate the Honda SMART Key system.

If the Honda SMART Key LED does not respond, replace the battery of the Honda SMART Key.

- Check that there is no communication failure in the Honda SMART Key system.

The Honda SMART Key system uses low intensity radio waves. The Honda SMART Key system may not work properly in the following condition:

- ▣ When there are facilities nearby that generate strong radio waves or noise such as TV towers, power stations, radio stations, or airports.
- ▣ When you carry the Honda SMART Key with a laptop or wireless communication device such as a radio or mobile phone.
- ▣ When the Honda SMART Key comes into contact with or is covered by metal objects.

- Check that a registered Honda SMART Key is used.

Use a registered Honda SMART Key.

The Honda SMART Key system cannot be activated without a registered Honda SMART Key.

- Make sure that you do not use a broken Honda SMART Key.

If you use a broken Honda SMART Key, the Honda SMART Key system cannot be activated. Bring the emergency key and ID tag to your dealer.

- Check the battery condition and battery lead in your vehicle.

Check the battery and battery terminals.

If the battery is weak, contact your dealer.

If the Honda SMART Key system cannot be activated due to other causes, contact your dealer.

Activating the Electrical System in an Emergency

The electrical system can be activated by inputting the ID number.

| Set to ID number input mode

1. Open the left and right saddlebags by the emergency procedures.
2. Press and hold the start button for more than 4 seconds.

↳ The buzzer sounds and the system enters the ID number input mode.

3. Check the ID number on the ID tag



| ID number input

You can input your ID number by pressing the fairing pocket opener and the start button. Input the ID number on the ID tag starting with the digit on the left by pressing the fairing pocket opener. The ID number is input according to the number of times the fairing pocket opener is pressed. Press the fairing pocket opener the desired number of times, then press the start button to fix the current digit (the buzzer sounds), and input the next digit, and then repeat until all the digits are input. While inputting the ID number, if the button is not pressed for about 20 seconds, the inputted ID number is cancelled and the system returns to the state before ID number input (the buzzer sounds)

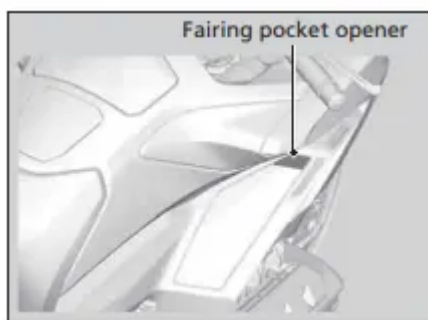

ID number input success:

After the last digit of the ID number is inputted and the start button is pressed, the ID number is authenticated. The steering will be unlocked (if it is locked) and the electrical system activated. You can start the engine.

You can turn off the engine and electrical system and also lock the steering using the ignition switch.

To activate the electrical system again, repeat the procedures for ID number input.

ID number input failure:

If the ID number is not authenticated after inputting, the steering cannot be unlocked and the electrical system will not activate.

Repeat the procedures for ID number input from the beginning.

ID number input cancel

If you input the wrong number, you can cancel ID number input by not pressing the button for about 20 seconds (the buzzer sounds).

Repeat the procedures for ID number input from the beginning.

If the Saddlebags or Travel Trunk Won't Open

The built-in key can be used to open the left saddle bag when the Honda SMART Key battery becomes weak. If you lose the Honda SMART Key, the left saddlebag can be unlocked using the emergency key. To remove the built-in key, pull it out by pressing the release button on the Honda SMART Key. To reinstall the built-in key, push the built in key into the Honda SMART Key until it clicks.

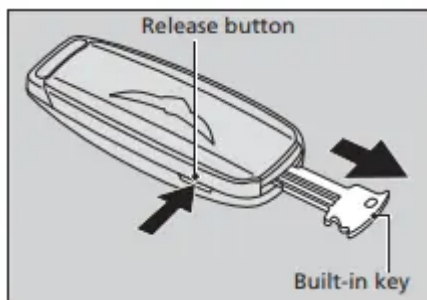

To Open the Saddlebags Emergency

1. Remove the rear center lid by using a flat head screwdriver covered with a protective cloth.

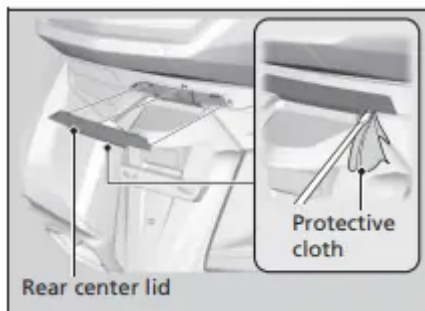

2. Remove the built-in key from the Honda SMART Key.
3. Insert the built-in key or emergency key in the left saddlebag opener and turn it clockwise to open the left saddlebag.

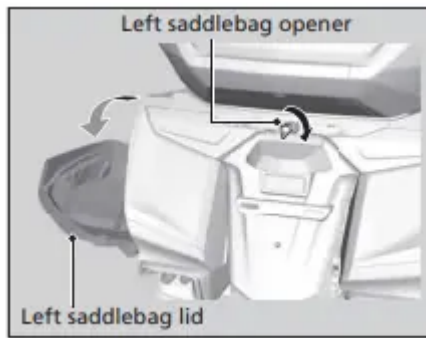

4. Release the right saddlebag opener from the prong in the left saddlebag. Pull the right saddlebag opener to open the right saddlebag.

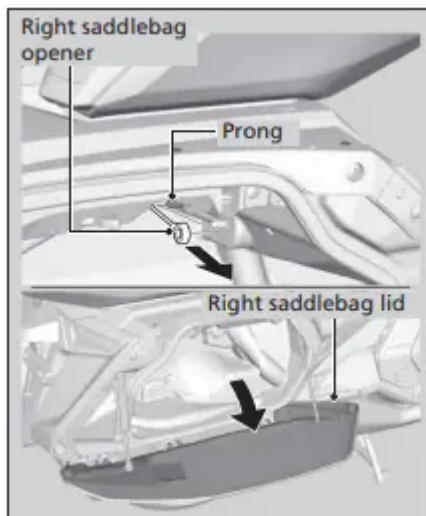

5. Install the right saddlebag opener onto the prong before closing the saddlebags.

To Open the Travel Trunk Emergency

1. Open the left and right saddlebags.
2. Release the travel trunk opener from the prong in the right saddlebag. Pull the travel trunk opener to open the travel trunk.

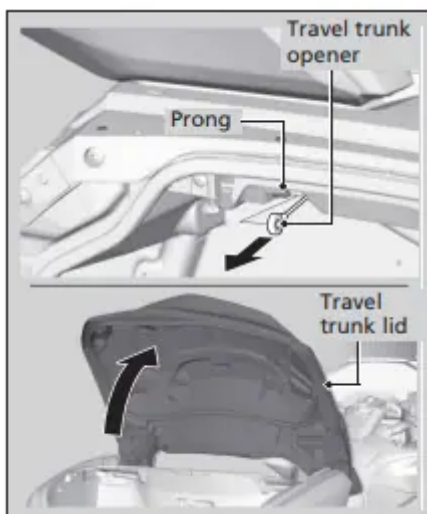

3. Install the travel trunk opener onto the prong before closing the right saddlebag.

Tire Puncture

Repairing a puncture or removing a wheel requires special tools and technical expertise. We recommend you have this type of service performed by your dealer. After an emergency repair, always have the tire inspected/replaced by your dealer.

Emergency Repair Using a Tire Repair Kit

If your tire has a minor puncture, you can make an emergency repair using a tubeless tire repair kit. Follow the instructions provided with the emergency tire repair kit. Riding your vehicle with a temporary tire repair is very risky. Do not exceed 30 mph (50 km/h). Have the tire replaced by your dealer as soon as possible

Audio System Trouble



Symptom	Cause/remedy
<p>Unable to pair Bluetooth® device</p>	<p>Some Bluetooth® devices and application software you use may be incompatible with the audio system and/or the operable functions may be limited.</p> <p>Check that the audio system and Bluetooth® device are both in the pairing mode. 2 P. 85, 90</p> <p>The audio system may not be properly connected when another Bluetooth® device is being paired at the same time. Check your surroundings to make sure no other device being paired is present before re-pairing. Presence of a Bluetooth® device in the vicinity sometimes affects the pairing due to radio wave interference, etc.</p> <p>When connecting a Bluetooth® device, make sure no other Bluetooth® device readied for pairing is present. Presence of a Bluetooth® device in the vicinity sometimes affects the pairing due to radio wave interference, etc.</p> <p>When you repeatedly fail in pairing, delete the paired device once, then try pairing again.</p>
<p>Unable to connect Bluetooth® device</p>	<p>Depending on the Bluetooth® device and application software you use, it may take some time for the audio system to connect to a device and to start playing an audio file.</p> <p>The connection may be temporarily disconnected when starting the engine, which is normal and not a malfunction. The Bluetooth® device will be reconnected after the engine is started.</p> <p>Check that your Bluetooth® device has been paired. Referring to the instruction manual of your Bluetooth® device, check that your Bluetooth® device is in connectable state.</p>
<p>Unable to connect Bluetooth® phone device</p>	<p>Some Bluetooth® devices and application software you use may not connect automatically. For connecting, follow the instructions in the instruction manual of your Bluetooth® device.</p> <p>The Bluetooth® devices that can be connected at the same time are limited to one Bluetooth® device and two Bluetooth® headsets.</p>



Symptom	Cause/remedy
	<p>If the problem continues after the above-described inspection, delete the paired device once, then try pairing again.</p> <p>The Bluetooth® connection cannot be established while launching Apple CarPlay/Android Auto. Quit Apple CarPlay/Android Auto, then try pairing again. 2</p> <p>While connected to Apple CarPlay/Android Auto, Bluetooth function is disabled.</p>
<p>Connected, but does not play.</p>	<p>Some Bluetooth® devices and application software you use may be incompatible with the audio system and/or audio files may not be played properly. Check the recommended specifications.</p> <p>Depending on the Bluetooth® device and application software you use, an audio file may not play automatically. For playing, follow the instructions in the instruction manual of your Bluetooth® device.</p> <p>Depending on the Bluetooth® device and application software you use, an audio file may not play normally after receiving a telephone call, etc. Check that your Bluetooth® device is in playable state.</p>
<p>Takes some time to start playing after turning the power on or changing the audio mode.</p>	<p>Right after the power is turned on or the audio mode is changed, the audio system may take some time to connect to an audio device and to start playing an audio file. Also, the audio system may not allow any audio control operation while preparing to play an audio file.</p>
<p>Sounds skip Noises mix</p>	<p>Presence of another Bluetooth® device or a device that emits electromagnetic waves such as communication equipment in the vicinity sometimes affects the communication.</p> <p>Due to the characteristics of Bluetooth®, though in rare cases, the system operation may become unstable. When it remains unstable, turn off the power to the audio system or the device being used, and then turn it on again.</p> <p>The storage location of the Bluetooth® device sometimes affects the audio system and communication. When sounds skip or noises mix, change the location of the device. For</p>



Symptom	Cause/remedy
	<p>example, when the device is kept in a pocket of clothing sandwiched in between the rider and passenger, the communication may be affected. For Bluetooth® antenna locations, refer to Audio System Location. Also, weather, buildings in the vicinity, road conditions, etc. can sometimes affect the communication.</p> <p>Depending on the Bluetooth® device and application software you use, an audio file may not play normally after receiving a telephone call, etc. Change the audio mode or turn off the power to the audio system and then turn it on again. If the skipping of sounds or mixing of noises continues, check the status of your Bluetooth® device.</p> <p>If the skipping of sounds or mixing of noises continues, delete the paired device once, then try pairing again.</p> <p>Check the recommended specifications.</p>
Audio volume from headset is small/big.	<p>Check the volume setting of the paired headset.</p> <p>Adjust the volume while in the individual modes.</p>
No or inaccurate display	<p>Depending on the audio device and the audio file, nothing may be displayed or the display may be inaccurate in some cases. Check the information on available tags. 2 P. 105</p> <p>When the information in an audio file such as the artist name and track title is in a non-compliant tag format, it may be indicated by “.” or no information will be shown.</p> <p>Depending on the type of the album art used for the music information of audio files, the album art may not be displayed. The system supports ID3v2 as available tag for album art. Check the album art format of the audio file.</p> <p>The system does not support album art display via Bluetooth® connection.</p>
About USB device	<p>Some USB devices may be incompatible with the audio system and/or their operable functions may be limited.</p>



Symptom	Cause/remedy
	<p>When the audio system does not recognize the USB device connected to the USB connector, turn the ignition switch OFF and then turn it on again.</p> <p>When a large number of files are stored in the USB device, it sometimes takes a long time before an audio file starts playing. Reduce the number of files in the USB device.</p> <p>Check that the audio files stored in the USB device is in a playable file format.</p>
USB failure	<p>USB function may be unusable when the system failure occurs. USB connection may recover by turning the ignition switch OFF, and then ON again.</p>
Bluetooth® handsfree calling cannot be available	<p>Connected Bluetooth® device may be unsupported device. Check the supported Bluetooth® version/profiles.</p> <p>When the Bluetooth® connection is unstable due to surrounding conditions or radio wave conditions, the handsfree calling functions may not be available.</p> <p>To use the Bluetooth® handsfree calling, a headset connection is necessary. Connect a paired headset.</p>
During a call, headset volume is small/big.	<p>Adjust the volume during a call</p>
Passenger's headset is no sound.	<p>If [Private mode] is enabled, no sound comes from the passenger's headset. Check [Private mode] setting</p>
About Phonebook	<p>Since the phonebook is stored in the system, it may be displayed even when connecting another phone.</p>
Bluetooth® Handsfree Calling	<p>Depending on the connection status, the times displayed in call history on the vehicle side or the phone side may differ.</p> <p>Depending on your mobile carrier plan, available functions may differ.</p>



Symptom	Cause/remedy
	<p>A display delay may occur depending on the number of phone books, call history and music data etc. stored in the connected device.</p>
<p>Apple CarPlay cannot be available.</p>	<p>Connected iPhone may be unsupported model. Check the compatible model with Apple CarPlay.</p> <p>Connected iPhone may be unsupported iOS version. Update the iPhone to the newer version.</p> <p>To use Apple CarPlay, a headset connection is necessary. Connect a paired headset. 2 P. 90</p> <p>When connecting your iPhone, if it is recognized as iPod, disconnect the USB cable once, enable the Apple CarPlay (2 P. 81), and then reconnect the USB cable again.</p> <p>When a mobile network communication is unstable due to surrounding conditions or signal strength conditions, Apple CarPlay functions may not be available.</p> <p>When the paired headset connection is broken due to headset battery depletion or communication failure, Apple CarPlay cannot be used until the connection is restored.</p> <p>The screen will not switch to Apple CarPlay automatically, other than when the ignition switch is turned to OFF with Apple CarPlay is activated.</p> <p>Apple CarPlay cannot be available with USB connection via the USB2 connector. Check the USB connection, and then reconnect the USB 1 connector if necessary.</p> <p>Some USB cables may be incompatible with Apple CarPlay. Use certified cable to connect the iPhone.</p> <p>You have not agreed to enable Apple CarPlay. Reconnect the iPhone and enable to use CarPlay on the disclaimer screen.</p> <p>Apple CarPlay setting on your iPhone may be disabled. Disconnect iPhone and enable the Apple CarPlay setting on your iPhone.</p>
<p>Android Auto cannot be available.</p>	<p>Connected Android phone may be unsupported model. Check the compatible model with Android Auto.</p>



Symptom	Cause/remedy
	<p>Connected Android phone may be unsupported Android version. Update the Android phone to the newer version.</p> <p>To use Android Auto, a headset connection is necessary. Connect a paired headset.</p> <p>When a mobile network communication is unstable due to surrounding conditions or signal strength conditions, Android Auto functions may not be available.</p> <p>When the paired headset connection is broken due to headset battery depletion or communication failure, go back to the Home screen, and pair the headset connection again.</p> <p>Android Auto cannot be available with USB connection via the USB2 connector. Check the USB connection, and then reconnect the USB 1 connector if necessary.</p> <p>Some USB cables may be incompatible with Android Auto. For Android Auto, the USB cables should be certified by USB-IF to be compliant with USB 2.0 Standard.</p> <p>You have not agreed to enable Android Auto. Reconnect the Android phone and enable to use Android Auto on the disclaimer screen.</p> <p>Android Auto setting on your Android phone may be disabled. Disconnect Android phone and enable the Android Auto setting on your Android phone.</p>
<p>Connected, but does not operate Apply CarPlay/ Android Auto.</p>	<p>You cannot operate Apple CarPlay/Android Auto by the center panel switches/Interface dial while the vehicle is in motion. Operate with the left handlebar switches or park your vehicle in a safe place, then operate</p>
<p>Some functions of Apple CarPlay/ Android Auto is not available.</p>	<p>Some functions may be limited due to condition of mobile network communication.</p>
<p>Apple CarPlay/ Android Auto screen is too dark/bright</p>	<p>Selecting [Day / Night] menu in [Vehicle setting], you can select daytime mode or nighttime mode in the navigation map or an application such as Maps, also adjust backlight</p>



Symptom	Cause/remedy
	brightness by [Auto dimmer meter illumination] menu in [Vehicle setting]
The multi-function display is too dark/bright	<p>When the ignition switch is in the ACC, [Auto Dimmer Meter Illumination] function does not work. Turn the ignition switch to ON.</p> <p>The map color tone has Day/Night color tones and it changes according to the surrounding brightness. You can select daytime mode or nighttime mode</p>
Audio system cannot operate.	Certain manual functions and settings are disabled or inoperable while the vehicle is in motion. You cannot select a grayed-out menu until the vehicle is stopped.
Set menu in [Vehicle setting] does not be reflected or inoperable.	In [Vehicle setting], certain items cannot be selected and display information is limited when the ignition switch is in ACC. The set menu will be reflected to the previous setting when the ignition switch is turned ON.
When turning the ignition switch OFF and ON continuously.	Since the system restart takes time, it may take time until the screen is appeared.
High temperature/overcurrent protection	To protect the system, some operations may be limited temporarily. The system automatically recovers after the cause is solved.
About Idling Stop system (GL1800D/DA Canada model)	When the Idling Stop system is activated, sound may not come out temporarily for system protection, but sound will recover automatically.
Radio receiver sensitivity	The sensitivity of receiver is affected by the object which interrupts a radio wave nearby the radio antenna (top of the right saddlebag).
Software update	The statements in this owner's manual may not match your vehicle's Audio System after performing the software update (map data update).

Electrical Trouble

Battery Goes Dead

Charge the battery using a motorcycle battery charger.

Remove the battery from the vehicle before charging.

Do not use an automobile-type battery charger, as these can overheat a motorcycle battery and cause permanent damage.

If the battery does not recover after recharging, contact your dealer.

Burned-out Light Bulb

All light bulbs on the vehicle are LEDs. If there is an LED which is not turned on, see your dealer for servicing.

Blown Fuse

Before handling fuses, see “Inspecting and Replacing Fuses.”

| Fuse Box Fuses

1. Remove the left side cover.
2. Remove the fuse box cover.
3. Pull the fuses out one by one with the fuse puller and check for a blown fuse. Always replace a blown fuse with a spare fuse of the same rating

▣ Spare fuses and fuse puller are provided on back side of the fuse cover.

4. Install the parts in the reverse order of removal.

| Main Fuse B, Speed Limiter Fuse and External Amplifier Fuse

To check and replace the main fuse B, speed limiter fuse and external amplifier fuse, see your dealer for servicing

GL1800D/DA USA model

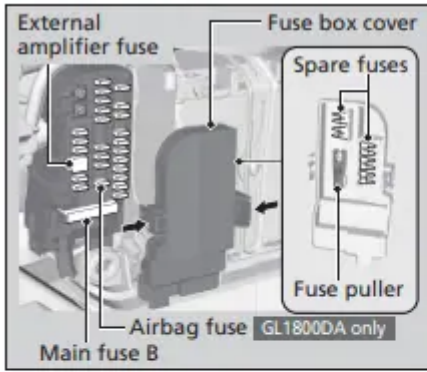

GL1800B USA model

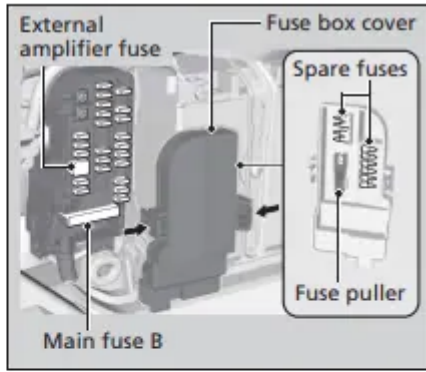

GL1800D/DA Canada model

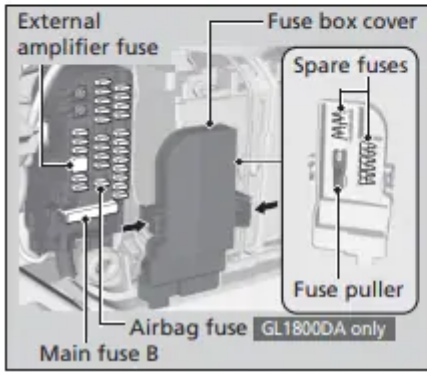

GL1800B Canada model

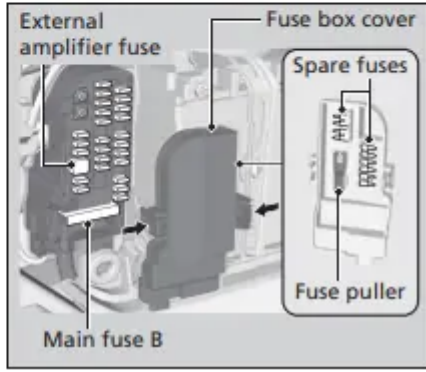

GL1800

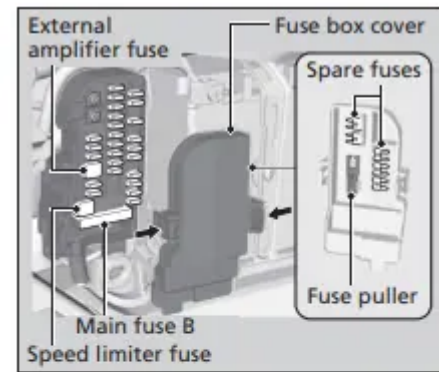

GL1800B

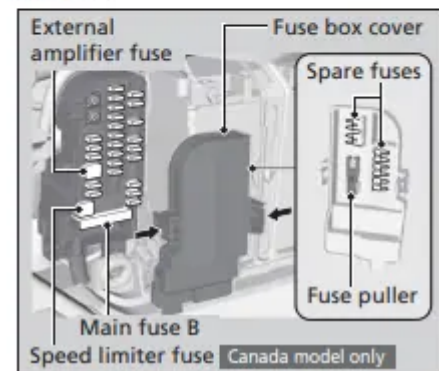

| Ignition Main Fuse & ACC Main Fuse



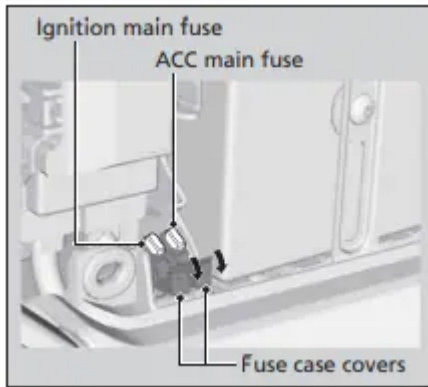

1. Remove the left side cover.
2. Remove the fuse case covers.
3. Pull the fuses out one by one with the fuse puller and check for a blown fuse. Always replace a blown fuse with a spare fuse of the same rating.
 - Spare fuses and fuse puller are provided on back side of the fuse box cover.
4. Install the parts in the reverse order of removal.

Warning

This content is compiled from multiple sources and is provided for reference purposes only. It may not be complete or fully applicable to all situations. If you are unable to resolve your issue, please contact the product manufacturer or an authorized service provider for official support.