

Positioning and connecting

Standard accessories

Note: Check the appliance for transport damage. Never use a damaged appliance. If you have any complaints, contact the dealer from whom you purchased the appliance or our Customer Service.

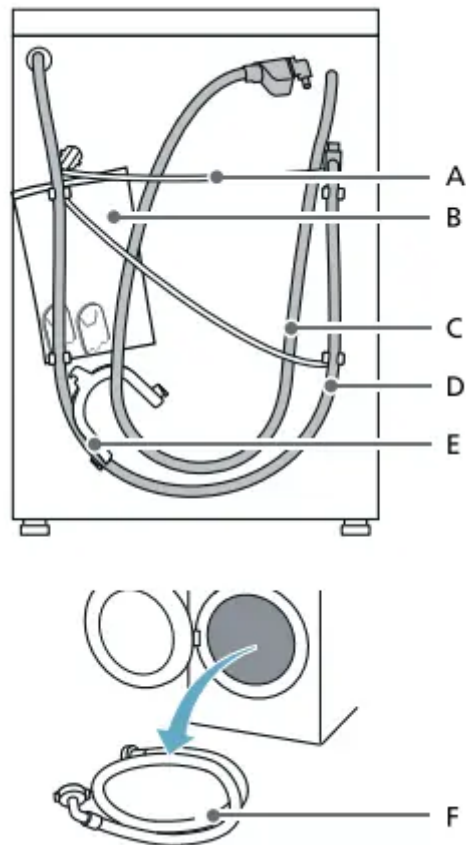

A Mains lead

B Bag:

- Installation and operating instructions
- Customer Service location directory*
- Warranty*
- Supplementary sheet for the installation and operating instructions*
- Cover caps for openings after the transport braces have been removed
- Home Connect Installation Guides*

C Water inlet hose on aquaStop models

D Water outlet hose

E Elbow for securing the water outlet hose*

F Cold water inlet hose on Standard/Aqua-Secure models

* Depending on the model

In addition, a hose clamp (24 - 40 mm diameter, available from specialist retailers) is required to connect the water outlet hose to a siphon.

Useful tool

- Spirit level for aligning
- Wrench with: – WAF13 for loosening the transport braces and – WAF17 for aligning the appliance feet

Installation surface - Note: The appliance must be stable aligned so that it does not move around.

- The installation surface must be firm and level.
- Soft floors/floor coverings are not suitable.

Installation on a base or a wooden joist floor

Caution! Damage to the appliance: The appliance may "wander" and tip/ topple from the base when spinning. The feet of the appliance must be secured with holding brackets. Order no. WMZ 2200, WX 975600, CZ 110600, Z 7080X0.

Note: On wooden joist floors, install the appliance:

- In a corner, if possible,
- On a water-resistant wooden board (min. 30 mm thick) which is screwed tightly to the floor.

Installing the appliance in a kitchenette

Warning Risk of death! There is a risk of electric shock if you touch live components. Do not remove the appliance covering plate.

Notes

- Recess width of 60 cm required.
- Only install the appliance underneath a continuous worktop that is securely connected to adjacent cabinets.

Removing the transport locks

Caution! Damage to the appliance

- The appliance is secured for transportation using transport locks. If the transport locks are not removed, the appliance may become damaged when it is operated. Before using the appliance for the first time, make sure that you completely remove all four transport locks. Keep the locks in a safe place.

- To prevent transport damage from occurring if the appliance is moved at a later date, you must refit the transport locks before transporting the appliance.

Note: Keep the screws and sleeves in a safe place.

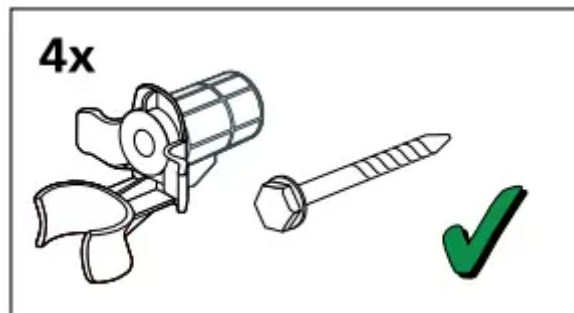

1. Take the hoses out of the holders.

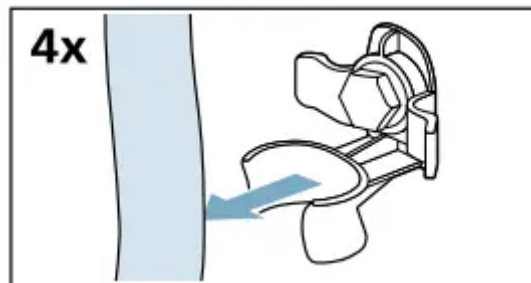

2. Unscrew and remove all four transport brace screws.

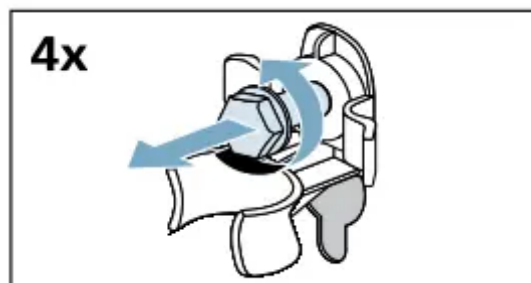

- Remove the mains cable from the holders



- Remove the sleeves.

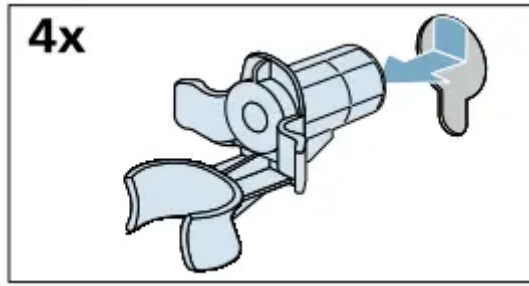

3. Fit the covers.



4. Lock the covers firmly in place by applying pressure to the snap-in hooks.

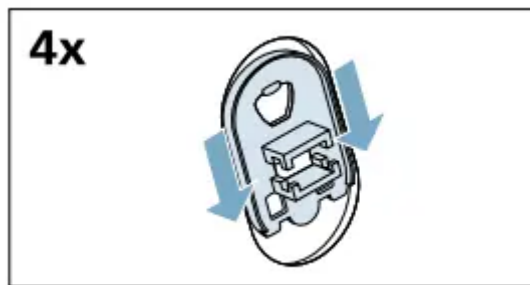

Removing the support struts

1. Unscrew and remove all screws in the vertical transport struts.

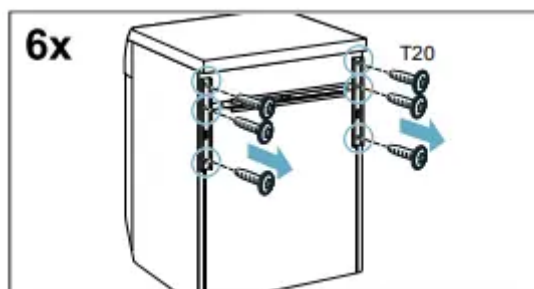

2. Remove the transport struts.



3. Undo and remove the screws on the horizontal transport strut.

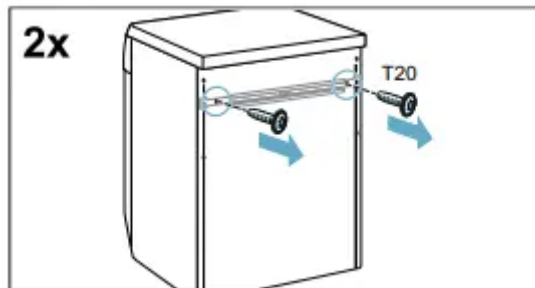

4. Remove the transport strut.

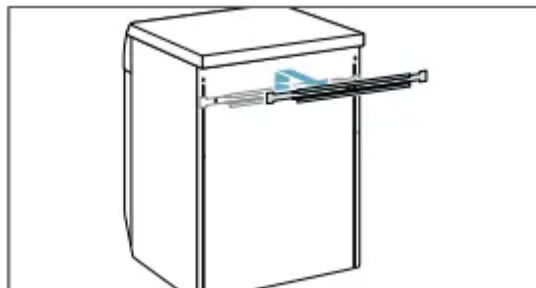

Hose and cable lengths

Connection on left side

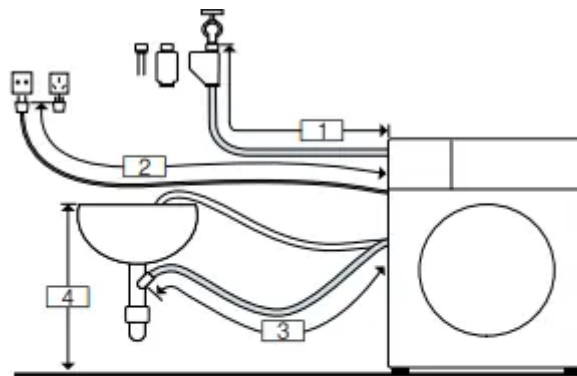

- 1 ~ 105 cm
- 2 ~ 150 cm
- 3 ~ 95 cm
- 4 60 cm ~ 100 cm

or Connection on right side

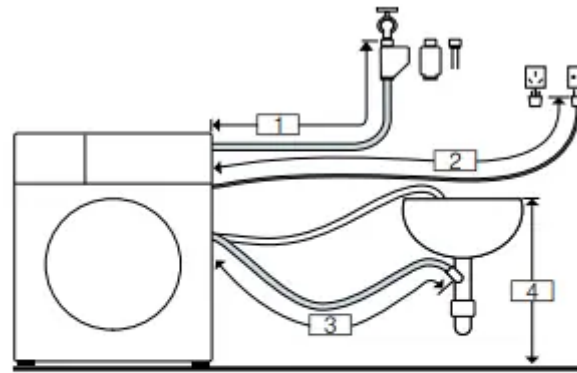

- | | |
|---|----------------|
| 1 | ~ 60 cm |
| 2 | ~ 195 cm |
| 3 | ~ 140 cm |
| 4 | 60 cm ~ 100 cm |

Tip: The following are available from specialist dealers/the after-sales service:

- An extension for Aqua-Stop or cold water supply hose (approx. 2.50 m); order no. WMZ2381
- A longer supply hose (approx. 2.20 m) for standard model.

Water inlet

:Warning Risk of death! There is a risk of electric shock if you touch live components. Do not immerse the Aqua-Stop safety valve* in water (it contains an electric valve). * Depending on the model Observe the following when connecting the appliance:

Notes

- Only operate the appliance using cold mains water.
- Do not connect the appliance to the mixer tap of an unpressurised hotwater boiler.
- Do not use a used supply hose. Only use the supply hose supplied or one that was purchased from an authorised specialist retailer.
- Do not bend, squash, modify or cut through the water supply hose (otherwise its strength is no longer guaranteed).
- Only tighten the screw connections by hand. If the screw connections are tightened too much with a tool (pliers), the thread may be damaged.

Optimum water pressure in the supply network

- At least 100 kPa (1 bar)
- Maximum 1000 kPa (10 bar)
- When the tap is open, the water flow is at least 8 l/min.
- If the water pressure is higher than this, a pressure-reducing valve must be installed.

Connection

1. Connect the water supply hose to the water tap ($\frac{3}{4}$ " = 26.4 mm) and to the appliance:

•

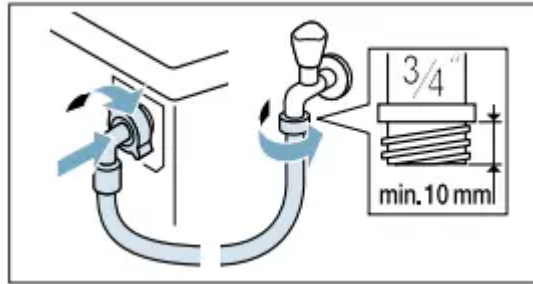

Model: Standard

•

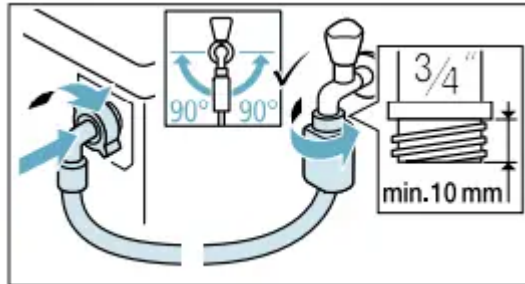

Model: AquaSecure

•

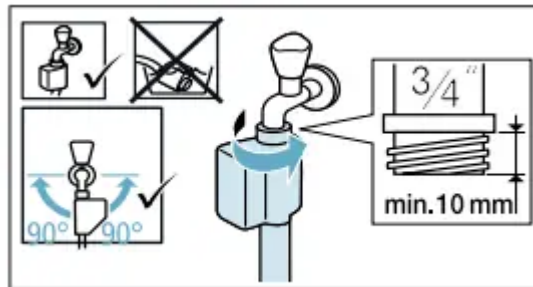

Model: Aqua-Stop

Tip: Connect also an external water filter (depending on the model) between water supply hose and tap. The filter filters dirt particles out of the water.

Water filter must be cleaned regularly to remove contaminants. This will prevent blockages. See also -> separate installation and cleaning instruction for water filter.

2. Open the water tap carefully, checking the leak tightness of the connection points. The screw connection is under mains water pressure

Water outlet

Warning Risk of scalding! When you are washing at high temperatures, there is a risk of scalding if you come into contact with hot water (e.g. when draining hot water into a washbasin). Do not reach into the hot water

Caution! Water damage: When water is being pumped away, the outlet hose is under water pressure and may slip out of the wash basin or connection point. Secure the drain hose so that it cannot slip out.

Caution! Damage to the appliance/fabrics: If the end of the drain hose is immersed in the drained water, water may be sucked back into the appliance and may damage the appliance/fabrics. Make sure that:

- The plug does not block drainage from the washbasin.
- The end of the drain hose is not immersed in the drained water.
- The water drains away quickly enough.

Note: Do not kink the water drain hose or put strain on it lengthways.

Connection

- Drainage into a siphon: The connection point must be secured using a hose clamp with a diameter of 24 - 40 mm (available from specialist dealers).

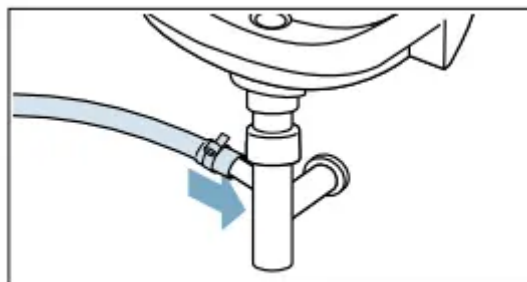

- Drainage into a washbasin: Secure the outlet hose so that it cannot slip out. Elbow available from after-sales service: Individual part number 00655300

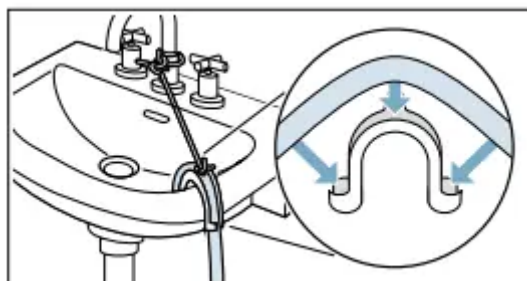

- Drainage into a plastic pipe with rubber bushing or into a drainage pit:

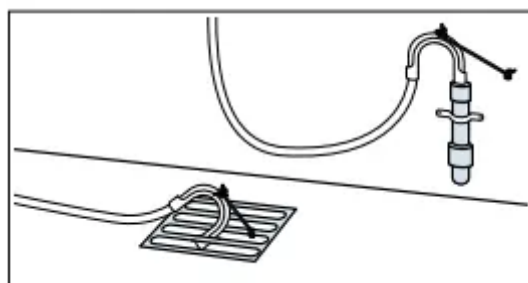

Note: The plastic pipe is not standard accessory, available from specialist dealers.

Alignment

Level the appliance using a spirit level. Incorrect levelling may result in intense noise, vibrations and "wandering".

1. Loosen the lock nuts using a wrench, by turning it in a clockwise direction.

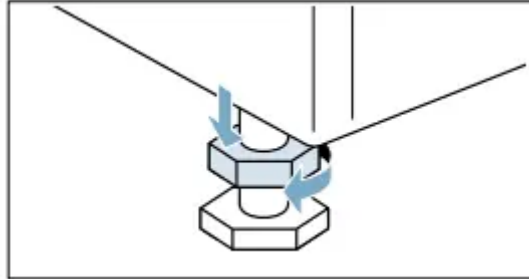

2. Check the alignment of the appliance with a spirit level, and adjust it if necessary. Change the height by turning the appliance feet. All four appliance feet must stand firmly on the ground

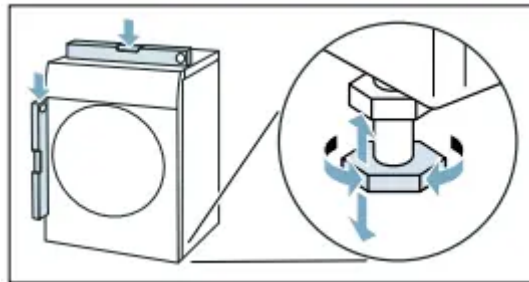

3. Tighten the lock nut against the housing. In doing so, hold the foot tight and do not adjust its height. The lock nuts on all four appliance feet must be screwed tightly against the housing.

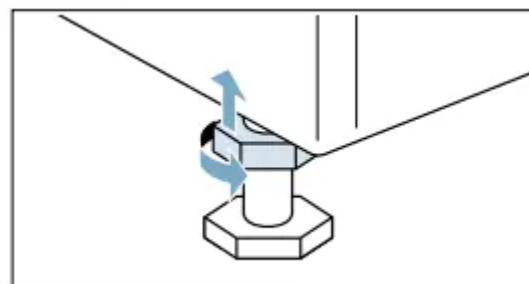

Electrical connection

Warning: Risk of death! There is a risk of electric shock if you touch live components.

- Never touch or hold the mains plug with wet hands.
- Only pull out the mains cable by the plug and never by the cable, as this could damage it.

Observe the following information and ensure that:

Notes

- The mains voltage and voltage indicated on the appliance (rating plate) are the same. The connected load and fuse required are specified on the rating plate.
- The appliance is only connected to an alternating current via a properly installed earthed socket.
- The mains plug fits the socket.
- The earthing system is properly installed.
- The mains cable is only replaced by a qualified electrician (if this is necessary). Replacement mains cables are available from the aftersales service.
- No multiple plugs/couplings or extension cables are used.
- If an earth-leakage circuit breaker is used, only a type which displays this symbol is

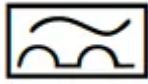

used: . Only this symbol guarantees compliance with the currently applicable regulations.

- The mains plug can be accessed at all times.
- The mains cable is not bent, squashed, modified, cut through, or in contact with heat sources.

Before washing for the first time

The appliance was inspected thoroughly before leaving the factory. To remove any residual test water, run the Drum Clean programme the first time without laundry.

Note:

- The appliance must have been installed and connected properly. -> "Positioning and connecting"
- Never switch on a damaged appliance.

1. Insert mains plug.

2. Turn the water tap on.

3. Press the  button till the indicator lamp lights up, release the button. The appliance is switched on.

4. Close the door. Do not load any laundry.

5. Select the Drum Clean 90°C programme.

6. Open the detergent drawer.

7. Pour approx. 1 litre of water into dispenser II.

8. Add standard detergent to dispenser II according to manufacturer's instructions for light soiling. Note: To prevent over sudsing, use only half the recommended amount of detergent. Do not use any woollens or mild detergents.

9. Close the detergent drawer.

10. Select  

11. When the programme ends, press the  button till the indicator lamp turns off, release the button. Your appliance is now ready for use.

Transportation

Preparatory work:

1. Turn off the water tap.
2. Reduce the water pressure in the supply hose.
3. Drain any residual water.
4. Disconnect the appliance from the mains.
5. Remove the hoses.
6. Empty the dispensers. -> "Detergent drawer and housing"

Installing the transport locks:

1. Remove the covers and keep them in a safe place. Note: Use a screwdriver if necessary.

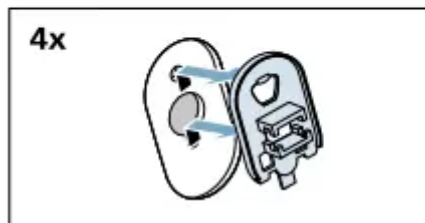
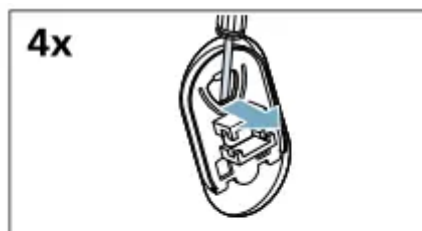

2. Insert all four sleeves.

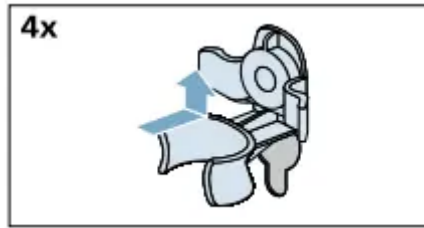

•



Clip the mains cable securely in the holders.

•



Insert and tighten the screws.

•

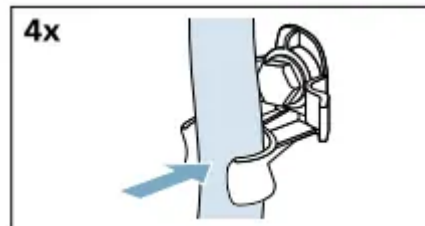

Clip the hoses securely in the holders.

Before switching on the appliance again: Notes

- The support struts must be removed.
- The transport braces must be removed. -> "Removing the transport locks"
- Pour approx. 1 litre of water into dispenser II, select the Drain programme and start. This will prevent detergent from flowing straight into the drain during the next wash.

Getting to know the appliance

Appliance

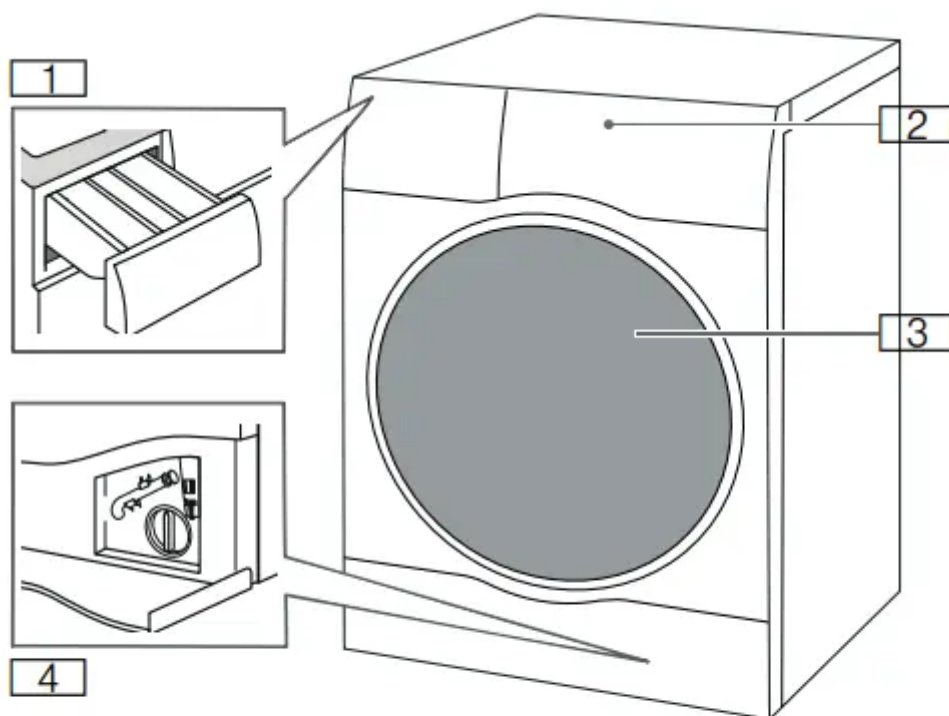

- 1 Detergent drawer
- 2 Control panel
- 3 Loading door
- 4 Service flap

Control panel

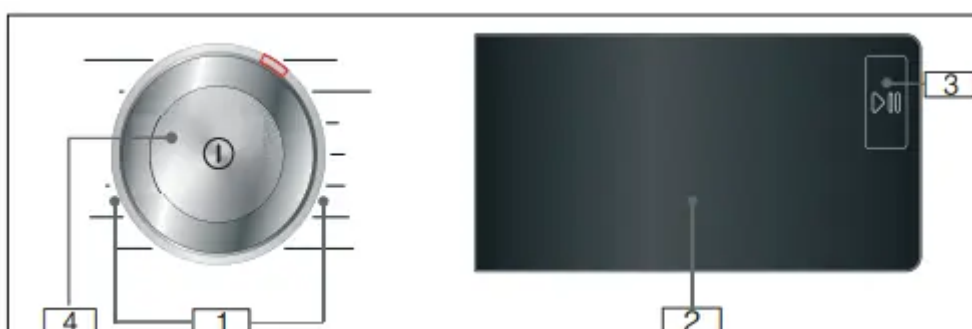

1 Programmes that can be selected.

2 Touch-Display



3 Start/Pause button: Touch  button to start, interrupt (e.g. reload washing) and cancel the programme.



4 Power button Press the  button to switch the appliance on/off.

Touch-Display

Programme default settings

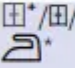

Display	Setting	Description
* - 90°	Temperature	Temperature that can be set in °C * = cold
∅, 400-1400*	Spin speed	Spin speed in rpm (revolutions per minute) ∅ = No spin
2:30*	Programme remaining time	Programme remaining time depends on the programme selection in h:min (hours:minutes)
0.5 - 24 h	"Finish in" time	Programme ends after ... h (h = hours)
10.0* kg/ 6.0* kg	Maximum load for Washing/Drying	Recommended load in kg
Wash+ Dry/Dry*	Appliance working mode with drying	Programme washing plus drying, or only drying
 *	Drying target	Three drying modes for different drying levels; can be selected after choosing drying phase.
* Depending on the selected model and programme.		

Additional programme settings

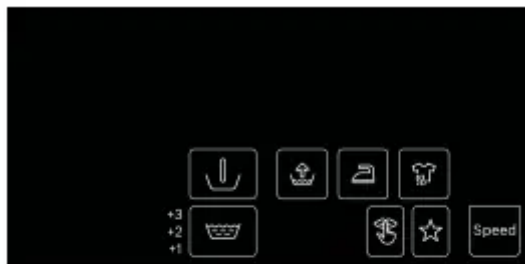

Display	Setting
↓ (Prewash)	
🪣 (Rinse plus)	
↑ (Water plus)	
👕 (Easy iron)	→ "Additional programme settings" on page 35
🧼 (Hygiene care)	
Speed	
☆ (Memory)	
🔇 (Silent)	

Status indicators for the programme progress (programme sequence)

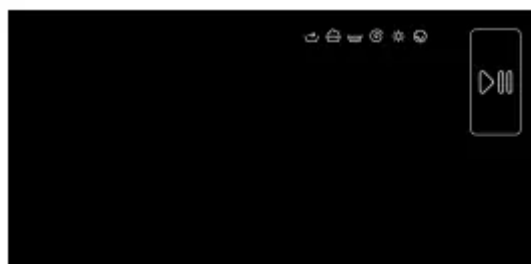

Display	Setting
▶	Start/Pause button
👕	Pretreatment
🪣	Wash
🪣	Rinse
🌀	Spin/Drain
☀️	Dry
🕒	Wrinkle guard
End	Programme end

Laundry

Preparing laundry for washing







Protecting your laundry and appliance: Caution! Damage to the appliance/textiles Foreign objects (e.g. coins, paper clips, needles, nails) may damage the washing or components of the appliance. The following instructions must be observed when preparing your laundry:

- Always follow the manufacturer's instructions when dosing all detergents, cleaning aids, care products and cleaning agents.
- Do not exceed maximum load. Overfilling will impair the washing result.
- Keep detergents and agents for the pretreatment of laundry (e.g. stain remover, prewash sprays, etc.) away from the surfaces of the appliance. Using a damp cloth, immediately remove any fine spray residue and other residue or droplets.
- Empty any pockets. Remove any foreign objects.
- Remove metal parts (paper clips, etc.).
- Trousers, knitwear and knitted textiles, e.g. jersey garments, T-shirts or sweatshirts, should be turned inside out.
- Ensure that underwired bras are appliance-washable.
- Wash delicates in a net or bag (tights, underwired bras, etc).
- Close zips, button up covers.
- Brush sand out of pockets and collars.
- Remove curtain fittings or place in a net/bag.

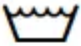
Sorting laundry: Sort your laundry according to the care instructions and manufacturer's information on the care labels, depending on:

- Type of fabric/fibre
- Colour - Note: Laundry may discolour. Wash white and coloured items separately. Wash new coloured items separately the first time you wash them.
- Soiling Wash laundry with the same level of soiling together. Some examples of soiling levels can be found in the chapter – Light: Do not need to pretreat, adjust the Speed setting if necessary. – Normal – Heavy: Load less laundry, need to pretreat or soak laundry firstly. – Stains: Remove/pretreat stains while they are fresh. First dab with soapy water; do not rub. Then wash the items of laundry with the appropriate programme. Stubborn or dried-in stains can sometimes only be removed by washing several times.

- Symbols on the care labels



	Suitable for normal washing process; e.g. Cottons programme
	A gentle washing process is required; e.g. Easy Care programme
	An especially gentle washing process is required; e.g. Delicates/ Silk programme
	Suitable for washing by hand; e.g.  Wool programme
	Do not machine wash.

Preparing laundry for drying:

Note: To ensure an even drying result, sort the laundry according to the:

- Type of fabric
- Care symbols which are indicated on the care labels.

Only dry laundry which is labelled “dryer-proof” or which has the following care symbols:

-  : You can select Cottons + Dry
-  : You can select Mixed Load + Dry

The following textiles should not be dried:

-  = care symbol “Do not dry”
- Delicates (silk, synthetic curtains).
- Textiles which contain foam rubber or similar materials.
- Textiles which were treated with flammable liquids, e.g. with stain remover, petroleum ether, thinners. Risk of explosion!
- Textiles which still contain hairspray or similar substances.

Notes

- Before drying, hand-washed textiles must be spun at the appropriate spin speed.
- Before drying, spin at the optimum speed. A spin speed of more than 1000 rpm is recommended for cotton, more than 800 rpm for easycare textiles.
- Do not iron washing immediately after drying. It is recommended to roll the washing up first to distribute residual moisture evenly.
- To ensure a good drying performance, quilts, terry cloths and other large textiles should be dried separately. Do not dry more than 6 terry cloths (or 5 kg).
- Do not exceed the maximum load.

Detergents and care products

You can protect your appliance and your laundry by selecting and using the correct detergents and care products. You can use all detergents and care products which are suitable for your appliance.

Note: Please read the safety information -> Page 5 to ensure that you use the appliance safely.

The manufacturer's instructions for use and dosage can be found on the packaging.

Notes

- Only use liquid detergents that are self-flowing
- Do not mix different liquid detergents
- Do not mix detergent and fabric softener
- Do not use products which have developed a top layer or are highly congealed
- Do not use products containing solvents, caustic agents or volatile substances (e.g. bleach)
- Use dyes sparingly as salt may damage stainless steel
- Do not use bleaching agents in the appliance

Programme default settings

P+ Programme default settings



- You can change the default settings for selected programmes. The settings can be changed even while the selected programme is running. The effects depending on the progress of the programme.



- Temperature

- Before and after the programme starts, you can change the temperature setting, depending on what stage the programme is in, by adjusting the desired temperature on the display.
- The maximum temperature that can be set depends on the programme that has been selected.

- Spin speed

- Depending on what stage the programme is in, you can change the spin speed (in rpm; revolutions per minute) before and during the programme by adjusting the desired speed on the display.
-  :  = "No spin". The water is only drained.
- You can select "No spin" to prevent creasing if the laundry will not be taken out of the appliance immediately after the programme has ended.
- The maximum speed that can be set depending on the model and the programme that has been selected.

Finish in

Before starting the programme, you can preselect the programme end ("Finish in" time) in 0.5h increments (h = hour) up to a maximum of 24 hours.

To do this:

1. Select a programme (except MyTime programme). The programme duration is displayed for the selected programme, e.g. 2:30 (hours:minutes).

2. Select the + button repeatedly until the required number of hours is displayed. Note: The setting values are increased using the + button, and decreased using the - button



3.

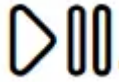

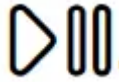
Select the  button. The programme starts. The selected number of hours (e.g. 8h) is shown in the display panel and counts down until the programme starts. The duration of the programme is then displayed.

Note: The length of the programme is automatically adjusted when the programme is running. Changes to the programme default settings or programme additional settings may also change the programme duration.

After starting the programme (if a "Finish in" time has been selected and the programme has not yet started), you can change the preselected number of hours as follows:

1. Select the A button.
2. Touch the + or - button to change the number of hours.

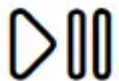

3.





Select the  button.

Wash+ Dry or Dry

- First you have to place the laundry into the drum and choose the wash programme. Then the drying function can be activated by selecting the buttons Wash+ Dry or Dry. Washing and drying without interruption mode is available by pressing Wash+ Dry. For dry only programmes without washing, press Dry on the display.
- Note: When a programme (with optional drying function) is selected, the buttons Wash+ Dry , Dry would be half lit on the display. After selected, it would be turned into full lit.
- For programmes only designed for drying function, Wash+ Dry will not be lit on the display

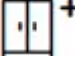
- After Wash+ Dry or Dry selected, one of  (Cupboard dry+)/  (Cupboard dry)/  (Iron dry) drying levels would be defaulted in the display, and you can change the level as required*.

-  (Cupboard dry): For single-layer fabrics. Garments can be folded or hung up in cupboard.
-  (Cupboard dry+): For fabrics made of thick, multilayered items of clothing, which need to be dried longer. Garments can be folded or hung up in a cupboard. Laundry more dry than » (Cupboard dry).* Some drying programmes do not offer different drying levels.
-  (Iron dry): Normal, single-layered laundry that still needs to be damp after drying and is suitable for ironing or hanging up.



P+ Additional programme settings



Note: You can find possible additional programme settings in the overview; these differ depending on the model.

- By selecting additional programme settings, you can better adapt the washing/drying process to your items of laundry.
- The settings can be selected or deselected depending on the progress of the programme.
- The button indicator lamps light up if a setting is activated.
- The settings are not retained after the appliance is switched off.

Speed

- Washing/drying in a shorter time while achieving a washing/drying result that is consistent with the normal performance.
- Touch Speed to activate or deactivate this additional programme setting.
- Note: With the additional Speed option activated, the maximum washing load will be reduced, and extra cooling water will be needed for the drying process.



(Prewash)

- Prewash for heavily soiled laundry.
- Touch  (Prewash) to activate or deactivate it.
- Note: Put the detergent into dispenser I and II.



(Rinse plus)

- Settings that can be selected:
 - +1: + 1 rinse cycle
 - +2: + 2 rinse cycles
 - +3: + 3 rinse cycles
- Additional rinse cycles for particularly sensitive skin and/or for areas with very soft water.
- Longer programme duration, due to additional rinse cycle.
- The number of rinse cycles that the programme actually runs depends on the number that is set as a basic setting for the programme.





(Hygiene care)

- An innovative function, pretreat dry laundry by hot air (up to 65°C) for additional hygienic demands, followed by a low temperature washing cycle. Achieves both hygiene effect and fabric care. Suitable for most non-delicate textiles.
- Note: During this process, the drum light will illuminate for approx. 10 minutes.



(Easy iron)



- A special operation using reduced spin speed followed by fluffing to help reduce creasing.
- Touch  (Easy iron) to activate or deactivate it.

-  Note: If  (Easy iron) has been activated, the laundry will have retained a higher than average level of moisture after spinning.

(Water plus)

- Increased water level for gentler treatment of the laundry.
- Touch  (Water plus) to activate or deactivate it.

(Memory)

- With memory you can save a selected programme with your favourite settings. To store:
 1. Switch on the appliance.
 2. Select a programme.
 3. If required, change the programme default settings and/or select programme additional settings.
 4. Touch and hold  (Memory) button for approx. three seconds. The programme is saved if all of the settings flash briefly.
- Calling up: touch  (Memory) button briefly after you switch on the appliance.
- Reset: touch and hold  (Memory) button again for approx. three seconds after selecting the new programme and settings.

(Silent)

- Function designed for noise reduction. Washing and drying process noise will be reduced, and ending signal will be switched off.
- Note: If silent is selected for wash only, remaining moisture of the laundry will be slightly increased. The spin result may not be satisfying. Before hanging you can select Spin programme to further reduce moisture.

Operating the appliance

Preparing the appliance

The appliance was tested before delivery. To remove residual water from the test procedure, the first wash cycle should be run without laundry using the Drum Clean programme. -> "Before washing for the first time"

Notes

- Never switch on a damaged appliance!
- Inform customer service!

1. Insert mains plug.

Warning Risk of death from electric shock! Risk of death if live parts are touched.

- Never pull out the mains plug by tugging the power cord.
- Insert/pull out the mains plug with dry hands only.

2. Turn the water tap on.

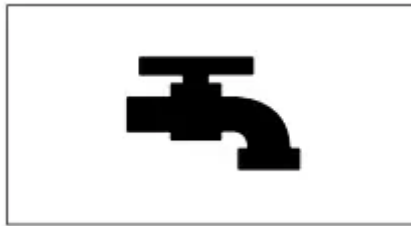

3. Open the appliance door.



Switching on the appliance/ selecting a programme

- Press the  button till the indicator lamp lights up, release the button.
- The appliance is switched on. The Cottons programme (only washing), which is preset at the factory, is then always displayed.
- You can use this programme or select a different programme.
- Note: If you have activated the childproof lock, you have to deactivate it before you can set a programme.-> "Childproof lock"
- Presettings and maximum load are indicated on the Touch-Display for the selected programme.

Adjusting the selected programme

Changing default settings: You can use the displayed default settings or adjust the selected programme to fit the laundry care needs e.g. Temperature, Spin speed, Finish in time.



To activate/ deactivate Wash+ Dry or Dry functions and drying levels touch the half lit buttons on the display.

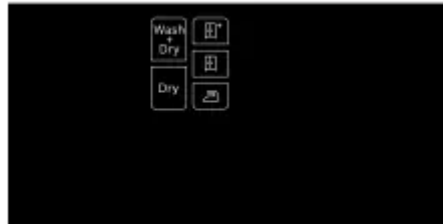

Notes

- Options can be selected, deselected or changed depending on the progress of the programme.
- If the buttons can be selected, they will be half lit in the display, then turn into full lit after activated.

Selecting additional programme settings:

- Select the additional programme settings by touching the half lit buttons in the display e.g. Speed, Prewash, Rinse plus....

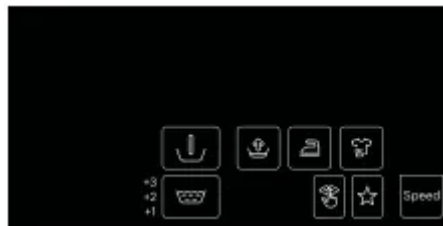

- Note: The selectable additional functions depends on the selected washing/drying programme

Placing laundry into the drum: Open the door, place laundry in the drum, make sure that no items of laundry are trapped between the door and the rubber seal, and close the door.

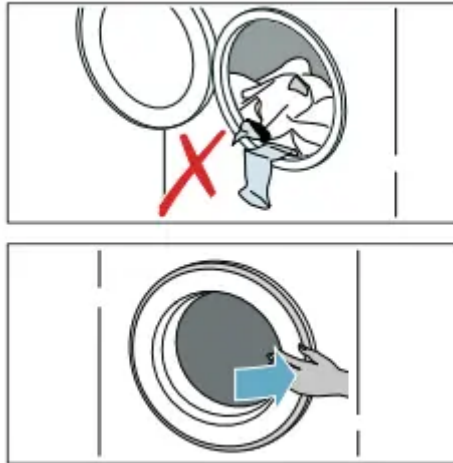

Notes

- Unfold and load presorted items of laundry. Mix large and small items. Washing items of different size distribute themselves better during the spin cycle. Individual items of washing may cause an unbalanced load.
- Observe the maximum specified load. Overfilling adversely affects the washing/drying result and promotes creasing.

Dosing and adding detergent and care products

Caution! Damage to the appliance: Detergents and agents for the pretreatment of laundry (e.g. stain remover, prewash sprays, etc.) may damage the surfaces of the appliance. Keep these agents away from the surfaces of the appliance. Using a damp cloth, immediately remove any fine spray residue and other residue/ droplets.

Dosing: Dose the detergents and care products according to:

- water hardness (ask your water supply company),
- the manufacturer's specifications on the packaging,
- the amount of laundry,
- soiling.

Filling the dispensers

1. Pull out the detergent drawer. **Warning Eye / skin irritation!** If the detergent drawer is opened while the appliance is running, detergent/care product may run out. Carefully open the drawer. If detergent/care product comes into contact with eyes or skin, rinse thoroughly. If accidentally swallowed, seek medical advice.
2. Pour in detergent and/or cleaning product.

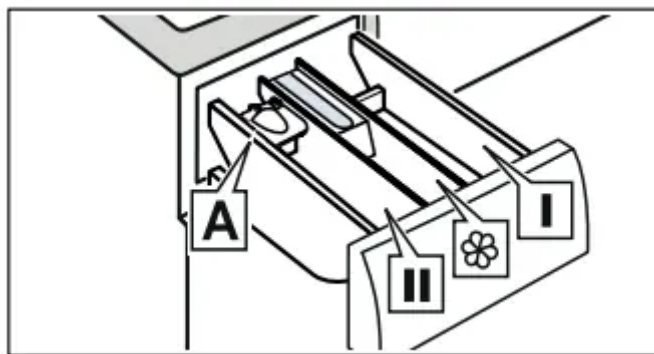

Dispenser I: Detergent for pretreat and clothing disinfectant. (only for the appliance with pretreat and disinfectant function)

Dispenser  : Softener, starch. Do not exceed the maximum load.

Dispenser II: Detergent for main wash, water softener, bleach, stain remover.

Dispenser A*: For dosing liquid detergent.

*depending on the model

Notes

- Always follow the manufacturer's instructions when dosing all detergents, cleaning aids, care products and cleaning agents.
- Dilute viscous fabric softener and fabric conditioner with water. This will prevent blockages.
- Be careful when opening the detergent drawer while the appliance is running.

Measuring aid A* for liquid detergent

*depending on the model

Position the measuring aid A for measuring the correct amount of liquid detergent:

1. Pull out the detergent drawer. Press down the insert and fully remove the drawer

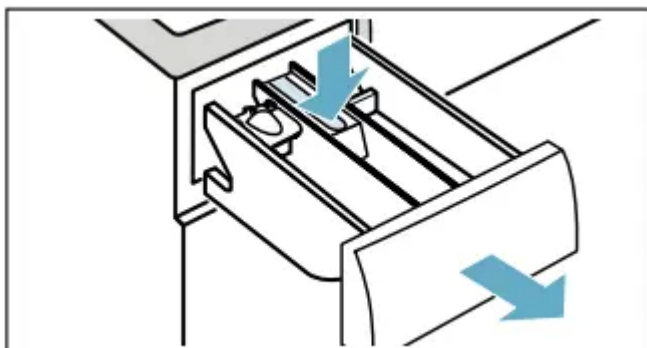

- Slide the measuring aid forwards, fold it down and click it into place.

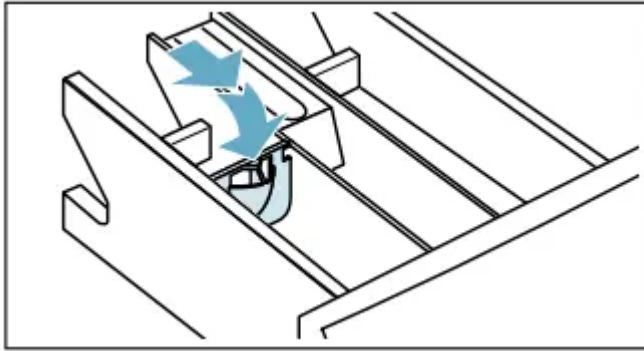



- Reinsert the drawer.

Note: Do not use the measuring aid for gel detergents and washing powder, or for programmes with pretreat or when "Finish in" time is selected.

For models without a measuring aid, pour the liquid detergent into the appropriate dispenser and place it in the drum

Starting the programme

- 

Touch and hold (Start/Reload) button for 1~2 seconds, then release the button. The programme starts and the appliance door is locked.
- The finish-in time is shown in the display panel and counts down until the programme starts. After the programme has started, the programme duration is displayed. And the symbols for the programme progress are lighting up.
- 

Note: Foam detection If the symbol also lights up in the display panel, the appliance has detected too much foam during the wash cycle and automatically activated additional rinse cycles to remove the foam.

Childproof lock

- You can lock the appliance to prevent the functions you have set from being changed inadvertently. To do this, activate the childproof lock.



- 



Touch and hold the (3s) button to activate/deactivate the childproof lock.



- To activate the childproof lock: After the programme starts, Touch and hold the  (3s) button for 3 seconds.

- 

(3s) lights up: The childproof lock is activated.

-  (3s) flashes: If a button is touched while childproof lock is activated, the  (3s) button will flash.

- Note: When the programme ends, End is displayed. The door is locked.  (3s) and  remain on to remind you to deactivate the childproof lock.



- To deactivate the childproof lock: Touch and hold the  (3s) button until the  (3s) indicator lamp is off.

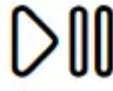

Adding/removing laundry

- After starting the programme (only for washing), you can add or remove laundry if necessary.

- Touch the  (Start/Reload) button. The appliance checks whether reloading is possible.

- If the following appears on the display panel:

-  The symbol  disappears, reloading is possible.

-  The symbol  lights up, reloading is not possible.

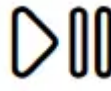
- To continue the programme, touch the  (Start/Reload) button. The programme continues automatically.

- Notes

- Do not leave the door open for too long when adding laundry as water from the laundry may leak out.
- For safety reasons, the door remains locked when the water level or temperature is high, or while the drum is turning, and it is not possible to add laundry during this time.

Changing the programme

If you have started the wrong programme by mistake, you can change the programme as follows:

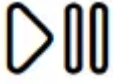
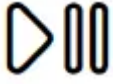
1.  Touch the  button.

2. Select another programme.

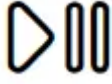
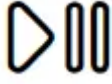
3.  And touch the  button again. The new programme starts from the beginning.



Note: If drying is activated, you have to switch the appliance off and on again to change the drying programme.

Cancel the programme

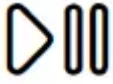
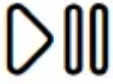
For programmes washing at high temperatures:

1.  Touch the  (Start/Reload) button.



2. To cool down laundry: Select Rinse.

3.  Touch the  (Start/Reload) button.

For programmes washing at low temperatures:

1.  Touch the  (Start/Reload) button.

2. Select Spin.

3.  Touch the  (Start/Reload) button.

For programmes in drying process:

1. Switch the appliance off.

2. Switch the appliance on again.

3. To cool down laundry: Select the MyTime + Dry.

4.  Touch the  (Start/Reload) button.

Programme end

End lights up on the Touch-Display and  and  displays are off.

If you have selected , the water is only drained after rinse process, no spin cycle.

Notes

- If Hot flashes in the display before the drying programme ends, the temperature in the drum is high. The programme for cooling the drum runs until the temperature in the drum has dropped.
- Wrinkle guard process starts after drying process is finished to prevent laundry getting wrinkle if you do not take laundry out in time. The process lasts about 30 minutes. 0:00 will be displayed in time display and  symbol will be displayed as the status symbol. You can touch any area of Touch-Display to terminate this process, then the door will be released and laundry can be taken out.

Removing laundry/switching off the appliance

1. Press the  button till the indicator lamp turns off, release the button. The appliance is switched off.
2. Open the door and remove the laundry.
3. Turn off the water tap. Note: Not required for Aqua-Stop models.

Notes

- Do not leave any items of laundry in the drum. They may shrink in the next wash or discolour another item.
- Remove any foreign objects from the drum and the rubber seal – risk of rusting.
- Wipe the rubber seal dry.

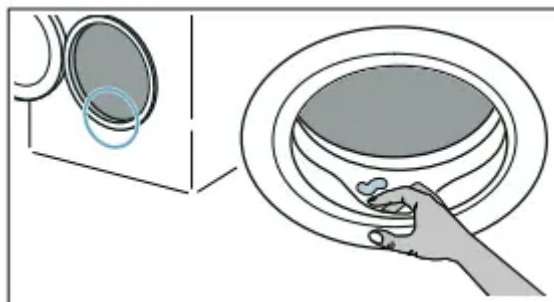

- Leave the door and detergent drawer open so that any residual water can evaporate.

- Always wait until the programme ends, as the appliance could still be locked. Then switch the appliance on and wait for it to unlock.

Appliance settings

Automatic switch-off

- If the appliance is not operated for approx. 5 minutes (depending on the water level inside of appliance), it will automatically switch off before the programme starts or after

the programme has ended. Press the power button  again to switch on the appliance.

Basic settings

- To access the basic settings, touch and hold the  (Silent) button for approx. 3 seconds. The control panel show:

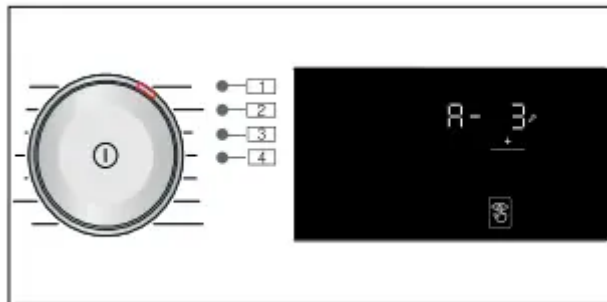

- You can change the following basic settings:
 - The volume of the end signal.
 - The volume of the buttons.
 - The brightness of the Touch-Display.
 - Switching the Drum Clean information signal on/off.

End signal : You can select position 1 and use the + button to adjust the volume of the end signal, e.g. R'- 3

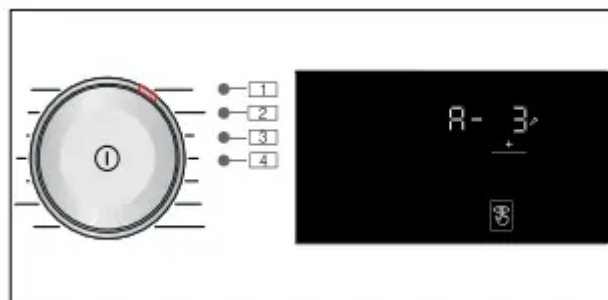

Possible setting values:

- 0 off
- 1 quiet
- 2 medium
- 3 loud
- 4 very loud

Button signal: You can select position 2 and use the + button to adjust the volume of the button signal, e.g. **b-3**

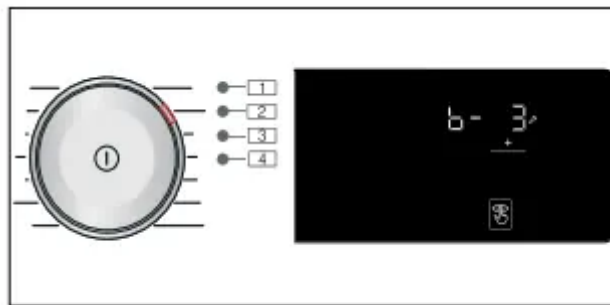

Possible setting values:

- 0 off
- 1 quiet
- 2 medium
- 3 loud
- 4 very loud

Brightness

- Possible setting values: 1 - 4
- You can select position 3 and use the + button to adjust the brightness of the Touch-Display, **[- 3**

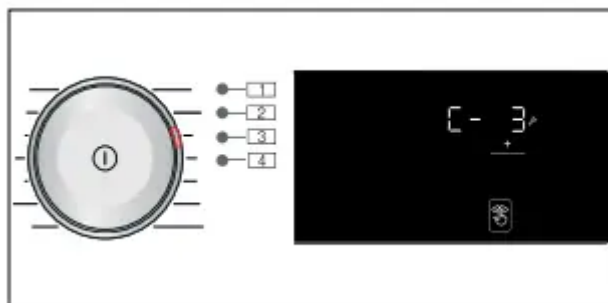

Possible setting values:

- 1 not very bright

- 2 normal level of brightness
- 3 bright
- 4 very bright

Switching the drum-care information signal on/off

You can select position 4 and use the ~ button to switch the Drum Clean information signal on or off, e.g. d-1

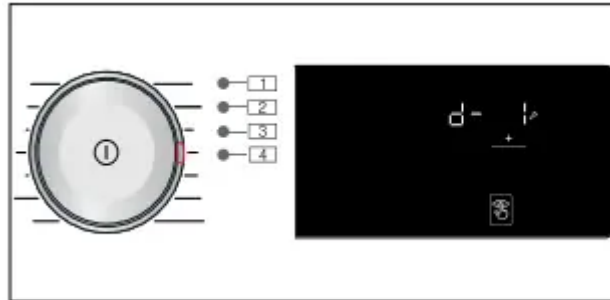

Possible setting values:

- 0 off
- 1 on

Sensors

Unbalanced load detection system

- The automatic unbalanced load detection system detects imbalances and ensures even distribution of the laundry by repeatedly starting and stopping drum spinning.
- If the laundry is extremely unevenly distributed, the spin speed is reduced or the spin cycle is not performed for safety reasons.
- Note: Place large and small items of laundry evenly in the drum.

Cleaning and maintenance

Warning Risk of death! There is a risk of electric shock if touch live components. Press the button



and pull out the mains plug

Caution! Fire and explosion hazard! Toxic vapours can be produced by cleaning agents that contain solvents, e.g. cleaning solvent. Do not use cleaning agents that contain solvents.

Caution! The appliance may be damaged! Cleaning agents that contain solvents, e.g. cleaning solvent, can damage surfaces and components in the appliance. Do not use cleaning agents that contain solvents.

Appliance housing/control panel

- Remove the detergent residue immediately.
- Wipe the housing and the control panel with a soft, damp cloth.
- Do not use abrasive cloths, sponges or detergents (stainless steel cleaner).
- Do not clean the appliance with a water jet.

Drum

- Warning: Risk of injury/material damage/ damage to the appliance!
- Permanently washing at low temperatures and a lack of ventilation for the appliance may damage the drum and cause injury.
- Regularly run a programme for cleaning the drum or wash at temperatures of at least 60°C.
- Leave the appliance to dry after every operation with the door open, and leave the detergent drawer to dry.
- Use chlorine-free cleaning agents, do not use steel wool.
- If there are odours in the appliance, or to clean the drum, run the Drum Clean 90°C programme without laundry.

Descaling

- Descaling should not be necessary if the detergent is measured out correctly. However, if it is required, follow the manufacturer's instructions for the descaling agent. Suitable descalers can be obtained via our website or from customer services.

Detergent drawer and housing

If the appliance contains detergent or fabric softener residues:

1. Pull out the detergent drawer. Press down the insert and fully remove the drawer

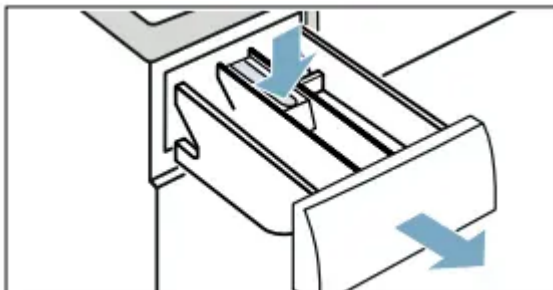

2. To remove the insert: Push the insert upwards from below with your finger.

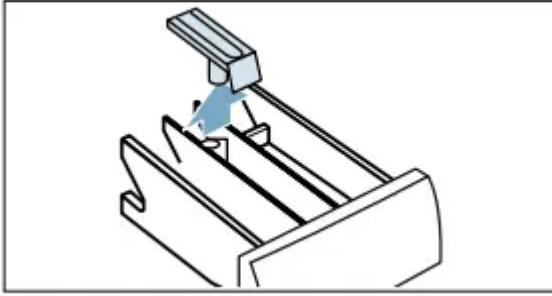

3. Clean the detergent dispenser tray and insert with water and a brush, and dry it. Clean

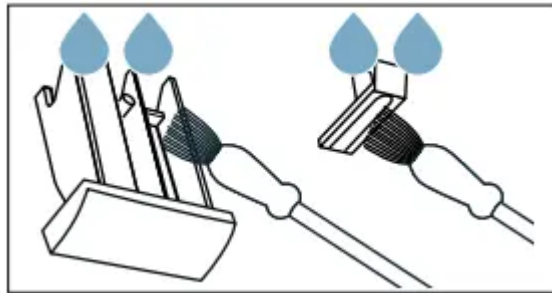

the inside of the housing as well.

4. Fit the insert and lock it in place (push the cylinder onto the guide pin).

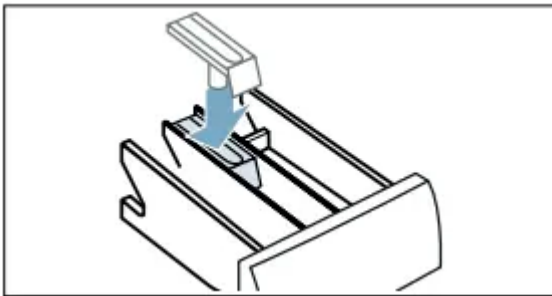

5.

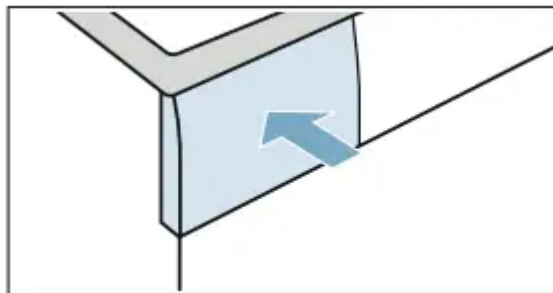

Push in the detergent drawer

Note: Leave the detergent drawer open so that any residual water can evaporate.

Drain pump is blocked

Note: Turn the water tap off to prevent more water from flowing in and to ensure that it is drained via the pump.

Warning Risk of scalding! When you wash at high temperatures, the water gets very hot. If you come into contact with the hot water, you may be scalded.

Allow the water to cool down first.

1. Switch off the appliance. Pull out the mains plug.

2.

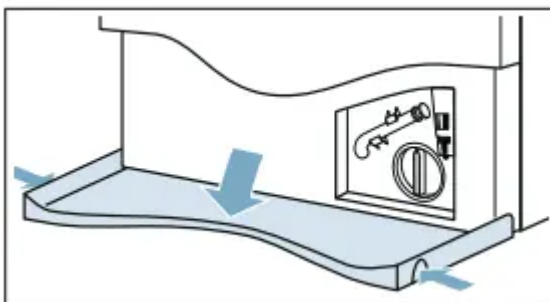

Open the service flap.

3. Take the drain hose out of the retainer. Remove the sealing cap and pour the water out into a suitable container. Replace the sealing cap and place the drain hose back in the



retainer.

4. Carefully unscrew the pump cover; residual water may leak out. Clean the interior, pump cover thread and pump housing. The impeller in the drain pump must be able to rotate.

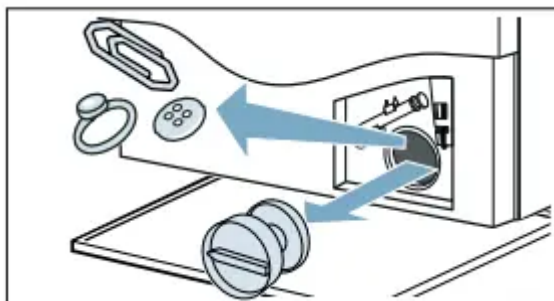

5. Refit and screw on the pump cover. The handle must be in a vertical position.

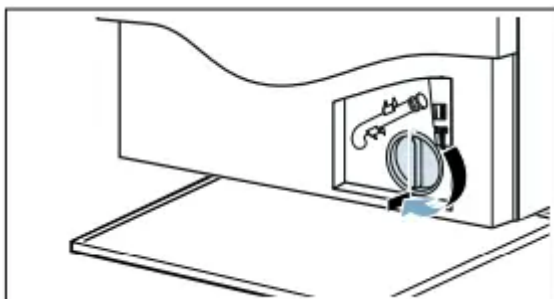

6.

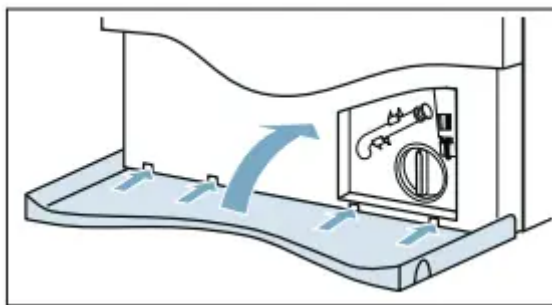

Close the service flap.

Note: To prevent unused detergent from flowing straight into the drain during the next wash: Pour 1 litre of water into dispenser II and start the Drain programme.

The drain hose at the siphon is blocked

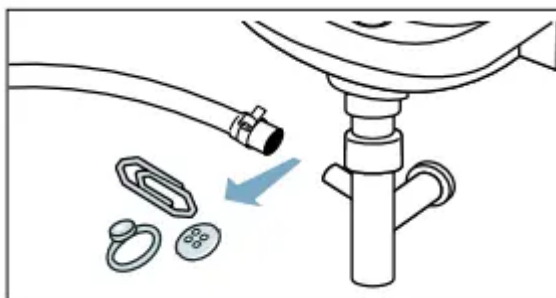

1. Press the  button. Pull out the mains plug.
2. Loosen the hose clamp. Carefully remove the drain hose; residual water may leak out.
3. Clean the drain hose and siphon connecting piece.



4. Re-attach the drain hose and secure the connection point using the hose clamp.

Filter in the water supply is blocked

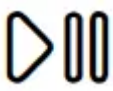
Release water pressure in the supply hose:

1. Turn off the water tap.
2. Select the Cottons (activate Speed setting) programme.
3. Select the  button. Allow the programme to run for approx. 40 seconds.
4. Press the button .
5. Pull out the mains plug.

Clean the filters:

1. Disconnect the hose from the rear of the appliance.

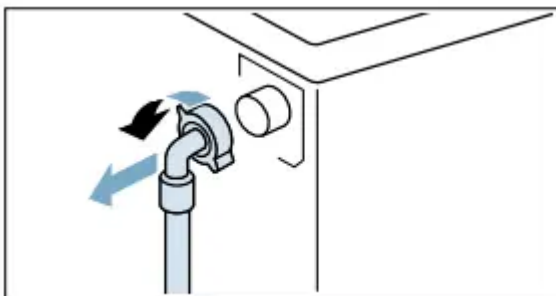

- 2.

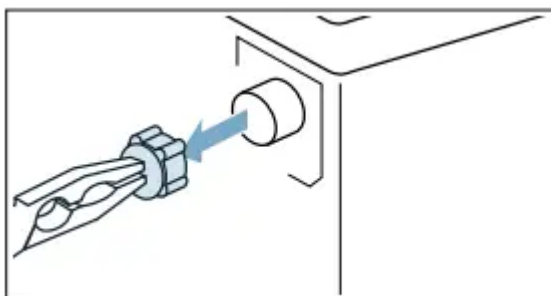

Use pliers to remove the filter.

- 3.



Clean the filter with a small brush.

- 4.

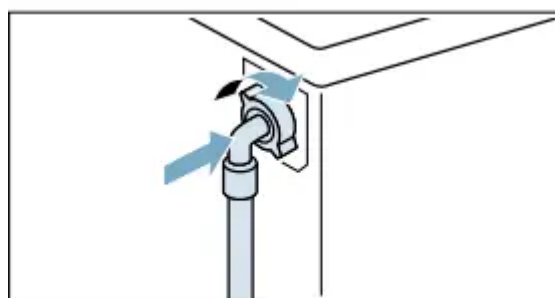

Connect the hose and check for leaks.

Troubleshooting

Faults and what to do about them

Emergency release

- E.g. power outage or in the event of a loss of power
- The programme continues when the power supply is restored.
- However, if the laundry has to be removed, the appliance door can be opened as follows:

- Warning Risk of scalding! When you are washing at high temperatures, there is a risk of scalding if you come into contact with hot water and laundry. If possible, leave it to cool down first.
- Warning Risk of injury! Reaching into the drum while it is still turning may cause hand injuries. Do not reach into the drum when it is turning. Wait until the drum has stopped turning.
- Caution! Water damage! Any escaping water may cause water damage. Do not open the door if water can be seen through the glass.

1. Press the  button. Pull out the mains plug.
2. Open the service flap

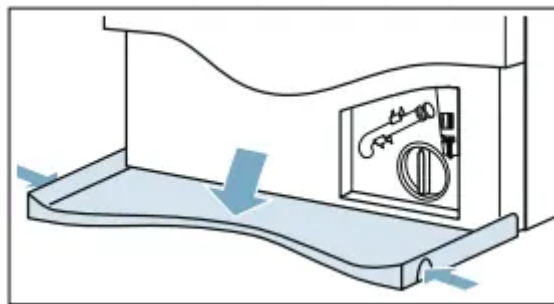

3. Drain the water.
4. Pull the emergency release downwards with a tool and release. The door can then be opened.



Faults and what to do about them

1. Water is leaking from the appliance.
 - Attach the drain hose correctly or replace it.
 - Tighten the screw fitting on the supply hose.

2. The appliance is not filling with water.

Detergent is not being dispensed.

- Programme does not start?

- Is the water tap turned on?
- Could the filter in the water supply be blocked? ~ "Filter in the water supply is blocked"
- Is the supply hose kinked or trapped?

4. The wrong detergent/fabric softener has been poured into the dispenser(s).

Dispenser(s):



1. Empty and clean.
2. Refill.

5. Detergent/fabric softener has congealed in the dispensers. Clean and refill the dispensers.

6. The door cannot be opened.

- The temperature in drum is too high to open the door.
- The safety function is activated. Stop the programme?
- The water level in drum is too high.
- Can the door only be opened by the emergency release? ~ "Emergency release"

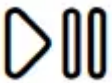
7. The programme will not start.

- Have you touched the  (Start/Reload) button or selected  (Finish in) time?

- Is the door closed?

- Childproof lock activated? Deactivate childproof lock.

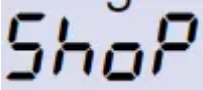
- Shop mode activated? If the display shows  for 5 s after you have switched on or off the appliance, the appliance is in shop mode. Turn off the shop mode as follows:

1. Switch the appliance off and on again.

2.

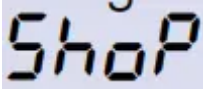
Wait for the display message  to disappear.

3.

Touch and hold  for at least 5 s. The appliance will automatically switch off. You can use the appliance now as usual.

8. The programme has started and the drum is rotating, but the drum is not filling with water.

- Not a fault – Some programme specifically detect and weigh the load after the program has started in order to calculate the optimum amount of water for washing. The drum will then start filling with water.

9. The water is not draining.

- Drain pipe or water drain hose is blocked. Clean the drain pipe and the water drain hose.
- Drain pipe or water drain hose is caught or jammed. Ensure that the drain pipe and the water drain hose are not kinked or trapped.
- The drain pump is blocked. ~ "Drain pump is blocked"
- The drain hose at the siphon is blocked. ~ "The drain hose at the siphon is blocked"
- - - - is activated (depending on the module). Continue the programme by selecting Spin

or Drain and pressing  (Start/Reload)

- The water drain hose is connected too high. Install the water drain hose at a maximum height of 1 meter. ~ "Hose and cable lengths"

10. Water is not visible in the drum.

- Not a fault – the water is below the visible area.

11. The spin result is not satisfactory. Laundry wet/too damp.

- Not a fault – the unbalanced load detection system has interrupted the spin cycle because the laundry is unevenly distributed. Distribute small and large items of laundry evenly in the drum.

•  (Easy iron) additional programme setting selected (depending on the model)?

•  (Silent) additional programme setting or Silent programme selected (depending on the model)?

- Is the selected spin speed too low?

12. The spin cycle runs several times.

- Not a fault – the unbalanced load detection system is adjusting an imbalance.

13. Residual water in the dispenser for care product.

- Not a fault – effect of the care product not impaired.
- If required, remove the insert.

14. Clean the detergent drawer and re-insert it.

- Compartment  is not rinsed out completely. Remove the insert. Clean the detergent drawer and reinsert it.

15. The programme is taking longer than usual.

- Not a fault – the unbalanced load detection system is adjusting an imbalance by repeatedly distributing the laundry.
- Not a fault – the foam detection system is activated – a rinse cycle has been switched on.

16. The length of the programme changes during the wash/dry cycle.

- Not a fault – the programme sequence is optimised for the specific washing/ drying process. This may change the length of the programme shown on the Touch-Display.

17. Foam may come out of the detergent drawer.

- Too much detergent used?
- Mix 1 tablespoon of fabric softener with ½ litre of water and pour into dispenser II. (Not for outdoor, sports and down-filled textiles!)
- Reduce detergent dosage for the next wash cycle.
- Use commercially available low foam detergent and care product which are suitable for machine.

18. Odours, stain formation in the appliance.

- Run the Drum Clean 90°C programme without laundry.
- Add washing powder or a detergent containing bleach.
- Note: To prevent foaming, only use half the amount of detergent recommended by the detergent manufacturer. Do not use detergents designed for woollens or delicates.

19. Loud noises, vibrations and appliance "movement" during the spin cycle.

- Is the appliance aligned? ~ "Alignment"
- Are the appliance's feet fixed? Secure the appliance's feet.
- Have the transport locks been removed? ~ "Removing the transport locks"

20. The Touch-Display indicator lights do not work while the appliance is running.

- Has there been a power failure?
- Circuit breaker fuses blown? Reset/replace the fuses.
- If the fault occurs repeatedly, call customer services.

21. There is detergent residue on the laundry.

- Some phosphate-free detergents contain water-insoluble residue.
- Select Rinse or brush the laundry after washing.

22. Spin during the drying phase.

- This is an innovative process known as thermal spinning used to reduce energy consumption during the drying phase. It is designed like this, please wait until program finished.

23. Fluff found on the laundry.

-



Run the Drum Clean — (cold) programme without laundry and detergent to remove fluff which have accumulated inside the drum during the previous drying cycle.

24. Water inlet noise during the drying phase.

- The washer dryer uses water condensation technology, water is constantly needed to dry the laundry. Therefore the water tap must be on all the time, till the end of the drying phase.

25. Drying duration extended.

-



Run the Drum Clean — (cold) programme to remove fluff which has collected in the washer drum during the drying phase.

- If the ambient temperature is higher than 30 °C, this may extend the drying time.
- Insufficient air circulation in the room may increase the drying time. Ventilate the room.

26. Drying programme does not start.

- Drying additional programme setting not selected?
- Door not closed properly?

27. Creasing.

- Creasing occurs when you have exceeded the maximum load or selected the wrong program for the type of fabric. All the required information can be found in the programme overview table.
- Remove clothes immediately after drying; creasing may occur if they are left in the drum.

28. The drying result is not satisfactory (laundry is not dry enough).

- After the end of the programme, warm laundry feels damper than it actually is. Spread the laundry out and allow the heat to disperse.
- Excessively high ambient temperature (above 30 °C) or inadequate ventilation in the room in which the washer dryer is situated.
- The laundry has not been spun well enough before drying. Always set the highest selectable spin speed for the particular washing programme.

- Washer dryer overloaded: Observe the recommendations for the maximum load in the programme table and on the load display. Do not overload the washer dryer, as the maximum load for the drying phase is less than the maximum load for the wash cycle. Unload the washer dryer after washing with the maximum load and divide the laundry into two drying cycles.
- The power supply voltage is too low (below 200 V) – provide a suitable power supply.
- The water pressure is low. According to water condensing principle, low water pressure will cause evaporated steam to not condense properly and completely.
- The water tap is closed during drying. Due to the use of the water condensation technology for drying, please keep the connected water tap open during the drying process, otherwise proper drying cannot be guaranteed.
- Thick multilayered textiles or textiles with thick fillings dry easily on the surface, but not inside. This equalisation process may take longer. For these types of textiles, select drying mode  (Cupboard dry+) or select MyTime with Dry.

If you cannot rectify a fault yourself (after switching the appliance off and on again) or a repair is required:

- Switch off the appliance and pull out the mains plug.
- Turn off the water tap and call customer service.

Warning

This content is compiled from multiple sources and is provided for reference purposes only. It may not be complete or fully applicable to all situations. If you are unable to resolve your issue, please contact the product manufacturer or an authorized service provider for official support.