

## **User Guide for Bypass Damper**

Finally there's a bypass zoning damper that doesn't require balancing those pesky weights. The new Honeywell TrueZONE Bypass damper dramatically cuts installation time by replacing the old weight system with a simple dial. No more hassles. No more frustration. Just an easy installation and year-round performance without the need for adjustments. It's the latest in the complete lineup of Honeywell TrueZONE solutions that make zoning easier than ever.

### **Bypass Hassle**

The days of spending one to two hours installing a zoning bypass damper are gone. With the new TrueZONE Bypass damper from Honeywell, you get an out of the box solution with little configuration needed. The TrueZONE Bypass replaces the tedious weight system with a simple, preset dial that needs little or no adjustment. Zoning just got a whole lot simpler.

## **Bypass Callbacks**

Bypass dampers are required in nearly all zoning installations to relieve pressure. Installing them used to require time-consuming weight balancing, but the TrueZONE Bypass has sent the weight system packing:

- Eliminates installation hassles
- Simple dial for setting when the system starts to bypass
- Spend less time on every zoning job
- Exclusive Honeywell technology

## **Bypass Labor**

The timesaving dial is just one of many TrueZONE Bypass innovations:

- Installs at any orientation at any angle
- Allows more airflow than typical weighted models, so you can install a smaller size
- Can handle all of the airflow needs of today's zoning systems to provide constant pressure relief regardless of the blower speed
- Designed for easy flex-duct installation
- Profitable — saves you upfront time through the fast installation and follow-up time by eliminating the callbacks associated with weighted models
- Quiet, efficient and reliable

# INSTALLATION INSTRUCTIONS

## APPLICATION

The TrueZONE® Bypass constant pressure regulating damper (CPRD) is a round static pressure relief damper. It is used in forced-air bypass applications to relieve excess static pressure when some of the zone dampers are closed. The damper is installed in a duct that delivers air to the return or a dump zone. The damper automatically opens and closes to maintain a desired static pressure.

The CPRD uses a calibrated spring to regulate the bypass air accurately when any number or combination of zones is calling. Conventional, weighted arm, bypass dampers may operate properly when one zone is calling; however, when different combinations of zones are calling, they bypass too much or too little. This can cause callbacks when homeowners complain of air noise.

### Selecting the Correct CPRD

1. Size the bypass damper by subtracting the cfm of the smallest zone from the cfm of the system.
2. Consult Table 1 to determine the CPRD to use.
3. Example: Bypass CFM = Total System CFM - Smallest Zone CFM

## DIMENSIONS

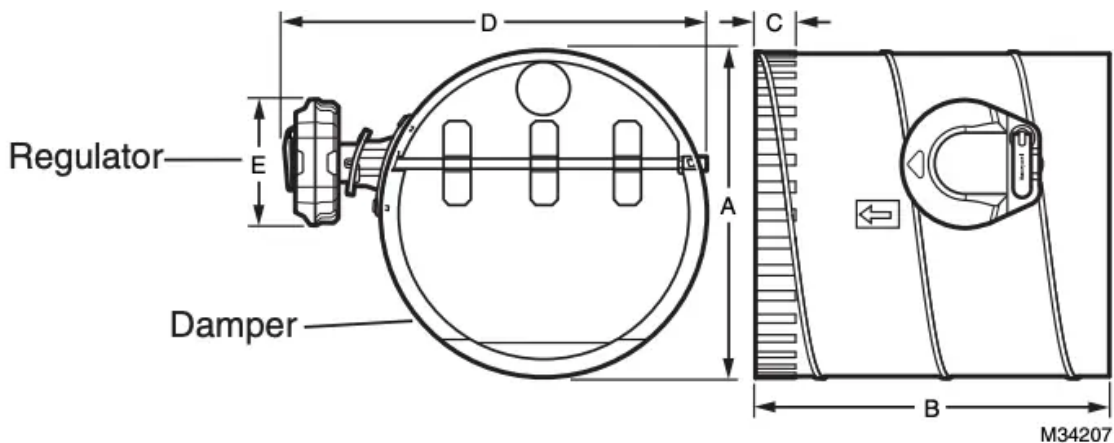

Table 2. CPRD Dimensions.

Model	A		B		C		D		E		Gauge
	in	mm	in	mm	in	mm	in	mm	in	mm	
CPRD8	8	203.2	9.65	245	1.50	38	11.54	292.84	4.65	118	26
CPRD10	10	254	11.42	290	1.50	38	13.50	343	4.65	118	26
CPRD12	12	305	13.18	235	1.50	38	15.47	392.84	4.65	118	24
CPRD14	14	355	14.96	380	1.50	38	17.36	441	4.65	118	22

## INSTALLATION

### Select Damper Location

Install the CPRD onto a starting collar or in duct that loops from supply to return. The supply side take-off must be before any zone dampers. It is best to install the return side of this loop as far a practical from the air handler.

The CPRD can be mounted in vertical or horizontal ductwork, or at any angle. The damper may also be rotated to be installed with the regulator on either side, top or at any angle between.

Secure the damper to sheet metal ductwork with screws or to flex-duct with tape. If ducting with flex-duct, the outer layer of plastic can be taped to the damper mounting flange to fully insulate the damper.

Alternatively, the CPRD can dump air from the supply to a non-critical temperature area such as a hallway, basement, or false ceiling.

### Attach Regulator to Damper

1. Align the regulator with the "D" shaft on the damper (see Fig. 1).
2. Slide the regulator onto the "D" shaft and push down while turning counterclockwise until it snaps into place see Fig. 2).

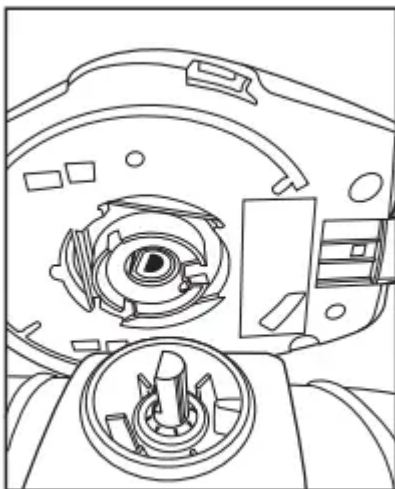

**Fig. 1.**

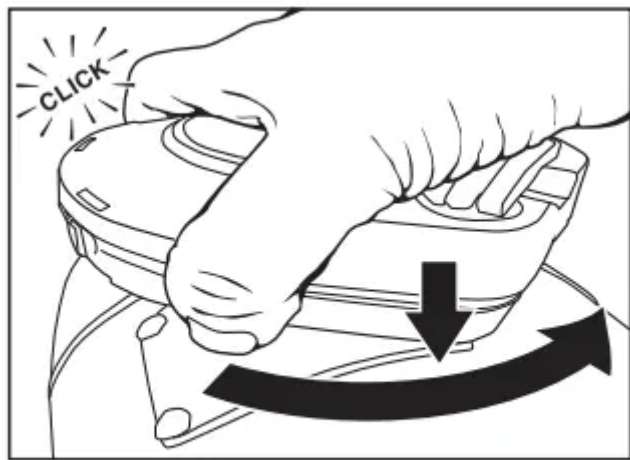

**Fig. 2.**

### Setting the Regulator

The CPRD is factory set to open at approximately .5"WC."

This setting is satisfactory for most installations. Some systems have higher static pressure. Test this by:

1. Make all zones call fan, heat, or cool; whichever has the highest CFM.
2. Verify that the damper position indicator points to closed.

3. If it does not point to closed:

- Flip the adjustment crank out (see Fig. 3)

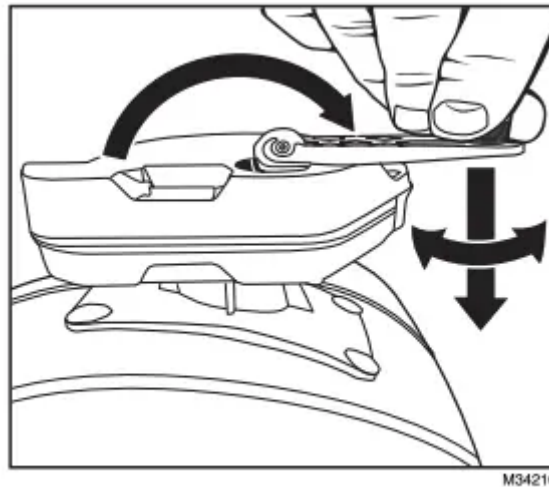

**Fig. 3.**

- Push down on the adjustment crank with gentle pressure. Caution: Do not rotate the adjustment crank without first pushing it down
  - Turn the adjustment crank clockwise until the indicator points to closed
  - When done, flip the adjustment crank back into the locked position
4. Make only the smallest zone call for fan, heat, or cool.
5. Verify that the airflow into that zone is not objectionable. If it is, then set the regulator to a lower pressure.

## **Removing the Regulator**

If you need to remove the regulator from the damper, do so by pressing the red release button. See Fig. 4. It is easier to remove the regulator after turning the pressure down to a lower setting.

