

User Manual for Electric Leaf Blower

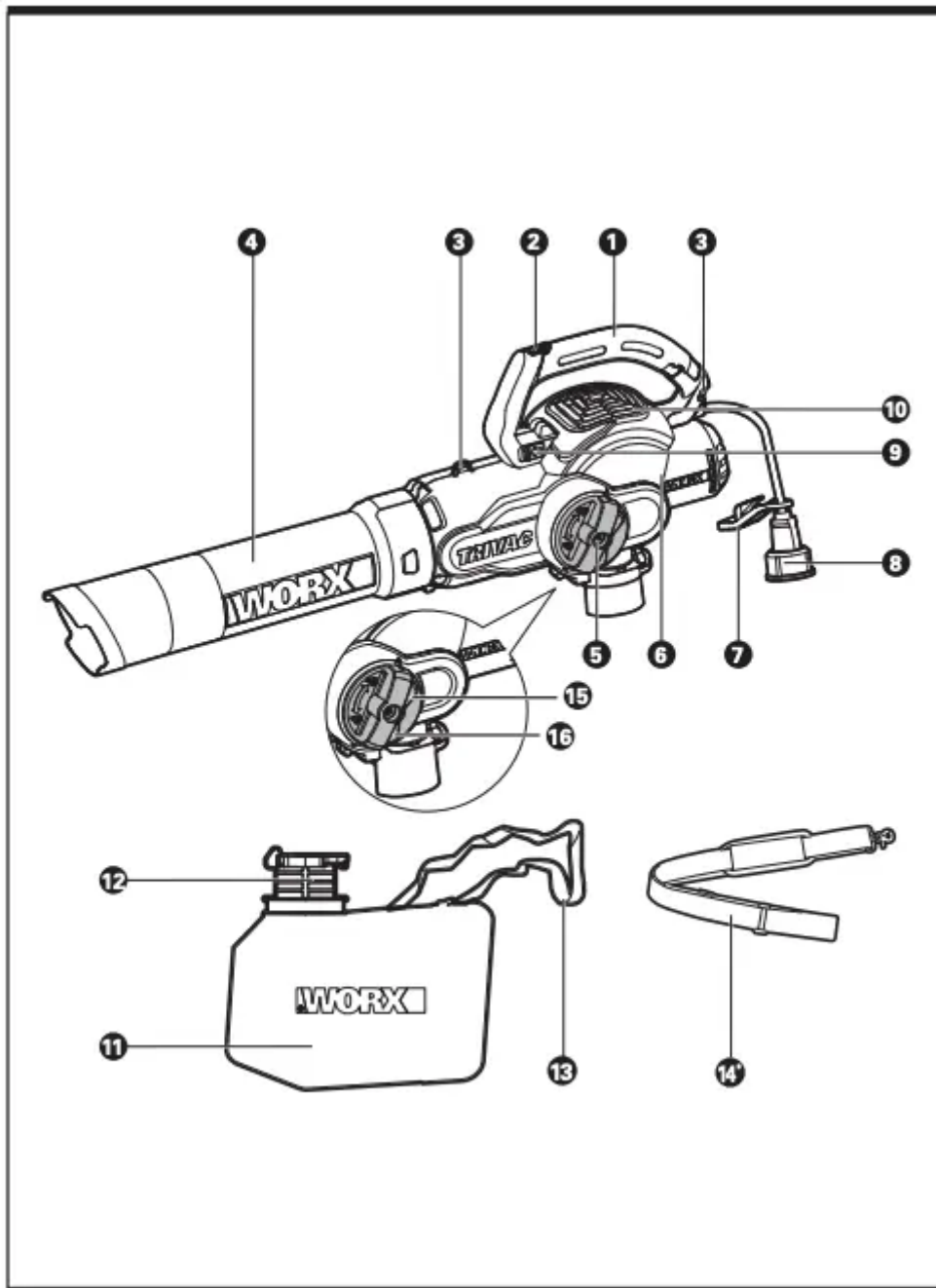





OPERATION



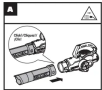
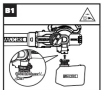
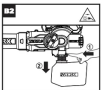

INTENDED USE

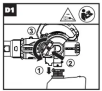
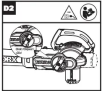
The blower & vacuum is intended for residential use only. Use the blower outdoors to move or vacuum yard debris as needed.

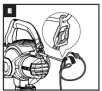
ASSEMBLY AND OPERATION

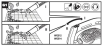

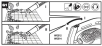
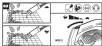
ACTION	FIGURE
ASSEMBLY	
Assembling the Blower/Vacuum Tube	
Attaching/Removing the Leaf Collection Bag (vacuum mode only)	 
Attaching the Shoulder Strap (supplied with WG514 only) NOTE: There are two positions for attaching the strap.	 
OPERATION	
Converting from Vacuum to Blower NOTE: Press either (a) or (b) release button to turn the blower/ vacuum selector knob until the knob clicks in place and is aligned with the corresponding arrow marking on the machine.	 
Converting from Blower to Vacuum NOTE: Press either (a) or (b) release button to turn the blower/ vacuum selector knob until the knob clicks in place and is aligned with the corresponding arrow marking on the machine	 
Attaching the Extension Cord	

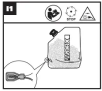
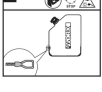
<p>Starting & Stopping</p> <p>WARNING:</p> <p>-The tool runs for a few seconds after it has been switched off. Let the motor come to a complete standstill before setting the tool down.</p>	
<p>Multiple Speed Adjustments</p> <p>• Two-speed Adjustment (only for WG512, WG514)</p> <p>-To maximum vacuum performance, it is better to use the II mode.</p> <p>- The I mode is only recommended when vacuuming in sensitive areas (i.e. flower beds)</p> <p>• Variable Speed Adjustment (only for WG513)</p> <p>Note: The speed of the blower can be altered by rotating the On/ Off switch.</p>	 
<p>Using the Blower</p> <p>CAUTION! —For maximum vacuum performance, it is better to use the II high speed mode.</p> <p>—Do not operate the blower near bystanders or pets.</p> <p>—Use extra care when cleaning debris from stairs or other tight areas.</p> <p>—Wear safety goggles or other suitable eye protection, long pants and shoes.</p>	 
<p>Using the Vacuum</p> <p>WARNING:</p> <p>—For vacuuming, make sure the tube and bag are installed in position, or else the machine can not start.</p> <p>CAUTION!</p> <p>—Do not vacuum solid objects such as carpentry wood blocks, large branches, broken glass, or pieces of metal and stones.</p>	
<p>Emptying the Leaf Collection Bag</p> <p>NOTE: It is recommended to empty the collection bag contents when the bag is 75% full.</p> <p>WARNING:</p>	 

-Normal usage of the Debris Collection bag causes it to wear and deteriorate over time. A worn or deteriorated bag allows small objects to be thrown through the bag, possibly injuring the operator or bystanders. Check the bag frequently. If it is worn or deteriorated, replace it with a new WORX debris collection bag.

Removing Clogged Debris from the Impeller and Blade (Tool Not Supplied)

Note:

1. Convert the tool from vacuum mode to blower mode before cleaning.
2. Remove the plug before opening the debris cover.

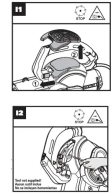

MAINTENANCE

Remove the plug before carrying out any adjustment, servicing or maintenance. Never use water or chemical cleaners to clean your power tool. Wipe clean with a dry cloth. Keep the motor ventilation slots clean. Keep all working controls free of dust. If the replacement of the supply cord is necessary, this has to be done by the manufacturer or his agent in order to avoid a safety hazard.

STORAGE

Store the Blower/Vacuum and extension cord indoors, in a cool dry location, out of reach of children and animals.

TROUBLE SHOOTING

Problems	Possible Causes	Corrective Action
The Blower/ Vacuum does not operate.	The Blower/ Vacuum Tube is not attached to the Motor Housing.	Attach the Blower/Vacuum Tube to the Motor Housing.
	Power cord is not connected to the power source.	Connect the power cord to a power source.
	The leaf collection bag is not completely installed.	Install the leaf collection bag in place completely
	The blower/ vacuum switch is not in line with the corresponding arrow on the tool.	Push the switch to the proper position.
The Blower/ Vacuum jammed or clogged.	Debris blocking in the Impeller	Remove clogged debris from the Impeller.
	Debris blocking in the Blower/ Vacuum Tube or the connection of the Leaf Collection Bag	Remove clogged debris from the Blower/Vacuum Tube or the connection of the Leaf Collection Bag.

PRODUCT SAFETY

WARNING: Some dust created by power sanding, sawing, grinding, drilling and other construction activities contains chemicals known to the state of California to cause cancer, birth defects or other reproductive harm. Some examples of these chemicals are:

- Lead from lead-based paints;
- Crystalline silica from bricks and cement and other masonry products;
- Arsenic and chromium from chemically treated lumber.

Your risk from these exposures varies, depending on how often you do this type of work. To reduce your exposure to these chemical: work in a well ventilated area, and work with approved safety equipment, such as those dust masks that are specially designed to filter out microscopic particles.

WARNING: This product can expose you to chemicals including lead, phthalate or bisphenol A which are known to the State of California to cause cancer, birth defects or other reproductive harm. Wash your hands after use. For more information go to P65Warnings

Important Safety Instructions

WARNING: When using electric gardening appliances, basic safety precautions should always be followed to reduce the risk of fire, electric shock, and personal injury, including the following:

WARNING: Read all instructions

FOR ALL APPLIANCES

- 1) Avoid Dangerous Environment - Don't use appliances in damp or wet locations.
- 2) Don't Use In Rain.
- 3) Keep Children Away - All visitors should be kept at a distance from work area.
- 4) Dress Properly - Do not wear loose clothing or jewelry. They can be caught in moving parts. Use of rubber gloves and substantial footwear is recommended when working outdoors. Wear protective hair covering to contain long hair.
- 5) Use Safety Glasses - Always use face or dust mask if operation is dusty.
- 6) Use Right Appliance - Do not use appliance for any job except that for which it is intended.
- 7) Ground Fault Circuit Interrupter (GFCI) protection should be provided on the circuit(s) or outlet(s) to be used for the gardening appliance. Receptacles are available having built-in GFCI protection and may be used for this measure of safety.
- 8) Warning -To reduce the risk of electric shock, use only with an extension cord intended for outdoor use, such as an extension cord of cord type SW-A, SOW-A, STW-A, STOW-A, SJW-A, SJOW-A, SJTW-A or SJTOW-A.
- 9) Extension Cord - Make sure your extension cord is in good condition. When using an extension cord, be sure to use one heavy enough to carry the current your product will draw. An undersized extension cord will cause a drop in line voltage resulting in loss of power and overheating. Table 1 shows the correct size to use depending on cord length and nameplate ampere rating. If in doubt, use the next heavier gage. The smaller the gage number, the heavier the cord. To reduce the risk of disconnection of appliance cord from the extension cord during operating:
 - i) Make a knot as shown in Figure 1; or
 - ii) Use one of the plug-receptacle retaining straps or connectors described in this manual.
- 10) Avoid Unintentional Starting - Don't carry plugged-in appliance with finger on switch. Be sure switch is off when plugging in.
- 11) Don't Abuse Cord - Never carry appliance by cord or yank it to disconnect from receptacle. Keep cord from heat, oil, and sharp edges.
- 12) Don't Force Appliance - It will do the job better and with less likelihood of a risk of injury at the rate for which it was designed.
- 13) Don't Overreach - Keep proper footing and balance at all times.

14) Stay Alert - Watch what you are doing. Use common sense. Do not operate appliance when you are tired.

15) Disconnect Appliance - Disconnect the appliance from the power supply when not in use, before servicing, when changing accessories such as blades, and the like.

16) Store Idle Appliances Indoors - When not in use, appliances should be stored indoors in dry, and high or locked-up place - out of reach of children.

17) Maintain Appliance With Care - Keep cutting edge sharp and clean for best performance and to reduce the risk of injury. Follow instructions for lubricating and changing accessories. Inspect appliance cord periodically, and if damaged, have it repaired by an authorized service facility. Inspect extension cords periodically and replace if damaged. Keep handles dry, clean, and free from oil and grease.

18) Check Damaged Parts - Before further use of the appliance, a guard or other part that is damaged should be carefully checked to determine that it will operate properly and perform its intended function. Check for alignment of moving parts, binding of moving parts, breakage of parts, mounting, and any other condition that may affect its operation. A guard or other part that is damaged should be properly repaired or replaced by an authorized service center unless indicated elsewhere in this manual.

FOR ALL DOUBLEINSULATED APPLIANCES

1) Replacement Parts When servicing use only identical replacement parts.

2) Polarized Appliance Connections To reduce the risk of electric shock, this appliance has a polarized plug (one blade is wider than the other) and will require the use of a polarized extension cord. The appliance plug will fit into a polarized extension cord only one way. If the plug does not fit fully into the extension cord, reverse the plug. If the plug still does not fit, obtain a correct polarized extension cord. A polarized extension cord will require the use of a polarized wall outlet. This plug will fit into the polarized wall outlet only one way. If the plug does not fit fully into the wall outlet, reverse the plug. If the plug still does not fit, contact a qualified electrician to install the proper wall outlet. Do not change the equipment plug, extension cord receptacle, or extension cord plug in any way.

READ ALL INSTRUCTIONS BEFORE USING THIS APPLIANCE

WARNING – To reduce the risk of fire, electric shock, or injury:

1) Do not leave appliance when plugged in. Unplug from outlet when not in use and before servicing.

2) To reduce the risk of electric shock – Do not use on wet surfaces. Do not expose to rain. Store indoors.

3) Do not allow to be used as a toy. Close attention is necessary when used by or near children.

4) Use only as described in this manual. Use only manufacture's recommended attachments.

- 5) Do not use with damaged cord or plug. If appliance is not working as it should, has been dropped, damaged, left outdoors, or dropped into water, return it to a service center.
- 6) Do not pull or carry by cord, use cord as a handle, close a door on cord, or pull cord around sharp edges or corners. Do not run appliance over cord. Keep cord away from heated surfaces.
- 7) Do not handle plug or appliance with wet hands.
- 8) Do not put any object into openings. Do not use with any opening blocked; keep free of dust, lint, hair, and anything that may reduce air flow.
- 9) Keep hair, loose clothing, fingers, and all parts of body away from openings and moving parts.
- 10) Turn off all controls before unplugging.
- 11) Use extra care when cleaning on stairs.
- 12) Do not use to pick up flammable or combustible liquids, such as gasoline, or use in areas where they may be present.
- 13) Do not pick up anything that is burning or smoking, such as cigarettes, matches, or hot ashes.
- 14) Do not use without dust bag and/or filters in place.
- 15) Do not unplug by pulling on cord. To unplug, grasp the plug, not the cord.
- 16) This appliance is provided with double insulation. Use only identical replacement parts. See instructions for Servicing of DoubleInsulated Appliances.

ADDITIONAL SAFETY RULES FOR EXTENSION CORD

- 1) Warning – To reduce the risk of personal injury due to loose electrical connection between the appliance's plug and extension cord, firmly and fully attach the appliance plug to the extension cord. Periodically check the connection while operating to ensure it is fully attached, Do not use an extension cord that provides a loose connection. A loose connection may result in overheating, fire, and increases the risk of a burning.
- 2) To reduce the risk of disconnection of the appliance cord from the extension cord during operating, secure the extension cord to the appliance plug as shown or described in the Operating Instructions.

Warning

This content is compiled from multiple sources and is provided for reference purposes only. It may not be complete or fully applicable to all situations. If you are unable to resolve your issue, please contact the product manufacturer or an authorized service provider for official support.