













## **SYMBOLS**

Some of the following symbols may be used on this product. Please study them and learn their meaning. Proper interpretation of these symbols will allow you to operate the product better and safer.



<b>SYMBOL</b>	<b>DESIGNATION/EXPLANATION</b>
V	Voltage
A	Current
Hz	Frequency (cycles per second)
Wh	Watt Hour - Energy Storage Capacity
Ah	Amp Hour - Current Capacity
DC	Direct current
⎓	Type or a characteristic of current
RPM	Revolutions per minute
□	Double-insulated construction
/min	Revolutions, strokes, surface speed, orbits etc., per minute
	Indicates a potential personal injury hazard.
	To reduce the risk of injury user must read and understand operator's manual before using this product.
	Always wear safety glasses with side shields that are marked to comply with ANSI Z87.1.
	Stop the motor and remove the battery before leaving the machine.
	Thrown objects can ricochet and result in personal injury or property damage
	Danger – Keep hands and feet away from openings while the machine is running. Do not use hands to unclog chute. Stop motor and remove the battery before removing debris.
	Keep hands, feet away from the discharge area.
	Keep bystanders a safe distance from the machine.
	Stay away from moving parts. Keep all guards and shields in place.

The following signal words and meanings are intended to explain the levels of risk associated with this product.

<b>SYMBOL</b>	<b>SIGNAL</b>	<b>MEANING</b>
	<b>DANGER</b>	Indicates an imminently hazardous situation, which, if not avoided, will result in death or serious injury.
	<b>WARNING</b>	Indicates a potentially hazardous situation, which, if not avoided, could result in death or serious injury.
	<b>CAUTION</b>	Indicates a potentially hazardous situation, which, if not avoided, may result in minor or moderate injury.
	<b>CAUTION</b>	(Without Safety Alert Symbol) Indicates a situation that may result in property damage.

## KNOW YOUR SNOW THROWER

Read this operator's manual and safety rules before operating your snow thrower. Compare the illustration in figure 1 to your snow thrower in order to familiarize yourself with the location of various controls and adjustments. Save this manual for future reference.

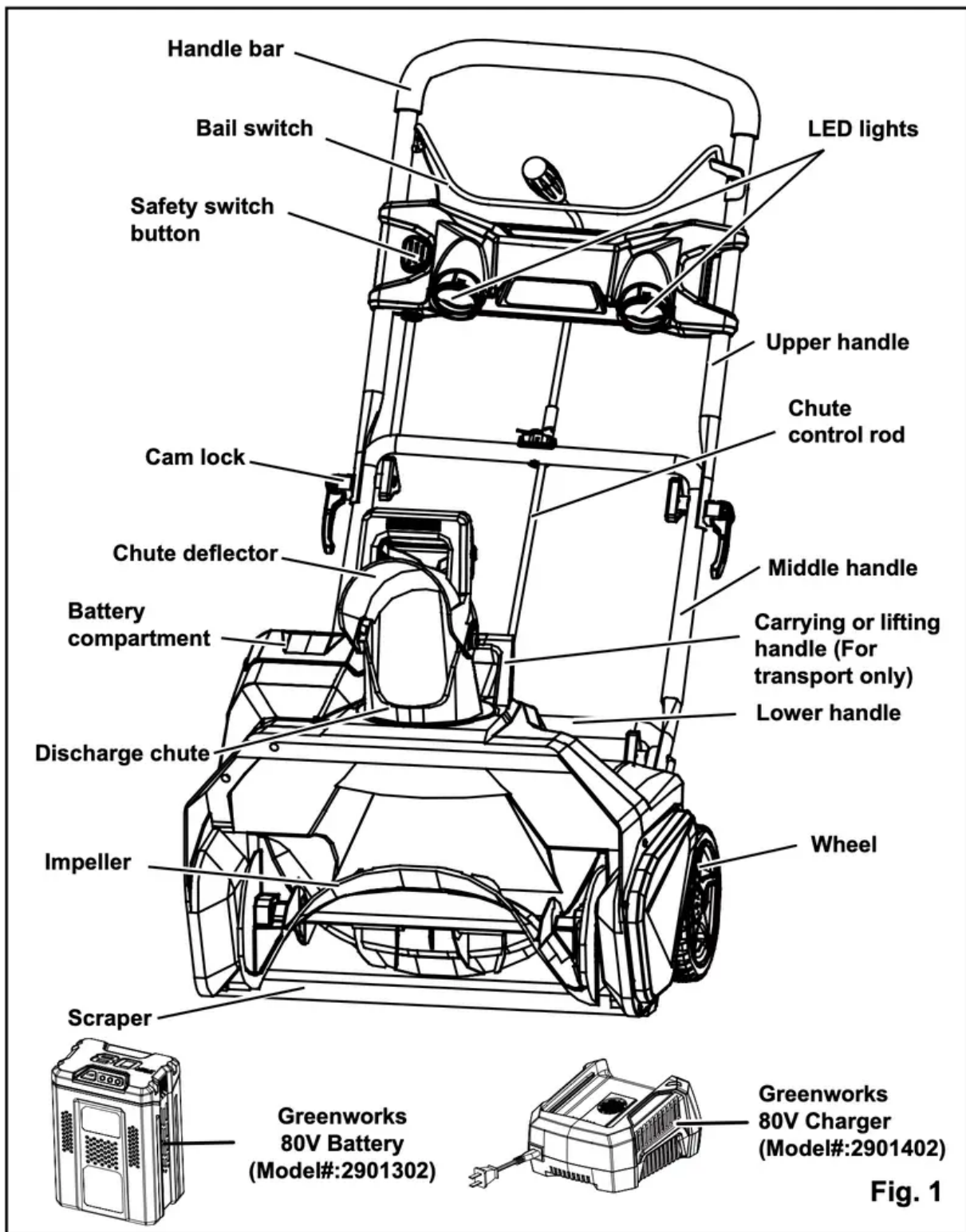

## ASSEMBLY INSTRUCTIONS

### UNPACKING

- Carefully remove the product and any accessories from the box. Make sure that all items listed in the packing list are included.

- Inspect the product carefully to make sure no breakage or damage occurred during shipping.
- Do not discard the packing material until you have carefully inspected and satisfactorily operated the product.
- If any parts are damaged or missing, please call 1-888-909-6757 for assistance.

## **PACKING LIST**

- Snow thrower
- Upper chute control rod
- Lower chute control rod
- Middle handle assembly
- Chute deflector
- Greenworks 80V Battery (Model#: 2901302)
- Greenworks 80V Charger (Model#: 2901402)
- (2) Cam locks
- (2) Bolts
- (4) Handle knobs
- (1) Hitch pin
- Owner's Manual

**WARNING:** If any parts are damaged or missing, do not operate this product until the parts are replaced. Failure to heed this warning could result in serious personal injury.

**WARNING:** Do not install the battery until assembly is complete. Failure to comply could result in accidental starting and possible serious personal injury.

**WARNING:** Do not attempt to modify this product or create accessories not recommended for use with this product. Any such alteration or modification is misuse, and could result in a hazardous condition leading to possible serious personal injury.

**WARNING:** Do not allow familiarity with this product to make you careless. Remember that a careless fraction of a second is sufficient to inflict serious injury.

**WARNING:** Do not use any attachments or accessories not recommended by the manufacturer of this product. The use of attachments or accessories not recommended can result in serious personal injury.

## **ASSEMBLING THE HANDLE** (See Figure 2)

- Align the holes (4) on the middle handle (2) and the lower handle (3). Insert the bolts (5), and use the handle knobs (6) to tighten them.

- Align the hole on the middle handle (2) and the upper handle (1). Insert the cam locks (7) and tighten them with the handle knobs (8) provided. Once tightened, close the cam locks to secure them in place.

**NOTE:** If the upper handle is loose or separated from the middle handle, tighten the cam lock handle knobs by turning them clockwise. Do not overtighten the handle knobs.

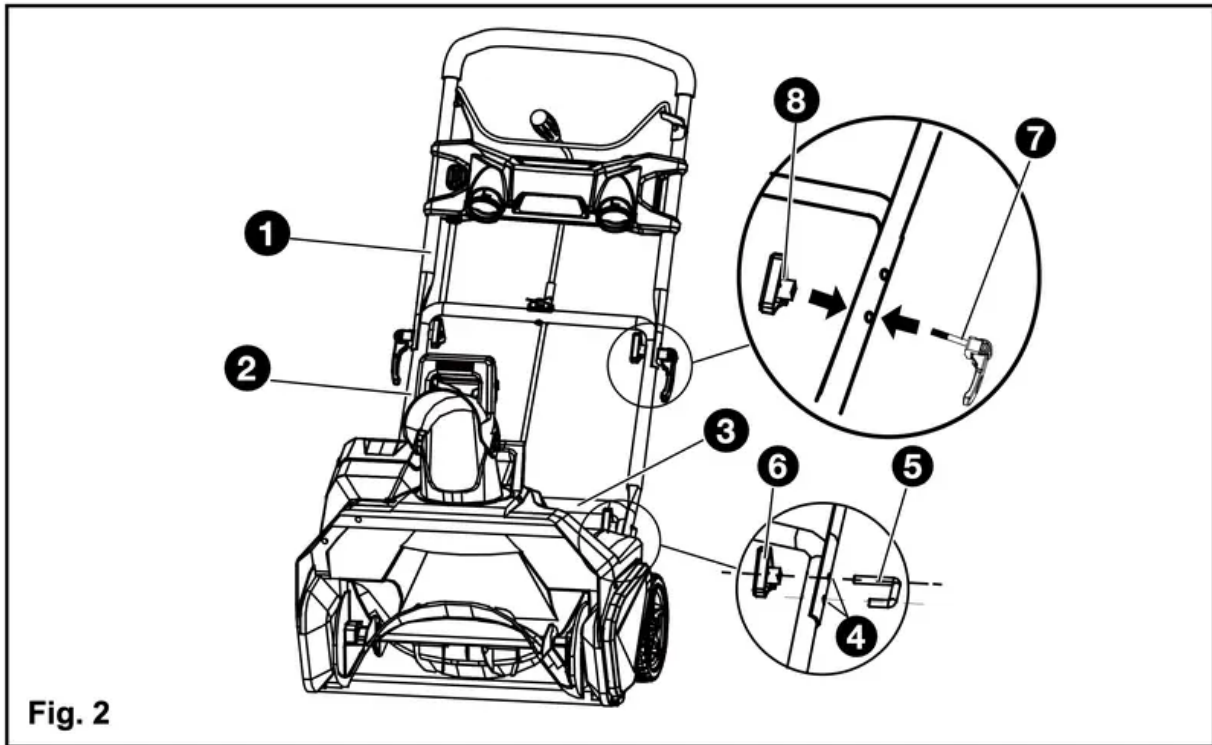

**Fig. 2**

### **ASSEMBLING THE DISCHARGE CHUTE (See Figure 3)**

Push the chute deflector (1) until the latching tabs (2) on both sides click into the slots (3) and the posts (4) on both sides click into the keyed holes (5).

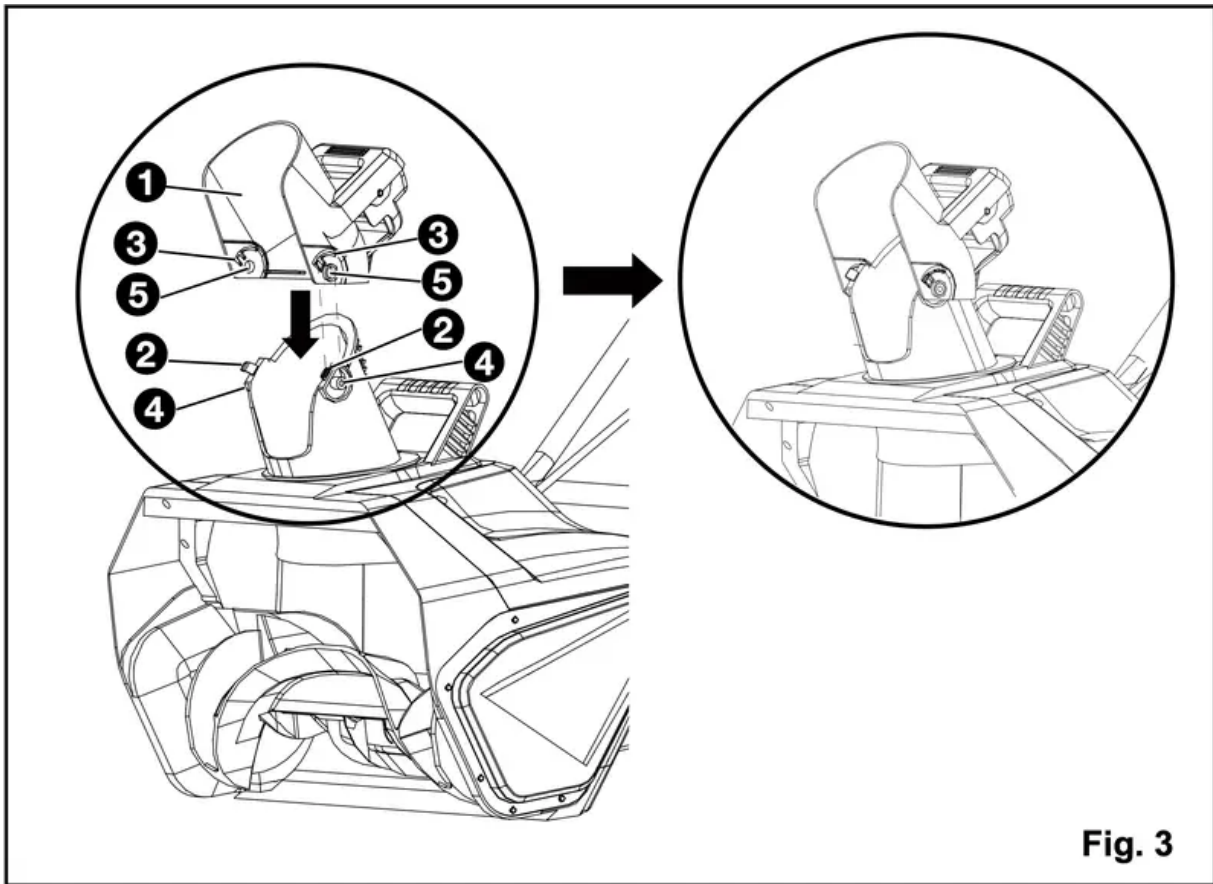

**Fig. 3**

**INSTALLING THE CHUTE CONTROL ROD** (See Figure 4)

- Position the discharge chute (1) so that it faces forward.

**NOTE:** Align the arrow (2) on the discharge chute with the arrow on the housing. (Fig. 4.1)

- Align the holes (3) on the upper chute control rod (4) with the holes on the lower chute control rod (5). Insert the hitch pin (6). insert the end of the chute control rod (7) through the keyed hole (8) in the bracket that is attached to the top of the middle handle. (fig.4.2)
- Ensure that the handle (9) of the chute control rod points upward, and insert the rod into the keyed hole (10) in the back of the housing. (fig.4.3)
- Firmly push the rod into the keyed hole in the back of the housing until it snaps into place.

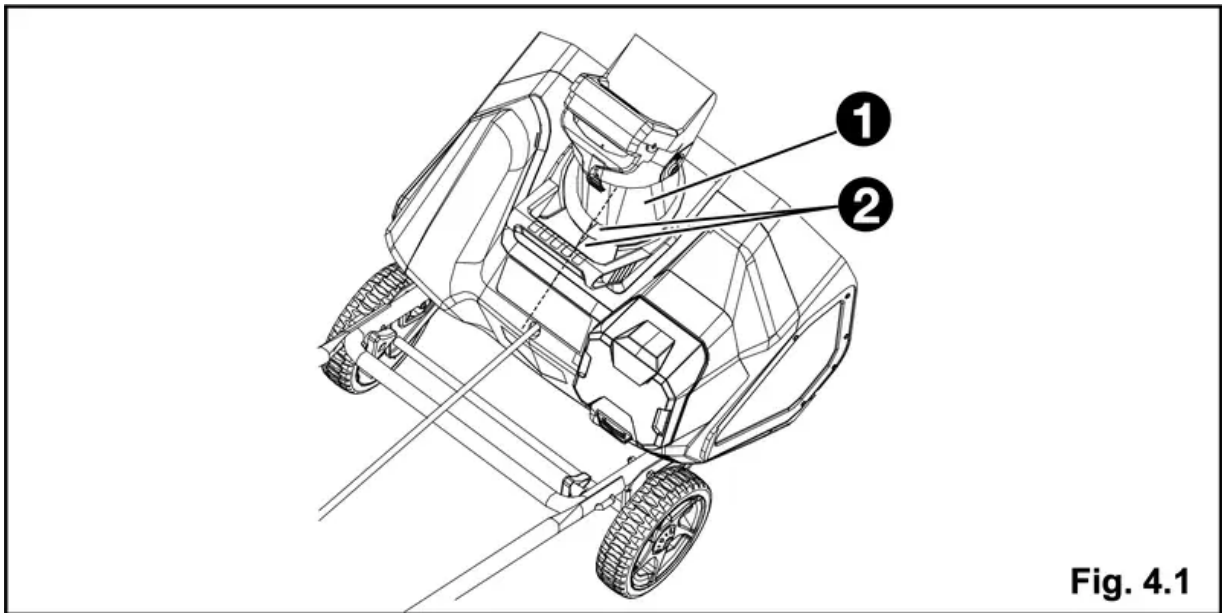

**Fig. 4.1**

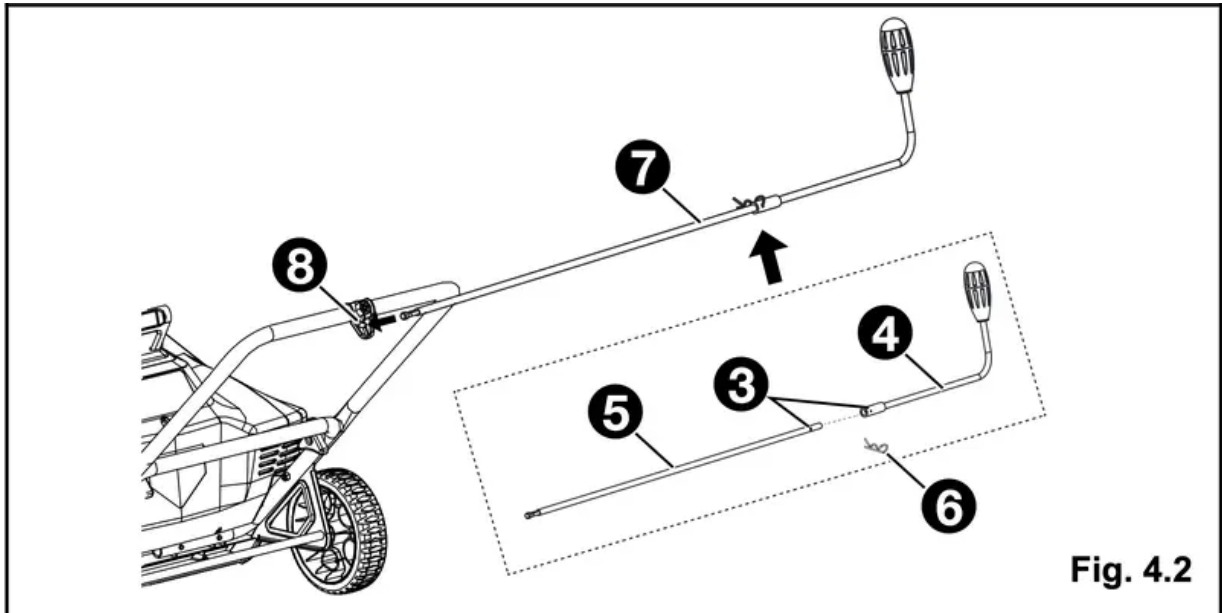

**Fig. 4.2**

- Rotate the handle on the chute control rod to ensure that it moves in the same direction as the chute. (fig.4.4)



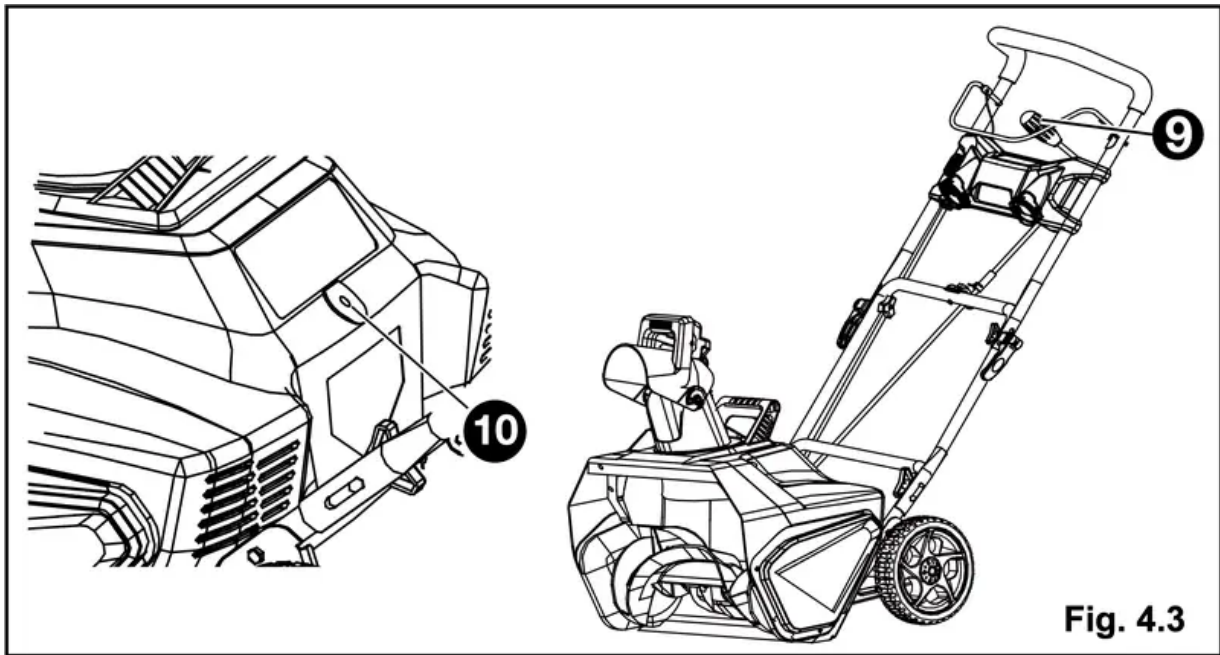

Fig. 4.3

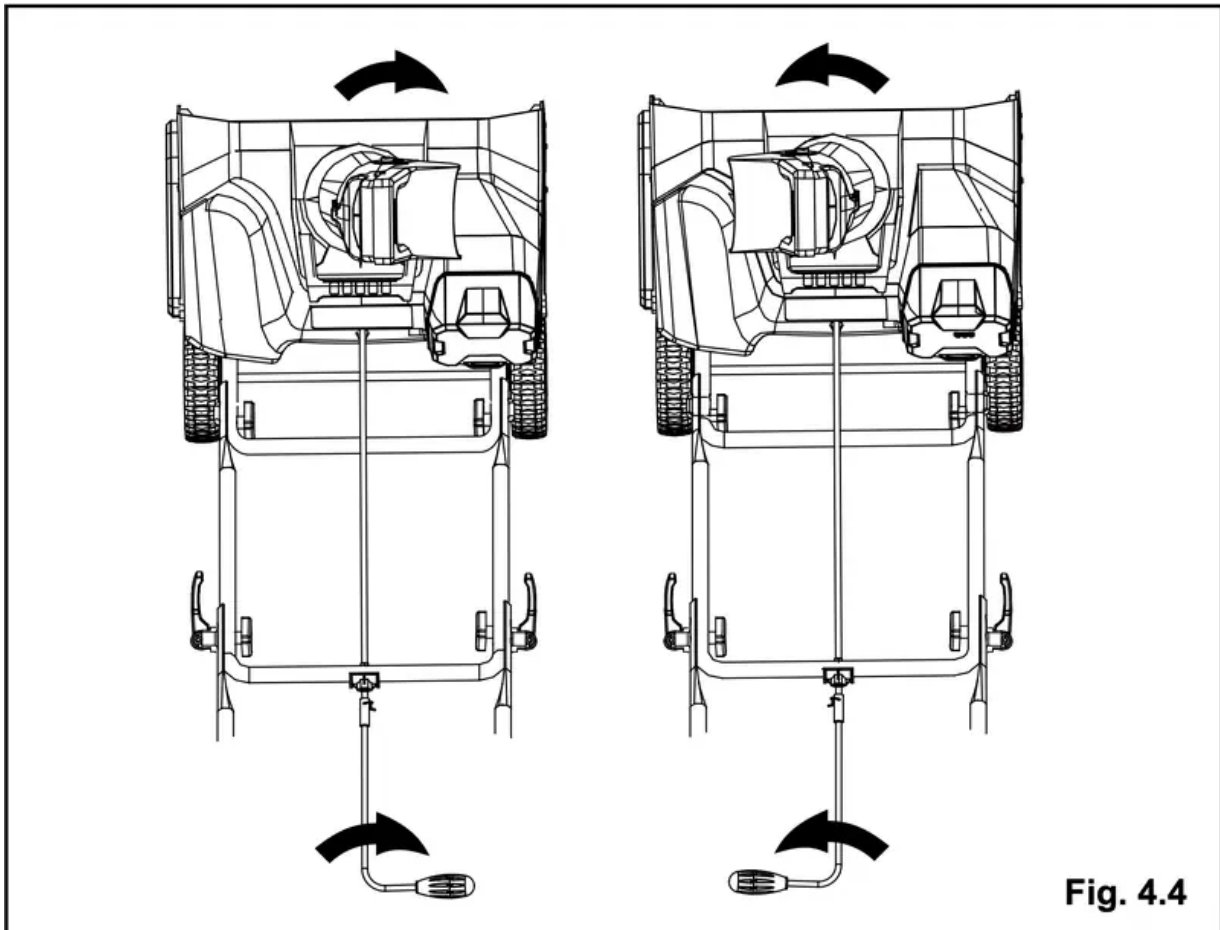
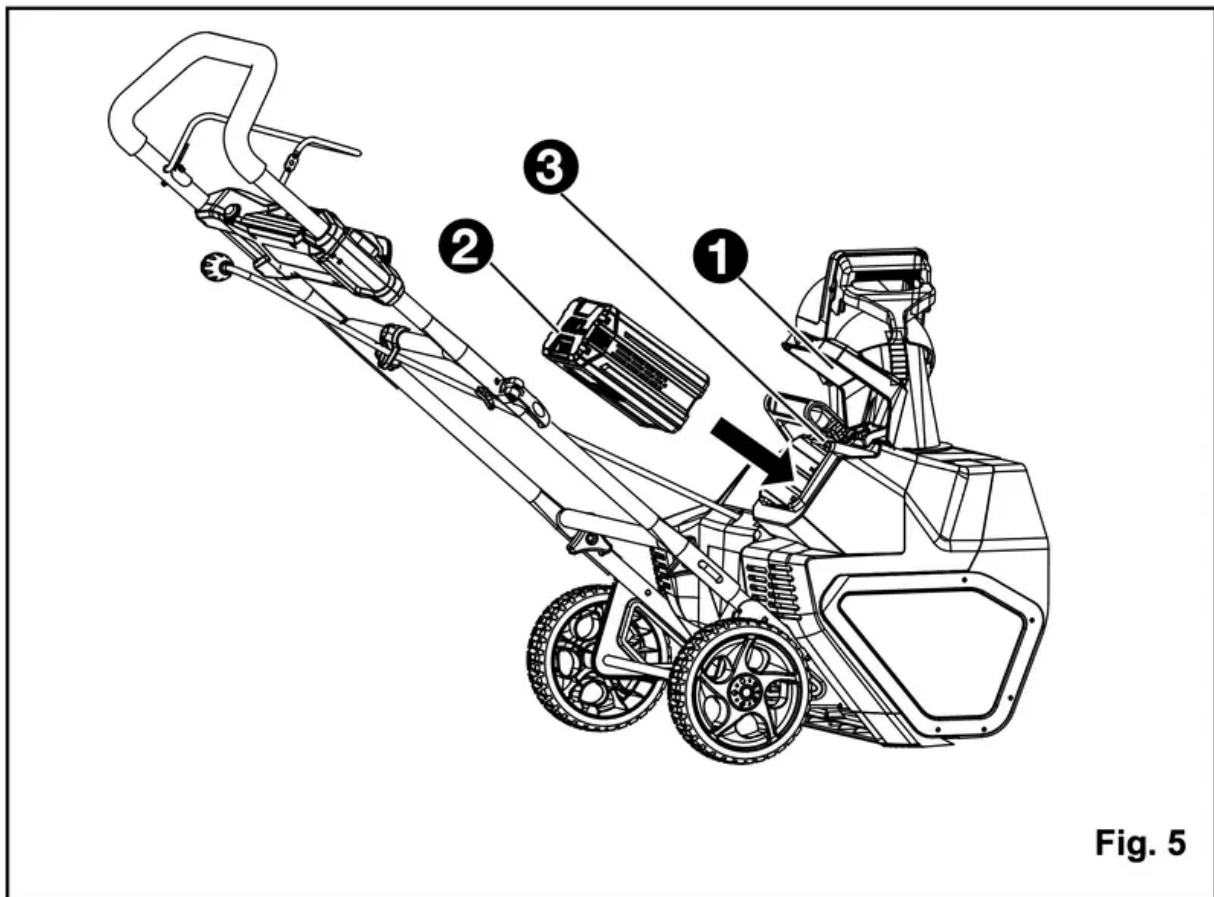

Fig. 4.4

**TO INSTALL BATTERY PACK (See Figure 5)**

- Open the battery compartment cover (1).
- Slide the battery (2) down to lock it into position. The battery is fully inserted into the snow thrower when you hear an audible "click".
- Close the battery compartment cover (1).



**Fig. 5**

#### **TO REMOVE BATTERY PACK (See Figure 5)**

- Ensure that the impeller has come to a complete stop.
- Release your grip on the bail to stop the snow thrower.
- Press the battery release button (3) on the snow thrower. This will cause the battery to raise out of the tool slightly.
- Remove battery pack from the snow thrower.

## **OPERATING INSTRUCTIONS**

#### **POWERING ON AND OFF (See Figure 6)**

- To power on, first press the safety switch button (1).
- While pressing the safety switch button with one hand, use your other hand to simultaneously pull the bail switch (2) toward you. Once the machine powers on, release the safety switch button and proceed with operation. The snow thrower can only be started by pressing the safety switch button first, followed by squeezing the bail switch; reverse operation will not start the machine.
- To power off, release your grip on the bail switch.

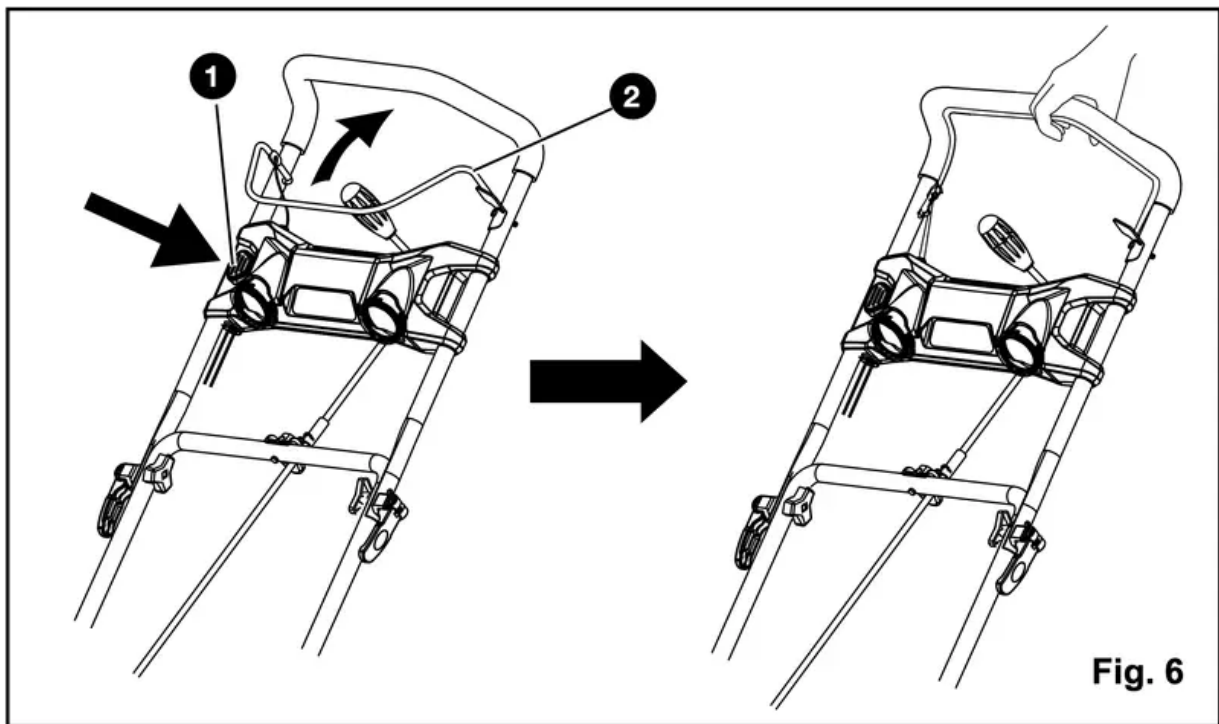

**Fig. 6**

**CAUTION:** Do not attempt to override the operation of the safety switch button or bar lever.

**WARNING:** The operation of any snow thrower can result in foreign objects being thrown into the eyes, which can cause severe eye damage. Always wear safety glasses while operating the snow thrower and while performing any adjustments or repairs.

**WARNING:** Keep bystanders a safe distance from the machine.

**INSPECT THE CLEARING AREA.** Remove all stones, sticks, wire, bones, and other debris that might be thrown by the rotating impeller.

**UTILIZING THE LED LIGHTS** (See Figure 7)

- To utilize the LED lights (1) for night time snow removal, activate the LED light switch (2).

**NOTE:** After you have finished using your snow thrower, remember to turn off the light switch.

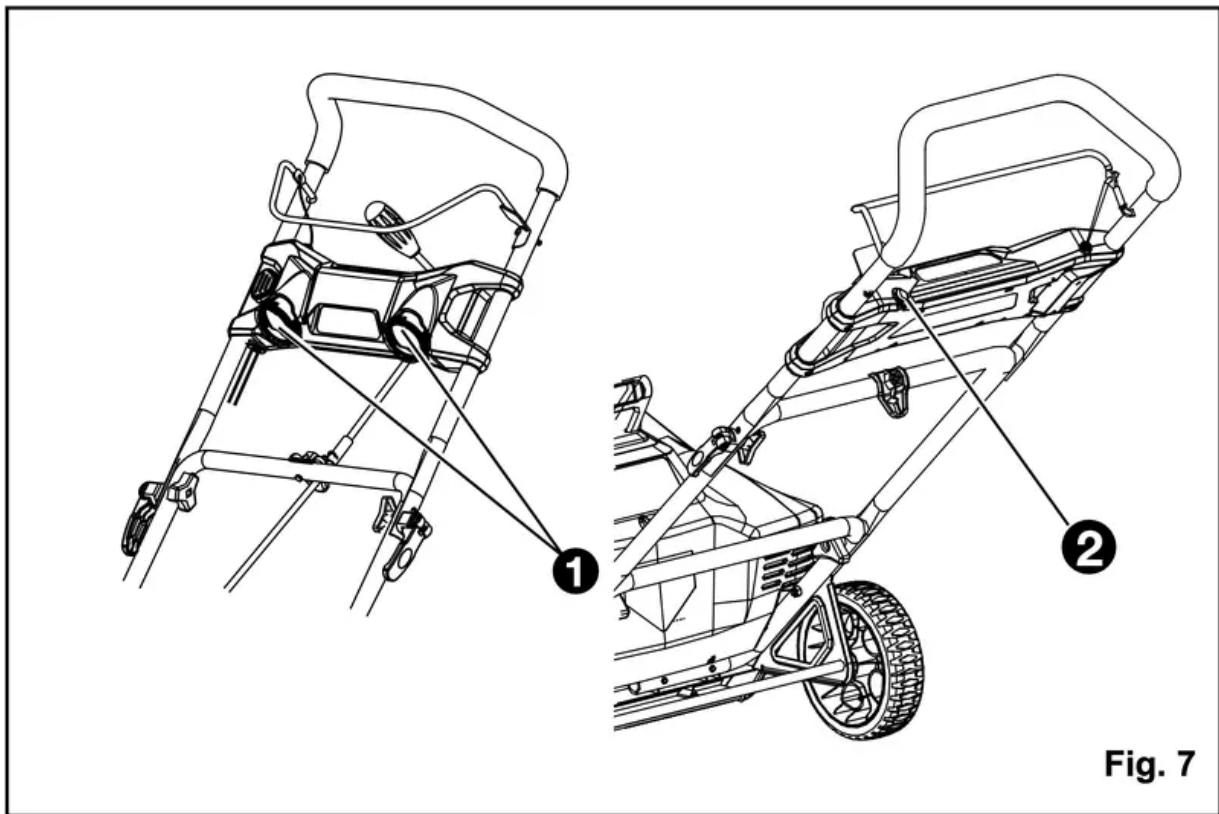

**Fig. 7**

**ADJUSTING THE DISCHARGE CHUTE AND CHUTE DEFLECTOR (See Figure 8)**

- To adjust the discharge chute, rotate the handle (1) on the chute control rod in the direction that you wish to direct the snow stream.
- To adjust the chute deflector (and therefore the height of the snow stream), squeeze the trigger (2) and raise or lower the chute deflector.

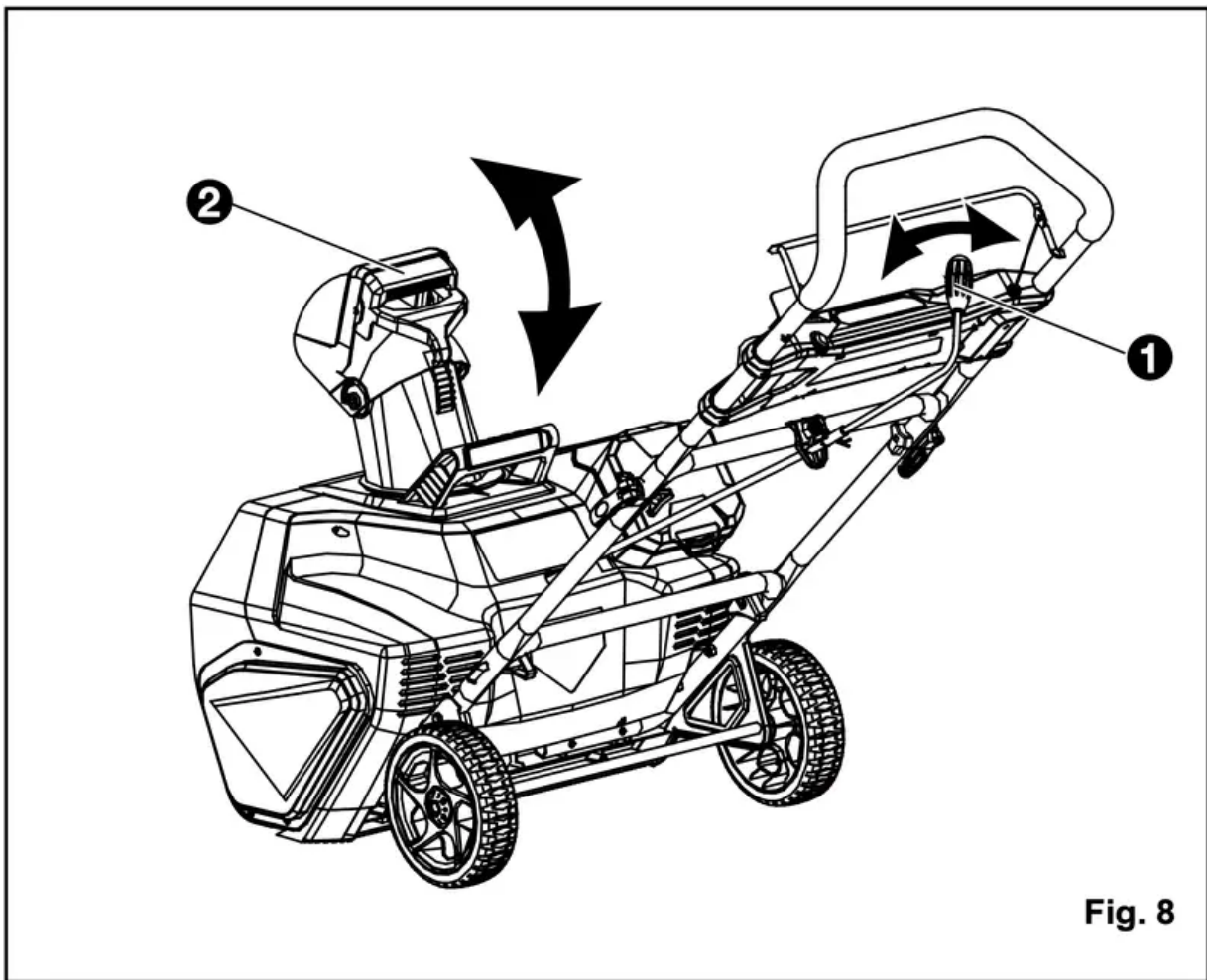

Fig. 8

### OPERATING TIPS

**WARNING:** If the Snow Thrower hits a foreign object while it is in use, the object could be thrown in the direction of the operator or a bystander. Thrown objects could cause serious personal injury. Keep the area to be cleared free of all foreign objects that may be picked up and thrown by the impeller.

- Keep the area of operation free of foreign objects that can become thrown by the impeller. Perform a thorough inspection of the area since some objects may be hidden from view by surrounding snow. If the snow thrower hits an obstruction or picks up a foreign object during use, stop the snow thrower, remove the battery, remove the obstruction, and inspect the unit for damage. Repair or replace any damaged part before restarting and operating the unit.
- Keep children, pets, and bystanders away from the area of operation. Be aware that the normal noise of the machine when turned on may make it difficult for you to hear approaching people.
- When moving the snow thrower, use the wheels on one side as the pivot point. Slightly tilt the snow thrower on this pivot point to move it forward or backward.

- Start your clearing path outward, throwing snow in a back and forth motion. To clear in the opposite direction, pivot the snow thrower on its wheels. Make sure to overlap clearing paths.
- Note the wind direction. If possible, move in the same direction as the wind so that the snow is not thrown against the wind (and thus back onto you and on the just cleared path).
- Do not push the snow thrower with excessive force. You should push the machine gently and at a consistent speed in accordance with the unit's throw rate.
- Some parts of the snow thrower may freeze under extreme temperature conditions. Do not attempt to operate the snow thrower with frozen parts. If the parts freeze while the snow thrower is in use, stop the snow thrower, remove the battery, and inspect for frozen parts. Free all parts before restarting or operating the snow thrower. Never force controls that are frozen.
- When working on pebbles, gravel, or unpaved surfaces, avoid throwing loose surface material along with the snow by pushing down on the handle to raise the scraper at the base of the unit above the pebbles or gravel.
- Cold Weather Operation: Lithium ion batteries can be safely used from temperatures ranging from -17 degrees to 45 degrees Celsius.  
**NOTE:** Do not store or charge battery outside. Battery must be charged and stored indoors prior to use of the snow thrower.
- If the Snow thrower does not start initially remove battery from snow thrower. Place battery on charger and allow to charge for 10 minutes. Remove from charger and install in Snowthrower for use. The start-up issue may be caused from the battery being too cold. To avoid this issue, ensure battery is stored in a dry cool place for storage and charging and leave indoors until ready for use.

## MAINTENANCE

### SERVICING

Servicing should be performed by a qualified technician. Replacement parts for this snow thrower must be identical to the parts that they replace. If repairs are necessary, contact the toll-free helpline, at 1-888-909-6757.

**Note:** Identify the left and right sides of the snow thrower when standing in the normal operating position.

**WARNING:** If the battery pack is installed into the snow thrower, the snow thrower could start accidentally while the operator is performing maintenance on it, which could cause serious personal injury. Remove the battery pack before performing any maintenance.

## STORAGE

- Run the snow thrower for a few minutes in order to melt any snow that may be left on the snow thrower.
- Wipe the snow thrower off with a dry cloth before storage. This will help prevent ice building up on the unit and parts freezing.
- Remove the battery and store it in a cool dry location, if possible. Charge the battery every six months when not in use in order to increase its life.
- Inspect the snow thrower thoroughly for worn, loose, or damaged parts. If any parts must be repaired or replaced, contact the Toll- free Helpline, at 1-888-909-6757.
- Store the snow thrower in a clean, dry place. Cover it in order to provide added protection.
- Always store battery and charger indoors.

## REPLACING THE SCRAPER (See Figure 9)

The scraper is located at the bottom of the impeller housing.

- Ensure that the battery is not installed in the tool.
- Remove the screw (1) from each side plate that holds the scraper and 3 screws (2) from under the machine that secures the scraper to the machine.
- Remove and discard the old scraper.
- Install the new scraper, and fasten it securely with 5 screws that you previously removed.

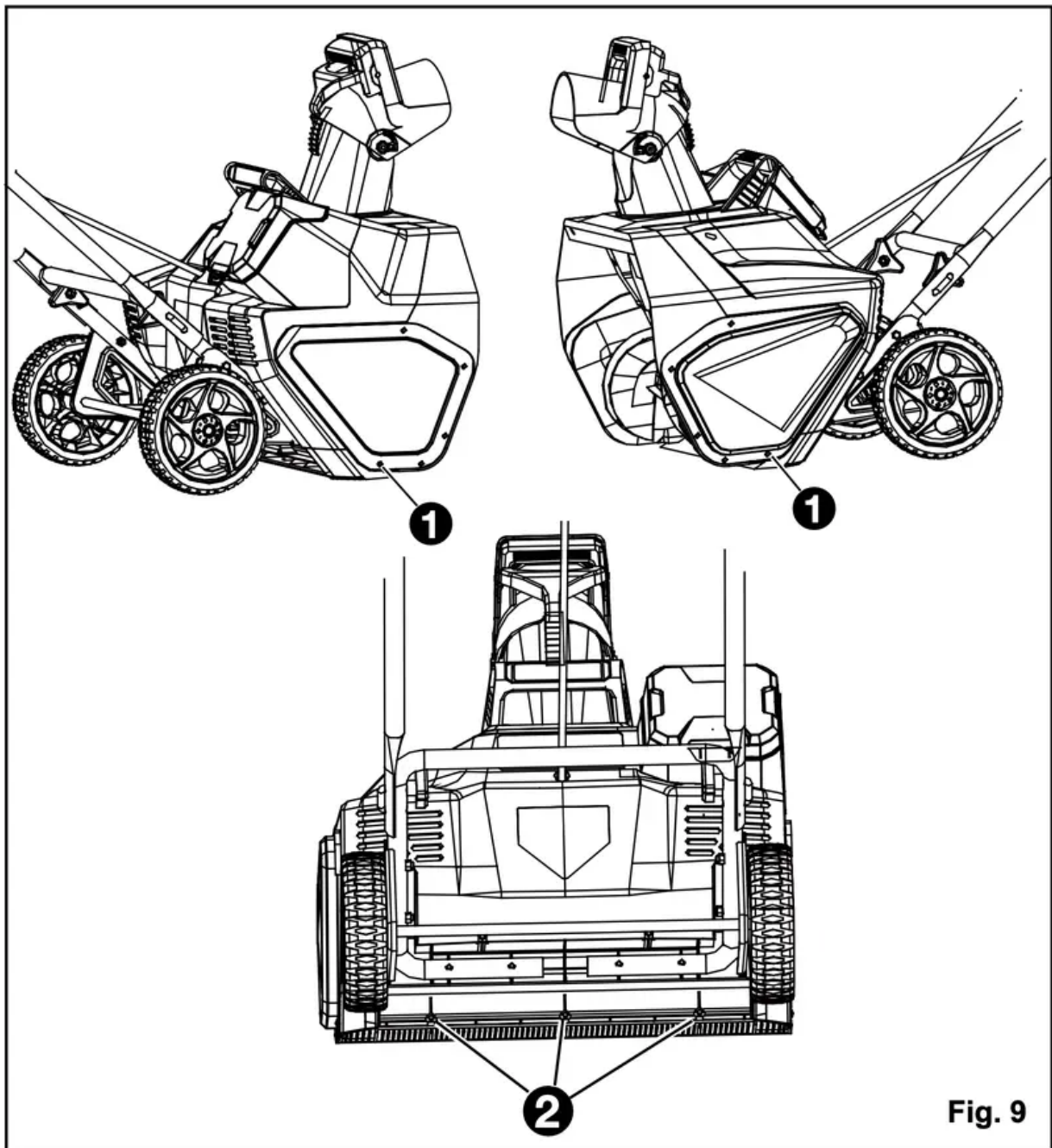

**Fig. 9**

### **REPLACING THE DRIVE BELT (See Figures 10)**

- Ensure that the battery is not installed in the tool.
- Remove the 5 screws (1) that secure the left side plate (2) to the frame of the snow thrower. Remove the side cover.
- Remove the old belt (3) from the small pulley (5) and large pulley (4).
- Loop one end of the new belt over the small pulley.
- Rotate the impeller with the left hand while positioning the belt on the large pulley with the right hand.
- Install the left side cover, and secure it using the 5 screws.

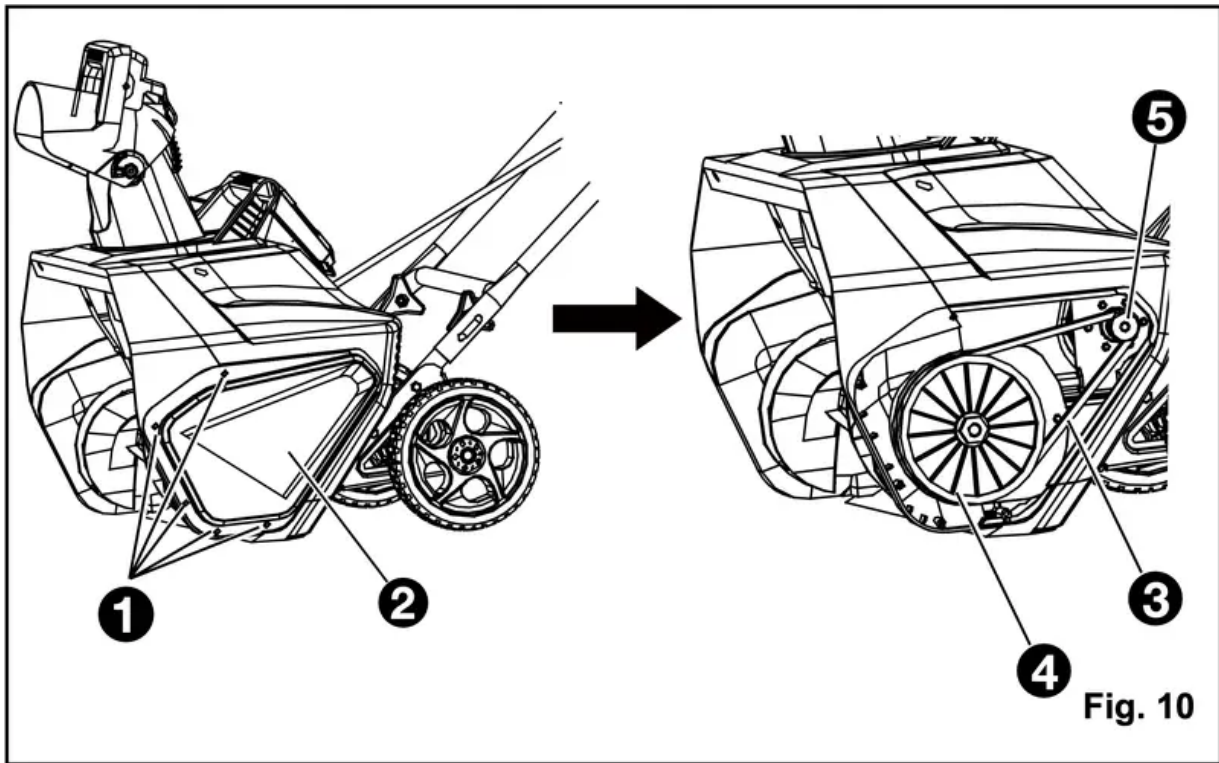

#### REPLACING THE IMPELLER (See Figures 11-13)

- Remove the 5 screws (1) that secure the right side cover (2) to the frame of the snow thrower.
- Remove the nut (3).
- Remove the 5 screws (4) that secure the left side cover (5) to the frame of the snow thrower.
- Remove the belt (6).
- Using a socket, remove the the large pulley (7).
- Remove the 5 screws (8) that secure the left side plate (9) and remove the left side plate.
- Pull the axle (10) and remove the old impeller (11).
- Install the new impeller.
- Reinstall the left side plate, large pulley, belt and left side cover.
- Reinstall the nut and right side cover.

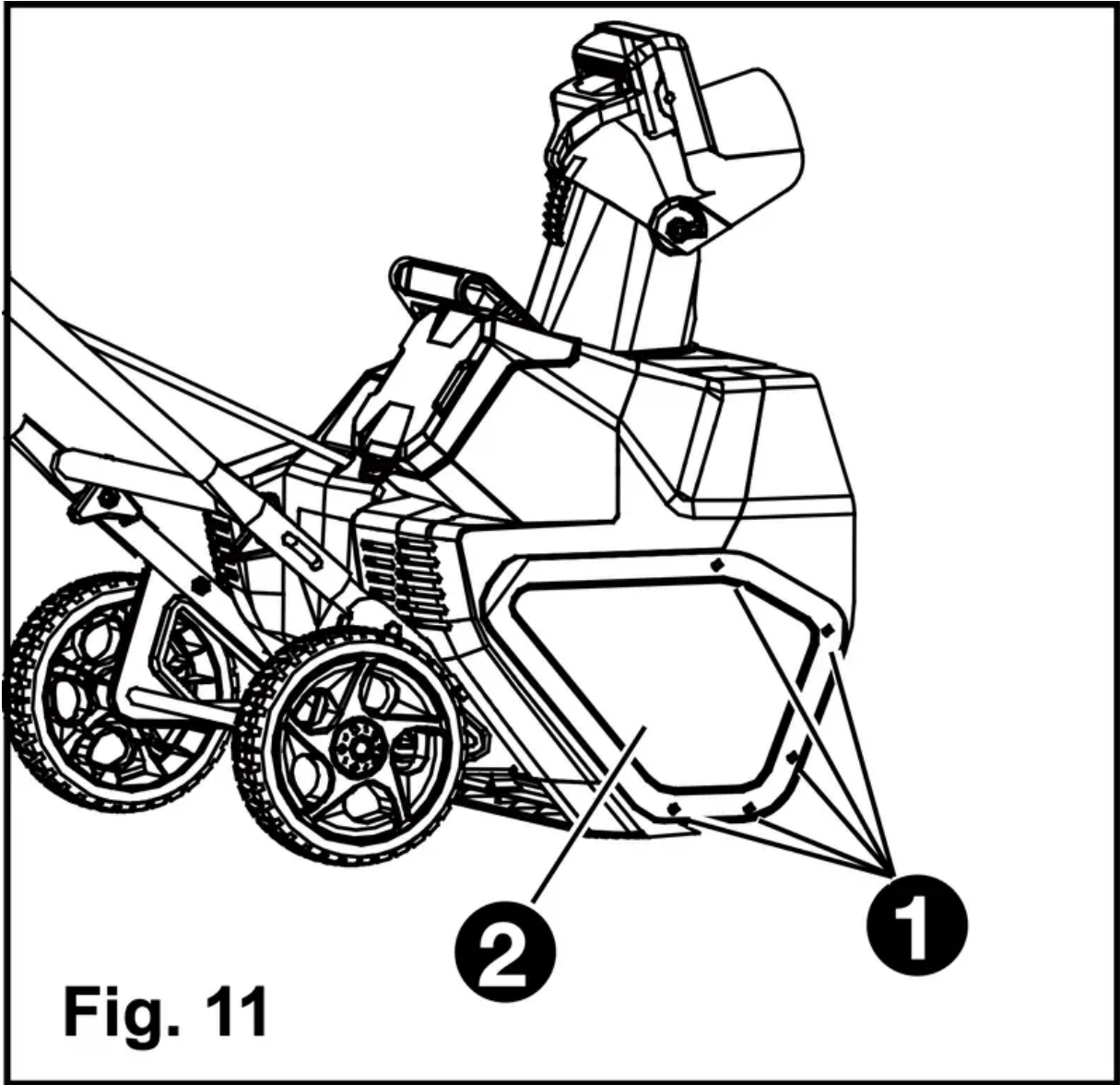

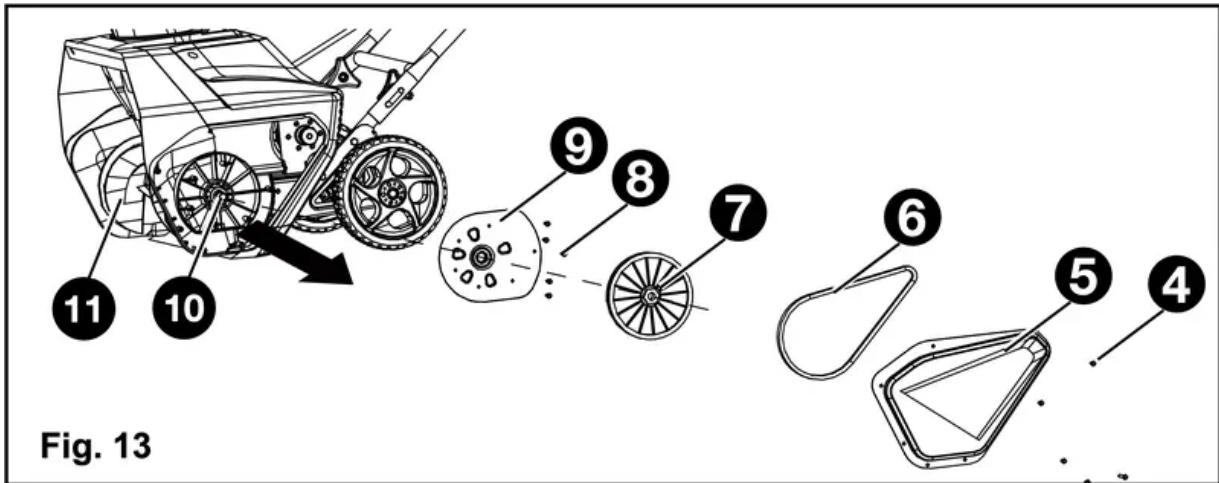
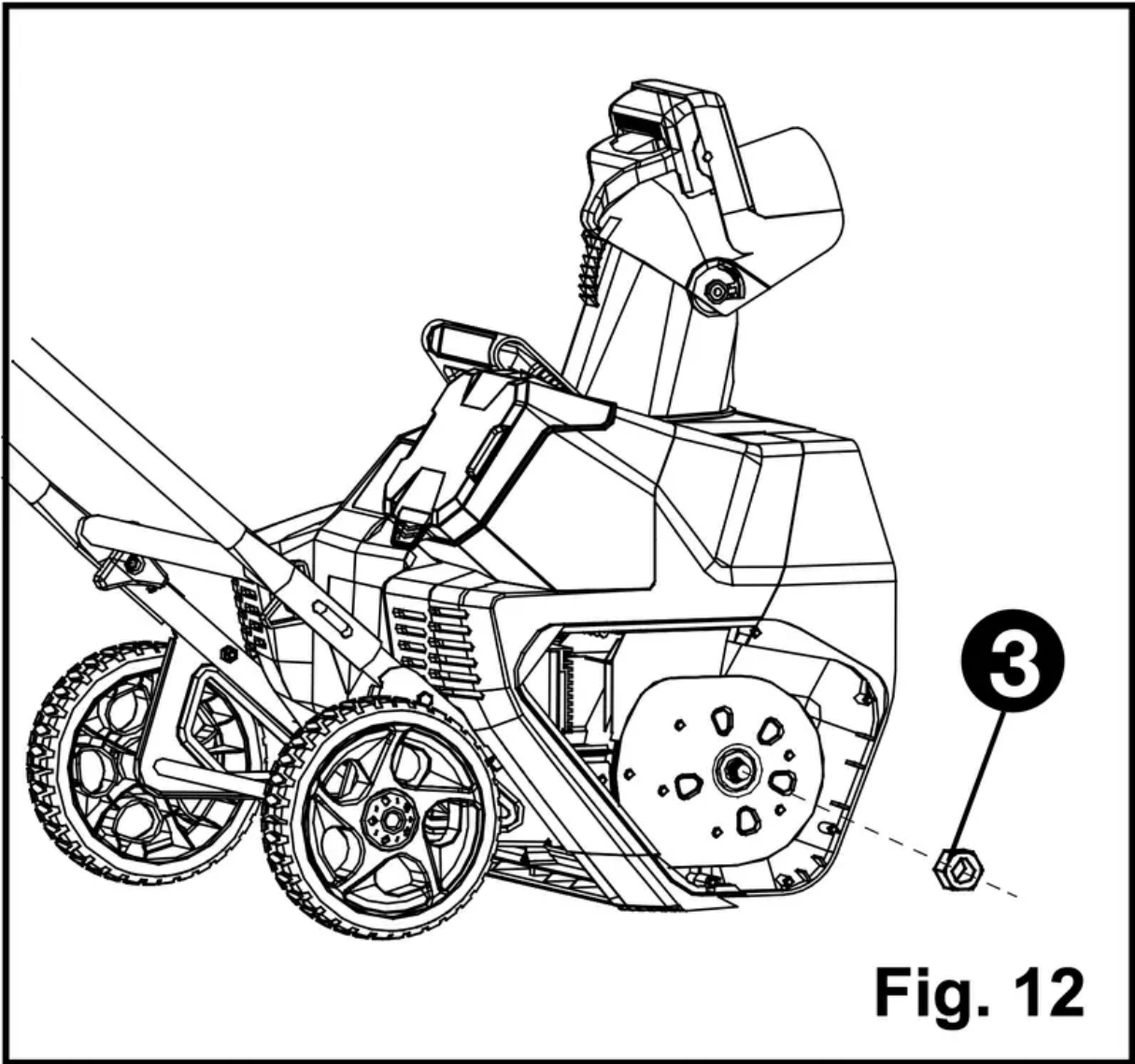

## TROUBLESHOOTING

PROBLEM	POSSIBLE CAUSE	SOLUTION
Then handle is not in position.	The bolts are not properly seated.	Make sure the bolts are correctly installed through the handle bars. Check to see if the hand knobs are tight.  Refer to Assembling the Handle section in this manual.
The snow thrower doesn't start.	The battery is not charged.	Charge the battery by following the procedures in the battery and charger manual.
	The switch is defective.	Have the switch replaced by an authorized service center.
	Battery is too cold.	Remove battery from snow thrower. Place battery on charger and allow to charge for 10 minutes. Remove from charger and install in Snow thrower for use.
	The battery is not attached to the motor.	Check the connection between the motor connector and the battery.
	Battery may require service or replacement.	Call toll free helpline, at 1-888-909-6757 or replace battery.
The motor is on, but the impeller does not turn.	The belt is damaged.	Replace the belt (see the section entitled Inspecting/Replacing the Drive Belt).
The snow thrower leaves a thin layer of snow behind.	The scraper is worn.	inspect the scraper for wear or damage. Replace the scraper (see the section entitled Replacing the Scraper).



**Warning**

This content is compiled from multiple sources and is provided for reference purposes only. It may not be complete or fully applicable to all situations. If you are unable to resolve your issue, please contact the product manufacturer or an authorized service provider for official support.

---

Document generated by [ManualsFile](#)