

Control Panel



 Child Lock

Press the button and hold for 2 seconds and the control panel will be locked

 Timer Button

Press to initiate the auto start and auto stop feature

 Mode Button

Press mode button to choose dry clothes function

 Lighting Button

Control the LED panel's light on/off

 Speed Button

Control the fan speed

 Dehumidify Button

Control the humidity setting up/down

 Power Button

Press to turn the dehumidifier on and off

Setting

Setting Humidity

The humidity level can be set within a range of 30%RH to 80%RH in 5% increments.

- - When it starts work. it will first automatically detect and show the room's humidity. In dehumidification mode (other modes are invalid). Press the "Dehumidify" button to change the humidity selection in 5% increments. "  " Flash and show the setting humidity.

When the "  " flashing. you can set the humidity within a range of 30%RH to 80%RH in 5% increments. Press "Dehumidify Button" to make the humidity setting increase by 5%RH.

After you don't operate the machine 5S. "  " the will show the actual room humidity.

- -When the humidity level is higher or drops to the level you have set. the dehumidifier will automatically begin to work or stop.
- -When the humidity level is set at 30%RH. the dehumidifier will be work at continuous dehumidifying mode.

Timer Setting

This setting is used for you to be able to set a time when you can set the timer to turn off and on the machine automatically.

1. Press the "TIMER" button to select the timer by 1-hour increments. You can set the timer up to 24 hours. It will start to do the countdown when you start the timer.
2. Press and hold the "TIMER" button for several seconds to make the selection of the timer faster.
3. If the time is set to 00, this is called the invalid time. If you set the timer successfully, the light "  "will light up. The led screen will show several seconds time. and show the current humidity.

Speed Button

Controls the fan speed.Press to select either High or Normal fan speed.

Higher fan speed will result in quicker moisture removal. Set the fan control to High for maximum moisture removal. When the humidity has been reduced and quiet operation is preferred. set the fan control to Normal.

Light Function Settings

1. In the power on state. press the [Lighting] button to make the backlight on and press the button one more time to make the backlight off.
2. If the light function is turned on except the "Power" button and the "Lighting" button on. other backlight indicators are turned off.

Lock(2s)



When the unit is turned on. press "LOCK" and hold on for 2 seconds. the control panel will be locked together with the other buttons. To unlock the control panel. press and hold the "LOCK" button again for 2 seconds.

Power Off Memory Function

- The device automatically restores the working state after power on.
- If the device is turned on and a power interruption occurred. after starting the unit again. it will keep the parameters or settings that was setup.
- If the device is turned off and power interruption occurred. the device will still be in a power off status when turned on.

Overflow Protection

When the bucket full of water. the machine will turn off automatically.

The indicator light  will flash. After you empty the water from the bucket the indicator light  will turn off. The machine will restart to work.

Auto Defrost Feature











When the dehumidifier is running at a lower temperature. the system will automatically determine whether there is a presence of frost. If the machine determines there is a presence of a frost. it will defrost automatically.

Defrost Action

The fan runs at high wind speed when the compressor stops.

Display Status Description

- When the device is currently powered on. when turning it off only the "POWER" will light up indicating device is in "Standby" status.

- Timer indicate light “  ”: If the timer is setup properly. the indicator will light up, when the timer is not setup properly the indicator light will be showing off.
- The lighting button “  ”: When use the light up function the light will up. if don't use the light will off.
- High- speed indicate light  If you set the unit to high speed fan mode, it indicator will light up.
- Low-speed indicate light  If you set the unit on low speed fan mode, it indicator will light up.
- Dehumidify mode light indicator  When the machine starts to dehumidify, the indicator light will be showing.
- Dry clothes light indicate “  ”: when dry clothes mode is selected. it will be on. otherwise it will be off.
- Water full light indicator “  ”When the water tank or bucket is full. this indicator will be flashing.
- LOCK indicator light “  ”: The indicator will light up if the control panel is locked successfully, if not the indicator will not show up.
- In the instance of having problems. the device will alarm and “  ” it will flash and show the error or fault code. (The alarm error or fault code and the humidity rotation will appear)
- When the dehumidifier working normally “  ”, will show the current humidity.

Instructions for Drying Clothes

The dehumidifier can be used for drying clothes in rainy weather.

Step 1.

Hang the washed clothes in a small space such as cloakroom. bathroom. or storage room.

Note: Keep away the unit from the water drip from the washed clothes.

Step 2.

Open the dehumidifier and set the humidity level at 30%RH. It is best if you let the air outlet of the dehumidifier to blow air to the clothes directly.

1. The drying effect will vary from the thickness of clothes, the number of clothes and the size of the drying space. Theoretically, the effect will be better when clothes are few, thin and space is small.
2. The drying process would take 3-8 hours, and we suggest that continuous drainage mode is more suitable when drying clothes.

Error & Protection Code

1. **E1** Humidity sensor error
2. **E2** Defrost temperature sensor error
3. **E4** Temperature sensor error
4. **E7** Bucket is full, empty the bucket

Attention

When the machine signals the alarm, it will flash or display the alarm. In case there are multiple errors on the unit, it will show the error in a turn display behavior.

1. If the display reads "E1", "E2" or "E4" error codes, please turn off and unplug the unit, and check for any obstructions. Plug it in again and restart the dehumidifier.
2. When one of the above malfunctions occurs, the buzzer will alarm for a few seconds. Press any key during the alarm to release the alarm sound. If the malfunction is still present, please don't hesitate to contact Kesnos Customer Service email: support@kesnos.com for help.

Note:

Before starting the machine, please ensure that the air outlet has been opened, otherwise the machine will overheat. Do not pull out the power cord directly to stop the machine.

Empty the Tank or Bucket

There are two ways to remove collected water.

Use the Bucket

When the water tank is already full, the Full Tank Alert indicator will light up, the dehumidifier will automatically shut down until the tank has been emptied and placed back to the unit.

Ways to Empty the Water Tank

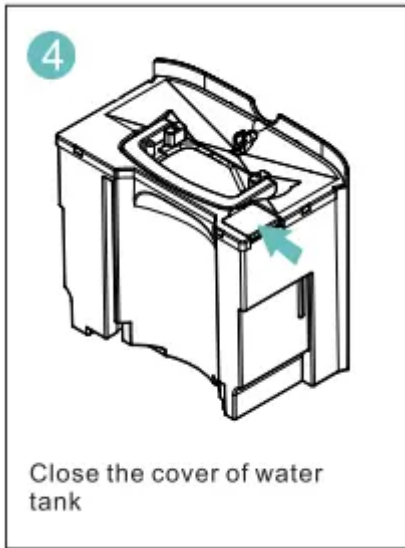
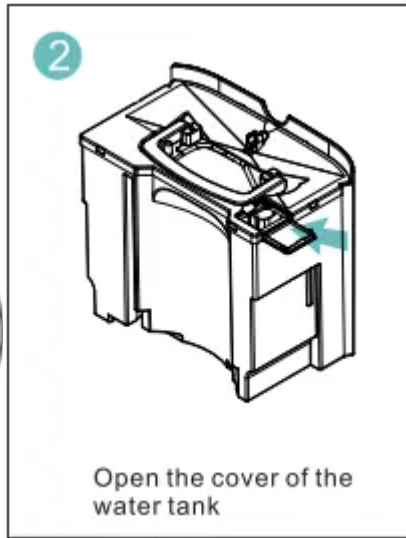
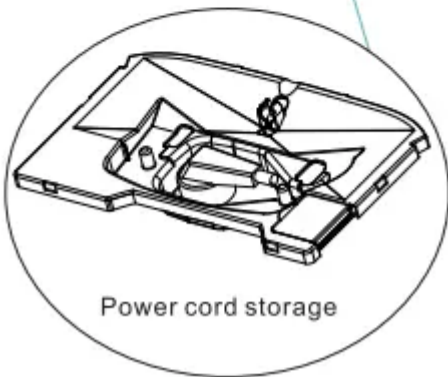
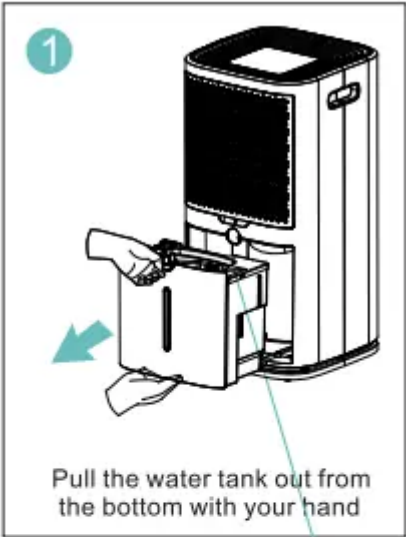



Note:

- Do not remove the float from the water tank. If the float in the water tank is removed, the sensor may not be able to determine the water level stored in the tank properly that may lead to water overflow leak from the water tank.
- If the water tank is dirty, just use cold water or warm water to clean it. Do not use detergent, steel wool, chemically treated dust cloth, gasoline, benzene, thinner or other solvents. Otherwise, it may damage the water tank and cause it to leak.
- When placing back the water tank, use your hands to press the tank back in its place. If the water tank is not placed properly, sensors or protections from water overflow may not operate as expected.

Continuous Drainage

Remove the power supply, take out the water tank, open the drain cover, insert the water pipe into the continuous drain port and push it back into the water tank. Connect the power supply to start the operation. The water outlet of the water pipe should be lower than the continuous drainage port by more than 3.9inches, and the water pipe cannot be bent.

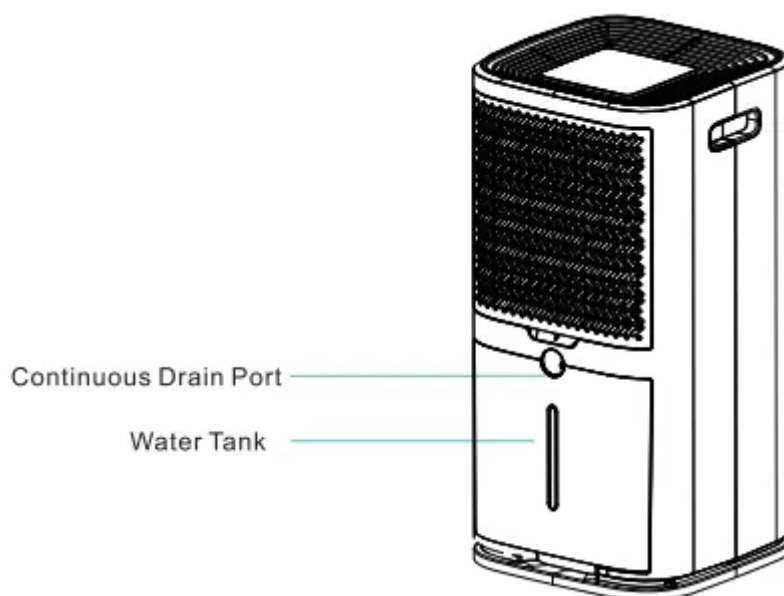
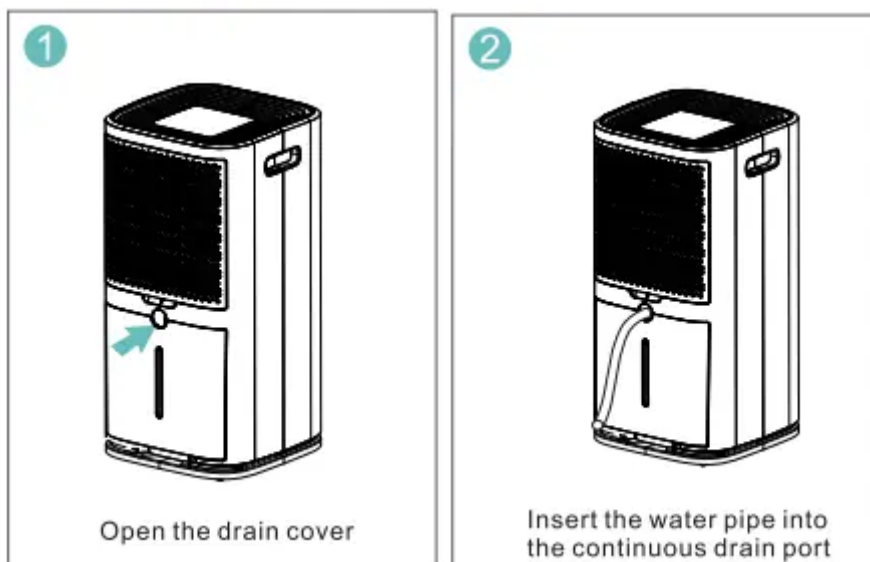

CLEANING AND MAINTENANCE

WARNING

Turn the dehumidifier off and remove the plug from the wall outlet before cleaning.

A- Cleaning the dehumidifier body

Please use only a soft and a bit wet textile or cloth to clean it.

B- Cleaning filter

- Pull out the filter.

- Clean the filter: Use a vacuum cleaner to gently remove the dust from the surface of the filter. If the filter is very dirty, wipe it with warm water and a mild detergent and dry it completely. Slowly insert the filter back into the fuselage.

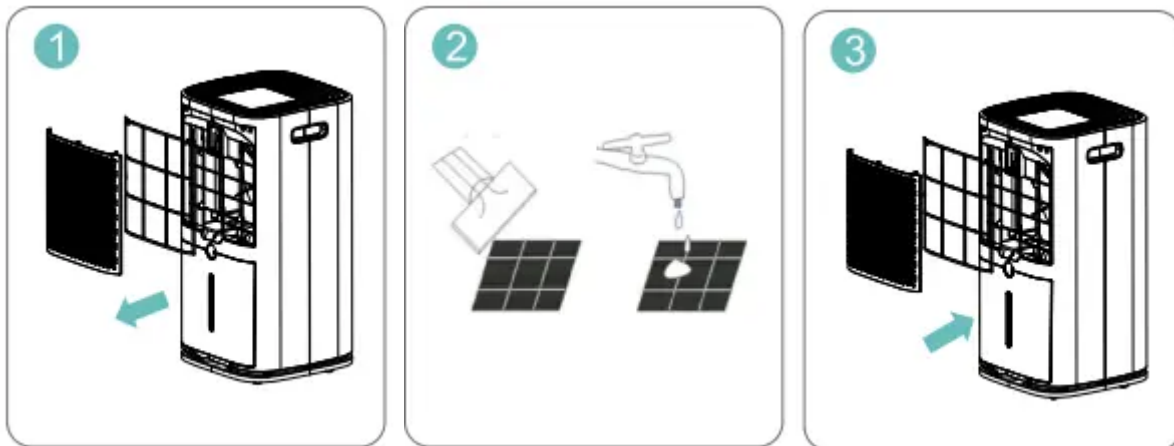

C- Dehumidifier storage

When you want to store the dehumidifier because you don't use it for a long time. Please pay attention to the following steps:

1. Empty the water in the water tank.
2. Roll up the power cord and tie it up.
3. Clean the filter.
4. Place the machine in a cool and dry environment.

COMMON FAULTS AND SOLUTIONS

Check the information below for troubleshooting steps that will save you time to resolve issues that may happen with the unit. The list includes most common issues. Listed below are not results of defective units, crafts, or materials in the unit. If all troubleshooting steps have been exhausted and the issue is still occurring, feel free to get in touch with Kesnos Customer Service to get further assistance.

Dehumidifier does not work

Is the power cord connected properly?

- Make sure that the unit's plug is inserted properly into the power outlet.

Bucket is not in the proper position

- Pull out the water tank and put it back in properly on the machine. Make sure as well that the water tank is empty.

Room temperature too high or too low. Below 41°F (5°C) or above 95°F (35°C)

- Our product are not suitable to work in places that are exposed in too much heat or cold environment.

Room temperature between 41°F (5°C)and 68 *F (20°C)

- The machine will defrost automatically.Itis the normal phenomenon.

Does the ambient humidity is lower than the humidity setting set to the machine?

- Please set the humidity more than the ambient humidity 30RH% or set the humidity 30RH%.

There is prevent frequent start function in the machine. Dose the machine stop working just now?

- Please wait for more than 3 minutes.

Poor dehumidification efficiency

Poor air circulation

- Please leave about 20cm around the product.

Low ambient humidity

- It is just the expected behavior from the machine.

The dehumidifier makes a loud noise when operating

Is there blocking around the air inlet?

- Clean up the dirty form the air outlet and intake.

Is the filter installed correctly?

- Please check whether the filter packing bag removed and install correctly.

Warning:

If the dehumidifier is still not working properly as expected and the troubleshooting steps or solutions above may not resolve the issue. Please unplug the power and shut down the dehumidifier then contact Kesnos customer support@kesnos.com

SAFETY NOTE



1. When using, please do not put the machine at the soft and uneven ground. avoid vibration and movement.



2. Do not insert thin rods and hard objects into the fuselage to avoid malfunction and danger.



3. When using, please keep the machine away from heating furnace, electric kettle and other heat sources.



4. When using, make sure doors and windows are closed to get the best humidity removal effect.



5. Please do not put objects around the body. If the ventilation is blocked, the dehumidification effect will be affected



6. If do not use the product for a long time, please unplug the power cord



7. When cleaning the dehumidifier fuselage, please use wet cloth or textile to wipe the unit's surface gently, do not splash water on the unit directly.

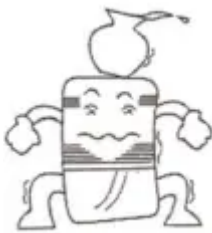

8. Please do not put any object on the dehumidifier.



9. Please clean the filter every two weeks (do not use hot water above 104F, gasoline toluene)



10. When on continuous drainage. make sure the drainage pipe is placed horizontally on the ground Avoid the pipe to be on uneven surface or in an arch position.



11. After cleaning the filter. do not dry the unit under direct sunlight to avoid filter deformation



12. Before moving and carrying the machine. please first pour out the water in the tank.

ENVIRONMENTAL CLAIMS

This product meets the requirements of the Measures for the Administrative of the Restricted Use of Hazardous Substances Contained in Electrical and Electronic Products.

- In accordance to the environmental protection. consumers that will use the unit normally, as expected, will not bring any harmful substances, precipitation and other factors that could affect their health.
- The environmental protection period of the company is 10 years. The term “environmental protection period” is valid only when the product is used normally under the circumstances described in this manual.

The name and content of Hazardous substances in the product

Part	Harmful Substance						Note
	Pb	Hg	Cd	Cr(VI)	PBB	PBDE)	
plastic parts	o	o	o	o	o	o	
Hardware	o	o	o	o	o	o	Contains sheet metal; screws
Refrigeration accessories	o	o	o	o	o	o	Contains two copper tubes, compressors, refrigeration valves
Electric control board assembly	X	o	X	o	o	o	Contains sensor
Other electrical devices	o	o	o	o	o	o	Contain:Motor capacitor ion generator
power cable	X	o	o	o	o	o	

This form is prepared in accordance with the provisions of SJ/T 11364 :Indicates that the content of the harmful substance in all homogeneous materials of the component is below the limit specified in GB/T 26572.

X:Indicates that the content of the harmful substance in at least one homogeneous material of the component exceeds the limit specified in GB/T 26572.

Note: The above label "x" parts contain harmful substances which exceed the standard due to the current technical level of the industry. temporarily unable to achieve substitution or reduction.

Warning

This content is compiled from multiple sources and is provided for reference purposes only. It may not be complete or fully applicable to all situations. If you are unable to resolve your issue, please contact the product manufacturer or an authorized service provider for official support.