

## Precautions When Using the Product

Refer to the following to use the product for its normal life span

	Do not pull the earphone cable with excessive force
	If the product is exposed to excessive sweat, clean the product.
	Keep the earbuds clean
	For your safety, do not wear the product while it is being charged.

## HD Speaker

If the communication network of the device you are connecting to supports HD Voice Calling, you can enjoy making voice calls and listening to music in high definition.

## Product Components



LG TONE ULTRA HBS-835 /  
LG TONE ULTRA α HBS-830  
(medium ear gels installed)

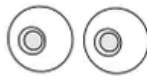

Extra Ear Gels  
(small)

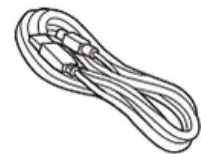

Micro USB  
Charging Cable  
(Optional)



User Manual



Warranty Card

**NOTE:** Actual product design may differ from images shown in manual. The option item are not available in some products.

### CAUTION

Make sure authentic LG Electronics components are used. Using a non-authentic component may damage the product and thus void the warranty.

## Product Description

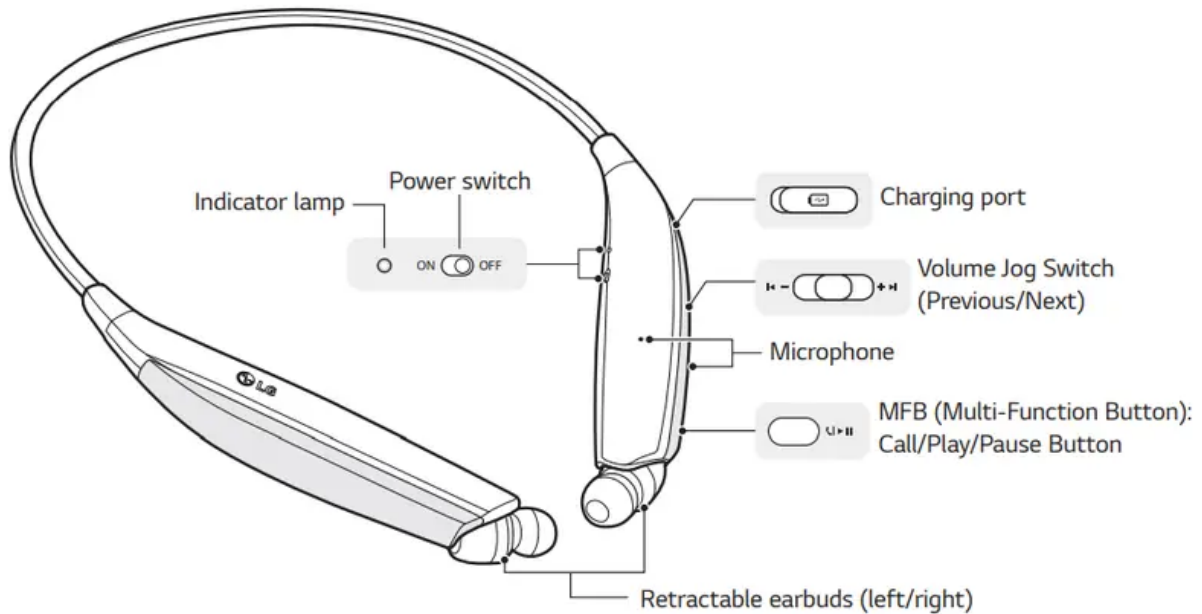

\* The appearance and specifications of the actual product may differ depending on the model.

**NOTE:** To prevent hearing loss, a control sound is played twice or at length when controlling the volume at high volumes.

## Pairing and Connecting



Put in your earbuds to easily pair and connect by following the voice prompts.

**NOTE:** If you are prompted for the authorization code (PIN code), type 0000.

If you hear that the battery is insufficient, recharge the battery before proceeding with pairing.

If pairing is not completed within three minutes, the power automatically turns off. If this happens, slide the Power switch from the OFF to the ON position to turn the power on.

## Connecting Quickly

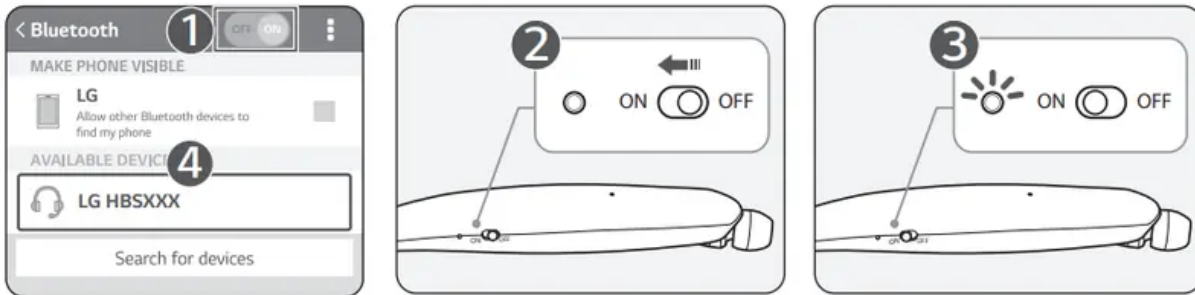

1. From the mobile phone's Settings menu, turn on Bluetooth.
2. On the headset, slide the Power switch towards the ON position to turn on the power.
3. The blue Indicator lamp turns on, and the headset enters Search mode.
4. From the mobile phone or device, select [LG HBSXXX] to connect.

- **NOTE:** In the above, HBSXXX is a model number unique to the product and may differ depending on the model (For example, in the case of a HBS-835 model, LG HBS835 is displayed).

5. A voice message will indicate that the connection is completed.

## Fast Pair

1. From the mobile phone's Settings menu, turn on Bluetooth.
2. On the headset, slide the Power switch towards the ON position to turn on the power.
3. The blue Indicator lamp turns on, and the headset enters Search mode.
4. Please place the mobile phone whose screen is unlocked or a device to be connected nearby and connect it to the headset according to the instructions on the screen.
5. A voice message will indicate that the connection is completed.

- **NOTE:** It only supports Android™ 6.0 or above.

Before connecting the headset, configure the mobile device or the device to be connected to use the location information.

## Connecting Manually (pairing with another phone or re-pairing)

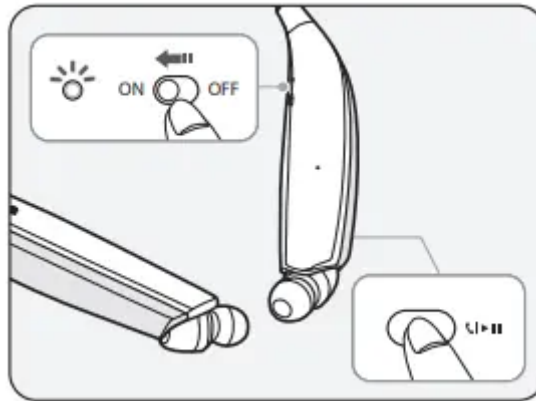

1. Press and hold the MFB and slide the Power switch to the ON position to turn it on.
2. The blue Indicator lamp turns on and the headset switches to Search mode.
3. From the mobile phone or device, select [LG HBSXXX] to connect.

**NOTE:** In the above, HBSXXX is a model number unique to the product and may differ depending on the model (For example, in the case of a HBS-835 model, LG HBS835 is displayed)

## Multiple Connections

The headset can be connected to two devices, such as a mobile phone and a PC, simultaneously.

**NOTE:** If the headset is simultaneously connected to two devices, the main functions work based on the “Main Connected Device.”

1. Press and hold the MFB and slide the Power switch to the ON position to turn it on.
2. Perform Steps 2 to 4 under “Connecting Quickly.” This device becomes the “Main Connected Device.”
3. Try to connect to headset using a previously connected device. This device becomes the “Sub Connected Device.”.

## Automatic Reconnection

If you turn on the headset, it will automatically connect to the most recent (Main or Sub Connected Device) device it was connected to. (If a device cannot be found, Search mode will be activated.)

If the product does not automatically connect to the device you want, search for your product on the device you want to connect to and connect it manually

## Indicator Lamp

Status	Description
Power On/Power Off	The blue <b>Indicator lamp</b> flashes.
Search Mode	The blue <b>Indicator lamp</b> is on.
Headset/Hands-free Profile Connected/Call Connected	The <b>Indicator lamp</b> will flash blue every five seconds.

## Mobile Calling Functions

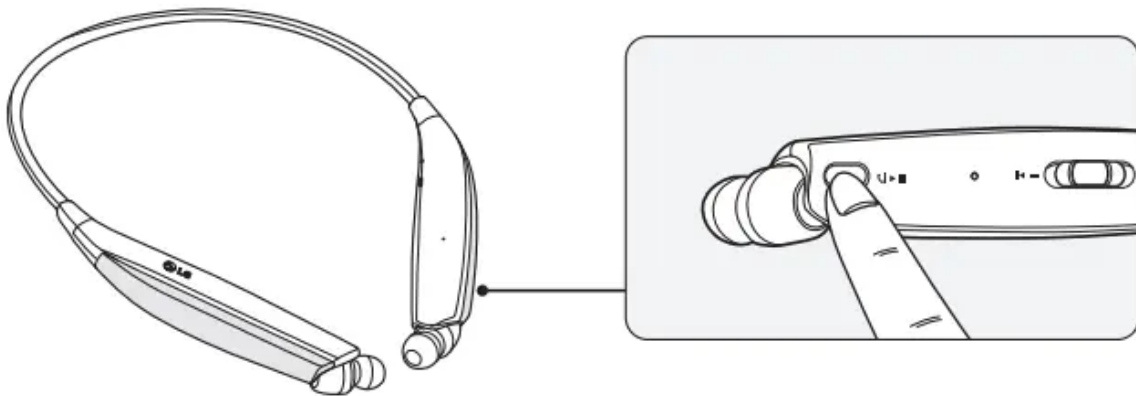

Functions	Status	Description
Answering Call	Ringing	Briefly press the <b>MFB</b> . NOTE: The headset will not vibrate if the Vibration function has been turned off.
Making a Call	Idle	If you make a call using a mobile phone, the call is automatically connected to the headset.
Switching Calls	Talking	Slide and hold the <b>Volume jog switch</b> in the volume up ( + ) direction for more than one second.
Redial	Idle/ Music on	Press and hold the <b>MFB</b> for more than one second to place a call to the last number dialed
Voice Dial	Idle/ Music on	Briefly press the <b>MFB</b> twice to active your headset's voice.
Receiving a Call While on the Phone	Talking	You can receive another call while on the phone by pressing and holding the <b>MFB</b> for one second. The existing call switches to a call waiting status. Press and hold the <b>MFB</b> again for one second to switch back to the previous call. Briefly press the <b>MFB</b> to end the existing call; briefly press it again to end the second call. (Performance may differ depending on the mobile phone settings.)
Rejecting a Call	Ringing	Press and hold the <b>MFB</b> for two seconds.
Enabling/Disabling Mute	Talking	Slide and hold the <b>Volume jog switch</b> in the volume down ( - ) direction for one second.
Volume up/Volume down	Talking	Briefly Slide the <b>Volume jog switch</b> to the volume up ( + ) or volume down ( - ) direction.

**CAUTION:** Do not disable/enable the Mute function while driving, as you need to use both hands.

**NOTE:** The Voice Dial and Redial functions work on the Main Connected Device or on the device on which you made the last call. (The Voice Dial and Redial functions may work differently depending on the mobile phone being used.)

## Playing Music

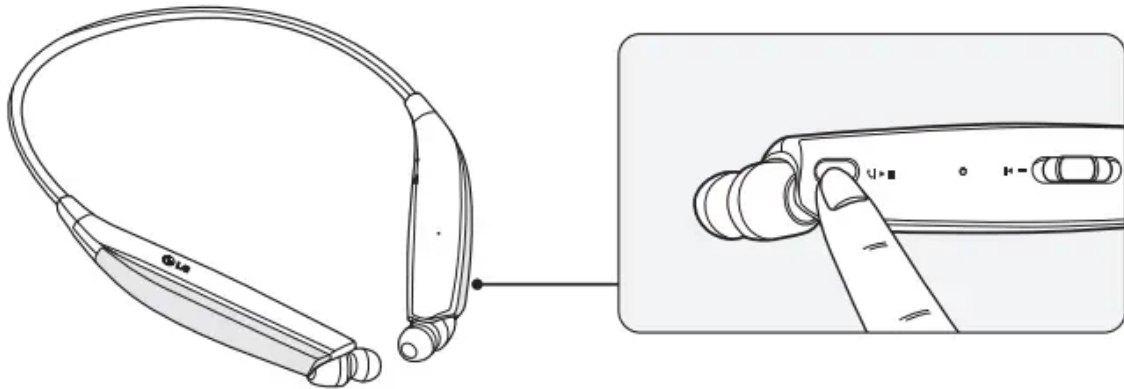

Functions	Status	Description
Play	Idle	Briefly press the <b>MFB</b> .
Pause	Music on	Briefly press the <b>MFB</b> .
Play Previous/Next Song	Music on	Slide and hold the <b>Volume jog switch</b> in the Previous ( <b>⏮</b> ) or Next ( <b>⏭</b> ) direction for one second to play the previous or next song.
Volume up/Volume down	Music on	Briefly Slide the <b>Volume jog switch</b> in the volume up ( <b>+</b> ) or volume down ( <b>-</b> ) direction.

## Switching Music Players

To switch to a different music playback device when multiple devices are connected, stop the currently playing music and then play music from the device of your choice

## Battery Charging and Alerts

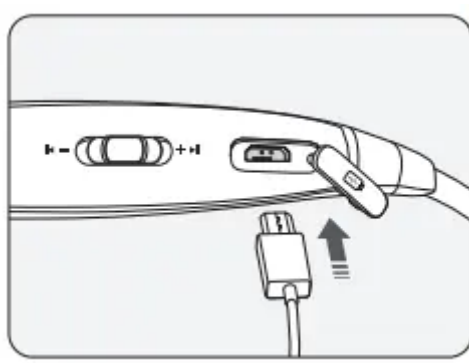

Open the Charging port cover and connect the charger to the Charging port.

Indicator Lamp	Red	Purple	Blue
Battery Status	Charging	80%	Completed

Slide and hold the Volume jog switch in the volume down ( ) direction for one second to check the Indicator lamp and battery level by voice.

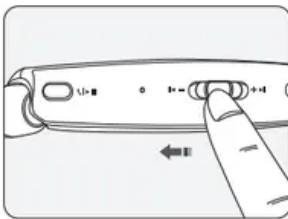

Battery Status	Sufficient	Normal	Insufficient
Indicator Lamp	Blue flashes	Purple flashes	Red flashes

## Vibration Alert Settings

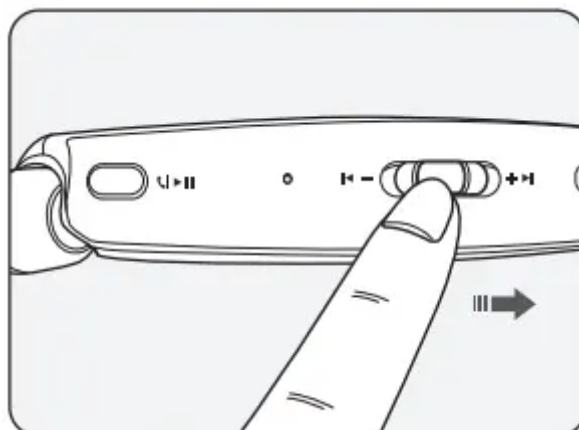

Slide and hold the Volume jog switch in the volume up ( ) direction for two seconds when the headset is not in use.

If you turn off the vibration alerts, it will not vibrate even when a call is being received or you are out of communication range.

**NOTE:** When vibration is turned off, the headset will not vibrate when receiving an incoming call.

## Out of Range

If the device connected to the product is out of effective communication range (33 feet/10 meters), the communication signal becomes weak and the communication is lost.

If the device comes back within effective communication range, the product automatically reconnects to the device. If the device is not automatically reconnected, press the MFB on the product to connect to it manually.

If a device that is not in use goes out of communication range when multiple devices are connected, the product vibrates and a voice message indicates that the connection is lost. In this case, the automatic reconnection function is not supported.

## Troubleshooting

Problems	Solutions
The power does not turn on	Check the battery level and charge it.
Cannot make a call with the headset	If the mobile phone does not support headset and hands-free functions, you cannot use the calling features. Check the battery level and charge it.
Cannot connect the headset to mobile phone	Check whether the headset is turned on. Check whether the headset is in Search mode. - Simultaneously press and hold the MFB and slide the Power switch to the ON position to put the headset in Search mode
The sound is low	Control the sound level of the device connected to the headset

### Warning

This content is compiled from multiple sources and is provided for reference purposes only. It may not be complete or fully applicable to all situations. If you are unable to resolve your issue, please contact the product manufacturer or an authorized service provider for official support.

---

Document generated by [ManualsFile](#)

